



工程指示 / 要求簡箋 ENGINEER INSTRUCTIONS(E.I.)

工程指示編號:	EI- 9168	修改版本:	E
	HK- 0878		
工程編號:	J 861	工程名稱:	己連拿利
收件人:	生統/技術部	發件人:	細佬
工程項目:	幕牆施工圖更新	日期:	07/11/2025

<input type="checkbox"/> 原合約工程包	<input type="checkbox"/> 原合約工程加 / 減賬 QT-	<input type="checkbox"/> 新工程報價 QT-
---------------------------------	--	------------------------------------

信件批核號碼/圖紙參考編號:	批核模具圖紙編號:
客戶指示附件:	管理內部批簽署:

<input type="checkbox"/> 初步鋁料 B.M.	<input type="checkbox"/> 加工拆圖, 然後生產	<input type="checkbox"/> 尺寸表
<input type="checkbox"/> 正式鋁料 B.M.	<input type="checkbox"/> 技術上資料/指示	<input type="checkbox"/> 報價
<input type="checkbox"/> 配件 B.M.	<input type="checkbox"/> 樣辦或貨品說明書	<input type="checkbox"/> 分判合約
<input type="checkbox"/> 其他:		

內容:	<p>給技術部: 幕牆施工圖更新, 請製作相關的加工圖。</p> <p>1.可按CAD檔案繼續做31F和32F加工圖</p> <p>2.附頁在微信回覆廠的紀錄</p> <p>3.FD門底加收口槽</p> <p>CAD文件在以下位置</p> <p>J:\midi_sharepoint\Public\to_china\謝永林\J861\EI9168E_HK0878_CAD</p>
完成上列要求日期:	26/11/2025

國內

<input type="checkbox"/> 生產技術總監	<input type="checkbox"/> 連附件	<input checked="" type="checkbox"/> 技術部	<input checked="" type="checkbox"/> 連附件	<input type="checkbox"/> 生產部	<input type="checkbox"/> 連附件
<input type="checkbox"/> 採購部	<input type="checkbox"/> 連附件	<input type="checkbox"/> 生產統籌部	<input type="checkbox"/> 連附件	<input type="checkbox"/> 報關組	<input type="checkbox"/> 連附件
<input type="checkbox"/> 質檢部	<input type="checkbox"/> 連附件	<input type="checkbox"/> 會計部	<input type="checkbox"/> 連附件	<input type="checkbox"/> 機械設計部	<input type="checkbox"/> 連附件
<input type="checkbox"/> 香港辦	<input type="checkbox"/> 連附件	<input type="checkbox"/> 其他:			

香港

<input type="checkbox"/> 行政部	<input type="checkbox"/> 連附件	<input type="checkbox"/> 會計部	<input type="checkbox"/> 連附件	<input type="checkbox"/> 統籌部	<input type="checkbox"/> 連附件	<input type="checkbox"/> 工程部	<input type="checkbox"/> 連附件
<input type="checkbox"/> 採購部	<input type="checkbox"/> 連附件	<input type="checkbox"/> QS部	<input type="checkbox"/> 連附件	<input type="checkbox"/> 地盤管理	<input type="checkbox"/> 連附件	<input type="checkbox"/> 維修部	<input type="checkbox"/> 連附件

*發件人簽署:	*組別成員批核簽署:
傳遞編號:	項目經理簽署: 

# 可按CAD檔案繼續做31F和32F加工圖

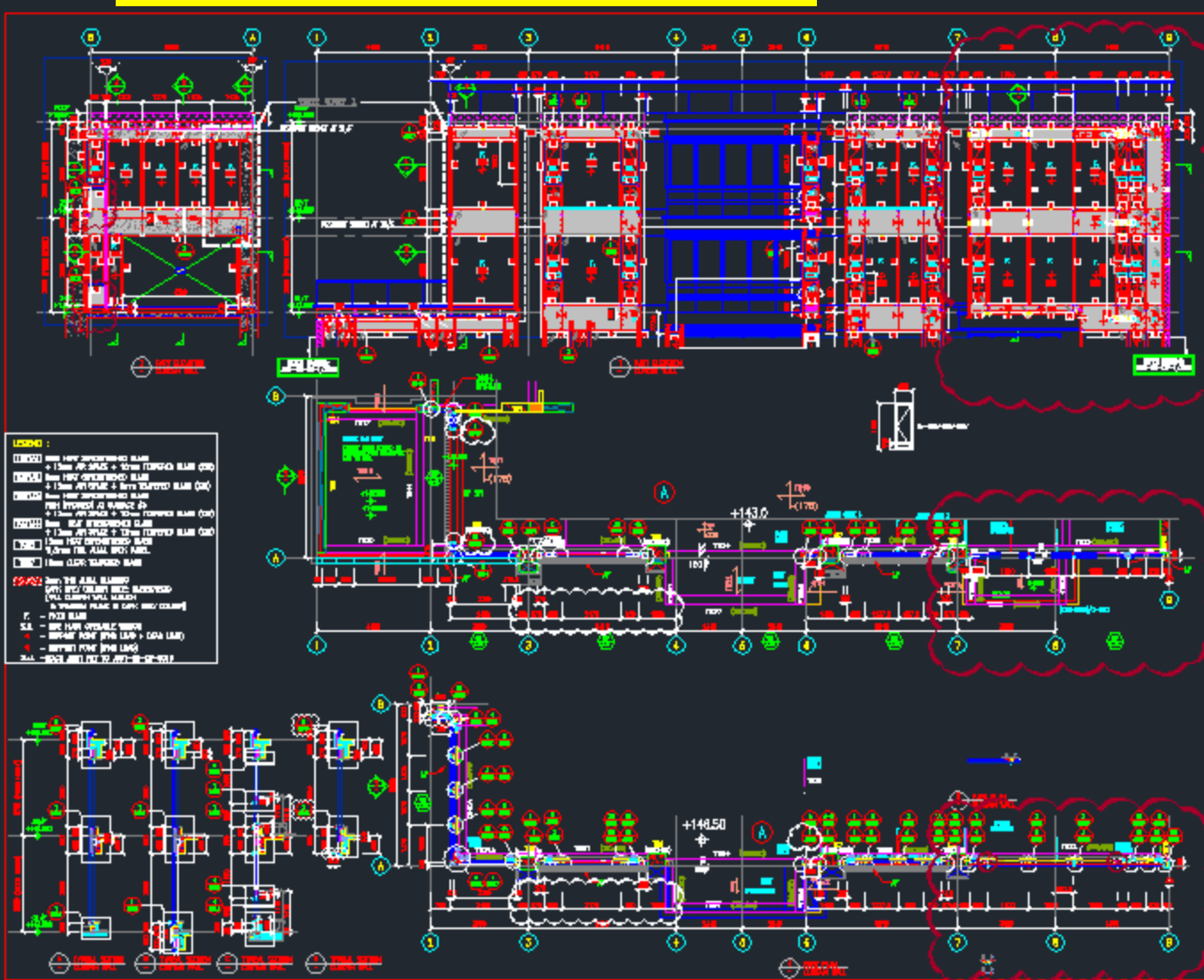

- LEGEND :**
- 100mm REINFORCED SLAB
  - 150mm REINFORCED SLAB
  - 200mm REINFORCED SLAB
  - 250mm REINFORCED SLAB
  - 300mm REINFORCED SLAB
  - 350mm REINFORCED SLAB
  - 400mm REINFORCED SLAB
  - 450mm REINFORCED SLAB
  - 500mm REINFORCED SLAB
  - 550mm REINFORCED SLAB
  - 600mm REINFORCED SLAB
  - 650mm REINFORCED SLAB
  - 700mm REINFORCED SLAB
  - 750mm REINFORCED SLAB
  - 800mm REINFORCED SLAB
  - 850mm REINFORCED SLAB
  - 900mm REINFORCED SLAB
  - 950mm REINFORCED SLAB
  - 1000mm REINFORCED SLAB
  - 1050mm REINFORCED SLAB
  - 1100mm REINFORCED SLAB
  - 1150mm REINFORCED SLAB
  - 1200mm REINFORCED SLAB
  - 1250mm REINFORCED SLAB
  - 1300mm REINFORCED SLAB
  - 1350mm REINFORCED SLAB
  - 1400mm REINFORCED SLAB
  - 1450mm REINFORCED SLAB
  - 1500mm REINFORCED SLAB
  - 1550mm REINFORCED SLAB
  - 1600mm REINFORCED SLAB
  - 1650mm REINFORCED SLAB
  - 1700mm REINFORCED SLAB
  - 1750mm REINFORCED SLAB
  - 1800mm REINFORCED SLAB
  - 1850mm REINFORCED SLAB
  - 1900mm REINFORCED SLAB
  - 1950mm REINFORCED SLAB
  - 2000mm REINFORCED SLAB
  - 2050mm REINFORCED SLAB
  - 2100mm REINFORCED SLAB
  - 2150mm REINFORCED SLAB
  - 2200mm REINFORCED SLAB
  - 2250mm REINFORCED SLAB
  - 2300mm REINFORCED SLAB
  - 2350mm REINFORCED SLAB
  - 2400mm REINFORCED SLAB
  - 2450mm REINFORCED SLAB
  - 2500mm REINFORCED SLAB
  - 2550mm REINFORCED SLAB
  - 2600mm REINFORCED SLAB
  - 2650mm REINFORCED SLAB
  - 2700mm REINFORCED SLAB
  - 2750mm REINFORCED SLAB
  - 2800mm REINFORCED SLAB
  - 2850mm REINFORCED SLAB
  - 2900mm REINFORCED SLAB
  - 2950mm REINFORCED SLAB
  - 3000mm REINFORCED SLAB
  - 3050mm REINFORCED SLAB
  - 3100mm REINFORCED SLAB
  - 3150mm REINFORCED SLAB
  - 3200mm REINFORCED SLAB
  - 3250mm REINFORCED SLAB
  - 3300mm REINFORCED SLAB
  - 3350mm REINFORCED SLAB
  - 3400mm REINFORCED SLAB
  - 3450mm REINFORCED SLAB
  - 3500mm REINFORCED SLAB
  - 3550mm REINFORCED SLAB
  - 3600mm REINFORCED SLAB
  - 3650mm REINFORCED SLAB
  - 3700mm REINFORCED SLAB
  - 3750mm REINFORCED SLAB
  - 3800mm REINFORCED SLAB
  - 3850mm REINFORCED SLAB
  - 3900mm REINFORCED SLAB
  - 3950mm REINFORCED SLAB
  - 4000mm REINFORCED SLAB
  - 4050mm REINFORCED SLAB
  - 4100mm REINFORCED SLAB
  - 4150mm REINFORCED SLAB
  - 4200mm REINFORCED SLAB
  - 4250mm REINFORCED SLAB
  - 4300mm REINFORCED SLAB
  - 4350mm REINFORCED SLAB
  - 4400mm REINFORCED SLAB
  - 4450mm REINFORCED SLAB
  - 4500mm REINFORCED SLAB
  - 4550mm REINFORCED SLAB
  - 4600mm REINFORCED SLAB
  - 4650mm REINFORCED SLAB
  - 4700mm REINFORCED SLAB
  - 4750mm REINFORCED SLAB
  - 4800mm REINFORCED SLAB
  - 4850mm REINFORCED SLAB
  - 4900mm REINFORCED SLAB
  - 4950mm REINFORCED SLAB
  - 5000mm REINFORCED SLAB
  - 5050mm REINFORCED SLAB
  - 5100mm REINFORCED SLAB
  - 5150mm REINFORCED SLAB
  - 5200mm REINFORCED SLAB
  - 5250mm REINFORCED SLAB
  - 5300mm REINFORCED SLAB
  - 5350mm REINFORCED SLAB
  - 5400mm REINFORCED SLAB
  - 5450mm REINFORCED SLAB
  - 5500mm REINFORCED SLAB
  - 5550mm REINFORCED SLAB
  - 5600mm REINFORCED SLAB
  - 5650mm REINFORCED SLAB
  - 5700mm REINFORCED SLAB
  - 5750mm REINFORCED SLAB
  - 5800mm REINFORCED SLAB
  - 5850mm REINFORCED SLAB
  - 5900mm REINFORCED SLAB
  - 5950mm REINFORCED SLAB
  - 6000mm REINFORCED SLAB
  - 6050mm REINFORCED SLAB
  - 6100mm REINFORCED SLAB
  - 6150mm REINFORCED SLAB
  - 6200mm REINFORCED SLAB
  - 6250mm REINFORCED SLAB
  - 6300mm REINFORCED SLAB
  - 6350mm REINFORCED SLAB
  - 6400mm REINFORCED SLAB
  - 6450mm REINFORCED SLAB
  - 6500mm REINFORCED SLAB
  - 6550mm REINFORCED SLAB
  - 6600mm REINFORCED SLAB
  - 6650mm REINFORCED SLAB
  - 6700mm REINFORCED SLAB
  - 6750mm REINFORCED SLAB
  - 6800mm REINFORCED SLAB
  - 6850mm REINFORCED SLAB
  - 6900mm REINFORCED SLAB
  - 6950mm REINFORCED SLAB
  - 7000mm REINFORCED SLAB
  - 7050mm REINFORCED SLAB
  - 7100mm REINFORCED SLAB
  - 7150mm REINFORCED SLAB
  - 7200mm REINFORCED SLAB
  - 7250mm REINFORCED SLAB
  - 7300mm REINFORCED SLAB
  - 7350mm REINFORCED SLAB
  - 7400mm REINFORCED SLAB
  - 7450mm REINFORCED SLAB
  - 7500mm REINFORCED SLAB
  - 7550mm REINFORCED SLAB
  - 7600mm REINFORCED SLAB
  - 7650mm REINFORCED SLAB
  - 7700mm REINFORCED SLAB
  - 7750mm REINFORCED SLAB
  - 7800mm REINFORCED SLAB
  - 7850mm REINFORCED SLAB
  - 7900mm REINFORCED SLAB
  - 7950mm REINFORCED SLAB
  - 8000mm REINFORCED SLAB
  - 8050mm REINFORCED SLAB
  - 8100mm REINFORCED SLAB
  - 8150mm REINFORCED SLAB
  - 8200mm REINFORCED SLAB
  - 8250mm REINFORCED SLAB
  - 8300mm REINFORCED SLAB
  - 8350mm REINFORCED SLAB
  - 8400mm REINFORCED SLAB
  - 8450mm REINFORCED SLAB
  - 8500mm REINFORCED SLAB
  - 8550mm REINFORCED SLAB
  - 8600mm REINFORCED SLAB
  - 8650mm REINFORCED SLAB
  - 8700mm REINFORCED SLAB
  - 8750mm REINFORCED SLAB
  - 8800mm REINFORCED SLAB
  - 8850mm REINFORCED SLAB
  - 8900mm REINFORCED SLAB
  - 8950mm REINFORCED SLAB
  - 9000mm REINFORCED SLAB
  - 9050mm REINFORCED SLAB
  - 9100mm REINFORCED SLAB
  - 9150mm REINFORCED SLAB
  - 9200mm REINFORCED SLAB
  - 9250mm REINFORCED SLAB
  - 9300mm REINFORCED SLAB
  - 9350mm REINFORCED SLAB
  - 9400mm REINFORCED SLAB
  - 9450mm REINFORCED SLAB
  - 9500mm REINFORCED SLAB
  - 9550mm REINFORCED SLAB
  - 9600mm REINFORCED SLAB
  - 9650mm REINFORCED SLAB
  - 9700mm REINFORCED SLAB
  - 9750mm REINFORCED SLAB
  - 9800mm REINFORCED SLAB
  - 9850mm REINFORCED SLAB
  - 9900mm REINFORCED SLAB
  - 9950mm REINFORCED SLAB
  - 10000mm REINFORCED SLAB

- NOTES:**
1. ALL DIMENSIONS ARE IN MM.
  2. ALL DIMENSIONS ARE TAKEN FROM EXTERIOR.
  3. ALL DIMENSIONS TO BE TAKEN AS SHOWN UNLESS OTHERWISE SPECIFIED.
- KEY:**
1. STAIR - FINISH TO TOP SURFACE.
  2. LIFT - FINISH TO SLAB LEVEL.
  3. UP - FINISH TO TOP SURFACE.

PROJECT NO.	1000000000
DATE	10/10/2010
SCALE	1:100

CLIENT: **MELICH BANG PROPERTIES LIMITED**

PROJECT: **WONG YEE SHAN HOUSING PROJECT**



DESIGNER: **WONG TIN ENGINEERING & TECHNOLOGY**

PROJECT: **WONG YEE SHAN HOUSING PROJECT**

CLIENT: **MELICH BANG PROPERTIES LIMITED**

PROJECT: **PROPOSED RECONSTRUCTION OF WONG YEE SHAN HOUSING PROJECT AT PHASE 3-4 (SHEWAN TOMES BUILDING, HONG KONG)**

REVISION: **1-001**

DATE: **10/10/2010**

DATE: 10-Sep-10	SCALE: 1:100
DESIGN BY: WTW	CHECK BY: WTW
PROJECT NO.: 1000000000	REV. NO.: 1

WT slabs\_1.dwg

20251106回復廠

這條企料用哪個節點?

1/5022

2/5022

3/5022

4/5022

這個節點是否錯誤了

用2/5001, 拉手在另一邊

綠色框靠牆壁百葉位用哪個節點?

1 - PART ELEVATION CURTAIN WALL

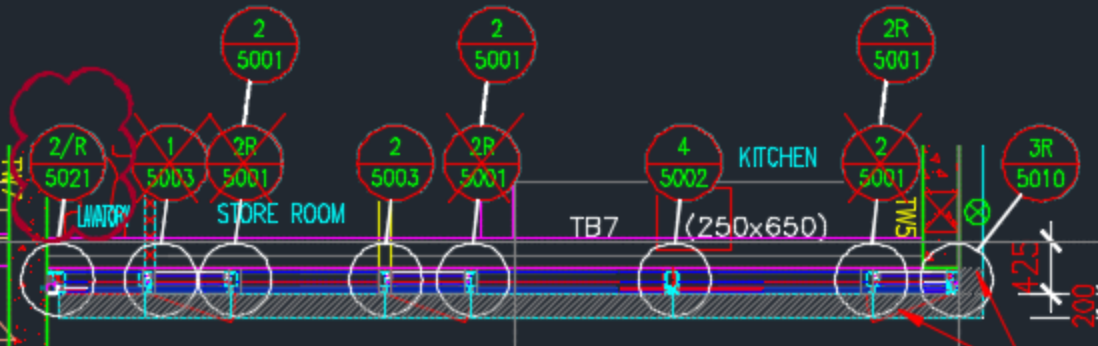
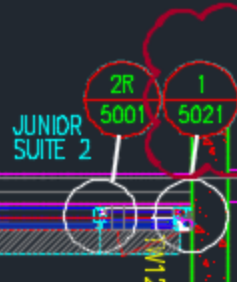
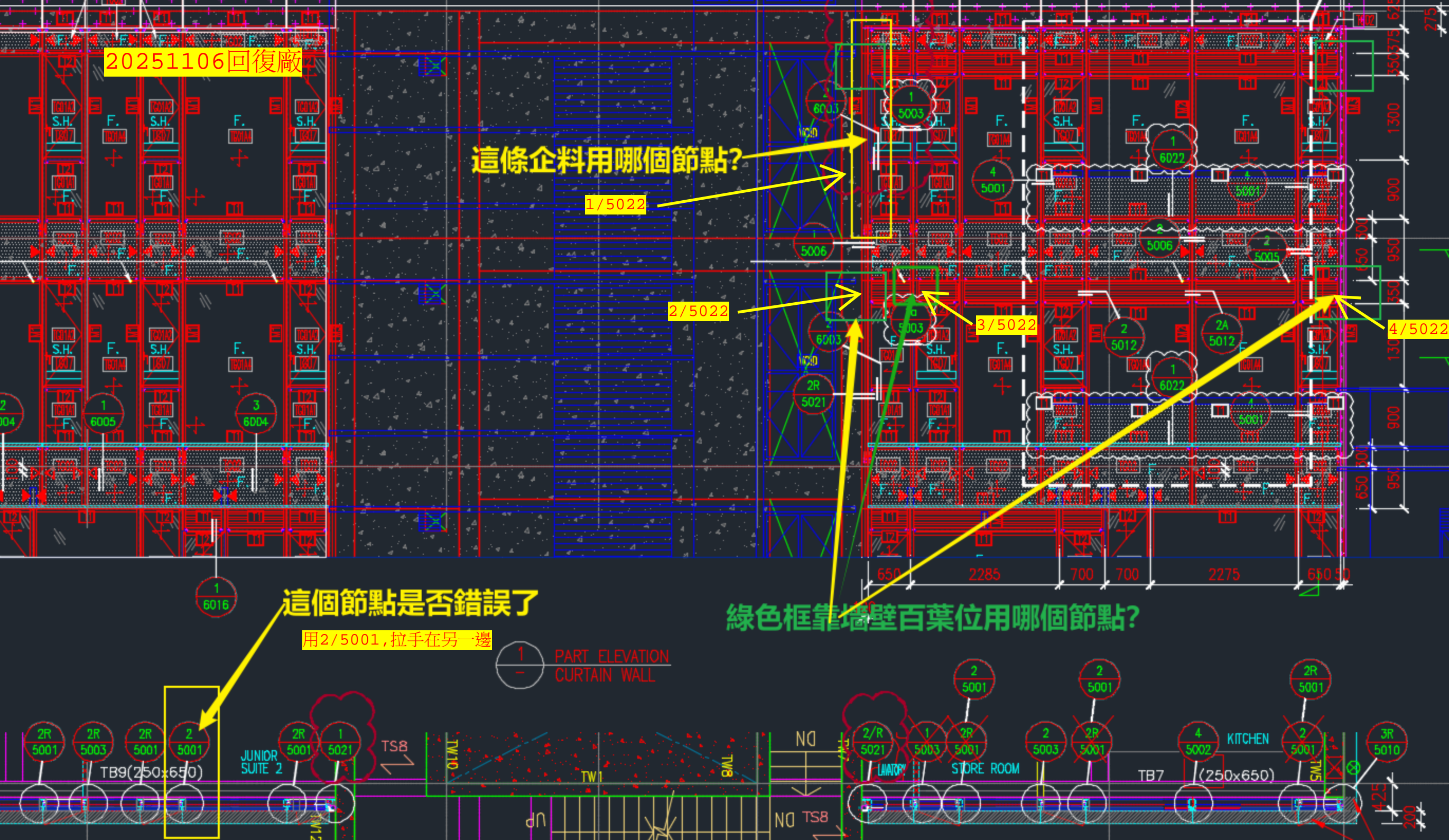

# 20251106回復廠

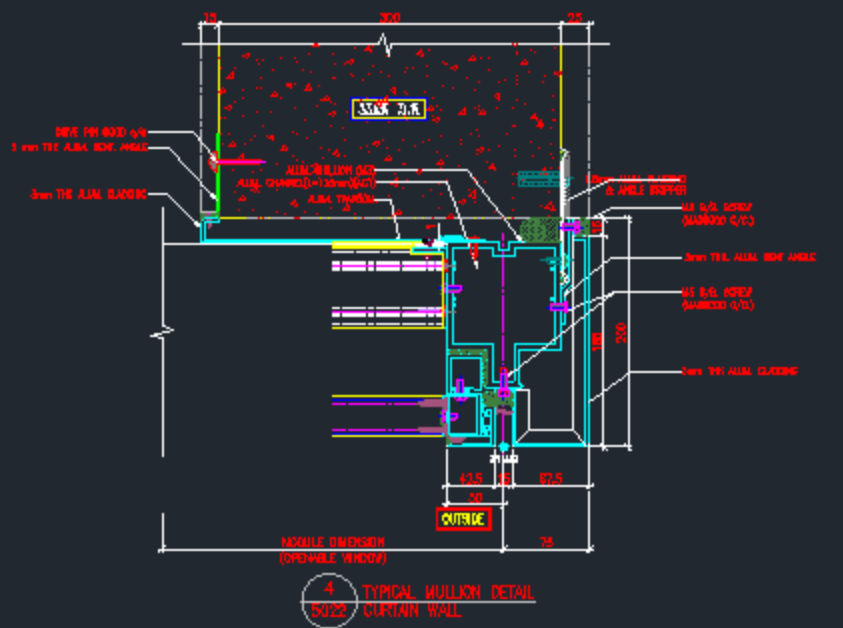
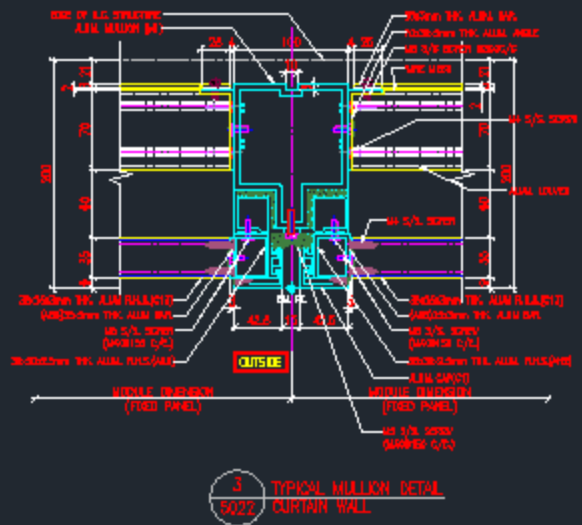
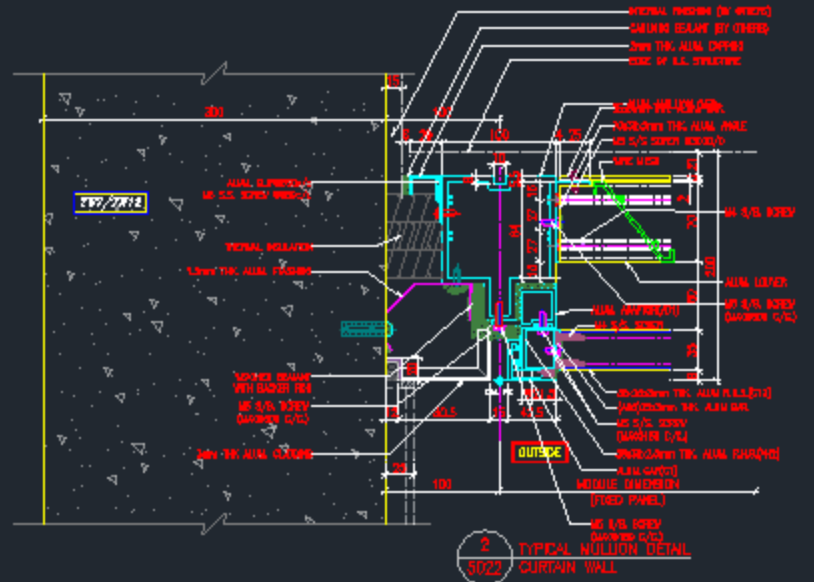
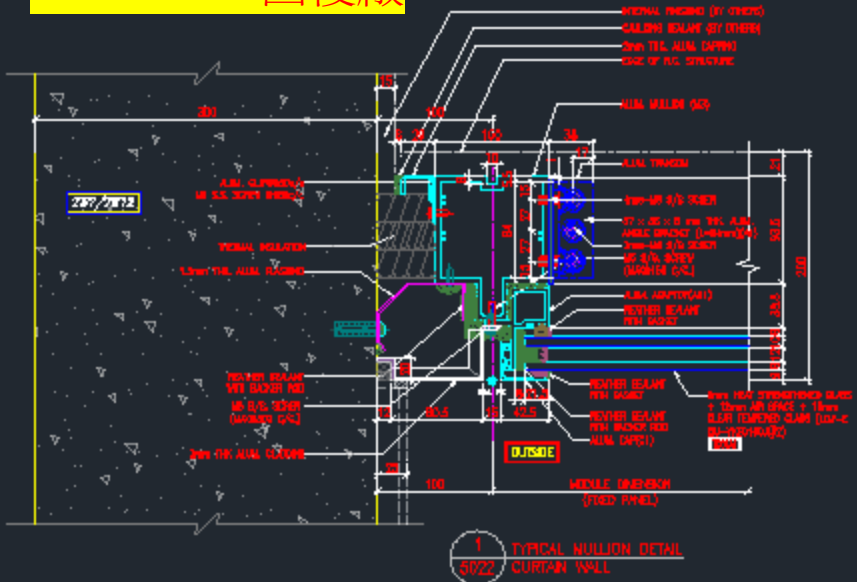



20251107回復廠

這兩個死牆位標註的節點是用生梗企的

2R/2021

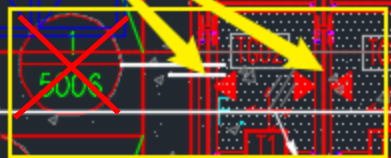

5/2022

但是這兩個位置標註的節點又是雙生企

650

2285

700

700

100

# 20251107回復廠

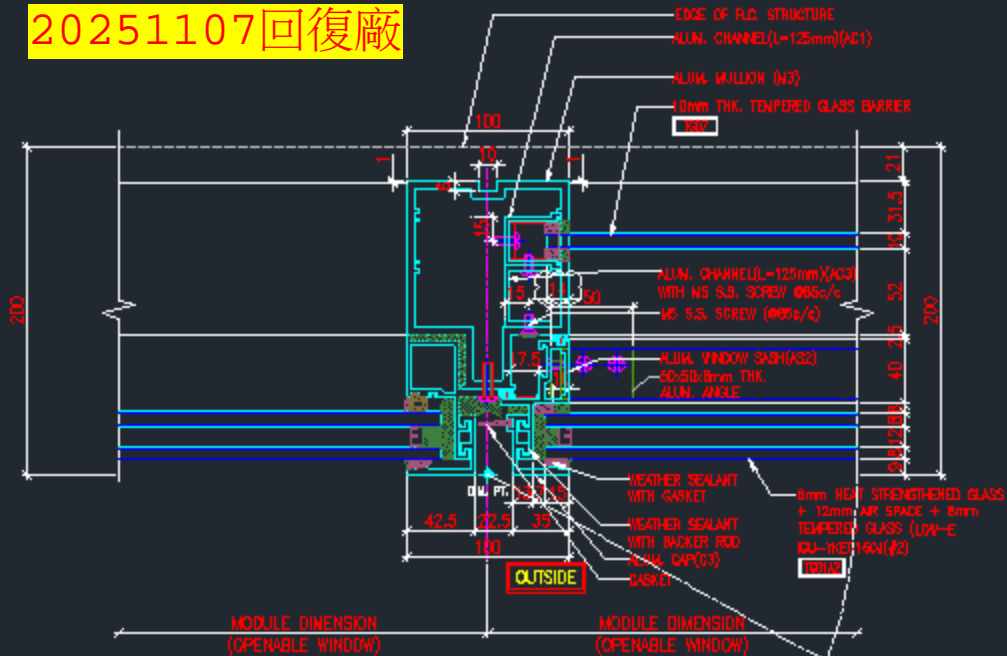

5  
5022 TYPICAL MULLION DETAIL  
CURTAIN WALL

FD門底加收口槽

15/F  
+92.300

12/F  
+89.000

11/F(+85.700)  
10/F(+82.400)  
9/F(+79.100)  
8/F(+75.800)  
7/F(+72.500)  
6/F(+69.200)  
5/F(+65.900)

3/F  
+62.600

3300 (FLOOR HEIGHT)

3300 (FLOOR HEIGHT)

3300 (FLOOR HEIGHT)

300

200 800 1575 550 690 550 1205 1030 1030 1205 550 690 550 1575 800

RESTRAINT SOCKET AT 9/F

1 - PART ELEVATION  
- CURTAIN WALL

3  
6008

MASTER

LIVING & DINING

NO

ROOM  
LIVING & DINING

ENSUITE  
WATER

3R  
6008

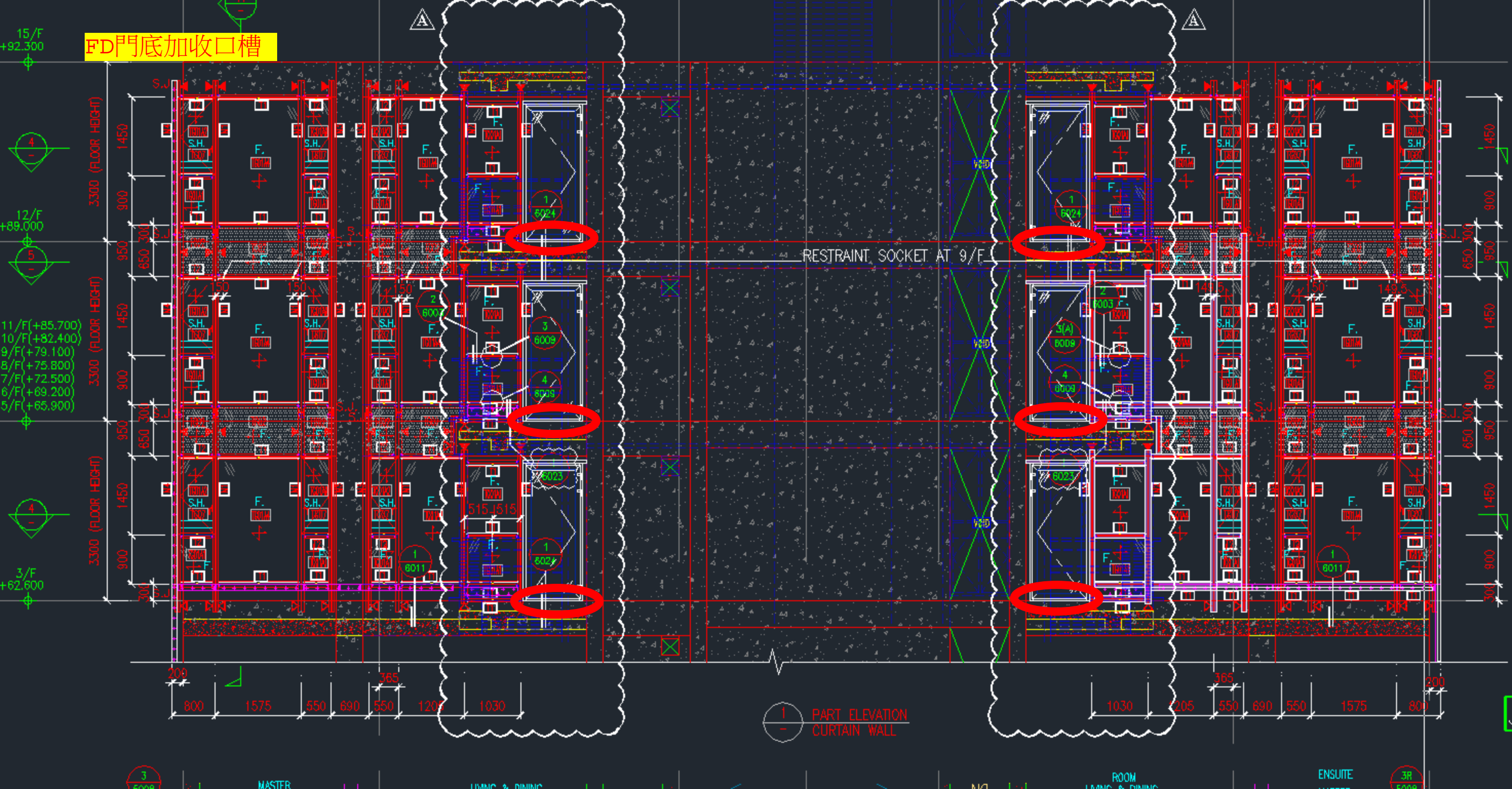

FD門底加收口槽

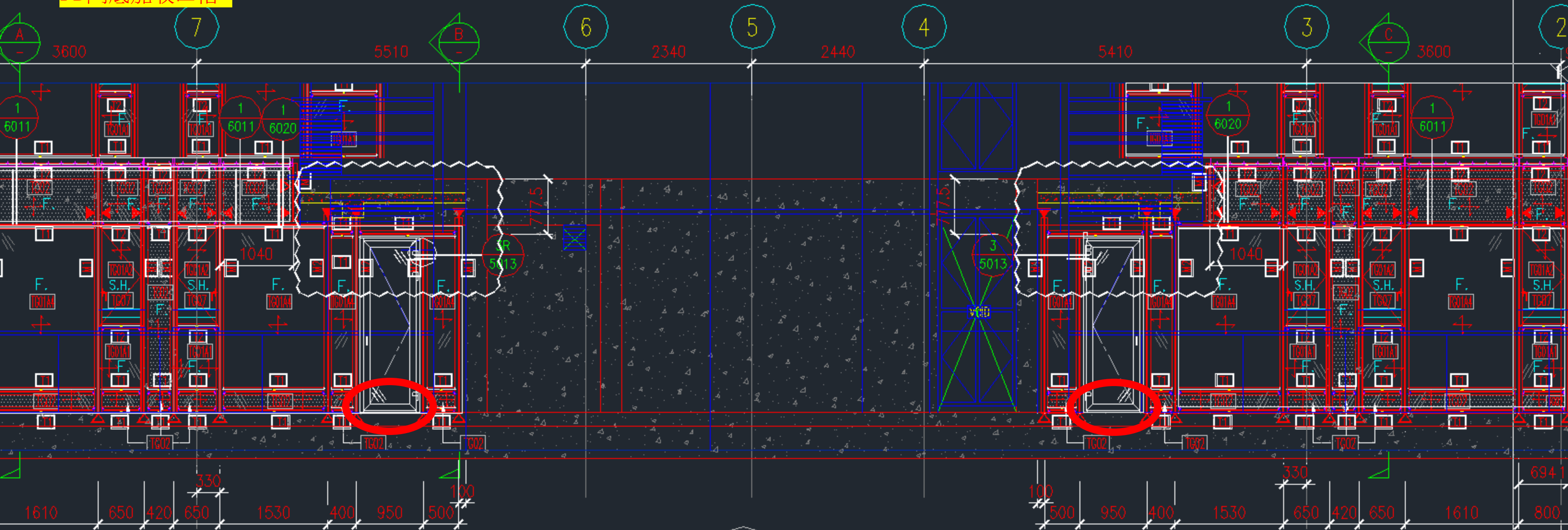

1  
-  
PART ELEVATION  
CURTAIN WALL

ME

92

47

/C

VG

FD門底加收口槽  
紅圈的位置

69

S)

25

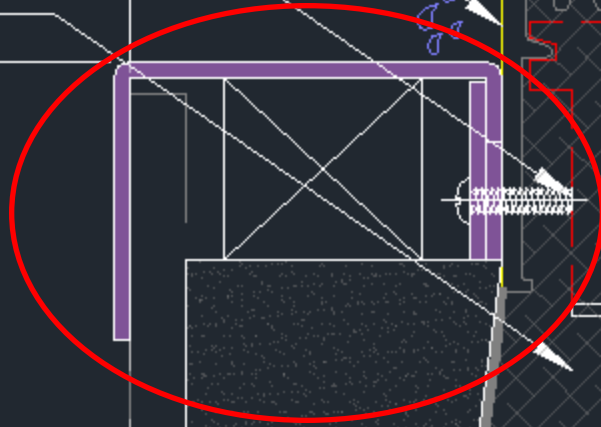

50