



工程指示 / 要求簡箋 ENGINEER INSTRUCTIONS(E.I.)

工程指示編號:	EI- 8934	修改版本:	J
	HK- 0563		
工程編號:	J 861	工程名稱:	己連拿利
收件人:	生統/技術部	發件人:	細佬
工程項目:	後裝窗趟門	日期:	08/07/2025

<input type="checkbox"/> 原合約工程包	<input type="checkbox"/> 原合約工程加 / 減賬 QT-	<input type="checkbox"/> 新工程報價 QT-
---------------------------------	--	------------------------------------

信件批核號碼/圖紙參考編號:	批核模具圖紙編號:
客戶指示附件:	管理內部批簽署:

<input type="checkbox"/> 初步鋁料 B.M.	<input type="checkbox"/> 加工拆圖, 然後生產	<input type="checkbox"/> 尺寸表
<input type="checkbox"/> 正式鋁料 B.M.	<input type="checkbox"/> 技術上資料/指示	<input type="checkbox"/> 報價
<input type="checkbox"/> 配件 B.M.	<input type="checkbox"/> 樣辦或貨品說明書	<input type="checkbox"/> 分判合約
<input type="checkbox"/> 其他:		

內容:	給技術部: 看附頁後裝窗趟門修改闊度(圖號: J861-SD-IW-1101和1101A), 請修改有關的加工圖
	CAD文件在以下位置 J:\midi_sharepoint\Public\to_china\謝永林\J861\EI8934J_HK0563_CAD
完成上列要求日期:	16/07/2025

國內

<input type="checkbox"/> 生產技術總監	<input type="checkbox"/> 連附件	<input checked="" type="checkbox"/> 技術部	<input checked="" type="checkbox"/> 連附件	<input type="checkbox"/> 生產部	<input type="checkbox"/> 連附件
<input type="checkbox"/> 採購部	<input type="checkbox"/> 連附件	<input type="checkbox"/> 生產統籌部	<input type="checkbox"/> 連附件	<input type="checkbox"/> 報關組	<input type="checkbox"/> 連附件
<input type="checkbox"/> 質檢部	<input type="checkbox"/> 連附件	<input type="checkbox"/> 會計部	<input type="checkbox"/> 連附件	<input type="checkbox"/> 機械設計部	<input type="checkbox"/> 連附件
<input type="checkbox"/> 香港辦	<input type="checkbox"/> 連附件	<input type="checkbox"/> 其他:			

香港

<input type="checkbox"/> 行政部	<input type="checkbox"/> 連附件	<input type="checkbox"/> 會計部	<input type="checkbox"/> 連附件	<input type="checkbox"/> 統籌部	<input type="checkbox"/> 連附件	<input type="checkbox"/> 工程部	<input type="checkbox"/> 連附件
<input type="checkbox"/> 採購部	<input type="checkbox"/> 連附件	<input type="checkbox"/> QS部	<input type="checkbox"/> 連附件	<input type="checkbox"/> 地盤管理	<input type="checkbox"/> 連附件	<input type="checkbox"/> 維修部	<input type="checkbox"/> 連附件

*發件人簽署:	*組別成員批核簽署:
傳遞編號:	項目經理簽署: 

REQUIRE	GLAZING AREA	OPENABLE AREA	GLAZING AREA
—	—	1,810	3,254

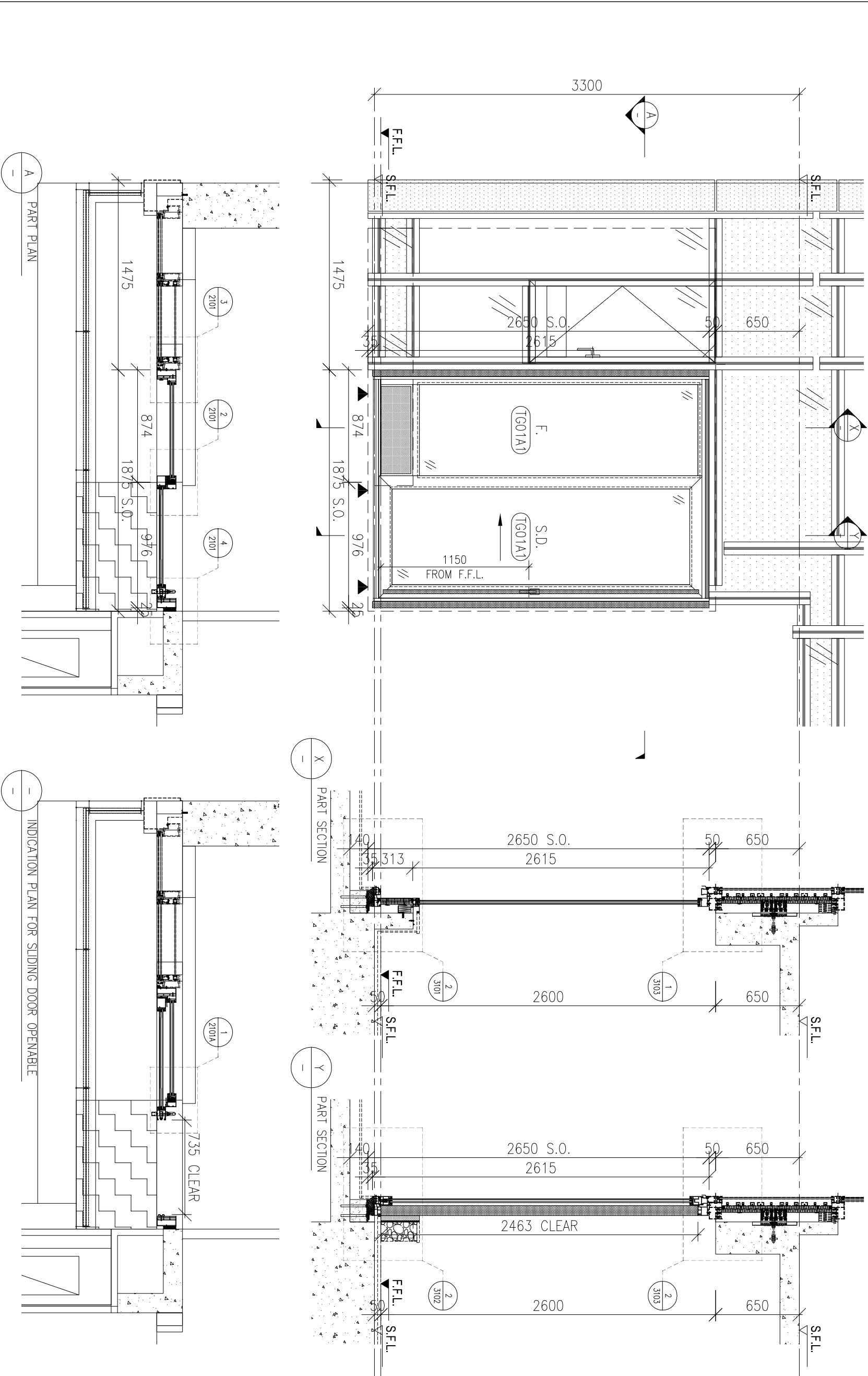

WINDOW MARK	SD-01 1 no.
LOCATION	(FLAT A MASTER ENSUITE AT 2/F)
GLAZING	TG01A1
WINDOW FRAME	150mm ALUM. SLIDING DOOR SECTION

B.O. REF :	
WONG TUNG & PARTNERS LTD.	
APPROVED	
APPROVED AS NOTED & RESUBMIT	
NO COMMENT	
REFER OTHER CONSULTANTS' COMMENTS	
Reviewed By	Date

CLIENT :  
**Pacific Century**  
 Premium Developments  
 盈科大树地產發展

ARCHITECT :  
**WONG TUNG & PARTNERS LIMITED**  
 ARCHITECTS & PLANNERS

MAIN CONTRACTOR :  
**顯利工程有限公司**  
 HIEN LEE ENGINEERING CO., LTD.

STRUCTURAL ENGINEER :  
**SYW & ASSOCIATES LTD.**  
 ARCHITECTS & PLANNERS  
**邵晉偉建築工程師**

FAÇADE CONSULTANT:

NOTE :  
 1. ALL DIMENSIONS ARE IN mm.  
 2. ALL ELEVATIONS ARE VIEWED FROM OUTSIDE.  
 3. ALL DIMENSIONS TO BE VERIFIED ON SITE BEFORE FABRICATION.

LEGEND :  
 (X1) DETAIL MARK NO.  
 (X001) REFER SHEET NO.

1. F.F.L. -- FINISHED FLOOR LEVEL  
 2. S.F.L. -- STRUCTURAL FLOOR LEVEL  
 3. (R) -- REVERSED DETAIL  
 4. F. -- FIXED WINDOW  
 5. S. -- SLIDING DOOR  
 6. GLASS LEGEND  
 T001A1 -- SOUTH-EAST FAÇADE LOW-E IGU (KED)60A (R)  
 T001A1 -- SOUTH-EAST FAÇADE LOW-E IGU (KED)60A (R)  
 Brimms CLEAR GLASS+12A+10mm CLEAR GLASS

NO.	DATE	DESIGN	REVISION	BY
1	23-10-2024			

JOB NO. : J-861  
 PROJECT : PROPOSED RESIDENTIAL DEVELOPMENT AT NOS. 3-6 GLENVALE, CENTRAL, HONG KONG

TITLE : WINDOW SCHEDULE FOR IN-SITU WINDOW

DATE : 26-06-24 SCALE : 1:30 @A3  
 DRAWN BY : IVAN CHECKED BY :  
**美特鋁質有限公司**  
 MIDU ALUMINIUM FABRICATOR LTD.  
 Units 6-8, Sunray Industrial Centre, 1/F  
 610 Ona Kwong Road, Kowloon  
 Tel: 23489211-4 Fax: (852) 27277866  
 DWG NO. : J861-SD-IW-1101 REV. : A

REQUIRE	PROVIDED
OPENABLE AREA	GLAZING AREA
1.687	3.030

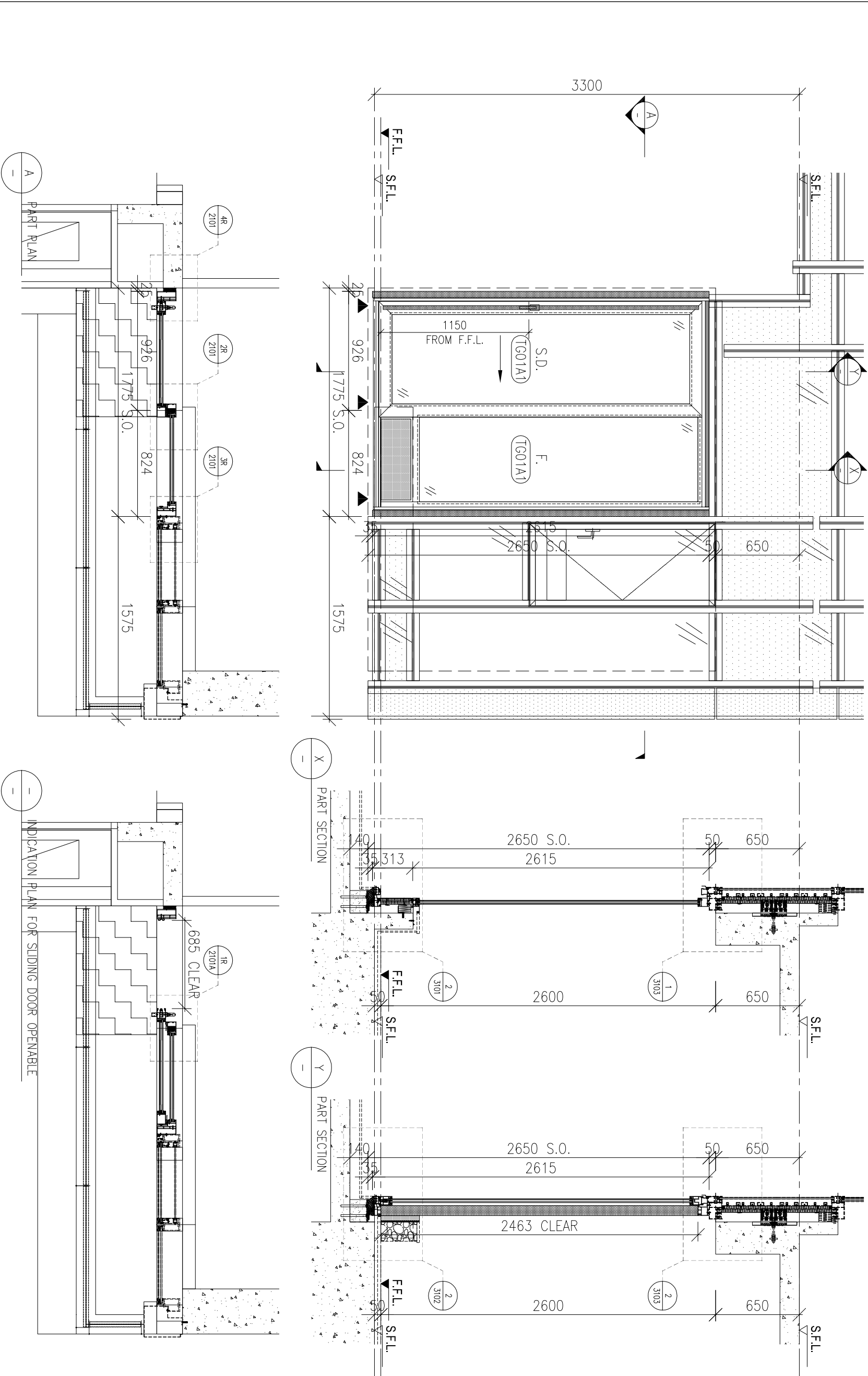

WINDOW MARK	SD-01R 1 no.
LOCATION	(FLAT D MASTER ENSUITE AT 2/F)
GLAZING	TG01A1
WINDOW FRAME	150mm ALUM. SLIDING DOOR SECTION

B.O. REF :	
WONG TUNG & PARTNERS LTD.	
APPROVED	
APPROVED AS NOTED & RESUBMIT	
RESUBMIT	
NO COMMENT	
REFER OTHER CONSULTANT'S COMMENTS	
Reviewed for compliance with the design intent. Comments made shall apply to all similar conditions & details, not just the approval shall not be construed as relieving the contractor for compliance with the contract documents & requirements.	
Reviewed By	Date

CLIENT :  
**Pacific Century**  
 Premium Developments  
 盈科大树地產發展

ARCHITECT :  
**WONG TUNG & PARTNERS LIMITED**  
 ARCHITECTS & PLANNERS

MAIN CONTRACTOR :  
**顯利工程有限公司**  
 HIEN LEE ENGINEERING CO., LTD.

STRUCTURAL ENGINEER :  
**SYW & ASSOCIATES LTD.**  
**SYW** 邵賢偉建築工程師

FAÇADE CONSULTANT:

NOTE :  
 1. ALL DIMENSIONS ARE IN mm.  
 2. ALL ELEVATIONS ARE VIEWED FROM OUTSIDE.  
 3. ALL DIMENSIONS TO BE VERIFIED ON SITE BEFORE FABRICATION.

LEGEND :  
 (X1) DETAIL MARK NO.  
 (X001) REFER SHEET NO.  
 1. F.F.L.--FINISHED FLOOR LEVEL  
 2. S.F.L.--STRUCTURAL FLOOR LEVEL  
 3. (R) --REVERSED DETAIL  
 4. F.--FIXED WINDOW  
 5. S.--SLIDING DOOR  
 6. GLASS LEGEND  
 T001A1--SOUTH-EAST FAÇADE LOW-E IGU-MED160U (F2)  
 Brimms CLEAR GLASS+124+10mm CLEAR GLASS

JOB NO. :	J-861
PROJECT :	PROPOSED RESIDENTIAL DEVELOPMENT AT NOS. 3-6 GLENVALE, CENTRAL, HONG KONG
TITLE :	WINDOW SCHEDULE FOR IN-SITU WINDOW
DATE :	26-06-24
SCALE :	1:30 @A3
DRAWN BY :	IVAN
CHECKED BY :	
UNITS :	Units 6-8, Sunray Industrial Centre, 1/F 610 Ona Kwong Road, Kowloon Tel:23489211-4 Fax:(852)27277666
DWG NO. :	J861-SD-IW-1101A
REV. :	-