

美特鋁質有限公司

MIDI ALUMINIUM FABRICATOR LTD.

(以此為準)



工程指示 / 要求簡箋 ENGINEER INSTRUCTIONS (E.I.)

工程指示編號:	EI- 6365 / 23	修改版本:	-
	HK- 1380 / 23		
工程編號:	J 859	工程名稱:	啟德6551
收件人:	Maggie Ior & 生統	發件人:	nero
工程項目:	後裝趟門 - 廠用不鏽鋼路軌(不鏽鋼巴316)	日期:	19/06/2023

<input type="checkbox"/> 原合約工程包	<input type="checkbox"/> 原合約工程加 / 減賬 QT-	<input type="checkbox"/> 新工程報價 QT-
---------------------------------	--	------------------------------------

信件批核號碼/圖紙參考編號:	批核模具圖紙編號:
客戶指示附件:	管理內部批簽署:

<input type="checkbox"/> 初步鋁料 B.M.	<input type="checkbox"/> 加工拆圖, 然後生產	<input type="checkbox"/> 尺寸表
<input type="checkbox"/> 正式鋁料 B.M.	<input type="checkbox"/> 技術上資料/指示	<input type="checkbox"/> 報價
<input type="checkbox"/> 配件 B.M.	<input type="checkbox"/> 樣辦或貨品說明書	<input type="checkbox"/> 分判合約
<input type="checkbox"/> 其他:		

內容: 請按附件資料訂購, 送廠。 數量: 104 材料: 不鏽鋼 Grade 316
完成上列要求日期: 07/07/2023

國內

<input type="checkbox"/> 生產技術總監	<input type="checkbox"/> 連附件	<input type="checkbox"/> 技術部	<input type="checkbox"/> 連附件	<input type="checkbox"/> 生產部	<input type="checkbox"/> 連附件
<input type="checkbox"/> 採購部	<input type="checkbox"/> 連附件	<input checked="" type="checkbox"/> 生產統籌部	<input checked="" type="checkbox"/> 連附件	<input type="checkbox"/> 報關組	<input type="checkbox"/> 連附件
<input type="checkbox"/> 質檢部	<input type="checkbox"/> 連附件	<input type="checkbox"/> 會計部	<input type="checkbox"/> 連附件	<input type="checkbox"/> 機械設計部	<input type="checkbox"/> 連附件
<input type="checkbox"/> 香港辦	<input type="checkbox"/> 連附件	<input type="checkbox"/> 其他:			

香港

<input type="checkbox"/> 行政部	<input type="checkbox"/> 連附件	<input type="checkbox"/> 會計部	<input type="checkbox"/> 連附件	<input type="checkbox"/> 統籌部	<input type="checkbox"/> 連附件	<input type="checkbox"/> 工程部	<input type="checkbox"/> 連附件
<input checked="" type="checkbox"/> 採購部	<input checked="" type="checkbox"/> 連附件	<input type="checkbox"/> QS部	<input type="checkbox"/> 連附件	<input type="checkbox"/> 地盤管理	<input type="checkbox"/> 連附件	<input type="checkbox"/> 維修部	<input type="checkbox"/> 連附件

*發件人簽署:	<i>(Signature)</i>	*組別成員批核簽署:	<i>(Signature)</i>
傳遞編號:	HK1380 / 23	項目經理簽署:	<i>(Signature)</i>

EG-DWG1



美特鋁質 有限公司
MIDI Aluminium Fabricator Ltd.

類別		物料號	
制圖	LRA	2023.03.09	圖號 J859-SS-2
修改	-	-	數量 XX
日期	-	-	位置
復核	-	-	
批准			

物料編號	數量	L			
SS-W6T5-LG1	21	1424			
SS-W7T5-LG1	21	1354			
SS-W6T6-LG1	21	1424			
SS-W7T6-LG1	21	1354			
SS-W2T9-LG1	20	1454			

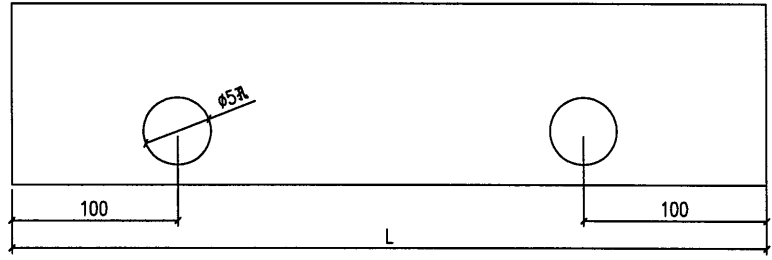
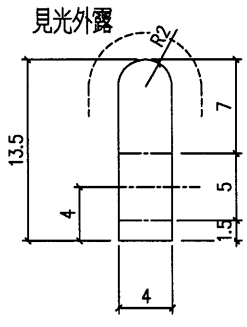

工程號	J-859	地盤	啟德站
名稱	不銹鋼路軌	採用	
材料	不銹鋼巴 (316)	地盤	
顏色		工廠	

附件	
----	--

3.7.6 Sliding / Folding Door Systems

1. Sliding door systems include Sliding Doors, Lift-and-Slide Doors and Sliding-and-Folding Doors, handle should be plated on both external and internal sides. It shall provide high degree of transparency due to large vent sizes as specified on the Drawings or accepted by Architect. It shall comply with thermal insulation requirement of the project. It shall also provide perfect watertightness not less than 1000 Pa and excellent sound reduction.
2. The sliding door systems shall use local made hardware with Multi-Point Locking System unless specified.
3. Sliding door frame to be 100 mm minimum, and mullion and/or vertical frame to be extended, if required by calculation.
4. Sliding door bottom frame to be 100 mm height and internal edge to be flash with floor finishing of interior works. Guide track at bottom frame should be in Stainless steel Grade 316.
5. Locking system to be considered to Multi-point locking operated by 1 or 2 handle, or 4 handles locking individually, and system to be selected by Architect or Client.
6. Performance of water-tightness to be following to clause 5.1.2(2) of this specification.
7. The performance of the proposed proprietary sliding door system should be supported by a Performance Test carried out by recognized testing authority. The Performance Test Report should be submitted to comply with the followings, but not limited to:
 - i) The water-tightness requirement shall not be less than 0.77 kPa.
 - ii) The structural adequacy shall not be less than +3.5 kPa / -3.0kPa.

3.7.7 Fire Stop / Thermal Insulation / Smoke Seal

1. The fire stop separation and continuous smoke seal, shall follow the requirements of the relevant Hong Kong Buildings Department and Fire Services Department, and comply with the requirements stipulated in Code of Practice for Fire Safety in Buildings 2011.
2. Fire stop insulation and continuous smoke seal, shall be installed continuously from all exterior cladding to beam, column, floor edge, jamb separations, and the like, to complete a perimeter enclosure, or isolation, of each floor and at the roof line to provide a fully sealed barrier from floor to floor between the face of the building structure and the exterior wall without interruption or discontinuity or openings.
3. Fire stop insulation materials shall be ROXUL (formerly CSR) or approved equivalent having a 102 mm minimum thickness from top to bottom. Horizontal Fire Stop Insulation shall be supported on continuous galvanized steel support pans. Installation and support of the fire safing material shall be in full conformance with the written recommendations of the manufacturer. Vertical Fire Stop Insulation shall be placed at the jambs of the facade systems, or other appropriate vertical areas as necessary.
4. The fire stop and thermal insulation shall have a foil face. Foil face shall face upward at horizontal conditions and towards the building interior when installed at jamb conditions. The thermal insulation shall be installed so as to prevent the formation of condensation within the spandrel cavity. The insulation shall be provided with retaining wires, impaling spikes or other suitable means to retain insulation in place.
5. The fire stop separation shall remain effective throughout all building movements and movements in the event of a fire. The fire safing shall be installed in conjunction with a smoke