



工程指示 / 要求簡箋(E.I.)

工程指示編號：EI / 8811 / 25

修改版次：-

工程編號：J - 858

工程名稱：將軍澳日出康城

工程項目：趟門 補 2 件玻璃 T1 玻璃廠責任 第六批

收件人：Maggie

發件人：Ant Yeung

日期：06/03/2025

要求提供 / 確認 事項：

- |                                    |                                     |                               |
|------------------------------------|-------------------------------------|-------------------------------|
| <input type="checkbox"/> 初步鋁料 B.M. | <input type="checkbox"/> 加工拆圖，然後生產  | <input type="checkbox"/> 尺寸表  |
| <input type="checkbox"/> 正式鋁料 B.M. | <input type="checkbox"/> 技術上資料 / 指示 | <input type="checkbox"/> 報價   |
| <input type="checkbox"/> 配件 B.M.   | <input type="checkbox"/> 樣辦或貨品說明書   | <input type="checkbox"/> 分判合約 |

內容：

由於趟門玻璃有“哈哈鏡情況”，信和要求玻璃廠派人到地盤視察。

→ 2025.03.06 早上 信和、本司、三鑫聯檢 T1 16BA 及 16BE 趟門玉。

→ 視察結果：三鑫認同是玻璃廠責任。請盡快安排補做及更換

請按玻璃 BM 生產玻璃，共 2 件 送地盤。

1. 請安排熱浸
2. 不要印上熱浸標籤。只給“可移除”的標籤。
3. 玻璃標籤請註明樓層，座。
4. 分座打扎
5. 第一批為 PR47254 RFC23697 (18 件)，第二批為 EI8303 (5 件)，  
第三批為 EI8437 (1 件)，第四批為 EI 8571 A (4+1 件)，第五批為 EI 8760 (3 件)，  
第六批為 本 EI (2 件) 玻璃廠責任

謝謝

請在 2025.03.27 前完成上列要求。

分發東莞各部門：

- |                                 |                              |                                |                              |                               |                              |                                |                              |
|---------------------------------|------------------------------|--------------------------------|------------------------------|-------------------------------|------------------------------|--------------------------------|------------------------------|
| <input type="checkbox"/> 生產技術總監 | <input type="checkbox"/> 連附件 | <input type="checkbox"/> 技術部   | <input type="checkbox"/> 連附件 | <input type="checkbox"/> 生產部  | <input type="checkbox"/> 連附件 | <input type="checkbox"/> 機械設計部 | <input type="checkbox"/> 連附件 |
| <input type="checkbox"/> 採購部    | <input type="checkbox"/> 連附件 | <input type="checkbox"/> 生產統籌部 | <input type="checkbox"/> 連附件 | <input type="checkbox"/> 小羅&清 | <input type="checkbox"/> 連附件 |                                |                              |
| <input type="checkbox"/> 質檢部    | <input type="checkbox"/> 連附件 | <input type="checkbox"/> 會計部   | <input type="checkbox"/> 連附件 | <input type="checkbox"/> 報關組  | <input type="checkbox"/> 連附件 | <input type="checkbox"/> 其他    | <input type="checkbox"/> 連附件 |

分發香港各部門：

- |                                         |                                         |                               |                              |                              |                              |                                                       |                                         |
|-----------------------------------------|-----------------------------------------|-------------------------------|------------------------------|------------------------------|------------------------------|-------------------------------------------------------|-----------------------------------------|
| <input type="checkbox"/> 行政部            | <input type="checkbox"/> 連附件            | <input type="checkbox"/> 會計部  | <input type="checkbox"/> 連附件 | <input type="checkbox"/> 統籌部 | <input type="checkbox"/> 連附件 | <input checked="" type="checkbox"/> 工程部地盤科文 <u>二寶</u> | <input checked="" type="checkbox"/> 連附件 |
| <input checked="" type="checkbox"/> 採購部 | <input checked="" type="checkbox"/> 連附件 | <input type="checkbox"/> QS 部 | <input type="checkbox"/> 連附件 | <input type="checkbox"/> 維修部 | <input type="checkbox"/> 連附件 | <input type="checkbox"/> 其他                           | <input type="checkbox"/> 連附件            |

傳遞編號：

HK / 25

發件人簽署：

項目經理簽署：

# J858康城11期单元幕墙玻璃分层统计表 (T1趟门)

工程: J858康城11期 (T1)

日期: 2023-06-10

T1 標準層 9-60F

訂購用

序号	玻璃编号	玻璃类型	玻璃尺寸			单面积 (m2)	分层数量	標準層每層幾多件	本次訂購數量	备注	本次訂購面积 (m2)
			W(mm)	x	H(mm)		61F				
1	<del>GL01-57</del>	GL01	<del>1010</del>	x	<del>2374</del>	2.40		1	41	送地盘	98.3
2	GL01-58	GL01	978	x	2525	2.47		1	41	送地盘	101.2
5	GL01-59	GL01	1035	x	2374	2.46		1	41	送地盘	100.7
6	<del>GL01-60</del>	GL01	<del>1003</del>	x	<del>2525</del>	2.53		1	41	送地盘	103.8
9	GL01-61	GL01	1017	x	2374	2.41		6	246	送地盘	593.9
<del>10</del>	<del>GL01-62</del>	GL01	<del>985</del>	x	<del>2525</del>	<del>2.49</del>		6	246	送地盘	611.8
13	GL01-63	GL01	977	x	2374	2.32		2	82	送地盘	190.2
14	GL01-64	GL01	945	x	2525	2.39		2	82	送地盘	195.7
17	GL01-65	GL01	1020	x	2374	2.42		1	41	送地盘	99.3
18	GL01-66	GL01	988	x	2525	2.49		1	41	送地盘	102.3
21	GL01-67	GL01	1005	x	2374	2.39		2	82	送地盘	195.6
<del>22</del>	<del>GL01-68</del>	GL01	<del>973</del>	x	<del>2525</del>	<del>2.46</del>		2	82	送地盘	201.5
						总数量		26	1066		2594.4

GL-01-61

2件

Midi Jason

轉寄訊息

@Midi Jason 今早同你及貴判玻璃廠-三鑫聯檢T1 16BA及16BE趙門玉發現哈哈鏡事宜，三鑫認同是玻璃廠責任。Jason，請盡快安排補做及更換

上午11:36

Midi Jason

轉寄訊息

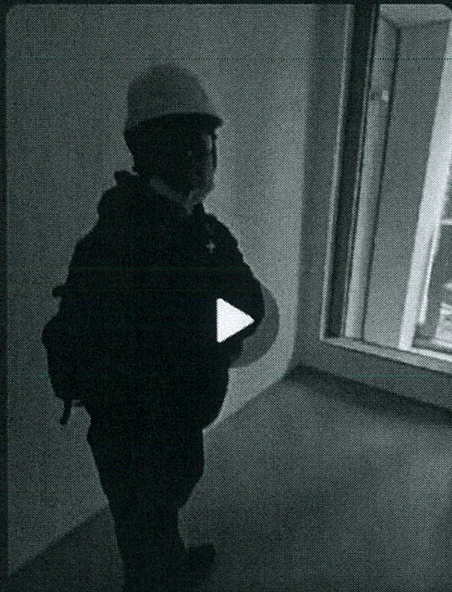

0:37

上午11:36

Midi Jason

轉寄訊息



6/3 早上  
聯檢結果



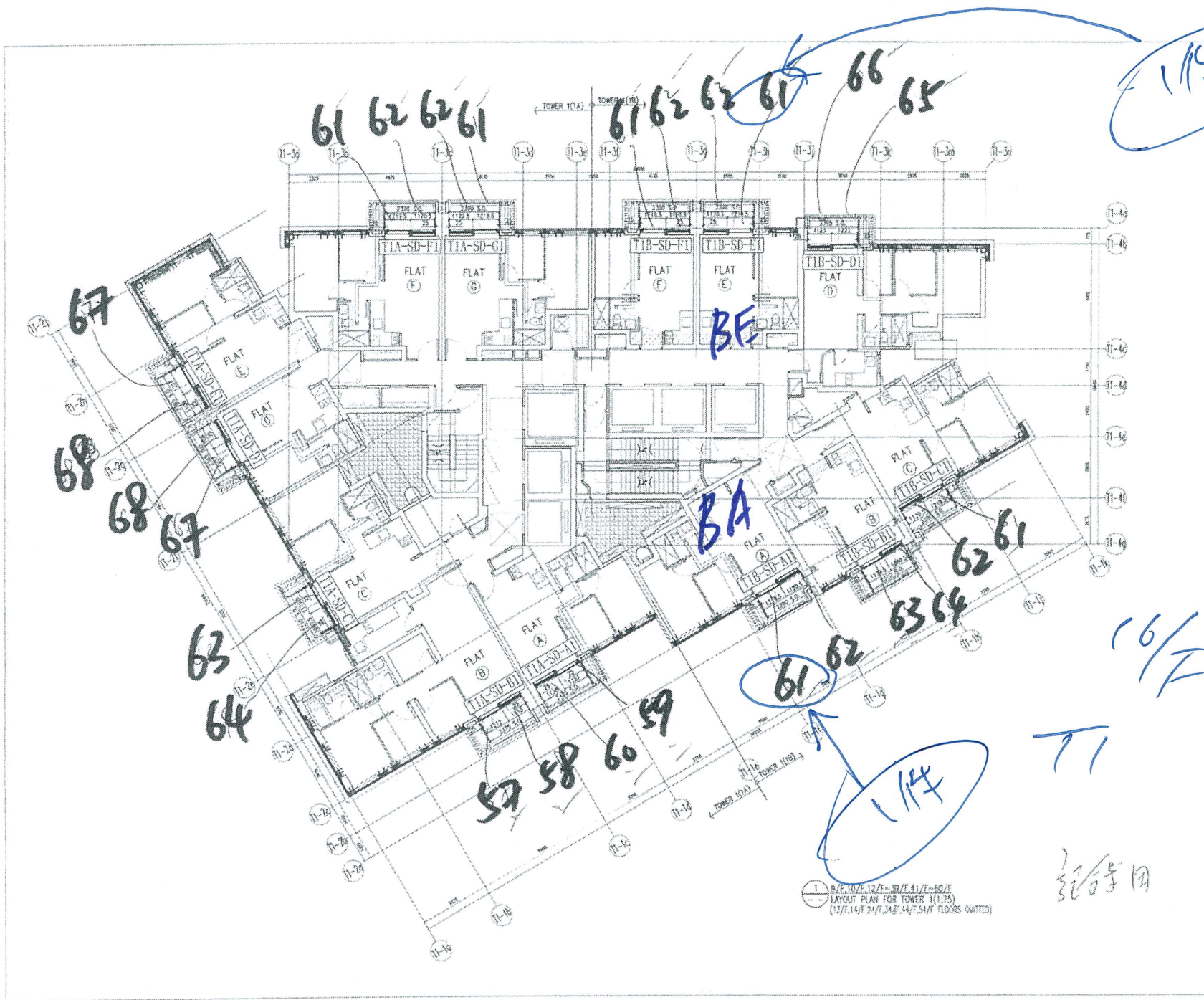

CLIENT: 信和置業有限公司  
Sino Land Company Limited

ARCHITECT: ronald lu & partners  
Ronald Lu & Partners (HK) Ltd.  
呂元偉建築師事務所 (香港) 有限公司

MAX CONSULTANT: Gammon  
STRUCTURAL ENGINEER: AECOM  
FACADE CONSULTANT: AECOM

NOTES:  
1. ALL DIMENSIONS ARE IN MM.  
2. ALL ELEVATIONS ARE VIEWED FROM OUTSIDE.  
3. ALL DIMENSIONS TO BE CHECKED ON SITE BEFORE FABRICATION.

LEGEND:  
① - DETAIL MARK NO.  
② - REFERENCE SHEET NO.

1. FILL - FINISHED FLOOR LEVEL  
2. DASHED - STRUCTURAL FLOOR LEVEL  
3. CIRCLES - REVERSED DETAIL

57	65
58	66
59	67
60	68
61	
62	

11-3a 11-3b 11-3c 11-3d 11-3e 11-3f 11-3g 11-3h 11-3i 11-3j 11-3k 11-3l 11-3m 11-3n 11-3o 11-3p 11-3q 11-3r

11-2a 11-2b 11-2c 11-2d 11-2e 11-2f 11-2g 11-2h 11-2i 11-2j 11-2k 11-2l 11-2m 11-2n 11-2o 11-2p 11-2q 11-2r

11-1a 11-1b 11-1c 11-1d 11-1e 11-1f 11-1g 11-1h 11-1i 11-1j 11-1k 11-1l 11-1m 11-1n 11-1o 11-1p 11-1q 11-1r

11-4a 11-4b 11-4c 11-4d 11-4e 11-4f 11-4g 11-4h 11-4i 11-4j 11-4k 11-4l 11-4m 11-4n 11-4o 11-4p 11-4q 11-4r

11-5a 11-5b 11-5c 11-5d 11-5e 11-5f 11-5g 11-5h 11-5i 11-5j 11-5k 11-5l 11-5m 11-5n 11-5o 11-5p 11-5q 11-5r

11-6a 11-6b 11-6c 11-6d 11-6e 11-6f 11-6g 11-6h 11-6i 11-6j 11-6k 11-6l 11-6m 11-6n 11-6o 11-6p 11-6q 11-6r

11-7a 11-7b 11-7c 11-7d 11-7e 11-7f 11-7g 11-7h 11-7i 11-7j 11-7k 11-7l 11-7m 11-7n 11-7o 11-7p 11-7q 11-7r

11-8a 11-8b 11-8c 11-8d 11-8e 11-8f 11-8g 11-8h 11-8i 11-8j 11-8k 11-8l 11-8m 11-8n 11-8o 11-8p 11-8q 11-8r

11-9a 11-9b 11-9c 11-9d 11-9e 11-9f 11-9g 11-9h 11-9i 11-9j 11-9k 11-9l 11-9m 11-9n 11-9o 11-9p 11-9q 11-9r

11-10a 11-10b 11-10c 11-10d 11-10e 11-10f 11-10g 11-10h 11-10i 11-10j 11-10k 11-10l 11-10m 11-10n 11-10o 11-10p 11-10q 11-10r

11-11a 11-11b 11-11c 11-11d 11-11e 11-11f 11-11g 11-11h 11-11i 11-11j 11-11k 11-11l 11-11m 11-11n 11-11o 11-11p 11-11q 11-11r

11-12a 11-12b 11-12c 11-12d 11-12e 11-12f 11-12g 11-12h 11-12i 11-12j 11-12k 11-12l 11-12m 11-12n 11-12o 11-12p 11-12q 11-12r

11-13a 11-13b 11-13c 11-13d 11-13e 11-13f 11-13g 11-13h 11-13i 11-13j 11-13k 11-13l 11-13m 11-13n 11-13o 11-13p 11-13q 11-13r

11-14a 11-14b 11-14c 11-14d 11-14e 11-14f 11-14g 11-14h 11-14i 11-14j 11-14k 11-14l 11-14m 11-14n 11-14o 11-14p 11-14q 11-14r

11-15a 11-15b 11-15c 11-15d 11-15e 11-15f 11-15g 11-15h 11-15i 11-15j 11-15k 11-15l 11-15m 11-15n 11-15o 11-15p 11-15q 11-15r

11-16a 11-16b 11-16c 11-16d 11-16e 11-16f 11-16g 11-16h 11-16i 11-16j 11-16k 11-16l 11-16m 11-16n 11-16o 11-16p 11-16q 11-16r

11-17a 11-17b 11-17c 11-17d 11-17e 11-17f 11-17g 11-17h 11-17i 11-17j 11-17k 11-17l 11-17m 11-17n 11-17o 11-17p 11-17q 11-17r

11-18a 11-18b 11-18c 11-18d 11-18e 11-18f 11-18g 11-18h 11-18i 11-18j 11-18k 11-18l 11-18m 11-18n 11-18o 11-18p 11-18q 11-18r

11-19a 11-19b 11-19c 11-19d 11-19e 11-19f 11-19g 11-19h 11-19i 11-19j 11-19k 11-19l 11-19m 11-19n 11-19o 11-19p 11-19q 11-19r

11-20a 11-20b 11-20c 11-20d 11-20e 11-20f 11-20g 11-20h 11-20i 11-20j 11-20k 11-20l 11-20m 11-20n 11-20o 11-20p 11-20q 11-20r

11-21a 11-21b 11-21c 11-21d 11-21e 11-21f 11-21g 11-21h 11-21i 11-21j 11-21k 11-21l 11-21m 11-21n 11-21o 11-21p 11-21q 11-21r

11-22a 11-22b 11-22c 11-22d 11-22e 11-22f 11-22g 11-22h 11-22i 11-22j 11-22k 11-22l 11-22m 11-22n 11-22o 11-22p 11-22q 11-22r

11-23a 11-23b 11-23c 11-23d 11-23e 11-23f 11-23g 11-23h 11-23i 11-23j 11-23k 11-23l 11-23m 11-23n 11-23o 11-23p 11-23q 11-23r

11-24a 11-24b 11-24c 11-24d 11-24e 11-24f 11-24g 11-24h 11-24i 11-24j 11-24k 11-24l 11-24m 11-24n 11-24o 11-24p 11-24q 11-24r

11-25a 11-25b 11-25c 11-25d 11-25e 11-25f 11-25g 11-25h 11-25i 11-25j 11-25k 11-25l 11-25m 11-25n 11-25o 11-25p 11-25q 11-25r

11-26a 11-26b 11-26c 11-26d 11-26e 11-26f 11-26g 11-26h 11-26i 11-26j 11-26k 11-26l 11-26m 11-26n 11-26o 11-26p 11-26q 11-26r

11-27a 11-27b 11-27c 11-27d 11-27e 11-27f 11-27g 11-27h 11-27i 11-27j 11-27k 11-27l 11-27m 11-27n 11-27o 11-27p 11-27q 11-27r

11-28a 11-28b 11-28c 11-28d 11-28e 11-28f 11-28g 11-28h 11-28i 11-28j 11-28k 11-28l 11-28m 11-28n 11-28o 11-28p 11-28q 11-28r

11-29a 11-29b 11-29c 11-29d 11-29e 11-29f 11-29g 11-29h 11-29i 11-29j 11-29k 11-29l 11-29m 11-29n 11-29o 11-29p 11-29q 11-29r

11-30a 11-30b 11-30c 11-30d 11-30e 11-30f 11-30g 11-30h 11-30i 11-30j 11-30k 11-30l 11-30m 11-30n 11-30o 11-30p 11-30q 11-30r

11-31a 11-31b 11-31c 11-31d 11-31e 11-31f 11-31g 11-31h 11-31i 11-31j 11-31k 11-31l 11-31m 11-31n 11-31o 11-31p 11-31q 11-31r

11-32a 11-32b 11-32c 11-32d 11-32e 11-32f 11-32g 11-32h 11-32i 11-32j 11-32k 11-32l 11-32m 11-32n 11-32o 11-32p 11-32q 11-32r

11-33a 11-33b 11-33c 11-33d 11-33e 11-33f 11-33g 11-33h 11-33i 11-33j 11-33k 11-33l 11-33m 11-33n 11-33o 11-33p 11-33q 11-33r

11-34a 11-34b 11-34c 11-34d 11-34e 11-34f 11-34g 11-34h 11-34i 11-34j 11-34k 11-34l 11-34m 11-34n 11-34o 11-34p 11-34q 11-34r

11-35a 11-35b 11-35c 11-35d 11-35e 11-35f 11-35g 11-35h 11-35i 11-35j 11-35k 11-35l 11-35m 11-35n 11-35o 11-35p 11-35q 11-35r

11-36a 11-36b 11-36c 11-36d 11-36e 11-36f 11-36g 11-36h 11-36i 11-36j 11-36k 11-36l 11-36m 11-36n 11-36o 11-36p 11-36q 11-36r

11-37a 11-37b 11-37c 11-37d 11-37e 11-37f 11-37g 11-37h 11-37i 11-37j 11-37k 11-37l 11-37m 11-37n 11-37o 11-37p 11-37q 11-37r

11-38a 11-38b 11-38c 11-38d 11-38e 11-38f 11-38g 11-38h 11-38i 11-38j 11-38k 11-38l 11-38m 11-38n 11-38o 11-38p 11-38q 11-38r

11-39a 11-39b 11-39c 11-39d 11-39e 11-39f 11-39g 11-39h 11-39i 11-39j 11-39k 11-39l 11-39m 11-39n 11-39o 11-39p 11-39q 11-39r

11-40a 11-40b 11-40c 11-40d 11-40e 11-40f 11-40g 11-40h 11-40i 11-40j 11-40k 11-40l 11-40m 11-40n 11-40o 11-40p 11-40q 11-40r

11-41a 11-41b 11-41c 11-41d 11-41e 11-41f 11-41g 11-41h 11-41i 11-41j 11-41k 11-41l 11-41m 11-41n 11-41o 11-41p 11-41q 11-41r

11-42a 11-42b 11-42c 11-42d 11-42e 11-42f 11-42g 11-42h 11-42i 11-42j 11-42k 11-42l 11-42m 11-42n 11-42o 11-42p 11-42q 11-42r

11-43a 11-43b 11-43c 11-43d 11-43e 11-43f 11-43g 11-43h 11-43i 11-43j 11-43k 11-43l 11-43m 11-43n 11-43o 11-43p 11-43q 11-43r

11-44a 11-44b 11-44c 11-44d 11-44e 11-44f 11-44g 11-44h 11-44i 11-44j 11-44k 11-44l 11-44m 11-44n 11-44o 11-44p 11-44q 11-44r

11-45a 11-45b 11-45c 11-45d 11-45e 11-45f 11-45g 11-45h 11-45i 11-45j 11-45k 11-45l 11-45m 11-45n 11-45o 11-45p 11-45q 11-45r

11-46a 11-46b 11-46c 11-46d 11-46e 11-46f 11-46g 11-46h 11-46i 11-46j 11-46k 11-46l 11-46m 11-46n 11-46o 11-46p 11-46q 11-46r

11-47a 11-47b 11-47c 11-47d 11-47e 11-47f 11-47g 11-47h 11-47i 11-47j 11-47k 11-47l 11-47m 11-47n 11-47o 11-47p 11-47q 11-47r

11-48a 11-48b 11-48c 11-48d 11-48e 11-48f 11-48g 11-48h 11-48i 11-48j 11-48k 11-48l 11-48m 11-48n 11-48o 11-48p 11-48q 11-48r

11-49a 11-49b 11-49c 11-49d 11-49e 11-49f 11-49g 11-49h 11-49i 11-49j 11-49k 11-49l 11-49m 11-49n 11-49o 11-49p 11-49q 11-49r

11-50a 11-50b 11-50c 11-50d 11-50e 11-50f 11-50g 11-50h 11-50i 11-50j 11-50k 11-50l 11-50m 11-50n 11-50o 11-50p 11-50q 11-50r

11-51a 11-51b 11-51c 11-51d 11-51e 11-51f 11-51g 11-51h 11-51i 11-51j 11-51k 11-51l 11-51m 11-51n 11-51o 11-51p 11-51q 11-51r

11-52a 11-52b 11-52c 11-52d 11-52e 11-52f 11-52g 11-52h 11-52i 11-52j 11-52k 11-52l 11-52m 11-52n 11-52o 11-52p 11-52q 11-52r

11-53a 11-53b 11-53c 11-53d 11-53e 11-53f 11-53g 11-53h 11-53i 11-53j 11-53k 11-53l 11-53m 11-53n 11-53o 11-53p 11-53q 11-53r

11-54a 11-54b 11-54c 11-54d 11-54e 11-54f 11-54g 11-54h 11-54i 11-54j 11-54k 11-54l 11-54m 11-54n 11-54o 11-54p 11-54q 11-54r

11-55a 11-55b 11-55c 11-55d 11-55e 11-55f 11-55g 11-55h 11-55i 11-55j 11-55k 11-55l 11-55m 11-55n 11-55o 11-55p 11-55q 11-55r

11-56a 11-56b 11-56c 11-56d 11-56e 11-56f 11-56g 11-56h 11-56i 11-56j 11-56k 11-56l 11-56m 11-56n 11-56o 11-56p 11-56q 11-56r

11-57a 11-57b 11-57c 11-57d 11-57e 11-57f 11-57g 11-57h 11-57i 11-57j 11-57k 11-57l 11-57m 11-57n 11-57o 11-57p 11-57q 11-57r

11-58a 11-58b 11-58c 11-58d 11-58e 11-58f 11-58g 11-58h 11-58i 11-58j 11-58k 11-58l 11-58m 11-58n 11-58o 11-58p 11-58q 11-58r

11-59a 11-59b 11-59c 11-59d 11-59e 11-59f 11-59g 11-59h 11-59i 11-59j 11-59k 11-59l 11-59m 11-59n 11-59o 11-59p 11-59q 11-59r

11-60a 11-60b 11-60c 11-60d 11-60e 11-60f 11-60g 11-60h 11-60i 11-60j 11-60k 11-60l 11-60m 11-60n 11-60o 11-60p 11-60q 11-60r

11-61a 11-61b 11-61c 11-61d 11-61e 11-61f 11-61g 11-61h 11-61i 11-61j 11-61k 11-61l 11-61m 11-61n 11-61o 11-61p 11-61q 11-61r

11-62a 11-62b 11-62c 11-62d 11-62e 11-62f 11-62g 11-62h 11-62i 11-62j 11-62k 11-62l 11-62m 11-62n 11-62o 11-62p 11-62q 11-62r

11-63a 11-63b 11-63c 11-63d 11-63e 11-63f 11-63g 11-63h 11-63i 11-63j 11-63k 11-63l 11-63m 11-63n 11-63o 11-63p 11-63q 11-63r

11-64a 11-64b 11-64c 11-64d 11-64e 11-64f 11-64g 11-64h 11-64i 11-64j 11-64k 11-64l 11-64m 11-64n 11-64o 11-64p 11-64q 11-64r

11-65a 11-65b 11-65c 11-65d 11-65e 11-65f 11-65g 11-65h 11-65i 11-65j 11-65k 11-65l 11-65m 11-65n 11-65o 11-65p 11-65q 11-65r

11-66a 11-66b 11-66c 11-66d 11-66e 11-66f 11-66g 11-66h 11-66i 11-66j 11-66k 11-66l 11-66m 11-66n 11-66o 11-66p 11-66q 11-66r

11-67a 11-67b 11-67c 11-67d 11-67e 11-67f 11-67g 11-67h 11-67i 11-67j 11-67k 11-67l 11-67m 11-67n 11-67o 11-67p 11-67q 11-67r

11-68a 11-68b 11-68c 11-68d 11-68e 11-68f 11-68g 11-68h 11-68i 11-68j 11-68k 11-68l 11-68m 11-68n 11-68o 11-68p 11-68q 11-68r

11-69a 11-69b 11-69c 11-69d 11-69e 11-69f 11-69g 11-69h 11-69i 11-69j 11-69k 11-69l 11-69m 11-69n 11-69o 11-69p 11-69q 11-69r

11-70a 11-70b 11-70c 11-70d 11-70e 11-70f 11-70g 11-70h 11-70i 11-70j 11-70k 11-70l 11-70m 11-70n 11-70o 11-70p 11-70q 11-70r

11-71a 11-71b 11-71c 11-71d 11-71e 11-71f 11-71g 11-71h 11-71i 11-71j 11-71k 11-71l 11-71m 11-71n 11-71o 11-71p 11-71q 11-71r

11-72a 11-72b 11-72c 11-72d 11-72e 11-72f 11-72g 11-72h 11-72i 11-72j 11-72k 11-72l 11-72m 11-72n 11-72o 11-72p 11-72q 11-72r

11-73a 11-73b 11-73c 11-73d 11-73e 11-73f 11-73g 11-73h 11-73i 11-73j 11-73k 11-73l 11-73m 11-73n 11-73o 11-73p 11-73q 11-73r

11-74a 11-74b 11-74c 11-74d 11-74e 11-74f 11-74g 11-74h 11-74i 11-74j 11-74k 11-74l 11-74m 11-74n 11-74o 11-74p 11-74q 11-74r

11-75a 11-75b 11-75c 11-75d 11-75e 11-75f 11-75g 11-75h 11-75i 11-75j 11-75k 11-75l 11-75m 11-75n 11-75o 11-75p 11-75q 11-75r

11-76a 11-76b 11-76c 11-76d 11-76e 11-76f 11-76g 11-76h 11-76i 11-76j 11-76k 11-76l 11-76m 11-76n 11-76o 11-76p 11-76q 11-76r

11-77a 11-77b 11-77c 11-77d 11-77e 11-77f 11-77g 11-77h 11-77i 11-77j 11-77k 11-77l 11-77m 11-77n 11-77o 11-77p 11-77q 11-77r

11-78a 11-78b 11-78c 11-78d 11-78e 11-78f 11-78g 11-78h 11-78i 11-78j 11-78k 11-78l 11-78m 11-78n 11-78o 11-78p 11-78q 11-78r

11-79a 11-79b 11-79c 11-79d 11-79e 11-79f 11-79g 11-79h 11-79i 11-79j 11-79k 11-79l 11-79m 11-79n 11-79o 11-79p 11-79q 11-79r

11-80a 11-80b 11-80c 11-80d 11-80e 11-80f 11-80g 11-80h 11-80i 11-80j 11-80k 11-80l 11-80m 11-80n 11-80o 11-80p 11-80q 11-80r

11-81a 11-81b 11-81c 11-81d 11-81e 11-81f 11-81g 11-81h 11-81i 11-81j 11-81k 11-81l 11-81m 11-81n 11-81o 11-81p 11-81q 11-81r

11-82a 11-82b 11-82c 11-82d 11-82e 11-82f 11-82g 11-82h 11-82i 11-82j 11-82k 11-82l 11-82m 11-82n 11-82o 11-82p 11-82q 11-82r

11-83a 11-83b 11-83c 11-83d 11-83e 11-83f 11-83g 11-83h 11-83i 11-83j 11-83k 11-83l 11-83m 11-83n 11-83o 11-83p 11-83q 11-83r

11-84a 11-84b 11-84c 11-84d 11-84e 11-84f 11-84g 11-84h 11-84i 11-84j 11-84k 11-84l 11-84m 11-84n 11-84o 11-84p 11-84q 11-84r

11-85a 11-85b 11-85c 11-85d 11-85e 11-85f 11-85g 11-85h 11-85i 11-85j 11-85k 11-85l 11-85m 11-85n 11-85o 11-85p 11-85q 11-85r

11-86a 11-86b 11-86c 11-86d 11-86e 11-86f 11-86g 11-86h 11-86i 11-86j 11-86k 11-86l 11-86m 11-86n 11-86o 11-86p 11-86q 11-86r

11-87a 11-87b 11-87c 11-87d 11-87e 11-87f 11-87g 11-87h 11-87i 11-87j 11-87k 11-87l 11-87m 11-87n 11-87o 11-87p 11-87q 11-87r

11-88a 11-88b 11-88c 11-88d 11-88e 11-88f 11-88g 11-88h 11-88i 11-88j 11-88k 11-88l 11-88m 11-88n 11-88o 11-88p 11-88q 11-88r

11-89a 11-89b 11-89c 11-89d 11-89e 11-89f 11-89g 11-89h 11-89i 11-89j 11-89k 11-89l 11-89m 11-89n 11-89o 11-89p 11-89q 11-89r

11-90a 11-90b 11-90c 11-90d 11-90e 11-90f 11-90g 11-90h 11-90i 11-90j 11-90k 11-90l 11-90m 11-90n 11-90o 11-90p 11-90q 11-90r

11-91a 11-91b 11-91c 11-91d 11-91e 11-91f 11-91g 11-91h 11-91i 11-91j 11-91k 11-91l 11-91m 11-91n 11-91o 11-91p 11-91q 11-91r

11-92a 11-92b 11-92c 11-92d 11-92e 11-92f 11-92g 11-92h

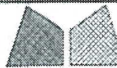
 美特鋁質有限公司 MIDI Aluminium Fabricator Ltd.			工程號	J858	類別		物料號	-
修改	-	-	採用工廠	✓	地盤	-	圖號	J858-GL01
日期	-	-	材料顏色	-	圖紙名稱	玻璃加工圖	數量	-
					材料	-	單件重量	- (KG)
					復核	-		
					批准	-		

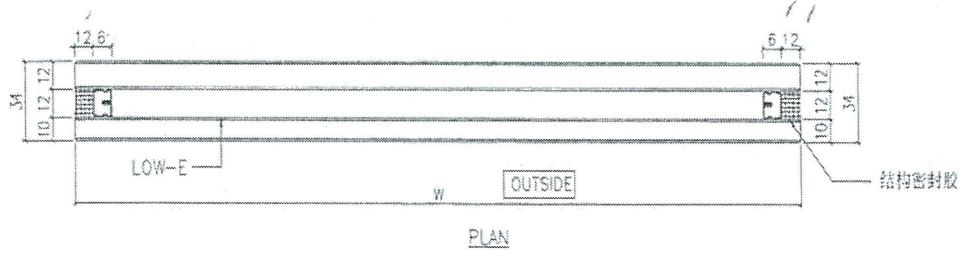
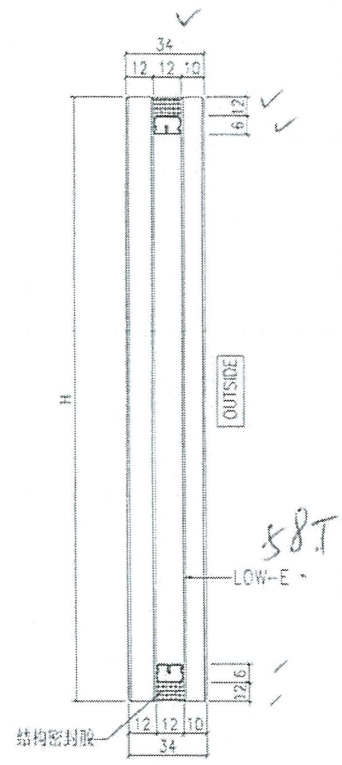

生产厂编号: R20220114001

- NOTES
1. ALL DIMENSION IN mm
  2. ALL EDGE CHAMFER 1x1x45°

G1