

工程指示 / 要求簡箋(E.I.)

工程指示編號：EI / 6872 / 23

修改版次：-

工程編號：J - 858

工程名稱：將軍澳日出康城 11

工程項目：後加 AC-Grille (凳仔碼) (T1-T3) 42 隻 地盤用

收件人：Maggie

發件人：Ant Yeung

日期：24/10/2023

要求提供 /  確認 事項：

- |                                    |                                     |                               |
|------------------------------------|-------------------------------------|-------------------------------|
| <input type="checkbox"/> 初步鋁料 B.M. | <input type="checkbox"/> 加工拆圖，然後生產  | <input type="checkbox"/> 尺寸表  |
| <input type="checkbox"/> 正式鋁料 B.M. | <input type="checkbox"/> 技術上資料 / 指示 | <input type="checkbox"/> 報價   |
| <input type="checkbox"/> 配件 B.M.   | <input type="checkbox"/> 樣辦或貨品說明書   | <input type="checkbox"/> 分判合約 |

內容：

請按 BM 及加工圖訂購預留碼送地盤安裝用 (凳仔碼)

1. 附上分層表，分座打扎。

2. 凳仔碼需驗焊， Fillet weld, 100% Visual, 10% MPI (For AC Grille)

3. 請提供 Mill cert

4. 疏氣孔為 Ø20mm

→ 5. AI. MC-A263 已有

謝謝

請在 2023.11.07 前完成上列要求。

分發東莞各部門：

- |  |   |  |   |
|--|---|--|---|
| <input type="checkbox"/> 生產技術總監 <input type="checkbox"/> 連附件 | <input type="checkbox"/> 技術部 <input type="checkbox"/> 連附件   | <input type="checkbox"/> 生產部 <input type="checkbox"/> 連附件    | <input type="checkbox"/> 機械設計部 <input type="checkbox"/> 連附件         |
| <input type="checkbox"/> 採購部 <input type="checkbox"/> 連附件    | <input type="checkbox"/> 生產統籌部 <input type="checkbox"/> 連附件 | <input type="checkbox"/> 小羅 & 清 <input type="checkbox"/> 連附件 |   |
| <input type="checkbox"/> 質檢部 <input type="checkbox"/> 連附件    | <input type="checkbox"/> 會計部 <input type="checkbox"/> 連附件   | <input type="checkbox"/> 報關組 <input type="checkbox"/> 連附件    | <input type="checkbox"/> 其他 <u>楊榮輝</u> <input type="checkbox"/> 連附件 |

分發香港各部門：

- |   |  |   |  |
|---|--|---|--|
| <input type="checkbox"/> 行政部 <input type="checkbox"/> 連附件                       | <input type="checkbox"/> 會計部 <input type="checkbox"/> 連附件  | <input type="checkbox"/> 統籌部 <input type="checkbox"/> 連附件 | <input checked="" type="checkbox"/> 工程部地盤科文 <input checked="" type="checkbox"/> 連附件 積哥 |
| <input checked="" type="checkbox"/> 採購部 <input checked="" type="checkbox"/> 連附件 | <input type="checkbox"/> QS 部 <input type="checkbox"/> 連附件 | <input type="checkbox"/> 維修部 <input type="checkbox"/> 連附件 | <input type="checkbox"/> 其他 _____ <input type="checkbox"/> 連附件                         |

傳遞編號：

HK / 23

發件人簽署：

項目經理簽署：



		美特鋁質有限公司		工程號：		J858		計算：		日期：		送呈：			
MIDI Aluminium Fabricator Ltd.		地盤名稱：		康城11期		核對：		日期：		2023.10.24		副本：			
BM編號：		預留碼(凳仔碼)		項目類別：		T1-T3 AC Grille (預留碼)(凳仔碼) EI		修改：		總重量(kg):		0.0			
序號	修改標示	配件圖號	物料編號	配件名稱	顏色	實用	後備	總數	單位	總重量		備註			
										單件重量	KG				
1				250x250x16mm鐵板 S275 J0	熱浸鋅	42	0	42	件			每套1件			
2	要驗焊		AC-250	50x50x8mm方鐵介子 S275 J0	熱浸鋅	168	0	168	支			每套4件			
3				直徑16圓鐵 S275 J0	熱浸鋅	168	0	168	件			每套4支			

ARCHITECT'S INSTRUCTION NO.

MC-A-263

Our Ref. : 19084NT-MC-A-263 BY FAX & TO BE COLLECTED  
Date : 19 October 2023  
Project : Proposed Residential Development at TKOTL 70 RP, Phase 11,  
Lohas Park, Tseung Kwan O, New Territories  
Contract : Superstructure Main Contract Works  
Contractor : Gammon Engineering and Construction Company Ltd  
Attn. : Mr. Percy Chan/Mr. Lawrence Pun

MC-A-263

DRAFT

Under the terms of the Contract, we hereby issue to the Contractor named above the following instructions (where applicable, the Contract Sum will be adjusted in accordance with the terms of the relevant condition):

**Design, Supply and Installation of Air-conditioning Metal Grille for Tower 1 to Tower 3**

This serves to confirm the Named Sub-contractor for the design, supply and installation of Air-conditioning Metal Grille at Tower Roof Floors for Tower 1 to Tower 3 to be Midi Aluminium Fabricator Limited.

You are reminded that no loss and/ or expenses claim, and no extension of time shall be granted as a result of this instruction.

You are required to make timely submission for relevant drawings / documents as required under the Contract for our consideration / approval.

Variation of works and/ or Prime Cost Rates adjustment, if required, shall be submitted for assessment in strict accordance with the Contract provisions.

Distribution:

		c.c.	w/e
	MTR Corporation Ltd.	- Mr. K.S. Lee/ Mr. Jacky Cheung	<input checked="" type="checkbox"/> <input checked="" type="checkbox"/>
	Sino Land Co. Ltd.	- Mr. Herbert Thung/ Mr. Francis Lai	<input checked="" type="checkbox"/> <input checked="" type="checkbox"/>
	AECOM	- Mr. Henry Lo/ Mr. Steven Lau	<input checked="" type="checkbox"/> <input checked="" type="checkbox"/>
	AECOM(RE)	- Mr. Ken Siu/ Mr. Simon Tso	<input checked="" type="checkbox"/> <input checked="" type="checkbox"/>
	WSP	- Mr. Tommy Leung/ Mr. Simon Kaan	<input checked="" type="checkbox"/> <input checked="" type="checkbox"/>
Wong Chi Kin Kenneth	Beria Consultants Ltd.	- Ms. May Chung/ Mr. Matthew Hung	<input checked="" type="checkbox"/> <input checked="" type="checkbox"/>
Director	ADI	- Mr. Wilter So/ Mr. Kenif Ng	<input checked="" type="checkbox"/> <input checked="" type="checkbox"/>
For and on behalf of	AECOM(Façade)	- Mr. Kim Wong / Ms. Crystal Wong	<input checked="" type="checkbox"/> <input checked="" type="checkbox"/>
Ronald Lu & Partners (Hong Kong) Ltd.	Moty's Deign	- Mr. Moses Lau/ Ms. Chan Hei Man	<input checked="" type="checkbox"/> <input checked="" type="checkbox"/>
	IsBim	- Mr. Keith Chiu	<input checked="" type="checkbox"/> <input checked="" type="checkbox"/>
FCH/GCH/AUL/kmy	Ramboll	- Ms. Brain Tam	<input checked="" type="checkbox"/> <input checked="" type="checkbox"/>

A.I. Pre-Approval Form

AIP No.: AIP-AI-MC-A-263

A.I. No.: AI-MC-A-263

1. Contract: Main Contract Contract Sum: HK\$2,751,222,076.61	Contractor: Gammon Engineering and Construction Company Ltd
--	---

2. Description: Design, Supply and Installation of Air-conditioning Metal Grille for Tower 1 to 3		
Reason(s) for change: Confirmation for additional Air-conditioning Metal Grille at Tower Private Roof Area on Tower 1 to 3 Roof Floor		
a) Statutory requirement <input type="checkbox"/> ;    b) Expenditure of provisional sum <input type="checkbox"/> ;    c) Adjustment of provisional quantity / PC Sum <input type="checkbox"/> d) Design Development <input checked="" type="checkbox"/> ;    e) Others: <input type="checkbox"/>		
Possible time implications: <u>Nil</u>		
The above is initiated by: <input type="checkbox"/> Architect / Consultants ( ) <input checked="" type="checkbox"/> Request of Developer / Project Manager <input type="checkbox"/> Request of MTRCL <input type="checkbox"/> Contract procedures <input type="checkbox"/> Requirement of Statutory Bodies ( ) <input type="checkbox"/> Others _____	Prepared by:  Henry Lo / Tommy Leung* Structural / M&E * Engineer Keith Chiu / BIM Project Manager Date:	Prepared / Endorsed * by:   Kenneth Wong Architect (RLP) Date: 07/10/2023

3. Estimated cost implications by QS Consultant / M&E Engineer:		
Estimate: a) Builder's Works    HK\$ b) M&E Works        HK\$ c) Abortive Works    HK\$ <hr/> Total    HK\$	a. Previous accumulated variations of this contract <u>HK\$</u> b. This AIP c. Accumulated variations _____ (rounded to nearest \$1,000)	
Remarks: _____ Signed: _____ Name:                      Beria (QS)                      WSP(M&E) Date: _____		

4. Endorsement by Developer: <input type="checkbox"/> Approved <input type="checkbox"/> Rejected <input type="checkbox"/> Require approval by MTRCL <input type="checkbox"/> Require retrospective approval by MTRCL
Remarks: _____ Signed: _____                      Date: _____

5. Approval by MTRCL: <input type="checkbox"/> Approved <input type="checkbox"/> Rejected
Remarks: _____ Signed: _____                      Date: _____

- Distribution:
- |  |  |  |  |
|--|--|--|--|
| <input checked="" type="checkbox"/> MTRCL                  | <input type="checkbox"/> RLP (Architect)               | <input checked="" type="checkbox"/> WSP (M&E)        | <input checked="" type="checkbox"/> Beria (QS) |
| <input checked="" type="checkbox"/> Sky Castle (Developer) | <input checked="" type="checkbox"/> AECOM (Structural) | <input checked="" type="checkbox"/> Other Consultant | AECOM(façade)/ADI/Moty/IsBIM                   |

\* Delete whichever is inapplicable

Attachment-  
Air-conditioning Metal Grille for Tower 1 to Tower 3

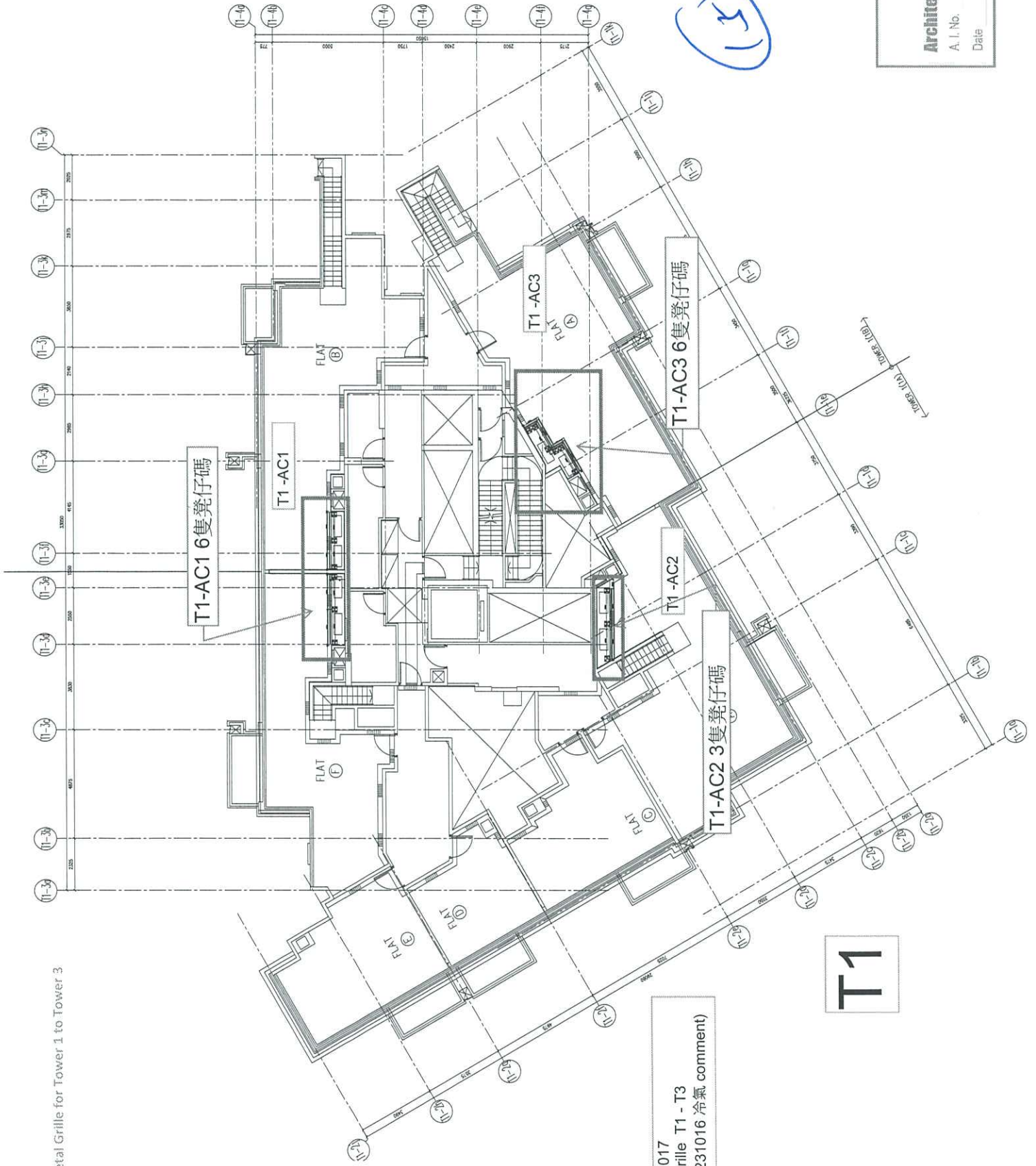

20231017  
A/C Grille T1 - T3  
(按20231016 冷氣 comment)

T1

**RONALD LU PARTNERS**  
**Architect's Instruction**  
A. I. No. MC-A-263  
Date OCT.2023

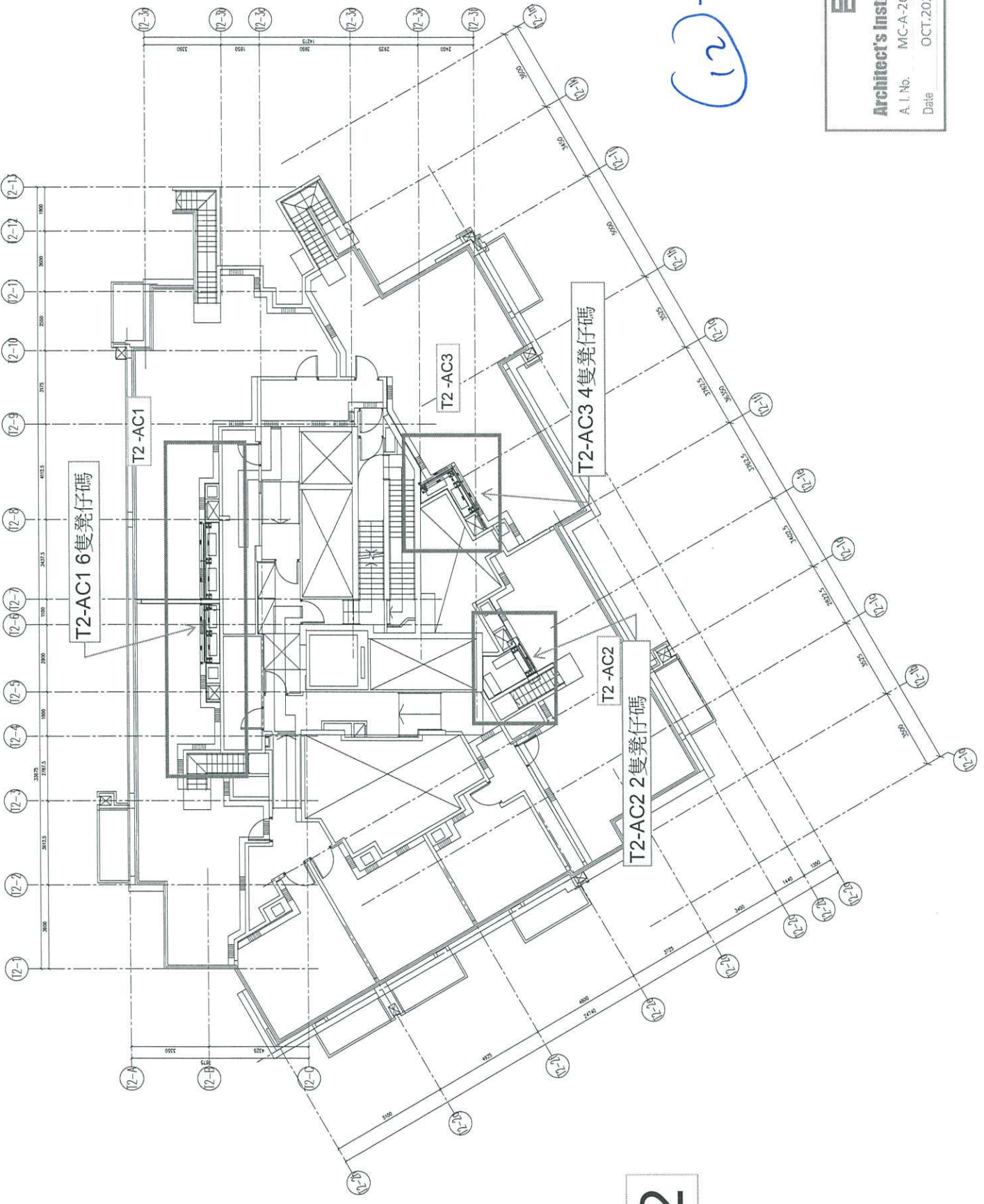

T2

(12-1)

**Architect's Instruction**  
 A. I. No. MC-A-263  
 Date OCT.2023

12+1

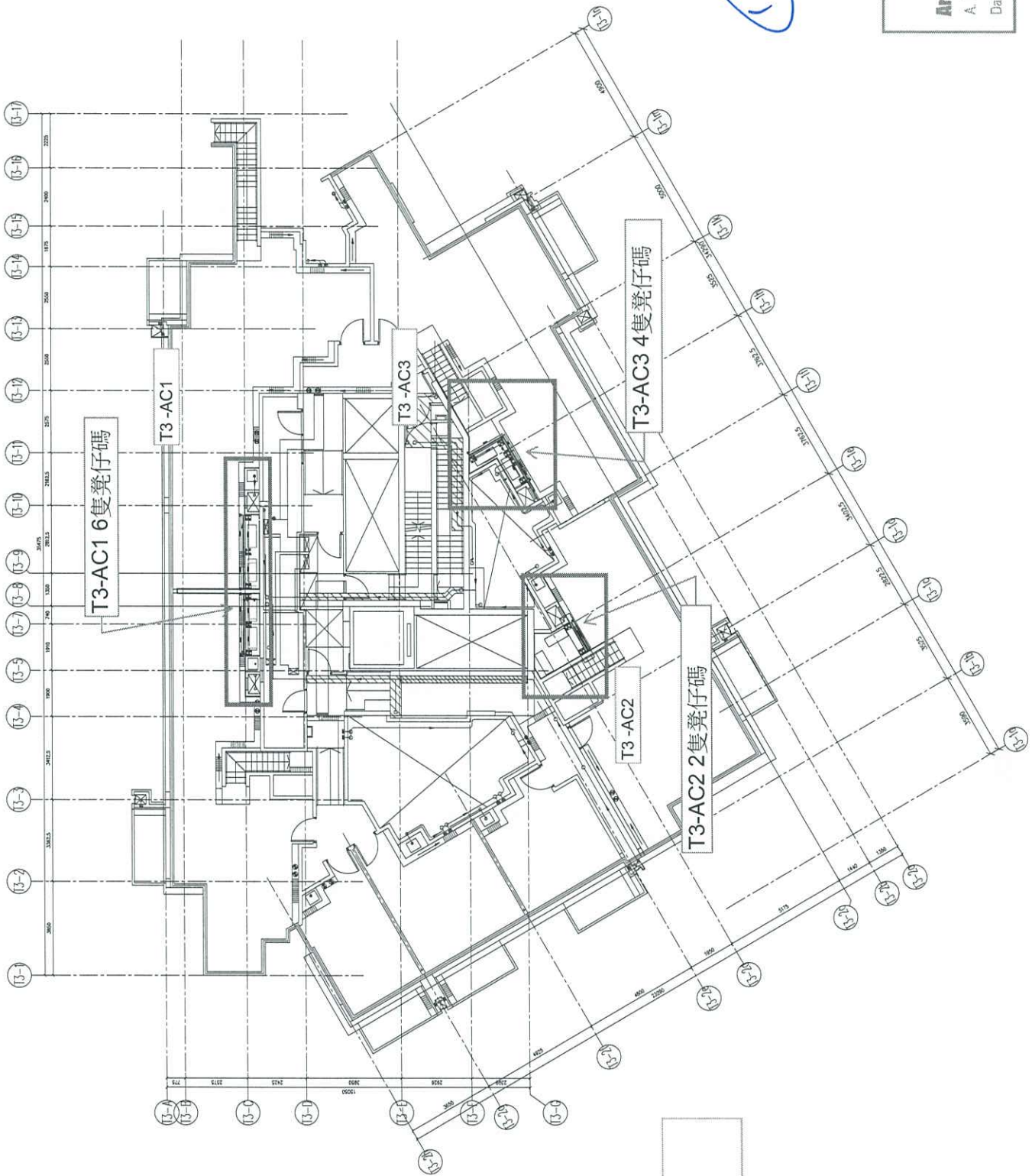

T3