



工程指示 / 要求簡箋(E.I.)

工程指示編號：EI / 6741 / 23 修改版次：
 工程編號：J - 858 工程名稱：將軍澳日出康城
 工程項目：趟門梗中企 廠用鐵件 (特包屋)
 收件人：生統 / Maggie 發件人：Ant Yeung 日期：18/09/2023

要求提供 / 確認 事項：

- | | | |
|------------------------------------|-------------------------------------|-------------------------------|
| <input type="checkbox"/> 初步鋁料 B.M. | <input type="checkbox"/> 加工拆圖，然後生產 | <input type="checkbox"/> 尺寸表 |
| <input type="checkbox"/> 正式鋁料 B.M. | <input type="checkbox"/> 技術上資料 / 指示 | <input type="checkbox"/> 報價 |
| <input type="checkbox"/> 配件 B.M. | <input type="checkbox"/> 樣辦或貨品說明書 | <input type="checkbox"/> 分判合約 |

內容：
按計數和 BD 批圖 3500 高的趟門中企 X86345 要 加力鐵 60x50 。

請生產送廠 特包屋趟門

附 BM 和 拆圖

謝謝

請在 2023.10.18 前完成上列要求。

附：

- 原合約工程包 原合約工程加 / 減賬 新工程報價

原因：-

分發東莞各部門：

- () 生產技術總監 連附件 (✓) 技術部 連附件 () 生產部 連附件 () 機械設計部 連附件
 () 採購部 連附件 (✓) 生產統籌部 連附件 () 小羅&清 連附件
 () 質檢部 連附件 () 會計部 連附件 () 報關組 連附件 () 其他 _____ 連附件

分發香港各部門：

- () 行政部 連附件 () 會計部 連附件 () 統籌部 連附件 () 工程部地盤科文 積哥 連附件
 (✓) 採購部 連附件 () QS 部 連附件 () 維修部 連附件 () 其他 _____ 連附件

傳遞編號：

HK 2159 / 23

發件人簽署： 

項目經理簽署： 



美特鋁質 有限公司
MIDI Aluminium Fabricator Ltd.

工程號 J858 地盤 將軍澳 康城11期

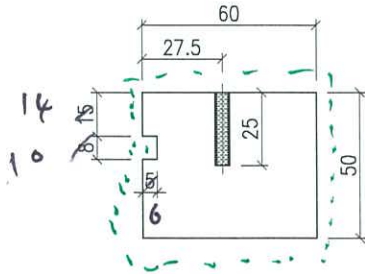

黑油

(3500高樓)

特色屋

超門

推門

加力鉸通

石各

60x2

= 62件

cut from
50mm plate

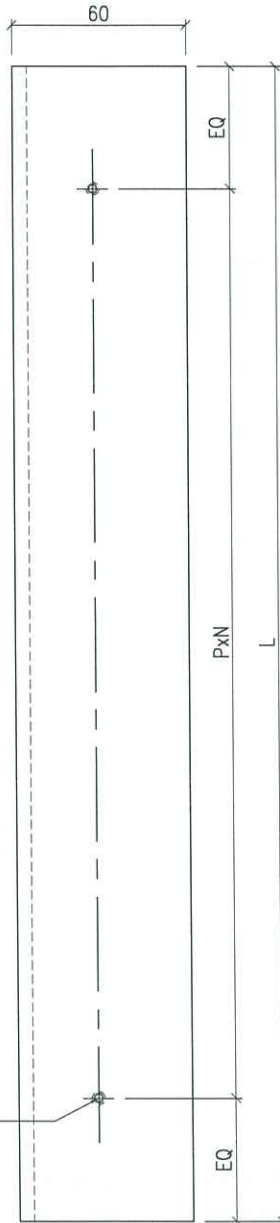

备注	产品编号	L	PxN=
H=2948	J858-SD-GS06	2684	300x8

黑油

每幅門1只

工厂安装

名稱	加力鐵加工圖	制圖	J.L.	2023-09-15	修改		
材料	60x50mm厚铁巴	復核			日期		
顏色	热浸锌	批准			圖號	J858-SD-GS06	



美特鋁質有限公司
MIDI Aluminum Fabricator Ltd.

工程號:	J-858	計算:	J.L.	日期:	2023-09-15	送呈:	Jason 哥	
地盤名稱:	康城11期	核對:		日期:		副本:		
項目類別:	特色层趟门	批准:		日期:				
類別: 特色层趟门企向加力铁件							總重量 (kg):	3918.896

BM編號:

序號	修改標示	配件圖號	物料編號	配件名稱	顏色	實用	後備	總數	單位		備注
									件	Kg	
1		J858-SD-GS06	J858-SD-GS06	60x50mm厚铁巴 (S-275)	热浸锌	60	2	62	件	63.208	3918.896
				合計		60	0	62	件		3918.896

7450

P591



8.1A Check Sliding Door Middle Mullion at penthouse

Refer to DWG: J858-CW-PE117

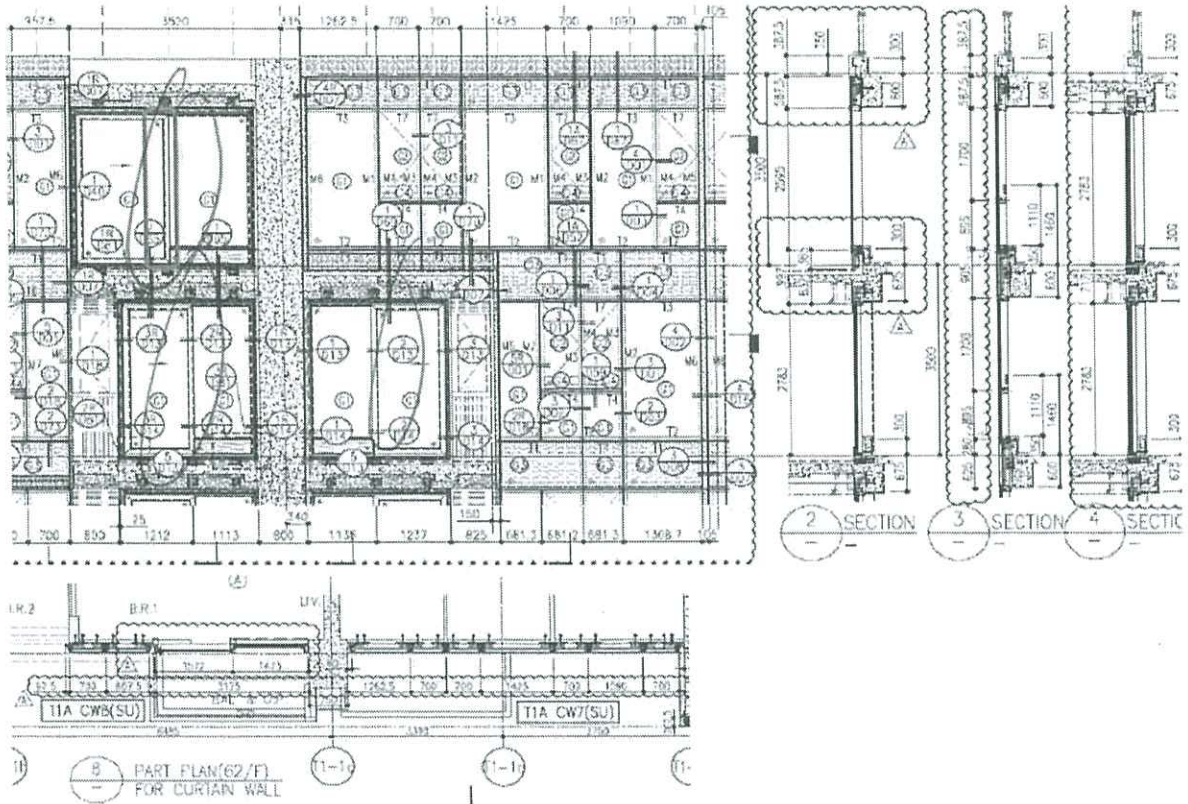

達 3500 高 超 門 的 加 力 鉗

用

Refer to DWG: J858-CW-D13

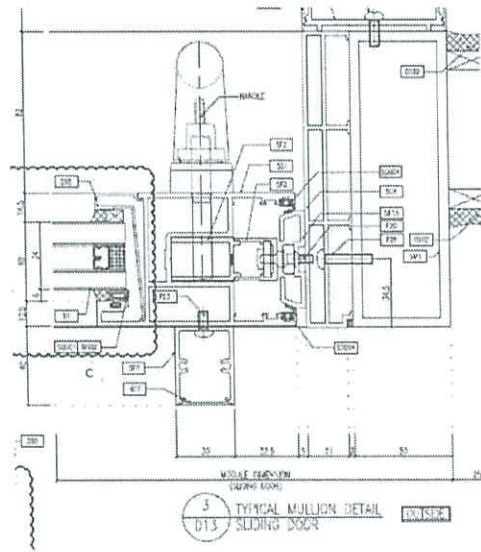
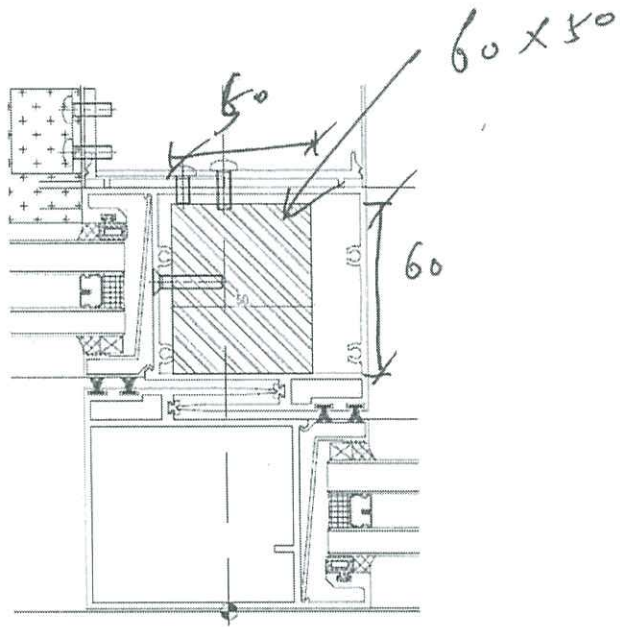
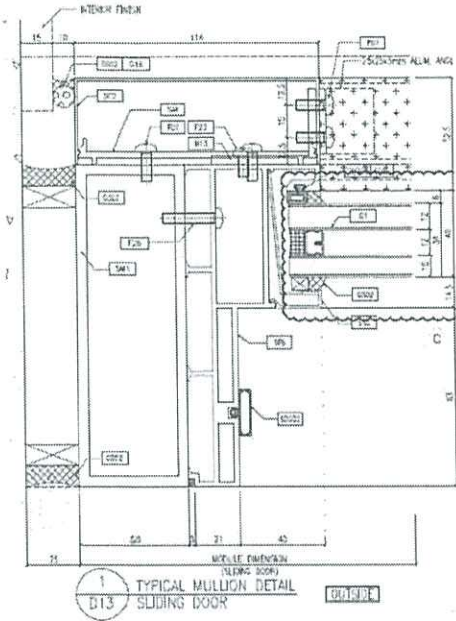

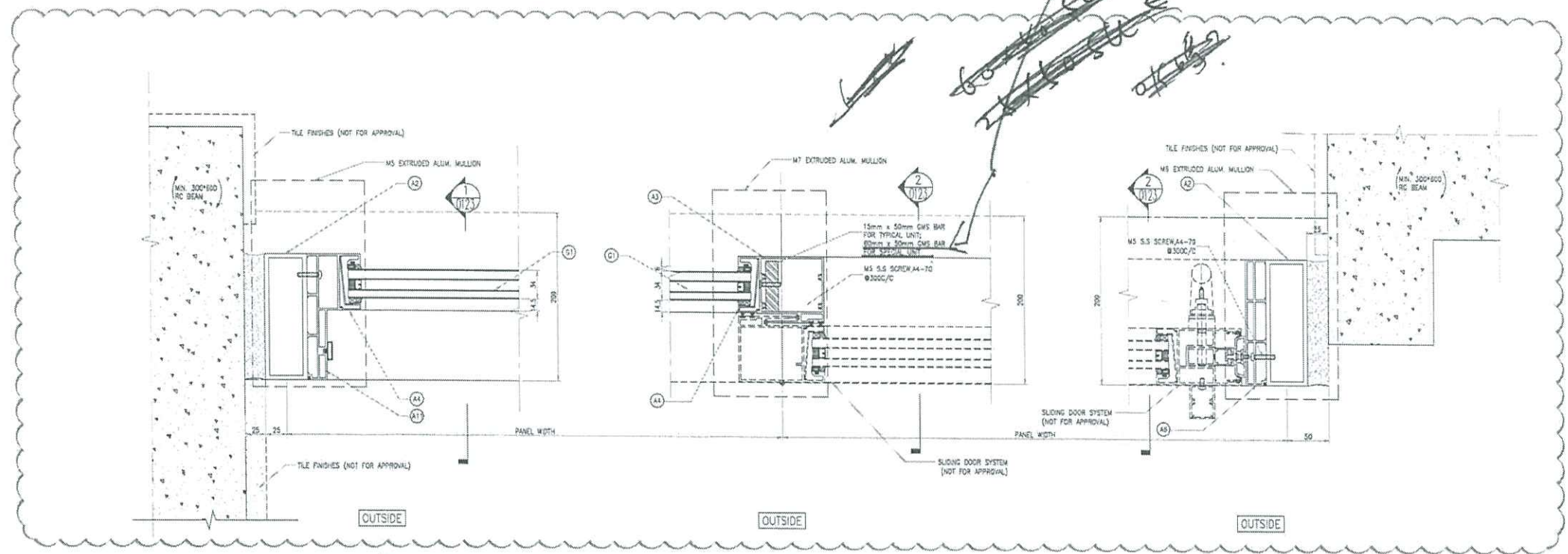

1. DETAIL (REFER TO DWG. 2/0071-0074, 2/0081-0082, 2/0091-0094)
 2. DETAIL (REFER TO DWG. 2/0071-0074, 2/0081-0082, 2/0091-0094)
 3. DETAIL (REFER TO DWG. 2/0071-0074, 2/0081-0082, 2/0091-0094)

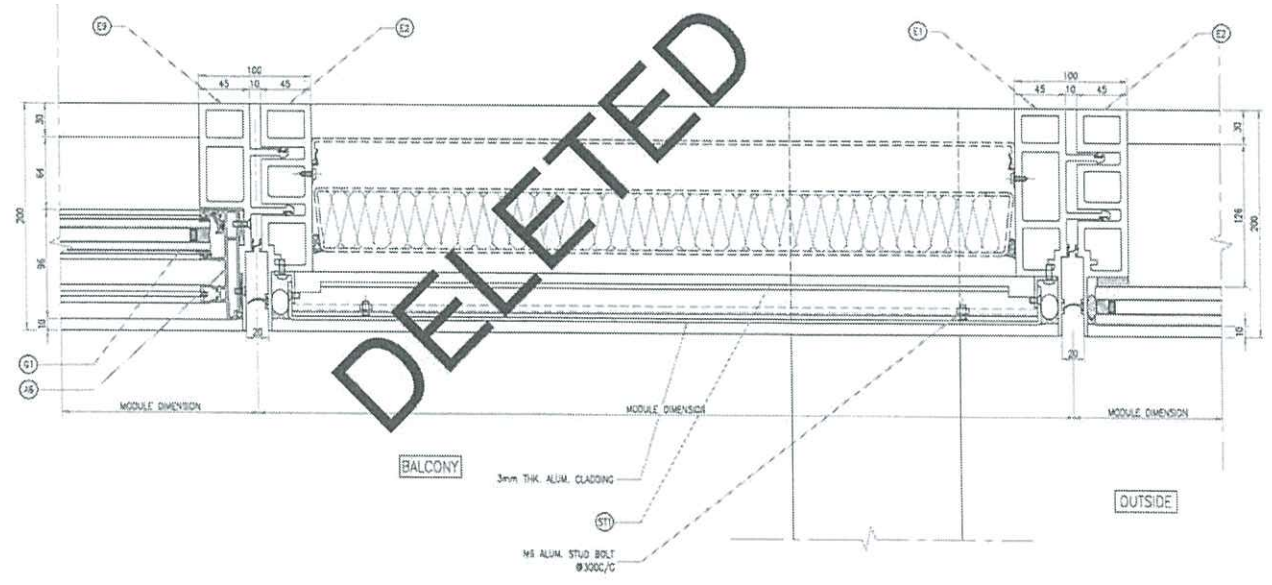

DELETED

4. DETAIL

B.D. REF :

CLIENT :
 信和置業有限公司
 Sino Land Company Limited

ARCHITECT :
 ronald lu & partners
 Architects - Planners - Interior Designers
 Ronald Lu & Partners (HK) Ltd.
 呂元祥建築師事務所 (香港) 有限公司

MAIN CONTRACTOR :
 Gammon

STRUCTURAL ENGINEER :
 AECOM

FACADE CONSULTANT:
 AECOM

NOTE :
 1. ALL DIMENSIONS ARE IN mm.
 2. ALL ELEVATIONS ARE VIEWED FROM OUTSIDE.
 3. ALL DIMENSIONS TO BE VERIFIED ON SITE BEFORE FABRICATION.

LEGEND :
 X1 --- DETAIL MARK NO.
 X001 --- REFER SHEET NO.
 1. F.F.L. --- FINISHED FLOOR LEVEL
 2. S.F.L. --- STRUCTURAL FLOOR LEVEL
 3. (Symbol) --- REVERSED DETAIL

B	25.04.22	BD AMENDMENT	K
A	28.12.21	BD AMENDMENT	K
-	30.09.20	BD SUBMISSION	K
NO.	DATE	REVISED	BY

JCB NO. : J-858

PROJECT :
 PROPOSED RESIDENTIAL DEVELOPMENT
 AT TKOIL 70RP, PHASE 11, LOHAS PARK
 TSEUNG KWAN O, N.T.

TITLE :
 FACADE DETAIL

DATE : 22-OCT-21	SCALE : 1:1(A1)
DRAWN BY : KY	CHECKED BY : YB

B.D. AMENDMENT

英特鋁質有限公司
 MIDI ALUMINUM FABRICATOR LTD.
 Units 6-8, Sunray Industrial Centre, 1/F
 610 Che Kwo Ling Road, Kowloon
 Tel: 23489211-4 Fax: (852) 27727866

DWG NO. : LP11/0102 REV. : B

HOT ROLLED STEEL PLATES

熱軋鋼板

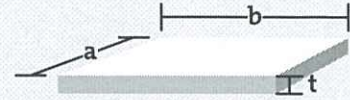

千克/每件 Weight:Kg/Sheet

厚度 Thickness (t)mm	尺寸 Size(a×b)							
	(3'×6')	(3'×7')	(4'×8')	(5'×10')	(5'×20')	(6'×20')	(6'×24')	(8'×20')
	914×1829mm	914×2134mm	1219×2438mm	1524×3048mm	1524×6096mm	1829×6096mm	1829×7315mm	2438×6096mm
1.2	15.75	18.37	28.00					
1.4	18.38	21.44	32.66					
1.5	19.68	22.97	34.99	54.70				
1.6	21.00	24.50	37.33	58.34				
1.8	23.63	27.56	41.99	65.64				
2.0	26.25	30.62	46.66	72.93				
2.3	30.18	35.22	53.66	83.87				
2.5	32.81	38.28	58.32	91.16				
2.8	36.74	42.87	65.32	102.10	204.20			
3.0	39.37	45.93	69.99	109.39	218.79			
4.0	52.49	61.24	93.32	145.86	291.72			
4.3	56.44	65.84	100.32	156.80	313.59	376.35		
4.5	59.05	68.90	104.98	164.09	328.18	393.86	472.62	565.00
4.8	63.00	73.50	111.98	175.03	350.06	420.12	504.13	560.00
5.0	65.61	76.56	116.65	182.32	364.64	437.62	525.13	583.34
5.3	76.13	88.81	135.31	211.49	422.99	507.64	609.15	676.67
6.0	78.74	91.87	139.98	218.79	437.57	525.15	630.16	700.00
8.0	105.00	122.50	186.64	291.72	583.43	700.19	840.21	933.34
9.0	118.13	137.81	209.97	328.18	656.36	787.72	945.24	1050.00
10.0	131.25	153.12	233.30	364.64	729.29	875.24	1050.26	1166.67
12.0	157.50	183.74	279.96	437.57	875.15	1050.29	1260.31	1400.00
14.0	183.72	214.36	326.61	510.50	1021.00	1225.34	1470.37	1633.34
15.0	196.88	229.68	349.94	546.97	1093.93	1312.66	1575.31	1750.01
16.0	210.00	244.99	373.27	583.43	1166.86	1400.39	1680.42	1866.67
19.0	249.38	290.93	443.26	692.82	1385.65	1662.96	1995.50	2216.67
20.0	262.50	306.24	466.59	729.29	1458.58	1750.48	2100.52	2333.34
22.0	288.75	336.86	513.25	802.22	1604.44	1925.53	2310.58	2566.68
25.0	328.13	382.80	583.24	911.61	1823.22	2188.11	2625.66	2916.68
30.0	393.75	459.36	699.89	1093.92	2187.87	2625.73	3150.78	3500.01
32.0	420.00	489.98	746.55	1166.85	2333.72	2800.78	3360.83	3733.35
35.0	459.38	535.92	816.54	676.24	2552.51	3063.35	3675.91	4083.35
38.0	498.75	581.86	886.52	1385.63	2771.30	3325.92	3990.99	4433.35
40.0	525.00	612.48	933.18	1458.56	2917.16	3500.97	4201.04	4666.68
45.0	590.63	689.04	1049.83	1640.88	3281.80	3938.59	4726.17	5250.02
50.0	656.25	765.60	1166.48	1823.20	3646.44	4376.21	5251.13	5833.35
55.0	721.76	842.12	1283.13	2005.54	4011.09	4813.83	5776.44	6416.69
57.0	748.13	872.78	1329.79	2078.45	4156.95	4988.88	5986.48	6650.02
60.0	787.37	918.67	1399.78	2187.87	4375.73	5251.45	6301.57	7000.02
64.0	840.00	979.97	1493.09	2333.70	4667.45	5601.55	6721.66	7466.69
65.0	852.99	995.23	1516.42	2370.19	4740.38	5689.08	6826.70	7583.36
70.0	918.75	1071.84	1633.07	2552.48	5105.02	6126.70	7351.82	8166.70
75.0	984.38	1148.40	1749.75	2734.80	5469.68	6564.30	7876.95	8750.03
80.0	1050.00	1224.96	1866.40	2917.12	5834.32	7001.92	8402.08	9333.36
90.0	1181.25	1378.08	2099.70	3281.76	6563.61	7877.16	9452.34	10500.03
100.0	1312.50	1531.20	2333.00	3646.40	7292.90	8752.40	10502.60	11666.70
110.0	1443.75	1684.32	2566.30	4011.04	8022.19	9627.64	11552.86	12833.37
120.0	1575.00	1837.44	2799.60	4375.68	8751.48	10502.88	12603.12	14000.04
130.0	1706.25	1990.56	3032.90	4740.32	9048.77	11378.12	13653.38	15166.71
140.0	1837.50	2143.68	3266.20	5104.96	10210.06	12253.36	14703.64	16333.38
150.0	1968.75	2296.80	3499.50	5469.60	10939.35	13128.60	15753.90	17500.05

50
50.0
70

B.3 REF.

CLIENT
Sinc Land Company Limited
新和置業有限公司

ARCHITECT
Ronald Lu & Partners
Ronald Lu & Partners (HK) Ltd.
羅元亮建築師事務所 (香港) 有限公司

STRUCTURAL ENGINEER
Gammon
AECOM

SCALE CONSULTANT
AECOM

NOTE:
1. ALL DIMENSIONS ARE IN MM.
2. ALL ELEVATIONS ARE VIEWED FROM OUTSIDE.
3. ALL DIMENSIONS TO BE CHECKED ON SITE BEFORE FABRICATION.

LEGEND:
A - DETAIL MARK NO.
B - REFER SHEET NO.
1. FF.FL. - FINISHED FLOOR LEVEL.
2. SF.FL. - STRUCTURAL FLOOR LEVEL.
3. - - - - - DIMENSIONAL DETAIL.

NO.	REV.	DATE	BY	CHKD
1		12-04-22	J-855	
2				
3				
4				
5				
6				
7				
8				
9				
10				
11				
12				

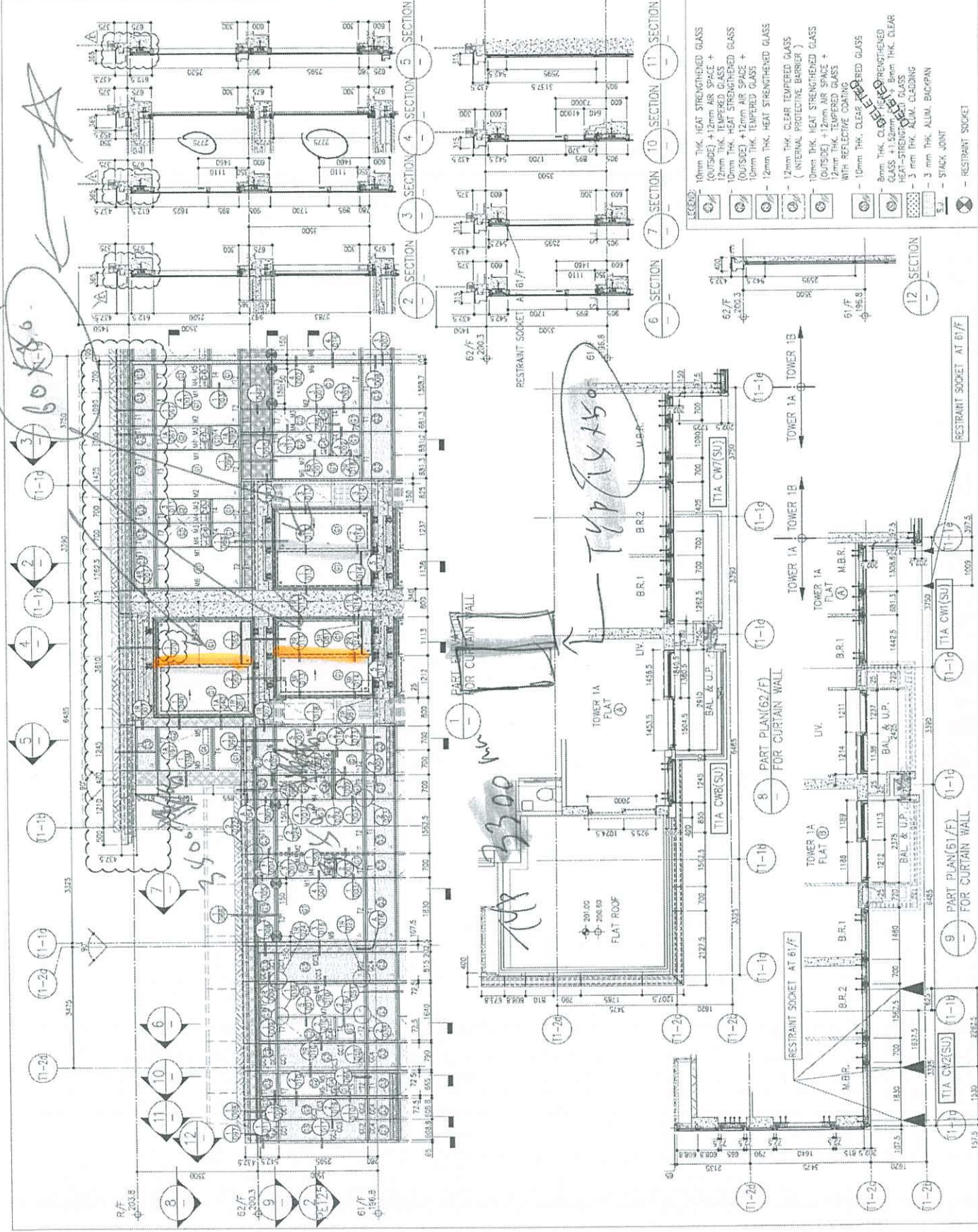

LEGEND:

(Symbol)	10mm THK. HEAT STRENGTHENED GLASS (OUTSIDE) + 12mm AIR SPACE + 12mm THK. TEMPERED GLASS
(Symbol)	10mm THK. HEAT STRENGTHENED GLASS (OUTSIDE) + 12mm AIR SPACE + 10mm THK. TEMPERED GLASS
(Symbol)	12mm THK. HEAT STRENGTHENED GLASS (INTERNAL PROTECTIVE BARRIER)
(Symbol)	10mm THK. HEAT STRENGTHENED GLASS (OUTSIDE) + 12mm AIR SPACE + 12mm THK. TEMPERED GLASS WITH REFLECTIVE COATING
(Symbol)	10mm THK. CLEAR STRENGTHENED GLASS
(Symbol)	8mm THK. CLEAR STRENGTHENED GLASS + 12mm AIR SPACE + 8mm THK. CLEAR HEAT-STRENGTHENED GLASS
(Symbol)	3 mm THK. ALUM. BACKPAN
(Symbol)	3 mm THK. ALUM. BACKPAN
(Symbol)	STACK JOINT
(Symbol)	RESTRAINT SOCKET

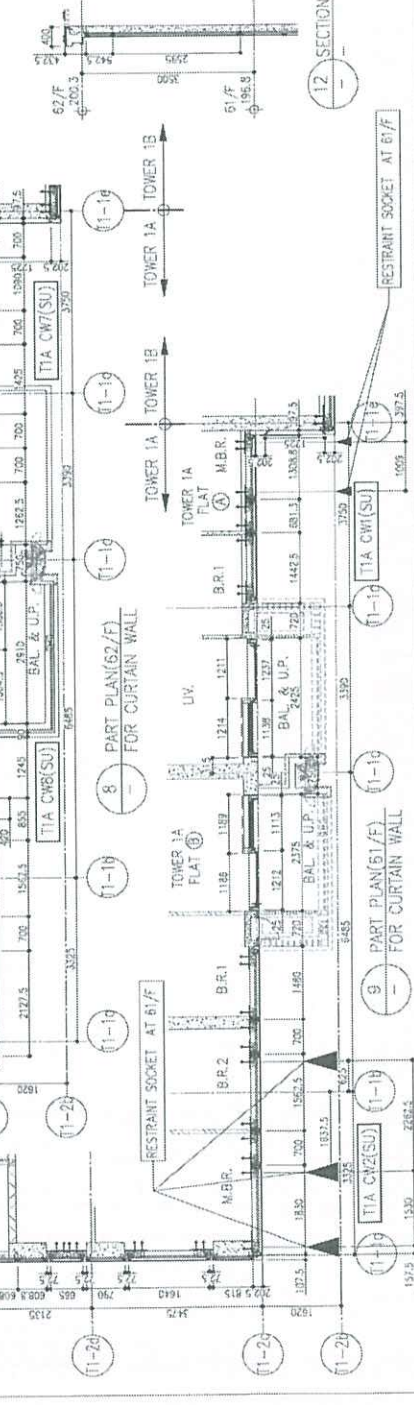



1/16 LAYOUT PLAN FOR TOWER 1(1:75)

TOWER 1(A) TOWER 1(B)

<p>RD. REF :</p>																																	
<p>CLIENT : 港地置业有限公司 Sino Land Company Limited</p>																																	
<p>ARCHITECT : Ronald Lu & Partners 羅國良建築師事務所 (香港) 有限公司 MAIN CONTRIBUTOR : 罗国良建筑事务所 (香港) 有限公司</p>																																	
<p>STRUCTURAL ENGINEER : Gammon AECOM AECOM</p>																																	
<p>FACTOR CONSULTANT: AECOM</p>																																	
<p>NOTE: 1. ALL DIMENSIONS ARE IN mm. 2. ALL ELEVATIONS ARE RENDERED FROM OUTSIDE. 3. ALL DIMENSIONS TO BE RENDERED ON SITE BEFORE FABRICATION. LEGEND: ST - DETAIL WORK NO. 1. EPFL - RENDERED FLOOR LEVEL 2. SFL - STRUCTURAL FLOOR LEVEL 3. RD - RENDERED DETAIL</p>																																	
<p>NO. DATE REVISION</p> <table border="1"> <tr><td>H</td><td>15/12/21</td><td>REVISED AS PER COMMENTS</td><td>15</td></tr> <tr><td>G</td><td>28/09/21</td><td>REVISED AS PER COMMENTS</td><td>15</td></tr> <tr><td>F</td><td>27/07/21</td><td>REVISED AS PER COMMENTS</td><td>15</td></tr> <tr><td>E</td><td>30/05/21</td><td>REVISED AS PER COMMENTS</td><td>15</td></tr> <tr><td>D</td><td>06/04/21</td><td>REVISED AS PER COMMENTS</td><td>15</td></tr> <tr><td>C</td><td>23/02/21</td><td>REVISED AS PER COMMENTS</td><td>15</td></tr> <tr><td>B</td><td>20/12/21</td><td>REVISED AS PER COMMENTS</td><td>15</td></tr> <tr><td>A</td><td>03/12/21</td><td>REVISED AS PER COMMENTS</td><td>15</td></tr> </table>		H	15/12/21	REVISED AS PER COMMENTS	15	G	28/09/21	REVISED AS PER COMMENTS	15	F	27/07/21	REVISED AS PER COMMENTS	15	E	30/05/21	REVISED AS PER COMMENTS	15	D	06/04/21	REVISED AS PER COMMENTS	15	C	23/02/21	REVISED AS PER COMMENTS	15	B	20/12/21	REVISED AS PER COMMENTS	15	A	03/12/21	REVISED AS PER COMMENTS	15
H	15/12/21	REVISED AS PER COMMENTS	15																														
G	28/09/21	REVISED AS PER COMMENTS	15																														
F	27/07/21	REVISED AS PER COMMENTS	15																														
E	30/05/21	REVISED AS PER COMMENTS	15																														
D	06/04/21	REVISED AS PER COMMENTS	15																														
C	23/02/21	REVISED AS PER COMMENTS	15																														
B	20/12/21	REVISED AS PER COMMENTS	15																														
A	03/12/21	REVISED AS PER COMMENTS	15																														
<p>JOB NO. : J-858 PROJECT : PROPOSED RESIDENTIAL DEVELOPMENT AT TOWER PHASE 11, LOHAS PARK, TSEUNG KWAN O, N.T. TITLE : TYPICAL FLOOR PLAN AT TOWER 1</p>																																	
<p>DATE : 22-OCT-21 SCALE : 1/25(A) DRAWN BY : KY CHECKED BY : YB MIDI Architecture Associates Ltd. Units 6-8, Sunny Industrial Centre, 1/F 610 Chee Kwoi Ling Road, Kowloon Tel: 23399211-4 Fax: 2332777065 DWC NO. : J858-CW-1P101 REV. : 11</p>																																	



1-1 FLOOR LAYOUT PLAN FOR TOWER 1 (1/75)

B.A. REF. :

CLIENT : 信和置業有限公司
Sino Land Company Limited

ARCHITECT : Ronald Lu & Partners
Ronald Lu & Partners (HK) Ltd.
呂元祥建築師事務所 (香港) 有限公司
MAIN CONTRACTOR :



STRUCTURAL ENGINEER :



FAVOUR CONSULTANT :



NOTE :
1. ALL DIMENSIONS ARE IN mm.
2. ALL DIMENSIONS ARE REFERRED FROM OUTSIDE.
3. ALL DIMENSIONS TO BE REFERRED ON SITE BEFORE FABRICATION.
LEGEND :
ST - DETAIL MARK NO.
1000 - BETTER SHEET NO.
1. FEEL - FINISHED FLOOR LEVEL
2. SET - STRUCTURAL FLOOR LEVEL
3. - FINISHED DETAIL

NO.	DATE	REVISION	BY	CHKD
0	05/05/21	REVISED AS PER COMMENTS	LS	LS
C	20/07/21	REVISED AS PER COMMENTS	LS	LS
B	20/05/21	REVISED AS PER COMMENTS	LS	LS
A	06/04/21	REVISED AS PER COMMENTS	LS	LS

JOB NO. : J-856
PROJECT : PROPOSED RESIDENTIAL DEVELOPMENT AT TOWER 1, PHASE 11, LOHAS PARK TSEUNG KWAN O, N.T.

TITLE : FLOOR LAYOUT PLAN AT TOWER 1

DATE : 22-OCT-21 SCALE : 1/75(A1)
DRAWN BY : KY CHECKED BY : YB

美特经贸有限公司
MIDI INTERNATIONAL MANAGEMENT LTD.
Unit 6-B, Sunny Industrial Centre, 1/F
619 Chee Kwoong Road, Kowloon
(852) 29231111 (852) 29231986
DMC NO. : J856-CM-17103 REV. : 0



TOWER 2 (2A) TOWER 2 (2B)

1/65/F
1/65/E
TYPICAL FLOOR PLAN FOR TOWER 2(1:75)

B.D. REF :

CLIENT :
 新地有限公司
 Sino Land Company Limited

ARCHITECT :
 Ronald Lu & Partners (HK) Ltd.
 呂元村建築師事務所(香港)有限公司
 MAIN CONSULTOR :

STRUCTURAL ENGINEER :
 Gammorn
 STRUCTURAL CONSULTANT:
 AECOM

NOTE:
 1. ALL DIMENSIONS ARE IN mm.
 2. ALL DIMENSIONS ARE VIEWED FROM OUTSIDE.
 3. ALL DIMENSIONS TO BE VERIFIED ON SITE BEFORE FABRICATION.
 LEGEND:
 (X) - DIML MARK NO.
 (S) - REFER SHEET NO.
 1. FILL - FINISHED FLOOR LEVEL
 2. SET - STRUCTURAL FLOOR LEVEL
 3. (R) - REVERSED LEVEL

NO.	DATE	REVISION	BY	CHKD
A	10/07/21	REVISED AS PER COMMENTS	LS	
B	20/07/21	REVISED AS PER COMMENTS	LS	
C	23/09/21	REVISED AS PER COMMENTS	LS	
D	12/04/21	REVISED AS PER COMMENTS	LS	
E	27/07/21	REVISED AS PER COMMENTS	LS	
F	29/09/21	REVISED AS PER COMMENTS	LS	
G	29/12/21	REVISED AS PER COMMENTS	LS	

JOB NO. : J-858
 PRODUCT :
 PROPOSED RESIDENTIAL DEVELOPMENT
 AT TOWER 208, PHASE 11, LOHAS PARK
 TSEUNG KWAN O, NT.

DATE : 22-OCT-21 SCALE : 1:25(A1)
 DRAWN BY : XT CHECKED BY : JB
 MIDI 藝特堅實有限公司
 Unit 6-8, Sunny Industrial Centre, 1/F
 162-169/211-4 San Tin, Tseung Kwan O, NT.
 Tel: 21889111-4 Fax: (852) 27771665
 REG. NO. : JBS9-CW-47201 REV. : 0



1/67/F. LAYOUT PLAN FOR TOWER 2 (1:3.5)

CLIENT : 新地置业有限公司 Sino Land Company Limited		ARCHITECT : Ronald Lu & Partners (HK) Ltd. 呂克材建築師事務所 (香港) 有限公司 MAIN CONTRACTOR :		STRUCTURAL ENGINEER : Gammion	
FAHOC CONSULTANT: AECOM		NOTE : 1. ALL DIMENSIONS ARE IN mm. 2. ALL DIMENSIONS ARE VERIFIED FROM OUTSIDE BEFORE CONSTRUCTION. 3. ALL DIMENSIONS TO BE VERIFIED ON SITE BEFORE CONSTRUCTION.			
LEGEND : 		REVISIONS : 1. FEEL - FINISHED FLOOR LEVEL 2. SETL - STRUCTURAL FLOOR LEVEL 3. REVERSED LEVEL			
JOB NO. : J-858 PROJECT : PROPOSED RESIDENTIAL DEVELOPMENT AT MOUL PARK, PHASE 11, LOHAS PARK (SEUNG KHAM O, N.T.) TITLE : PENHOUSE LAYOUT PLAN AT TOWER 2		DATE : 22-OCT-21 SCALE : 1:350(A1) DRAWN BY : KY CHECKED BY : YB			
DATE : 22-OCT-21 SCALE : 1:350(A1) DRAWN BY : KY CHECKED BY : YB		REVISIONS : NO. DATE REVISION BY			
MIDI Architecture Firm Ltd. 11/F, 610 Chee Koon Street, Kowloon Tel: (852) 27771665 Fax: (852) 27771665 DMC NO. : 8558-CM-41703		REV. : B			



1-1 66/F.L.
1-1 LAYOUT PLAN FOR TOWER 3A(1/75)

B.D. REF :
DATE : 22-OCT-21
SCALE : 1:75(A1)

CLIENT :
寶利地有限公司
Sino Land Company Limited

ARCHITECT :
Ronald Lu & Partners
Ronald Lu & Partners (HK) Ltd.
呂元仲建築師事務所 (香港) 有限公司

STRUCTURAL ENGINEER :
Gammorn

FAÇADE CONSULTANT:
AECOM

AECOM

NOTES:
1. ALL DIMENSIONS ARE IN mm.
2. ALL DIMENSIONS ARE VERIFIED FROM OUTSIDE BEFORE FOUNDATION.
3. ALL DIMENSIONS TO BE VERIFIED ON SITE BEFORE FOUNDATION.
LEGEND:
① - DETAIL MARK NO.
② - REFER SHEET NO.
1. F.F.L. - FINISHED FLOOR LEVEL
2. S.F.L. - FINISHED SLOPE LEVEL
3. F.F.L. - FINISHED BEAM

NO.	DATE	REVISION
H	20/12/21	REVISED AS PER COMMENTS
G	18/08/21	REVISED AS PER COMMENTS
F	28/07/21	REVISED AS PER COMMENTS
E	30/05/21	REVISED AS PER COMMENTS
D	06/04/21	REVISED AS PER COMMENTS
C	23/02/21	REVISED AS PER COMMENTS
B	20/12/21	REVISED AS PER COMMENTS
A	03/12/21	REVISED AS PER COMMENTS

JOB NO. : J-858
PROJECT :
PROPOSED RESIDENTIAL DEVELOPMENT
AT TOWER 700P, PHASE 11, LOHAS PARK
TSEUNG KWAN O, N.T.

TITLE :
TYPICAL FLOOR PLAN
AT TOWER 3

DESIGNED BY : NB
CHECKED BY : KY
DRAWN BY : KY

UNITA 6-8, Sunny Industrial Centre, 1/F
810 Chee Koo Ling Road, Kowloon
Tel: (852) 27771888
Fax: (852) 27718888
DWC NO. : J858-04-1P01
REV. : H

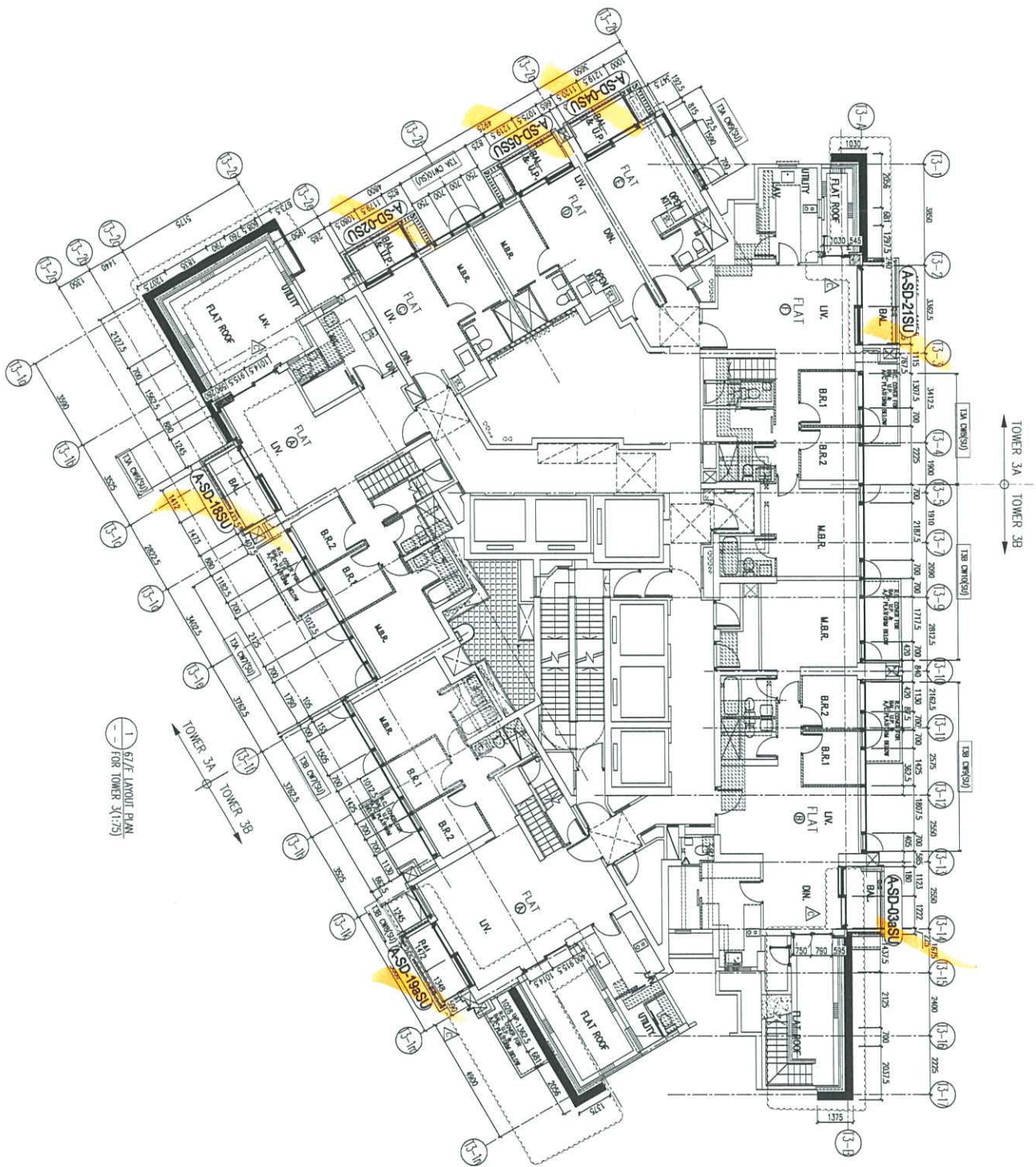

B.D. REF :

CLIENT :
 信和置業有限公司
 Sino Land Company Limited

ARCHITECT :
 Ronald Lu & Partners (HK) Ltd.
 呂元仲建築師事務所 (香港) 有限公司

STRUCTURAL ENGINEER :
 Gammion

FAHOLE CONSULTANT:
 AECOM

NOTE:
 1. ALL DIMENSIONS ARE IN mm.
 2. ALL DIMENSIONS ARE VERTICAL FROM OUTSIDE.
 3. ALL DIMENSIONS TO BE VERIFIED ON SITE BEFORE FABRICATION.

LEGEND:
 (X) DETAIL MARK NO.
 (200) REFER SHEET NO.
 1. E.L. - STAIRWELL FLOOR LEVEL
 2. S.L. - STAIRWELL FLOOR LEVEL
 X. (R) - REVERSED ROOM.

NO.	DATE	DESCRIPTION	BY	CHKD
C	05/05/23	REVISED AS PER COMMENTS	LS	LS
B	30/05/23	REVISED AS PER COMMENTS	LS	LS
A	06/04/23	REVISED AS PER COMMENTS	LS	LS

JOB NO. : J-858
 PROJECT : PROPOSED RESIDENTIAL DEVELOPMENT AT KOWI 708P, PHASE 11, LOHAS PARK, TSEUNG KWAN O, N.T.
 TITLE : PERIMETER LAYOUT PLAN AT TOWER 3

DATE : 22-OCT-21 SCALE : 1:25(A1)
 DRAWN BY : KY CHECKED BY : YB
 MIDI Architecture International Ltd.
 Units 6-8, Sunny Industrial Centre, 1/F,
 610 Chee Koo Long Road, Tseung Kwan O,
 New Territories, Hong Kong
 Tel: (852) 2717-7855
 Fax: (852) 2717-7856
 DMC NO. : 0858-DM-1300 REV. : C