



工程指示 / 要求簡箋(E.I.)

工程指示編號：EI / 5272 / 22

修改版次：K

工程編號：J - 858

工程名稱：將軍澳日出康城 LP 11

工程項目：幕牆 大貨單元件加工圖

收件人：生統

發件人：Ant Yeung

日期：23/11/2022

要求提供 / 確認 事項：

K版: 修改 AS 05A 一張,

K版: 按則師 11/21 comment 先暫停 T1A-CW6, T1A-CW3, T2A-CW3, T3A-CW3

I版:提供總共 63 件,水哥通知改了去水孔給圖紙記錄(只改 63 件)

I版:提供 Zone 2(T1 2 區)的加工圖數量表、組裝圖數量表、Zone2 開料單

I版: 改 AF0084A

J版: 補圖紙一張(H122785-S02)修拉巴。

H版:邊企料套心用膠固定,公母料套心不需用膠固定。

G版: 已修改玻璃欄河做法。窗站做法: 框的窗站向室內入 1.5 ,墊巴改加在玉的窗站底,窗站不阻去水口

F版: 按 EI5019 改氣孔。

E版: 按試水箱 comment 修改加工圖(雙掛勾碼單元),和回覆廠疑問。

E版: J858 單元件(T1-9~11F)加工圖數量統計表-1108。

D版: 按試水箱 comment 修改大貨掛勾碼。(公企一邊)

C版: 附上最急的 63 件位置及單元片編號。

B版: 因應來料較預期遲,必須分批生產和出貨。附上出貨次序(按折棚次序)見後頁

最先 Zone 1: 63 件; 第二 Zone 2: 60 件; 第三 Zone 3: 65 件; 第四 Zone 4: 52 件 請廠按此次序分批打開料單供生產使用。

A版: 已附圖則登記表,分層統計表及位置圖 此 63 件需廠打開料單

請按加工圖生產單元件送地盆安裝。

1. 第一批為 T1 9-17/F

2. 最優先的為 T1 B-D 單位開始 折棚平面次序見 EI5216

3. 排期按 EI4723 A

4. 附開料單 先附 T1 9-11/F, 請再給 12,15,16,17 /F

5. 附 J858 康城 11 期單元件數量分層統計表(T1)(T2)(T3)

6. J858 單元件(T1-9~11F)加工圖數量統計表 excel to 只給生統

7. J858 單元件(T1-9~11F)組裝圖數量統計表.excel to 只給生統

8. 生統/ 水洪留意: 早前業主視察 comment 的,需要跟進

9. 生統/ 水洪留意: 試水箱所調節的,在大貨,也要相應跟進

10. 生統/ 水洪留意: 轉角生窗玉用新模,需要測試開啟

11. 生統/ 水洪留意: 掛勾碼暫停開避位 X86256 / X86255 (可以開料 200mm 長/ 但不開避位): 試水箱有 commnet

12. 此單包括 (T1 9-60/F, T2 9-65/F, T3 9-65/F)

13. T2 11/F 有改動 3 件,未改圖 (再跟進)

請在 2022.11.25 前完成上列要求。

附: 頁

原合約工程包

原合約工程加 / 減賬

新工程報價

分發 拆圖 BUN  連附件

分發東莞各部門:

( ) 生產技術總監  連附件 ( ) 技術部  連附件 ( ) 生產部  連附件 ( ) 機械設計部  連附件

( ) 採購部  連附件 (✓) 生產統籌部  連附件 ( ) 水羅 & 清  連附件

( ) 質檢部  連附件 ( ) 會計部  連附件 ( ) 報關組  連附件 (✓) 其他 水洪  連附件

分發香港各部門:

( ) 行政部  連附件 ( ) 會計部  連附件 ( ) 統籌部  連附件 (✓) 工程部地盤科文  連附件 積哥

( ) 採購部  連附件 ( ) QS 部  連附件 ( ) 維修部  連附件 ( ) 其他 \_\_\_\_\_  連附件

傳遞編號:

發件人簽署:

HK 2087 / 22

項目經理簽署:

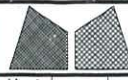
|  |                |                      |                  |                     |              |
|--|----------------|----------------------|------------------|---------------------|--------------|
|  <b>美特鋁質有限公司</b><br>MIDI Aluminium Fabricator Ltd. |                | 工程號 J858<br>地盘 康城11期 | 類別<br>制圖 Z. S. P | 物料號 -<br>2022-06-28 | 圖號 ALm-700H1 |
| 修改 1<br>日期 22/11   | 採用工廠<br>材料颜色 - | 图纸名称 单元组装图<br>材料 -   | 復核 -<br>批准 -     | 數量 -<br>單件重量 -      | -<br>(KG)    |

**AS-05A**

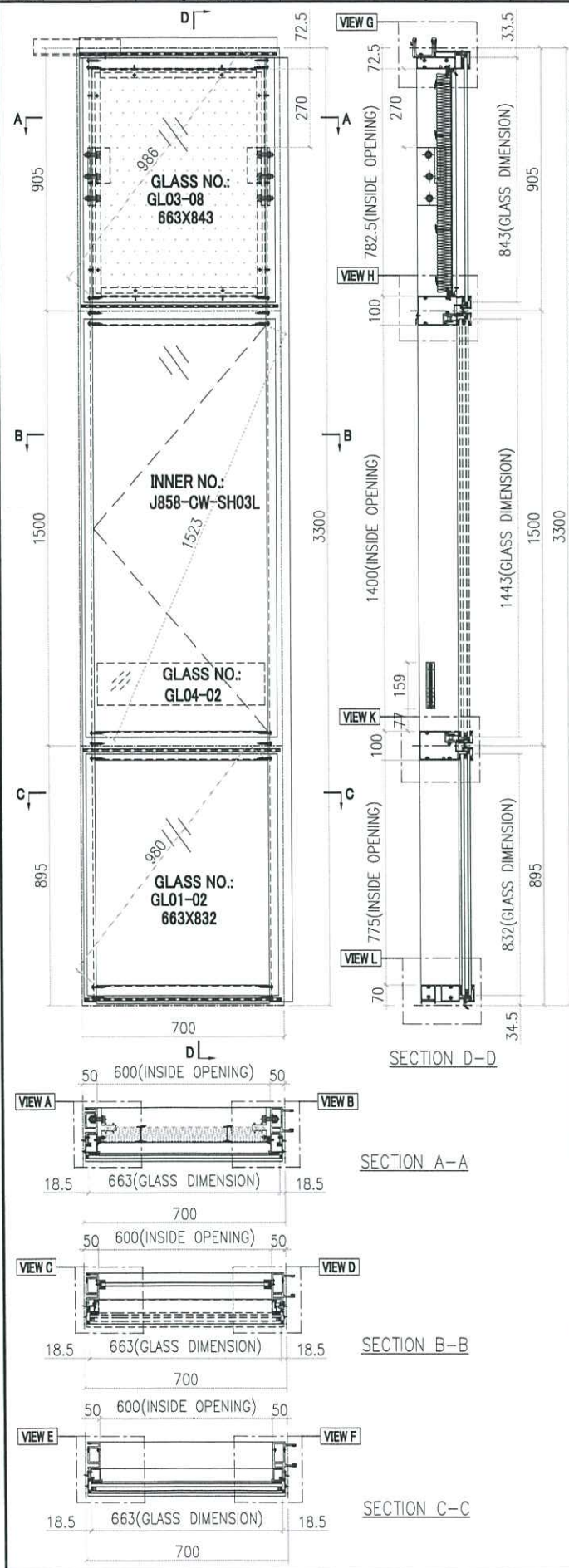

| T3A-CW6-0901 | 1         | 9/F  | INSTALL UNIT NO. | QTY. | FLOOR |
|--------------|-----------|------|------------------|------|-------|
| T3A-CW6-1001 | 1         | 10/F | T2B-CW6-0904     | 1    | 9/F   |
| T3A-CW6-1201 | 1         | 12/F | T2B-CW6-1004     | 1    | 10/F  |
| T3A-CW6-1501 | 1         | 15/F | T2B-CW6-1204     | 1    | 12/F  |
| T3A-CW6-1601 | 1         | 16/F | T2B-CW6-1504     | 1    | 15/F  |
| T3A-CW6-1701 | 1         | 17/F | T2B-CW6-1604     | 1    | 16/F  |
| T3A-CW6-1801 | 1         | 18/F | T2B-CW6-1704     | 1    | 17/F  |
| T3A-CW6-1901 | 1         | 19/F | T2B-CW6-1804     | 1    | 18/F  |
| T3A-CW6-2001 | 1         | 20/F | T2B-CW6-1904     | 1    | 19/F  |
| T3A-CW6-2101 | 1         | 21/F | T2B-CW6-2004     | 1    | 20/F  |
| T3A-CW6-2201 | 1         | 22/F | T2B-CW6-2104     | 1    | 21/F  |
| T3A-CW6-2301 | 1         | 23/F | T2B-CW6-2204     | 1    | 22/F  |
| T3A-CW6-2501 | 1         | 25/F | T2B-CW6-2304     | 1    | 23/F  |
| T3A-CW6-2601 | 1         | 26/F | T2B-CW6-2504     | 1    | 25/F  |
| T3A-CW6-2701 | 1         | 27/F | T2B-CW6-2604     | 1    | 26/F  |
| T3A-CW6-2801 | 1         | 28/F | T2B-CW6-2704     | 1    | 27/F  |
| T3A-CW6-2901 | 1         | 29/F | T2B-CW6-2804     | 1    | 28/F  |
| T3A-CW6-3001 | 1         | 30/F | T2B-CW6-2904     | 1    | 29/F  |
| T3A-CW6-3101 | 1         | 31/F | T2B-CW6-3004     | 1    | 30/F  |
| T3A-CW6-3201 | 1         | 32/F | T2B-CW6-3104     | 1    | 31/F  |
| T3A-CW6-3301 | 1         | 33/F | T2B-CW6-3204     | 1    | 32/F  |
| T3A-CW6-3501 | 1         | 35/F | T2B-CW6-3304     | 1    | 33/F  |
| T3A-CW6-3601 | 1         | 36/F | T2B-CW6-3504     | 1    | 35/F  |
| T3A-CW6-3701 | 1         | 37/F | T2B-CW6-3604     | 1    | 36/F  |
| T3A-CW6-3801 | 1         | 38/F | T2B-CW6-3704     | 1    | 37/F  |
| T3A-CW6-3901 | 1         | 39/F | T2B-CW6-3804     | 1    | 38/F  |
| T3A-CW6-4101 | 1         | 41/F | T2B-CW6-3904     | 1    | 39/F  |
| T3A-CW6-4201 | 1         | 42/F | T2B-CW6-4104     | 1    | 41/F  |
| T3A-CW6-4301 | 1         | 43/F | T2B-CW6-4204     | 1    | 42/F  |
| T3A-CW6-4501 | 1         | 45/F | T2B-CW6-4304     | 1    | 43/F  |
| T3A-CW6-4601 | 1         | 46/F | T2B-CW6-4504     | 1    | 45/F  |
| T3A-CW6-4701 | 1         | 47/F | T2B-CW6-4604     | 1    | 46/F  |
| T3A-CW6-4801 | 1         | 48/F | T2B-CW6-4704     | 1    | 47/F  |
| T3A-CW6-4901 | 1         | 49/F | T2B-CW6-4804     | 1    | 48/F  |
| T3A-CW6-5001 | 1         | 50/F | T2B-CW6-4904     | 1    | 49/F  |
| T3A-CW6-5101 | 1         | 51/F | T2B-CW6-5004     | 1    | 50/F  |
| T3A-CW6-5201 | 1         | 52/F | T2B-CW6-5104     | 1    | 51/F  |
| T3A-CW6-5301 | 1         | 53/F | T2B-CW6-5204     | 1    | 52/F  |
| T3A-CW6-5501 | 1         | 55/F | T2B-CW6-5304     | 1    | 53/F  |
| T3A-CW6-5601 | 1         | 56/F | T2B-CW6-5504     | 1    | 55/F  |
| T3A-CW6-5701 | 1         | 57/F | T2B-CW6-5604     | 1    | 56/F  |
| T3A-CW6-5801 | 1         | 58/F | T2B-CW6-5704     | 1    | 57/F  |
| T3A-CW6-5901 | 1         | 59/F | T2B-CW6-5804     | 1    | 58/F  |
| T3A-CW6-6001 | 1         | 60/F | T2B-CW6-5904     | 1    | 59/F  |
| T3A-CW6-6101 | 1         | 61/F | T2B-CW6-6004     | 1    | 60/F  |
| T3A-CW6-6201 | 1         | 62/F | T2B-CW6-6104     | 1    | 61/F  |
| T3A-CW6-6301 | 1         | 63/F | T2B-CW6-6204     | 1    | 62/F  |
| T3A-CW6-6501 | 1         | 65/F | T2B-CW6-6304     | 1    | 63/F  |
| <b>TOTAL</b> | <b>96</b> |      | T2B-CW6-6504     | 1    | 65/F  |

| GLASS | GLASS NUMBER | WIDTH | HEIGHT | QTY. |
|-------|--------------|-------|--------|------|
|       | GL03-08      | 663   | 843    | 1    |
|       | GL04-02      | 580   | 145    | 1    |
|       | GL01-02      | 663   | 832    | 1    |

|     | T1B-CW5  | T1B-CW6  | T1A-CW5  | T1A-CW4  | T1A-CW3  |
|-----|--|--|--|--|--|
| 19F |  |  |  |  |  |
| 18F |  |  |  |  |  |
| 17F |  |  |  |  |  |
| 16F |  |  |  |  |  |
| 15F |  |  |  |  |  |
| 14F |  |  |  |  |  |
| 13F |  |  |  |  |  |
| 12F |  |  |  |  |  |
| 11F | T1B-CW5-1001<br>T1B-CW5-1101<br>T1B-CW5-1102<br>T1B-CW5-1103<br>T1B-CW5-1104 | T1B-CW6-1101<br>T1B-CW6-1102<br>T1B-CW6-1103<br>T1B-CW6-1104<br>T1B-CW6-1105<br>T1B-CW6-1106<br>T1A-CW5-1101<br>T1A-CW5-1102<br>T1A-CW5-1103<br>T1A-CW5-1104<br>T1A-CW5-1105<br>T1A-CW5-1106<br>T1A-CW5-1107<br>T1A-CW4-1101<br>T1A-CW4-1102<br>T1A-CW4-1103<br>T1A-CW4-1104<br>T1A-CW4-1105<br>T1A-CW4-1106<br>T1A-CW4-1107<br>T1A-CW4-1108<br>T1A-CW3-1101<br>T1A-CW3-1102<br>T1A-CW3-1103<br>T1A-CW3-1104<br>T1A-CW3-1105<br>T1A-CW3-1106<br>T1A-CW3-1107<br>T1A-CW3-1108<br>T1A-CW3-1109<br>T1A-CW3-1110<br>T1A-CW3-1111 | T1A-CW5-1001<br>T1A-CW5-1002<br>T1A-CW5-1003<br>T1A-CW5-1004<br>T1A-CW4-1001<br>T1A-CW4-1002<br>T1A-CW4-1003<br>T1A-CW4-1004<br>T1A-CW4-1005<br>T1A-CW4-1006<br>T1A-CW4-1007<br>T1A-CW4-1008<br>T1A-CW3-1001<br>T1A-CW3-1002<br>T1A-CW3-1003<br>T1A-CW3-1004<br>T1A-CW3-1005<br>T1A-CW3-1006<br>T1A-CW3-1007<br>T1A-CW3-1008<br>T1A-CW3-1009<br>T1A-CW3-1010<br>T1A-CW3-1011 | T1A-CW4-1001<br>T1A-CW4-1002<br>T1A-CW4-1003<br>T1A-CW4-1004<br>T1A-CW4-1005<br>T1A-CW4-1006<br>T1A-CW4-1007<br>T1A-CW4-1008<br>T1A-CW3-1001<br>T1A-CW3-1002<br>T1A-CW3-1003<br>T1A-CW3-1004<br>T1A-CW3-1005<br>T1A-CW3-1006<br>T1A-CW3-1007<br>T1A-CW3-1008<br>T1A-CW3-1009<br>T1A-CW3-1010<br>T1A-CW3-1011 | T1A-CW3-1001<br>T1A-CW3-1002<br>T1A-CW3-1003<br>T1A-CW3-1004<br>T1A-CW3-1005<br>T1A-CW3-1006<br>T1A-CW3-1007<br>T1A-CW3-1008<br>T1A-CW3-1009<br>T1A-CW3-1010<br>T1A-CW3-1011 |
| 10F |  |  |  |  |  |
| 9F  |  |  |  |  |  |

↑

暫停

T1A (G)  
T1B (F)

↑

T1A (G)











SHO LHM COMPANY LIMITED  
 信和置業有限公司

ARCHITECT  
 Ronald Lu  
 Ronald Lu & Partners (HK) Ltd.  
 羅朗土建築師事務所 (香港) 有限公司  
 HKS (CN) 2012-2013

STRUCTURAL ENGINEER  
**GAMMON**  
**AECOM**

FAÇADE CONSULTANT  
**AECOM**

NOTE: ALL DIMENSIONS ARE IN MM. ALL ELEVATIONS ARE VIEWED FROM OUTSIDE UNLESS SPECIFICALLY NOTED OTHERWISE. DIMENSIONS ARE GIVEN ON SITE.

REVISIONS:

| NO. | DATE     | REVISION                |
|-----|----------|-------------------------|
| C   | 13/02/21 | REVISED AS PER COMMENTS |
| B   | 20/12/21 | REVISED AS PER COMMENTS |
| A   | 03/12/21 | REVISED AS PER COMMENTS |
| N   | 01/12/21 | REVISED                 |
| 1   |          |                         |

PROJECT: PROPOSED RESIDENTIAL DEVELOPMENT AT 'AGILE TOWER', PHASE II, LOMAS PARK, TSING KOWAN Q, N.T.

TITLE: TYPICAL FLOOR PLAN AT TOWER 2

DATE: 22-08-21  
 SCALE: 1:100(A1)

DRAWN BY: KY  
 CHECKED BY: JB

PROJECT NO: J-858

CLIENT: MIDT  
 MIDT ALUMINUM FABRICATOR LTD.  
 610 Gao Xue Road, Kunshan  
 Tel: 22486211-4, Fax: 8522777866

PROJECT NO: J-858-DW-LP201

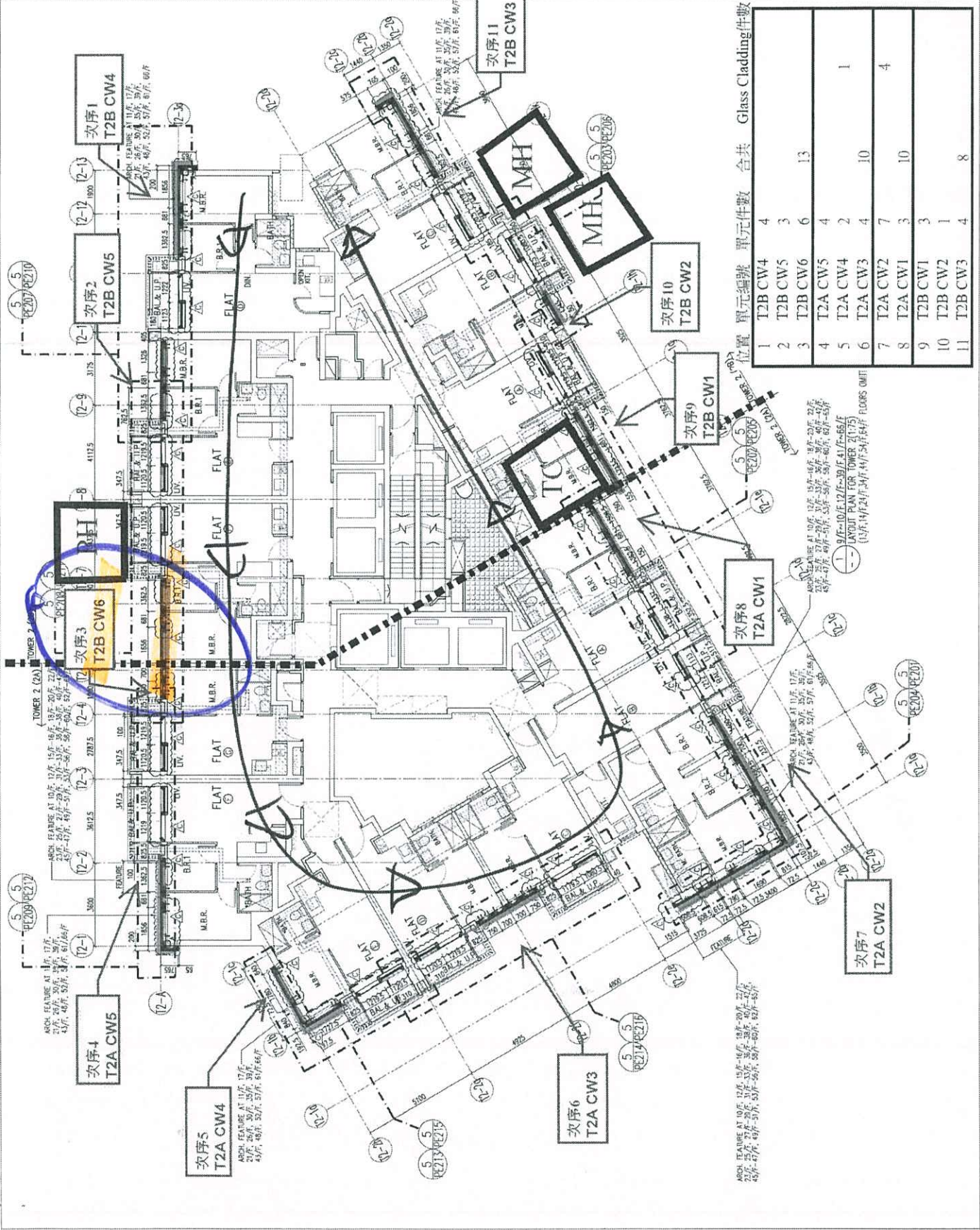

位置 單元編號 單元件數 合共 Glass Cladding件數

|    |         |   |    |
|----|---------|---|----|
| 1  | T2B CW4 | 4 |    |
| 2  | T2B CW5 | 3 |    |
| 3  | T2B CW6 | 6 | 13 |
| 4  | T2A CW5 | 4 |    |
| 5  | T2A CW4 | 2 | 1  |
| 6  | T2A CW3 | 4 | 10 |
| 7  | T2A CW2 | 7 | 4  |
| 8  | T2A CW1 | 3 | 10 |
| 9  | T2B CW1 | 3 |    |
| 10 | T2B CW2 | 1 |    |
| 11 | T2B CW3 | 4 | 8  |

ARCHITECTURAL ELEVATION AT 10/F, 12/F, 15/F, 16/F, 17/F, 18/F, 19/F, 20/F, 21/F, 22/F, 23/F, 24/F, 25/F, 26/F, 27/F, 28/F, 29/F, 30/F, 31/F, 32/F, 33/F, 34/F, 35/F, 36/F, 37/F, 38/F, 39/F, 40/F, 41/F, 42/F, 43/F, 44/F, 45/F, 46/F, 47/F, 48/F, 49/F, 50/F, 51/F, 52/F, 53/F, 54/F, 55/F, 56/F, 57/F, 58/F, 59/F, 60/F, 61/F, 62/F, 63/F, 64/F, 65/F, 66/F, 67/F, 68/F, 69/F, 70/F, 71/F, 72/F, 73/F, 74/F, 75/F, 76/F, 77/F, 78/F, 79/F, 80/F, 81/F, 82/F, 83/F, 84/F, 85/F, 86/F, 87/F, 88/F, 89/F, 90/F, 91/F, 92/F, 93/F, 94/F, 95/F, 96/F, 97/F, 98/F, 99/F, 100/F, 101/F, 102/F, 103/F, 104/F, 105/F, 106/F, 107/F, 108/F, 109/F, 110/F, 111/F, 112/F, 113/F, 114/F, 115/F, 116/F, 117/F, 118/F, 119/F, 120/F, 121/F, 122/F, 123/F, 124/F, 125/F, 126/F, 127/F, 128/F, 129/F, 130/F, 131/F, 132/F, 133/F, 134/F, 135/F, 136/F, 137/F, 138/F, 139/F, 140/F, 141/F, 142/F, 143/F, 144/F, 145/F, 146/F, 147/F, 148/F, 149/F, 150/F, 151/F, 152/F, 153/F, 154/F, 155/F, 156/F, 157/F, 158/F, 159/F, 160/F, 161/F, 162/F, 163/F, 164/F, 165/F, 166/F, 167/F, 168/F, 169/F, 170/F, 171/F, 172/F, 173/F, 174/F, 175/F, 176/F, 177/F, 178/F, 179/F, 180/F, 181/F, 182/F, 183/F, 184/F, 185/F, 186/F, 187/F, 188/F, 189/F, 190/F, 191/F, 192/F, 193/F, 194/F, 195/F, 196/F, 197/F, 198/F, 199/F, 200/F, 201/F, 202/F, 203/F, 204/F, 205/F, 206/F, 207/F, 208/F, 209/F, 210/F, 211/F, 212/F, 213/F, 214/F, 215/F, 216/F, 217/F, 218/F, 219/F, 220/F, 221/F, 222/F, 223/F, 224/F, 225/F, 226/F, 227/F, 228/F, 229/F, 230/F, 231/F, 232/F, 233/F, 234/F, 235/F, 236/F, 237/F, 238/F, 239/F, 240/F, 241/F, 242/F, 243/F, 244/F, 245/F, 246/F, 247/F, 248/F, 249/F, 250/F, 251/F, 252/F, 253/F, 254/F, 255/F, 256/F, 257/F, 258/F, 259/F, 260/F, 261/F, 262/F, 263/F, 264/F, 265/F, 266/F, 267/F, 268/F, 269/F, 270/F, 271/F, 272/F, 273/F, 274/F, 275/F, 276/F, 277/F, 278/F, 279/F, 280/F, 281/F, 282/F, 283/F, 284/F, 285/F, 286/F, 287/F, 288/F, 289/F, 290/F, 291/F, 292/F, 293/F, 294/F, 295/F, 296/F, 297/F, 298/F, 299/F, 300/F, 301/F, 302/F, 303/F, 304/F, 305/F, 306/F, 307/F, 308/F, 309/F, 310/F, 311/F, 312/F, 313/F, 314/F, 315/F, 316/F, 317/F, 318/F, 319/F, 320/F, 321/F, 322/F, 323/F, 324/F, 325/F, 326/F, 327/F, 328/F, 329/F, 330/F, 331/F, 332/F, 333/F, 334/F, 335/F, 336/F, 337/F, 338/F, 339/F, 340/F, 341/F, 342/F, 343/F, 344/F, 345/F, 346/F, 347/F, 348/F, 349/F, 350/F, 351/F, 352/F, 353/F, 354/F, 355/F, 356/F, 357/F, 358/F, 359/F, 360/F, 361/F, 362/F, 363/F, 364/F, 365/F, 366/F, 367/F, 368/F, 369/F, 370/F, 371/F, 372/F, 373/F, 374/F, 375/F, 376/F, 377/F, 378/F, 379/F, 380/F, 381/F, 382/F, 383/F, 384/F, 385/F, 386/F, 387/F, 388/F, 389/F, 390/F, 391/F, 392/F, 393/F, 394/F, 395/F, 396/F, 397/F, 398/F, 399/F, 400/F, 401/F, 402/F, 403/F, 404/F, 405/F, 406/F, 407/F, 408/F, 409/F, 410/F, 411/F, 412/F, 413/F, 414/F, 415/F, 416/F, 417/F, 418/F, 419/F, 420/F, 421/F, 422/F, 423/F, 424/F, 425/F, 426/F, 427/F, 428/F, 429/F, 430/F, 431/F, 432/F, 433/F, 434/F, 435/F, 436/F, 437/F, 438/F, 439/F, 440/F, 441/F, 442/F, 443/F, 444/F, 445/F, 446/F, 447/F, 448/F, 449/F, 450/F, 451/F, 452/F, 453/F, 454/F, 455/F, 456/F, 457/F, 458/F, 459/F, 460/F, 461/F, 462/F, 463/F, 464/F, 465/F, 466/F, 467/F, 468/F, 469/F, 470/F, 471/F, 472/F, 473/F, 474/F, 475/F, 476/F, 477/F, 478/F, 479/F, 480/F, 481/F, 482/F, 483/F, 484/F, 485/F, 486/F, 487/F, 488/F, 489/F, 490/F, 491/F, 492/F, 493/F, 494/F, 495/F, 496/F, 497/F, 498/F, 499/F, 500/F, 501/F, 502/F, 503/F, 504/F, 505/F, 506/F, 507/F, 508/F, 509/F, 510/F, 511/F, 512/F, 513/F, 514/F, 515/F, 516/F, 517/F, 518/F, 519/F, 520/F, 521/F, 522/F, 523/F, 524/F, 525/F, 526/F, 527/F, 528/F, 529/F, 530/F, 531/F, 532/F, 533/F, 534/F, 535/F, 536/F, 537/F, 538/F, 539/F, 540/F, 541/F, 542/F, 543/F, 544/F, 545/F, 546/F, 547/F, 548/F, 549/F, 550/F, 551/F, 552/F, 553/F, 554/F, 555/F, 556/F, 557/F, 558/F, 559/F, 560/F, 561/F, 562/F, 563/F, 564/F, 565/F, 566/F, 567/F, 568/F, 569/F, 570/F, 571/F, 572/F, 573/F, 574/F, 575/F, 576/F, 577/F, 578/F, 579/F, 580/F, 581/F, 582/F, 583/F, 584/F, 585/F, 586/F, 587/F, 588/F, 589/F, 590/F, 591/F, 592/F, 593/F, 594/F, 595/F, 596/F, 597/F, 598/F, 599/F, 600/F, 601/F, 602/F, 603/F, 604/F, 605/F, 606/F, 607/F, 608/F, 609/F, 610/F, 611/F, 612/F, 613/F, 614/F, 615/F, 616/F, 617/F, 618/F, 619/F, 620/F, 621/F, 622/F, 623/F, 624/F, 625/F, 626/F, 627/F, 628/F, 629/F, 630/F, 631/F, 632/F, 633/F, 634/F, 635/F, 636/F, 637/F, 638/F, 639/F, 640/F, 641/F, 642/F, 643/F, 644/F, 645/F, 646/F, 647/F, 648/F, 649/F, 650/F, 651/F, 652/F, 653/F, 654/F, 655/F, 656/F, 657/F, 658/F, 659/F, 660/F, 661/F, 662/F, 663/F, 664/F, 665/F, 666/F, 667/F, 668/F, 669/F, 670/F, 671/F, 672/F, 673/F, 674/F, 675/F, 676/F, 677/F, 678/F, 679/F, 680/F, 681/F, 682/F, 683/F, 684/F, 685/F, 686/F, 687/F, 688/F, 689/F, 690/F, 691/F, 692/F, 693/F, 694/F, 695/F, 696/F, 697/F, 698/F, 699/F, 700/F, 701/F, 702/F, 703/F, 704/F, 705/F, 706/F, 707/F, 708/F, 709/F, 710/F, 711/F, 712/F, 713/F, 714/F, 715/F, 716/F, 717/F, 718/F, 719/F, 720/F, 721/F, 722/F, 723/F, 724/F, 725/F, 726/F, 727/F, 728/F, 729/F, 730/F, 731/F, 732/F, 733/F, 734/F, 735/F, 736/F, 737/F, 738/F, 739/F, 740/F, 741/F, 742/F, 743/F, 744/F, 745/F, 746/F, 747/F, 748/F, 749/F, 750/F, 751/F, 752/F, 753/F, 754/F, 755/F, 756/F, 757/F, 758/F, 759/F, 760/F, 761/F, 762/F, 763/F, 764/F, 765/F, 766/F, 767/F, 768/F, 769/F, 770/F, 771/F, 772/F, 773/F, 774/F, 775/F, 776/F, 777/F, 778/F, 779/F, 780/F, 781/F, 782/F, 783/F, 784/F, 785/F, 786/F, 787/F, 788/F, 789/F, 790/F, 791/F, 792/F, 793/F, 794/F, 795/F, 796/F, 797/F, 798/F, 799/F, 800/F, 801/F, 802/F, 803/F, 804/F, 805/F, 806/F, 807/F, 808/F, 809/F, 810/F, 811/F, 812/F, 813/F, 814/F, 815/F, 816/F, 817/F, 818/F, 819/F, 820/F, 821/F, 822/F, 823/F, 824/F, 825/F, 826/F, 827/F, 828/F, 829/F, 830/F, 831/F, 832/F, 833/F, 834/F, 835/F, 836/F, 837/F, 838/F, 839/F, 840/F, 841/F, 842/F, 843/F, 844/F, 845/F, 846/F, 847/F, 848/F, 849/F, 850/F, 851/F, 852/F, 853/F, 854/F, 855/F, 856/F, 857/F, 858/F, 859/F, 860/F, 861/F, 862/F, 863/F, 864/F, 865/F, 866/F, 867/F, 868/F, 869/F, 870/F, 871/F, 872/F, 873/F, 874/F, 875/F, 876/F, 877/F, 878/F, 879/F, 880/F, 881/F, 882/F, 883/F, 884/F, 885/F, 886/F, 887/F, 888/F, 889/F, 890/F, 891/F, 892/F, 893/F, 894/F, 895/F, 896/F, 897/F, 898/F, 899/F, 900/F, 901/F, 902/F, 903/F, 904/F, 905/F, 906/F, 907/F, 908/F, 909/F, 910/F, 911/F, 912/F, 913/F, 914/F, 915/F, 916/F, 917/F, 918/F, 919/F, 920/F, 921/F, 922/F, 923/F, 924/F, 925/F, 926/F, 927/F, 928/F, 929/F, 930/F, 931/F, 932/F, 933/F, 934/F, 935/F, 936/F, 937/F, 938/F, 939/F, 940/F, 941/F, 942/F, 943/F, 944/F, 945/F, 946/F, 947/F, 948/F, 949/F, 950/F, 951/F, 952/F, 953/F, 954/F, 955/F, 956/F, 957/F, 958/F, 959/F, 960/F, 961/F, 962/F, 963/F, 964/F, 965/F, 966/F, 967/F, 968/F, 969/F, 970/F, 971/F, 972/F, 973/F, 974/F, 975/F, 976/F, 977/F, 978/F, 979/F, 980/F, 981/F, 982/F, 983/F, 984/F, 985/F, 986/F, 987/F, 988/F, 989/F, 990/F, 991/F, 992/F, 993/F, 994/F, 995/F, 996/F, 997/F, 998/F, 999/F, 1000/F, 1001/F, 1002/F, 1003/F, 1004/F, 1005/F, 1006/F, 1007/F, 1008/F, 1009/F, 1010/F, 1011/F, 1012/F, 1013/F, 1014/F, 1015/F, 1016/F, 1017/F, 1018/F, 1019/F, 1020/F, 1021/F, 1022/F, 1023/F, 1024/F, 1025/F, 1026/F, 1027/F, 1028/F, 1029/F, 1030/F, 1031/F, 1032/F, 1033/F, 1034/F, 1035/F, 1036/F, 1037/F, 1038/F, 1039/F, 1040/F, 1041/F, 1042/F, 1043/F, 1044/F, 1045/F, 1046/F, 1047/F, 1048/F, 1049/F, 1050/F, 1051/F, 1052/F, 1053/F, 1054/F, 1055/F, 1056/F, 1057/F, 1058/F, 1059/F, 1060/F, 1061/F, 1062/F, 1063/F, 1064/F, 1065/F, 1066/F, 1067/F, 1068/F, 1069/F, 1070/F, 1071/F, 1072/F, 1073/F, 1074/F, 1075/F, 1076/F, 1077/F, 1078/F, 1079/F, 1080/F, 1081/F, 1082/F, 1083/F, 1084/F, 1085/F, 1086/F, 1087/F, 1088/F, 1089/F, 1090/F, 1091/F, 1092/F, 1093/F, 1094/F, 1095/F, 1096/F, 1097/F, 1098/F, 1099/F, 1100/F, 1101/F, 1102/F, 1103/F, 1104/F, 1105/F, 1106/F, 1107/F, 1108/F, 1109/F, 1110/F, 1111/F, 1112/F, 1113/F, 1114/F, 1115/F, 1116/F, 1117/F, 1118/F, 1119/F, 1120/F, 1121/F, 1122/F, 1123/F, 1124/F, 1125/F, 1126/F, 1127/F, 1128/F, 1129/F, 1130/F, 1131/F, 1132/F, 1133/F, 1134/F, 1135/F, 1136/F, 1137/F, 1138/F, 1139/F, 1140/F, 1141/F, 1142/F, 1143/F, 1144/F, 1145/F, 1146/F, 1147/F, 1148/F, 1149/F, 1150/F, 1151/F, 1152/F, 1153/F, 1154/F, 1155/F, 1156/F, 1157/F, 1158/F, 1159/F, 1160/F, 1161/F, 1162/F, 1163/F, 1164/F, 1165/F, 1166/F, 1167/F, 1168/F, 1169/F, 1170/F, 1171/F, 1172/F, 1173/F, 1174/F, 1175/F, 1176/F, 1177/F, 1178/F, 1179/F, 1180/F, 1181/F, 1182/F, 1183/F, 1184/F, 1185/F, 1186/F, 1187/F, 1188/F, 1189/F, 1190/F, 1191/F, 1192/F, 1193/F, 1194/F, 1195/F, 1196/F, 1197/F, 1198/F, 1199/F, 1200/F, 1201/F, 1202/F, 1203/F, 1204/F, 1205/F, 1206/F, 1207/F, 1208/F, 1209/F, 1210/F, 1211/F, 1212/F, 1213/F, 1214/F, 1215/F, 1216/F, 1217/F, 1218/F, 1219/F, 1220/F, 1221/F, 1222/F, 1223/F, 1224/F, 1225/F, 1226/F, 1227/F, 1228/F, 1229/F, 1230/F, 1231/F, 1232/F, 1233/F, 1234/F, 1235/F, 1236/F, 1237/F, 1238/F, 1239/F, 1240/F, 1241/F, 1242/F, 1243/F, 1244/F, 1245/F, 1246/F, 1247/F, 1248/F, 1249/F, 1250/F, 1251/F, 1252/F, 1253/F, 1254/F, 1255/F, 1256/F, 1257/F, 1258/F, 1259/F, 1260/F, 1261/F, 1262/F, 1263/F, 1264/F, 1265/F, 1266/F, 1267/F, 1268/F, 1269/F, 1270/F, 1271/F, 1272/F, 1273/F, 1274/F, 1275/F, 1276/F, 1277/F, 1278/F, 1279/F, 1280/F, 1281/F, 1282/F, 1283/F, 1284/F, 1285/F, 1286/F, 1287/F, 1288/F, 1289/F, 1290/F, 1291/F, 1292/F, 1293/F, 1294/F, 1295/F, 1296/F, 1297/F, 1298/F, 1299/F, 1300/F, 1301/F, 1302/F, 1303/F, 1304/F, 1305/F, 1306/F, 1307/F, 1308/F, 1309/F, 1310/F, 1311/F, 1312/F, 1313/F, 1314/F, 1315/F, 1316/F, 1317/F, 1318/F, 1319/F, 1320/F, 1321/F, 1322/F, 1323/F, 1324/F, 1325/F, 1326/F, 1327/F, 1328/F, 1329/F, 1330/F, 1331/F, 1332/F, 1333/F, 1334/F, 1335/F, 1336/F, 1337/F, 1338/F, 1339/F, 1340/F, 1341/F, 1342/F, 1343/F, 1344/F, 1345/F, 1346/F, 1347/F, 1348/F, 1349/F, 1350/F, 1351/F, 1352/F, 1353/F, 1354/F, 1355/F, 1356/F, 1357/F, 1358/F, 1359/F, 1360/F, 1361/F, 1362/F, 1363/F, 1364/F, 1365/F, 1366/F, 1367/F, 1368/F, 1369/F, 1370/F, 1371/F, 1372/F, 1373/F, 1374/F, 1375/F, 1376/F, 1377/F, 1378/F, 1379/F, 1380/F, 1381/F, 1382/F, 1383/F, 1384/F, 1385/F, 1386/F, 1387/F, 1388/F, 1389/F, 1390/F, 1391/F, 1392/F, 1393/F, 1394/F, 1395/F, 1396/F, 1397/F, 1398/F, 1399/F, 1400/F, 1401/F, 1402/F, 1403/F, 1404/F, 1405/F, 1406/F, 1407/F, 1408/F, 1409/F, 1410/F, 1411/F, 1412/F, 1413/F, 1414/F, 1415/F, 1416/F, 1417/F, 1418/F, 1419/F, 1420/F, 1421/F, 1422/F, 1423/F, 1424/F, 1425/F, 1426/F, 1427/F, 1428/F, 1429/F, 1430/F, 1431/F, 1432/F, 1433/F, 1434/F, 1435/F, 1436/F, 1437/F, 1438/F, 1439/F, 1440/F, 1441/F, 1442/F, 1443/F, 1444/F, 1445/F, 1446/F, 1447/F, 1448/F, 1449/F, 1450/F, 1451/F, 1452/F, 1453/F, 1454/F, 1455/F, 1456/F, 1457/F, 1458/F, 1459/F, 1460/F, 1461/F, 1462/F, 1463/F, 1464/F, 1465/F, 1466/F, 1467/F, 1468/F, 1469/F, 1470/F, 1471/F, 1472/F, 1473/F, 1474/F, 1475/F, 1476/F, 1477/F, 1478/F, 1479/F, 1480/F, 1481/F, 1482/F, 1483/F, 1484/F, 1485/F, 1486/F, 1487/F, 1488/F, 1489/F, 1490/F, 1491/F, 1492/F, 1493/F, 1494/F, 1495/F, 1496/F, 1497/F, 1498/F, 1499/F, 1500/F, 1501/F, 1502/F, 1503/F, 1504/F, 1505/F, 1506/F, 1507/F, 1508/F, 1509/F, 1510/F, 1511/F, 1512/F, 1513/F, 1514/F, 1515/F, 1516/F, 1517/F, 1518/F, 1519/F, 1520/F, 1521/F, 1522/F, 1523/F, 1524/F, 1525/F, 1526/F, 1527/F, 1528/F, 1529/F, 1530/F, 1531/F, 1532/F, 1533/F, 1534/F, 1535/F, 1536/F, 1537/F, 1538/F, 1539/F, 1540/F, 1541/F, 1542/F, 1543/F, 1544/F, 1545/F, 1546/F, 1547/F, 1548/F, 1549/F, 1550/F, 1551/F, 1552/F, 1553/F, 1554/F, 1555/F, 1556/F, 1557/F, 1558/F, 1559/F, 1560/F, 1561/F, 1562/F, 1563/F, 1564/F, 1565/F, 1566/F, 1567/F, 1568/F, 1569/F, 1570/F, 1571/F, 1572/F, 1573/F, 1574/F, 1575/F, 1576/F, 1577/F, 1578/F, 1579/F, 1580/F, 1581/F, 1582/F, 1583/F, 1584/F, 1585/F, 1586/F, 1587/F, 1588/F, 1589/F, 1590/F, 1591/F, 1592/F, 1593/F, 1594/F, 1595/F, 1596/F, 1597/F, 1598/F, 1599/F, 1600/F, 1601/F, 1602/F, 1603/F, 1604/F, 1605/F, 1606/F, 1607/F, 1608/F, 1609/F, 1610/F, 1611/F, 1612/F, 1613/F, 1614/F, 1615/F, 1616/F, 1617/F, 1618/F, 1619/F, 1620/F, 1621/F, 1622/F, 1623/F, 1624/F, 1625/F, 1626/F, 1627/F, 1628/F, 1629/F, 1630/F, 1631/F, 1632/F, 1633/F, 1634/F, 1635/F, 1636/F, 1637/F, 1638/F, 1639/F, 1640/F, 1641/F, 1642/F, 1643/F, 1644/F, 1645/F, 1646/F, 1647/F, 1648/F, 1649/F, 1650/F, 1651/F, 1652/F, 1653/F, 1654/F, 1655/F, 1656/F, 1657/F, 1658/F, 1659/F, 1660/F, 1661/F, 1662/F, 1663/F, 1664/F, 1665/F, 1666/F, 1667/F, 1668/F, 1669/F, 1670/F, 1671/F, 1672/F, 1673/F, 1674/F, 1675/F, 1676/F, 1677/F, 1678/F, 1679/F, 1680/F, 1681/F, 1682/F, 1683/F, 1684/F, 1685/F, 1686/F, 1687/F, 1688/F, 1689/F, 1690/F, 1691/F, 1692/F, 1693/F, 1694/F, 1695/F, 1696/F, 1697/F, 1698/F, 1699/F, 1700/F, 1701/F, 1702/F, 1703/F, 1704/F, 1705/F, 1706/F, 1707/F, 1708/F, 1709/F, 1710/F, 1711/F, 1712/F, 1713/F, 1714/F, 1715/F, 1716/F, 1717/F, 1718/F, 1719/F, 1720/F, 1721/F, 1722/F, 172

B.O. REF:

SHO LING COMPANY LIMITED  
怡和置業有限公司

CONSULTING ENGINEERS  
SHO LING PARTNERS (HK) LTD.  
怡和置業有限公司  
MAIN CONTRACTOR:

GAMMON  
STRUCTURAL ENGINEER

AECOM  
FAÇADE CONSULTANT

AECOM

NOTE:  
1. ALL DIMENSIONS ARE IN mm FROM O.D.C.S.  
2. ALL DIMENSIONS TO BE VERIFIED ON SITE BEFORE FABRICATION.

LEGEND:  
① - DETAIL MARK NO.  
② - REFER SHEET NO.

1. F.F.L. - FINISHED FLOOR LEVEL.  
2. S.F.L. - STRUCTURAL FLOOR LEVEL.  
3. - REVERSED DETAIL.

|    |    |          |                         |
|----|----|----------|-------------------------|
| LS | C  | 22/02/23 | REVISED AS PER COMMENTS |
| LS | R  | 20/12/21 | REVISED AS PER COMMENTS |
| LS | A  | 15/12/21 | REVISED AS PER COMMENTS |
| LS | W  | 08/12/21 | REVISED AS PER COMMENTS |
| LS | BY |          |                         |

JOB NO.: J-256

PROPOSED RESIDENTIAL DEVELOPMENT  
AT MOUL TUNG, PHASE 11, LING PAI  
DEWING AIN O, VIET.

TITLE:  
TYPICAL FLOOR PLAN  
AT TOWER 3

DATE: 23-07-21

SCALE: 1/750(A1)

DRAWN BY: KY

DESIGNED BY: YB

SHO LING PARTNERS (HK) LTD.

MIDI Aluminium Fabrication Ltd.

610 Cheung Koo Lane, Road, Kowloon

TEL: 2497311-4 Fax: 24977728

DWG NO.: 4655-01-P30

REV: C

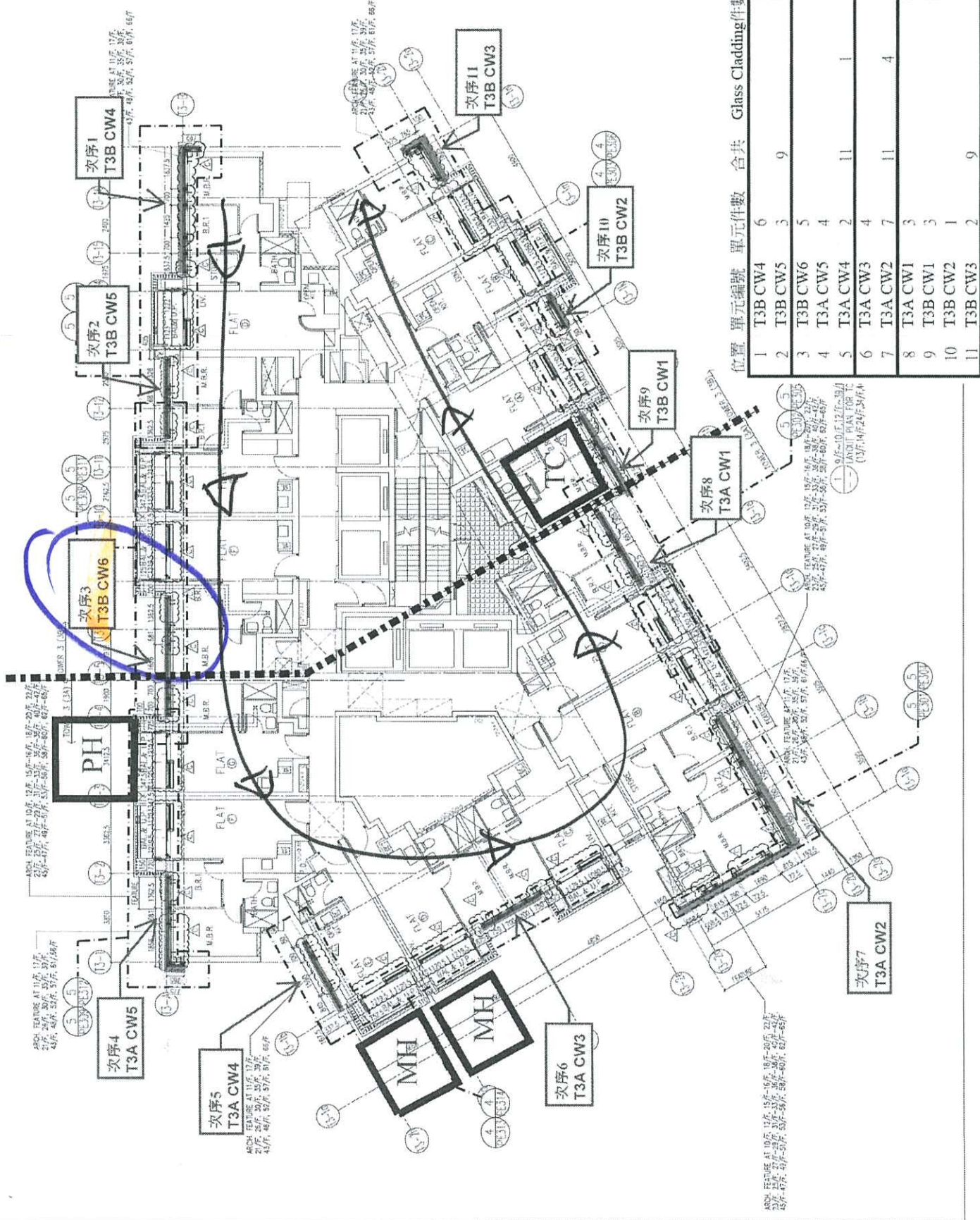

位置 單元編號 單元件數 合共 Glass Cladding 件數

|    |         |   |    |
|----|---------|---|----|
| 1  | T3B CW4 | 6 |    |
| 2  | T3B CW5 | 3 | 9  |
| 3  | T3B CW6 | 5 |    |
| 4  | T3A CW5 | 4 |    |
| 5  | T3A CW4 | 2 | 11 |
| 6  | T3A CW3 | 4 |    |
| 7  | T3A CW2 | 7 | 11 |
| 8  | T3A CW1 | 3 |    |
| 9  | T3B CW1 | 3 |    |
| 10 | T3B CW2 | 1 |    |
| 11 | T3B CW3 | 2 | 9  |

ARCH. FEATURE AT 10/F, 11/F, 15/F, 16/F, 18/F, 20/F, 22/F, 27/F, 28/F, 29/F, 30/F, 31/F, 32/F, 33/F, 35/F, 36/F, 40/F, 42/F, 43/F, 45/F, 47/F, 49/F, 51/F, 53/F, 55/F, 56/F, 58/F, 60/F, 62/F, 65/F, 67/F, 69/F, 71/F, 73/F, 75/F, 77/F, 79/F, 81/F, 83/F, 85/F, 87/F, 89/F, 91/F, 93/F, 95/F, 97/F, 99/F, 101/F, 103/F, 105/F, 107/F, 109/F, 111/F, 113/F, 115/F, 117/F, 119/F, 121/F, 123/F, 125/F, 127/F, 129/F, 131/F, 133/F, 135/F, 137/F, 139/F, 141/F, 143/F, 145/F, 147/F, 149/F, 151/F, 153/F, 155/F, 157/F, 159/F, 161/F, 163/F, 165/F, 167/F, 169/F, 171/F, 173/F, 175/F, 177/F, 179/F, 181/F, 183/F, 185/F, 187/F, 189/F, 191/F, 193/F, 195/F, 197/F, 199/F, 201/F, 203/F, 205/F, 207/F, 209/F, 211/F, 213/F, 215/F, 217/F, 219/F, 221/F, 223/F, 225/F, 227/F, 229/F, 231/F, 233/F, 235/F, 237/F, 239/F, 241/F, 243/F, 245/F, 247/F, 249/F, 251/F, 253/F, 255/F, 257/F, 259/F, 261/F, 263/F, 265/F, 267/F, 269/F, 271/F, 273/F, 275/F, 277/F, 279/F, 281/F, 283/F, 285/F, 287/F, 289/F, 291/F, 293/F, 295/F, 297/F, 299/F, 301/F, 303/F, 305/F, 307/F, 309/F, 311/F, 313/F, 315/F, 317/F, 319/F, 321/F, 323/F, 325/F, 327/F, 329/F, 331/F, 333/F, 335/F, 337/F, 339/F, 341/F, 343/F, 345/F, 347/F, 349/F, 351/F, 353/F, 355/F, 357/F, 359/F, 361/F, 363/F, 365/F, 367/F, 369/F, 371/F, 373/F, 375/F, 377/F, 379/F, 381/F, 383/F, 385/F, 387/F, 389/F, 391/F, 393/F, 395/F, 397/F, 399/F, 401/F, 403/F, 405/F, 407/F, 409/F, 411/F, 413/F, 415/F, 417/F, 419/F, 421/F, 423/F, 425/F, 427/F, 429/F, 431/F, 433/F, 435/F, 437/F, 439/F, 441/F, 443/F, 445/F, 447/F, 449/F, 451/F, 453/F, 455/F, 457/F, 459/F, 461/F, 463/F, 465/F, 467/F, 469/F, 471/F, 473/F, 475/F, 477/F, 479/F, 481/F, 483/F, 485/F, 487/F, 489/F, 491/F, 493/F, 495/F, 497/F, 499/F, 501/F, 503/F, 505/F, 507/F, 509/F, 511/F, 513/F, 515/F, 517/F, 519/F, 521/F, 523/F, 525/F, 527/F, 529/F, 531/F, 533/F, 535/F, 537/F, 539/F, 541/F, 543/F, 545/F, 547/F, 549/F, 551/F, 553/F, 555/F, 557/F, 559/F, 561/F, 563/F, 565/F, 567/F, 569/F, 571/F, 573/F, 575/F, 577/F, 579/F, 581/F, 583/F, 585/F, 587/F, 589/F, 591/F, 593/F, 595/F, 597/F, 599/F, 601/F, 603/F, 605/F, 607/F, 609/F, 611/F, 613/F, 615/F, 617/F, 619/F, 621/F, 623/F, 625/F, 627/F, 629/F, 631/F, 633/F, 635/F, 637/F, 639/F, 641/F, 643/F, 645/F, 647/F, 649/F, 651/F, 653/F, 655/F, 657/F, 659/F, 661/F, 663/F, 665/F, 667/F, 669/F, 671/F, 673/F, 675/F, 677/F, 679/F, 681/F, 683/F, 685/F, 687/F, 689/F, 691/F, 693/F, 695/F, 697/F, 699/F, 701/F, 703/F, 705/F, 707/F, 709/F, 711/F, 713/F, 715/F, 717/F, 719/F, 721/F, 723/F, 725/F, 727/F, 729/F, 731/F, 733/F, 735/F, 737/F, 739/F, 741/F, 743/F, 745/F, 747/F, 749/F, 751/F, 753/F, 755/F, 757/F, 759/F, 761/F, 763/F, 765/F, 767/F, 769/F, 771/F, 773/F, 775/F, 777/F, 779/F, 781/F, 783/F, 785/F, 787/F, 789/F, 791/F, 793/F, 795/F, 797/F, 799/F, 801/F, 803/F, 805/F, 807/F, 809/F, 811/F, 813/F, 815/F, 817/F, 819/F, 821/F, 823/F, 825/F, 827/F, 829/F, 831/F, 833/F, 835/F, 837/F, 839/F, 841/F, 843/F, 845/F, 847/F, 849/F, 851/F, 853/F, 855/F, 857/F, 859/F, 861/F, 863/F, 865/F, 867/F, 869/F, 871/F, 873/F, 875/F, 877/F, 879/F, 881/F, 883/F, 885/F, 887/F, 889/F, 891/F, 893/F, 895/F, 897/F, 899/F, 901/F, 903/F, 905/F, 907/F, 909/F, 911/F, 913/F, 915/F, 917/F, 919/F, 921/F, 923/F, 925/F, 927/F, 929/F, 931/F, 933/F, 935/F, 937/F, 939/F, 941/F, 943/F, 945/F, 947/F, 949/F, 951/F, 953/F, 955/F, 957/F, 959/F, 961/F, 963/F, 965/F, 967/F, 969/F, 971/F, 973/F, 975/F, 977/F, 979/F, 981/F, 983/F, 985/F, 987/F, 989/F, 991/F, 993/F, 995/F, 997/F, 999/F, 1001/F, 1003/F, 1005/F, 1007/F, 1009/F, 1011/F, 1013/F, 1015/F, 1017/F, 1019/F, 1021/F, 1023/F, 1025/F, 1027/F, 1029/F, 1031/F, 1033/F, 1035/F, 1037/F, 1039/F, 1041/F, 1043/F, 1045/F, 1047/F, 1049/F, 1051/F, 1053/F, 1055/F, 1057/F, 1059/F, 1061/F, 1063/F, 1065/F, 1067/F, 1069/F, 1071/F, 1073/F, 1075/F, 1077/F, 1079/F, 1081/F, 1083/F, 1085/F, 1087/F, 1089/F, 1091/F, 1093/F, 1095/F, 1097/F, 1099/F, 1101/F, 1103/F, 1105/F, 1107/F, 1109/F, 1111/F, 1113/F, 1115/F, 1117/F, 1119/F, 1121/F, 1123/F, 1125/F, 1127/F, 1129/F, 1131/F, 1133/F, 1135/F, 1137/F, 1139/F, 1141/F, 1143/F, 1145/F, 1147/F, 1149/F, 1151/F, 1153/F, 1155/F, 1157/F, 1159/F, 1161/F, 1163/F, 1165/F, 1167/F, 1169/F, 1171/F, 1173/F, 1175/F, 1177/F, 1179/F, 1181/F, 1183/F, 1185/F, 1187/F, 1189/F, 1191/F, 1193/F, 1195/F, 1197/F, 1199/F, 1201/F, 1203/F, 1205/F, 1207/F, 1209/F, 1211/F, 1213/F, 1215/F, 1217/F, 1219/F, 1221/F, 1223/F, 1225/F, 1227/F, 1229/F, 1231/F, 1233/F, 1235/F, 1237/F, 1239/F, 1241/F, 1243/F, 1245/F, 1247/F, 1249/F, 1251/F, 1253/F, 1255/F, 1257/F, 1259/F, 1261/F, 1263/F, 1265/F, 1267/F, 1269/F, 1271/F, 1273/F, 1275/F, 1277/F, 1279/F, 1281/F, 1283/F, 1285/F, 1287/F, 1289/F, 1291/F, 1293/F, 1295/F, 1297/F, 1299/F, 1301/F, 1303/F, 1305/F, 1307/F, 1309/F, 1311/F, 1313/F, 1315/F, 1317/F, 1319/F, 1321/F, 1323/F, 1325/F, 1327/F, 1329/F, 1331/F, 1333/F, 1335/F, 1337/F, 1339/F, 1341/F, 1343/F, 1345/F, 1347/F, 1349/F, 1351/F, 1353/F, 1355/F, 1357/F, 1359/F, 1361/F, 1363/F, 1365/F, 1367/F, 1369/F, 1371/F, 1373/F, 1375/F, 1377/F, 1379/F, 1381/F, 1383/F, 1385/F, 1387/F, 1389/F, 1391/F, 1393/F, 1395/F, 1397/F, 1399/F, 1401/F, 1403/F, 1405/F, 1407/F, 1409/F, 1411/F, 1413/F, 1415/F, 1417/F, 1419/F, 1421/F, 1423/F, 1425/F, 1427/F, 1429/F, 1431/F, 1433/F, 1435/F, 1437/F, 1439/F, 1441/F, 1443/F, 1445/F, 1447/F, 1449/F, 1451/F, 1453/F, 1455/F, 1457/F, 1459/F, 1461/F, 1463/F, 1465/F, 1467/F, 1469/F, 1471/F, 1473/F, 1475/F, 1477/F, 1479/F, 1481/F, 1483/F, 1485/F, 1487/F, 1489/F, 1491/F, 1493/F, 1495/F, 1497/F, 1499/F, 1501/F, 1503/F, 1505/F, 1507/F, 1509/F, 1511/F, 1513/F, 1515/F, 1517/F, 1519/F, 1521/F, 1523/F, 1525/F, 1527/F, 1529/F, 1531/F, 1533/F, 1535/F, 1537/F, 1539/F, 1541/F, 1543/F, 1545/F, 1547/F, 1549/F, 1551/F, 1553/F, 1555/F, 1557/F, 1559/F, 1561/F, 1563/F, 1565/F, 1567/F, 1569/F, 1571/F, 1573/F, 1575/F, 1577/F, 1579/F, 1581/F, 1583/F, 1585/F, 1587/F, 1589/F, 1591/F, 1593/F, 1595/F, 1597/F, 1599/F, 1601/F, 1603/F, 1605/F, 1607/F, 1609/F, 1611/F, 1613/F, 1615/F, 1617/F, 1619/F, 1621/F, 1623/F, 1625/F, 1627/F, 1629/F, 1631/F, 1633/F, 1635/F, 1637/F, 1639/F, 1641/F, 1643/F, 1645/F, 1647/F, 1649/F, 1651/F, 1653/F, 1655/F, 1657/F, 1659/F, 1661/F, 1663/F, 1665/F, 1667/F, 1669/F, 1671/F, 1673/F, 1675/F, 1677/F, 1679/F, 1681/F, 1683/F, 1685/F, 1687/F, 1689/F, 1691/F, 1693/F, 1695/F, 1697/F, 1699/F, 1701/F, 1703/F, 1705/F, 1707/F, 1709/F, 1711/F, 1713/F, 1715/F, 1717/F, 1719/F, 1721/F, 1723/F, 1725/F, 1727/F, 1729/F, 1731/F, 1733/F, 1735/F, 1737/F, 1739/F, 1741/F, 1743/F, 1745/F, 1747/F, 1749/F, 1751/F, 1753/F, 1755/F, 1757/F, 1759/F, 1761/F, 1763/F, 1765/F, 1767/F, 1769/F, 1771/F, 1773/F, 1775/F, 1777/F, 1779/F, 1781/F, 1783/F, 1785/F, 1787/F, 1789/F, 1791/F, 1793/F, 1795/F, 1797/F, 1799/F, 1801/F, 1803/F, 1805/F, 1807/F, 1809/F, 1811/F, 1813/F, 1815/F, 1817/F, 1819/F, 1821/F, 1823/F, 1825/F, 1827/F, 1829/F, 1831/F, 1833/F, 1835/F, 1837/F, 1839/F, 1841/F, 1843/F, 1845/F, 1847/F, 1849/F, 1851/F, 1853/F, 1855/F, 1857/F, 1859/F, 1861/F, 1863/F, 1865/F, 1867/F, 1869/F, 1871/F, 1873/F, 1875/F, 1877/F, 1879/F, 1881/F, 1883/F, 1885/F, 1887/F, 1889/F, 1891/F, 1893/F, 1895/F, 1897/F, 1899/F, 1901/F, 1903/F, 1905/F, 1907/F, 1909/F, 1911/F, 1913/F, 1915/F, 1917/F, 1919/F, 1921/F, 1923/F, 1925/F, 1927/F, 1929/F, 1931/F, 1933/F, 1935/F, 1937/F, 1939/F, 1941/F, 1943/F, 1945/F, 1947/F, 1949/F, 1951/F, 1953/F, 1955/F, 1957/F, 1959/F, 1961/F, 1963/F, 1965/F, 1967/F, 1969/F, 1971/F, 1973/F, 1975/F, 1977/F, 1979/F, 1981/F, 1983/F, 1985/F, 1987/F, 1989/F, 1991/F, 1993/F, 1995/F, 1997/F, 1999/F, 2001/F, 2003/F, 2005/F, 2007/F, 2009/F, 2011/F, 2013/F, 2015/F, 2017/F, 2019/F, 2021/F, 2023/F, 2025/F, 2027/F, 2029/F, 2031/F, 2033/F, 2035/F, 2037/F, 2039/F, 2041/F, 2043/F, 2045/F, 2047/F, 2049/F, 2051/F, 2053/F, 2055/F, 2057/F, 2059/F, 2061/F, 2063/F, 2065/F, 2067/F, 2069/F, 2071/F, 2073/F, 2075/F, 2077/F, 2079/F, 2081/F, 2083/F, 2085/F, 2087/F, 2089/F, 2091/F, 2093/F, 2095/F, 2097/F, 2099/F, 2101/F, 2103/F, 2105/F, 2107/F, 2109/F, 2111/F, 2113/F, 2115/F, 2117/F, 2119/F, 2121/F, 2123/F, 2125/F, 2127/F, 2129/F, 2131/F, 2133/F, 2135/F, 2137/F, 2139/F, 2141/F, 2143/F, 2145/F, 2147/F, 2149/F, 2151/F, 2153/F, 2155/F, 2157/F, 2159/F, 2161/F, 2163/F, 2165/F, 2167/F, 2169/F, 2171/F, 2173/F, 2175/F, 2177/F, 2179/F, 2181/F, 2183/F, 2185/F, 2187/F, 2189/F, 2191/F, 2193/F, 2195/F, 2197/F, 2199/F, 2201/F, 2203/F, 2205/F, 2207/F, 2209/F, 2211/F, 2213/F, 2215/F, 2217/F, 2219/F, 2221/F, 2223/F, 2225/F, 2227/F, 2229/F, 2231/F, 2233/F, 2235/F, 2237/F, 2239/F, 2241/F, 2243/F, 2245/F, 2247/F, 2249/F, 2251/F, 2253/F, 2255/F, 2257/F, 2259/F, 2261/F, 2263/F, 2265/F, 2267/F, 2269/F, 2271/F, 2273/F, 2275/F, 2277/F, 2279/F, 2281/F, 2283/F, 2285/F, 2287/F, 2289/F, 2291/F, 2293/F, 2295/F, 2297/F, 2299/F, 2301/F, 2303/F, 2305/F, 2307/F, 2309/F, 2311/F, 2313/F, 2315/F, 2317/F, 2319/F, 2321/F, 2323/F, 2325/F, 2327/F, 2329/F, 2331/F, 2333/F, 2335/F, 2337/F, 2339/F, 2341/F, 2343/F, 2345/F, 2347/F, 2349/F, 2351/F, 2353/F, 2355/F, 2357/F, 2359/F, 2361/F, 2363/F, 2365/F, 2367/F, 2369/F, 2371/F, 2373/F, 2375/F, 2377/F, 2379/F, 2381/F, 2383/F, 2385/F, 2387/F, 2389/F, 2391/F, 2393/F, 2395/F, 2397/F, 2399/F, 2401/F, 2403/F, 2405/F, 2407/F, 2409/F, 2411/F, 2413/F, 2415/F, 2417/F, 2419/F, 2421/F, 2423/F, 2425/F, 2427/F, 2429/F, 2431/F, 2433/F, 2435/F, 2437/F, 2439/F, 2441/F, 2443/F, 2445/F, 2447/F, 2449/F, 2451/F, 2453/F, 2455/F, 2457/F, 2459/F, 2461/F, 2463/F, 2465/F, 2467/F, 2469/F, 2471/F, 2473/F, 2475/F, 2477/F, 2479/F, 2481/F, 2483/F, 2485/F, 2487/F, 2489/F, 2491/F, 2493/F, 2495/F, 2497/F, 2499/F, 2501/F, 2503/F, 2505/F, 2507/F, 2509/F, 2511/F, 2513/F, 2515/F, 2517/F, 2519/F, 2521/F, 2523/F, 2525/F, 2527/F, 2529/F, 2531/F, 2533/F, 2535/F, 2537/F, 2539/F, 2541/F, 2543/F, 2545/F, 2547/F, 2549/F, 2551/F, 2553/F, 2555/F, 2557/F, 2559/F, 2561/F, 2563/F, 2565/F, 2567/F, 2569/F, 2571/F, 2573/F, 2575/F, 2577/F, 2579/F, 2581/F, 2583/F, 2585/F, 2587/F, 2589/F, 2591/F, 2593/F, 2595/F, 2597/F, 2599/F, 2601/F, 2603/F, 2605/F, 2607/F, 2609/F, 2611/F, 2613/F, 2615/F, 2617/F, 2619/F, 2621/F, 2623/F, 2625/F, 2627/F, 2629/F, 2631/F, 2633/F, 2635/F, 2637/F, 2639/F, 2641/F, 2643/F, 2645/F, 2647/F, 2649/F, 2651/F, 2653/F, 2655/F, 2657/F, 2659/F, 2661/F, 2663/F, 2665/F, 2667/F, 2669/F, 2671/F, 2673/F, 2675/F, 2677/F, 2679/F, 2681/F, 2683/F, 2685/F, 2687/F, 2689/F, 2691/F, 2693/F, 2695/F, 2697/F, 2699/F, 2701/F, 2703/F, 2705/F, 2707/F, 2709/F, 2711/F, 2713/F, 2715/F, 2717/F, 2719/F, 2721/F, 2723/F, 2725/F, 2727/F, 2729/F, 2731/F, 2733/F, 2735/F, 2737/F, 2739/F, 2741/F, 2743/F, 2745/F, 2747/F, 2749/F, 2751/F, 2753/F, 2755/F, 2757/F, 2759/F, 2761/F, 2763/F, 2765/F, 2767/F, 2769/F, 2771/F, 2773/F, 2775/F, 2777/F, 2779/F, 2781/F, 2783/F, 2785/F, 2787/F, 2789/F, 2791/F, 2793/F, 2795/F, 2797/F, 2799/F, 2801/F, 2803/F, 2805/F, 2807/F, 2809/F, 2811/F, 2813/F, 2815/F, 2817/F, 2819/F, 2821/F, 2823/F, 2825/F, 2827/F, 2829/F, 2831/F, 2833/F, 2835/F, 2837/F, 2839/F, 2841/F, 2843/F, 2845/F, 2847/F, 2849/F, 2851/F, 2853/F, 2855/F, 2857/F, 2859/F, 2861/F, 2863/F, 2865/F, 2867/F, 2869/F, 2871/F, 2873/F, 2875/F, 2877/F, 2879/F, 2881/F, 2883/F, 2885/F, 2887/F, 2889/F, 2891/F, 2893/F, 2895/F, 2897/F, 2899/F, 2901/F, 2903/F, 2905/F, 2907/F, 2909/F, 2911/F, 2913/F, 2915/F, 2917/F, 2919/F, 2921/F, 2923/F, 2925/F, 2927/F, 2929/F, 2931/F, 2933/F, 2935/F, 2937/F, 2939/F, 2941/F, 2943/F, 2945/F, 2947/F, 2949/F, 2951/F, 2953/F, 2955/F, 2957/F, 2959/F, 2961/F, 2963/F, 2965/F, 2967/F, 2969/F, 2971/F, 2973/F, 2975/F, 2977/F, 2979/F, 2981/F, 2983/F, 2985/F, 2987/F, 2989/F, 2991/F, 2993/F, 2995/F, 2997/F, 2999/F, 3001/F, 3003/F, 3005/F, 3007/F, 3009/F, 3011/F, 3013/F, 3015/F, 3017/F, 3019/F, 3021/F, 3023/F, 3025/F, 3027/F, 3029/F, 3031/F, 3033/F, 3035/F, 3037/F, 3039/F, 3041/F, 3043/F, 3045/F, 3047/F, 3049/F, 3051/F, 3053/F, 3055/F, 3057/F, 3059/F, 3061/F, 3063/F, 3065/F, 3067/F, 3069/F, 3071/F, 3073/F, 3075/F, 3077/F, 3079/F, 3081/F, 3083/F, 3085/F, 3087/F, 3089/F, 3091/F, 3093/F, 3095/F, 3097/F, 3099/F, 3101/F, 3103/F, 3105/F, 3107/F, 3109/F, 3111/F, 3113/F, 3115/F, 3117/F, 3119/F, 3121/F, 3123/F, 3125/F, 3127/F, 3129/F, 3131/F, 3133/F, 3135/F, 3137/F, 3139/F

**From:** "Marina TONG [RLPHK]" <marinatong@rlp.asia>  
**To:** "jason.lcs.midi@gmail.com" <jason.lcs.midi@gmail.com>  
**Copies to:** "Florence CHEUNG [RLPHK]" <florencecheung@rlp.asia>,  
"Ginny CHAU [RLPHK]" <ginnychau@rlp.asia>,  
"Wallace NG [RLPHK]" <wallaceng@rlp.asia>,  
RLP Project  
email - 3931 <p19084@rlphk.com>,  
Andy Chan Yan Wai <andywchan@sino.com>,  
Herbert Thung - Sino <herbertthung@sino.com>,  
"michael.nwp.midi@gmail.com" <michael.nwp.midi@gmail.com>,  
"ant.ysy.midi@gmail.com" <ant.ysy.midi@gmail.com>,  
"midi@midiltd.com.hk" <midi@midiltd.com.hk>  
**Subject:** Lohas P11 - Rectification of Curtain Wall Window Division between 2 Flats  
**Date sent:** Mon, 21 Nov 2022 03:37:07 +0000

Dear Jason (Midi),

劉新通知

As per our discussion with Herbert, attached please find the confirmed rectification proposal for your shop drawing revision. Please kindly advise how this may affect the current curtain wall installation on site of T1. Thank you.

Regards,  
Marina Tong  
T: 3189 9252

**From:** Marina TONG [RLPHK]  
**Sent:** Monday, 21 November 2022 11:20 am  
**To:** Herbert Thung - Sino <herbertthung@sino.com>  
**Cc:** Florence CHEUNG [RLPHK] <florencecheung@rlphk.com>; Ginny CHAU [RLPHK] <ginnychau@rlp.asia>; Wallace NG [RLPHK] <wallaceng@rlp.asia>; RLP Project email - 3931 <p19084@rlphk.com>; Andy Chan Yan Wai <andywchan@sino.com>  
**Subject:** Lohas P11 - Rectification of Curtain Wall Window Division between 2 Flats

Dear Herbert,

Regarding the curtain wall mullion setting-out discrepancy found between sales brochure and curtain wall shop drawing, attached please find the rectification proposal for the 4 concerned areas. Please kindly review and comment for our onward coordination with Midi. Thank you.

Regards,  
Marina Tong  
T: 3189 9252

Print only when it's necessary: each ream of A4 paper has an average lifecycle carbon footprint of 2.32kg CO2e, which is equivalent to charging your smartphone 282 times.

---

This e-mail (including its attachment(s) (if any)) is confidential and may be legally privileged. If you are not the intended recipient(s), you must not use, retain, disclose, copy, print, forward or disseminate this e-mail or its attachment(s) (if any). If you have received this e-mail by mistake, please notify us by e-mail or telephone immediately and delete it from your system.

E-mail transmission cannot be guaranteed to be completely secure or error free as information could have been intercepted, corrupted, lost, destroyed or incomplete. Any electronically transmitted advice or opinion, unless

**Lohas P11 - Rectification of Curtain Wall Window Division between 2 Flats**

21 Nov 2022

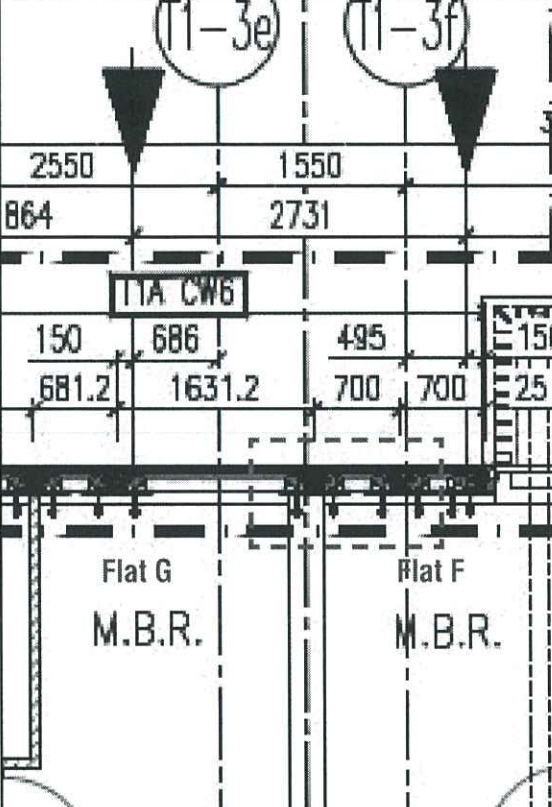
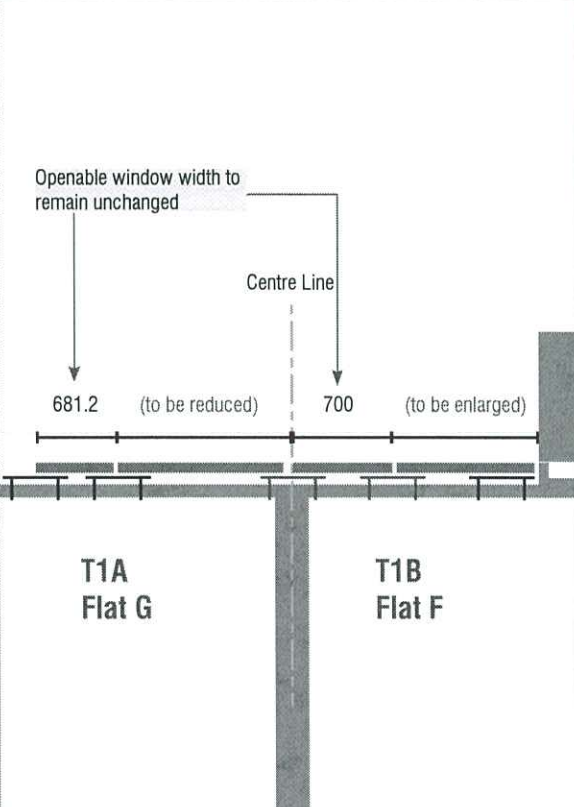
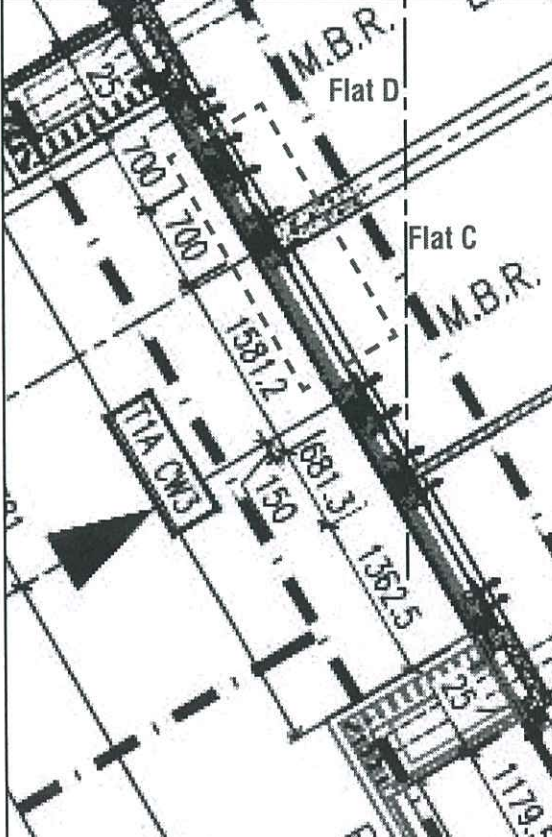
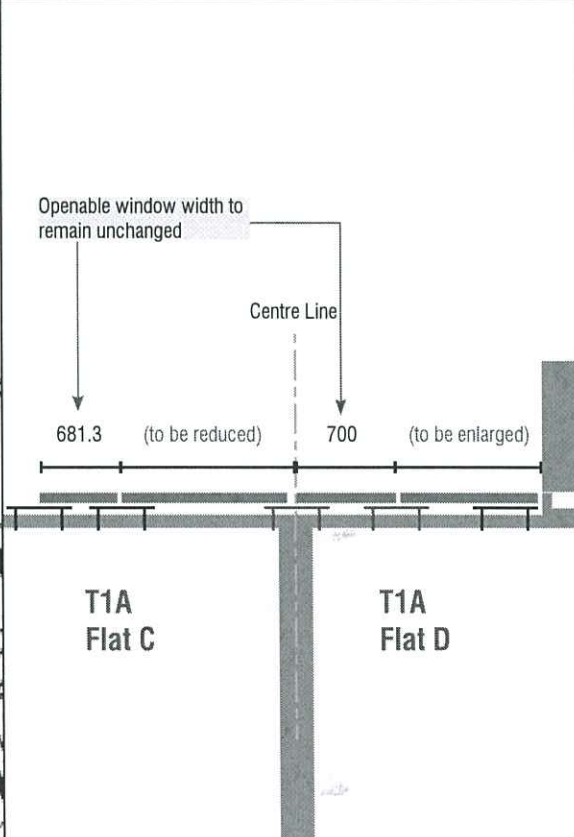
| Location                   | Shop Drawing  | Rectification  |
|----------------------------|---|--|
| T1A Flat G &<br>T1B Flat F |  <p>Shop drawing showing window dimensions for T1A Flat G and T1B Flat F. Key dimensions include 2550, 1550, 864, 2731, 150, 686, 495, 150, 681.2, 1631.2, 700, 700, 25. Labels include T1-3e, T1-3f, T1A CW6, Flat G M.B.R., and Flat F M.B.R.</p> |  <p>Rectification diagram for T1A Flat G and T1B Flat F. It shows the openable window width to remain unchanged, the center line, and the required adjustments: 681.2 (to be reduced) and 700 (to be enlarged).</p> |
| T1A Flat C &<br>Flat D     |  <p>Shop drawing showing window dimensions for T1A Flat C and Flat D. Key dimensions include 2550, 700, 700, 1581.2, 150, 681.3, 150, 1382.5, 25, 1179.5. Labels include T1A CW5, Flat C M.B.R., and Flat D M.B.R.</p>                             |  <p>Rectification diagram for T1A Flat C and Flat D. It shows the openable window width to remain unchanged, the center line, and the required adjustments: 681.3 (to be reduced) and 700 (to be enlarged).</p>    |

**Lohas P11 - Rectification of Curtain Wall Window Division between 2 Flats**

21 Nov 2022

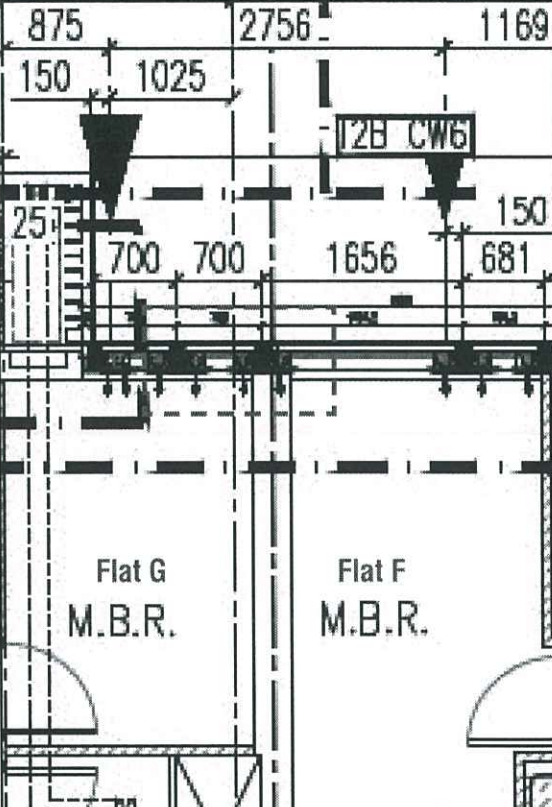
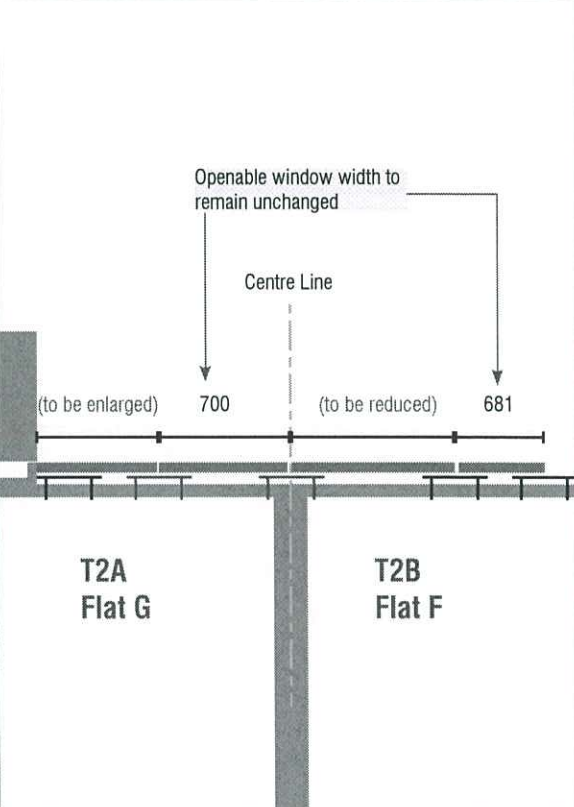
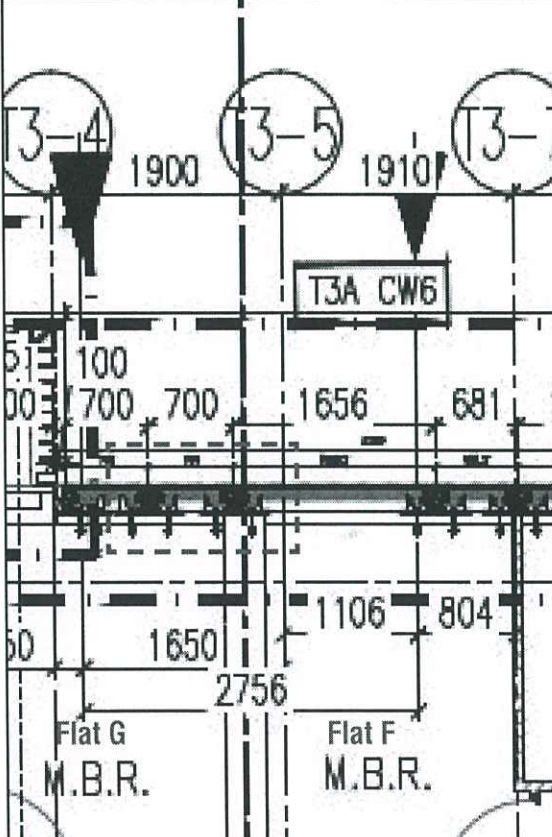
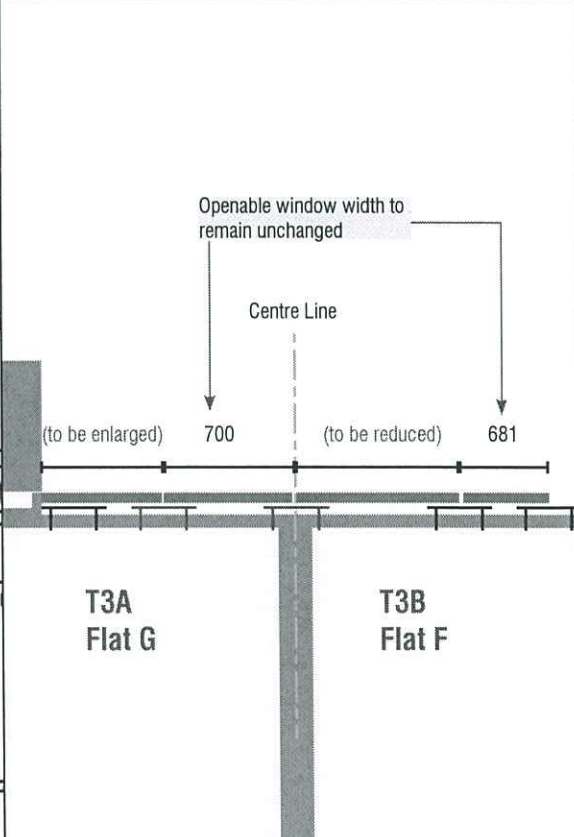
| Location                | Shop Drawing  | Rectification  |
|-------------------------|---|--|
| T2A Flat G & T2B Flat F |  <p>Shop drawing details for T2A Flat G and T2B Flat F. Dimensions include: 875, 2756, 1169, 150, 1025, 12B CW6, 25, 700, 700, 1656, 681, 150. Labels include Flat G M.B.R. and Flat F M.B.R.</p>                         |  <p>Rectification diagram for T2A Flat G and T2B Flat F. It shows a horizontal line representing the window division with a vertical dashed 'Centre Line'. The left side is labeled '(to be enlarged)' with a dimension of 700. The right side is labeled '(to be reduced)' with a dimension of 681. A bracket above the line indicates 'Openable window width to remain unchanged'.</p>  |
| T3A Flat G & T3B Flat F |  <p>Shop drawing details for T3A Flat G and T3B Flat F. Dimensions include: 1900, 1910, 13-4, 13-5, 13-7, 51, 100, 700, 700, 1656, 681, 1, 50, 1650, 2756, 1106, 804. Labels include Flat G M.B.R. and Flat F M.B.R.</p> |  <p>Rectification diagram for T3A Flat G and T3B Flat F. It shows a horizontal line representing the window division with a vertical dashed 'Centre Line'. The left side is labeled '(to be enlarged)' with a dimension of 700. The right side is labeled '(to be reduced)' with a dimension of 681. A bracket above the line indicates 'Openable window width to remain unchanged'.</p> |



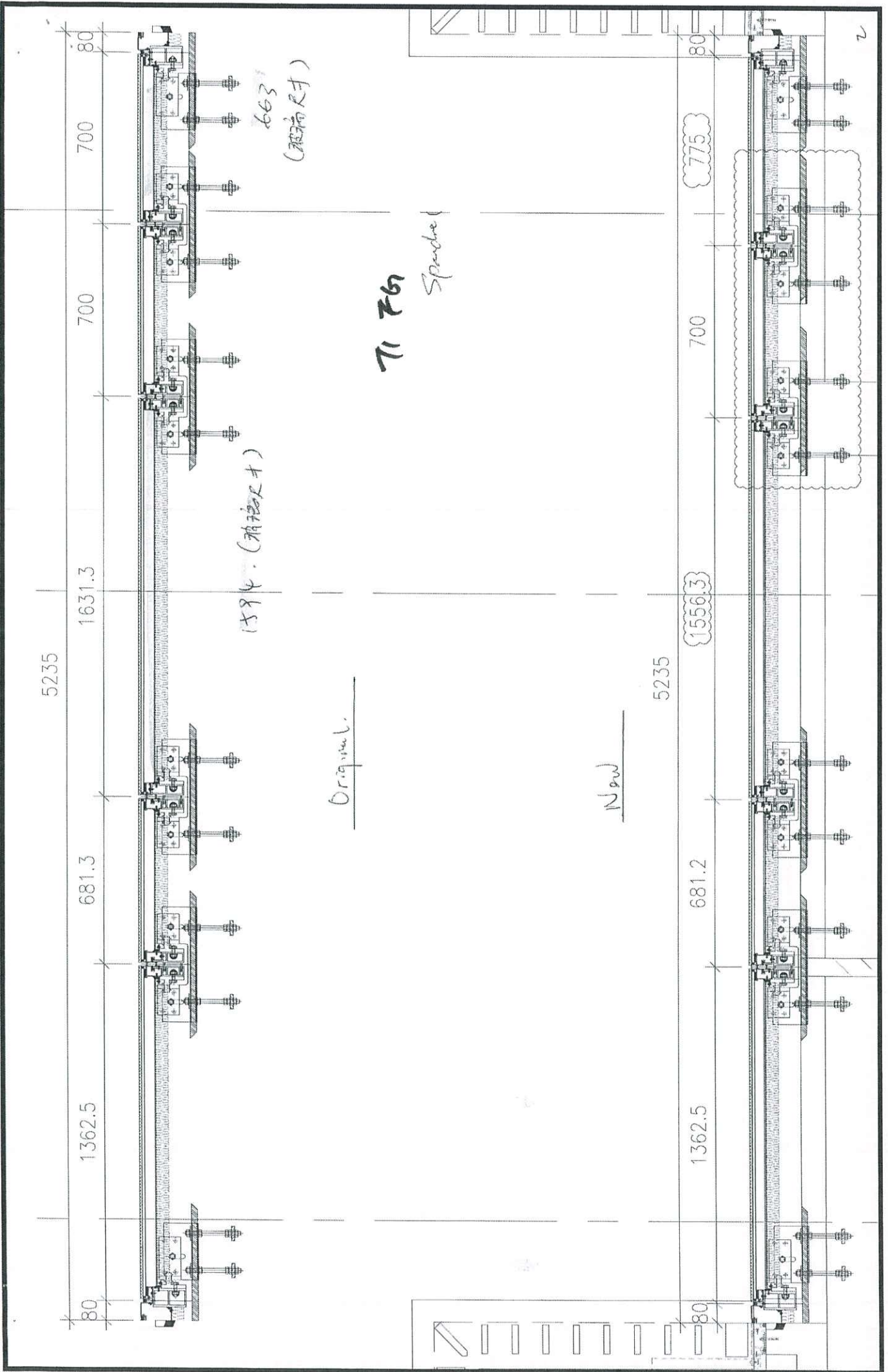

TICD  
Vision

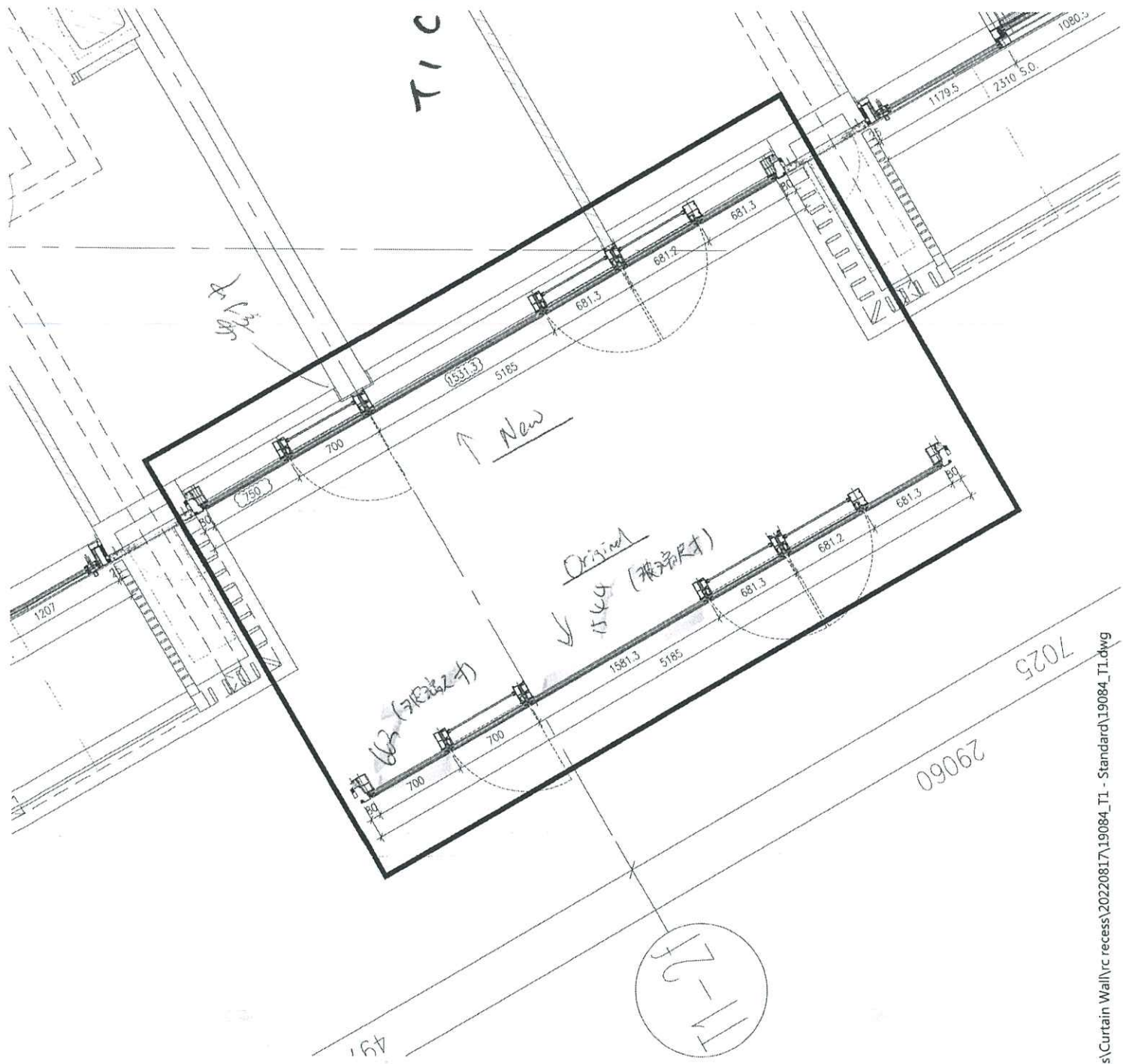

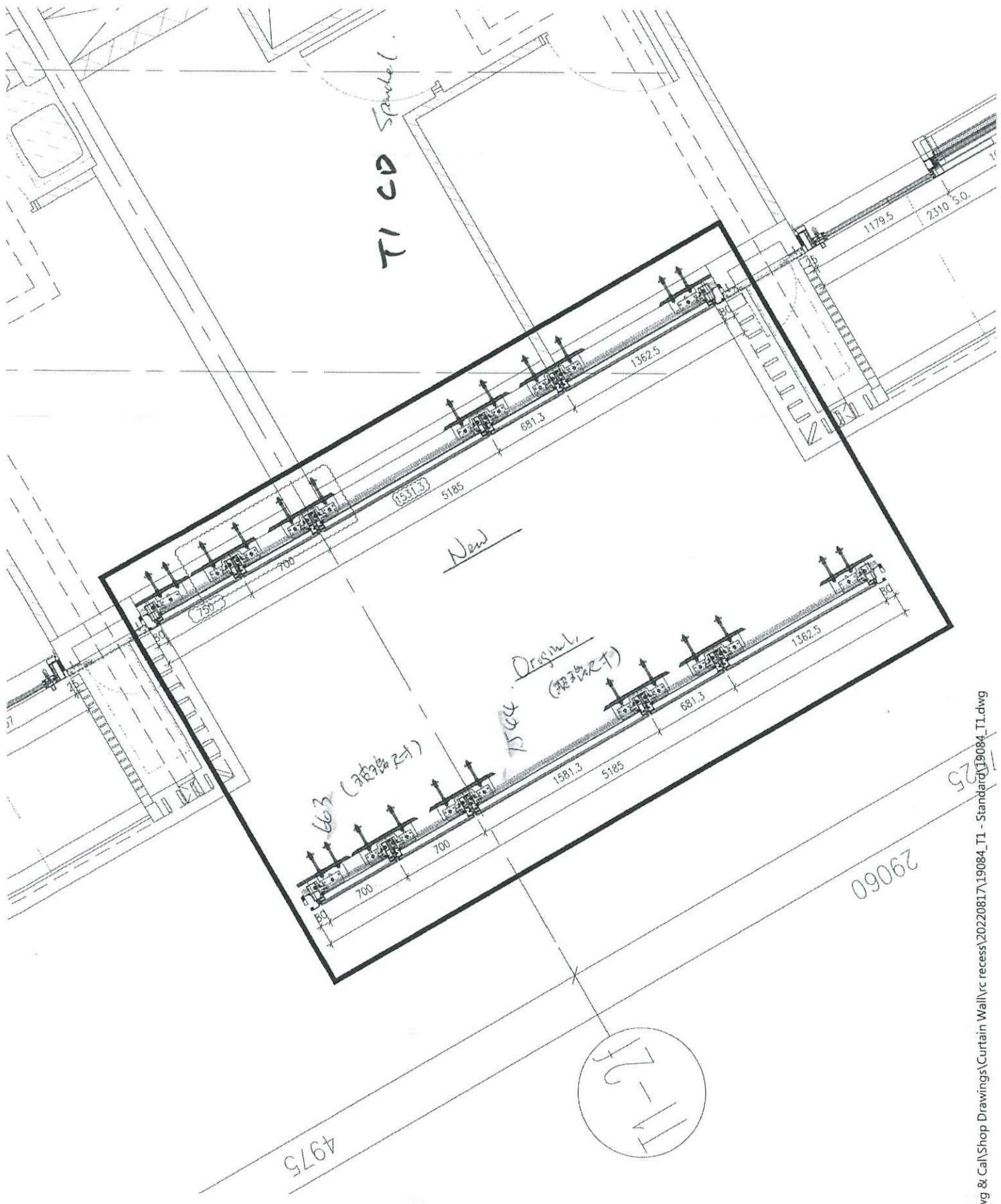

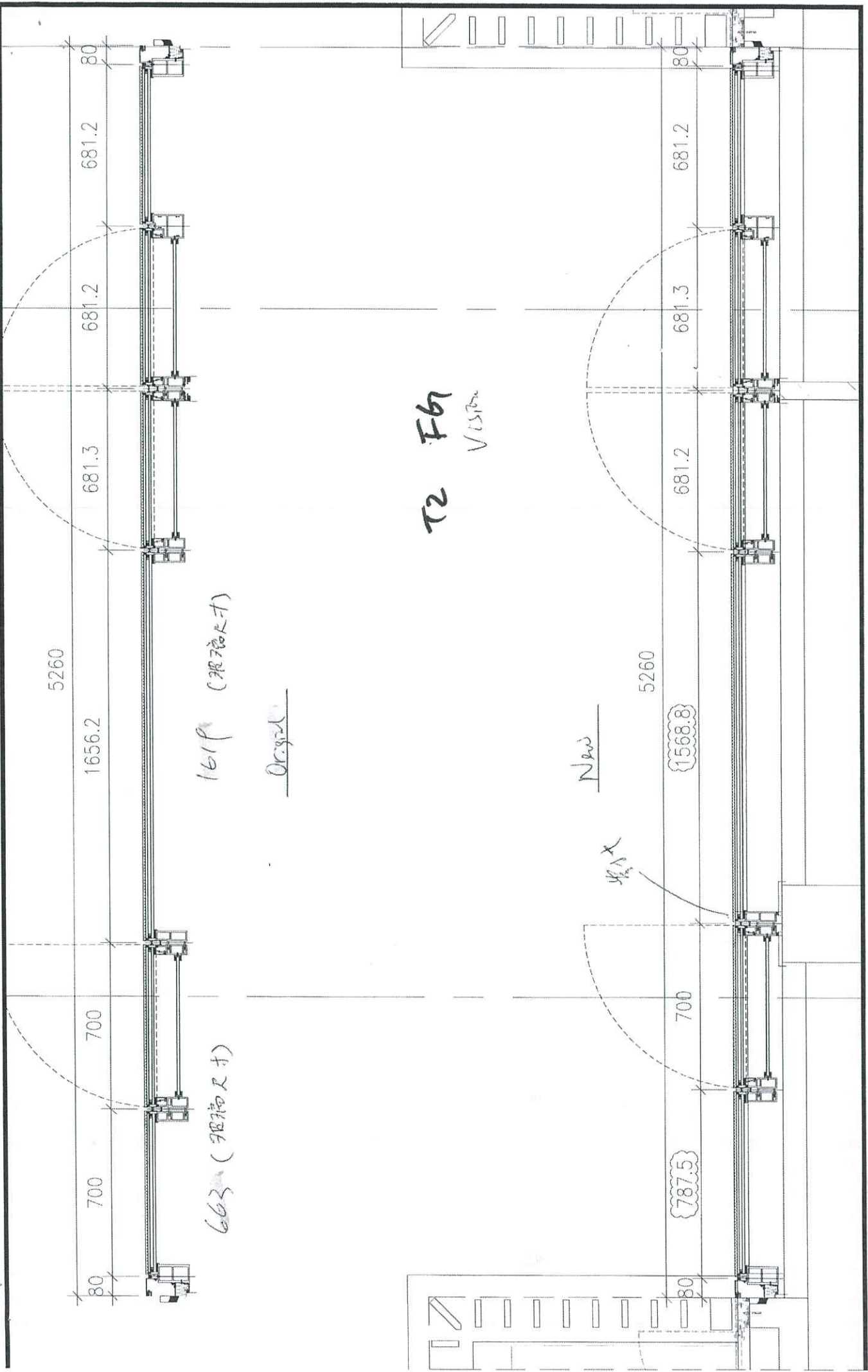

663 (根据尺寸)

1619 (根据尺寸)

Original

T2 F67  
V1570

New

修改

5260

1656.2

700

700

681.2

681.2

681.3

80

5260

1568.8

700

787.5

681.2

681.3

681.2

80

