

工程指示 / 要求簡箋(E.I.)

工程指示編號：EI / 5119 / 24

修改版次：H

工程編號：J - 858

工程名稱：將軍澳日出康城 11

工程項目：Glass Cladding 地盆用配件 (加訂特色層及后各款)

收件人：林哥

發件人：Ant Yeung

日期：21/06/2024

要求提供 / 確認 事項：

- |                                    |                                     |                               |
|------------------------------------|-------------------------------------|-------------------------------|
| <input type="checkbox"/> 初步鋁料 B.M. | <input type="checkbox"/> 加工拆圖，然後生產  | <input type="checkbox"/> 尺寸表  |
| <input type="checkbox"/> 正式鋁料 B.M. | <input type="checkbox"/> 技術上資料 / 指示 | <input type="checkbox"/> 報價   |
| <input type="checkbox"/> 配件 B.M.   | <input type="checkbox"/> 樣辦或貨品說明書   | <input type="checkbox"/> 分判合約 |

內容：

H: 加訂 SU 尾數及後備數，加訂#2 M5.5 x25mm 六角頭自鑽 2400 粒 及  
加訂#3 M6.3 x25mm M6.3 x25mm 圓頭自鑽 400 粒

G: 加訂尾數，增加 #6 M8 x 85 六角頭螺栓配 1 平 1 彈 1 螺帽 1500 粒。

F: 按判頭在船工作需要，六角頭自鑽 能減少掉失螺絲地盆所需增加。未出貨的改做六角頭。  
已出貨的不改

E: 按地盆所需增加， #3 加訂 3000 粒 / #4a (80 長) 加訂 2000 粒

E: 拆圖部：請全面覆核 Glass cladding 配件 BM 用量

D: 早前 拉爆 M10 只訂一半數量 90mm 長，現用 M10 x 110 mm 長，放行餘數 (新增#5a)  
拉爆 M10 總用量為 14600 粒

D: M8 x 75mm 露牙不足需要 M8 x 85mm (新增#4a) (優先數量 400 粒)

謝謝

請在 2024.07.02 前完成上列要求。

附： 頁

原合約工程包

原合約工程加 / 減賬

新工程報價

分發東莞各部門：

- |                                 |                              |                                |                              |                               |                              |                                |                              |
|---------------------------------|------------------------------|--------------------------------|------------------------------|-------------------------------|------------------------------|--------------------------------|------------------------------|
| <input type="checkbox"/> 生產技術總監 | <input type="checkbox"/> 連附件 | <input type="checkbox"/> 技術部   | <input type="checkbox"/> 連附件 | <input type="checkbox"/> 生產部  | <input type="checkbox"/> 連附件 | <input type="checkbox"/> 機械設計部 | <input type="checkbox"/> 連附件 |
| <input type="checkbox"/> 採購部    | <input type="checkbox"/> 連附件 | <input type="checkbox"/> 生產統籌部 | <input type="checkbox"/> 連附件 | <input type="checkbox"/> 小羅&清 | <input type="checkbox"/> 連附件 |                                |                              |
| <input type="checkbox"/> 質檢部    | <input type="checkbox"/> 連附件 | <input type="checkbox"/> 會計部   | <input type="checkbox"/> 連附件 | <input type="checkbox"/> 報關組  | <input type="checkbox"/> 連附件 | <input type="checkbox"/> 其他    | <input type="checkbox"/> 連附件 |

分發香港各部門：

- |                              |                              |                               |                              |   |   |                                  |                              |    |
|------------------------------|------------------------------|-------------------------------|------------------------------|---|---|----------------------------------|------------------------------|----|
| <input type="checkbox"/> 行政部 | <input type="checkbox"/> 連附件 | <input type="checkbox"/> 會計部  | <input type="checkbox"/> 連附件 | <input checked="" type="checkbox"/> 統籌部 | <input checked="" type="checkbox"/> 連附件 | <input type="checkbox"/> 工程部地盤科文 | <input type="checkbox"/> 連附件 | 積哥 |
| <input type="checkbox"/> 採購部 | <input type="checkbox"/> 連附件 | <input type="checkbox"/> QS 部 | <input type="checkbox"/> 連附件 | <input type="checkbox"/> 維修部            | <input type="checkbox"/> 連附件            | <input type="checkbox"/> 其他      | <input type="checkbox"/> 連附件 |    |

傳遞編號：

HK / 24

發件人簽署：

項目經理簽署：

 美特鋁質有限公司 MIDI Aluminium Fabricator Ltd.	工程號:	J-858	計算:	WCM	日期:	20/2/2024	送呈:	Jason哥
	地盤名稱:	康城11期	核對:		日期:		副本:	
地盤用配件B.M.表	項目類別:	Glass Cladding单元	批准:		日期:			
BM編號:	A/C Code : EI 5119 H						此BM依據第7版施工圖大樣計算	

序號	修改標示	配件圖號	物料編號	配件名稱	顏色	實用	後備	總數	單位	備注
1				M5 x20mm圓頭機絲	SS 316	18704	296	19000	粒	修Glass Cladding 橫向鐵槽上下螺絲用
2	H 增加	未出貨地盆改做六角頭		M5.5 x25mm六角頭自鑽	SS 316	21974	526	22500	粒	修Glass Cladding 企身边框修向錢件
2A	H 增加			M6.3 x25mm圓頭自鑽	SS 316	11034	466	11500	粒	修Glass Cladding 橫身边框修向錢件
3	E 增加	牙長=全牙	M8x30 mm	六角頭螺栓配1平1彈1螺帽	A4-70	16918	82	17000	粒	修Glass Cladding 企向鐵碼與牆身鐵碼, 修鐵件接駁片
4		牙長=全牙	M8x75mm	六角頭螺栓配1平1彈1螺帽	A4-70	1964	36	2000	粒	修Glass Cladding 企向鐵槽與牆身鐵碼, 修鐵件接駁片
5	已訂	避免石矢出入	M10x90mm	拉爆螺絲 (Hilti HST3-R)	不秀鋼	7270	30	7300	粒	修Glass Cladding 牆身鐵碼, 間距850C/C
5a	D 新增		M10x110mm	拉爆螺絲 (Hilti HST3-R)	不秀鋼	7270	30	7300	粒	修Glass Cladding 牆身鐵碼, 間距850C/C
4a	E 增加/更正長度	牙長=全牙	M8x80mm	六角頭螺栓配1平1彈1螺帽	A4-70	3964	36	4000	粒	修Glass Cladding 企向鐵槽與牆身鐵碼, 修鐵件接駁片
6	G 新增	牙長=全牙	M8x85mm	六角頭螺栓配1平1彈1螺帽	A4-70	1500	0	1500	粒	修Glass Cladding 企向鐵槽與牆身鐵碼, 修鐵件接駁片

T1							
	W	H	M6 (横)	M5 (企)	(件)		
GC-01	592	2331	4	17	88	352	1496
GC-02	592	300	4	4	46	184	184
GC-03	592	640	4	4	92	368	368
GC-04	592	2345	4	17	4	16	68
GC-05	592	2531	4	17	2	8	34
GC-06	592	587.5	4	4	2	8	8
GC-07	592	265	4	4	46	184	184
GC-08	773	2395	4	17	44	176	748
GC-09	773	841	4	8	35	140	280
GC-10	773	2345	4	17	2	8	34
GC-11	773	265	4	4	11	44	44
GC-12	773	576	4	4	11	44	44
GC-13	773	2595	4	17	1	4	17
GC-14	773	587.5	4	4	1	4	4
GC-15	798	2331	6	17	88	528	1496
GC-16	798	905	6	6	70	420	420
GC-17	798	2345	6	17	4	24	68
GC-18	1262	230	6	4	11	66	44
GC-19	798	640	6	4	11	66	44
GC-20	798	2595	6	17	3	18	51
GC-21	798	587.5	6	4	2	12	8
GC-22	1152	265	6	4	12	72	48
GC-23	1152	270	6	4	12	72	48
GC-24	798	370	6	4	12	72	48
GC-25	596.5	2395	4	17	88	352	1496
GC-26	596.5	905	4	6	70	280	420
GC-27	596.5	370	4	4	24	96	96
GC-28	596.5	2345	4	17	4	16	68
GC-29	596.5	265	4	4	12	48	48
GC-30	596.5	270	4	4	12	48	48
GC-31	877	265	6	4	12	72	48
GC-32	877	270	6	4	12	72	48
GC-33	596.5	2595	4	17	4	16	68
GC-34	596.5	587.5	4	4	2	8	8
GC-35	1043	2395	6	17	44	264	748
GC-36	1043	905	6	6	35	210	210
GC-37	1043	311	6	4	12	72	48
GC-38	1043	2281	6	17	2	12	34
GC-39	1190	265	6	4	12	72	48
GC-40	1190	270	6	4	12	72	48
GC-41	1043	2595	6	17	2	12	34
GC-42	1043	587.5	6	4	1	6	4
						4618	9310
						M6 (横)	M5 (企)

T2							
	W	H	M6 (横)	M5 (企)	(件)		
GC-01	592	2331	4	17	96	384	1632
GC-02	592	265	4	4	50	200	200
GC-03	592	640	4	4	100	400	400
GC-04	592	2345	4	17	4	16	68
GC-05	592	2531	4	17	2	8	34
GC-06	592	587.5	4	4	2	8	8
GC-07	592	265	4	4	50	200	200
GC-08	773	2395	4	17	48	192	816
GC-09	773	841	4	8	38	152	304
GC-10	773	2345	4	17	2	8	34
GC-11	773	265	4	4	12	48	48
GC-12	773	576	4	4	12	48	48
GC-13	773	2595	4	17	1	4	17
GC-14	773	587.5	4	4	1	4	4
GC-15	798	2331	6	17	48	288	816
GC-16	798	905	6	6	38	228	228
GC-17	798	2345	6	17	2	12	34
GC-18	1262	230	6	4	12	72	48
GC-19	798	640	6	4	12	72	48
GC-20	798	2595	6	17	1	6	17
GC-21	798	587.5	6	4	1	6	4
GC-43	823	2395	6	17	48	288	816
GC-44	823	905	6	6	38	228	228
GC-45	823	311	6	4	13	78	52
GC-46	823	2345	6	17	2	12	34
GC-47	1287	265	6	4	13	78	52
GC-48	1287	265	6	4	13	78	52
GC-49	823	2595	6	17	2	12	34
GC-50	823	528.5	6	4	1	6	4
						3136	6280
						M6 (横)	M5 (企)

T3							
	W	H	M6 (横)	M5 (企)	(件)		
GC-01	592	2331	4	17	96	384	1632
GC-02	592	265	4	4	50	200	200
GC-03	592	640	4	4	100	400	400
GC-04	592	2345	4	17	4	16	68
GC-05	592	2531	4	17	2	8	34
GC-06	592	587.5	4	4	2	8	8
GC-07	592	265	4	4	50	200	200
GC-08	773	2395	4	17	48	192	816
GC-09	773	841	4	8	38	152	304
GC-10	773	2345	4	17	2	8	34
GC-11	773	265	4	4	12	48	48
GC-12	773	576	4	4	12	48	48
GC-13	773	2595	4	17	1	4	17
GC-14	773	587.5	4	4	1	4	4
GC-15	798	2331	6	17	96	576	1632
GC-16	798	905	6	6	76	456	456
GC-17	798	2345	6	17	4	24	68
GC-18	1262	230	6	4	12	72	48
GC-19	798	640	5	4	12	60	48
GC-20	798	2595	6	17	3	18	51
GC-21	798	587.5	6	4	2	12	8
GC-24	798	370	6	4	13	78	52
GC-51	871.5	265	6	4	13	78	52
GC-52	871.5	265	6	4	13	78	52
GC-53	825	265	6	4	13	78	52
GC-54	885	265	6	4	13	78	52
						3280	6384
						M6 (横)	M5 (企)

	Total
M6 (横)	11034
M5 (企)	21974

ITEM No.	FASTENER DIAGRAM	DESCRIPTION
F01		ST6.3x38mm LG. PAN HEAD SELF TAPPING SCREW STAINLESS STEEL GR. A4-70 (FACTORY)
F02		ST6.3x50mm LG. PAN HEAD SELF TAPPING SCREW STAINLESS STEEL GR. A4-70 (FACTORY)
F03		ST4.2x12mm LG. PAN HEAD SELF TAPPING SCREW STAINLESS STEEL GR. A4-70 (FACTORY)
F04		M10x20mm LG. FLAT HEAD MACHINE SCREW STAINLESS STEEL GR. A4-70 (FACTORY)
F05		M4x16mm LG. PAN HEAD MACHINE SCREW STAINLESS STEEL GR. A4-70 (FACTORY)
F06		ST4.2x25mm LG. PAN HEAD SELF TAPPING SCREW STAINLESS STEEL GR. A4-70 (FACTORY)
F07		M5x15mm LG. PAN HEAD MACHINE SCREW STAINLESS STEEL GR. A4-70 (FACTORY)
F08		M5x20mm LG. PAN HEAD MACHINE SCREW STAINLESS STEEL GR. A4-70 (FACTORY)
F09		M12x45mm LG. HEX HEAD BOLT c/w NUT & SPRING WASHER STAINLESS STEEL GR. A4-70 (FACTORY)
F10		M16x75mm LG. HEX HEAD BOLT c/w NUT & SPRING WASHER STAINLESS STEEL GR. 8.8 (FACTORY)
F11		M5x25 S.S. SELF-TAPPING SCREW W./PLASTIC PLUG (SITE)
F12		M10x30mm LG. PAN HEAD MACHINE SCREW STAINLESS STEEL GR. A4-70 (FACTORY)
F13		ST4.8x12mm LG. PAN HEAD SELF DRILL SCREW STAINLESS STEEL GR. A4-70 (SITE)
F14		ST4.8x12mm LG. PAN HEAD SELF TAPPING SCREW STAINLESS STEEL GR. A4-70 (FACTORY)

ITEM No.	FASTENER DIAGRAM	DESCRIPTION
F15		ST6.3x32mm LG. FLAT HEAD SELF TAPPING SCREW STAINLESS STEEL GR. A4-70 (FACTORY)
F16		M8x75mm LG. HEX HEAD BOLT c/w NUT & SPRING WASHER STAINLESS STEEL GR. A4-70 (SITE)
F17		M5x35mm LG. PAN HEAD MACHINE SCREW STAINLESS STEEL GR. A4-70 (FACTORY)
F18		M5x20mm LG. FLAT HEAD MACHINE SCREW STAINLESS STEEL GR. A4-70 (FACTORY)
F19		M5x30mm LG. PAN HEAD MACHINE SCREW STAINLESS STEEL GR. A4-70 (FACTORY)
F20		M5x10mm LG. FLAT HEAD MACHINE SCREW STAINLESS STEEL GR. A4-70 (FACTORY)
F21		M5x12mm LG. FLAT HEAD MACHINE SCREW STAINLESS STEEL GR. A4-70 (FACTORY)
F22		M5x15mm LG. PAN HEAD MACHINE SCREW STAINLESS STEEL GR. A4-70 (FACTORY)
F23		M5x12mm LG. PAN HEAD MACHINE SCREW STAINLESS STEEL GR. A4-70 (FACTORY)
F24		M5x16mm LG. PAN HEAD MACHINE SCREW STAINLESS STEEL GR. A4-70 (FACTORY)
F25		ST4.8x15mm LG. PAN HEAD SELF DRILL SCREW STAINLESS STEEL GR. A4-70 (SITE)
F26		M5x25mm LG. PAN HEAD MACHINE SCREW STAINLESS STEEL GR. A4-70 (FACTORY)
F27		ST5.5x25mm LG. HEX HEAD SELF DRILL SCREW STAINLESS STEEL GR. A4-70 (SITE)
F09A		M12x80mm LG. HEX HEAD BOLT c/w NUT & SPRING WASHER STAINLESS STEEL GR. A4-70 (FACTORY)

ITEM No.	FASTENER DIAGRAM	DESCRIPTION
F51		ST5.5x19mm LG. PAN HEAD SELF DRILL SCREW STAINLESS STEEL GR. A4-70 (SITE)
F52		ST5.5x15mm LG. HEX HEAD SELF DRILL SCREW STAINLESS STEEL GR. A4-70 (SITE)
F53		M6x100mm LG. HEX HEAD BOLT c/w NUT & SPRING WASHER STAINLESS STEEL GR. A4-70 (SITE)
F54		M16x60mm LG. HEX HEAD BOLT GR. 8.8 (SITE)
F55		M12x45mm LG. HEX HEAD BOLT c/w NUT & SPRING WASHER STAINLESS STEEL GR. A4-70 (SITE)
F56		M5x15mm LG. PAN HEAD MACHINE SCREW STAINLESS STEEL GR. A4-70 (SITE)
F57		M6x15mm LG. PAN HEAD MACHINE SCREW STAINLESS STEEL GR. A4-70 (SITE)
F58		#14x25mm LG. PAN HEAD SELF TAPPING SCREW STAINLESS STEEL GR. A4-70 (FACTORY)
F59		M8x25mm LG. HEX HEAD BOLT c/w NUT & SPRING WASHER STAINLESS STEEL GR. A4-70 (SITE)
Z001		METAL PIN FOR INSULATION MATERIAL: GALVANISED STEEL COLOR: SILVER
F28		M5x10mm LG. PAN HEAD MACHINE SCREW STAINLESS STEEL GR. A4-70

ITEM No.	FASTENER DIAGRAM	DESCRIPTION
FA01		M6 ALUM. STUD BOLT : AW-5754[Al Mg3] NUT : GR. A4-80 1-SPRING WASHER : GR. A4 1-FLAT WASHER : GR. A4 (FACTORY)
FA02		M10x90mm LG. HILTI ANCHOR BOLT STAINLESS STEEL GR. A4 (SITE)
FA03		M16x140mm LG. HILTI ANCHOR BOLT STAINLESS STEEL GR. A4 (SITE)
HA01		HILTI HAK 700 CAST-IN CHANNEL (L=450) (SITE)
HA02		HILTI HAK 700 CAST-IN CHANNEL (L=350) (SITE)
HA03		HILTI HAK 700 CAST-IN CHANNEL (L=350) (SITE)
F61		M6x25mm LG. PAN HEAD SELF DRILL SCREW STAINLESS STEEL GR. A4-70 (SITE)

**Glass Cladding 橫向  
用圓頭M6.3x25mm**

**Glass Cladding  
企向  
用M5.5x25mm  
六角頭白鑽**

B.D. REF :

CLIENT :  
 信和置業有限公司  
Sino Land Company Limited

ARCHITECT :  
 Ronald Lu & Partners  
Architects, Planners, Interior Designers  
Ronald Lu & Partners (HK) Ltd.  
呂元祥建築師事務所 (香港) 有限公司

MAIN CONTRACTOR :  
 Gammon

STRUCTURAL ENGINEER :  
 AECOM

FAÇADE CONSULTANT:  
 AECOM

NOTE :  
1. ALL DIMENSIONS ARE IN mm.  
2. ALL ELEVATIONS ARE VIEWED FROM OUTSIDE.  
3. ALL DIMENSIONS TO BE VERIFIED ON SITE BEFORE FABRICATION.

LEGEND :

NO.	DATE	REVISED	BY
E	25/12/22	REVISED AS PER COMMENTS	LS
D	28/09/22	REVISED AS PER COMMENTS	LS
C	06/04/22	REVISED AS PER COMMENTS	LS
B	22/02/22	REVISED AS PER COMMENTS	LS
A	03/12/21	REVISED AS PER COMMENTS	LS

JOB NO. : J-858  
PROJECT : PROPOSED RESIDENTIAL DEVELOPMENT AT TKOTL 70RP, PHASE 11, LOHAS PARK TSEUNG KWAN O, N.T.

TITLE : MATERIAL LIST FOR CURTAIN WALL

DATE : 22-OCT-21 SCALE : 1:1(A1)  
DRAWN BY : KY CHECKED BY : YB

美特鋁質有限公司  
MIDI ALUMINIUM FABRICATOR LTD.  
Units 6-8, Sunray Industrial Centre, 1/F  
610 Cha Kwo Ling Road, Kowloon  
Tel:23489211-4 Fax:(852)27727666

DWG NO. : J858-CW-CM02 REV. : E





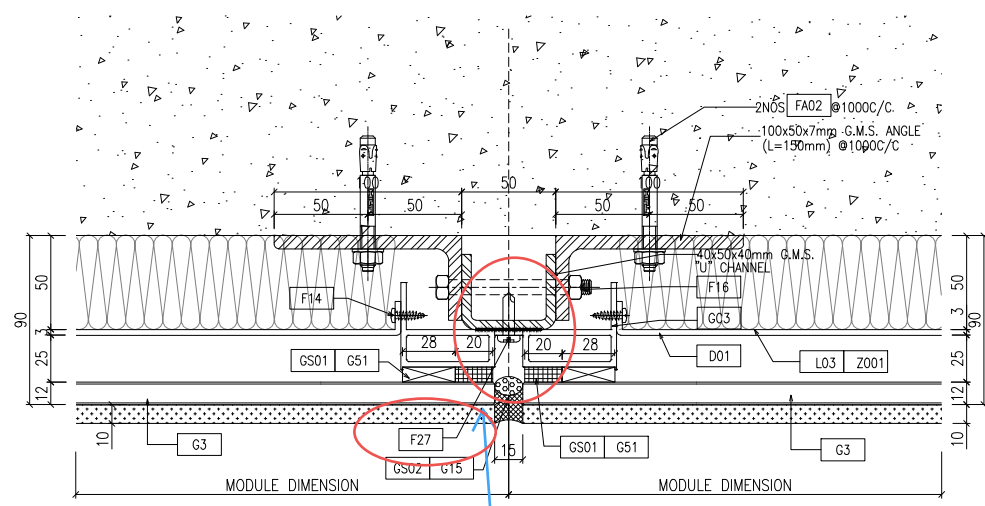
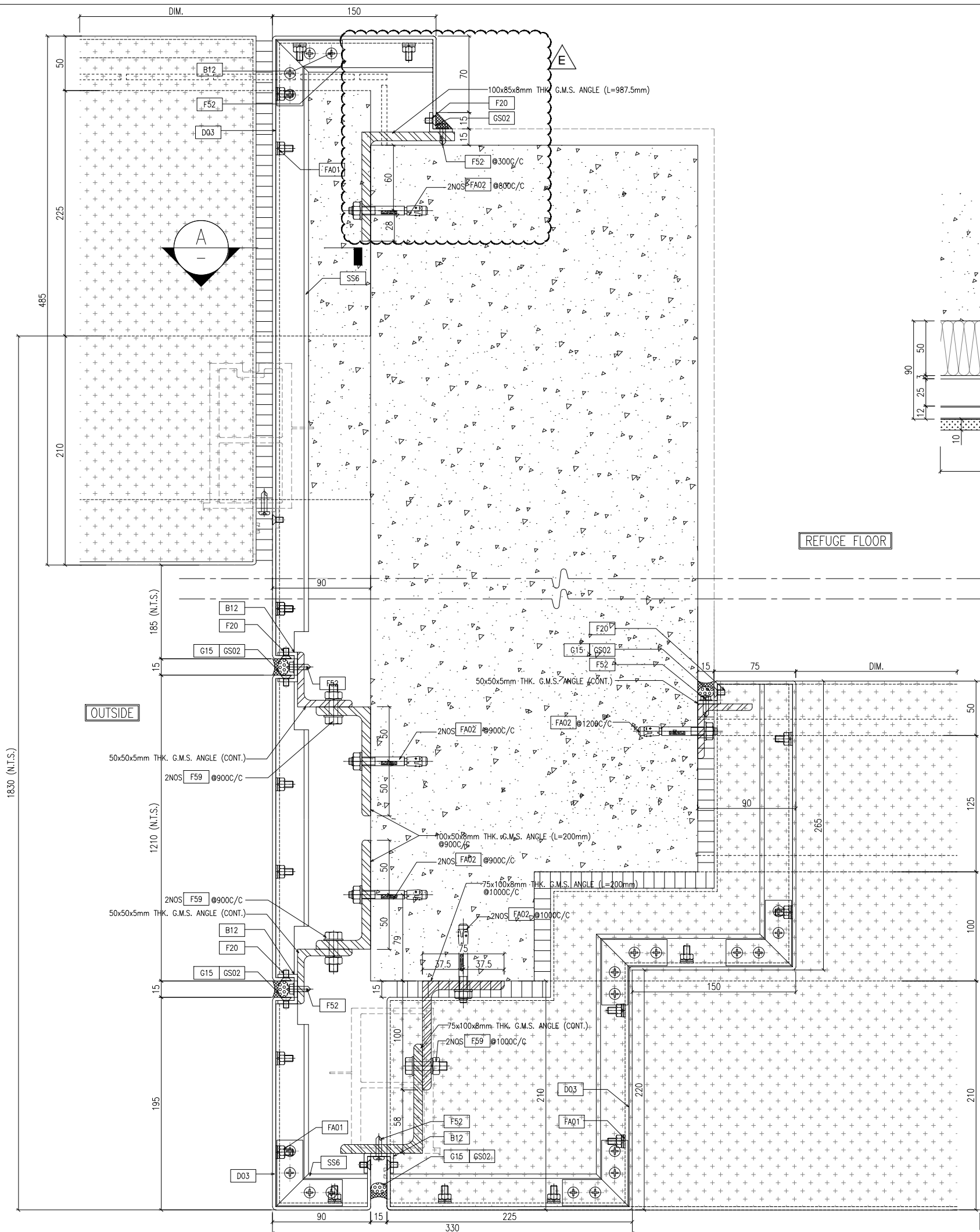

**Glass Cladding**  
**企向**  
**用M5.5x25mm**  
**六角頭自鑽**

1 D19 TYPICAL MULLION DETAIL CURTAIN WALL

B.D. REF :

CLIENT :  
 信和置業有限公司  
 Sino Land Company Limited

ARCHITECT :  
 ronald lu & partners  
 Architects, Planners, Interior Designers  
 Ronald Lu & Partners (HK) Ltd.  
 呂元祥建築師事務所 (香港) 有限公司

MAIN CONTRACTOR :  
 Gammon

STRUCTURAL ENGINEER :  
 AECOM

FAÇADE CONSULTANT:  
 AECOM

- NOTE :
1. ALL DIMENSIONS ARE IN mm.
  2. ALL ELEVATIONS ARE VIEWED FROM OUTSIDE.
  3. ALL DIMENSIONS TO BE VERIFIED ON SITE BEFORE FABRICATION.

- LEGEND :
- (x1) --- DETAIL MARK NO.
  - (x001) --- REFER SHEET NO.

1. F.F.L. --- FINISHED FLOOR LEVEL
2. S.F.L. --- STRUCTURAL FLOOR LEVEL
3. (R) --- REVERSED DETAIL

NO.	DATE	REVISED	BY
E	25/12/22	REVISED AS PER COMMENTS	LS
D	28/09/22	REVISED AS PER COMMENTS	LS
C	22/07/22	REVISED AS PER COMMENTS	LS
B	25/05/22	REVISED AS PER COMMENTS	LS
A	07/04/22	REVISED AS PER COMMENTS	LS

JOB NO. : J-858  
 PROJECT : PROPOSED RESIDENTIAL DEVELOPMENT AT TKOIL 70RP, PHASE 11, LOHAS PARK TSEUNG KWAN O, N.T.

TITLE :  
 TYPICAL MULLION DETAIL FOR CURTAIN WALL

DATE : 22-OCT-21 SCALE : 1:2(A1)  
 DRAWN BY : CHECKED BY :

美特鋁質有限公司  
 MIDI ALUMINIUM FABRICATOR LTD.  
 Units 6-8, Sunray Industrial Centre, 1/F  
 610 Cha Kwo Ling Road, Kowloon  
 Tel:23489211-4 Fax:(852)2727666

DWG NO. : J858-CW-D19 REV. : E

