

工程指示 / 要求簡箋(E.I.)

工程指示編號：EI / 4822 / 22

修改版次：

工程編號：J - 858

工程名稱：將軍澳日出康城 11

工程項目：幕牆 廠用配件 BM (扇撐和拉手) TYP

收件人：生統 / Maggie / 楊榮輝

發件人：Ant Yeung

日期：27/06/2022

要求提供 /  確認 事項：

- |                                    |                                     |                               |
|------------------------------------|-------------------------------------|-------------------------------|
| <input type="checkbox"/> 初步鋁料 B.M. | <input type="checkbox"/> 加工拆圖，然後生產  | <input type="checkbox"/> 尺寸表  |
| <input type="checkbox"/> 正式鋁料 B.M. | <input type="checkbox"/> 技術上資料 / 指示 | <input type="checkbox"/> 報價   |
| <input type="checkbox"/> 配件 B.M.   | <input type="checkbox"/> 樣辦或貨品說明書   | <input type="checkbox"/> 分判合約 |

內容：

請按 BM 訂購 (扇撐和拉手) 送廠， 謝謝

可分 2 批送料 2022SH16 和 2026-001A.

首批 8 月 5 日(送一半)，

第二批 2023 年 1 月 5 日(送一半)，

請在 2022.08.05 前完成上列要求。

附： 頁

原合約工程包

原合約工程加 / 減賬

新工程報價

分發東莞各部門：

- |  |  |   |  |
|--|--|---|--|
| <input type="checkbox"/> 生產技術總監 <input type="checkbox"/> 連附件 | <input type="checkbox"/> 技術部 <input type="checkbox"/> 連附件              | <input type="checkbox"/> 生產部 <input type="checkbox"/> 連附件               | <input type="checkbox"/> 機械設計部 <input type="checkbox"/> 連附件                    |
| <input type="checkbox"/> 採購部 <input type="checkbox"/> 連附件    | <input checked="" type="checkbox"/> 生產統籌部 <input type="checkbox"/> 連附件 | <input checked="" type="checkbox"/> 小羅 & 清 <input type="checkbox"/> 連附件 |  |
| <input type="checkbox"/> 質檢部 <input type="checkbox"/> 連附件    | <input type="checkbox"/> 會計部 <input type="checkbox"/> 連附件              | <input type="checkbox"/> 報關組 <input type="checkbox"/> 連附件               | <input checked="" type="checkbox"/> 其他 <u>楊榮輝</u> <input type="checkbox"/> 連附件 |

分發香港各部門：

- |   |  |   |  |
|---|--|---|--|
| <input type="checkbox"/> 行政部 <input type="checkbox"/> 連附件 | <input type="checkbox"/> 會計部 <input type="checkbox"/> 連附件  | <input type="checkbox"/> 統籌部 <input type="checkbox"/> 連附件 | <input type="checkbox"/> 工程部地盤科文 <input type="checkbox"/> 連附件  |
| <input type="checkbox"/> 採購部 <input type="checkbox"/> 連附件 | <input type="checkbox"/> QS 部 <input type="checkbox"/> 連附件 | <input type="checkbox"/> 維修部 <input type="checkbox"/> 連附件 | <input type="checkbox"/> 其他 _____ <input type="checkbox"/> 連附件 |

傳遞編號：

HK 1042 / 22

發件人簽署：

項目經理簽署：

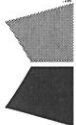
 美特鋁質有限公司 MIDI Aluminium Fabricator Ltd.		工程號: J-858	計算: shaw	日期: 2022/06/27	送呈:
廠用配件B.M.表(标准层总表)		地盤名稱 康城11期	核對:	日期:	副本:
BM編號:		項目類別 单元幕墙	批准:	日期:	
A/C Code :		此BM依據20220530收施工圖大樣計算			

序號	修改標示	配件圖號	物料編號	配件名稱	顏色	實用	後備	總數	單位	備注
8		(不分左右) ✓	香檳金	2026-001A手柄	已批色號 H433072	4088	112	4200	套	用于標準生窗拉手 (配螺絲)
9				東城2022-SH16扇撐(左)	不鏽鋼 SS 304	4088	112	4200	隻	SH窗玉用 (左開窗) ✓
10				東城2022-SH16扇撐(右)	不鏽鋼 SS 304	4088	112	4200	隻	SH窗玉用 (右開窗)

叉高17.5 mm  
不要東成標誌

看增 check 數

左 右

	L/Floor	R/Floor	Floor	L	R
T1	16	14	46	736	644
T2	14	13	50	700	650
T3	12	15	50	600	750

紀錄

5/5/2014

左 右

Total	L	R
42	2036	2044
*2	4072	4088

# Gammon

## MATERIALS SUBMISSION FORM

Project Proposed Residential Development at TKOTL 70RP, Phase 11, Lohas Park, Tseung Kwan O, New Territories

Works Main Contract

Contract No. J3931

Ref. No. P19084NT/MS/MD/581 (Rev.0)

GECC Ref. J3931/304/D03546

Date 1 Apr 2022

To / Attn RLP / Mr. Kenneth Wong / Ms. Florence Cheung

Subject **Material Submission – Midi – Submission of Sample for Hardware for Curtain Wall at Tower (MS023)**

27/4 email

19084NT

RONALD LU & PARTNERS

Form RLP/TSF

Received by / / 6 APR 2022

RECEIVED

Received by RLP

JN003250

We write to request this submission replied by:  RLP /  AECOM /  WSP /  Others

Anticipated date of response 14 Apr 2022

We certify that the submission has been checked and is in full compliance with the Specification & Contract Documents, unless otherwise stated in the remarks.

*[Signature]*  
Matthew Wong  
For and on behalf of  
Gammon Engineering & Construction Company Limited

MW/BK/BN/HW/vh

- |                     |   |
|---------------------|---|
| MTRC (Site)         | <input checked="" type="checkbox"/> Mr. KS Lee / Mr. Teddy Wu / Mr. HF Au / Mr. SL Kwai / Mr. Jacky Cheung                |
| MTRC (STR)          | <input type="checkbox"/> Mr. Tony Fan   |
| MTRC (E&M)          | <input type="checkbox"/> Mr. Ricky Ting   |
| MTRC (Cost & Prog)  | <input type="checkbox"/> Mr. Anthony Tam  |
| SKY CASTLE          | <input checked="" type="checkbox"/> Mr. Herbert Tsang / Mr. Francis Lau / Mr. Davy Ko / Mr. Kenneth Leung / Mr. Andy Chan |
| AECOM               | <input type="checkbox"/> Mr. Henry Lo / Mr. Cole Li   |
| AECOM (Façade)      | <input checked="" type="checkbox"/> Mr. Moone Lee / Ms. Phoenix Chung / Mr. Ryan Ho                                       |
| WSP                 | <input type="checkbox"/> Mr. Simon Kaan / Mr. Tommy Leung   |
| ADI (LANDSCAPE)     | <input type="checkbox"/> Mr. Walter So / Mr. Kenf Ng  |
| MDL                 | <input type="checkbox"/> Mr. Morly Law  |
| Beria               | <input type="checkbox"/> Mr. Keith Yim / Mr. Randolph Chan  |
| RE (AECOM)          | <input type="checkbox"/> Mr. Simon Tso / Mr. Ken Su   |
| COW                 | <input checked="" type="checkbox"/> Mr. Marcus Kee  |
| BSI                 | <input type="checkbox"/> BSI  |
| WSP (Safety & Risk) | <input type="checkbox"/> Mr. Chris Tong / Mr. Louis Siu   |
| Ramboll             | <input type="checkbox"/> Mr. David Yeung  |
| Tin Lee             | <input type="checkbox"/> Mr. Eddie Kwan   |
| AEC                 | <input type="checkbox"/> Mr. Andy Liu   |

Material / Work Description *	Sample for Hardware for Curtain Wall
Location	Curtain Wall
Brand Name	TungShing
Model / Reference No. *	1) Hinge : 2022-SH16" 2) Lock Fastener (扣碼) : TC903 3) Wedge (窗拈) : 837-SDH-03 4) Lock Set Stage (鎖扣) : 201-08 5) S.S Roller Pin (窗鎖點) : 202-06
Country of Origin	
Supplier Name	TungShing
Others (Color / Pattern, etc.) *	N/A
Material / Work Reference *	N/A
Specification Reference	N/A
Related Dwg. / A.I. Ref. *	N/A
Related BQ Reference	N/A
Submission Attachment	
Sample	<input checked="" type="checkbox"/> In RLP
Catalogue / Technical Data *	<input type="checkbox"/> Attached
Test Report / Certificate *	<input type="checkbox"/> N/A
Equipment Schedule	<input type="checkbox"/> N/A
Method Statement	<input type="checkbox"/> N/A
Installation Details	<input type="checkbox"/> N/A
Job Reference	<input type="checkbox"/> N/A
Remarks (To list deviations, if any)	* Delete as appropriate

### Review Status / Comment

### RESPONSE TO TECHNICAL SUBMISSION

Date 25/4-2022

Comments REVIEW STATUS - B.  
1/ REFER TO COMMENTS FROM FACADE CONSULT ANT.  
2/ PRODUCT SHALL BE INSTALLED ACCORDING TO MANUFACTURER'S MANUAL TO ENSURE PROPER FUNCTIONING & MAINTENANCE OF CURTAIN WALL WINDOW.



For and on behalf of  
Ronald Lu & Partners (Hong Kong) Ltd. SKH/WYF/TTCC

No review is made of detail dimensions/quantities.  
The submission is reviewed for general compliance with the design intent only.  
Any comments or amendments required shall not be deemed to be variation.  
The review does not release the Contractor from his responsibilities to comply with contract requirements.  
For resubmission, the Contractor has to highlight or cloud those revision areas in the shop drawing for review.

Legend: A (No objection) B (No objection, subject to comments as noted) C (Amendment & resubmission required) D (Rejected & resubmission required)

w/e

Replied by SE / Date

Replied by BS / Date

Replied by RLP / Date 25/4-2022

- |                     |   |
|---------------------|---|
| MTRC (Site)         | <input checked="" type="checkbox"/> Mr. KS Lee / Mr. Teddy Wu / Mr. HF Au / Mr. SL Kwai / Mr. Jacky Cheung                |
| MTRC (STR)          | <input type="checkbox"/> Mr. Tony Fan   |
| MTRC (E&M)          | <input type="checkbox"/> Mr. Ricky Ting   |
| MTRC (Cost & Prog)  | <input type="checkbox"/> Mr. Anthony Tam  |
| SKY CASTLE          | <input checked="" type="checkbox"/> Mr. Herbert Tsang / Mr. Francis Lau / Mr. Davy Ko / Mr. Kenneth Leung / Mr. Andy Chan |
| AECOM               | <input type="checkbox"/> Mr. Henry Lo / Mr. Cole Li   |
| AECOM (Façade)      | <input checked="" type="checkbox"/> Mr. Moone Lee / Ms. Phoenix Chung / Mr. Ryan Ho                                       |
| WSP                 | <input type="checkbox"/> Mr. Simon Kaan / Mr. Tommy Leung   |
| ADI (LANDSCAPE)     | <input type="checkbox"/> Mr. Walter So / Mr. Kenf Ng  |
| MDL                 | <input type="checkbox"/> Mr. Morly Law  |
| Beria               | <input type="checkbox"/> Mr. Keith Yim / Mr. Randolph Chan  |
| RE (AECOM)          | <input type="checkbox"/> Mr. Simon Tso / Mr. Ken Su   |
| COW                 | <input type="checkbox"/> Mr. Marcus Kee   |
| BSI                 | <input type="checkbox"/> BSI  |
| WSP (Safety & Risk) | <input type="checkbox"/> Mr. Chris Tong / Mr. Louis Siu   |
| Ramboll             | <input type="checkbox"/> Mr. David Yeung  |
| Tin Lee             | <input type="checkbox"/> Mr. Eddie Kwan   |
| AEC                 | <input type="checkbox"/> Mr. Andy Liu   |

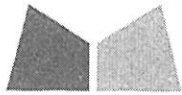

美特鋁質有限公司  
MIDI ALUMINIUM FABRICATOR LTD.

Our ref. MC/41169/858

1<sup>st</sup> April, 2022

Gammon Construction Company Limited  
22/F Tower 1, The Quayside,  
77 Hoi Bun Road,  
Kwun Tong, Kowloon.

By Email & Hand

Attn.: Mr. Matthew Wong

Dear Sir,

**Re: Design, Supply and Installation of Curtain Wall, Glass Wall, Aluminium Window, Aluminium Cladding, Aluminium Louvres and Glass Balustrade Nominated Sub-Contract at T.K.O.T.L. 70 RP, Phase 11, LOHAS Park, Tseung Kwan O, N.T.**  
**Submission of Sample for Hardware for Curtain Wall (MS023)**

Regarding the captioned project, we would like to submit the Sample for hardware for Curtain Wall for your review and comment.

Brand: Tung Shing

- 1) Hinge : 2022-SH16"
- 2) Lock Fastener (扣碼) : TC903
- 3) Wedge (窗拈) : 837-SDH-03
- 4) Lock Set Stage (鎖扣) : 201-08
- 5) S.S Roller Pin (窗鎖點) : 202-06

Remarks:

- 1.) The sample will be delivered to RLP office directly.

If you have any query, please feel free to contact us.

Thank you for your kind attention.

Yours faithfully,  
MIDI ALUMINIUM FABRICATOR LTD.

Marco Tam  
Director

Encl - 5 page(s)

cc. Gammon	- Mr. Jun Tsui / Mr. Brian Ng	(w/e)
Sino	- Mr. Terry Wan / Mr. Andy Chan	(w/e) (Email Only)
RLP	- Ms. Marina Tong / Ms. Ginny Chau	(w/e) (Email Only)
Aecom	- Mr. Ryan Ko / Mr. Cole Li	(w/e) (Email Only)
	- Ms. Daisy Lau / Ms. Crystal Wong	

FM/MT/DW/JL/AY/EL/KL/yl

九龍茶果嶺道610號生利工業中心1樓6-8號  
Units 6-8, 1<sup>st</sup> Floor, Sunray Industrial Centre, 610 Cha Kwo Ling Road, Kln.  
TEL. (電話): 2348 9211 FAX. (傳真): 2772 7666 E-mail Address (電郵): midi@midiltd.com.hk.



ISO 9001 : 2015  
Certificate No.: CC 1795

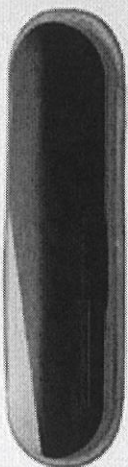

3) Springs  
2022-0311F

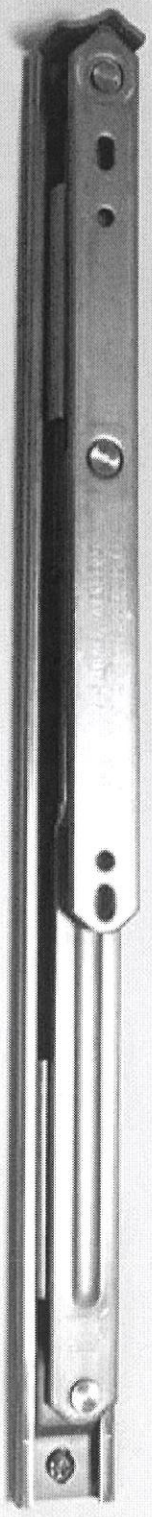

**ADD ALUMINIUM FABRICATOR LTD**  
 Unit 4, 7, 8, 9, 10, 11, 12, 13, 14, 15, 16, 17, 18, 19, 20, 21, 22, 23, 24, 25, 26, 27, 28, 29, 30, 31, 32, 33, 34, 35, 36, 37, 38, 39, 40, 41, 42, 43, 44, 45, 46, 47, 48, 49, 50, 51, 52, 53, 54, 55, 56, 57, 58, 59, 60, 61, 62, 63, 64, 65, 66, 67, 68, 69, 70, 71, 72, 73, 74, 75, 76, 77, 78, 79, 80, 81, 82, 83, 84, 85, 86, 87, 88, 89, 90, 91, 92, 93, 94, 95, 96, 97, 98, 99, 100, 101, 102, 103, 104, 105, 106, 107, 108, 109, 110, 111, 112, 113, 114, 115, 116, 117, 118, 119, 120, 121, 122, 123, 124, 125, 126, 127, 128, 129, 130, 131, 132, 133, 134, 135, 136, 137, 138, 139, 140, 141, 142, 143, 144, 145, 146, 147, 148, 149, 150, 151, 152, 153, 154, 155, 156, 157, 158, 159, 160, 161, 162, 163, 164, 165, 166, 167, 168, 169, 170, 171, 172, 173, 174, 175, 176, 177, 178, 179, 180, 181, 182, 183, 184, 185, 186, 187, 188, 189, 190, 191, 192, 193, 194, 195, 196, 197, 198, 199, 200, 201, 202, 203, 204, 205, 206, 207, 208, 209, 210, 211, 212, 213, 214, 215, 216, 217, 218, 219, 220, 221, 222, 223, 224, 225, 226, 227, 228, 229, 230, 231, 232, 233, 234, 235, 236, 237, 238, 239, 240, 241, 242, 243, 244, 245, 246, 247, 248, 249, 250, 251, 252, 253, 254, 255, 256, 257, 258, 259, 260, 261, 262, 263, 264, 265, 266, 267, 268, 269, 270, 271, 272, 273, 274, 275, 276, 277, 278, 279, 280, 281, 282, 283, 284, 285, 286, 287, 288, 289, 290, 291, 292, 293, 294, 295, 296, 297, 298, 299, 300, 301, 302, 303, 304, 305, 306, 307, 308, 309, 310, 311, 312, 313, 314, 315, 316, 317, 318, 319, 320, 321, 322, 323, 324, 325, 326, 327, 328, 329, 330, 331, 332, 333, 334, 335, 336, 337, 338, 339, 340, 341, 342, 343, 344, 345, 346, 347, 348, 349, 350, 351, 352, 353, 354, 355, 356, 357, 358, 359, 360, 361, 362, 363, 364, 365, 366, 367, 368, 369, 370, 371, 372, 373, 374, 375, 376, 377, 378, 379, 380, 381, 382, 383, 384, 385, 386, 387, 388, 389, 390, 391, 392, 393, 394, 395, 396, 397, 398, 399, 400, 401, 402, 403, 404, 405, 406, 407, 408, 409, 410, 411, 412, 413, 414, 415, 416, 417, 418, 419, 420, 421, 422, 423, 424, 425, 426, 427, 428, 429, 430, 431, 432, 433, 434, 435, 436, 437, 438, 439, 440, 441, 442, 443, 444, 445, 446, 447, 448, 449, 450, 451, 452, 453, 454, 455, 456, 457, 458, 459, 460, 461, 462, 463, 464, 465, 466, 467, 468, 469, 470, 471, 472, 473, 474, 475, 476, 477, 478, 479, 480, 481, 482, 483, 484, 485, 486, 487, 488, 489, 490, 491, 492, 493, 494, 495, 496, 497, 498, 499, 500, 501, 502, 503, 504, 505, 506, 507, 508, 509, 510, 511, 512, 513, 514, 515, 516, 517, 518, 519, 520, 521, 522, 523, 524, 525, 526, 527, 528, 529, 530, 531, 532, 533, 534, 535, 536, 537, 538, 539, 540, 541, 542, 543, 544, 545, 546, 547, 548, 549, 550, 551, 552, 553, 554, 555, 556, 557, 558, 559, 560, 561, 562, 563, 564, 565, 566, 567, 568, 569, 570, 571, 572, 573, 574, 575, 576, 577, 578, 579, 580, 581, 582, 583, 584, 585, 586, 587, 588, 589, 590, 591, 592, 593, 594, 595, 596, 597, 598, 599, 600, 601, 602, 603, 604, 605, 606, 607, 608, 609, 610, 611, 612, 613, 614, 615, 616, 617, 618, 619, 620, 621, 622, 623, 624, 625, 626, 627, 628, 629, 630, 631, 632, 633, 634, 635, 636, 637, 638, 639, 640, 641, 642, 643, 644, 645, 646, 647, 648, 649, 650, 651, 652, 653, 654, 655, 656, 657, 658, 659, 660, 661, 662, 663, 664, 665, 666, 667, 668, 669, 670, 671, 672, 673, 674, 675, 676, 677, 678, 679, 680, 681, 682, 683, 684, 685, 686, 687, 688, 689, 690, 691, 692, 693, 694, 695, 696, 697, 698, 699, 700, 701, 702, 703, 704, 705, 706, 707, 708, 709, 710, 711, 712, 713, 714, 715, 716, 717, 718, 719, 720, 721, 722, 723, 724, 725, 726, 727, 728, 729, 730, 731, 732, 733, 734, 735, 736, 737, 738, 739, 740, 741, 742, 743, 744, 745, 746, 747, 748, 749, 750, 751, 752, 753, 754, 755, 756, 757, 758, 759, 760, 761, 762, 763, 764, 765, 766, 767, 768, 769, 770, 771, 772, 773, 774, 775, 776, 777, 778, 779, 780, 781, 782, 783, 784, 785, 786, 787, 788, 789, 790, 791, 792, 793, 794, 795, 796, 797, 798, 799, 800, 801, 802, 803, 804, 805, 806, 807, 808, 809, 810, 811, 812, 813, 814, 815, 816, 817, 818, 819, 820, 821, 822, 823, 824, 825, 826, 827, 828, 829, 830, 831, 832, 833, 834, 835, 836, 837, 838, 839, 840, 841, 842, 843, 844, 845, 846, 847, 848, 849, 850, 851, 852, 853, 854, 855, 856, 857, 858, 859, 860, 861, 862, 863, 864, 865, 866, 867, 868, 869, 870, 871, 872, 873, 874, 875, 876, 877, 878, 879, 880, 881, 882, 883, 884, 885, 886, 887, 888, 889, 890, 891, 892, 893, 894, 895, 896, 897, 898, 899, 900, 901, 902, 903, 904, 905, 906, 907, 908, 909, 910, 911, 912, 913, 914, 915, 916, 917, 918, 919, 920, 921, 922, 923, 924, 925, 926, 927, 928, 929, 930, 931, 932, 933, 934, 935, 936, 937, 938, 939, 940, 941, 942, 943, 944, 945, 946, 947, 948, 949, 950, 951, 952, 953, 954, 955, 956, 957, 958, 959, 960, 961, 962, 963, 964, 965, 966, 967, 968, 969, 970, 971, 972, 973, 974, 975, 976, 977, 978, 979, 980, 981, 982, 983, 984, 985, 986, 987, 988, 989, 990, 991, 992, 993, 994, 995, 996, 997, 998, 999, 1000

4) Lock Set Stage  
(8 x 1) : 201-08

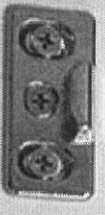

2) Lock Fastener  
(4 x 4) : TC003



5) S Roller Pin  
(8 x 8) : 202-06



3) Wedge (8 x 8) :  
837-SOH-03





**MIDI ALUMINIUM FABRICATOR LTD.**

Units 6, 7, 8 Sunray Industrial Centre, 1st Floor, 610 Cho Kwo Ling Road Kowloon.

Project

: T.K.O.T.L. 70 RP, Phase II, LOHAS Park, Tseung Kwan O, N.T.

Subject

: Sample for Hardware for Curtain Wall (MS023)

Brand

: Tung Shing

- 1) Hinge : 2022-SH16"
- 2) Lock Fastener (扣碼) : TC903
- 3) Wedge (窗拑) : 837-SDH-03
- 4) Lock Set Stage (鎖扣) : 201-08
- 5) S.S Roller Pin (窗鎖點) : 202-06

Letter ref.

: MC/41169/858

Date

: 1<sup>st</sup> April 2022

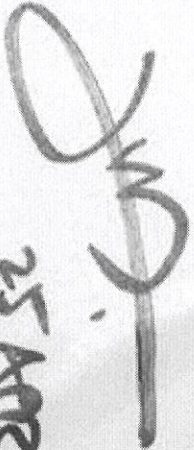
  
25 APR 2022

P19084MT / MS / MD / 581 (rev 02)

# Tung<sup>®</sup> 2022SH超重型方槽不锈钢铰链(分左右)

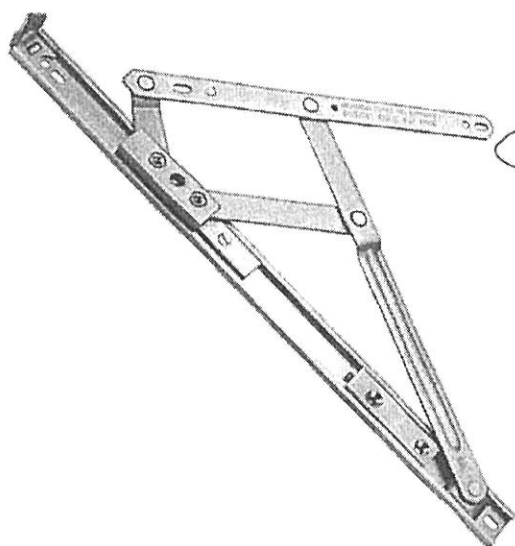

铝窗规格				
型号	窗最宽(mm)	窗最高(mm)	窗最重(kg)	开启角度
2022-SH16°	1200	1800	120	90° -1°

安装尺寸										
型号	A	B	C	D	E	F	G	H	I	J
16°	39	56.8	140.3	234.3	245.7	25.5	36.2	311.5	351.5	400

- ☞ 适用于超重型平开窗，承重可达120kg。
- ☞ 选用最优良的(304)不锈钢制造。
- ☞ 十万次严格开关测试后仍能操作正常，确保恒久耐用。
- ☞ 符合香港、新加坡、中国标准。
- ☞ 产品已获专利，专利号：PATENT NO. P.R.C. 201620554912.8

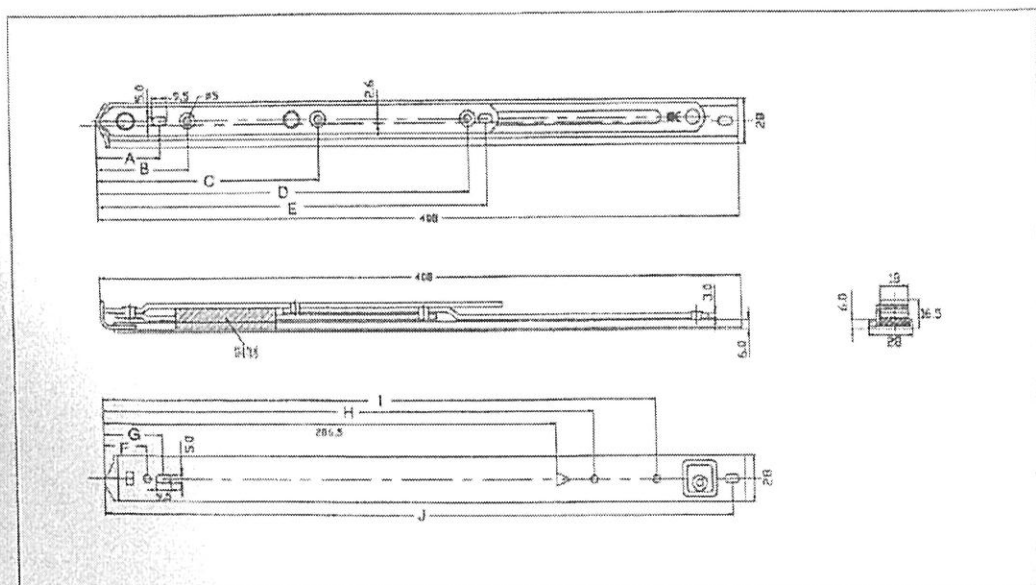

Project Proposed Residential Development at TKOTL 70RP, Phase 11, Lohas Park, Tseung Kwan O, New Territories  
 Works Main Contract  
 Contract No. J3931  
 Ref No. P19084NT/MS/MD/522 (Rev.0)  
 GECCL Ref. J3931/304/D03139  
 Date 10 Mar 2022  
 To / Attn RLP / Mr. Kenneth Wong / Ms. Florence Cheung  
 Subject **Material Submission – Midi – Submission of Sample for Hardware for Curtain Wall at Tower (MS022)**

41169  
 Received by / /  
 Received by RLP

We write to request this submission replied by:  RLP /  AECOM /  WSP /  Others  
 Anticipated date of response **24 Mar 2022**

We certify that the submission has been checked and is in full compliance with the Specification & Contract Documents, unless otherwise stated in the remarks

  
 Matthew Wong  
 For and on behalf of  
**Gammon Engineering & Construction Company Limited**  
 MW/BK/JT/BN/HW/vh

- cc: w/c
- Mr. KS Lee / Mr. Terry Wu / Mr. HF Au / Mr. S. Kwang / Mr. Benny Cheung
  - Mr. Tony Fan
  - Mr. Rocky Tong
  - Mr. Anthony Tam
  - Mr. Herbert Tung / Mr. Francis Au / Mr. Wang / Mr. Kenneth Leung / Mr. Andy Chan
  - Mr. Henry Lo / Mr. Goble
  - Ms. Monica Lee / Ms. Phoebe Chung / Mr. Ryan Ho
  - Mr. Simon Tsui / Mr. Tommy Leung
  - Mr. Walter So / Mr. David Ho
  - Mr. Wong Jui
  - Mr. Keith Yip / Mr. Ramesh Chari
  - Mr. Simon Tsui / Mr. Ken So
  - Mr. Marcus Fong
  - BS
  - Mr. Chris Tong / Mr. David So
  - Mr. David Young
  - Mr. Eddie Kwan
  - Mr. Andy Ip

<b>Material / Work Description *</b>	Sample for Hardware for Curtain Wall
Location	Curtain Wall
Brand Name	TungShing
<b>Model / Reference No. *</b>	Handle 2026-001A
Country of Origin	
Supplier Name	TungShing
Others (Color / Pattern, etc) *	N/A
<b>Material / Work Reference *</b>	N/A
Specification Reference	N/A
Related Dwg / A / Ref *	N/A
Related BQ Reference	N/A
<b>Submission Attachment</b>	
Sample	<input type="checkbox"/> N/A
Catalogue / Technical Data *	<input type="checkbox"/> Attached
Test Report / Certificate *	<input type="checkbox"/> N/A
Equipment Schedule	<input type="checkbox"/> N/A
Method Statement	<input type="checkbox"/> N/A
Installation Details	<input type="checkbox"/> N/A
Job Reference	<input type="checkbox"/> N/A
<b>Remarks</b> (To list deviations, if any)	* Delete as appropriate

**Review Status / Comment**

You are reminded that the above comments are not exhaustive and any comments/approval shall by no means relieve Contractor's liability to ensure compliance with all contractual and statutory requirements. Any comments/approval are subject to no time implications and no cost additions to the Contract unless explicitly confirmed in writing by the Architect.

You are required to ensure your proposal fully conform to contractual requirements, actual and implied warranties. Any approved system / material (including all accessories and ancillary materials/fittings) shall be used in strict accordance with relevant manufacturer's instructions, method statement and recommendations for use in respective areas specified in the Contract.

**RESPONSE TO TECHNICAL SUBMISSION**

Date 16 March 2022  
 Comments **Review Status / Comment: B**  
 1/ Colour to match silver champagne cladding colour \*  
 2/ Please ensure no finger scratching when the handle is used  
 3/ All application shall comply with the Contract requirements, actual/ implied warranties (if any) and necessary statutory requirement.

Replied by SE / Date  
 Replied by BS / Date  
 Replied by RLP / Date 16 March 2022



For and on behalf of  
**Ronald Lu & Partners (Hong Kong) Ltd.**  
 SKH/WYF/ATC

No review is made of detail dimensions/quantities  
 The submission is reviewed for general compliance with the design intent only  
 Any comments or amendments required shall not be deemed to be variation  
 The review does not release the Contractor from his responsibilities to comply with contract requirements  
 For resubmission the Contractor has to highlight or cloud those revision areas in the shop drawing for review  
**Legend** A (No objection) C (Amendment & resubmission required)  
 B (No objection, subject to comments as noted) D (Rejected & resubmission required)

- cc: w/c
- Mr. S. Lee / Mr. Terry Wu / Mr. HF Au / Mr. S. Kwang / Mr. Benny Cheung
  - Mr. Tony Fan
  - Mr. Rocky Tong
  - Mr. Anthony Tam
  - Mr. Herbert Tung / Mr. Francis Au / Mr. Wang / Mr. Kenneth Leung / Mr. Andy Chan
  - Mr. Henry Lo / Mr. Goble
  - Ms. Monica Lee / Ms. Phoebe Chung / Mr. Ryan Ho
  - Mr. Simon Tsui / Mr. Tommy Leung
  - Mr. Walter So / Mr. David Ho
  - Mr. Wong Jui
  - Mr. Keith Yip / Mr. Ramesh Chari
  - Mr. Simon Tsui / Mr. Ken So
  - Mr. Marcus Fong
  - BS
  - Mr. Chris Tong / Mr. David So
  - Mr. David Young
  - Mr. Eddie Kwan
  - Mr. Andy Ip



美特鋁質有限公司  
MIDI ALUMINIUM FABRICATOR LTD.

Our ref. MC/41110/858

7<sup>th</sup> March, 2022

Gammon Construction Company Limited  
22/F Tower 1, The Quayside,  
77 Hoi Bun Road,  
Kwun Tong, Kowloon.

By Email & Hand

Attn.: Mr. Matthew Wong

Dear Sir,

**Re: Design, Supply and Installation of Curtain Wall, Glass Wall, Aluminium Window, Aluminium Cladding, Aluminium Louvres and Glass Balustrade Nominated Sub-Contract at T.K.O.T.L. 70 RP, Phase 11, LOHAS Park, Tseung Kwan O, N.T.**  
**Submission of Sample for Hardware for Curtain Wall (Handle) (MS22)**

Regarding the captioned project, we would like to submit the Sample for hardware for Curtain Wall for your review and comment.

Brand: Tung Shing

1) Handle(拉手) : 2026-001A

Remarks:

The hardware was used in previous project - Grand Central(凱滙), attached is the approved record for your reference.

Thank you for your kind attention.

Yours faithfully,  
MIDI ALUMINIUM FABRICATOR LTD.

Marco Tam  
Director

Encl - page(s)

FM/MT/DW/JL/AY/EL/KL/wk

Quayside  
Kwun Tong,  
Kong

thew Wong

ply & Installation of Curte  
O.T.L 70 RP, Phase 11, L  
Sample for Hardware

s Wall, Aluminium Window, Aluminum Claddi  
seung Kwan O, N.T.  
Wall (MS22)

captioned project, we w  
w and comment.

submit the Sample for hardware for Curtain

ing

) : 2026-001

was used in pr

ord for you

for your kind attention.

ly.  
INIUM FABRICATOR LTI

ages

JL / AY / EL / KL / WK

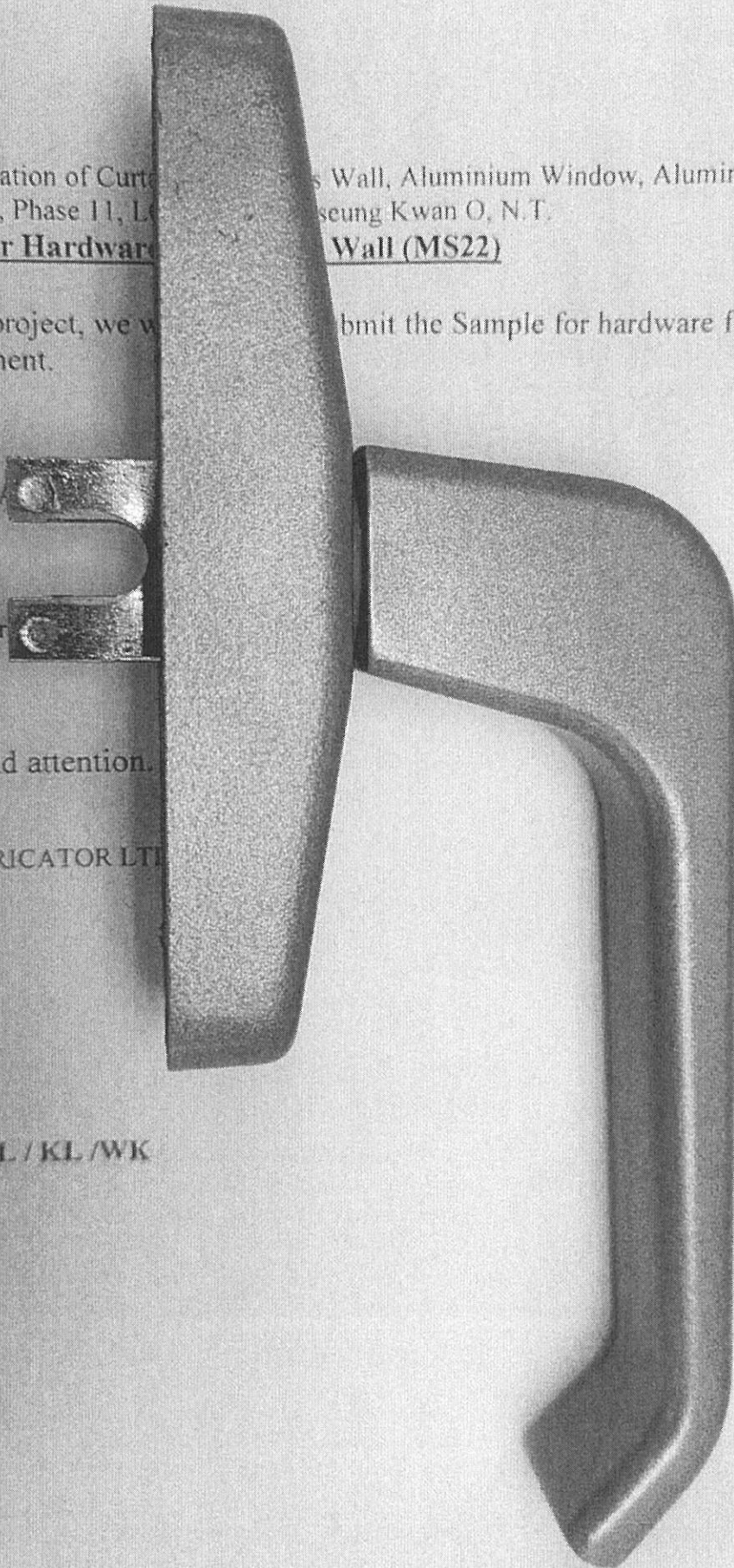

tion of Curtain Wall  
Phase 11, LOHAS  
Hardware for C

MIOME

project, we would like to s  
ent.

ant Wall

A

previous project - Grand Central

nd attention.

BRICATOR LTD

/EL/KL/WK

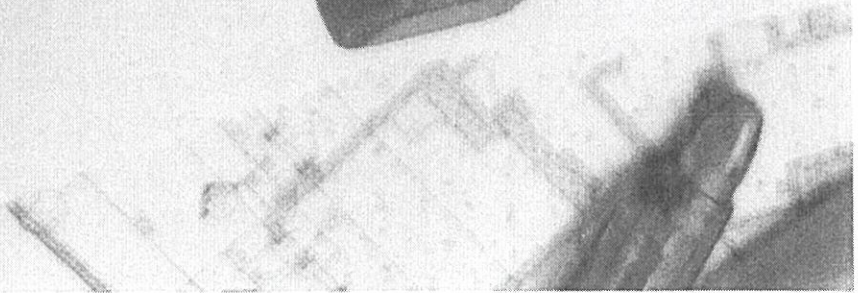

THE OFFICE OF THE ATTORNEY GENERAL  
STATE OF CALIFORNIA  
SUBJECT : Submission of Sample for Hardware for Curtain Wall (Handle) (MS22)  
Brand : Jung Shing  
Handle(拉手) : 2026-001 A  
Letter ref : MG/41110/858

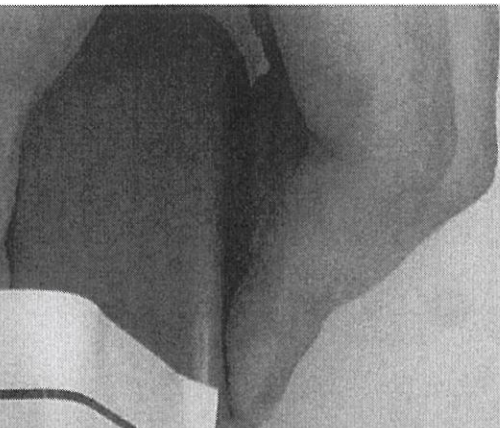

# Tung<sup>®</sup> 多点锁执手系列

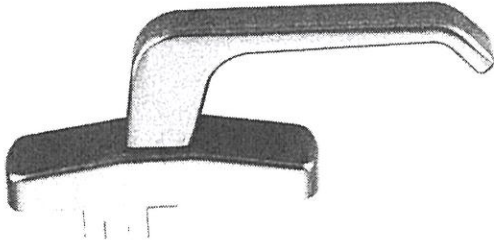

**2026-001A** 拨叉长度有多种尺寸可供选择

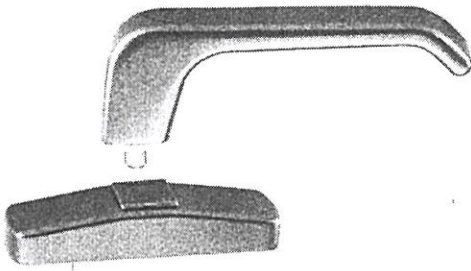
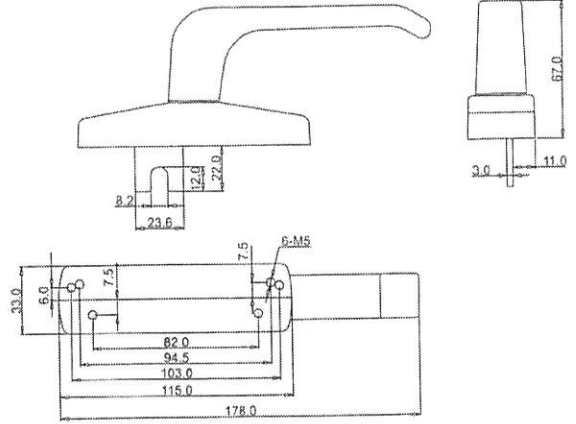

**2026-005** 拨叉长度有多种尺寸可供选择

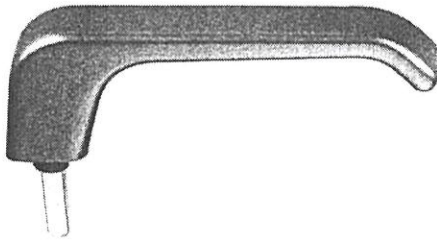
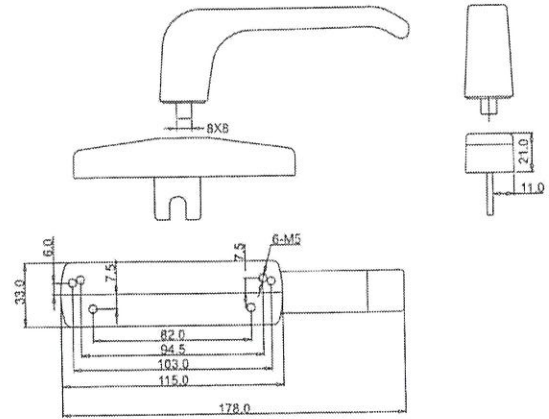

**2026-005A** L:可根据要求长度做

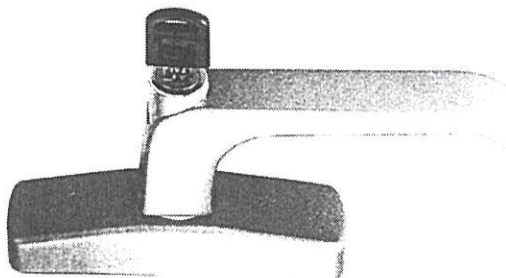
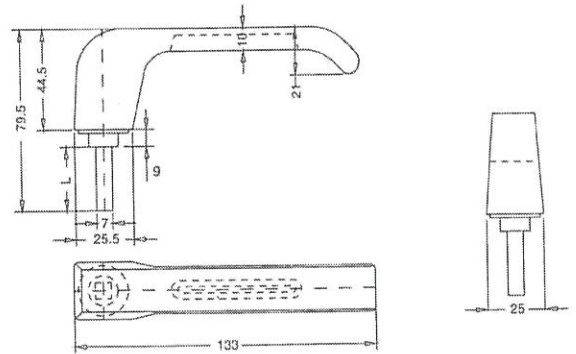

**2026-006有匙** 拨叉长度有多种尺寸可供选择

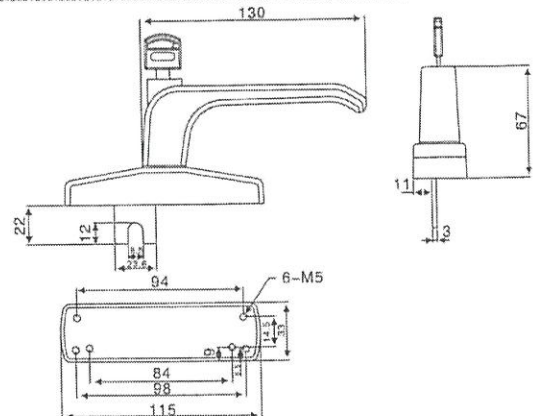

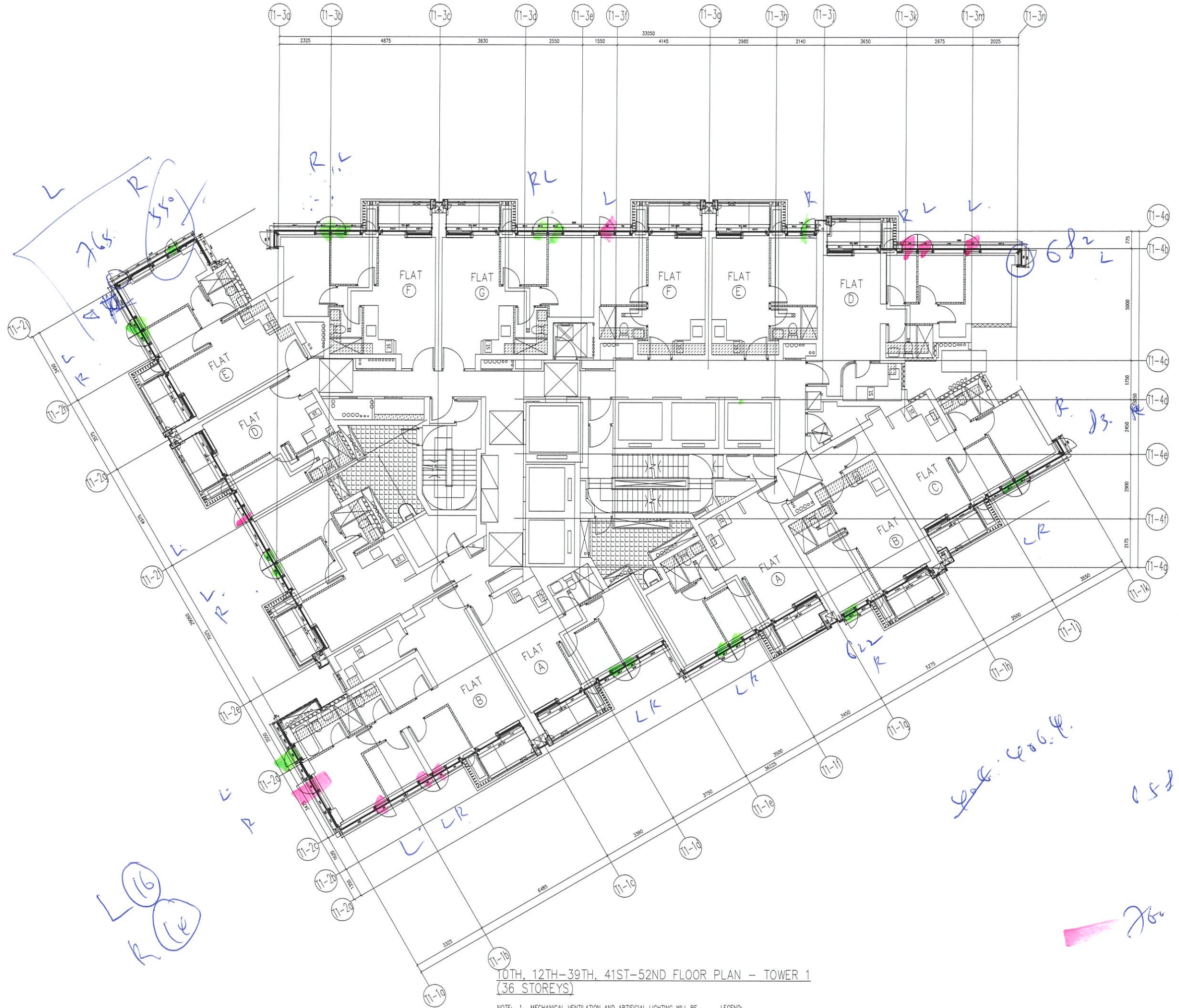

10TH, 12TH-39TH, 41ST-52ND FLOOR PLAN - TOWER 1  
(36 STOREYS)

NOTE: 1. MECHANICAL VENTILATION AND ARTIFICIAL LIGHTING WILL BE PROVIDED AT THE BATHROOM/ LAVATORY MARKED WITH \* \* \* FOR OMISSION OF NATURAL LIGHTING AND VENTILATION.  
2. THERE WILL BE NO 13/F, 14/F, 24/F, 34/F & 44/F IN THE NOMENCLATURE SYSTEM FOR NUMBERING OF FLOORS.

LEGEND:  
 OPEN KITCHEN  
 NON-STRUCTURAL PREFABRICATED EXTERNAL WALL  
 SUNKEN SLAB

*Handwritten note:* 400

*Handwritten note:* 658

*Handwritten note:* 765 = 685

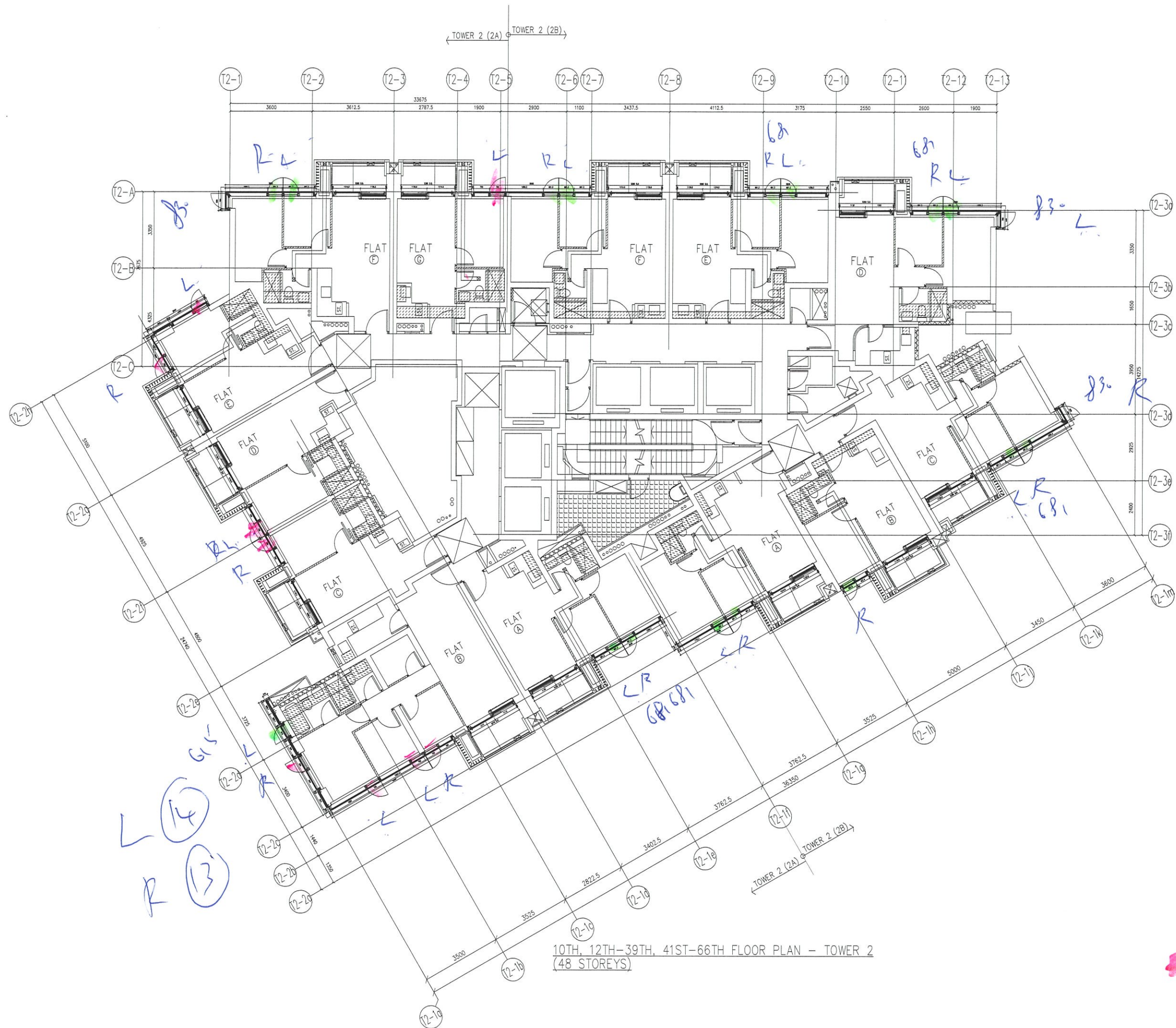

10TH, 12TH-39TH, 41ST-66TH FLOOR PLAN - TOWER 2 (48 STOREYS)

700



10TH, 12TH-39TH, 41ST-66TH FLOOR PLAN - TOWER 3 (3A & 3B)

T3