

工程指示 / 要求簡箋(E.I.)

工程指示編號：EI/4721/22

修改版次：

工程編號：J - 858

工程名稱：將軍澳日出康城 11

工程項目：大樓 幕牆單元 玻璃 初步玻璃 BM 和確認款式

收件人：Maggie

發件人：Ant Yeung

日期：26/05/2022

要求提供 / 確認 事項：

- | | | |
|------------------------------------|-------------------------------------|-------------------------------|
| <input type="checkbox"/> 初步鋁料 B.M. | <input type="checkbox"/> 加工拆圖，然後生產 | <input type="checkbox"/> 尺寸表 |
| <input type="checkbox"/> 正式鋁料 B.M. | <input type="checkbox"/> 技術上資料 / 指示 | <input type="checkbox"/> 報價 |
| <input type="checkbox"/> 配件 B.M. | <input type="checkbox"/> 樣辦或貨品說明書 | <input type="checkbox"/> 分判合約 |

內容：

現提供 大樓 幕牆單元 玻璃 初步玻璃 BM 和確認款式 請留意

此為初步玻璃 BM 供備料和擬定合同用。

IGU Low-E 用 58T Low-E； 反光片用 SSC1-60T

幕牆使用 4 款玻璃。玻璃編號 (R 字頭) 和預計米數，請參看後頁總表。

預計首批交玻璃到廠為 2022.08.15

請留意：1. IGU 用 GE 結構膠 SSG4400

謝謝 2. IGU 乾燥鋁帶請報價 Option 使用黑色

請在 2022.06.24 前完成上列要求。

附： 頁

原合約工程包

原合約工程加 / 減賬

新工程報價

分發東莞各部門：

- | | | | |
|--|---|---|--|
| <input type="checkbox"/> 生產技術總監 <input type="checkbox"/> 連附件 | <input type="checkbox"/> 技術部 <input type="checkbox"/> 連附件 | <input type="checkbox"/> 生產部 <input type="checkbox"/> 連附件 | <input type="checkbox"/> 機械設計部 <input type="checkbox"/> 連附件 |
| <input type="checkbox"/> 採購部 <input type="checkbox"/> 連附件 | <input type="checkbox"/> 生產統籌部 <input type="checkbox"/> 連附件 | <input checked="" type="checkbox"/> 小羅 & 清 <input type="checkbox"/> 連附件 | |
| <input type="checkbox"/> 質檢部 <input type="checkbox"/> 連附件 | <input type="checkbox"/> 會計部 <input type="checkbox"/> 連附件 | <input type="checkbox"/> 報關組 <input type="checkbox"/> 連附件 | <input type="checkbox"/> 其他 _____ <input type="checkbox"/> 連附件 |

分發香港各部門：

- | | | | |
|--|--|---|--|
| <input type="checkbox"/> 行政部 <input type="checkbox"/> 連附件 | <input type="checkbox"/> 會計部 <input type="checkbox"/> 連附件 | <input type="checkbox"/> 統籌部 <input type="checkbox"/> 連附件 | <input type="checkbox"/> 工程部地盤科文 <input type="checkbox"/> 連附件 |
| <input checked="" type="checkbox"/> 採購部 <input type="checkbox"/> 連附件 | <input type="checkbox"/> QS 部 <input type="checkbox"/> 連附件 | <input type="checkbox"/> 維修部 <input type="checkbox"/> 連附件 | <input type="checkbox"/> 其他 _____ <input type="checkbox"/> 連附件 |

傳遞編號：

HK 0852/22

發件人簽署：

項目經理簽署：

J858 LP11
Bulk Material - Glass

Curtain Wall / Glass Cladding / Sliding Door

- GL1 10mm Heat strengthened glass w/ low-e 58T (#2) + 12mm air + 12mm tempered glass (R20220114001)
- GL2 10mm Heat strengthened glass w/ low-e 58T (#2) + 12mm air + 10mm tempered glass (R20220114003)
- GL3 12mm Heat strengthened 60T (#2)glass (R20220324054)
- GL4 12mm clear tempered glass (R20220114008)

- (Fixed glass and sliding door)
- (Openable window)
- (Spandral glass and Glass Cladding)
- (Protective barrier)

T1	Glass Sqm	Glass Qty
GL1	6390.012	3672
GL2	1316.282	1402
GL3	2522.21	2796
GL4	102.391	1364

T2	Glass Sqm	Glass Qty
GL1	6841.168	3886
GL2	1308.767	1408
GL3	2281.435	2582
GL4	102.49	1372

T3	Glass Sqm	Glass Qty
GL1	6676.762	3725
GL2	1274.264	1353
GL3	2243.585	2588
GL4	100.65	1323

	Total Sqm	Total Qty
GL1	19907.9	11283
GL2	3899.3	4163
GL3	7047.2	7966
GL4	305.5	4059
	平方米	件

Alum WinDow 則師未正式批核

- TG11 6mm Clear Tempered Glass (R20220401057)
- TG9 6mm Heat strengthened clear glass + 1.52 milky PVB + 6mm low iron Heat strengthened clear glass (R20220414034)
- Option A 6mm clear glass + 1.52 PVB + 6mm #4 Acid etch temper glass
- Option B 12 mm Temper Acid Etch

- (Kitchen)
- (Bathroom)

Precast Window 則師未正式批核

T1	Glass Sqm	Glass Qty
TG11	13.13	45
TG9	47.49	136

T2	Glass Sqm	Glass Qty
TG11	14.3	49
TG9	105.05	249

T3	Glass Sqm	Glass Qty
TG11	14.3	49
TG9	122.16	298

	Total Sqm	Total Qty
TG11	41.7	143
TG9	274.7	683

Insitu Window 則師未正式批核

T1	Glass Sqm	Glass Qty
TG11	35.54	47
TG9	0	0

T2	Glass Sqm	Glass Qty
TG11	38.61	51
TG9	18.72	50

T3	Glass Sqm	Glass Qty
TG11	38.61	51
TG9	18.49	50

	Total Sqm	Total Qty
TG11	112.8	149
TG9	37.2	100

J858康城11期单元幕墙玻璃分层统计表

工程: J858康城11期(T1)

日期: 12-Mar-22

序号	玻璃编号	玻璃类型	中线尺寸				玻璃尺寸				单面积 (m2)	分层数量				总数 量					
			W(mm)	x	H(mm)		左-	右-	上-	下-		W(mm)	x	H(mm)			9F(10,12-16,18-20,22-25,27-29,31-33,36-38,41-42,45-47,49-51,53-56,58-60F相同,共34层)	11F	40F	17F(21,26,30,35,39,43,48,52,57F相同,共10层)	
1	GL01-01	GL01	665	x	895	18.5	18.5	28.5	33.5	628	x	833	0.52	34		1	1	10	46	24.1	
2	GL01-02	GL01	700	x	895	18.5	18.5	28.5	33.5	663	x	833	0.55	306		7	7	90	410	226.4	
3	GL01-03	GL01	681	x	895	18.5	18.5	28.5	33.5	644	x	833	0.54	476		6	6	140	628	336.9	
4	GL01-04	GL01	622.5	x	895	18.5	18.5	28.5	33.5	585.5	x	833	0.49	68				20	88	42.9	
5	GL01-05	GL01	765	x	895	68	18.5	28.5	33.5	678.5	x	833	0.57	136		4	4	40	184	104.0	
6	GL01-06	GL01	940	x	2395	18.5	18.5	28.5	33.5	903	x	2333	2.11	34				10	44	92.7	
7	GL01-07	GL01	940	x	2345	18.5	18.5	28.5	33.5	903	x	2283	2.06		1	1			2	4.1	
8	GL01-08	GL01	1830	x	2395	18.5	18.5	28.5	33.5	1793	x	2333	4.18	34				10	44	184.1	
9	GL01-09	GL01	1830	x	2345	18.5	18.5	28.5	33.5	1793	x	2283	4.09		1	1			2	8.2	
10	GL01-10	GL01	1562.5	x	2395	18.5	18.5	28.5	33.5	1525.5	x	2333	3.56	34				10	44	156.6	
11	GL01-11	GL01	1562.5	x	2345	18.5	18.5	28.5	33.5	1525.5	x	2283	3.48		1	1			2	7.0	
12	GL01-12	GL01	700	x	2395	18.5	18.5	28.5	33.5	663	x	2333	1.55	136				40	176	272.2	
13	GL01-13	GL01	700	x	2345	18.5	18.5	28.5	33.5	663	x	2283	1.51		2	2			4	6.1	
14	GL01-14	GL01	681	x	2395	18.5	18.5	28.5	33.5	644	x	2333	1.50	238				70	308	462.8	
15	GL01-15	GL01	1309	x	2395	18.5	18.5	28.5	33.5	1272	x	2333	2.97	34				10	44	130.6	
16	GL01-16	GL01	1699	x	2395	18.5	18.5	28.5	33.5	1662	x	2333	3.88	34				10	44	170.6	
17	GL01-17	GL01	622.5	x	2395	18.5	18.5	28.5	33.5	585.5	x	2333	1.37	68				20	88	120.2	
18	GL01-18	GL01	681	x	2345	18.5	18.5	28.5	33.5	644	x	2283	1.47		3	3			6	8.8	
19	GL01-19	GL01	1856	x	2395	18.5	68	28.5	33.5	1769.5	x	2333	4.13	68				20	88	363.3	
20	GL01-20	GL01	1856	x	2345	18.5	68	28.5	33.5	1769.5	x	2283	4.04		2	2			4	16.2	
21	GL01-21	GL01	1631	x	2395	18.5	18.5	28.5	33.5	1594	x	2333	3.72	34				10	44	163.6	
22	GL01-22	GL01	837.5	x	895	18.5	18.5	28.5	33.5	800.5	x	833	0.67	34		1	1	10	46	30.7	
23	GL01-23	GL01	1425	x	2395	18.5	18.5	28.5	33.5	1388	x	2333	3.24	34				10	44	142.5	
24	GL01-24	GL01	1837.5	x	2395	68	18.5	28.5	33.5	1751	x	2333	4.09	34				10	44	179.7	
25	GL01-25	GL01	1425	x	2345	18.5	18.5	28.5	33.5	1388	x	2283	3.17		1	1			2	6.3	
26	GL01-26	GL01	1837.5	x	2345	68	18.5	28.5	33.5	1751	x	2283	4.00		1	1			2	8.0	
27	GL01-27	GL01	1746	x	2395	68	18.5	28.5	33.5	1659.5	x	2333	3.87	34				10	44	170.4	
28	GL01-28	GL01	1746	x	2345	68	18.5	28.5	33.5	1659.5	x	2283	3.79		1	1			2	7.6	
29	GL01-29	GL01	1581	x	2395	18.5	18.5	28.5	33.5	1544	x	2333	3.60	34				10	44	158.5	
																			0.0		
1	GL02-01	GL02	665	x	1500	18.5	18.5	28.5	28.5	628	x	1443	0.91	34				10	44	39.9	
2	GL02-02	GL02	665	x	1450	18.5	18.5	28.5	28.5	628	x	1393	0.87		1	1			2	1.7	
3	GL02-03	GL02	700	x	1500	18.5	18.5	28.5	28.5	663	x	1443	0.96	238				70	308	294.7	
4	GL02-04	GL02	700	x	1450	18.5	18.5	28.5	28.5	663	x	1393	0.92		7	7			14	12.9	
5	GL02-05	GL02	681	x	1500	18.5	26	28.5	28.5	636.5	x	1443	0.92	476				140	616	565.8	
6	GL02-06	GL02	681	x	1450	18.5	18.5	28.5	28.5	644	x	1393	0.90		6	6			12	10.8	
7	GL02-07	GL02	622.5	x	1500	18.5	18.5	28.5	28.5	585.5	x	1443	0.84	68				20	88	74.3	
8	GL02-08	GL02	765	x	1500	68	18.5	28.5	28.5	678.5	x	1443	0.98	136				40	176	172.3	
9	GL02-09	GL02	765	x	1450	68	18.5	28.5	28.5	678.5	x	1393	0.95		4	4			8	7.6	
10	GL02-10	GL02	837.5	x	1500	18.5	18.5	28.5	28.5	800.5	x	1443	1.16	34				10	44	50.8	
11	GL02-11	GL02	837.5	x	1450	18.5	18.5	28.5	28.5	800.5	x	1393	1.12		1	1			2	2.2	
12	GL02-12	GL02	700	x	1500	26	18.5	28.5	28.5	655.5	x	1443	0.95	68				20	88	83.2	
																			0	0.0	
1	GL03-01	GL03	665	x	905	18.5	18.5	33.5	293.5	628	x	578	0.36	34		1	1	10	46	16.7	
2	GL03-02	GL03	1640	x	905	18.5	18.5	33.5	28.5	1603	x	843	1.35	34			1		35	47.3	
3	GL03-03	GL03	1640	x	905	18.5	18.5	33.5	293.5	1603	x	578	0.93		1			10	11	10.2	
4	GL03-04	GL03	1830	x	905	18.5	18.5	33.5	28.5	1793	x	843	1.51	34			1		35	52.9	
5	GL03-05	GL03	1830	x	905	18.5	18.5	33.5	293.5	1793	x	578	1.04		1			10	11	11.4	
6	GL03-06	GL03	1562.5	x	905	18.5	18.5	33.5	28.5	1525.5	x	843	1.29	34			1		35	45.0	
7	GL03-07	GL03	1562.5	x	905	18.5	18.5	33.5	293.5	1525.5	x	578	0.88		1			10	11	9.7	
8	GL03-08	GL03	700	x	905	18.5	18.5	33.5	28.5	663	x	843	0.56	272		4	8	40	324	181.1	
9	GL03-09	GL03	700	x	905	18.5	18.5	33.5	293.5	663	x	578	0.38		2			20	22	8.4	
10	GL03-10	GL03	1400	x	905	18.5	18.5	33.5	293.5	1363	x	578	0.79	34		1	1	10	46	36.2	
11	GL03-11	GL03	1362.5	x	905	18.5	18.5	33.5	28.5	1325.5	x	843	1.12	204		4	6	40	254	283.8	
12	GL03-12	GL03	681	x	905	18.5	18.5	33.5	28.5	644	x	843	0.54		238		4	7	40	289	156.9
13	GL03-13	GL03	1309	x	905	18.5	18.5	33.5	28.5	1272	x	843	1.07	34		1	1	10	46	49.3	
14	GL03-14	GL03	1699	x	905	18.5	18.5	33.5	28.5	1662	x	843	1.40	34		1	1	10	46	64.4	
15	GL03-15	GL03	1245	x	905	18.5	18.5	33.5	28.5	1208	x	843	1.02	68		2	2	20	92	93.7	
16	GL03-17	GL03	1362.5	x	905	18.5	18.5	298.5	293.5	1325.5	x	313	0.41		2			20	22	9.1	
17	GL03-18	GL03	681	x	905	18.5	18.5	298.5	293.5	644	x	313	0.20		2			20	22	4.4	
18	GL03-19	GL03	1856	x	905	18.5	68	33.5	28.5	1769.5	x	843	1.49	68			2		70	104.4	
19	GL03-20	GL03	1856	x	905	18.5	68	298.5	293.5	1769.5	x	313	0.55		1			10	11	6.1	
20	GL03-21	GL03	765	x	905	68	18.5	33.5	28.5	678.5	x	843	0.57	136			4		140	80.1	
21	GL03-22	GL03	765	x	905	68	18.5	298.5	293.5	678.5	x	313	0.21		3			30	33	7.0	

GL1

3605

GL2

1316

T1

J858康城11期单元幕墙玻璃分层统计表

工程: J858康城11期(T1)

日期: 12-Mar-22

序号	玻璃编号	玻璃类型	中线尺寸				玻璃尺寸				单面积 (m2)	分层数量				总数量									
			W(mm)	x	H(mm)		左-	右-	上-	下-		W(mm)	x	H(mm)			9F(10,12-16,18-20,22-25,27-29,31-33,36-38,41-42,45-47,49-51,53-56,58-60F相同,共34层)	11F	40F	17F(21,26,30,35,39,43,48,52,57F相同,共10层)					
22	GL03-23	GL03	765	x	905	68	18.5	33.5	293.5	678.5	x	578	0.39				1		10		11	4.3			
23	GL03-24	GL03	1856	x	905	18.5	68	33.5	293.5	1769.5	x	578	1.02				1		10		11	11.3			
24	GL03-25	GL03	681	x	905	18.5	18.5	33.5	293.5	644	x	578	0.37				1		10		11	4.1			
25	GL03-26	GL03	1362.5	x	905	18.5	18.5	298.5	28.5	1325.5	x	578	0.77	34							34	26.0			
26	GL03-27	GL03	1362.5	x	905	18.5	18.5	33.5	293.5	1325.5	x	578	0.77				1	1		10		12	9.2		
27	GL03-28	GL03	1631	x	905	18.5	18.5	33.5	28.5	1594	x	843	1.34	34			1	1		10		46	61.8		
28	GL03-29	GL03	700	x	905	18.5	18.5	298.5	293.5	663	x	313	0.21				2			20		22	4.6		
29	GL03-30	GL03	837.5	x	905	18.5	18.5	33.5	28.5	800.5	x	843	0.67	34				1				35	23.6		
30	GL03-31	GL03	837.5	x	905	18.5	18.5	298.5	293.5	800.5	x	313	0.25				1			10		11	2.8		
31	GL03-32	GL03	1425	x	905	18.5	18.5	33.5	28.5	1388	x	843	1.17	34				1				35	41.0		
32	GL03-33	GL03	1837.5	x	905	68	18.5	33.5	28.5	1751	x	843	1.48	34								35	51.7		
33	GL03-34	GL03	1425	x	905	18.5	18.5	298.5	293.5	1388	x	313	0.43				1			10		11	4.8		
34	GL03-35	GL03	1837.5	x	905	68	18.5	298.5	293.5	1751	x	313	0.55				1			10		11	6.0		
35	GL03-36	GL03	1400	x	905	18.5	18.5	33.5	28.5	1363	x	843	1.15	34				1				35	40.2		
36	GL03-37	GL03	1400	x	905	18.5	18.5	298.5	293.5	1363	x	313	0.43				1			10		11	4.7		
37	GL03-38	GL03	1746	x	905	68	18.5	33.5	28.5	1659.5	x	843	1.40	34				1				35	49.0		
38	GL03-39	GL03	1746	x	905	68	18.5	298.5	293.5	1659.5	x	313	0.52				1			10		11	5.7		
39	GL03-40	GL03	1581	x	905	18.5	18.5	33.5	28.5	1544	x	843	1.30	34				1	1		10		46	59.9	
40	GL03-89	GL03	1362.5	x	482.5	18.5	18.5	33.5	28.5	1325.5	x	420.5	0.56				4	4				8	4.5		
41	GL03-90	GL03	681	x	482.5	18.5	18.5	33.5	28.5	644	x	420.5	0.27				4	4				8	2.2		
42	GL03-91	GL03	1309	x	482.5	18.5	18.5	33.5	28.5	1272	x	420.5	0.53				1	1				2	1.1		
43	GL03-92	GL03	1699	x	482.5	18.5	18.5	33.5	28.5	1662	x	420.5	0.70				1	1				2	1.4		
44	GL03-93	GL03	1245	x	482.5	18.5	18.5	33.5	28.5	1208	x	420.5	0.51				2	2				4	2.0		
45	GL03-94	GL03	1631	x	482.5	18.5	18.5	33.5	28.5	1594	x	420.5	0.67				1	1				2	1.3		
46	GL03-95	GL03	700	x	482.5	18.5	18.5	33.5	28.5	663	x	420.5	0.28				4	4				8	2.2		
47	GL03-96	GL03	1581	x	482.5	18.5	18.5	33.5	28.5	1544	x	420.5	0.65				1	1				2	1.3		
48	GL03-62	GL03	609	x	2395	7.5	7.5	28.5	33.5	594	x	2333	1.39	68						20		88	122.0		
49	GL03-63	GL03	609	x	2345	7.5	7.5	28.5	33.5	594	x	2283	1.36				2	2				4	5.4		
50	GL03-64	GL03	609	x	905	7.5	7.5	33.5	293.5	594	x	578	0.34	68				2	2		20		92	31.6	
51	GL03-65	GL03	790	x	2395	7.5	7.5	28.5	33.5	775	x	2333	1.81	34						10		44	79.6		
52	GL03-66	GL03	790	x	2345	7.5	7.5	28.5	33.5	775	x	2283	1.77				1	1				2	3.5		
53	GL03-67	GL03	790	x	905	7.5	7.5	33.5	28.5	775	x	843	0.65	34				1				35	22.9		
54	GL03-68	GL03	790	x	905	7.5	7.5	33.5	293.5	775	x	578	0.45				1			10		11	4.9		
55	GL03-69	GL03	887.5	x	2395	7.5	7.5	28.5	33.5	872.5	x	2333	2.04	34						10		44	89.6		
56	GL03-70	GL03	887.5	x	2345	7.5	7.5	28.5	33.5	872.5	x	2283	1.99				1	1				2	4.0		
57	GL03-71	GL03	887.5	x	905	7.5	7.5	33.5	28.5	872.5	x	843	0.74	34				1				35	25.7		
58	GL03-72	GL03	887.5	x	905	7.5	7.5	33.5	293.5	872.5	x	578	0.50				1			10		11	5.5		
59	GL03-73	GL03	625	x	2395	7.5	7.5	28.5	33.5	610	x	2333	1.42	68						20		88	125.2		
60	GL03-74	GL03	625	x	2345	7.5	7.5	28.5	33.5	610	x	2283	1.39				2	2				4	5.6		
61	GL03-75	GL03	625	x	905	7.5	7.5	33.5	28.5	610	x	843	0.51	68				2	2		20		92	47.3	
62	GL03-76	GL03	815	x	2395	7.5	7.5	28.5	33.5	800	x	2333	1.87	34						10		44	82.1		
63	GL03-77	GL03	815	x	2345	7.5	7.5	28.5	33.5	800	x	2283	1.83				1	1				2	3.7		
64	GL03-78	GL03	815	x	905	7.5	7.5	33.5	28.5	800	x	843	0.67	34				1				35	23.6		
65	GL03-79	GL03	815	x	905	7.5	7.5	298.5	293.5	800	x	313	0.25				1			10		11	2.8		
66	GL03-80	GL03	960	x	2395	7.5	7.5	28.5	33.5	945	x	2333	2.20	34						10		44	97.0		
67	GL03-81	GL03	960	x	2345	7.5	7.5	28.5	33.5	945	x	2283	2.16				1	1				2	4.3		
68	GL03-82	GL03	960	x	905	7.5	7.5	33.5	28.5	945	x	843	0.80	34				1				35	27.9		
69	GL03-83	GL03	960	x	905	7.5	7.5	298.5	293.5	945	x	313	0.30				1			10		11	3.3		
1	GS01-01	GS01	1212	x	2747	166	36	186	187	1010	x	2374	2.40	34						10		44	105.5		
2	GS01-02	GS01	1113	x	2747	99	36	122	100	978	x	2525	2.47	34						10		44	108.7		
3	GS01-03	GS01	1237	x	2747	166	36	186	187	1035	x	2374	2.46	34						10		44	108.1		
4	GS01-04	GS01	1138	x	2747	99	36	122	100	1003	x	2525	2.53	34						10		44	111.4		
5	GS01-05	GS01	1219.5	x	2747	166	36	186	187	1017.5	x	2374	2.42	204						60		264	637.7		
6	GS01-06	GS01	1120.5	x	2747	99	36	122	100	985.5	x	2525	2.49	204						60		264	656.9		
7	GS01-07	GS01	1179.5	x	2747	166	36	186	187	977.5	x	2374	2.32	68						20		88	204.2		
8	GS01-08	GS01	1080.5	x	2747	99	36	122	100	945.5	x	2525	2.39	68						20		88	210.1		
9	GS01-09	GS01	1222	x	2747	166	36	186	187	1020	x	2374	2.42	34						10		44	106.5		
10	GS01-10	GS01	1123	x	2747	99	36	122	100	988	x	2525	2.49	34						10		44	109.8		
11	GS01-11	GS01	1207	x	2747	166	36	186	187	1005	x	2374	2.39	68						20		88	210.0		
12	GS01-12	GS01	1108	x	2747	99	36	122	100	973	x	2525	2.46	68						20		88	216.2		
1	GL04-01	GL04	665	x	135	60	60	0	0	545	x	135	0.07	34						10		44	3.2		
2	GL04-02	GL04	700	x	135	60	60	0	0	580	x	135	0.08	306						90		396	31.0		
3	GL04-03	GL04	681	x	135	60	60	0	0	561	x	135	0.08	476						140		616	46.7		
4	GL04-04	GL04	622.5	x	135	60	60	0	0	502.5	x	135	0.07	68						20		88	6.0		
5	GL04-05	GL04	765	x	135	231	60	0	0	474	x	135	0.06	136						40		176	11.3		
6	GL04-06	GL04	837.5	x	135	60	60	0	0	717.5	x	135	0.10	34						10		44	4.3		
														总数量	6936			129	129		2040		0	9234	10330.9

GL3

2522

GL1

2785

GL4

102

注:

1	GL01	10mm THK. HEAT STRENGTHEN GLASS (OUTSIDE) W/ LOW-E COATING ON SURFACE #2 + 12 mm AIR SPACE + 12mm THK. CLEAR TEMPERED GLASS(INSIDE)	IGU</
---	------	---	-------

J858康城11期单元幕墙玻璃分层统计表

工程: J858康城11期(T2)

日期: 16-Mar-22

序号	玻璃编号	玻璃类型	中线尺寸				玻璃尺寸				单面积 (m2)	分层数量				总数量						
			W(mm)	x	H(mm)		左-	右-	上-	下-		W(mm)	x	H(mm)			9F(10,12-16,18-20,22-25,27-29,31-33,36-38,41-42,45-47,49-51,53-56,58-60,52-65F相同,共37层)	11F	40F	17F(21,26,30,35,39,43,48,52,57,61,66F相同,共12层)		
1	GL01-02	GL01	700	x	895	18.5	18.5	28.5	33.5	663	x	833	0.55				333	6	6	108	453	250.2
2	GL01-03	GL01	681	x	895	18.5	18.5	28.5	33.5	644	x	833	0.54				518	8	8	168	702	376.6
3	GL01-04	GL01	622.5	x	895	18.5	18.5	28.5	33.5	585.5	x	833	0.49				37			12	49	23.9
4	GL01-05	GL01	765	x	895	68	18.5	28.5	33.5	678.5	x	833	0.57				111	3	3	36	153	86.5
5	GL01-10	GL01	1562.5	x	2395	18.5	18.5	28.5	33.5	1525.5	x	2333	3.56				37			12	49	174.4
6	GL01-11	GL01	1562.5	x	2345	18.5	18.5	28.5	33.5	1525.5	x	2283	3.48					1	1		2	7.0
7	GL01-12	GL01	700	x	2395	18.5	18.5	28.5	33.5	663	x	2333	1.55				74			24	98	151.6
8	GL01-13	GL01	700	x	2345	18.5	18.5	28.5	33.5	663	x	2283	1.51					1	1		2	3.0
9	GL01-14	GL01	681	x	2395	18.5	18.5	28.5	33.5	644	x	2333	1.50				259			84	343	515.3
10	GL01-15	GL01	1309	x	2395	18.5	18.5	28.5	33.5	1272	x	2333	2.97				37			12	49	145.4
11	GL01-17	GL01	622.5	x	2395	18.5	18.5	28.5	33.5	585.5	x	2333	1.37				37			12	49	66.9
12	GL01-18	GL01	681	x	2345	18.5	18.5	28.5	33.5	644	x	2283	1.47					4	4		8	11.8
13	GL01-19	GL01	1856	x	2395	18.5	68	28.5	33.5	1769.5	x	2333	4.13				111			36	147	606.9
14	GL01-20	GL01	1856	x	2345	18.5	68	28.5	33.5	1769.5	x	2283	4.04					3	3		6	24.2
15	GL01-30	GL01	1724	x	2395	18.5	18.5	28.5	33.5	1687	x	2333	3.94				37			12	49	192.9
16	GL01-31	GL01	1855	x	2395	18.5	18.5	28.5	33.5	1818	x	2333	4.24				37			12	49	207.8
17	GL01-32	GL01	990	x	2395	18.5	18.5	28.5	33.5	953	x	2333	2.22				37			12	49	108.9
18	GL01-33	GL01	1855	x	2345	18.5	18.5	28.5	33.5	1818	x	2283	4.15					1	1		2	8.3
19	GL01-34	GL01	990	x	2345	18.5	18.5	28.5	33.5	953	x	2283	2.18					1	1		2	4.4
20	GL01-35	GL01	615	x	895	18.5	18.5	28.5	33.5	578	x	833	0.48				37	1	1	12	51	24.6
21	GL01-36	GL01	1656	x	2395	18.5	18.5	28.5	33.5	1619	x	2333	3.78				37			12	49	185.1
22	GL01-37	GL01	1326	x	2395	18.5	18.5	28.5	33.5	1289	x	2333	3.01				37			12	49	147.4
23	GL01-38	GL01	1326	x	2345	18.5	18.5	28.5	33.5	1289	x	2283	2.94					1	1		2	5.9
24	GL01-39	GL01	1080	x	2395	18.5	18.5	28.5	33.5	1043	x	2333	2.43				37			12	49	119.2
25	GL01-40	GL01	1080	x	2345	18.5	18.5	28.5	33.5	1043	x	2283	2.38					1	1		2	4.8
26	GL01-41	GL01	1027.5	x	2395	18.5	18.5	28.5	33.5	990.5	x	2333	2.31				37			12	49	113.2
27	GL01-42	GL01	1027.5	x	2345	18.5	18.5	28.5	33.5	990.5	x	2283	2.26					1	1		2	4.5
28	GL01-43	GL01	750	x	2395	18.5	18.5	28.5	33.5	713	x	2333	1.66				74			24	98	163.0
																					0	0.0
1	GL02-03	GL02	700	x	1500	18.5	18.5	28.5	28.5	663	x	1443	0.96				185			60	245	234.4
2	GL02-04	GL02	700	x	1450	18.5	18.5	28.5	28.5	663	x	1393	0.92					6	6		12	11.1
3	GL02-05	GL02	681	x	1500	18.5	26	28.5	28.5	636.5	x	1443	0.92				518			168	686	630.1
4	GL02-06	GL02	681	x	1450	18.5	18.5	28.5	28.5	644	x	1393	0.90					8	8		16	14.4
5	GL02-07	GL02	622.5	x	1500	18.5	18.5	28.5	28.5	585.5	x	1443	0.84				37			12	49	41.4
6	GL02-08	GL02	765	x	1500	68	18.5	28.5	28.5	678.5	x	1443	0.98				111			36	147	143.9
7	GL02-09	GL02	765	x	1450	68	18.5	28.5	28.5	678.5	x	1393	0.95					3	3		6	5.7
8	GL02-12	GL02	700	x	1500	26	18.5	28.5	28.5	655.5	x	1443	0.95				148			48	196	185.4
9	GL02-13	GL02	615	x	1500	18.5	18.5	28.5	28.5	578	x	1443	0.83				37			12	49	40.9
10	GL02-14	GL02	615	x	1450	18.5	18.5	28.5	28.5	578	x	1393	0.81					1	1		2	1.6
																					0	0.0
1	GL03-06	GL03	1562.5	x	905	18.5	18.5	33.5	28.5	1525.5	x	843	1.29				37		1		38	48.9
2	GL03-07	GL03	1562.5	x	905	18.5	18.5	33.5	293.5	1525.5	x	578	0.88					1		12	13	11.5
3	GL03-08	GL03	700	x	905	18.5	18.5	33.5	28.5	663	x	843	0.56				222	4	6	48	280	156.5
4	GL03-09	GL03	700	x	905	18.5	18.5	33.5	293.5	663	x	578	0.38					2		24	26	10.0
5	GL03-10	GL03	1400	x	905	18.5	18.5	33.5	293.5	1363	x	578	0.79				37		1	12	51	40.2
6	GL03-11	GL03	1362.5	x	905	18.5	18.5	33.5	28.5	1325.5	x	843	1.12				222	4	6	48	280	312.9
7	GL03-12	GL03	681	x	905	18.5	18.5	33.5	28.5	644	x	843	0.54				259	4	7	48	318	172.6
8	GL03-13	GL03	1309	x	905	18.5	18.5	33.5	28.5	1272	x	843	1.07				37		1	12	51	54.7
9	GL03-15	GL03	1245	x	905	18.5	18.5	33.5	28.5	1208	x	843	1.02				37		1	12	51	51.9
10	GL03-17	GL03	1362.5	x	905	18.5	18.5	298.5	293.5	1325.5	x	313	0.41					3		36	39	16.2
11	GL03-18	GL03	681	x	905	18.5	18.5	298.5	293.5	644	x	313	0.20					3		36	39	7.9
12	GL03-19	GL03	1856	x	905	18.5	68	33.5	28.5	1769.5	x	843	1.49				111		3		114	170.1
13	GL03-20	GL03	1856	x	905	18.5	68	298.5	293.5	1769.5	x	313	0.55					3		36	39	21.6
14	GL03-21	GL03	765	x	905	68	18.5	33.5	28.5	678.5	x	843	0.57				111		3		114	65.2
15	GL03-22	GL03	765	x	905	68	18.5	298.5	293.5	678.5	x	313	0.21					3		36	39	8.3
16	GL03-27	GL03	1362.5	x	905	18.5	18.5	33.5	293.5	1325.5	x	578	0.77				37		1		38	29.1
17	GL03-41	GL03	1724	x	905	18.5	18.5	33.5	28.5	1687	x	843	1.42				37		1	12	51	72.5
18	GL03-42	GL03	1855	x	905	18.5	18.5	33.5	28.5	1818	x	843	1.53						1		38	58.2
19	GL03-43	GL03	1690	x	905	18.5	18.5	33.5	28.5	1653	x	843	1.39				37		1		38	53.0
20	GL03-44	GL03	1855	x	905	18.5	18.5	33.5	293.5	1818	x	578	1.05					1		12	13	13.7
21	GL03-45	GL03	1690	x	905	18.5	18.5	33.5	293.5	1653	x	578	0.96					1		12	13	12.4
22	GL03-46	GL03	615	x	905	18.5	18.5	33.5	293.5	578	x	578	0.33				37		1	12	51	17.0
23	GL03-47	GL03	1656	x	905	18.5	18.5	33.5	28.5	1619	x	843	1.36				37		1	12	51	69.6
24	GL03-48	GL03	1326	x	905	18.5	18.5	33.5	28.5	1289	x	843	1.09				37		1	12	51	55.4
25	GL03-49	GL03	1780	x	905	18.5	18.5	33.5	28.5	1743	x	843	1.47				37		1		38	55.8
26	GL03-50	GL03	1780	x	905	18.5	18.5	298.5	293.5	1743	x	313	0.55					1		12	13	7.1
27	GL03-51	GL03	1727.5	x	905	18.5	18.5	33.5	28.5	1690.5	x	843	1.43				37		1		38	54.2

GL1

3734

GL2

1309

Tv

J858康城11期单元幕墙玻璃分层统计表

工程: J858康城11期(T3)

日期: 18-Mar-22

序号	玻璃编号	玻璃类型	中线尺寸				玻璃尺寸				单面积 (m ²)	分层数量					总数量				
			W(mm)	x	H(mm)		左	右	上	下		W(mm)	x	H(mm)	9F(10,12-16,18-20,22-25,27-29,31-33,36-38,41-42,45-47,49-51,53-56,58-60,52-65F相同,共37层)	11F		40F	17F(21,26,30,35,39,43,48,52,57,61,66F相同,共12层)	5F	
1	GL01-02	GL01	700	x	895	18.5	18.5	28.5	33.5	663	x	833	0.55	407		8	8	132		555	306.5
2	GL01-03	GL01	681	x	895	18.5	18.5	28.5	33.5	644	x	833	0.54	370		2	2	120		494	265.0
3	GL01-04	GL01	622.5	x	895	18.5	18.5	28.5	33.5	585.5	x	833	0.49	37				12		49	23.9
4	GL01-05	GL01	765	x	895	68	18.5	28.5	33.5	678.5	x	833	0.57	111		3	3	36		153	86.5
5	GL01-10	GL01	1562.5	x	2395	18.5	18.5	28.5	33.5	1525.5	x	2333	3.56	37				12		49	174.4
6	GL01-11	GL01	1562.5	x	2345	18.5	18.5	28.5	33.5	1525.5	x	2283	3.48			1	1			2	7.0
7	GL01-12	GL01	700	x	2395	18.5	18.5	28.5	33.5	663	x	2333	1.55	74				24		98	151.6
8	GL01-13	GL01	700	x	2345	18.5	18.5	28.5	33.5	663	x	2283	1.51			1	1			2	3.0
9	GL01-14	GL01	681	x	2395	18.5	18.5	28.5	33.5	644	x	2333	1.50	185				60		245	368.1
10	GL01-15	GL01	1309	x	2395	18.5	18.5	28.5	33.5	1272	x	2333	2.97	37				12		49	145.4
11	GL01-17	GL01	622.5	x	2395	18.5	18.5	28.5	33.5	585.5	x	2333	1.37	37				12		49	66.9
12	GL01-18	GL01	681	x	2345	18.5	18.5	28.5	33.5	644	x	2283	1.47			1	1			2	2.9
13	GL01-19	GL01	1856	x	2395	18.5	68	28.5	33.5	1769.5	x	2333	4.13	37				12		49	202.3
14	GL01-20	GL01	1856	x	2345	18.5	68	28.5	33.5	1769.5	x	2283	4.04			1	1			2	8.1
15	GL01-22	GL01	837.5	x	895	18.5	18.5	28.5	33.5	800.5	x	833	0.67	37		1	1	12		51	34.0
16	GL01-23	GL01	1425	x	2395	18.5	18.5	28.5	33.5	1388	x	2333	3.24	37				12		49	158.7
17	GL01-24	GL01	1837.5	x	2395	68	18.5	28.5	33.5	1751	x	2333	4.09	37				12		49	200.2
18	GL01-25	GL01	1425	x	2345	18.5	18.5	28.5	33.5	1388	x	2283	3.17			1	1			2	6.3
19	GL01-26	GL01	1837.5	x	2345	68	18.5	28.5	33.5	1751	x	2283	4.00			1	1			2	8.0
20	GL01-30	GL01	1724	x	2395	18.5	18.5	28.5	33.5	1687	x	2333	3.94	37				12		49	192.9
21	GL01-31	GL01	1855	x	2395	18.5	18.5	28.5	33.5	1818	x	2333	4.24	37				12		49	207.8
22	GL01-32	GL01	990	x	2395	18.5	18.5	28.5	33.5	953	x	2333	2.22	37				12		49	108.9
23	GL01-33	GL01	1855	x	2345	18.5	18.5	28.5	33.5	1818	x	2283	4.15			1	1			2	8.3
24	GL01-34	GL01	990	x	2345	18.5	18.5	28.5	33.5	953	x	2283	2.18			1	1			2	4.4
25	GL01-35	GL01	615	x	895	18.5	18.5	28.5	33.5	578	x	833	0.48	37		1	1	12		51	24.6
26	GL01-36	GL01	1656	x	2395	18.5	18.5	28.5	33.5	1619	x	2333	3.78	37				12		49	185.1
27	GL01-43	GL01	750	x	2395	18.5	18.5	28.5	33.5	713	x	2333	1.66	74				24		98	163.0
28	GL01-44	GL01	1125	x	2395	18.5	68	28.5	33.5	1038.5	x	2333	2.42	37				12		49	118.7
29	GL01-45	GL01	1125	x	2345	18.5	68	28.5	33.5	1038.5	x	2283	2.37			1	1			2	4.7
30	GL01-46	GL01	1326	x	2395	18.5	18.5	28.5	33.5	1289	x	2333	3.01	37				12		49	147.4
31	GL01-47	GL01	1590	x	2395	18.5	18.5	28.5	33.5	1553	x	2333	3.62	37				12		49	177.5
32	GL01-48	GL01	1590	x	2345	18.5	18.5	28.5	33.5	1553	x	2283	3.55			1	1			2	7.1
																					0.0
																					3569
1	GL02-03	GL02	700	x	1500	18.5	18.5	28.5	28.5	663	x	1443	0.96	259				84		343	328.2
2	GL02-04	GL02	700	x	1450	18.5	18.5	28.5	28.5	663	x	1393	0.92			8	8			16	14.8
3	GL02-05	GL02	681	x	1500	18.5	26	28.5	28.5	636.5	x	1443	0.92	370				120		490	450.1
4	GL02-06	GL02	681	x	1450	18.5	18.5	28.5	28.5	644	x	1393	0.90			2	2			4	3.6
5	GL02-07	GL02	622.5	x	1500	18.5	18.5	28.5	28.5	585.5	x	1443	0.84	37				12		49	41.4
6	GL02-08	GL02	765	x	1500	68	18.5	28.5	28.5	678.5	x	1443	0.98	111				36		147	143.9
7	GL02-09	GL02	765	x	1450	68	18.5	28.5	28.5	678.5	x	1393	0.95			3	3			6	5.7
8	GL02-10	GL02	837.5	x	1500	18.5	18.5	28.5	28.5	800.5	x	1443	1.16	37				12		49	56.6
9	GL02-11	GL02	837.5	x	1450	18.5	18.5	28.5	28.5	800.5	x	1393	1.12			1	1			2	2.2
10	GL02-12	GL02	700	x	1500	26	18.5	28.5	28.5	655.5	x	1443	0.95	148				48		196	185.4
11	GL02-13	GL02	615	x	1500	18.5	18.5	28.5	28.5	578	x	1443	0.83	37				12		49	40.9
12	GL02-14	GL02	615	x	1450	18.5	18.5	28.5	28.5	578	x	1393	0.81			1	1			2	1.6
																					0.0
																					-1274
1	GL03-06	GL03	1562.5	x	905	18.5	18.5	33.5	28.5	1525.5	x	843	1.29	37			1			38	48.9
2	GL03-07	GL03	1562.5	x	905	18.5	18.5	33.5	293.5	1525.5	x	578	0.88			1		12		13	11.5
3	GL03-08	GL03	700	x	905	18.5	18.5	33.5	28.5	663	x	843	0.56	333		4	9	48		394	220.2
4	GL03-09	GL03	700	x	905	18.5	18.5	33.5	293.5	663	x	578	0.38			4		48		52	19.9
5	GL03-10	GL03	1400	x	905	18.5	18.5	33.5	293.5	1363	x	578	0.79	37		1	1	12		51	40.2
6	GL03-11	GL03	1362.5	x	905	18.5	18.5	33.5	28.5	1325.5	x	843	1.12	148		4	4	48		204	227.9
7	GL03-12	GL03	681	x	905	18.5	18.5	33.5	28.5	644	x	843	0.54	185		4	5	48		242	131.4
8	GL03-13	GL03	1309	x	905	18.5	18.5	33.5	28.5	1272	x	843	1.07	37		1	1	12		51	54.7
9	GL03-15	GL03	1245	x	905	18.5	18.5	33.5	28.5	1208	x	843	1.02	37		1	1	12		51	51.9
10	GL03-17	GL03	1362.5	x	905	18.5	18.5	298.5	293.5	1325.5	x	313	0.41			1		12		13	5.4
11	GL03-18	GL03	681	x	905	18.5	18.5	298.5	293.5	644	x	313	0.20			1		12		13	2.6
12	GL03-19	GL03	1856	x	905	18.5	68	33.5	28.5	1769.5	x	843	1.49	37			1			38	56.7
13	GL03-20	GL03	1856	x	905	18.5	68	298.5	293.5	1769.5	x	313	0.55			1		12		13	7.2
14	GL03-21	GL03	765	x	905	68	18.5	33.5	28.5	678.5	x	843	0.57	111			3			114	65.2
15	GL03-22	GL03	765	x	905	68	18.5	298.5	293.5	678.5	x	313	0.21			2		24		26	5.5
16	GL03-23	GL03	765	x	905	68	18.5	33.5	293.5	678.5	x	578	0.39			1		12		13	5.1
17	GL03-27	GL03	1362.5	x	905	18.5	18.5	33.5	293.5	1325.5	x	578	0.77	37			1			38	29.1
18	GL03-29	GL03	700	x	905	18.5	18.5	298.5	293.5	663	x	313	0.21			1		12		13	2.7

GL1

GL2
-1274

T3

J858康城11期单元幕墙玻璃分层统计表

工程: J858康城11期(T3)
日期: 18-Mar-22

序号	玻璃编号	玻璃类型	中线尺寸				玻璃尺寸				单面积 (m2)	分层数量					总数量		
			W(mm)	x	H(mm)	左-	右-	上-	下-	W(mm)		x	H(mm)	9F(10,12-16,18-20,22-25,27-29,31-33,36-38,41-42,45-47,49-51,53-56,58-60,52-65F相同,共37层)	11F	40F		17F(21,26,30,35,39,43,48,52,57,61,66F相同,共12层)	5F
19	GL03-30	GL03	837.5	x	905	18.5	18.5	33.5	28.5	800.5	x	843	0.67	37		1			38
20	GL03-32	GL03	1425	x	905	18.5	18.5	33.5	28.5	1388	x	843	1.17	37		1			38
21	GL03-33	GL03	1837.5	x	905	68	18.5	33.5	28.5	1751	x	843	1.48	37		1			38
22	GL03-41	GL03	1724	x	905	18.5	18.5	33.5	28.5	1687	x	843	1.42	37	1	1	12		51
23	GL03-42	GL03	1855	x	905	18.5	18.5	33.5	28.5	1818	x	843	1.53	37		1			38
24	GL03-43	GL03	1690	x	905	18.5	18.5	33.5	28.5	1653	x	843	1.39	37		1			38
25	GL03-44	GL03	1855	x	905	18.5	18.5	33.5	293.5	1818	x	578	1.05		1		12		13
26	GL03-45	GL03	1690	x	905	18.5	18.5	33.5	293.5	1653	x	578	0.96		1		12		13
27	GL03-46	GL03	615	x	905	18.5	18.5	33.5	293.5	578	x	578	0.33	37	1	1	12		51
28	GL03-47	GL03	1656	x	905	18.5	18.5	33.5	28.5	1619	x	843	1.36	37	1	1	12		51
29	GL03-53	GL03	750	x	905	18.5	18.5	33.5	28.5	713	x	843	0.60	74	2	2	24		102
30	GL03-54	GL03	1825	x	905	18.5	68	33.5	28.5	1738.5	x	843	1.47	37		1			38
31	GL03-55	GL03	1825	x	905	18.5	68	298.5	293.5	1738.5	x	313	0.54		1		12		13
32	GL03-56	GL03	837.5	x	905	18.5	18.5	33.5	293.5	800.5	x	578	0.46		1		12		13
33	GL03-57	GL03	1425	x	905	18.5	18.5	33.5	293.5	1388	x	578	0.80		1		12		13
34	GL03-58	GL03	1837.5	x	905	68	18.5	33.5	293.5	1751	x	578	1.01		1		12		13
35	GL03-59	GL03	1326	x	905	18.5	18.5	33.5	28.5	1289	x	843	1.09	37	1	1	12		51
36	GL03-60	GL03	1590	x	905	18.5	18.5	33.5	28.5	1553	x	843	1.31	37		1			38
37	GL03-61	GL03	1590	x	905	18.5	18.5	298.5	293.5	1553	x	313	0.49		1		12		13
38	GL03-89	GL03	1362.5	x	482.5	18.5	18.5	33.5	28.5	1325.5	x	420.5	0.56		4	4			8
39	GL03-90	GL03	681	x	482.5	18.5	18.5	33.5	28.5	644	x	420.5	0.27		4	4			8
40	GL03-91	GL03	1309	x	482.5	18.5	18.5	33.5	28.5	1272	x	420.5	0.53		1	1			2
41	GL03-93	GL03	1245	x	482.5	18.5	18.5	33.5	28.5	1208	x	420.5	0.51		1	1			2
42	GL03-95	GL03	700	x	482.5	18.5	18.5	33.5	28.5	663	x	420.5	0.28		4	4			8
43	GL03-97	GL03	1724	x	482.5	18.5	18.5	33.5	28.5	1687	x	420.5	0.71		1	1			2
44	GL03-98	GL03	1656	x	482.5	18.5	18.5	33.5	28.5	1619	x	420.5	0.68		1	1			2
45	GL03-99	GL03	750	x	482.5	18.5	18.5	33.5	28.5	713	x	420.5	0.30		2	2			4
46	GL03-100	GL03	1326	x	482.5	18.5	18.5	33.5	28.5	1289	x	420.5	0.54		1	1			2
47	GL03-62	GL03	609	x	2395	7.5	7.5	28.5	33.5	594	x	2333	1.39	74			24		98
48	GL03-63	GL03	609	x	2345	7.5	7.5	28.5	33.5	594	x	2283	1.36		2	2			4
49	GL03-64	GL03	609	x	905	7.5	7.5	33.5	293.5	594	x	578	0.34	74	2	2	24		102
50	GL03-65	GL03	790	x	2395	7.5	7.5	28.5	33.5	775	x	2333	1.81	37			12		49
51	GL03-66	GL03	790	x	2345	7.5	7.5	28.5	33.5	775	x	2283	1.77		1	1			2
52	GL03-67	GL03	790	x	905	7.5	7.5	33.5	28.5	775	x	843	0.65	37		1			38
53	GL03-68	GL03	790	x	905	7.5	7.5	33.5	293.5	775	x	578	0.45		1		12		13
54	GL03-76	GL03	815	x	2395	7.5	7.5	28.5	33.5	800	x	2333	1.87	37			12		49
55	GL03-77	GL03	815	x	2345	7.5	7.5	28.5	33.5	800	x	2283	1.83		1	1			2
56	GL03-78	GL03	815	x	905	7.5	7.5	33.5	28.5	800	x	843	0.67	37		1			38
57	GL03-84	GL03	815	x	905	7.5	7.5	33.5	293.5	800	x	578	0.46		1		12		13
58	GL03-85	GL03	840	x	2395	7.5	7.5	28.5	33.5	825	x	2333	1.92	37			12		49
59	GL03-86	GL03	840	x	2345	7.5	7.5	28.5	33.5	825	x	2283	1.88		1	1			2
60	GL03-87	GL03	840	x	905	7.5	7.5	33.5	28.5	825	x	843	0.70	37		1			38
61	GL03-88	GL03	840	x	905	7.5	7.5	298.5	293.5	825	x	313	0.26		1		12		13
1	GS01-01	GS01	1212	x	2747	166	36	186	187	1010	x	2374	2.40	37			12		49
2	GS01-02	GS01	1113	x	2747	99	36	122	100	978	x	2525	2.47	37			12		49
3	GS01-13	GS01	1237	x	2747	166	36	186	187	1035	x	2374	2.46	37			12		49
4	GS01-14	GS01	1138	x	2747	99	36	122	100	1003	x	2525	2.53	37			12		49
5	GS01-15	GS01	1219.5	x	2747	166	36	186	187	1017.5	x	2374	2.42	296			96		392
6	GS01-16	GS01	1120.5	x	2747	99	36	122	100	985.5	x	2525	2.49	296			96		392
7	GS01-17	GS01	1179.5	x	2747	166	36	186	187	977.5	x	2374	2.32	74			24		98
8	GS01-18	GS01	1080.5	x	2747	99	36	122	100	945.5	x	2525	2.39	74			24		98
9	GS01-19	GS01	1222	x	2747	166	36	186	187	1020	x	2374	2.42	37			12		49
10	GS01-20	GS01	1123	x	2747	99	36	122	100	988	x	2525	2.49	37			12		49
1	GL04-02	GL04	700	x	135	60	60	0	0	580	x	135	0.08	407			132		539
2	GL04-03	GL04	681	x	135	60	60	0	0	561	x	135	0.08	370			120		490
3	GL04-04	GL04	622.5	x	135	60	60	0	0	502.5	x	135	0.07	37			12		49
4	GL04-05	GL04	765	x	135	231	60	0	0	474	x	135	0.06	111			36		147
5	GL04-06	GL04	837.5	x	135	60	60	0	0	717.5	x	135	0.10	37			12		49
6	GL04-07	GL04	615	x	135	60	60	0	0	495	x	135	0.07	37			12		49
																			0.0
																			100
																			10294.7

注:

1	GL01	10mm THK. HEAT STRENGTHEN GLASS (OUTSIDE) W/ LOW-E COATING ON SURFACE #2 + 12 mm AIR SPACE + 12mm THK. CLEAR TEMPERED GLASS(INSIDE)	IGU
2	GL02	10mm THK. HEAT STRENGTHEN GLASS (OUTSIDE) W/ LOW-E COATING ON SURFACE #2 + 12 mm AIR SPACE + 10mm THK. CLEAR TEMPERED GLASS(INSIDE)	IGU
3	GL03	12mm THK. HEAT STRENGTHEN GLASS	
4	GL04	12mm THK. CLEAR TEMPERED GLASS	
5	GS01	10mm THK. HEAT STRENGTHEN GLASS (OUTSIDE) W/ LOW-E COATING ON SURFACE #2 + 12 mm AIR SPACE + 12mm THK. CLEAR TEMPERED GLASS(INSIDE)	IGU

25.6
44.5
56.1
72.5
58.2
53.0
13.7
12.4
17.0
69.6
61.3
55.7
7.1
6.0
10.4
13.2
55.4
49.7
6.3
4.5
2.2
1.1
1.0
2.2
1.4
1.4
1.2
1.1
135.8
5.4
35.0
88.6
3.5
24.8
5.8
91.5
3.7
25.6
6.0
94.3
3.8
26.4
3.4
3518
2294
3108
42.2
37.1
3.3
9.4
4.7
3.3
0.0
100
10295

GL3
GL1
GL4

13

midi@midiltd.com.hk

From: Ka Hei Wong <KaHei.Wong@gammonconstruction.com>
To: "jason.lcs.midi@gmail.com" <jason.lcs.midi@gmail.com>
Subject: J3931 (LP11) - MAT to RLP - Material Submission ? Midi ? Glass
Samples for Curtain Wall at Tower 1-3 (MS14)
Date sent: Wed, 25 May 2022 09:51:02 +0000

Dear Midi,
Please find the attached material submission reply by RLP for your further action. Many thanks.

Best Regards,

Wong Ka Hei

13931 Lohas Park Package 11

Tel: 9526 4768

Legal Disclaimer

This email (and any attachments) is confidential and subject to copyright. It may be subject to legal or other professional privilege. It is intended for use by the addressee(s) only and if you have received it in error, please notify the sender immediately by return email and delete it from your system. Any personal data in this email must be handled in accordance with applicable privacy laws.

Project Proposed Residential Development at TKOTL 70RP, Phase 11, Lohas Park, Tseung Kwan O, New Territories
Works Main Contract
Contract No. J3931
Ref. No. P19084NT/MS/A/439 (Rev. 0)
GECCL Ref. J3931/304/D02681
Date 29 Jan 2022
To / Attn RLP / Mr. Kenneth Wong / Ms. Florence Cheung
Subject **Material Submission - Midi - Glass Samples for Curtain Wall at Tower 1-3 (MS14)**

We write to request this submission replied by: RLP / AECOM / WSP / Others
Anticipated date of response **12 Feb 2022**

We certify that the submission has been checked and is in full compliance with the Specification & Contract Documents, unless otherwise stated in the remarks.

Received by / / /

Received by RLP

Matthew Wong
For and on behalf of
Gammon Engineering & Construction Company Limited

Curtain wall, sliding door

- cc w/e
- Mr. KS Lee / Mr. Teddy Wu / Mr. HF Au / Mr. Si. Kwan / Mr. Jacky Cheung
 - Mr. Tony Fan
 - Mr. Ricky Ting
 - Mr. Anthony Tam
 - Mr. Herbert Chung / Mr. Francis Lau / Mr. Dayi Ke / Mr. Kenneth Leung / Mr. Andy Chan
 - Mr. Henry Lo / Mr. Cole Li
 - Ms. Monnie Lee / Ms. Phoebe Chung / Mr. Ryan Ko
 - Mr. Simon Kaan / Mr. Tommy Leung
 - Mr. Witter So / Mr. Kenif Ng
 - Mr. Morly Law
 - Mr. Keith Yim / Mr. Randolph Chan
 - Mr. Simon Tso / Mr. Ken Siu
 - Mr. Marcus Kee
 - BSI
 - Mr. Chris Tong / Mr. Louis Siu
 - Mr. David Yeung
 - Mr. Eddie Kwan
 - Mr. Andy Lai

Material / Work Description *	Glass sample
Location	<u>Precast alum window, insitu alum window</u>
Brand Name	Guangdong Haikong Special Glass Technology Co., Ltd.
Model / Reference No. *	Refer to Midi letter cover
Country of Origin	CHINA
Supplier Name	Guangdong Haikong Special Glass Technology Co. Ltd.
Others (Color / Pattern, etc.) *	N/A
Material / Work Reference *	N/A
Specification Reference	Architectural general specification - GS-12
Related Dwg. / A.I. Ref. *	N/A
Related BQ Reference	N/A
Submission Attachment	
Sample	<input checked="" type="checkbox"/> 1 set of sample
Catalogue / Technical Data *	<input checked="" type="checkbox"/> Attached
Test Report / Certificate *	<input type="checkbox"/> N/A
Equipment Schedule	<input type="checkbox"/> N/A
Method Statement	<input type="checkbox"/> N/A
Installation Details	<input type="checkbox"/> N/A
Job Reference	<input type="checkbox"/> N/A
Remarks (To list deviations, if any)	* Delete as appropriate

Review Status / Comment **B**
(REFER TO MEMOS UNDER REVIEW IN THIS SUBMISSION AS MARKED ON THE GLASS DATA PAGE).

RESPONSE TO TECHNICAL SUBMISSION

Date 01/5/2022

Comments ONLY G1, G2 & G4 UNDER REVIEW IN THIS SUBMISSION.

2/ REFER TO COMMENTS MARKED ON THE ATTACHED PAGES.

3/ G5, G51 & G52 DELETED DUE TO DESIGN CHANGE

4/ REFER TO COMMENTS FROM SIND, WSP, FACADE CONSULTANT & OTHER



RONALD LU & PARTNERS
For and on behalf of **RELEVANT PARTIES**,
Ronald Lu & Partners (Hong Kong) Ltd.

5/ PLEASE NOTE THAT IT IS CONTRACTOR'S RESPONSIBILITY TO FULFILL

No review is made of detail dimensions/quantities.

The submission is reviewed for general compliance with the design intent only.

Any comments or amendments required shall not be deemed to be variation.

The review does not release the Contractor from his responsibilities to comply with contract requirements.

For resubmission, the Contractor has to highlight or cloud those revision areas in the shop drawing for review.

Legend

A (No objection)

B (No objection, subject to comments as noted)

C (Amendment & resubmission required)

D (Rejected & resubmission required)

w/e

SKH/NFY/TT C

Replied by SE / Date

Replied by BS / Date

Replied by RLP / Date 6/5/2022

- cc w/e
- Mr. KS Lee / Mr. Teddy Wu / Mr. HF Au / Mr. Si. Kwan / Mr. Jacky Cheung
 - Mr. Tony Fan
 - Mr. Ricky Ting
 - Mr. Anthony Tam
 - Mr. Herbert Chung / Mr. Francis Lau / Mr. Dayi Ke / Mr. Kenneth Leung / Mr. Andy Chan
 - Mr. Henry Lo / Mr. Cole Li
 - Ms. Monnie Lee / Ms. Phoebe Chung / Mr. Ryan Ko
 - Mr. Simon Kaan / Mr. Tommy Leung
 - Mr. Witter So / Mr. Kenif Ng
 - Mr. Morly Law
 - Mr. Keith Yim / Mr. Randolph Chan
 - Mr. Simon Tso / Mr. Ken Siu
 - Mr. Marcus Kee
 - BSI
 - Mr. Chris Tong / Mr. Louis Siu
 - Mr. David Yeung
 - Mr. Eddie Kwan
 - Mr. Andy Lai



美特鋁質有限公司
MIDI ALUMINIUM FABRICATOR LTD.

Our ref. MC/41008/858

25th January, 2022

Gammon Construction Company Limited
22/F Tower 1, The Quayside,
77 Hoi Bun Road,
Kwun Tong, Kowloon.

By Email & Hand

Attn.: Mr. Matthew Wong

Dear Sir,

Re: Design, Supply and Installation of Curtain Wall, Glass Wall, Aluminium Window, Aluminium Cladding, Aluminium Louvres and Glass Balustrade Nominated Sub-Contract at T.K.O.T.L. 70 RP, Phase 11, LOHAS Park, Tseung Kwan O, N.T.
Submission of Glass Sample for Curtain Wall at Tower 1, 2 & 3 (MS014)

Regarding the captioned project, we would like to submit Glass samples for Curtain Wall at Tower 1, 2 & 3 for your review and comment.

Brand: Guangdong Haikong Special Glass Technology Co. Ltd.

Glass Sample 1: 10mm Low E (58T) Clear Heat Strengthened Glass+ 12A+ 12mm Clear Tempered Glass (I.G.U.) (G1)

Glass code: R20220114001 ✓
Use of Location: Curtain Wall Fixed Glass

and sliding door
(fixed and movable)

Glass Sample 2: 10mm Low E (58T) Clear Heat Strengthened Glass+ 12A+ 10mm Clear Tempered Glass (I.G.U.) (G2)

Glass code: R20220114003 ✓
Use of Location: Curtain Wall Window

Refer to our
comments on your
MS439 (rev.1)

Glass Sample 3: ~~12mm Clear Heat Strengthened Glass (G3)~~
Glass code: ~~R20220114007~~
Use of Location: ~~Curtain Wall Sprandrel~~

(for openable window
protective barrier)

Glass Sample 4: 12mm Clear Tempered Glass (G4)
Glass code: R20220114008 ✓
Use of Location: Curtain Wall

Same as G3

Glass Sample 5: ~~10mm Clear Heat Strengthened Glass (G5)~~
Glass code: ~~R20220114009~~
Use of Location: ~~Glass Cladding, Curtain Wall Sprandrel~~

.../P.2

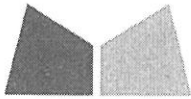

美特鋁質有限公司
MIDI ALUMINIUM FABRICATOR LTD.

Our ref. MC/41008/858

25th January, 2022

Page 2

Brand: Guangdong Haikong Special Glass Technology Co. Ltd.

Glass Sample 6: 10mm Low E (58T) Clear Heat Strengthened Glass+ 9A+ 10mm Clear Tempered Glass (I.G.U.) (GS1)

Glass code: R20220114004

Use of Location: Sliding Door (Fix)

Glass Sample 7: 8mm Heat Strengthened Glass+ 1.52mm PVB+ 8mm Heat Strengthened Glass (GS2)

Glass code: R20220114012

Use of Location: Sliding Door

Same as G1

Remarks:

1. 1 set of glass sample will be delivered to site office directly.

If you have any query, please feel free to contact us.

Thank you for your kind attention.

Yours faithfully,
MIDI ALUMINIUM FABRICATOR LTD.

Marco Tam
Director

Encl - 9 page(s)

FM/MT/DW/JL/EL/KL/yl





广东海控特种玻璃技术有限公司
Guangdong HaiKong Special Glass Technology Co., Ltd.

Items under review in this submission

玻璃性能参数 Performance Data

客户名称: 美特

项目名称: Lohas Park II

日期: 14/1-2022

	可见光 Light characteristics				太阳能 Energy characteristics					U-Value 空气 (W/m ² K)
	透光率 trans (%)	反光率 Reflection		热反射率 Reflection (%)	热透率 trans (%)	热吸收率 Abs (%)	热能系数 Solar Factor	遮阳系数 Shading Coefficient		
		外 Out (%)	内 In (%)						E.R.	
G1 ✓	50%	20%	11%	29%	51%	0.39	0.44	1.82	R20220114001 ✓	
G1x	48%	20%	10%	27%	54%	0.38	0.43	1.80	R20220114002 ✓	
G2 ✓	50%	20%	11%	30%	50%	0.39	0.45	1.83	R20220114003 ✓	
G3 / G4 ✓	86%	8%	8%	71%	22%	0.78	0.89	5.60	R20220114007 / R20220114008 ✓	
G2a	81%	8%	8%	54%	43%	0.64	0.74	5.04		
G5	87%	8%	8%	74%	19%	0.80	0.92	5.67	R20220114009 ✓	
G5x	50%	20%	11%	30%	50%	0.39	0.45	2.02	R20220114004 ✓	
G82	84%	8%	8%	66%	27%	0.74	0.85	5.25	R20220114012 ✓	
TG09	53%	6%	6%	48%	47%	0.62	0.71	5.37		

- The performance data shown are nominal and subject to variations due to manufacturing tolerances.
- A slight shift in visible light reflectance or transmission may be noticed after heat-treatment.
- The tolerance of data with respect to photometric properties is ±3 points.
- The U-value tolerance is ±0.1W/m².k.
- Specifications technical and other data are based on information available at the time of preparation this document and are subject to change without prior notice.
- The above performance parameters calculated in accordance with WINDOW6 software. All data are just for your reference, not as an official contract.

创新, 成就建筑梦想! Achieve Dreams With Innovation

G1
 G2
 G3
 G4
 G5
 G6
 G7
 G8
 G9
 G10
 G11
 G12
 G13
 G14
 G15
 G16
 G17
 G18
 G19
 G20
 G21
 G22
 G23
 G24
 G25
 G26
 G27
 G28
 G29
 G30
 G31
 G32
 G33
 G34
 G35
 G36
 G37
 G38
 G39
 G40
 G41
 G42
 G43
 G44
 G45
 G46
 G47
 G48
 G49
 G50
 G51
 G52
 G53
 G54
 G55
 G56
 G57
 G58
 G59
 G60
 G61
 G62
 G63
 G64
 G65
 G66
 G67
 G68
 G69
 G70
 G71
 G72
 G73
 G74
 G75
 G76
 G77
 G78
 G79
 G80
 G81
 G82
 G83
 G84
 G85
 G86
 G87
 G88
 G89
 G90
 G91
 G92
 G93
 G94
 G95
 G96
 G97
 G98
 G99
 G100

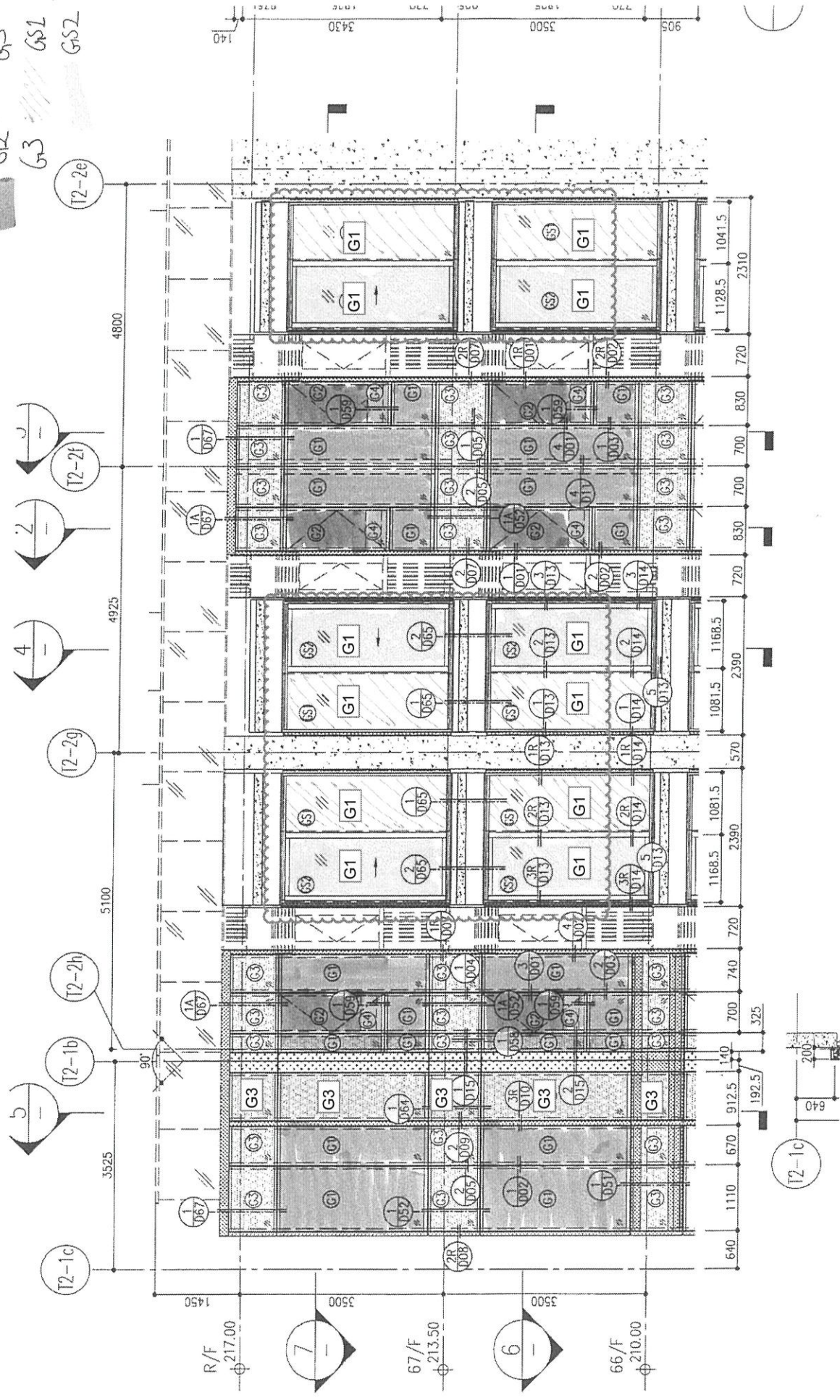



MIDI ALUMINIUM FABRICATOR LTD.

Units 6, 7, 8 Sunray Industrial Centre, 1st Floor, 610 Cha Kwo Ling Road Kowloon.

Project : T.K.O.T.L. 70 RP, Phase 11, LOHAS Park, Tseung Kwan O, N.T.

Subject : 10mm Low E (58T) Clear Heat Strengthened Glass+ 12A +
12mm Clear Tempered Glass (I.G.U.) (G1) - Glass Sample 1

Brand : Guangdong Haikong Special Glass Technology Co. Ltd.

Glass Code : R20220114001

Location : Curtain Wall Fixed Glass

Letter ref. : MC/41008/858

Date : 25th January 2022

R 20220114001

25 JAN 2022

10x12

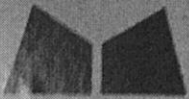

MIDI ALUMINIUM FABRICATOR LTD.

Units 6, 7, 8 Sunray Industrial Centre, 1st Floor, 610 Cha Kwo Ling Road Kowloon.

Project : T.K.O.T.L. 70 RP, Phase 11, LOHAS Park, Tseung Kwan O, N.T.

Subject : 10mm Low E (58T) Clear Heat Strengthened Glass+ 12A + 10mm Clear Tempered Glass (I.G.U.) (G2)- Glass Sample 2

6x10

Brand : Guangdong Haikong Special Glass Technology Co. Ltd.

Glass Code : R20220114003

Location : Curtain Wall Window

Letter ref. : MC/41008/858

Date : 25th January 2022

R20220114003

06 May 2022



MIDI ALUMINIUM FABRICATOR LTD.

Units 6, 7, 8 Sunray Industrial Centre, 1st Floor, 610 Che Kwo Ling Road Kowloon.

Project : T.K.O.T.L. 70 RP, Phase 11, LOHAS Park, Tseun
Subject : 12mm Clear Tempered Glass (G4) - Glass Sample 4
Brand : Guangdong Haikong Special Glass Technology Co. Ltd.
Glass Code : R20220114008
Location : Curtain Wall
Letter ref. : MC/41008/858
Date : 25th January 2022

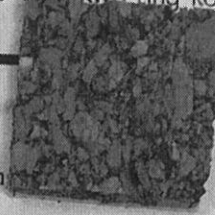

12 mm

R20220114008

06 MAY 2022

GS - 12 GLAZING

GS - 12

GS-12.0 **GENERALLY**

This section is predominantly intended for glazing in doors and windows and should be read in conjunction with GS-7 Curtain Wall when curtain walls and window walls are the subject of the glazing requirement.

GS-12.0.1 Ordinances, Regulations, Codes and Standards

Comply with the documents contained in this Specification regarding Ordinances, Regulations, Code of Practices, Standards and PNAP relevant for Curtain Walls and Glazing under GS-7 and GS-5 respectively.

All Standards and Codes of Practice are to be the latest issue. If there is any conflict between the standards and codes listed, the more onerous is to apply.

MATERIALS

GS-12.1.0 **GLASS GENERALLY**

Glass generally shall be in accordance to **BS 952-1**, **BS 952-2** or **ASTM C1036**.

GS-12.1.1 **TEMPERED & LAMINATED GLASS**

Tempered and laminated glass shall conform to the relevant safety class requirements of **BS 6262-4**; and shall be determined by testing to **BS EN 12600** although tests in accordance with **ANSI Z97.1** are acceptable.

GS-12.1.2 **EDGE QUALITY**

Edge quality finish for all glass, irrespective of heat treatment, is important. Heat treated glass may be rejected, and annealed glass will be rejected, if it does not conform to the following criteria:

- a) Shark teeth shall not penetrate more than half of glass thickness.
- b) Serration hackle may occur only within 150 mm of corners.
- c) Flare shall not exceed 1.0 mm as measured perpendicular to glass surface across the edge. Flare shall not occur at setting blocks.
- d) Bevel shall not exceed 1.6 mm.
- e) Flake chips may occur only within 200 mm of corners; depth shall not exceed 0.8 mm and length or diameter shall not exceed 6.0 mm.
- f) Rough chips shall not be permitted. Rough chips shall be those which exceed any of the dimensional limits for flake chips.
- g) Shells on the face of the glass are not permitted on annealed glass and are only acceptable for heat treated glass if they were present prior to heat treatment and are covered by a glazing bead or glass stop. They are not permitted for glass that will be structurally glazed with silicone.
- h) All non-captured but concealed glass edge shall be true and square in a frosted finish with arris.
- i) Exposed glass edge shall be true and square, polished smooth with arris

GS - 12 GLAZING

GS - 12

GS-12.1.3 INSULATING GLASS-IGU

- a) Insulating glass shall have double edge seals. Primary seal shall be extruded polyisobutylene continuously bonded to glass surfaces and desiccant filled metal spacer, including corners.
- b) Minimum width of primary seal shall be 3.0 mm. Secondary seal shall be a 2 part neutral cure structural sealant. Secondary seal shall completely cover spacer with no gaps or voids, and shall be continuously bonded to both plates of glass.
- c) Where non-pyrolytic (hard) Low-E coatings are used, edge deletion of the coating is required unless specifically stated as not being required by the glass manufacturer.

GS-12.1.4 FLATNESS

In addition to conforming to **BS 952-1**, **BS 952-2** and **ASTM C1048**, monolithic heat strengthened and tempered glass shall conform to the following flatness tolerances:

- a) Bow and warp have the same meaning. They are both defined as deviation of a glass surface from a true plane, with the glass freestanding or installed in a frame and positioned in a vertical plane.
- b) Localized bow refers to any straight line segment with a length of 300 mm on a glass surface.
- c) Overall bow refers to any straight line segment on a glass surface which extends between opposite edges across the smaller glass dimension and is perpendicular to at least one edge. The length of the line segment is the gauge length.
- d) Localized bow shall not exceed 1.6 mm.
- e) Overall bow shall not exceed: 1.0 mm per 300 mm for gauge length in the range zero to 1 m; 0.75 mm per 300 mm for gauge length in the range 1 m to 2.40m; one half of the values listed in **ASTM C1048**, Table 2 for gauge lengths exceeding 2.40m.
- f) Where heat treating results in essentially parallel ripples or waves, the maximum peak-to-valley deviation shall not exceed 0.127 mm. Requirements for localized bow and overall bow shall also be satisfied. Direction of ripples shall be consistent throughout the building and approved by the SO.
- g) The specified bow and ripple tolerances are intended as manufacturing quality control limits.

GS-12.1.5 INCLUSIONS IN TEMPERED GLASS

Tempered glass shall be subject to quality control measures (i.e. heat soaking) to minimize nickel sulfide and other inclusions that could result in spontaneous breakage. Such inclusions are defined as a material defect by this specification. Installed tempered glass which experiences spontaneous breakage shall be replaced (material and labour) under the warranty provisions.

GS-12.1.6 PLASTIC FILMS

Plastic films used to opacify glass shall conform to the following requirements:

- a) Minimum nominal thickness of polyester shall be 0.08mm. Film shall be pigmented and have a black colour unless otherwise stated.
- b) The bonding surface shall be completely coated with a solvent based adhesive.
- c) Monolithic opacified glass shall have a safety backing for fallout resistance.

GS - 12 GLAZING

GS - 12

GS-12.1.7

VISION GLASS

Vision glass shall be as specified in the Particular Specification.

GS-12.1.8

SPANDREL GLASS

Spandrel glass shall be as specified in the Particular Specification.

GS-12.1.9

CRITERIA FOR GLASS

Performance requirements for glass shall be as follows:

- a) For the purpose of glass selection, design wind pressure shall be assumed to have three second duration. Minimum roof imposed load shall be assumed to have one week duration.
- b) Upon first application of design wind and imposed load pressures, probability of breakage shall not exceed 8/1000 for vertical glass, and 1/1000 for sloped and horizontal glass.
- c) Provide heat strengthened glass where annealed glass would be vulnerable to thermal breakage.
- d) In addition, the allowable tensile stress of fully toughened glass (tempered glass) for use with unfactored loads shall not exceed the following:
 1. 50 N/mm² for unfactored wind loads.
 2. 35 N/mm² for medium and long-term unfactored loads.

GS-12.1.10

GLASS REPLACEMENT

Glazing details shall permit glass replacement after initial construction, shall permit reuse of original gaskets unless it has been damaged, shall permit replacement glass of the same nominal size as original glass, and shall not require cutting of framing members or removal of interior finishes.

Vision glass in conventional frames shall be replaceable from the interior.

Spandrel glass shall be replaceable from the exterior. Silicone supported vision glass shall be replaceable from the exterior and/or interior.

GS-12.1.11

GLAZING MATERIALS

The minimum service life of all gaskets, weather stripping and other glazing accessories shall be 15 years.

Gaskets and weather-strips, except at structural sealant glazing shall, as a minimum, conform to **BS 6262** except:

- a) Sponge gaskets shall be extruded black neoprene with a hardness of 40 +5/-4 durometer Shore A and conforming to **ASTM C509**.
- b) Design sponge gaskets to provide 20% to 35% compression. Sponge gaskets are only to be used as gap fillers and must not be used where the performance relies on compression resistance.
- c) Dense gaskets shall normally be black extrusions with a Shore A hardness of 70 +5/-4 for hollow profiles and 60 +5/-4 for solid profiles, and conforming to **ASTM C864** or **BS 4255-1**. Outdoor and indoor gaskets shall be silicone, EPDM, neoprene or a Thermal Plastic Elastomer (TPE). However TPE gaskets are not permitted to be used where their performance is dependent upon compression resistance. Where the colour of the gasket is other than black, only heat cured silicone rubber is to be used.

GS - 12

GLAZING

GS - 12

- e) Insulating fire graded glass can be of any composition if the relevant fire certificate can be provided.

GS-12.2.6

MIRROR GLASS

- a) Mirror glass shall be selected float suitable for silvering and a minimum Q2
- b) Quality in accordance with **ASTM C1036**.
- c) Mirrors shall have square or bevelled edges. Exposed edges are to be ground or
- d) Polished smooth with an arised edge.

GS-12.2.7

HEAT STRENGTHENED GLASS

1. Heat strengthened glass shall be glass that has been heat treated to give increased strength, in accordance with the requirements of **ASTM C1048**, to approximately two (2) time the strength and impact resistance of untreated float glass.
2. To be defined as Heat Strengthened glass, the residual surface compression must be between 24 and 52 MPa.
3. Glass with a surface compression in excess of 45 MPa is to be subjected to heat soak testing in accordance with the relevant procedures set out in **BS EN 14179-1**. Submit the compliance certificate for the glass delivered to site. The compliance certificate should include the following information:
 - a) Identification of the batch;
 - b) Quantity and configuration of thermocouples used to measure the glass surface temperatures in the oven;
 - c) Graphs of the heat soak process cycle associated with each of the thermocouples indicating the glass surface temperatures at representative glass locations and time duration of the heating phase, holding phase and cooling phase of the process;
 - d) Name of the glass manufacturer;
 - e) Location of the oven;
 - f) Calibration report of the oven;
 - g) Date of carrying out the heat soaking process;
 - h) Quantity and size of glass subject to the heat soaking process and records of breakages of panels in the tests; and
 - i) Minimum dimension of glass separation in the oven.
 - j) Heat strengthened glass is not to be considered a safety glass.
 - k) Size, all required bore hole(s) and edge finishes etc. of a heat strengthened glass shall be pre-determined prior to ordering and fabrication of the glass panel.

GS-12.2.8

FULLY TEMPERED GLASS

- a) Fully tempered glass shall be glass that has been heat treated to give increased strength, in accordance with the requirements of **ASTM C1048**, to approximately four (4) times the strength and impact resistance of untreated float glass.
- b) To be defined as Fully Tempered glass, the residual surface compression must be a minimum of 69 MPa, however it is recommended that the glass supplied as fully tempered has a minimum of 75 MPa.

Gammon

MATERIALS SUBMISSION FORM

Project Proposed Residential Development at TKOTL 70RP, Phase 11, Lohas Park, Tseung Kwan O, New Territories

Works Main Contract

Contract No. J3931

Ref. No. P19084NT/MS/MD/439 (Rev.2)

GECCL Ref. J3931/304/D04188

Date 16 May 2022

To / Attn RLP / Mr. Kenneth Wong / Ms. Florence Cheung

Subject **Material Submission – Midi – Glass Sample* for Curtain Wall of Spandrel Glass and Glass Cladding at Tower**

19084NT
Form RLP/TSF
IN 003766
RONALD LU & PARTNERS

Received by 18 MAY 2022
RECEIVED

Received by RLP

We write to request this submission replied by: RLP / AECOM / WSP / Others

Anticipated date of response 30 May 2022

We certify that the submission has been checked and is in full compliance with the Specification & Contract Documents, unless otherwise stated in the remarks.

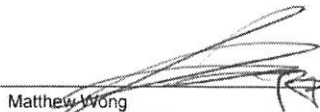
Matthew Wong
For and on behalf of
Gammon Engineering & Construction Company Limited

MW/BK/JT/BN/DL/HW/vh

- MTRC (Site) Mr. KS Lee / Mr. Teddy Wu / Mr. HF Au / Mr. SL Kwan / Mr. Jacky Cheung
- MTRC (STR) Mr. Tony Fan
- MTRC (E&M) Mr. Ricky Ling
- MTRC (Cost & Prog) Mr. Anthony Tam
- SKY CASTLE Mr. Herbert Thang / Mr. Francis Lui / Mr. David So / Mr. Kenneth Leung / Mr. Andy Chan
- AECOM Mr. Henry Lo / Mr. Colo Li
- AECOM (Façade) Ms. Monnie Lee / Ms. Phoebe Chung / Mr. Ryan Ko
- WSP Mr. Simon Kwan / Mr. Tommy Leung
- AD (LANDSCAPE) Mr. Walter So / Mr. Kenif Ng
- MDL Mr. Morly Law
- Baria Mr. Kevin Yim / Mr. Randolph Chan
- RE (AECOM) Mr. Simon Tso / Mr. Ken Siu
- COW Mr. Marcus Kee
- BSI BSI
- WSP (Safety & Risk) Mr. Chris Tong / Mr. Louis Siu
- Ramboll Mr. David Yeung
- Tin Loo Mr. Eddie Kwan
- AEC Mr. Andy Lai

Material / Work Description *	Glass Sample for Curtain Wall (Spandrel Glass and Glass Cladding)
Location	Glass
Brand Name	Guangdong Haikong Special Glass Technology Co. Ltd.
Model / Reference No. *	
Country of Origin	China
Supplier Name	Guangdong Haikong Special Glass Technology Co. Ltd.
Others (Color / Pattern, etc.) *	
Material / Work Reference *	N/A
Specification Reference	N/A
Related Dwg. / A.I. Ref. *	N/A
Related BQ Reference	N/A
Submission Attachment	
Sample	<input checked="" type="checkbox"/> At RLP
Catalogue / Technical Data *	<input type="checkbox"/> N/A
Test Report / Certificate *	<input checked="" type="checkbox"/> Attached
Equipment Schedule	<input type="checkbox"/> N/A
Method Statement	<input type="checkbox"/> N/A
Installation Details	<input type="checkbox"/> N/A
Job Reference	<input type="checkbox"/> N/A
Remarks (To list deviations, if any)	* Delete as appropriate

R 2022-032-4054

Review Status / Comment

RESPONSE TO TECHNICAL SUBMISSION

Date 24/5-2022

Comments REVIEW STATUS: B.
1/ REFER TO COMMENTS FROM SINO, FACADE CONSULTANT, MTRC AND OTHER RELEVANT PARTIES.
2/ REFER TO COMMENTS AS ATTACHED IN RED & GREEN.



For and on behalf of
Ronald Lu & Partners (Hong Kong) Ltd. SKH / WYF / TTC main

Replied by SE / Date

Replied by BS / Date

Replied by RLP / Date 24/5-2022

No review is made of detail dimensions/quantities.
The submission is reviewed for general compliance with the design intent only.
Any comments or amendments required shall not be deemed to be variation.
The review does not release the Contractor from his responsibilities to comply with contract requirements.
For resubmission, the Contractor has to highlight or cloud those revision areas in the shop drawing for review.

Legend: A (No objection) B (No objection, subject to comments as noted) C (Amendment & resubmission required) D (Rejected & resubmission required)

w/e

- MTRC (Site) Mr. KS Lee / Mr. Teddy Wu / Mr. HF Au / Mr. SL Kwan / Mr. Jacky Cheung
- MTRC (STR) Mr. Tony Fan
- MTRC (E&M) Mr. Ricky Ling
- MTRC (Cost & Prog) Mr. Anthony Tam
- SKY CASTLE Mr. Herbert Thang / Mr. Francis Lui / Mr. David So / Mr. Kenneth Leung / Mr. Andy Chan
- AECOM Mr. Henry Lo / Mr. Colo Li
- AECOM (Façade) Ms. Monnie Lee / Ms. Phoebe Chung / Mr. Ryan Ko
- WSP Mr. Simon Kwan / Mr. Tommy Leung
- AD (LANDSCAPE) Mr. Walter So / Mr. Kenif Ng
- MDL Mr. Morly Law
- Baria Mr. Kevin Yim / Mr. Randolph Chan
- RE (AECOM) Mr. Simon Tso / Mr. Ken Siu
- COW Mr. Marcus Kee
- BSI BSI
- WSP (Safety & Risk) Mr. Chris Tong / Mr. Louis Siu
- Ramboll Mr. David Yeung
- Tin Loo Mr. Eddie Kwan
- AEC Mr. Andy Lai

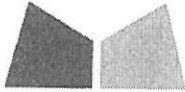

美特鋁質有限公司
MIDI ALUMINIUM FABRICATOR LTD.

Our ref. MC/41267/858

12th May, 2022

Gammon Construction Company Limited
22/F Tower 1, The Quayside,
77 Hoi Bun Road,
Kwun Tong, Kowloon.

By Email & Hand

Attn.: Mr. Matthew Wong

Dear Sir,

Re: Design, Supply and Installation of Curtain Wall, Glass Wall, Aluminium Window, Aluminium Cladding, Aluminium Louvres and Glass Balustrade Nominated Sub-Contract at T.K.O.T.L. 70 RP, Phase 11, LOHAS Park, Tseung Kwan O, N.T. Submission of Glass Sample for Curtain Wall (Spandrel Glass and Glass Cladding) (MS035)

Regarding the captioned project, we would like to submit Glass Sample for Curtain Wall (Spandrel Glass and Glass Cladding) for your review and comment.

Brand : Guangdong Haikong Special Glass Technology Co. Ltd.

Glass Sample : 12mm Reflective Glass (12SSC1-60THS)
Glass code : R20220324054
Use of Location: CW Spandrel Glass and Glass Cladding

Remarks:

- 1.) The 12SSC1-60THS Reflective Glass was confirmed at Glass mock up on 2022.04.23, See Attachment 1.
- 2.) The Glass data was attached on Attachment 2.
- 3.) Applied location was attached on Attachment 3.
- 4.) Two set of glass sample will be delivered to Gammon site office.

If you have any query, please feel free to contact us.

Thank you for your kind attention.

Yours faithfully,
MIDI ALUMINIUM FABRICATOR LTD.

Francis Mau
Managing Director

Encl - 5 page(s)

cc. Gammon	- Mr. Jun Tsui / Mr. Brian Ng	(w/e)
Sino	- Mr. Terry Wan / Mr. Andy Chan	(w/e) (Email Only)
RLP	- Ms. Marina Tong / Ms. Ginny Chau	(w/e) (Email Only)
Aecom	- Mr. Ryan Ko / Mr. Cole Li	(w/e) (Email Only)
	- Ms. Daisy Lau / Ms. Crystal Wong	

EM/MT/DW/JL/BL/AY/vl
九龍葵涌道610號生利工業中心1樓6-8號
Units 6-8, 1st Floor, Sunray Industrial Centre, 610 Cha Kwo Ling Road, Kln.
TEL. (電話): 2348 9211 FAX. (傳真): 2772 7666 E-mail Address (電郵): midi@midiltd.com.hk.



Attachment ①

Marina TONG [RLPHK]

From: Andy Chan Yan Wai <andywchan@sino.com>
Sent: Friday, 22 April 2022 5:37 pm
To: jason.lcs.midi@gmail.com; Jun Leung Wai Tsui; Marina TONG [RLPHK]
Cc: Herbert Thung; Francis Lai; Chan Pui Huen; TKOTL70 (Lohas Park Package 11); Kenneth Leung; Terry Wan
Subject: LP11 - Curtain Wall Spandrel Glass and Backpad Color
Attachments: D03705.MS-MD-439 (Rev.1).pdf; 273524373_955772871733562_309446607206249078_n.jpg; D02665.MS-A-437 (Rev. 0) RLP Reply_.pdf

Dear Jason / Marina,

Further to the inspection of spandrel mock up this afternoon, we write to confirm the spandrel glass and backpad color as below:

1. Spandrel Glass – 12mm Reflective Glass (12mmSSC1-60THS) – See the attached submission D03705.MS-MD-439 (Rev.1) with mark ups
2. Backpad Color – Sliver Champagne - See the attached approved submission D02665.MS-A-437 (Rev. 0)

Midi please proceed the material ordering in order to suit the site progress and also prepare formal material submission of the said material as soon as possible.

B. Regards,
Andy



Please consider the environment before printing this e-mail.

Confidential Caution This email and its attachment are intended solely for the addressee(s) and contain information that is confidential and may be legally privileged. If you are not the intended recipient, any disclosure, copying, distribution or any use of it and/or its attachment(s) is prohibited and may be unlawful. In such case you should destroy this email and all attachment(s) transmitted with it and kindly notify the sender by reply email. Internet communications cannot be guaranteed to be timely, secure, error or virus-free. No liability is accepted by Sino Group and the sender for any loss and damage for the content of this email, or for the consequences of any actions taken on the basis of the information provided, or as a result of transmission of this email.

✓
R20220324054



广东海控特种玻璃技术有限公司
Guangdong HaiKong Special Glass Technology Co., Ltd.

Attachment 2

玻璃性能参数Performance Data

客户名称: 美特 项目名称: J858 日出康城11期 日期: 11/5-2022

玻璃产品 Class Product	可见光 Light characteristics				太阳热能 Energy characteristics						U-Value 空气 (W/M ² K)
	透光率 trans (%)	反光率Reflection		热反射率 Reflection((%)	热吸收率 Abs (%)	热能系数 SolarFactor	遮阳系数 Shading Coefficient	S.C.			
		外Out (%)	内In (%)					E.R.	E.A.	S.F.	
10mm STB1-58T#2+12A+12mm clear (G4)	50%	20%	11%	20%	51%	0.39	0.44	AIR		1.82	
10mm STB1-58T#2+12A+10mm clear (G2,G81)	50%	20%	11%	20%	50%	0.39	0.45	AIR		1.83	
12mm SSC1-60T #2 (G3)	58%	15%	15%	10%	42%	0.60	0.69	AIR		5.38	
12mm clear (G4)	86%	8%	8%	7%	42%	0.78	0.89	AIR		5.60	
6mm clear +0.38milky white TG09 (216500)+1.14pvb+6mm low iron	77%	7%	7%	7%	42%	0.75	0.86	AIR		5.56	
6mm clear TG11	89%	8%	8%	7%	14%	0.82	0.95	AIR		5.70	

Spandrel
R2022032
K054

- The performance data shown are nominal and subject to variations due to manufacturing tolerances.
- A slight shift in visible light reflectance or transmission may be noticed after heat-treatment.
- The tolerance of data with respect to photometric properties is ±3 points.
- The U-value tolerance is ±0.1W/m².k.
- Specifications technical and other data are based on information available at the time of preparation this document and are subject to change without prior notice.
- The above performance parameters calculated in accordance with WINDOW6 software.All data are just for your reference, not as an official contract.

创新, 成就建筑梦想! Achieve Dreams With Innovation



MIDI ALUMINIUM FABRICATOR LTD.

Units 6, 7, 8 Sunray Industrial Centre, 1st Floor, 610 Chee Kwo Ling Road Kowloon.

Project : T.K.O.T.L. 70 RP, Phase 11, LOHAS Park, Tseung Kwan O, N.T.

Subject : 12mm Reflective Glass (12SSC1-60THS) Sample (MS035)

Brand : Guangdong Haikong Special Glass Technology Co. Ltd.

Glass Code : R20220324054

Location : CW Spandrel Glass and Glass Cladding

Letter ref. : MC/41267/858

Date : 12th May 2022

25.5.2022



海控特玻
HaiKong SGT

建筑工程玻璃
Architectural Glass

产品结构: 12SSCI-60THS
Composition:

客户名称: 美特
Customer:

工程名称: 日出康城II期
Project:

样品编号: R20220324054
Sample No.:

检验员 (QC)

此面为室外面 (Exterior)

样品颜色供参考, 不作为质量验收依据!
Sample Color for reference, Not used as a basis for quality acceptance!



MIDI ALUMINIUM FABRICATOR LTD.

Units 6, 7, 8 Sunny Industrial Centre, 1st Floor, 610 Cha Kwo Ling Road, Kowloon

Project : T.K.O.T.L. 70 RP, Phase 11, LOHAS Park, Tseung Kwan O, N.T.
Subject : 12mm Reflective Glass (12SSC1-60THIS) Sample (MS035)
Brand : Guangdong Huihong Special Glass Technology Co., Ltd.
Glass Code : R20220324054
Location : CW Spandrel Glass and Glass Cladding
Letter ref. : MC/41267/858
Date : 12th May 2022

海拉特玻璃
Hi-Kong SGT
1023811-1461186

產品類別: 1023811-1461186
客戶名稱: 海拉特
工程名稱: 旺角海拉特玻璃
樣品編號: K20220324054 玻璃員: CC
Sample No.: 1023811-1461186

Attachment 3

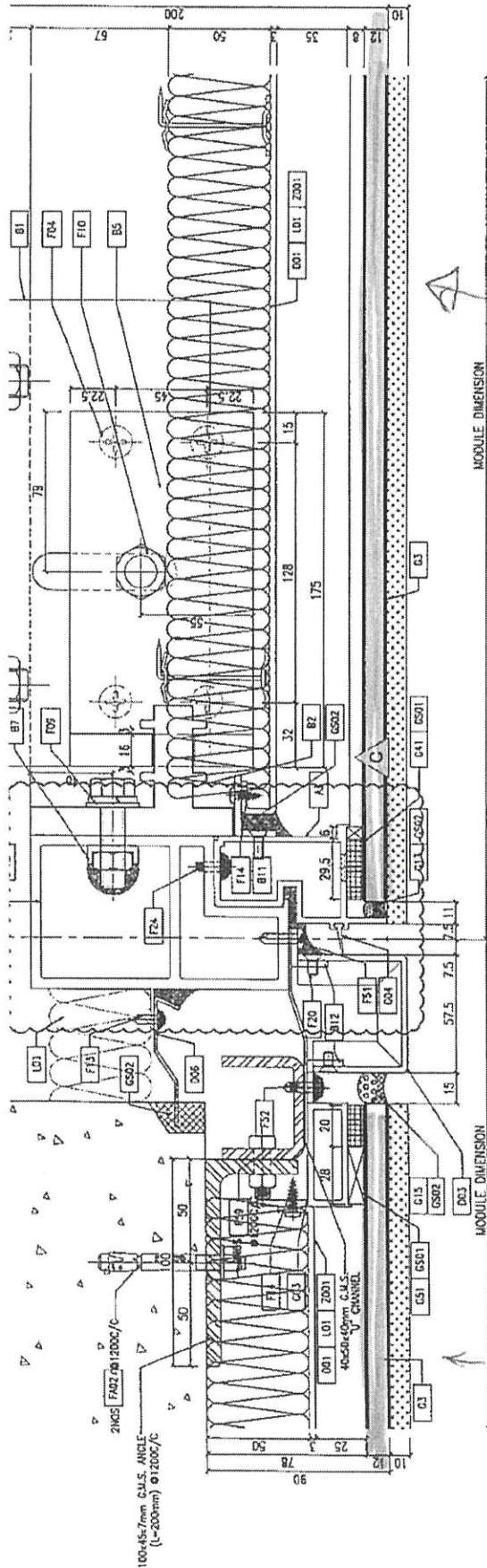

MODULE DIMENSION

MODULE DIMENSION

TYPICAL MULLION DETAIL CURTAIN WALL

Spandrel

Glass cladding

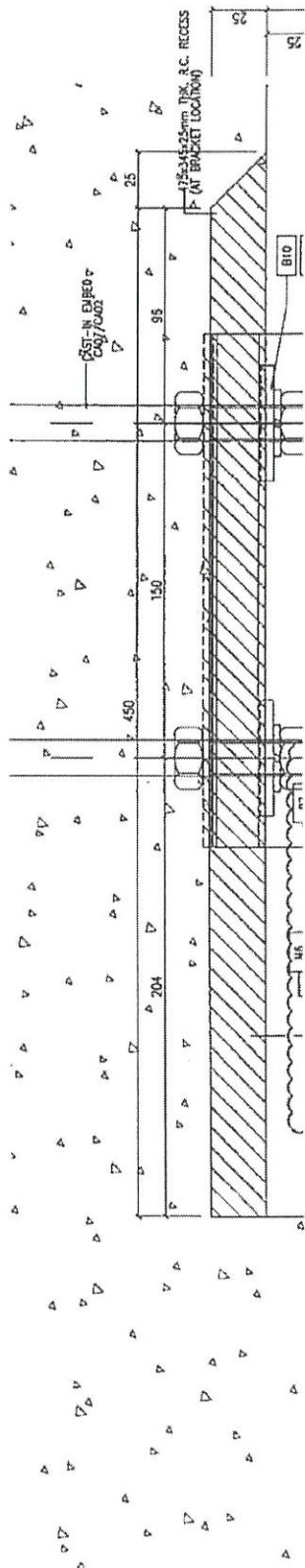

TYPICAL MULLION DETAIL CURTAIN WALL

Spandrel

Glass cladding

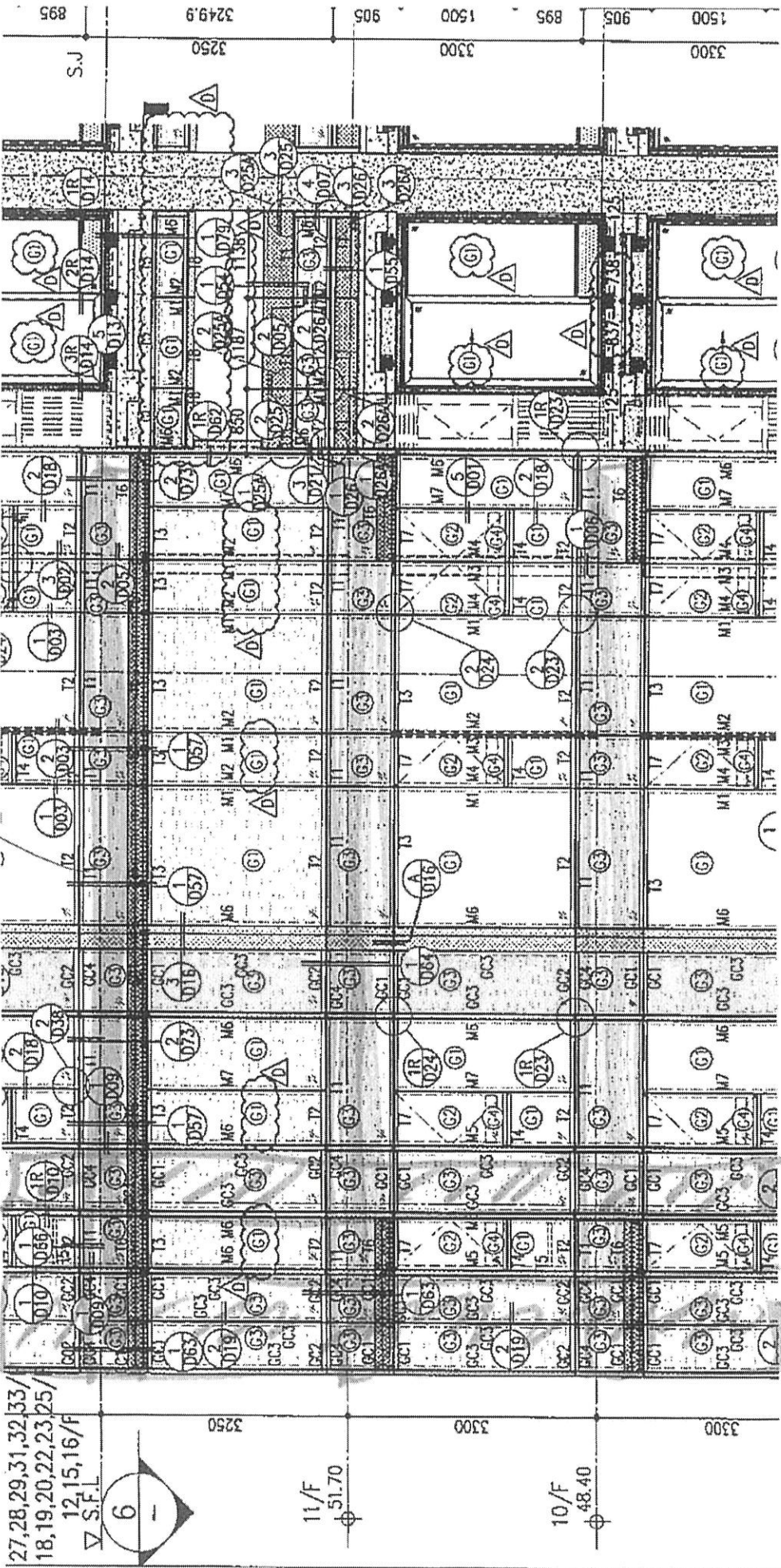

CW Spandrel

Glass cladding

APPLICATION OF G73

27, 28, 29, 31, 32, 33/
18, 19, 20, 22, 23, 25/
12, 15, 16/F
S.F.L.

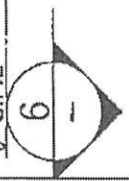

11/F
51.70

10/F
48.40

3250

3300

3300

S.J.
895

3249.9

905

1500

895

905

1500

3300

3300