



工程指示 / 要求簡箋 ENGINEER INSTRUCTIONS(E.I.)

工程指示編號:	EI- 4631	修改版本:	A
	HK-0714		
工程編號:	J 858	工程名稱:	將軍澳日出康城11
收件人:	生統 / 楊榮輝 / .Maggie	發件人:	Ant Yeung
工程項目:	幕牆 單元件 香檳金膠 廠用配件BM	日期:	29/04/2022

<input type="checkbox"/> 原合約工程包	<input type="checkbox"/> 原合約工程加 / 減賬 QT-	<input type="checkbox"/> 新工程報價 QT-
---------------------------------	--	------------------------------------

信件批核號碼/圖紙參考編號:	批核模具圖紙編號:
客戶指示附件:	管理內部批簽署:

<input type="checkbox"/> 初步鋁料 B.M.	<input type="checkbox"/> 加工拆圖, 然後生產	<input type="checkbox"/> 尺寸表
<input type="checkbox"/> 正式鋁料 B.M.	<input type="checkbox"/> 技術上資料/指示	<input type="checkbox"/> 報價
<input type="checkbox"/> 配件 B.M.	<input type="checkbox"/> 樣辦或貨品說明書	<input type="checkbox"/> 分判合約
<input type="checkbox"/> 其他:		

內容: 按2022/4/27 胡哥, Marco 會議, 橫碰企膠, 只是0.5mm 隙, 修螺絲後不見光, 可用淺灰代替。只有欄河玻璃, 才用香檳金色。減少數量 先預3 板 1728x3 = 5184支  
業主已確認幕牆單元件的部分位置為香檳金色膠(code 577) 跟觀塘色。  
因香檳金膠(code 577) 不是標準色, 貨期長, 需要先訂送廠。

完成上列要求日期: 08/01/2022 2022.8.1

國內

<input type="checkbox"/> 生產技術總監	<input type="checkbox"/> 連附件	<input type="checkbox"/> 技術部	<input type="checkbox"/> 連附件	<input type="checkbox"/> 生產部	<input type="checkbox"/> 連附件
<input type="checkbox"/> 採購部	<input type="checkbox"/> 連附件	<input checked="" type="checkbox"/> 生產統籌部	<input checked="" type="checkbox"/> 連附件	<input type="checkbox"/> 報關組	<input type="checkbox"/> 連附件
<input type="checkbox"/> 質檢部	<input type="checkbox"/> 連附件	<input type="checkbox"/> 會計部	<input type="checkbox"/> 連附件	<input type="checkbox"/> 機械設計部	<input type="checkbox"/> 連附件
<input checked="" type="checkbox"/> 其他:					

香港

<input type="checkbox"/> 行政部	<input type="checkbox"/> 連附件	<input type="checkbox"/> 會計部	<input type="checkbox"/> 連附件	<input type="checkbox"/> 統籌部	<input type="checkbox"/> 連附件	<input type="checkbox"/> 工程部	<input type="checkbox"/> 連附件
<input checked="" type="checkbox"/> 採購部	<input checked="" type="checkbox"/> 連附件	<input type="checkbox"/> QS部	<input type="checkbox"/> 連附件	<input type="checkbox"/> 地盤管理	<input type="checkbox"/> 連附件	<input type="checkbox"/> 維修部	<input type="checkbox"/> 連附件

*發件人簽署:	*組別成員批核簽署:
傳遞編號:	項目經理簽署:

ei4631A

3/3

grey  
在  
(非耐胶)  
的  
铝料透玻璃  
(玻璃胶)  
grey

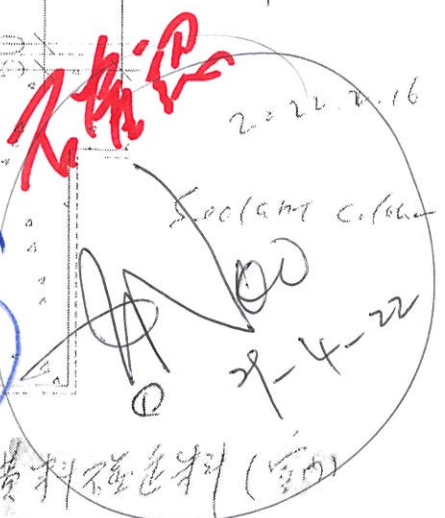

香橙金 silver champagne  
silver champagne sealant - location 1

连接磁

的封管

香橙金

Standard colour confirmed to be grey. Please coordinate with Polyfair for confirmation.

code (577),  
silver champagne colour

① Interface between mullion and transom (inside.)

silver champagne sealant - location 2

silver champagne sealant - location 3

OUTSIDE

修虫是行在理光用漆在

INSIDE

② protective Barrier.

silver champagne sealant - location 4

外控  
香橙金  
的封管

本工程用  
香橙金色胶  
和深灰色胶

漆在 P.1

香橙金

Reply from R...  
3 March 2022

4 下殼位置

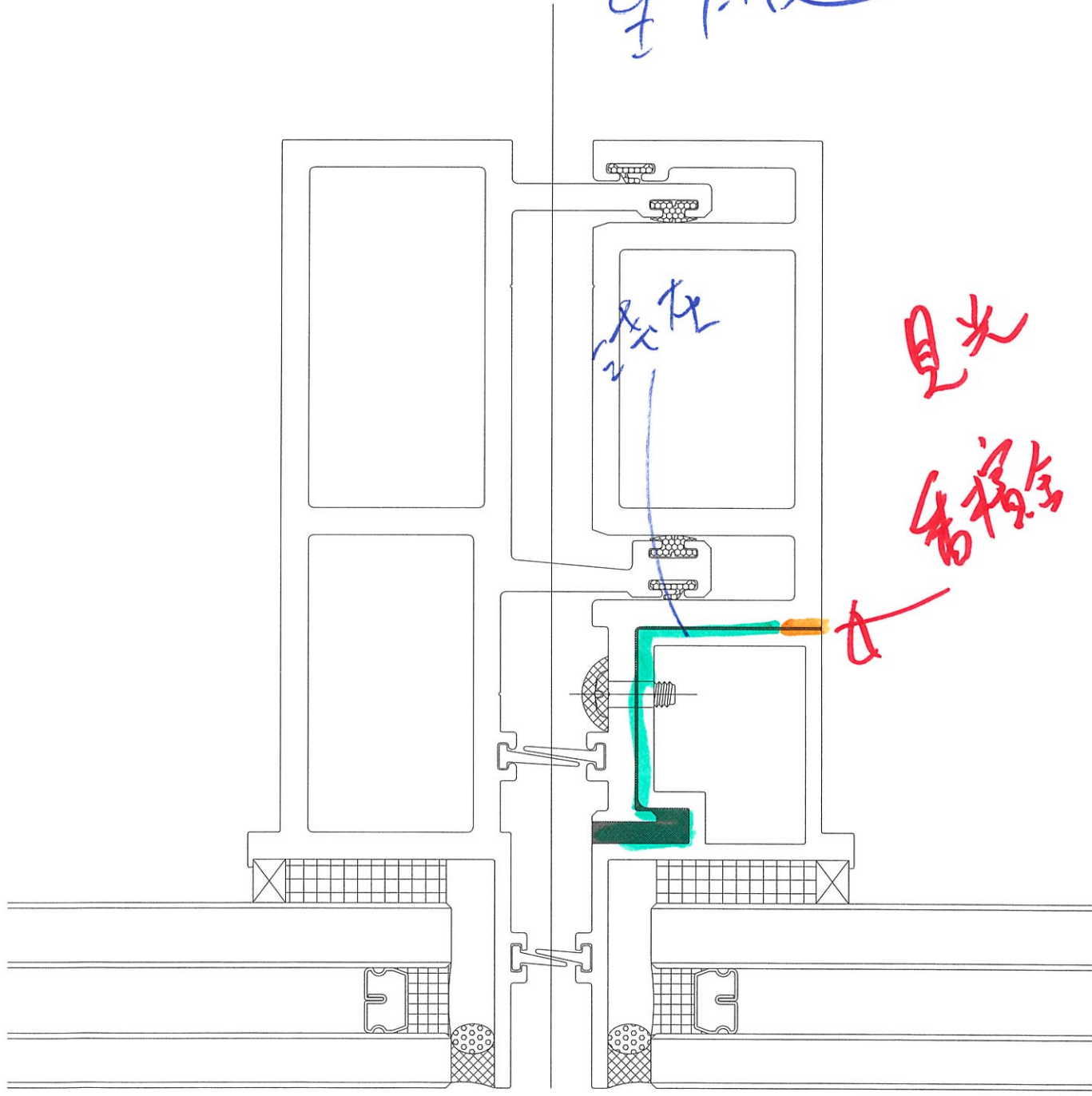

BRONZE 0577

BASE : 791

PART : 2.5

2019.10.24

胡煜  
香梅金

J837

用



(주) 정원피앤에스  
SEONG WON P&S CO., LTD

胡煜胡用

香梅金

code (577)

Project Proposed Residential Development at TKOTL 70RP, Phase 11, Lohas Park, Tseung Kwan O, New Territories

Works Main Contract

Contract No. J3931

Ref. No. P19084NT/MS/MD/591 (Rev.0)

GECCL Ref. J3931/304/D03629

Date 4 Apr 2022

To / Attn RLP / Mr. Kenneth Wong / Ms. Florence Cheung

Subject **Material Submission – Midi – Submission of Color Sample for Dowsil 791 (Tailor - Made Silver Champagne) & (Grey) (MS024)**

We write to request this submission replied by:  RLP /  AECOM /  WSP /  Others

Anticipated date of response 19 Apr 2022

We certify that the submission has been checked and is in full compliance with the Specification & Contract Documents, unless otherwise stated in the remarks.

  
Matthew Wong  
For and on behalf of  
**Gammon Engineering & Construction Company Limited**

MW/BK/JTB/N/HW/vh

Received by / / /

Received by RLP

	cc	w/e
MTRC (Site)	<input checked="" type="checkbox"/>	<input type="checkbox"/> Mr. KS Lee / Mr. Teddy Wu / Mr. HF Au / Mr. Si Kwai / Mr. Jacky Cheung
MTRC (STR)	<input type="checkbox"/>	<input type="checkbox"/> Mr. Tony Fan
MTRC (E&M)	<input type="checkbox"/>	<input type="checkbox"/> Mr. Ricky Ling
MTRC (Cost & Prog)	<input type="checkbox"/>	<input type="checkbox"/> Mr. Anthony Tam
SKY CASTLE	<input checked="" type="checkbox"/>	<input type="checkbox"/> Mr. Herbert Thang / Mr. Francis Lau / Mr. Tony Ho / Mr. Kenneth Wong / Mr. Andy Chan
AECOM	<input type="checkbox"/>	<input type="checkbox"/> Mr. Henry Lo / Mr. Cole Li
AECOM (Facade)	<input checked="" type="checkbox"/>	<input type="checkbox"/> Ms. Moana Lee / Ms. Phoenix Chung / Mr. Ryan Kwok
WSP	<input type="checkbox"/>	<input type="checkbox"/> Mr. Simon Kwan / Mr. Tommy Leung
ADI (LANDSCAPE)	<input type="checkbox"/>	<input type="checkbox"/> Mr. Wilson So / Mr. Kendall Ng
MDL	<input checked="" type="checkbox"/>	<input type="checkbox"/> Mr. Mervyn Law
Boris	<input checked="" type="checkbox"/>	<input type="checkbox"/> Mr. Keith Yim / Mr. Randolph Chan
RE (AECOM)	<input type="checkbox"/>	<input type="checkbox"/> Mr. Simon Tso / Mr. Ken So
COW	<input checked="" type="checkbox"/>	<input type="checkbox"/> Mr. Marcus Koo
BSI	<input type="checkbox"/>	<input type="checkbox"/> BSI
WSP (Safety & Risk)	<input type="checkbox"/>	<input type="checkbox"/> Mr. Chris Tong / Mr. Louis Si
Ramboll	<input type="checkbox"/>	<input type="checkbox"/> Mr. David Yeung
Tin Lee	<input type="checkbox"/>	<input type="checkbox"/> Mr. Eddie Kwun
AEC	<input type="checkbox"/>	<input type="checkbox"/> Mr. Andy Le

Material / Work Description *	Color sample for Dowsil 791 (Tailor made silver champagne)
Location	Curtain Wall
Brand Name	Dowsil
Model / Reference No. *	Code: 577
Country of Origin	Korean
Supplier Name	Dowsil
Others (Color / Pattern, etc.) *	Silver champagne & Dark Grey (standard colour)
Material / Work Reference *	N/A
Specification Reference	N/A
Related Dwg. / A.I. Ref. *	RFI/MD/370
Related BQ Reference	N/A
Submission Attachment	
Sample	<input checked="" type="checkbox"/> Attached
Catalogue / Technical Data *	<input type="checkbox"/> Attached
Test Report / Certificate *	<input type="checkbox"/> N/A
Equipment Schedule	<input type="checkbox"/> N/A
Method Statement	<input type="checkbox"/> N/A
Installation Details	<input type="checkbox"/> Attached location
Job Reference	<input type="checkbox"/> N/A
Remarks (To list deviations, if any)	* Delete as appropriate

已批

Review Status / Comment

### RESPONSE TO TECHNICAL SUBMISSION

Date 22 April 2022

Comments 1/ Please refer to comments marked on the attached pages  
2/ Item no. 1 - tailor-made silver champagne weather sealant (approval status - B)  
3/ Item no. 2 - standard colour grey shall be changed to standard colour DARK GREY (approval status - c)

Replied by SE / Date

Replied by BS / Date

Replied by RLP / Date 22 April 2022



**RONALD LU & PARTNERS**

For and on behalf of  
**Ronald Lu & Partners (Hong Kong) Ltd.**

SKH/ WYF/ TTC

No review is made of detail dimensions/quantities  
The submission is reviewed for general compliance with the design intent only  
Any comments or amendments required shall not be deemed to be variation.  
The review does not release the Contractor from his responsibilities to comply with contract requirements  
For resubmission, the Contractor has to highlight or cloud those revision areas in the shop drawing for review

Legend: A (No objection) C (Amendment & resubmission required)  
B (No objection, subject to comments as noted) D (Rejected & resubmission required)

w/e

	cc	w/e
MTRC (Site)	<input type="checkbox"/>	<input type="checkbox"/> Mr. KS Lee / Mr. Teddy Wu / Mr. HF Au / Mr. Si Kwai / Mr. Jacky Cheung
MTRC (STR)	<input type="checkbox"/>	<input type="checkbox"/> Mr. Tony Fan
MTRC (E&M)	<input type="checkbox"/>	<input type="checkbox"/> Mr. Ricky Ling
MTRC (Cost & Prog)	<input type="checkbox"/>	<input type="checkbox"/> Mr. Anthony Tam
SKY CASTLE	<input checked="" type="checkbox"/>	<input type="checkbox"/> Mr. Herbert Thang / Mr. Francis Lau / Mr. Tony Ho / Mr. Kenneth Wong / Mr. Andy Chan
AECOM	<input type="checkbox"/>	<input type="checkbox"/> Mr. Henry Lo / Mr. Cole Li
AECOM (Facade)	<input checked="" type="checkbox"/>	<input type="checkbox"/> Ms. Moana Lee / Ms. Phoenix Chung / Mr. Ryan Kwok
WSP	<input type="checkbox"/>	<input type="checkbox"/> Mr. Simon Kwan / Mr. Tommy Leung
ADI (LANDSCAPE)	<input type="checkbox"/>	<input type="checkbox"/> Mr. Wilson So / Mr. Kendall Ng
MDL	<input checked="" type="checkbox"/>	<input type="checkbox"/> Mr. Mervyn Law
Boris	<input checked="" type="checkbox"/>	<input type="checkbox"/> Mr. Keith Yim / Mr. Randolph Chan
RE (AECOM)	<input type="checkbox"/>	<input type="checkbox"/> Mr. Simon Tso / Mr. Ken So
COW	<input checked="" type="checkbox"/>	<input type="checkbox"/> Mr. Marcus Koo
BSI	<input type="checkbox"/>	<input type="checkbox"/> BSI
WSP (Safety & Risk)	<input type="checkbox"/>	<input type="checkbox"/> Mr. Chris Tong / Mr. Louis Si
Ramboll	<input type="checkbox"/>	<input type="checkbox"/> Mr. David Yeung
Tin Lee	<input type="checkbox"/>	<input type="checkbox"/> Mr. Eddie Kwun
AEC	<input type="checkbox"/>	<input type="checkbox"/> Mr. Andy Le

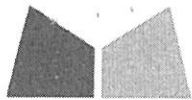

美特鋁質有限公司  
MIDI ALUMINIUM FABRICATOR LTD.

Our ref. MC/41175/858

4<sup>th</sup> April, 2022

Gammon Construction Company Limited  
22/F Tower 1, The Quayside,  
77 Hoi Bun Road,  
Kwun Tong, Kowloon.

By Email & Hand

Attn.: Mr. Matthew Wong

Dear Sir,

**Re: Design, Supply and Installation of Curtain Wall, Glass Wall, Aluminium Window, Aluminium Cladding, Aluminium Louvres and Glass Balustrade Nominated Sub-Contract at T.K.O.T.L. 70 RP, Phase 11, LOHAS Park, Tseung Kwan O, N.T. Submission of Color Sample for Dowsil 791 (Tailor - Made Silver Champagne) & (Grey) (MS024)**

As per Comment on 3rd Mar , we would like to submit color sample for Dowsil 791 for your review and comment.

Remarks:

1) **Tailor - Made Silver Champagne color (code : 577) to be used (Highlighted in Orange)**

**Same as Grand Central** (to be used at interior of flat)

1. For the interface between Mullion and Transom and
2. For Protective Glass Barrier

Minimum Order for Silver Champagne color is 1728 支

Please issue A.I to Confirm to the Tailor - Made Silver Champagne color

change to Dark Grey as per latest instruction from Sino

2) **Standard Grey color to be used (Highlighted in Red)**

1. Curtain Wall (except the interface between Mullion and Transom) and Protective Glass Barrier
2. Glass Cladding
3. Glazing
4. Backpan
5. Sliding Door
6. Cladding

(at interior of flat)

Remarks:

- 1.) The sample will be delivered to RLP office directly.

If you have any query, please feel free to contact us.

Thank you for your kind attention.

.../P.2