



工程指示 / 要求簡箋 ENGINEER INSTRUCTIONS(E.I.)

工程指示編號:	EI- 5024 / 22	修改版本:	-
	HK- 1410 / 22		
工程編號:	J 857	工程名稱:	啟德6552
收件人:	生統	發件人:	Nero HO
工程項目:	幕牆單元件 - 生產批次調動	日期:	24/08/2022

<input type="checkbox"/> 原合約工程包	<input type="checkbox"/> 原合約工程加 / 減賬 QT-	<input type="checkbox"/> 新工程報價 QT-
---------------------------------	--	------------------------------------

信件批核號碼/圖紙參考編號:	批核模具圖紙編號:
客戶指示附件:	管理內部批簽署:

<input type="checkbox"/> 初步鋁料 B.M.	<input type="checkbox"/> 加工拆圖, 然後生產	<input type="checkbox"/> 尺寸表
<input type="checkbox"/> 正式鋁料 B.M.	<input type="checkbox"/> 技術上資料 / 指示	<input type="checkbox"/> 報價
<input type="checkbox"/> 配件 B.M.	<input type="checkbox"/> 樣辦或貨品說明書	<input type="checkbox"/> 分判合約
<input checked="" type="checkbox"/> 其他: 生產批次		

內容:

由於地盤沙機安裝位置有變動安裝, SD-PE-3010(原安裝沙機位置)會改在SD-PE-3009(新安裝沙機位置), 因此生產批次需要配合作出調整。

詳情調動要求, 請參閱附件資料。

完成上列要求日期: / /

國內

<input type="checkbox"/> 生產技術總監	<input type="checkbox"/> 連附件	<input type="checkbox"/> 技術部	<input type="checkbox"/> 連附件	<input type="checkbox"/> 生產部	<input type="checkbox"/> 連附件
<input type="checkbox"/> 採購部	<input type="checkbox"/> 連附件	<input checked="" type="checkbox"/> 生產統籌部	<input checked="" type="checkbox"/> 連附件	<input type="checkbox"/> 報關組	<input type="checkbox"/> 連附件
<input type="checkbox"/> 質檢部	<input type="checkbox"/> 連附件	<input type="checkbox"/> 會計部	<input type="checkbox"/> 連附件	<input type="checkbox"/> 機械設計部	<input type="checkbox"/> 連附件
<input type="checkbox"/> 香港辦	<input type="checkbox"/> 連附件	<input type="checkbox"/> 其他:			

<input type="checkbox"/> 行政部	<input type="checkbox"/> 連附件	<input type="checkbox"/> 會計部	<input type="checkbox"/> 連附件	<input type="checkbox"/> 統籌部	<input type="checkbox"/> 連附件	<input type="checkbox"/> 工程部	<input type="checkbox"/> 連附件
<input type="checkbox"/> 採購部	<input type="checkbox"/> 連附件	<input type="checkbox"/> QS部	<input type="checkbox"/> 連附件	<input type="checkbox"/> 地盤管理	<input type="checkbox"/> 連附件	<input type="checkbox"/> 維修部	<input type="checkbox"/> 連附件

*發件人簽署:	<i>NH</i>	*組別成員批核簽署:	
傳遞編號:	HK 1410 / 22	項目經理簽署:	<i>[Signature]</i>

J857单元幕墙单元件派位图

SD-PE-3009/T8&T7座北面

J857单元幕墙单元件派位图									
SD-PE-3009/T8&T7座北面									
	31F								
	30F								
序號5.	29F	CW-269	CW-270	CW-271	CW-272	CW-273	CW-274	CW-275	CW-264A
		1097.5*3300/F	560*3300/SHR	1583*3300/F	700*3300/SHR	560*3300/SHL	1428.5*3300/F	538.5*3300/F	500*3300/SHR
	28F	CW-269	CW-270	CW-271	CW-272	CW-273	CW-274	CW-275	CW-264A
		1097.5*3300/F	560*3300/SHR	1583*3300/F	700*3300/SHR	560*3300/SHL	1428.5*3300/F	538.5*3300/F	500*3300/SHR
	27F	CW-269	CW-270	CW-271	CW-272	CW-273	CW-274	CW-275	CW-264A
		1097.5*3300/F	560*3300/SHR	1583*3300/F	700*3300/SHR	560*3300/SHL	1428.5*3300/F	538.5*3300/F	500*3300/SHR
	26F/ 吊船碼	CW-269D	CW-270	CW-271D	CW-272	CW-273	CW-274D	CW-275D	CW-264A
		1097.5*3300/F/吊船碼	560*3300/SHR	1583*3300/F/吊船碼	700*3300/SHR	560*3300/SHL	1428.5*3300/F/吊船碼	538.5*3300/F/吊船碼	500*3300/SHR
	25F	CW-269	CW-270	CW-271	CW-272	CW-273	CW-274	CW-275	CW-264A
		1097.5*3300/F	560*3300/SHR	1583*3300/F	700*3300/SHR	560*3300/SHL	1428.5*3300/F	538.5*3300/F	500*3300/SHR
23F	CW-269	CW-270	CW-271	CW-272	CW-273	CW-274	CW-275	CW-264A	
	1097.5*3300/F	560*3300/SHR	1583*3300/F	700*3300/SHR	560*3300/SHL	1428.5*3300/F	538.5*3300/F	500*3300/SHR	
22F	CW-269	CW-270	CW-271	CW-272	CW-273	CW-274	CW-275	CW-264A	
	1097.5*3300/F	560*3300/SHR	1583*3300/F	700*3300/SHR	560*3300/SHL	1428.5*3300/F	538.5*3300/F	500*3300/SHR	
21F	CW-269	CW-270	CW-271	CW-272	CW-273	CW-274	CW-275	CW-264A	
	1097.5*3300/F	560*3300/SHR	1583*3300/F	700*3300/SHR	560*3300/SHL	1428.5*3300/F	538.5*3300/F	500*3300/SHR	
序號4.	20F	CW-269	CW-270	CW-271	CW-272	CW-273	CW-274	CW-275	CW-264A
		1097.5*3300/F	560*3300/SHR	1583*3300/F	700*3300/SHR	560*3300/SHL	1428.5*3300/F	538.5*3300/F	500*3300/SHR
	19F/ 吊船碼	CW-269D	CW-270	CW-271D	CW-272	CW-273	CW-274D	CW-275D	CW-264A
		1097.5*3300/F/吊船碼	560*3300/SHR	1583*3300/F/吊船碼	700*3300/SHR	560*3300/SHL	1428.5*3300/F/吊船碼	538.5*3300/F/吊船碼	500*3300/SHR
	18F	CW-269	CW-270	CW-271	CW-272	CW-273	CW-274	CW-275	CW-264A
		1097.5*3300/F	560*3300/SHR	1583*3300/F	700*3300/SHR	560*3300/SHL	1428.5*3300/F	538.5*3300/F	500*3300/SHR
	17F	CW-269	CW-270	CW-271	CW-272	CW-273	CW-274	CW-275	CW-264A
		1097.5*3300/F	560*3300/SHR	1583*3300/F	700*3300/SHR	560*3300/SHL	1428.5*3300/F	538.5*3300/F	500*3300/SHR
	16F	CW-269	CW-270	CW-271	CW-272	CW-273	CW-274	CW-275	CW-264A
		1097.5*3300/F	560*3300/SHR	1583*3300/F	700*3300/SHR	560*3300/SHL	1428.5*3300/F	538.5*3300/F	500*3300/SHR
15F	CW-269	CW-270	CW-271	CW-272	CW-273	CW-274	CW-275	CW-264A	
	1097.5*3300/F	560*3300/SHR	1583*3300/F	700*3300/SHR	560*3300/SHL	1428.5*3300/F	538.5*3300/F	500*3300/SHR	
序號1.	12F/ 吊船碼	CW-269D	CW-270	CW-271D	CW-272	CW-273	CW-274D	CW-275D	CW-264A
		1097.5*3300/F/吊船碼	560*3300/SHR	1583*3300/F/吊船碼	700*3300/SHR	560*3300/SHL	1428.5*3300/F/吊船碼	538.5*3300/F/吊船碼	500*3300/SHR
	11F	CW-269	CW-270	CW-271	CW-272	CW-273	CW-274	CW-275	CW-264A
		1097.5*3300/F	560*3300/SHR	1583*3300/F	700*3300/SHR	560*3300/SHL	1428.5*3300/F	538.5*3300/F	500*3300/SHR
	10F	CW-269	CW-270	CW-271	CW-272	CW-273	CW-274	CW-275	CW-264A
		1097.5*3300/F	560*3300/SHR	1583*3300/F	700*3300/SHR	560*3300/SHL	1428.5*3300/F	538.5*3300/F	500*3300/SHR
	9F	CW-269	CW-270	CW-271	CW-272	CW-273	CW-274	CW-275	CW-264A
		1097.5*3300/F	560*3300/SHR	1583*3300/F	700*3300/SHR	560*3300/SHL	1428.5*3300/F	538.5*3300/F	500*3300/SHR
	8F	CW-269	CW-270	CW-271	CW-272	CW-273	CW-274	CW-275	CW-264A
		1097.5*3300/F	560*3300/SHR	1583*3300/F	700*3300/SHR	560*3300/SHL	1428.5*3300/F	538.5*3300/F	500*3300/SHR
7F/ 吊船碼	CW-269D	CW-270	CW-271D	CW-272	CW-273	CW-274D	CW-275D	CW-264A	
	1097.5*3300/F/吊船碼	560*3300/SHR	1583*3300/F/吊船碼	700*3300/SHR	560*3300/SHL	1428.5*3300/F/吊船碼	538.5*3300/F/吊船碼	500*3300/SHR	
MO1	6F	CW-269	CW-270	CW-271	CW-272	CW-273	CW-274	CW-275	CW-264A
		1097.5*3300/F	560*3300/SHR	1583*3300/F	700*3300/SHR	560*3300/SHL	1428.5*3300/F	538.5*3300/F	500*3300/SHR
	5F	CW-269	CW-270	CW-271	CW-272	CW-273	CW-274	CW-275	CW-264A
		1097.5*3300/F	560*3300/SHR	1583*3300/F	700*3300/SHR	560*3300/SHL	1428.5*3300/F	538.5*3300/F	500*3300/SHR
		CW-069	CW-070	CW-071	CW-072				
		1097.5*845/底樑	560*845/底樑	1583*845/底樑	700*845/底樑				
		T8座				T7座			

序號1. MO4(3B)3009的7F至12F→繼續生產加工至完成此批次，完成後存倉。

序號2. MO5(3B)3009(靠右)7座的15F至20F→生產批次改為MO9(5)

序號3. MO7(3C)3009(靠右)7座的21F至29F→生產批次改為MO11(5)

序號4. MO5(3B)3009(靠左)8座的15F至20F→生產批次維持不變

序號5. MO7(3C)3009(靠左)8座的21F至29F→生產批次維持不變

序號6. MO9(5)3010(靠右)6座的5F至18F及(靠左)7座7F至16F→MO5(3B)

序號7. MO11(5)3010(靠右)6座的19F至31F及(靠左)7座17F至29F→MO7(3C)

J857单元幕墙单元件派位图							
SD-PE-3010/T7&T6座北面							
					33F		
					32F		
序號7.	29F	CW-276 1171*3300/TH	CW-212 790*3300/F	CW-278 950*3300/F	CW-279 560*3300/SHR	31F	
	28F	CW-276 1171*3300/TH	CW-212 790*3300/F	CW-278 950*3300/F	CW-279 560*3300/SHR	30F	
	27F	CW-276 1171*3300/TH	CW-212 790*3300/F	CW-278 950*3300/F	CW-279 560*3300/SHR	29F	
	26F/ 吊船碼	CW-276 1171*3300/TH	CW-212E 790*3300/F/吊船碼	CW-278D 950*3300/F/吊船碼	CW-279 560*3300/SHR	28F/ 吊船碼	
	25F	CW-276 1171*3300/TH	CW-212 790*3300/F	CW-278 950*3300/F	CW-279 560*3300/SHR	27F	
	23F	CW-276 1171*3300/TH	CW-212 790*3300/F	CW-278 950*3300/F	CW-279 560*3300/SHR	26F	
	22F	CW-276 1171*3300/TH	CW-212 790*3300/F	CW-278 950*3300/F	CW-279 560*3300/SHR	25F	
	21F	CW-276 1171*3300/TH	CW-212 790*3300/F	CW-278 950*3300/F	CW-279 560*3300/SHR	23F	
	20F	CW-276 1171*3300/TH	CW-212 790*3300/F	CW-278 950*3300/F	CW-279 560*3300/SHR	22F	
	19F/ 吊船碼	CW-276 1171*3300/TH	CW-212E 790*3300/F/吊船碼	CW-278D 950*3300/F/吊船碼	CW-279 560*3300/SHR	21F/ 吊船碼	
	18F	CW-276 1171*3300/TH	CW-212 790*3300/F	CW-278 950*3300/F	CW-279 560*3300/SHR	20F	
	17F	CW-276 1171*3300/TH	CW-212 790*3300/F	CW-278 950*3300/F	CW-279 560*3300/SHR	19F	
	序號6.	16F	CW-276 1171*3300/TH	CW-212 790*3300/F	CW-278 950*3300/F	CW-279 560*3300/SHR	18F
		15F	CW-276 1171*3300/TH	CW-212 790*3300/F	CW-278 950*3300/F	CW-279 560*3300/SHR	17F
12F/ 吊船碼		CW-276 1171*3300/TH	CW-212E 790*3300/F/吊船碼	CW-278D 950*3300/F/吊船碼	CW-279 560*3300/SHR	16F/ 吊船碼	
11F		CW-276 1171*3300/TH	CW-212 790*3300/F	CW-278 950*3300/F	CW-279 560*3300/SHR	15F	
10F		CW-276 1171*3300/TH	CW-212 790*3300/F	CW-278 950*3300/F	CW-279 560*3300/SHR	12F	
9F		CW-276 1171*3300/TH	CW-212 790*3300/F	CW-278 950*3300/F	CW-279 560*3300/SHR	11F	
8F		CW-276 1171*3300/TH	CW-212 790*3300/F	CW-278 950*3300/F	CW-279 560*3300/SHR	10F	
7F/ 吊船碼		CW-276 1171*3300/TH	CW-212E 790*3300/F/吊船碼	CW-278D 950*3300/F/吊船碼	CW-279 560*3300/SHR	9F/ 吊船碼	
MO1	6F	CW-276 1171*3300/TH	CW-212 790*3300/F	CW-278 950*3300/F	CW-279 560*3300/SHR	8F	
	5F	CW-076 1171*845/底梗	CW-212 790*3300/F	CW-278 950*3300/F	CW-279 560*3300/SHR	7F	
			CW-212 790*3300/F	CW-278 950*3300/F	CW-279 560*3300/SHR	6F	
			CW-304 790*3300/F	CW-278 950*3300/F	CW-279 560*3300/SHR	5F	
			CW-303 790*3300/F	CW-278 950*3300/F	CW-279 560*3300/SHR	3F	
			CW-303 790*3300/F	CW-278 950*3300/F	CW-279 560*3300/SHR	2F	
			CW-077 790*845/底梗	CW-078 950*845/底梗	CW-079 560*845/底梗	MO1	

T7座	T6座
-----	-----

- 序號1. MO4(3B)3009的7F至12F→繼續生產加工至完成此批次，完成後存倉。
 序號2. MO5(3B)3009(靠右)7座的15F至20F→生產批次改為MO9(5)
 序號3. MO7(3C)3009(靠右)7座的21F至29F→生產批次改為MO11(5)
 序號4. MO5(3B)3009(靠左)8座的15F至20F→生產批次維持不變
 序號5. MO7(3C)3009(靠左)8座的21F至29F→生產批次維持不變
 序號6. MO9(5)3010(靠右)6座的5F至18F及(靠左)7座7F至16F→MO5(3B)
 序號7. MO11(5)3010(靠右)6座的19F至31F及(靠左)7座17F至29F→MO7(3C)

3009 及 3010 生產批次
最新排產調動要求
(20220824)

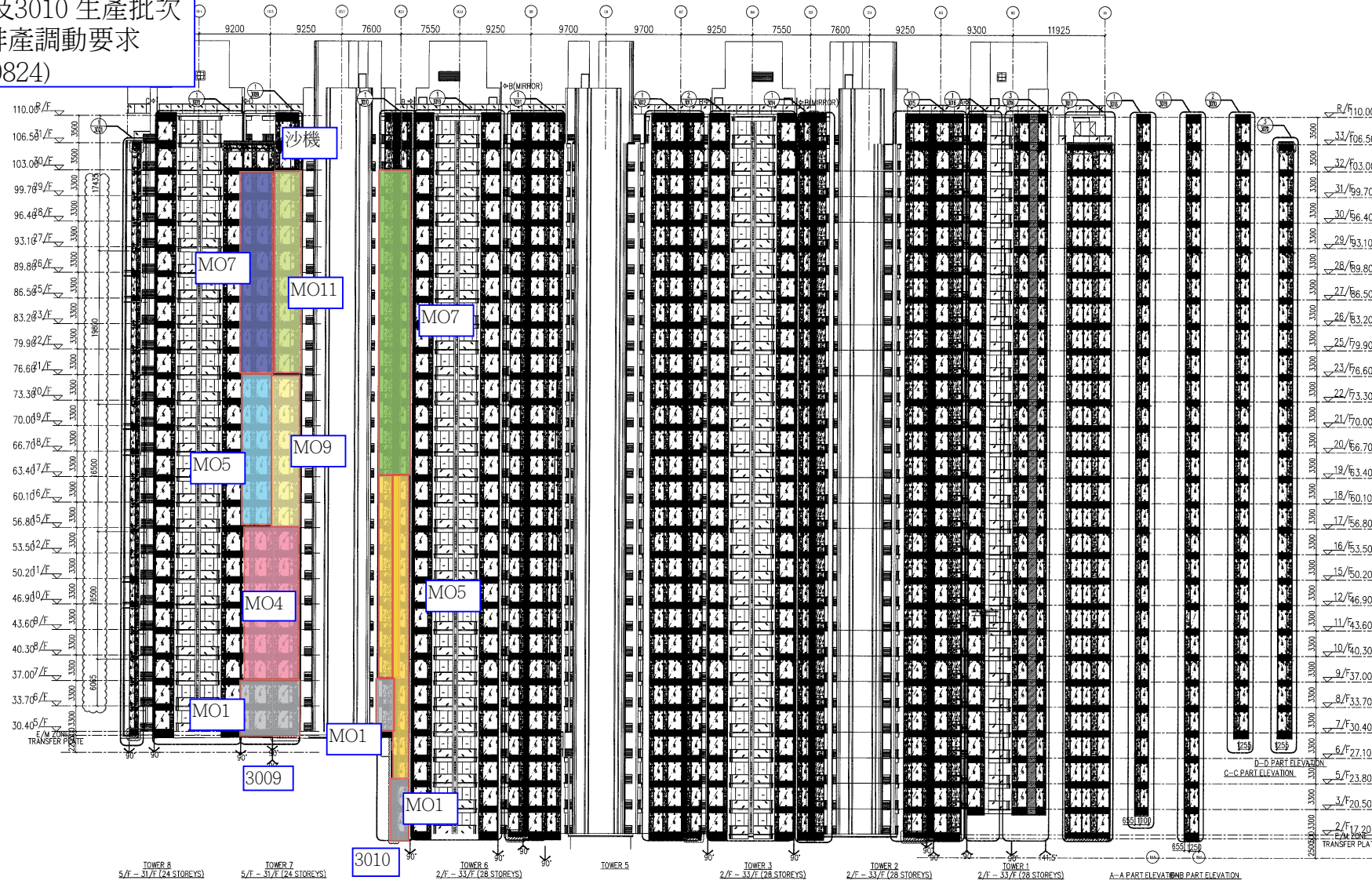

B.D. REF :
F.S.D. REF :
Note :
1. All dimensions are in mm.
2. All elevations are viewed from outside.
3. All dimensions to be verified on site before fabrication.

GENERAL NOTES

- Legend :
- F.F.L. --- Finished Floor Level
 - S.F.L. --- Structural Floor Level
 - Reversed Detail
- X1 --- DETAIL MARK NO.
X001 --- REFER SHEET NO.

REV	DATE	DESCRIPTION	BY
E	16.Apr.2022	GENERAL REVISION	
D	04.FEB.2022	GENERAL REVISION	
C	04.JAN.2022	GENERAL REVISION	
B	22.Nov.2021	GENERAL REVISION	
A	10.Nov.2021	GENERAL REVISION	

CLIENT :
MARBLE EDGE INVESTMENT LTD.

ARCHITECT :
RONALD LU & PARTNERS
ARCHITECTS | PLANNERS | INTERIOR DESIGNERS

STRUCTURAL ENGINEER :
CMA C M WONG & ASSOCIATES LTD
STRUCTURAL ENGINEERS

MAIN CONTRACTOR :
裕民建築有限公司

美特鋁質有限公司
MIDI ALUMINIUM FABRICATOR LTD.
Units 5-8, Sunray Industrial Centre, 1/F
610 Cho Kwo Ling Road, Kwailoon
Tel: 25489211-4 Fax: (852) 2727666

PROJECT :
PROPOSED RESIDENTIAL DEVELOPMENT AT NEW KOWLOON INLAND LOT. NO.6552

TITLE :
TOWER ELEVATION "2" FOR TOWER 1-8

JOB NO. : J-857
DRAWN BY : AN DATE : 18.Oct.2021
CHKD BY : SCALE : A1:250.00000
DWG. NO. : SD-EL-2002 REV. : A

- LEGEND :
- S.F.L. = STRUCTURAL FLOOR LEVEL
C.W. = UNITIZED CURTAIN WALL (FOR BD APPROVAL)
◁EM1 = WIND LOAD +DEAD LOAD FIXING LOCATION
◁EM2 = WIND LOAD +DEAD LOAD FIXING LOCATION
◁EM3 = WIND LOAD FIXING LOCATION
GL1 = 8mm HEAT STRENGTHEN LOW IRON GLASS + 1.52 PVB INTERLAYER+
GL2 = 8mm HEAT STRENGTHEN LOW IRON GLASS + 12mm AIR SPACE +12mm LOW IRON FULLY TEMPERED IGI LAMINATED CLEAR GLASS
GL3 = 8mm HEAT STRENGTHEN LOW IRON GLASS + 1.52 PVB INTERLAYER+
GL4 = 8mm HEAT STRENGTHEN LOW IRON GLASS + 8mm AIR SPACE +8mm LOW IRON FULLY TEMPERED IGI UNLAINED CLEAR GLASS
GL5 = 8mm HEAT STRENGTHEN LOW IRON GLASS + 1.52 PVB INTERLAYER+
GL6 = 8mm HEAT STRENGTHEN LOW IRON GLASS + 12mm AIR SPACE +10mm LOW IRON FULLY TEMPERED LAMINATED GLASS
GB = 10mm FULLY TEMPERED MONOLITHIC CLEAR GLASS (BARRIER)

- S.J. = STACK JOINT
M1 = EXTRUDED ALUM. MALE MULLION (AL03)
M2 = EXTRUDED ALUM. MALE MULLION (AL03A)
M3 = EXTRUDED ALUM. FEMALE MULLION (AL04)
M4 = EXTRUDED ALUM. FEMALE MULLION (AL04A)
M5 = EXTRUDED ALUM. FEMALE MULLION (AL04B)
M6 = EXTRUDED ALUM. OUTER CORNER MALE MULLION (AL07)
M7 = EXTRUDED ALUM. OUTER CORNER FEMALE MULLION (AL08)
M8 = EXTRUDED ALUM. OUTER CORNER MALE MULLION (AL08)
M9 = EXTRUDED ALUM. OUTER CORNER FEMALE MULLION (AL08)
M10 = EXTRUDED ALUM. OUTER CORNER FEMALE MULLION (AL85)
M11 = EXTRUDED ALUM. INTERMEDIATE MULLION (AL65)
M12 = EXTRUDED ALUM. INTERMEDIATE MULLION (AL66)
M13 = EXTRUDED ALUM. INTERMEDIATE MULLION (AL66)
M14 = EXTRUDED ALUM. INTERMEDIATE MULLION (AL67)
M15 = EXTRUDED ALUM. MALE MULLION (AL67)
M16 = EXTRUDED ALUM. FEMALE MULLION (AL68)

- T1 = EXTRUDED ALUM. SILL STACK JOINT (AL11)
T2 = EXTRUDED ALUM. GUTTER STACK JOINT (AL12)
T3 = EXTRUDED ALUM. INTERMEDIATE TRANSOM (AL13)
T4 = EXTRUDED ALUM. INTERMEDIATE TRANSOM (AL15)
T5 = EXTRUDED ALUM. INTERMEDIATE TRANSOM (AL14)
T6 = EXTRUDED ALUM. TRANSOM (AL71)
T7 = EXTRUDED ALUM. TRANSOM (AL72)
T8 = EXTRUDED ALUM. TRANSOM (AL69)
T9 = EXTRUDED ALUM. TRANSOM (AL70)
T10 = EXTRUDED ALUM. INTERMEDIATE TRANSOM (AL106)
T11 = EXTRUDED ALUM. INTERMEDIATE TRANSOM (AL107)
T12 = EXTRUDED ALUM. INTERMEDIATE TRANSOM (AL105)
T13 = EXTRUDED ALUM. GUTTER STACK JOINT (AL105)

- TS = EXTRUDED ALUM. SILL STACK JOINT (AL11)
TG = EXTRUDED ALUM. GUTTER STACK JOINT (AL12)
TT = EXTRUDED ALUM. INTERMEDIATE TRANSOM (AL13)
TU = EXTRUDED ALUM. INTERMEDIATE TRANSOM (AL15)
TV = EXTRUDED ALUM. INTERMEDIATE TRANSOM (AL14)
TW = EXTRUDED ALUM. TRANSOM (AL71)
TX = EXTRUDED ALUM. TRANSOM (AL72)
TY = EXTRUDED ALUM. TRANSOM (AL69)
TZ = EXTRUDED ALUM. TRANSOM (AL70)
TA = EXTRUDED ALUM. INTERMEDIATE TRANSOM (AL106)
TB = EXTRUDED ALUM. INTERMEDIATE TRANSOM (AL107)
TC = EXTRUDED ALUM. INTERMEDIATE TRANSOM (AL105)

TOWER 1-8 ELEVATION
SCALE: 1:250.00000

