

EXTRUSION MARK: (AL79) EXTRUDED ALUM. BRACKET GRADE: 6063-T6	EXTRUSION MARK: (AL80) EXTRUDED ALUM. ADAPTOR GRADE: 6063-T5	EXTRUSION MARK: (AL81) EXTRUDED ALUM. BRACKET GRADE: 6061-T6	EXTRUSION MARK: (AL82) EXTRUDED ALUM. OPENABLE FRAME GRADE: 6063-T5	EXTRUSION MARK: (AL83) EXTRUDED ALUM. WASHER GRADE: 6063-T5	EXTRUSION MARK: (AL87) EXTRUDED ALUM. ADAPTOR GRADE: 6063-T6																																																																																																																																																																																																
<table border="1"> <tr><th>MASS PROPERTIES (UNIT)</th><th>VALUES</th></tr> <tr><td>Area (mm²)</td><td>299</td></tr> <tr><td>Perimeter (mm)</td><td>135</td></tr> <tr><td>Bounding Box - X (mm)</td><td>-4 to 7</td></tr> <tr><td>Bounding Box - Y (mm)</td><td>-30 to 29</td></tr> <tr><td>Centroid - X (mm)</td><td>0.0000</td></tr> <tr><td>Centroid - Y (mm)</td><td>0.0000</td></tr> <tr><td>Moments of inertia - X (mm⁴)</td><td>79707</td></tr> <tr><td>Moments of inertia - Y (mm⁴)</td><td>4554</td></tr> <tr><td>Product of inertia - XY (mm⁴)</td><td>15354</td></tr> <tr><td>Radii of gyration - X (mm)</td><td>16</td></tr> <tr><td>Radii of gyration - Y (mm)</td><td>4</td></tr> <tr><td>Principal moments along X-Y (mm⁴)</td><td>82723 along [0]</td></tr> <tr><td>Principal moments along Y-X (mm⁴)</td><td>1548 along [0.1]</td></tr> <tr><td>Elastic Modulus - Zx (mm²)</td><td>1 / y-max= 2865</td></tr> <tr><td>Elastic Modulus - Zy (mm²)</td><td>1 / x-max= 666</td></tr> </table>	MASS PROPERTIES (UNIT)	VALUES	Area (mm ²)	299	Perimeter (mm)	135	Bounding Box - X (mm)	-4 to 7	Bounding Box - Y (mm)	-30 to 29	Centroid - X (mm)	0.0000	Centroid - Y (mm)	0.0000	Moments of inertia - X (mm ⁴)	79707	Moments of inertia - Y (mm ⁴)	4554	Product of inertia - XY (mm ⁴)	15354	Radii of gyration - X (mm)	16	Radii of gyration - Y (mm)	4	Principal moments along X-Y (mm ⁴)	82723 along [0]	Principal moments along Y-X (mm ⁴)	1548 along [0.1]	Elastic Modulus - Zx (mm ²)	1 / y-max= 2865	Elastic Modulus - Zy (mm ²)	1 / x-max= 666	<table border="1"> <tr><th>MASS PROPERTIES (UNIT)</th><th>VALUES</th></tr> <tr><td>Area (mm²)</td><td>576</td></tr> <tr><td>Perimeter (mm)</td><td>384</td></tr> <tr><td>Bounding Box - X (mm)</td><td>-15 to 12</td></tr> <tr><td>Bounding Box - Y (mm)</td><td>-39 to 39</td></tr> <tr><td>Centroid - X (mm)</td><td>0</td></tr> <tr><td>Centroid - Y (mm)</td><td>0</td></tr> <tr><td>Moments of inertia - X (mm⁴)</td><td>373277</td></tr> <tr><td>Moments of inertia - Y (mm⁴)</td><td>47971</td></tr> <tr><td>Product of inertia - XY (mm⁴)</td><td>9231</td></tr> <tr><td>Radii of gyration - X (mm)</td><td>25</td></tr> <tr><td>Radii of gyration - Y (mm)</td><td>9</td></tr> <tr><td>Principal moments along X-Y (mm⁴)</td><td>373539 along [1.0]</td></tr> <tr><td>Principal moments along Y-X (mm⁴)</td><td>47710 along [0.1]</td></tr> <tr><td>Elastic Modulus - Zx (mm²)</td><td>1 / y-max= 3376</td></tr> <tr><td>Elastic Modulus - Zy (mm²)</td><td>1 / x-max= 3282</td></tr> </table>	MASS PROPERTIES (UNIT)	VALUES	Area (mm ²)	576	Perimeter (mm)	384	Bounding Box - X (mm)	-15 to 12	Bounding Box - Y (mm)	-39 to 39	Centroid - X (mm)	0	Centroid - Y (mm)	0	Moments of inertia - X (mm ⁴)	373277	Moments of inertia - Y (mm ⁴)	47971	Product of inertia - XY (mm ⁴)	9231	Radii of gyration - X (mm)	25	Radii of gyration - Y (mm)	9	Principal moments along X-Y (mm ⁴)	373539 along [1.0]	Principal moments along Y-X (mm ⁴)	47710 along [0.1]	Elastic Modulus - Zx (mm ²)	1 / y-max= 3376	Elastic Modulus - Zy (mm ²)	1 / x-max= 3282	<table border="1"> <tr><th>MASS PROPERTIES (UNIT)</th><th>VALUES</th></tr> <tr><td>Area (mm²)</td><td>1786</td></tr> <tr><td>Perimeter (mm)</td><td>457</td></tr> <tr><td>Bounding Box - X (mm)</td><td>-15 to 9</td></tr> <tr><td>Bounding Box - Y (mm)</td><td>-95 to 77</td></tr> <tr><td>Centroid - X (mm)</td><td>0</td></tr> <tr><td>Centroid - Y (mm)</td><td>0</td></tr> <tr><td>Moments of inertia - X (mm⁴)</td><td>3863224</td></tr> <tr><td>Moments of inertia - Y (mm⁴)</td><td>167991</td></tr> <tr><td>Product of inertia - XY (mm⁴)</td><td>313342</td></tr> <tr><td>Radii of gyration - X (mm)</td><td>47</td></tr> <tr><td>Radii of gyration - Y (mm)</td><td>10</td></tr> <tr><td>Principal moments along X-Y (mm⁴)</td><td>3988220 along [1.0]</td></tr> <tr><td>Principal moments along Y-X (mm⁴)</td><td>142295 along [0.1]</td></tr> <tr><td>Elastic Modulus - Zx (mm²)</td><td>1 / y-max= 4159</td></tr> <tr><td>Elastic Modulus - Zy (mm²)</td><td>1 / x-max= 4683</td></tr> </table>	MASS PROPERTIES (UNIT)	VALUES	Area (mm ²)	1786	Perimeter (mm)	457	Bounding Box - X (mm)	-15 to 9	Bounding Box - Y (mm)	-95 to 77	Centroid - X (mm)	0	Centroid - Y (mm)	0	Moments of inertia - X (mm ⁴)	3863224	Moments of inertia - Y (mm ⁴)	167991	Product of inertia - XY (mm ⁴)	313342	Radii of gyration - X (mm)	47	Radii of gyration - Y (mm)	10	Principal moments along X-Y (mm ⁴)	3988220 along [1.0]	Principal moments along Y-X (mm ⁴)	142295 along [0.1]	Elastic Modulus - Zx (mm ²)	1 / y-max= 4159	Elastic Modulus - Zy (mm ²)	1 / x-max= 4683	<table border="1"> <tr><th>MASS PROPERTIES (UNIT)</th><th>VALUES</th></tr> <tr><td>Area (mm²)</td><td>706.8704</td></tr> <tr><td>Perimeter (mm)</td><td>406.5127</td></tr> <tr><td>Bounding Box - X (mm)</td><td>-36 to 9</td></tr> <tr><td>Bounding Box - Y (mm)</td><td>-46.7327 to 29.2873</td></tr> <tr><td>Centroid - X (mm)</td><td>0.0000</td></tr> <tr><td>Centroid - Y (mm)</td><td>0.0000</td></tr> <tr><td>Moments of inertia - X (mm⁴)</td><td>384621.7134</td></tr> <tr><td>Moments of inertia - Y (mm⁴)</td><td>148928.3679</td></tr> <tr><td>Product of inertia - XY (mm⁴)</td><td>124727.8580</td></tr> <tr><td>Radii of gyration - X (mm)</td><td>23.4260</td></tr> <tr><td>Radii of gyration - Y (mm)</td><td>14.5722</td></tr> <tr><td>Principal moments along X-Y (mm⁴)</td><td>436390.8181 along [0.9184 0.3937]</td></tr> <tr><td>Principal moments along Y-X (mm⁴)</td><td>9509.2567 along [-0.3937 0.9184]</td></tr> <tr><td>Elastic Modulus - Zx (mm²)</td><td>1 / y-max= 4231.2947</td></tr> <tr><td>Elastic Modulus - Zy (mm²)</td><td>1 / x-max= 5863.8036</td></tr> </table>	MASS PROPERTIES (UNIT)	VALUES	Area (mm ²)	706.8704	Perimeter (mm)	406.5127	Bounding Box - X (mm)	-36 to 9	Bounding Box - Y (mm)	-46.7327 to 29.2873	Centroid - X (mm)	0.0000	Centroid - Y (mm)	0.0000	Moments of inertia - X (mm ⁴)	384621.7134	Moments of inertia - Y (mm ⁴)	148928.3679	Product of inertia - XY (mm ⁴)	124727.8580	Radii of gyration - X (mm)	23.4260	Radii of gyration - Y (mm)	14.5722	Principal moments along X-Y (mm ⁴)	436390.8181 along [0.9184 0.3937]	Principal moments along Y-X (mm ⁴)	9509.2567 along [-0.3937 0.9184]	Elastic Modulus - Zx (mm ²)	1 / y-max= 4231.2947	Elastic Modulus - Zy (mm ²)	1 / x-max= 5863.8036	<table border="1"> <tr><th>MASS PROPERTIES (UNIT)</th><th>VALUES</th></tr> <tr><td>Area (mm²)</td><td>418</td></tr> <tr><td>Perimeter (mm)</td><td>157</td></tr> <tr><td>Bounding Box - X (mm)</td><td>-40 to 30</td></tr> <tr><td>Bounding Box - Y (mm)</td><td>-4 to 4</td></tr> <tr><td>Centroid - X (mm)</td><td>0.0000</td></tr> <tr><td>Centroid - Y (mm)</td><td>0.0000</td></tr> <tr><td>Moments of inertia - X (mm⁴)</td><td>1776</td></tr> <tr><td>Moments of inertia - Y (mm⁴)</td><td>135579</td></tr> <tr><td>Product of inertia - XY (mm⁴)</td><td>0</td></tr> <tr><td>Radii of gyration - X (mm)</td><td>2</td></tr> <tr><td>Radii of gyration - Y (mm)</td><td>17</td></tr> <tr><td>Principal moments along X-Y (mm⁴)</td><td>1776 along [1.0]</td></tr> <tr><td>Principal moments along Y-X (mm⁴)</td><td>125579 along [0.1]</td></tr> <tr><td>Elastic Modulus - Zx (mm²)</td><td>1 / y-max= 397</td></tr> <tr><td>Elastic Modulus - Zy (mm²)</td><td>1 / x-max= 4188</td></tr> </table>	MASS PROPERTIES (UNIT)	VALUES	Area (mm ²)	418	Perimeter (mm)	157	Bounding Box - X (mm)	-40 to 30	Bounding Box - Y (mm)	-4 to 4	Centroid - X (mm)	0.0000	Centroid - Y (mm)	0.0000	Moments of inertia - X (mm ⁴)	1776	Moments of inertia - Y (mm ⁴)	135579	Product of inertia - XY (mm ⁴)	0	Radii of gyration - X (mm)	2	Radii of gyration - Y (mm)	17	Principal moments along X-Y (mm ⁴)	1776 along [1.0]	Principal moments along Y-X (mm ⁴)	125579 along [0.1]	Elastic Modulus - Zx (mm ²)	1 / y-max= 397	Elastic Modulus - Zy (mm ²)	1 / x-max= 4188	<table border="1"> <tr><th>MASS PROPERTIES (UNIT)</th><th>VALUES</th></tr> <tr><td>Area (mm²)</td><td>1229</td></tr> <tr><td>Perimeter (mm)</td><td>736</td></tr> <tr><td>Bounding Box - X (mm)</td><td>-40 to 43</td></tr> <tr><td>Bounding Box - Y (mm)</td><td>-47 to 48</td></tr> <tr><td>Centroid - X (mm)</td><td>0</td></tr> <tr><td>Centroid - Y (mm)</td><td>0</td></tr> <tr><td>Moments of inertia - X (mm⁴)</td><td>893102</td></tr> <tr><td>Moments of inertia - Y (mm⁴)</td><td>645009</td></tr> <tr><td>Product of inertia - XY (mm⁴)</td><td>-510811</td></tr> <tr><td>Radii of gyration - X (mm)</td><td>27</td></tr> <tr><td>Radii of gyration - Y (mm)</td><td>23</td></tr> <tr><td>Principal moments along X-Y (mm⁴)</td><td>1494712 along [1.1]</td></tr> <tr><td>Principal moments along Y-X (mm⁴)</td><td>243398 along [0.1]</td></tr> <tr><td>Elastic Modulus - Zx (mm²)</td><td>1 / y-max= 18493</td></tr> <tr><td>Elastic Modulus - Zy (mm²)</td><td>1 / x-max= 15069</td></tr> </table>	MASS PROPERTIES (UNIT)	VALUES	Area (mm ²)	1229	Perimeter (mm)	736	Bounding Box - X (mm)	-40 to 43	Bounding Box - Y (mm)	-47 to 48	Centroid - X (mm)	0	Centroid - Y (mm)	0	Moments of inertia - X (mm ⁴)	893102	Moments of inertia - Y (mm ⁴)	645009	Product of inertia - XY (mm ⁴)	-510811	Radii of gyration - X (mm)	27	Radii of gyration - Y (mm)	23	Principal moments along X-Y (mm ⁴)	1494712 along [1.1]	Principal moments along Y-X (mm ⁴)	243398 along [0.1]	Elastic Modulus - Zx (mm ²)	1 / y-max= 18493	Elastic Modulus - Zy (mm ²)	1 / x-max= 15069
MASS PROPERTIES (UNIT)	VALUES																																																																																																																																																																																																				
Area (mm ²)	299																																																																																																																																																																																																				
Perimeter (mm)	135																																																																																																																																																																																																				
Bounding Box - X (mm)	-4 to 7																																																																																																																																																																																																				
Bounding Box - Y (mm)	-30 to 29																																																																																																																																																																																																				
Centroid - X (mm)	0.0000																																																																																																																																																																																																				
Centroid - Y (mm)	0.0000																																																																																																																																																																																																				
Moments of inertia - X (mm ⁴)	79707																																																																																																																																																																																																				
Moments of inertia - Y (mm ⁴)	4554																																																																																																																																																																																																				
Product of inertia - XY (mm ⁴)	15354																																																																																																																																																																																																				
Radii of gyration - X (mm)	16																																																																																																																																																																																																				
Radii of gyration - Y (mm)	4																																																																																																																																																																																																				
Principal moments along X-Y (mm ⁴)	82723 along [0]																																																																																																																																																																																																				
Principal moments along Y-X (mm ⁴)	1548 along [0.1]																																																																																																																																																																																																				
Elastic Modulus - Zx (mm ²)	1 / y-max= 2865																																																																																																																																																																																																				
Elastic Modulus - Zy (mm ²)	1 / x-max= 666																																																																																																																																																																																																				
MASS PROPERTIES (UNIT)	VALUES																																																																																																																																																																																																				
Area (mm ²)	576																																																																																																																																																																																																				
Perimeter (mm)	384																																																																																																																																																																																																				
Bounding Box - X (mm)	-15 to 12																																																																																																																																																																																																				
Bounding Box - Y (mm)	-39 to 39																																																																																																																																																																																																				
Centroid - X (mm)	0																																																																																																																																																																																																				
Centroid - Y (mm)	0																																																																																																																																																																																																				
Moments of inertia - X (mm ⁴)	373277																																																																																																																																																																																																				
Moments of inertia - Y (mm ⁴)	47971																																																																																																																																																																																																				
Product of inertia - XY (mm ⁴)	9231																																																																																																																																																																																																				
Radii of gyration - X (mm)	25																																																																																																																																																																																																				
Radii of gyration - Y (mm)	9																																																																																																																																																																																																				
Principal moments along X-Y (mm ⁴)	373539 along [1.0]																																																																																																																																																																																																				
Principal moments along Y-X (mm ⁴)	47710 along [0.1]																																																																																																																																																																																																				
Elastic Modulus - Zx (mm ²)	1 / y-max= 3376																																																																																																																																																																																																				
Elastic Modulus - Zy (mm ²)	1 / x-max= 3282																																																																																																																																																																																																				
MASS PROPERTIES (UNIT)	VALUES																																																																																																																																																																																																				
Area (mm ²)	1786																																																																																																																																																																																																				
Perimeter (mm)	457																																																																																																																																																																																																				
Bounding Box - X (mm)	-15 to 9																																																																																																																																																																																																				
Bounding Box - Y (mm)	-95 to 77																																																																																																																																																																																																				
Centroid - X (mm)	0																																																																																																																																																																																																				
Centroid - Y (mm)	0																																																																																																																																																																																																				
Moments of inertia - X (mm ⁴)	3863224																																																																																																																																																																																																				
Moments of inertia - Y (mm ⁴)	167991																																																																																																																																																																																																				
Product of inertia - XY (mm ⁴)	313342																																																																																																																																																																																																				
Radii of gyration - X (mm)	47																																																																																																																																																																																																				
Radii of gyration - Y (mm)	10																																																																																																																																																																																																				
Principal moments along X-Y (mm ⁴)	3988220 along [1.0]																																																																																																																																																																																																				
Principal moments along Y-X (mm ⁴)	142295 along [0.1]																																																																																																																																																																																																				
Elastic Modulus - Zx (mm ²)	1 / y-max= 4159																																																																																																																																																																																																				
Elastic Modulus - Zy (mm ²)	1 / x-max= 4683																																																																																																																																																																																																				
MASS PROPERTIES (UNIT)	VALUES																																																																																																																																																																																																				
Area (mm ²)	706.8704																																																																																																																																																																																																				
Perimeter (mm)	406.5127																																																																																																																																																																																																				
Bounding Box - X (mm)	-36 to 9																																																																																																																																																																																																				
Bounding Box - Y (mm)	-46.7327 to 29.2873																																																																																																																																																																																																				
Centroid - X (mm)	0.0000																																																																																																																																																																																																				
Centroid - Y (mm)	0.0000																																																																																																																																																																																																				
Moments of inertia - X (mm ⁴)	384621.7134																																																																																																																																																																																																				
Moments of inertia - Y (mm ⁴)	148928.3679																																																																																																																																																																																																				
Product of inertia - XY (mm ⁴)	124727.8580																																																																																																																																																																																																				
Radii of gyration - X (mm)	23.4260																																																																																																																																																																																																				
Radii of gyration - Y (mm)	14.5722																																																																																																																																																																																																				
Principal moments along X-Y (mm ⁴)	436390.8181 along [0.9184 0.3937]																																																																																																																																																																																																				
Principal moments along Y-X (mm ⁴)	9509.2567 along [-0.3937 0.9184]																																																																																																																																																																																																				
Elastic Modulus - Zx (mm ²)	1 / y-max= 4231.2947																																																																																																																																																																																																				
Elastic Modulus - Zy (mm ²)	1 / x-max= 5863.8036																																																																																																																																																																																																				
MASS PROPERTIES (UNIT)	VALUES																																																																																																																																																																																																				
Area (mm ²)	418																																																																																																																																																																																																				
Perimeter (mm)	157																																																																																																																																																																																																				
Bounding Box - X (mm)	-40 to 30																																																																																																																																																																																																				
Bounding Box - Y (mm)	-4 to 4																																																																																																																																																																																																				
Centroid - X (mm)	0.0000																																																																																																																																																																																																				
Centroid - Y (mm)	0.0000																																																																																																																																																																																																				
Moments of inertia - X (mm ⁴)	1776																																																																																																																																																																																																				
Moments of inertia - Y (mm ⁴)	135579																																																																																																																																																																																																				
Product of inertia - XY (mm ⁴)	0																																																																																																																																																																																																				
Radii of gyration - X (mm)	2																																																																																																																																																																																																				
Radii of gyration - Y (mm)	17																																																																																																																																																																																																				
Principal moments along X-Y (mm ⁴)	1776 along [1.0]																																																																																																																																																																																																				
Principal moments along Y-X (mm ⁴)	125579 along [0.1]																																																																																																																																																																																																				
Elastic Modulus - Zx (mm ²)	1 / y-max= 397																																																																																																																																																																																																				
Elastic Modulus - Zy (mm ²)	1 / x-max= 4188																																																																																																																																																																																																				
MASS PROPERTIES (UNIT)	VALUES																																																																																																																																																																																																				
Area (mm ²)	1229																																																																																																																																																																																																				
Perimeter (mm)	736																																																																																																																																																																																																				
Bounding Box - X (mm)	-40 to 43																																																																																																																																																																																																				
Bounding Box - Y (mm)	-47 to 48																																																																																																																																																																																																				
Centroid - X (mm)	0																																																																																																																																																																																																				
Centroid - Y (mm)	0																																																																																																																																																																																																				
Moments of inertia - X (mm ⁴)	893102																																																																																																																																																																																																				
Moments of inertia - Y (mm ⁴)	645009																																																																																																																																																																																																				
Product of inertia - XY (mm ⁴)	-510811																																																																																																																																																																																																				
Radii of gyration - X (mm)	27																																																																																																																																																																																																				
Radii of gyration - Y (mm)	23																																																																																																																																																																																																				
Principal moments along X-Y (mm ⁴)	1494712 along [1.1]																																																																																																																																																																																																				
Principal moments along Y-X (mm ⁴)	243398 along [0.1]																																																																																																																																																																																																				
Elastic Modulus - Zx (mm ²)	1 / y-max= 18493																																																																																																																																																																																																				
Elastic Modulus - Zy (mm ²)	1 / x-max= 15069																																																																																																																																																																																																				

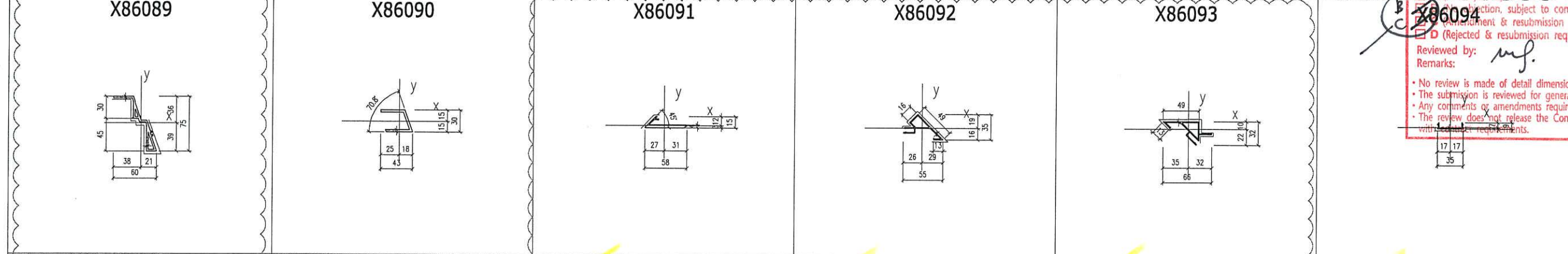

EXTRUSION MARK: (AL88) EXTRUDED ALUM. ADAPTOR GRADE: 6063-T6	EXTRUSION MARK: (AL89) EXTRUDED ALUM. U-CHANNEL (FOR GLASS BARRIER) GRADE: 6063-T6	EXTRUSION MARK: (AL90) EXTRUDED ALUM. ADAPTOR GRADE: 6063-T6	EXTRUSION MARK: (AL91) EXTRUDED ALUM. CAPPING GRADE: 6063-T5	EXTRUSION MARK: (AL92) EXTRUDED ALUM. CAPPING GRADE: 6063-T5	EXTRUSION MARK: (AL93) EXTRUDED ALUM. CAPPING GRADE: 6063-T5																																																																																																																																																																																																
<table border="1"> <tr><th>MASS PROPERTIES (UNIT)</th><th>VALUES</th></tr> <tr><td>Area (mm²)</td><td>430.8271</td></tr> <tr><td>Perimeter (mm)</td><td>346.2122</td></tr> <tr><td>Bounding Box - X (mm)</td><td>-36.0786 to 21.4738</td></tr> <tr><td>Bounding Box - Y (mm)</td><td>-38.2434 to 36.1804</td></tr> <tr><td>Centroid - X (mm)</td><td>0.0000</td></tr> <tr><td>Centroid - Y (mm)</td><td>0.0000</td></tr> <tr><td>Moments of inertia - X (mm⁴)</td><td>247798.5537</td></tr> <tr><td>Moments of inertia - Y (mm⁴)</td><td>83489.1238</td></tr> <tr><td>Product of inertia - XY (mm⁴)</td><td>132468.9728</td></tr> <tr><td>Radii of gyration - X (mm)</td><td>23.9299</td></tr> <tr><td>Radii of gyration - Y (mm)</td><td>13.9187</td></tr> <tr><td>Principal moments along X-Y (mm⁴)</td><td>319848.2101 along [0.8754 0.4833]</td></tr> <tr><td>Principal moments along Y-X (mm⁴)</td><td>11439.4673 along [-0.4833 0.8754]</td></tr> <tr><td>Elastic Modulus - Zx (mm²)</td><td>1 / y-max= 8395.8348</td></tr> <tr><td>Elastic Modulus - Zy (mm²)</td><td>1 / x-max= 2192.5479</td></tr> </table>	MASS PROPERTIES (UNIT)	VALUES	Area (mm ²)	430.8271	Perimeter (mm)	346.2122	Bounding Box - X (mm)	-36.0786 to 21.4738	Bounding Box - Y (mm)	-38.2434 to 36.1804	Centroid - X (mm)	0.0000	Centroid - Y (mm)	0.0000	Moments of inertia - X (mm ⁴)	247798.5537	Moments of inertia - Y (mm ⁴)	83489.1238	Product of inertia - XY (mm ⁴)	132468.9728	Radii of gyration - X (mm)	23.9299	Radii of gyration - Y (mm)	13.9187	Principal moments along X-Y (mm ⁴)	319848.2101 along [0.8754 0.4833]	Principal moments along Y-X (mm ⁴)	11439.4673 along [-0.4833 0.8754]	Elastic Modulus - Zx (mm ²)	1 / y-max= 8395.8348	Elastic Modulus - Zy (mm ²)	1 / x-max= 2192.5479	<table border="1"> <tr><th>MASS PROPERTIES (UNIT)</th><th>VALUES</th></tr> <tr><td>Area (mm²)</td><td>184</td></tr> <tr><td>Perimeter (mm)</td><td>194</td></tr> <tr><td>Bounding Box - X (mm)</td><td>-25 to 18</td></tr> <tr><td>Bounding Box - Y (mm)</td><td>-15 to 15</td></tr> <tr><td>Centroid - X (mm)</td><td>0.0000</td></tr> <tr><td>Centroid - Y (mm)</td><td>0.0000</td></tr> <tr><td>Moments of inertia - X (mm⁴)</td><td>41125</td></tr> <tr><td>Moments of inertia - Y (mm⁴)</td><td>37037</td></tr> <tr><td>Product of inertia - XY (mm⁴)</td><td>-12096</td></tr> <tr><td>Radii of gyration - X (mm)</td><td>12</td></tr> <tr><td>Radii of gyration - Y (mm)</td><td>11</td></tr> <tr><td>Principal moments along X-Y (mm⁴)</td><td>26813 along [1.1]</td></tr> <tr><td>Principal moments along Y-X (mm⁴)</td><td>51349 along [1.1]</td></tr> <tr><td>Elastic Modulus - Zx (mm²)</td><td>1 / y-max= 2874</td></tr> <tr><td>Elastic Modulus - Zy (mm²)</td><td>1 / x-max= 1493</td></tr> </table>	MASS PROPERTIES (UNIT)	VALUES	Area (mm ²)	184	Perimeter (mm)	194	Bounding Box - X (mm)	-25 to 18	Bounding Box - Y (mm)	-15 to 15	Centroid - X (mm)	0.0000	Centroid - Y (mm)	0.0000	Moments of inertia - X (mm ⁴)	41125	Moments of inertia - Y (mm ⁴)	37037	Product of inertia - XY (mm ⁴)	-12096	Radii of gyration - X (mm)	12	Radii of gyration - Y (mm)	11	Principal moments along X-Y (mm ⁴)	26813 along [1.1]	Principal moments along Y-X (mm ⁴)	51349 along [1.1]	Elastic Modulus - Zx (mm ²)	1 / y-max= 2874	Elastic Modulus - Zy (mm ²)	1 / x-max= 1493	<table border="1"> <tr><th>MASS PROPERTIES (UNIT)</th><th>VALUES</th></tr> <tr><td>Area (mm²)</td><td>249</td></tr> <tr><td>Perimeter (mm)</td><td>183</td></tr> <tr><td>Bounding Box - X (mm)</td><td>-27 to 31</td></tr> <tr><td>Bounding Box - Y (mm)</td><td>-15 to 12</td></tr> <tr><td>Centroid - X (mm)</td><td>0</td></tr> <tr><td>Centroid - Y (mm)</td><td>0</td></tr> <tr><td>Moments of inertia - X (mm⁴)</td><td>2347</td></tr> <tr><td>Moments of inertia - Y (mm⁴)</td><td>63572</td></tr> <tr><td>Product of inertia - XY (mm⁴)</td><td>3224</td></tr> <tr><td>Radii of gyration - X (mm)</td><td>3</td></tr> <tr><td>Radii of gyration - Y (mm)</td><td>16</td></tr> <tr><td>Principal moments along X-Y (mm⁴)</td><td>2178 along [1.0]</td></tr> <tr><td>Principal moments along Y-X (mm⁴)</td><td>63742 along [0.1]</td></tr> <tr><td>Elastic Modulus - Zx (mm²)</td><td>1 / y-max= 188</td></tr> <tr><td>Elastic Modulus - Zy (mm²)</td><td>1 / x-max= 2668</td></tr> </table>	MASS PROPERTIES (UNIT)	VALUES	Area (mm ²)	249	Perimeter (mm)	183	Bounding Box - X (mm)	-27 to 31	Bounding Box - Y (mm)	-15 to 12	Centroid - X (mm)	0	Centroid - Y (mm)	0	Moments of inertia - X (mm ⁴)	2347	Moments of inertia - Y (mm ⁴)	63572	Product of inertia - XY (mm ⁴)	3224	Radii of gyration - X (mm)	3	Radii of gyration - Y (mm)	16	Principal moments along X-Y (mm ⁴)	2178 along [1.0]	Principal moments along Y-X (mm ⁴)	63742 along [0.1]	Elastic Modulus - Zx (mm ²)	1 / y-max= 188	Elastic Modulus - Zy (mm ²)	1 / x-max= 2668	<table border="1"> <tr><th>MASS PROPERTIES (UNIT)</th><th>VALUES</th></tr> <tr><td>Area (mm²)</td><td>170</td></tr> <tr><td>Perimeter (mm)</td><td>277</td></tr> <tr><td>Bounding Box - X (mm)</td><td>-26 to 29</td></tr> <tr><td>Bounding Box - Y (mm)</td><td>-16 to 19</td></tr> <tr><td>Centroid - X (mm)</td><td>0</td></tr> <tr><td>Centroid - Y (mm)</td><td>0</td></tr> <tr><td>Moments of inertia - X (mm⁴)</td><td>13278</td></tr> <tr><td>Moments of inertia - Y (mm⁴)</td><td>36525</td></tr> <tr><td>Product of inertia - XY (mm⁴)</td><td>10708</td></tr> <tr><td>Radii of gyration - X (mm)</td><td>9</td></tr> <tr><td>Radii of gyration - Y (mm)</td><td>15</td></tr> <tr><td>Principal moments along X-Y (mm⁴)</td><td>9098 along [1.0]</td></tr> <tr><td>Principal moments along Y-X (mm⁴)</td><td>40705 along [0.1]</td></tr> <tr><td>Elastic Modulus - Zx (mm²)</td><td>1 / y-max= 708</td></tr> <tr><td>Elastic Modulus - Zy (mm²)</td><td>1 / x-max= 1220</td></tr> </table>	MASS PROPERTIES (UNIT)	VALUES	Area (mm ²)	170	Perimeter (mm)	277	Bounding Box - X (mm)	-26 to 29	Bounding Box - Y (mm)	-16 to 19	Centroid - X (mm)	0	Centroid - Y (mm)	0	Moments of inertia - X (mm ⁴)	13278	Moments of inertia - Y (mm ⁴)	36525	Product of inertia - XY (mm ⁴)	10708	Radii of gyration - X (mm)	9	Radii of gyration - Y (mm)	15	Principal moments along X-Y (mm ⁴)	9098 along [1.0]	Principal moments along Y-X (mm ⁴)	40705 along [0.1]	Elastic Modulus - Zx (mm ²)	1 / y-max= 708	Elastic Modulus - Zy (mm ²)	1 / x-max= 1220	<table border="1"> <tr><th>MASS PROPERTIES (UNIT)</th><th>VALUES</th></tr> <tr><td>Area (mm²)</td><td>184</td></tr> <tr><td>Perimeter (mm)</td><td>316</td></tr> <tr><td>Bounding Box - X (mm)</td><td>-35 to 32</td></tr> <tr><td>Bounding Box - Y (mm)</td><td>-22 to 10</td></tr> <tr><td>Centroid - X (mm)</td><td>0</td></tr> <tr><td>Centroid - Y (mm)</td><td>0</td></tr> <tr><td>Moments of inertia - X (mm⁴)</td><td>16123</td></tr> <tr><td>Moments of inertia - Y (mm⁴)</td><td>49665</td></tr> <tr><td>Product of inertia - XY (mm⁴)</td><td>16217</td></tr> <tr><td>Radii of gyration - X (mm)</td><td>9</td></tr> <tr><td>Radii of gyration - Y (mm)</td><td>18</td></tr> <tr><td>Principal moments along X-Y (mm⁴)</td><td>8565 along [1.0]</td></tr> <tr><td>Principal moments along Y-X (mm⁴)</td><td>56223 along [0.1]</td></tr> <tr><td>Elastic Modulus - Zx (mm²)</td><td>1 / y-max= 741</td></tr> <tr><td>Elastic Modulus - Zy (mm²)</td><td>1 / x-max= 1436</td></tr> </table>	MASS PROPERTIES (UNIT)	VALUES	Area (mm ²)	184	Perimeter (mm)	316	Bounding Box - X (mm)	-35 to 32	Bounding Box - Y (mm)	-22 to 10	Centroid - X (mm)	0	Centroid - Y (mm)	0	Moments of inertia - X (mm ⁴)	16123	Moments of inertia - Y (mm ⁴)	49665	Product of inertia - XY (mm ⁴)	16217	Radii of gyration - X (mm)	9	Radii of gyration - Y (mm)	18	Principal moments along X-Y (mm ⁴)	8565 along [1.0]	Principal moments along Y-X (mm ⁴)	56223 along [0.1]	Elastic Modulus - Zx (mm ²)	1 / y-max= 741	Elastic Modulus - Zy (mm ²)	1 / x-max= 1436	<table border="1"> <tr><th>MASS PROPERTIES (UNIT)</th><th>VALUES</th></tr> <tr><td>Area (mm²)</td><td>71</td></tr> <tr><td>Perimeter (mm)</td><td>100</td></tr> <tr><td>Bounding Box - X (mm)</td><td>-17 to 17</td></tr> <tr><td>Bounding Box - Y (mm)</td><td>-2 to 7</td></tr> <tr><td>Centroid - X (mm)</td><td>0</td></tr> <tr><td>Centroid - Y (mm)</td><td>0</td></tr> <tr><td>Moments of inertia - X (mm⁴)</td><td>308</td></tr> <tr><td>Moments of inertia - Y (mm⁴)</td><td>9472</td></tr> <tr><td>Product of inertia - XY (mm⁴)</td><td>2</td></tr> <tr><td>Radii of gyration - X (mm)</td><td>2</td></tr> <tr><td>Radii of gyration - Y (mm)</td><td>12</td></tr> <tr><td>Principal moments along X-Y (mm⁴)</td><td>308 along [1.0]</td></tr> <tr><td>Principal moments along Y-X (mm⁴)</td><td>9472 along [0.1]</td></tr> <tr><td>Elastic Modulus - Zx (mm²)</td><td>1 / y-max= 65</td></tr> <tr><td>Elastic Modulus - Zy (mm²)</td><td>1 / x-max= 548</td></tr> </table>	MASS PROPERTIES (UNIT)	VALUES	Area (mm ²)	71	Perimeter (mm)	100	Bounding Box - X (mm)	-17 to 17	Bounding Box - Y (mm)	-2 to 7	Centroid - X (mm)	0	Centroid - Y (mm)	0	Moments of inertia - X (mm ⁴)	308	Moments of inertia - Y (mm ⁴)	9472	Product of inertia - XY (mm ⁴)	2	Radii of gyration - X (mm)	2	Radii of gyration - Y (mm)	12	Principal moments along X-Y (mm ⁴)	308 along [1.0]	Principal moments along Y-X (mm ⁴)	9472 along [0.1]	Elastic Modulus - Zx (mm ²)	1 / y-max= 65	Elastic Modulus - Zy (mm ²)	1 / x-max= 548
MASS PROPERTIES (UNIT)	VALUES																																																																																																																																																																																																				
Area (mm ²)	430.8271																																																																																																																																																																																																				
Perimeter (mm)	346.2122																																																																																																																																																																																																				
Bounding Box - X (mm)	-36.0786 to 21.4738																																																																																																																																																																																																				
Bounding Box - Y (mm)	-38.2434 to 36.1804																																																																																																																																																																																																				
Centroid - X (mm)	0.0000																																																																																																																																																																																																				
Centroid - Y (mm)	0.0000																																																																																																																																																																																																				
Moments of inertia - X (mm ⁴)	247798.5537																																																																																																																																																																																																				
Moments of inertia - Y (mm ⁴)	83489.1238																																																																																																																																																																																																				
Product of inertia - XY (mm ⁴)	132468.9728																																																																																																																																																																																																				
Radii of gyration - X (mm)	23.9299																																																																																																																																																																																																				
Radii of gyration - Y (mm)	13.9187																																																																																																																																																																																																				
Principal moments along X-Y (mm ⁴)	319848.2101 along [0.8754 0.4833]																																																																																																																																																																																																				
Principal moments along Y-X (mm ⁴)	11439.4673 along [-0.4833 0.8754]																																																																																																																																																																																																				
Elastic Modulus - Zx (mm ²)	1 / y-max= 8395.8348																																																																																																																																																																																																				
Elastic Modulus - Zy (mm ²)	1 / x-max= 2192.5479																																																																																																																																																																																																				
MASS PROPERTIES (UNIT)	VALUES																																																																																																																																																																																																				
Area (mm ²)	184																																																																																																																																																																																																				
Perimeter (mm)	194																																																																																																																																																																																																				
Bounding Box - X (mm)	-25 to 18																																																																																																																																																																																																				
Bounding Box - Y (mm)	-15 to 15																																																																																																																																																																																																				
Centroid - X (mm)	0.0000																																																																																																																																																																																																				
Centroid - Y (mm)	0.0000																																																																																																																																																																																																				
Moments of inertia - X (mm ⁴)	41125																																																																																																																																																																																																				
Moments of inertia - Y (mm ⁴)	37037																																																																																																																																																																																																				
Product of inertia - XY (mm ⁴)	-12096																																																																																																																																																																																																				
Radii of gyration - X (mm)	12																																																																																																																																																																																																				
Radii of gyration - Y (mm)	11																																																																																																																																																																																																				
Principal moments along X-Y (mm ⁴)	26813 along [1.1]																																																																																																																																																																																																				
Principal moments along Y-X (mm ⁴)	51349 along [1.1]																																																																																																																																																																																																				
Elastic Modulus - Zx (mm ²)	1 / y-max= 2874																																																																																																																																																																																																				
Elastic Modulus - Zy (mm ²)	1 / x-max= 1493																																																																																																																																																																																																				
MASS PROPERTIES (UNIT)	VALUES																																																																																																																																																																																																				
Area (mm ²)	249																																																																																																																																																																																																				
Perimeter (mm)	183																																																																																																																																																																																																				
Bounding Box - X (mm)	-27 to 31																																																																																																																																																																																																				
Bounding Box - Y (mm)	-15 to 12																																																																																																																																																																																																				
Centroid - X (mm)	0																																																																																																																																																																																																				
Centroid - Y (mm)	0																																																																																																																																																																																																				
Moments of inertia - X (mm ⁴)	2347																																																																																																																																																																																																				
Moments of inertia - Y (mm ⁴)	63572																																																																																																																																																																																																				
Product of inertia - XY (mm ⁴)	3224																																																																																																																																																																																																				
Radii of gyration - X (mm)	3																																																																																																																																																																																																				
Radii of gyration - Y (mm)	16																																																																																																																																																																																																				
Principal moments along X-Y (mm ⁴)	2178 along [1.0]																																																																																																																																																																																																				
Principal moments along Y-X (mm ⁴)	63742 along [0.1]																																																																																																																																																																																																				
Elastic Modulus - Zx (mm ²)	1 / y-max= 188																																																																																																																																																																																																				
Elastic Modulus - Zy (mm ²)	1 / x-max= 2668																																																																																																																																																																																																				
MASS PROPERTIES (UNIT)	VALUES																																																																																																																																																																																																				
Area (mm ²)	170																																																																																																																																																																																																				
Perimeter (mm)	277																																																																																																																																																																																																				
Bounding Box - X (mm)	-26 to 29																																																																																																																																																																																																				
Bounding Box - Y (mm)	-16 to 19																																																																																																																																																																																																				
Centroid - X (mm)	0																																																																																																																																																																																																				
Centroid - Y (mm)	0																																																																																																																																																																																																				
Moments of inertia - X (mm ⁴)	13278																																																																																																																																																																																																				
Moments of inertia - Y (mm ⁴)	36525																																																																																																																																																																																																				
Product of inertia - XY (mm ⁴)	10708																																																																																																																																																																																																				
Radii of gyration - X (mm)	9																																																																																																																																																																																																				
Radii of gyration - Y (mm)	15																																																																																																																																																																																																				
Principal moments along X-Y (mm ⁴)	9098 along [1.0]																																																																																																																																																																																																				
Principal moments along Y-X (mm ⁴)	40705 along [0.1]																																																																																																																																																																																																				
Elastic Modulus - Zx (mm ²)	1 / y-max= 708																																																																																																																																																																																																				
Elastic Modulus - Zy (mm ²)	1 / x-max= 1220																																																																																																																																																																																																				
MASS PROPERTIES (UNIT)	VALUES																																																																																																																																																																																																				
Area (mm ²)	184																																																																																																																																																																																																				
Perimeter (mm)	316																																																																																																																																																																																																				
Bounding Box - X (mm)	-35 to 32																																																																																																																																																																																																				
Bounding Box - Y (mm)	-22 to 10																																																																																																																																																																																																				
Centroid - X (mm)	0																																																																																																																																																																																																				
Centroid - Y (mm)	0																																																																																																																																																																																																				
Moments of inertia - X (mm ⁴)	16123																																																																																																																																																																																																				
Moments of inertia - Y (mm ⁴)	49665																																																																																																																																																																																																				
Product of inertia - XY (mm ⁴)	16217																																																																																																																																																																																																				
Radii of gyration - X (mm)	9																																																																																																																																																																																																				
Radii of gyration - Y (mm)	18																																																																																																																																																																																																				
Principal moments along X-Y (mm ⁴)	8565 along [1.0]																																																																																																																																																																																																				
Principal moments along Y-X (mm ⁴)	56223 along [0.1]																																																																																																																																																																																																				
Elastic Modulus - Zx (mm ²)	1 / y-max= 741																																																																																																																																																																																																				
Elastic Modulus - Zy (mm ²)	1 / x-max= 1436																																																																																																																																																																																																				
MASS PROPERTIES (UNIT)	VALUES																																																																																																																																																																																																				
Area (mm ²)	71																																																																																																																																																																																																				
Perimeter (mm)	100																																																																																																																																																																																																				
Bounding Box - X (mm)	-17 to 17																																																																																																																																																																																																				
Bounding Box - Y (mm)	-2 to 7																																																																																																																																																																																																				
Centroid - X (mm)	0																																																																																																																																																																																																				
Centroid - Y (mm)	0																																																																																																																																																																																																				
Moments of inertia - X (mm ⁴)	308																																																																																																																																																																																																				
Moments of inertia - Y (mm ⁴)	9472																																																																																																																																																																																																				
Product of inertia - XY (mm ⁴)	2																																																																																																																																																																																																				
Radii of gyration - X (mm)	2																																																																																																																																																																																																				
Radii of gyration - Y (mm)	12																																																																																																																																																																																																				
Principal moments along X-Y (mm ⁴)	308 along [1.0]																																																																																																																																																																																																				
Principal moments along Y-X (mm ⁴)	9472 along [0.1]																																																																																																																																																																																																				
Elastic Modulus - Zx (mm ²)	1 / y-max= 65																																																																																																																																																																																																				
Elastic Modulus - Zy (mm ²)	1 / x-max= 548																																																																																																																																																																																																				

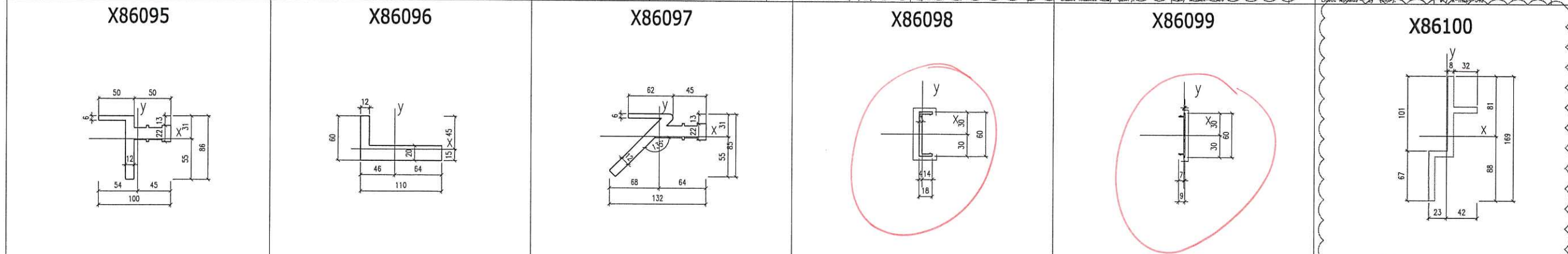

EXTRUSION MARK: (AL94) EXTRUDED ALUM. CORNER HOOK-ON BRACKET GRADE: 6061-T6	EXTRUSION MARK: (AL95) EXTRUDED ALUM. ANGLE BRACKET GRADE: 6061-T6	EXTRUSION MARK: (AL96) EXTRUDED ALUM. CORNER HOOK-ON BRACKET GRADE: 6061-T6	EXTRUSION MARK: (AL97) EXTRUDED ALUM. CAPPING GRADE: 6063-T5	EXTRUSION MARK: (AL98) EXTRUDED ALUM. CAPPING GRADE: 6063-T5	EXTRUSION MARK: (AL99) EXTRUDED ALUM. BRACKET GRADE: 6061-T6																																																																																																																																																																																																
<table border="1"> <tr><th>MASS PROPERTIES (UNIT)</th><th>VALUES</th></tr> <tr><td>Area (mm²)</td><td>2146.18</td></tr> <tr><td>Perimeter (mm)</td><td>394.71</td></tr> <tr><td>Bounding Box - X (mm)</td><td>-54.34 to 45.16</td></tr> <tr><td>Bounding Box - Y (mm)</td><td>-55.08 to 30.92</td></tr> <tr><td>Centroid - X (mm)</td><td>0.00</td></tr> <tr><td>Centroid - Y (mm)</td><td>0.00</td></tr> <tr><td>Moments of inertia - X (mm⁴)</td><td>1029146.07</td></tr> <tr><td>Moments of inertia - Y (mm⁴)</td><td>1051383.74</td></tr> <tr><td>Product of inertia - XY (mm⁴)</td><td>-44054.39</td></tr> <tr><td>Radii of gyration - X (mm)</td><td>21.90</td></tr> <tr><td>Radii of gyration - Y (mm)</td><td>22.13</td></tr> <tr><td>Principal moments along X-Y (mm⁴)</td><td>994803.74 along [0.79 0.61]</td></tr> <tr><td>Principal moments along Y-X (mm⁴)</td><td>1085736.08 along [-0.61 0.79]</td></tr> <tr><td>Elastic Modulus - Zx (mm²)</td><td>1 / y-max= 18883.67</td></tr> <tr><td>Elastic Modulus - Zy (mm²)</td><td>1 / x-max= 18347.53</td></tr> </table>	MASS PROPERTIES (UNIT)	VALUES	Area (mm ²)	2146.18	Perimeter (mm)	394.71	Bounding Box - X (mm)	-54.34 to 45.16	Bounding Box - Y (mm)	-55.08 to 30.92	Centroid - X (mm)	0.00	Centroid - Y (mm)	0.00	Moments of inertia - X (mm ⁴)	1029146.07	Moments of inertia - Y (mm ⁴)	1051383.74	Product of inertia - XY (mm ⁴)	-44054.39	Radii of gyration - X (mm)	21.90	Radii of gyration - Y (mm)	22.13	Principal moments along X-Y (mm ⁴)	994803.74 along [0.79 0.61]	Principal moments along Y-X (mm ⁴)	1085736.08 along [-0.61 0.79]	Elastic Modulus - Zx (mm ²)	1 / y-max= 18883.67	Elastic Modulus - Zy (mm ²)	1 / x-max= 18347.53	<table border="1"> <tr><th>MASS PROPERTIES (UNIT)</th><th>VALUES</th></tr> <tr><td>Area (mm²)</td><td>2690.00</td></tr> <tr><td>Perimeter (mm)</td><td>340.00</td></tr> <tr><td>Bounding Box - X (mm)</td><td>-46.22 to 63.78</td></tr> <tr><td>Bounding Box - Y (mm)</td><td>-15.37 to 44.63</td></tr> <tr><td>Centroid - X (mm)</td><td>0.00</td></tr> <tr><td>Centroid - Y (mm)</td><td>0.00</td></tr> <tr><td>Moments of inertia - X (mm⁴)</td><td>491960.18</td></tr> <tr><td>Moments of inertia - Y (mm⁴)</td><td>3170157.98</td></tr> <tr><td>Product of inertia - XY (mm⁴)</td><td>578223.95</td></tr> <tr><td>Radii of gyration - X (mm)</td><td>13.55</td></tr> <tr><td>Radii of gyration - Y (mm)</td><td>34.39</td></tr> <tr><td>Principal moments along X-Y (mm⁴)</td><td>372057.28 along [0.98 -0.20]</td></tr> <tr><td>Principal moments along Y-X (mm⁴)</td><td>3280600.87 along [0.20 0.98]</td></tr> <tr><td>Elastic Modulus - Zx (mm²)</td><td>1 / y-max= 11023.86</td></tr> <tr><td>Elastic Modulus - Zy (mm²)</td><td>1 / x-max= 49707.80</td></tr> </table>	MASS PROPERTIES (UNIT)	VALUES	Area (mm ²)	2690.00	Perimeter (mm)	340.00	Bounding Box - X (mm)	-46.22 to 63.78	Bounding Box - Y (mm)	-15.37 to 44.63	Centroid - X (mm)	0.00	Centroid - Y (mm)	0.00	Moments of inertia - X (mm ⁴)	491960.18	Moments of inertia - Y (mm ⁴)	3170157.98	Product of inertia - XY (mm ⁴)	578223.95	Radii of gyration - X (mm)	13.55	Radii of gyration - Y (mm)	34.39	Principal moments along X-Y (mm ⁴)	372057.28 along [0.98 -0.20]	Principal moments along Y-X (mm ⁴)	3280600.87 along [0.20 0.98]	Elastic Modulus - Zx (mm ²)	1 / y-max= 11023.86	Elastic Modulus - Zy (mm ²)	1 / x-max= 49707.80	<table border="1"> <tr><th>MASS PROPERTIES (UNIT)</th><th>VALUES</th></tr> <tr><td>Area (mm²)</td><td>2725.72</td></tr> <tr><td>Perimeter (mm)</td><td>482.06</td></tr> <tr><td>Bounding Box - X (mm)</td><td>-67.55 to 64.29</td></tr> <tr><td>Bounding Box - Y (mm)</td><td>-54.52 to 30.51</td></tr> <tr><td>Centroid - X (mm)</td><td>0.00</td></tr> <tr><td>Centroid - Y (mm)</td><td>0.00</td></tr> <tr><td>Moments of inertia - X (mm⁴)</td><td>1170555.60</td></tr> <tr><td>Moments of inertia - Y (mm⁴)</td><td>3329388.79</td></tr> <tr><td>Product of inertia - XY (mm⁴)</td><td>-1151578.80</td></tr> <tr><td>Radii of gyration - X (mm)</td><td>20.72</td></tr> <tr><td>Radii of gyration - Y (mm)</td><td>34.95</td></tr> <tr><td>Principal moments along X-Y (mm⁴)</td><td>671595.32 along [0.92 0.40]</td></tr> <tr><td>Principal moments along Y-X (mm⁴)</td><td>3828350.07 along [-0.40 0.92]</td></tr> <tr><td>Elastic Modulus - Zx (mm²)</td><td>1 / y-max= 21469.69</td></tr> <tr><td>Elastic Modulus - Zy (mm²)</td><td>1 / x-max= 49290.47</td></tr> </table>	MASS PROPERTIES (UNIT)	VALUES	Area (mm ²)	2725.72	Perimeter (mm)	482.06	Bounding Box - X (mm)	-67.55 to 64.29	Bounding Box - Y (mm)	-54.52 to 30.51	Centroid - X (mm)	0.00	Centroid - Y (mm)	0.00	Moments of inertia - X (mm ⁴)	1170555.60	Moments of inertia - Y (mm ⁴)	3329388.79	Product of inertia - XY (mm ⁴)	-1151578.80	Radii of gyration - X (mm)	20.72	Radii of gyration - Y (mm)	34.95	Principal moments along X-Y (mm ⁴)	671595.32 along [0.92 0.40]	Principal moments along Y-X (mm ⁴)	3828350.07 along [-0.40 0.92]	Elastic Modulus - Zx (mm ²)	1 / y-max= 21469.69	Elastic Modulus - Zy (mm ²)	1 / x-max= 49290.47	<table border="1"> <tr><th>MASS PROPERTIES (UNIT)</th><th>VALUES</th></tr> <tr><td>Area (mm²)</td><td>328</td></tr> <tr><td>Perimeter (mm)</td><td>188</td></tr> <tr><td>Bounding Box - X (mm)</td><td>-4 to 14</td></tr> <tr><td>Bounding Box - Y (mm)</td><td>-30 to 30</td></tr> <tr><td>Centroid - X (mm)</td><td>0</td></tr> <tr><td>Centroid - Y (mm)</td><td>0</td></tr> <tr><td>Moments of inertia - X (mm⁴)</td><td>142952</td></tr> <tr><td>Moments of inertia - Y (mm⁴)</td><td>7234</td></tr> <tr><td>Product of inertia - XY (mm⁴)</td><td>0</td></tr> <tr><td>Radii of gyration - X (mm)</td><td>21</td></tr> <tr><td>Radii of gyration - Y (mm)</td><td>5</td></tr> <tr><td>Principal moments along X-Y (mm⁴)</td><td>142952 along [1.0]</td></tr> <tr><td>Principal moments along Y-X (mm⁴)</td><td>7234 along [0.1]</td></tr> <tr><td>Elastic Modulus - Zx (mm²)</td><td>1 / y-max= 4765</td></tr> <tr><td>Elastic Modulus - Zy (mm²)</td><td>1 / x-max= 529</td></tr> </table>	MASS PROPERTIES (UNIT)	VALUES	Area (mm ²)	328	Perimeter (mm)	188	Bounding Box - X (mm)	-4 to 14	Bounding Box - Y (mm)	-30 to 30	Centroid - X (mm)	0	Centroid - Y (mm)	0	Moments of inertia - X (mm ⁴)	142952	Moments of inertia - Y (mm ⁴)	7234	Product of inertia - XY (mm ⁴)	0	Radii of gyration - X (mm)	21	Radii of gyration - Y (mm)	5	Principal moments along X-Y (mm ⁴)	142952 along [1.0]	Principal moments along Y-X (mm ⁴)	7234 along [0.1]	Elastic Modulus - Zx (mm ²)	1 / y-max= 4765	Elastic Modulus - Zy (mm ²)	1 / x-max= 529	<table border="1"> <tr><th>MASS PROPERTIES (UNIT)</th><th>VALUES</th></tr> <tr><td>Area (mm²)</td><td>111</td></tr> <tr><td>Perimeter (mm)</td><td>151</td></tr> <tr><td>Bounding Box - X (mm)</td><td>-7 to 10</td></tr> <tr><td>Bounding Box - Y (mm)</td><td>-30 to 30</td></tr> <tr><td>Centroid - X (mm)</td><td>0</td></tr> <tr><td>Centroid - Y (mm)</td><td>0</td></tr> <tr><td>Moments of inertia - X (mm⁴)</td><td>38796</td></tr> <tr><td>Moments of inertia - Y (mm⁴)</td><td>343</td></tr> <tr><td>Product of inertia - XY (mm⁴)</td><td>-7</td></tr> <tr><td>Radii of gyration - X (mm)</td><td>19</td></tr> <tr><td>Radii of gyration - Y (mm)</td><td>2</td></tr> <tr><td>Principal moments along X-Y (mm⁴)</td><td>38796 along [1.0]</td></tr> <tr><td>Principal moments along Y-X (mm⁴)</td><td>343 along [0.1]</td></tr> <tr><td>Elastic Modulus - Zx (mm²)</td><td>1 / y-max= 1292</td></tr> <tr><td>Elastic Modulus - Zy (mm²)</td><td>1 / x-max= 48</td></tr> </table>	MASS PROPERTIES (UNIT)	VALUES	Area (mm ²)	111	Perimeter (mm)	151	Bounding Box - X (mm)	-7 to 10	Bounding Box - Y (mm)	-30 to 30	Centroid - X (mm)	0	Centroid - Y (mm)	0	Moments of inertia - X (mm ⁴)	38796	Moments of inertia - Y (mm ⁴)	343	Product of inertia - XY (mm ⁴)	-7	Radii of gyration - X (mm)	19	Radii of gyration - Y (mm)	2	Principal moments along X-Y (mm ⁴)	38796 along [1.0]	Principal moments along Y-X (mm ⁴)	343 along [0.1]	Elastic Modulus - Zx (mm ²)	1 / y-max= 1292	Elastic Modulus - Zy (mm ²)	1 / x-max= 48	<table border="1"> <tr><th>MASS PROPERTIES (UNIT)</th><th>VALUES</th></tr> <tr><td>Area (mm²)</td><td>1668.0000</td></tr> <tr><td>Perimeter (mm)</td><td>468.0000</td></tr> <tr><td>Bounding Box - X (mm)</td><td>-23.4248 to 41.5792</td></tr> <tr><td>Bounding Box - Y (mm)</td><td>-87.6284 to 81.8716</td></tr> <tr><td>Centroid - X (mm)</td><td>0.0000</td></tr> <tr><td>Centroid - Y (mm)</td><td>0.0000</td></tr> <tr><td>Moments of inertia - X (mm⁴)</td><td>362027.6039</td></tr> <tr><td>Moments of inertia - Y (mm⁴)</td><td>437874.6068</td></tr> <tr><td>Product of inertia - XY (mm⁴)</td><td>-948481.2694</td></tr> <tr><td>Radii of gyration - X (mm)</td><td>45.0557</td></tr> <tr><td>Radii of gyration - Y (mm)</td><td>35.5278</td></tr> <tr><td>Principal moments along X-Y (mm⁴)</td><td>392926.7544 along [0.6819 -0.2625]</td></tr> <tr><td>Principal moments along Y-X (mm⁴)</td><td>178277.8552 along [0.2625 0.6819]</td></tr> <tr><td>Elastic Modulus - Zx (mm²)</td><td>1 / y-max= 4184.5397</td></tr> <tr><td>Elastic Modulus - Zy (mm²)</td><td>1 / x-max= 1892.8042</td></tr> </table>	MASS PROPERTIES (UNIT)	VALUES	Area (mm ²)	1668.0000	Perimeter (mm)	468.0000	Bounding Box - X (mm)	-23.4248 to 41.5792	Bounding Box - Y (mm)	-87.6284 to 81.8716	Centroid - X (mm)	0.0000	Centroid - Y (mm)	0.0000	Moments of inertia - X (mm ⁴)	362027.6039	Moments of inertia - Y (mm ⁴)	437874.6068	Product of inertia - XY (mm ⁴)	-948481.2694	Radii of gyration - X (mm)	45.0557	Radii of gyration - Y (mm)	35.5278	Principal moments along X-Y (mm ⁴)	392926.7544 along [0.6819 -0.2625]	Principal moments along Y-X (mm ⁴)	178277.8552 along [0.2625 0.6819]	Elastic Modulus - Zx (mm ²)	1 / y-max= 4184.5397	Elastic Modulus - Zy (mm ²)	1 / x-max= 1892.8042
MASS PROPERTIES (UNIT)	VALUES																																																																																																																																																																																																				
Area (mm ²)	2146.18																																																																																																																																																																																																				
Perimeter (mm)	394.71																																																																																																																																																																																																				
Bounding Box - X (mm)	-54.34 to 45.16																																																																																																																																																																																																				
Bounding Box - Y (mm)	-55.08 to 30.92																																																																																																																																																																																																				
Centroid - X (mm)	0.00																																																																																																																																																																																																				
Centroid - Y (mm)	0.00																																																																																																																																																																																																				
Moments of inertia - X (mm ⁴)	1029146.07																																																																																																																																																																																																				
Moments of inertia - Y (mm ⁴)	1051383.74																																																																																																																																																																																																				
Product of inertia - XY (mm ⁴)	-44054.39																																																																																																																																																																																																				
Radii of gyration - X (mm)	21.90																																																																																																																																																																																																				
Radii of gyration - Y (mm)	22.13																																																																																																																																																																																																				
Principal moments along X-Y (mm ⁴)	994803.74 along [0.79 0.61]																																																																																																																																																																																																				
Principal moments along Y-X (mm ⁴)	1085736.08 along [-0.61 0.79]																																																																																																																																																																																																				
Elastic Modulus - Zx (mm ²)	1 / y-max= 18883.67																																																																																																																																																																																																				
Elastic Modulus - Zy (mm ²)	1 / x-max= 18347.53																																																																																																																																																																																																				
MASS PROPERTIES (UNIT)	VALUES																																																																																																																																																																																																				
Area (mm ²)	2690.00																																																																																																																																																																																																				
Perimeter (mm)	340.00																																																																																																																																																																																																				
Bounding Box - X (mm)	-46.22 to 63.78																																																																																																																																																																																																				
Bounding Box - Y (mm)	-15.37 to 44.63																																																																																																																																																																																																				
Centroid - X (mm)	0.00																																																																																																																																																																																																				
Centroid - Y (mm)	0.00																																																																																																																																																																																																				
Moments of inertia - X (mm ⁴)	491960.18																																																																																																																																																																																																				
Moments of inertia - Y (mm ⁴)	3170157.98																																																																																																																																																																																																				
Product of inertia - XY (mm ⁴)	578223.95																																																																																																																																																																																																				
Radii of gyration - X (mm)	13.55																																																																																																																																																																																																				
Radii of gyration - Y (mm)	34.39																																																																																																																																																																																																				
Principal moments along X-Y (mm ⁴)	372057.28 along [0.98 -0.20]																																																																																																																																																																																																				
Principal moments along Y-X (mm ⁴)	3280600.87 along [0.20 0.98]																																																																																																																																																																																																				
Elastic Modulus - Zx (mm ²)	1 / y-max= 11023.86																																																																																																																																																																																																				
Elastic Modulus - Zy (mm ²)	1 / x-max= 49707.80																																																																																																																																																																																																				
MASS PROPERTIES (UNIT)	VALUES																																																																																																																																																																																																				
Area (mm ²)	2725.72																																																																																																																																																																																																				
Perimeter (mm)	482.06																																																																																																																																																																																																				
Bounding Box - X (mm)	-67.55 to 64.29																																																																																																																																																																																																				
Bounding Box - Y (mm)	-54.52 to 30.51																																																																																																																																																																																																				
Centroid - X (mm)	0.00																																																																																																																																																																																																				
Centroid - Y (mm)	0.00																																																																																																																																																																																																				
Moments of inertia - X (mm ⁴)	1170555.60																																																																																																																																																																																																				
Moments of inertia - Y (mm ⁴)	3329388.79																																																																																																																																																																																																				
Product of inertia - XY (mm ⁴)	-1151578.80																																																																																																																																																																																																				
Radii of gyration - X (mm)	20.72																																																																																																																																																																																																				
Radii of gyration - Y (mm)	34.95																																																																																																																																																																																																				
Principal moments along X-Y (mm ⁴)	671595.32 along [0.92 0.40]																																																																																																																																																																																																				
Principal moments along Y-X (mm ⁴)	3828350.07 along [-0.40 0.92]																																																																																																																																																																																																				
Elastic Modulus - Zx (mm ²)	1 / y-max= 21469.69																																																																																																																																																																																																				
Elastic Modulus - Zy (mm ²)	1 / x-max= 49290.47																																																																																																																																																																																																				
MASS PROPERTIES (UNIT)	VALUES																																																																																																																																																																																																				
Area (mm ²)	328																																																																																																																																																																																																				
Perimeter (mm)	188																																																																																																																																																																																																				
Bounding Box - X (mm)	-4 to 14																																																																																																																																																																																																				
Bounding Box - Y (mm)	-30 to 30																																																																																																																																																																																																				
Centroid - X (mm)	0																																																																																																																																																																																																				
Centroid - Y (mm)	0																																																																																																																																																																																																				
Moments of inertia - X (mm ⁴)	142952																																																																																																																																																																																																				
Moments of inertia - Y (mm ⁴)	7234																																																																																																																																																																																																				
Product of inertia - XY (mm ⁴)	0																																																																																																																																																																																																				
Radii of gyration - X (mm)	21																																																																																																																																																																																																				
Radii of gyration - Y (mm)	5																																																																																																																																																																																																				
Principal moments along X-Y (mm ⁴)	142952 along [1.0]																																																																																																																																																																																																				
Principal moments along Y-X (mm ⁴)	7234 along [0.1]																																																																																																																																																																																																				
Elastic Modulus - Zx (mm ²)	1 / y-max= 4765																																																																																																																																																																																																				
Elastic Modulus - Zy (mm ²)	1 / x-max= 529																																																																																																																																																																																																				
MASS PROPERTIES (UNIT)	VALUES																																																																																																																																																																																																				
Area (mm ²)	111																																																																																																																																																																																																				
Perimeter (mm)	151																																																																																																																																																																																																				
Bounding Box - X (mm)	-7 to 10																																																																																																																																																																																																				
Bounding Box - Y (mm)	-30 to 30																																																																																																																																																																																																				
Centroid - X (mm)	0																																																																																																																																																																																																				
Centroid - Y (mm)	0																																																																																																																																																																																																				
Moments of inertia - X (mm ⁴)	38796																																																																																																																																																																																																				
Moments of inertia - Y (mm ⁴)	343																																																																																																																																																																																																				
Product of inertia - XY (mm ⁴)	-7																																																																																																																																																																																																				
Radii of gyration - X (mm)	19																																																																																																																																																																																																				
Radii of gyration - Y (mm)	2																																																																																																																																																																																																				
Principal moments along X-Y (mm ⁴)	38796 along [1.0]																																																																																																																																																																																																				
Principal moments along Y-X (mm ⁴)	343 along [0.1]																																																																																																																																																																																																				
Elastic Modulus - Zx (mm ²)	1 / y-max= 1292																																																																																																																																																																																																				
Elastic Modulus - Zy (mm ²)	1 / x-max= 48																																																																																																																																																																																																				
MASS PROPERTIES (UNIT)	VALUES																																																																																																																																																																																																				
Area (mm ²)	1668.0000																																																																																																																																																																																																				
Perimeter (mm)	468.0000																																																																																																																																																																																																				
Bounding Box - X (mm)	-23.4248 to 41.5792																																																																																																																																																																																																				
Bounding Box - Y (mm)	-87.6284 to 81.8716																																																																																																																																																																																																				
Centroid - X (mm)	0.0000																																																																																																																																																																																																				
Centroid - Y (mm)	0.0000																																																																																																																																																																																																				
Moments of inertia - X (mm ⁴)	362027.6039																																																																																																																																																																																																				
Moments of inertia - Y (mm ⁴)	437874.6068																																																																																																																																																																																																				
Product of inertia - XY (mm ⁴)	-948481.2694																																																																																																																																																																																																				
Radii of gyration - X (mm)	45.0557																																																																																																																																																																																																				
Radii of gyration - Y (mm)	35.5278																																																																																																																																																																																																				
Principal moments along X-Y (mm ⁴)	392926.7544 along [0.6819 -0.2625]																																																																																																																																																																																																				
Principal moments along Y-X (mm ⁴)	178277.8552 along [0.2625 0.6819]																																																																																																																																																																																																				
Elastic Modulus - Zx (mm ²)	1 / y-max= 4184.5397																																																																																																																																																																																																				
Elastic Modulus - Zy (mm ²)	1 / x-max= 1892.8042																																																																																																																																																																																																				

B.D. REF :
F.S.D. REF :
Note :
1. All dimensions are in mm.
2. All elevations are viewed from outside.
3. All dimensions to be verified on site before fabrication.

GENERAL NOTES
Legend :
1. F.F.L.-- Finished Floor Level
2. S.F.L.-- Structural Floor Level
3. (R) -- Reversed Detail
X1 -- DETAIL MARK NO.
X001 -- REFER SHEET NO.

* COLOUR OF DIE TO BE INDICATED & FURTHER COMMENTS
* SUBJECT TO BD'S APPROVAL OF CURTAIN WALL DETAILS
* AL97 & AL98 NEED TO BE RESUBMITTED

Reviewed by: *mf.*
Remarks:
• No review is made of detail dimensions quantities.
• The submission is reviewed for general compliance with the design intent only.
• Any comments or amendments required shall not be deemed to be variation.
• The review does not release the Contractor from his responsibilities to comply with contract requirements.

DATE: 11/11
* AL97 & AL98 NEED TO BE RESUBMITTED
B 8.Nov.2021 GENERAL REVISION
A 18.Oct.2021 GENERAL REVISION
REV. DATE DESCRIPTION BY
CLIENT : MARBLE EDGE INVESTMENT LTD.

ARCHITECT : RONALD LU & PARTNERS ARCHITECTS | PLANNERS | INTERIOR DESIGNERS
STRUCTURAL ENGINEER : CMA CHAN WONG & ASSOCIATES LTD

MAIN CONTRACTOR : 裕民建築有限公司
美特鋁質有限公司
MIDI ALUMINIUM FABRICATOR LTD.
Units 6-8, Sunray Industrial Centre, 1/F
610 Cho Kwo Ling Road, Kowloon
Tel: 23489211-4 Fax: (852) 27727666

PROJECT : PROPOSED RESIDENTIAL DEVELOPMENT AT NEW KOWLOON INLAND LOT. NO.6552

TITLE : SECTION PROPERTIES (PAGE 3 OF 4)
JOB NO. : J-857
DRAWN BY : AN DATE : 18.Oct.2021
CHKD BY : SCALE A1: 1:3 A3:
DWG. NO. : SD-SP-0007 REV. : -

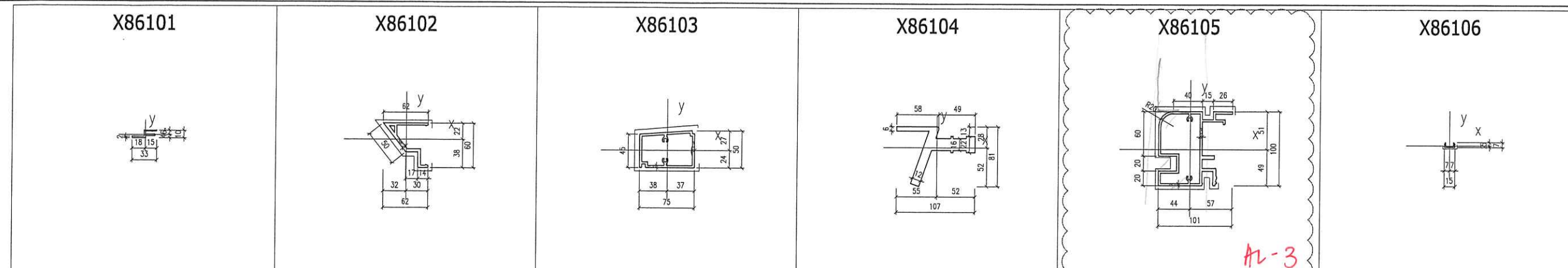

EXTRUSION MARK: (AL100) EXTRUDED ALUM. ADAPTOR GRADE: 6063-T5	EXTRUSION MARK: (AL101) EXTRUDED ALUM. ADAPTOR GRADE: 6063-T6	EXTRUSION MARK: (AL102) ALUM. VERTICAL FEATURE GRADE: 6063-T5	EXTRUSION MARK: (AL103) EXTRUDED ALUM. HOOK GRADE: 6061-T6	EXTRUSION MARK: (AL104) ALUM. VERTICAL FEATURE GRADE: 6063-T5	EXTRUSION MARK: (AL112) EXTRUDED ALUM. CAPPING GRADE: 6063-T5																																																																																																																																																																																																
<table border="1"> <tr><th>MASS PROPERTIES (UNIT)</th><th>VALUES</th></tr> <tr><td>Area (mm²):</td><td>96</td></tr> <tr><td>Perimeter (mm):</td><td>111</td></tr> <tr><td>Bounding Box - X (mm):</td><td>-18 to 15</td></tr> <tr><td>Bounding Box - Y (mm):</td><td>-4 to 6</td></tr> <tr><td>Centroid - X (mm):</td><td>0.0000</td></tr> <tr><td>Centroid - Y (mm):</td><td>0.0000</td></tr> <tr><td>Moments of inertia - X (mm⁴):</td><td>1100</td></tr> <tr><td>Moments of inertia - Y (mm⁴):</td><td>6615</td></tr> <tr><td>Product of inertia - XY (mm⁴):</td><td>-1739</td></tr> <tr><td>Radii of gyration - X (mm):</td><td>3</td></tr> <tr><td>Radii of gyration - Y (mm):</td><td>8</td></tr> <tr><td>Principal moments along X-Y (mm⁴):</td><td>598 along [1 0]</td></tr> <tr><td>Principal moments along Y-X (mm⁴):</td><td>7117 along [0 1]</td></tr> <tr><td>Elastic Modulus - Zx (mm²):</td><td>1 / y-max= 184</td></tr> <tr><td>Elastic Modulus - Zy (mm²):</td><td>1 / x-max= 375</td></tr> </table>	MASS PROPERTIES (UNIT)	VALUES	Area (mm ²):	96	Perimeter (mm):	111	Bounding Box - X (mm):	-18 to 15	Bounding Box - Y (mm):	-4 to 6	Centroid - X (mm):	0.0000	Centroid - Y (mm):	0.0000	Moments of inertia - X (mm ⁴):	1100	Moments of inertia - Y (mm ⁴):	6615	Product of inertia - XY (mm ⁴):	-1739	Radii of gyration - X (mm):	3	Radii of gyration - Y (mm):	8	Principal moments along X-Y (mm ⁴):	598 along [1 0]	Principal moments along Y-X (mm ⁴):	7117 along [0 1]	Elastic Modulus - Zx (mm ²):	1 / y-max= 184	Elastic Modulus - Zy (mm ²):	1 / x-max= 375	<table border="1"> <tr><th>MASS PROPERTIES (UNIT)</th><th>VALUES</th></tr> <tr><td>Area (mm²):</td><td>595</td></tr> <tr><td>Perimeter (mm):</td><td>330</td></tr> <tr><td>Bounding Box - X (mm):</td><td>-32 to 30</td></tr> <tr><td>Bounding Box - Y (mm):</td><td>-38 to 22</td></tr> <tr><td>Centroid - X (mm):</td><td>0</td></tr> <tr><td>Centroid - Y (mm):</td><td>0</td></tr> <tr><td>Moments of inertia - X (mm⁴):</td><td>22902</td></tr> <tr><td>Moments of inertia - Y (mm⁴):</td><td>166770</td></tr> <tr><td>Product of inertia - XY (mm⁴):</td><td>110190</td></tr> <tr><td>Radii of gyration - X (mm):</td><td>29</td></tr> <tr><td>Radii of gyration - Y (mm):</td><td>117</td></tr> <tr><td>Principal moments along X-Y (mm⁴):</td><td>312958 along [1 1]</td></tr> <tr><td>Principal moments along Y-X (mm⁴):</td><td>83713 along [-1 1]</td></tr> <tr><td>Elastic Modulus - Zx (mm²):</td><td>1 / y-max= 6032</td></tr> <tr><td>Elastic Modulus - Zy (mm²):</td><td>1 / x-max= 5235</td></tr> </table>	MASS PROPERTIES (UNIT)	VALUES	Area (mm ²):	595	Perimeter (mm):	330	Bounding Box - X (mm):	-32 to 30	Bounding Box - Y (mm):	-38 to 22	Centroid - X (mm):	0	Centroid - Y (mm):	0	Moments of inertia - X (mm ⁴):	22902	Moments of inertia - Y (mm ⁴):	166770	Product of inertia - XY (mm ⁴):	110190	Radii of gyration - X (mm):	29	Radii of gyration - Y (mm):	117	Principal moments along X-Y (mm ⁴):	312958 along [1 1]	Principal moments along Y-X (mm ⁴):	83713 along [-1 1]	Elastic Modulus - Zx (mm ²):	1 / y-max= 6032	Elastic Modulus - Zy (mm ²):	1 / x-max= 5235	<table border="1"> <tr><th>MASS PROPERTIES (UNIT)</th><th>VALUES</th></tr> <tr><td>Area (mm²):</td><td>805</td></tr> <tr><td>Perimeter (mm):</td><td>543</td></tr> <tr><td>Bounding Box - X (mm):</td><td>-38 to 37</td></tr> <tr><td>Bounding Box - Y (mm):</td><td>-24 to 27</td></tr> <tr><td>Centroid - X (mm):</td><td>0</td></tr> <tr><td>Centroid - Y (mm):</td><td>0</td></tr> <tr><td>Moments of inertia - X (mm⁴):</td><td>282127</td></tr> <tr><td>Moments of inertia - Y (mm⁴):</td><td>556408</td></tr> <tr><td>Product of inertia - XY (mm⁴):</td><td>-21465</td></tr> <tr><td>Radii of gyration - X (mm):</td><td>19</td></tr> <tr><td>Radii of gyration - Y (mm):</td><td>28</td></tr> <tr><td>Principal moments along X-Y (mm⁴):</td><td>280457 along [1 0]</td></tr> <tr><td>Principal moments along Y-X (mm⁴):</td><td>558078 along [0 1]</td></tr> <tr><td>Elastic Modulus - Zx (mm²):</td><td>1 / y-max= 10645</td></tr> <tr><td>Elastic Modulus - Zy (mm²):</td><td>1 / x-max= 14732</td></tr> </table>	MASS PROPERTIES (UNIT)	VALUES	Area (mm ²):	805	Perimeter (mm):	543	Bounding Box - X (mm):	-38 to 37	Bounding Box - Y (mm):	-24 to 27	Centroid - X (mm):	0	Centroid - Y (mm):	0	Moments of inertia - X (mm ⁴):	282127	Moments of inertia - Y (mm ⁴):	556408	Product of inertia - XY (mm ⁴):	-21465	Radii of gyration - X (mm):	19	Radii of gyration - Y (mm):	28	Principal moments along X-Y (mm ⁴):	280457 along [1 0]	Principal moments along Y-X (mm ⁴):	558078 along [0 1]	Elastic Modulus - Zx (mm ²):	1 / y-max= 10645	Elastic Modulus - Zy (mm ²):	1 / x-max= 14732	<table border="1"> <tr><th>MASS PROPERTIES (UNIT)</th><th>VALUES</th></tr> <tr><td>Area (mm²):</td><td>2258</td></tr> <tr><td>Perimeter (mm):</td><td>414</td></tr> <tr><td>Bounding Box - X (mm):</td><td>-55 to 52</td></tr> <tr><td>Bounding Box - Y (mm):</td><td>-52 to 28</td></tr> <tr><td>Centroid - X (mm):</td><td>0</td></tr> <tr><td>Centroid - Y (mm):</td><td>0</td></tr> <tr><td>Moments of inertia - X (mm⁴):</td><td>852401</td></tr> <tr><td>Moments of inertia - Y (mm⁴):</td><td>1572292</td></tr> <tr><td>Product of inertia - XY (mm⁴):</td><td>-239313</td></tr> <tr><td>Radii of gyration - X (mm):</td><td>19</td></tr> <tr><td>Radii of gyration - Y (mm):</td><td>28</td></tr> <tr><td>Principal moments along X-Y (mm⁴):</td><td>280106 along [1 0]</td></tr> <tr><td>Principal moments along Y-X (mm⁴):</td><td>1644588 along [0 1]</td></tr> <tr><td>Elastic Modulus - Zx (mm²):</td><td>1 / y-max= 16319</td></tr> <tr><td>Elastic Modulus - Zy (mm²):</td><td>1 / x-max= 28504</td></tr> </table>	MASS PROPERTIES (UNIT)	VALUES	Area (mm ²):	2258	Perimeter (mm):	414	Bounding Box - X (mm):	-55 to 52	Bounding Box - Y (mm):	-52 to 28	Centroid - X (mm):	0	Centroid - Y (mm):	0	Moments of inertia - X (mm ⁴):	852401	Moments of inertia - Y (mm ⁴):	1572292	Product of inertia - XY (mm ⁴):	-239313	Radii of gyration - X (mm):	19	Radii of gyration - Y (mm):	28	Principal moments along X-Y (mm ⁴):	280106 along [1 0]	Principal moments along Y-X (mm ⁴):	1644588 along [0 1]	Elastic Modulus - Zx (mm ²):	1 / y-max= 16319	Elastic Modulus - Zy (mm ²):	1 / x-max= 28504	<table border="1"> <tr><th>MASS PROPERTIES (UNIT)</th><th>VALUES</th></tr> <tr><td>Area (mm²):</td><td>1575</td></tr> <tr><td>Perimeter (mm):</td><td>1022</td></tr> <tr><td>Bounding Box - X (mm):</td><td>-44 to 57</td></tr> <tr><td>Bounding Box - Y (mm):</td><td>-49 to 51</td></tr> <tr><td>Centroid - X (mm):</td><td>0</td></tr> <tr><td>Centroid - Y (mm):</td><td>0</td></tr> <tr><td>Moments of inertia - X (mm⁴):</td><td>1922624</td></tr> <tr><td>Moments of inertia - Y (mm⁴):</td><td>1229292</td></tr> <tr><td>Product of inertia - XY (mm⁴):</td><td>-245148</td></tr> <tr><td>Radii of gyration - X (mm):</td><td>36</td></tr> <tr><td>Radii of gyration - Y (mm):</td><td>28</td></tr> <tr><td>Principal moments along X-Y (mm⁴):</td><td>2064933 along [1 0]</td></tr> <tr><td>Principal moments along Y-X (mm⁴):</td><td>1157343 along [0 1]</td></tr> <tr><td>Elastic Modulus - Zx (mm²):</td><td>1 / y-max= 38825</td></tr> <tr><td>Elastic Modulus - Zy (mm²):</td><td>1 / x-max= 21513</td></tr> </table>	MASS PROPERTIES (UNIT)	VALUES	Area (mm ²):	1575	Perimeter (mm):	1022	Bounding Box - X (mm):	-44 to 57	Bounding Box - Y (mm):	-49 to 51	Centroid - X (mm):	0	Centroid - Y (mm):	0	Moments of inertia - X (mm ⁴):	1922624	Moments of inertia - Y (mm ⁴):	1229292	Product of inertia - XY (mm ⁴):	-245148	Radii of gyration - X (mm):	36	Radii of gyration - Y (mm):	28	Principal moments along X-Y (mm ⁴):	2064933 along [1 0]	Principal moments along Y-X (mm ⁴):	1157343 along [0 1]	Elastic Modulus - Zx (mm ²):	1 / y-max= 38825	Elastic Modulus - Zy (mm ²):	1 / x-max= 21513	<table border="1"> <tr><th>MASS PROPERTIES (UNIT)</th><th>VALUES</th></tr> <tr><td>Area (mm²):</td><td>35</td></tr> <tr><td>Perimeter (mm):</td><td>52</td></tr> <tr><td>Bounding Box - X (mm):</td><td>-7 to 7</td></tr> <tr><td>Bounding Box - Y (mm):</td><td>-2 to 5</td></tr> <tr><td>Centroid - X (mm):</td><td>0</td></tr> <tr><td>Centroid - Y (mm):</td><td>0</td></tr> <tr><td>Moments of inertia - X (mm⁴):</td><td>107</td></tr> <tr><td>Moments of inertia - Y (mm⁴):</td><td>625</td></tr> <tr><td>Product of inertia - XY (mm⁴):</td><td>1</td></tr> <tr><td>Radii of gyration - X (mm):</td><td>2</td></tr> <tr><td>Radii of gyration - Y (mm):</td><td>5</td></tr> <tr><td>Principal moments along X-Y (mm⁴):</td><td>107 along [1 0]</td></tr> <tr><td>Principal moments along Y-X (mm⁴):</td><td>823 along [0 1]</td></tr> <tr><td>Elastic Modulus - Zx (mm²):</td><td>1 / y-max= 23</td></tr> <tr><td>Elastic Modulus - Zy (mm²):</td><td>1 / x-max= 112</td></tr> </table>	MASS PROPERTIES (UNIT)	VALUES	Area (mm ²):	35	Perimeter (mm):	52	Bounding Box - X (mm):	-7 to 7	Bounding Box - Y (mm):	-2 to 5	Centroid - X (mm):	0	Centroid - Y (mm):	0	Moments of inertia - X (mm ⁴):	107	Moments of inertia - Y (mm ⁴):	625	Product of inertia - XY (mm ⁴):	1	Radii of gyration - X (mm):	2	Radii of gyration - Y (mm):	5	Principal moments along X-Y (mm ⁴):	107 along [1 0]	Principal moments along Y-X (mm ⁴):	823 along [0 1]	Elastic Modulus - Zx (mm ²):	1 / y-max= 23	Elastic Modulus - Zy (mm ²):	1 / x-max= 112
MASS PROPERTIES (UNIT)	VALUES																																																																																																																																																																																																				
Area (mm ²):	96																																																																																																																																																																																																				
Perimeter (mm):	111																																																																																																																																																																																																				
Bounding Box - X (mm):	-18 to 15																																																																																																																																																																																																				
Bounding Box - Y (mm):	-4 to 6																																																																																																																																																																																																				
Centroid - X (mm):	0.0000																																																																																																																																																																																																				
Centroid - Y (mm):	0.0000																																																																																																																																																																																																				
Moments of inertia - X (mm ⁴):	1100																																																																																																																																																																																																				
Moments of inertia - Y (mm ⁴):	6615																																																																																																																																																																																																				
Product of inertia - XY (mm ⁴):	-1739																																																																																																																																																																																																				
Radii of gyration - X (mm):	3																																																																																																																																																																																																				
Radii of gyration - Y (mm):	8																																																																																																																																																																																																				
Principal moments along X-Y (mm ⁴):	598 along [1 0]																																																																																																																																																																																																				
Principal moments along Y-X (mm ⁴):	7117 along [0 1]																																																																																																																																																																																																				
Elastic Modulus - Zx (mm ²):	1 / y-max= 184																																																																																																																																																																																																				
Elastic Modulus - Zy (mm ²):	1 / x-max= 375																																																																																																																																																																																																				
MASS PROPERTIES (UNIT)	VALUES																																																																																																																																																																																																				
Area (mm ²):	595																																																																																																																																																																																																				
Perimeter (mm):	330																																																																																																																																																																																																				
Bounding Box - X (mm):	-32 to 30																																																																																																																																																																																																				
Bounding Box - Y (mm):	-38 to 22																																																																																																																																																																																																				
Centroid - X (mm):	0																																																																																																																																																																																																				
Centroid - Y (mm):	0																																																																																																																																																																																																				
Moments of inertia - X (mm ⁴):	22902																																																																																																																																																																																																				
Moments of inertia - Y (mm ⁴):	166770																																																																																																																																																																																																				
Product of inertia - XY (mm ⁴):	110190																																																																																																																																																																																																				
Radii of gyration - X (mm):	29																																																																																																																																																																																																				
Radii of gyration - Y (mm):	117																																																																																																																																																																																																				
Principal moments along X-Y (mm ⁴):	312958 along [1 1]																																																																																																																																																																																																				
Principal moments along Y-X (mm ⁴):	83713 along [-1 1]																																																																																																																																																																																																				
Elastic Modulus - Zx (mm ²):	1 / y-max= 6032																																																																																																																																																																																																				
Elastic Modulus - Zy (mm ²):	1 / x-max= 5235																																																																																																																																																																																																				
MASS PROPERTIES (UNIT)	VALUES																																																																																																																																																																																																				
Area (mm ²):	805																																																																																																																																																																																																				
Perimeter (mm):	543																																																																																																																																																																																																				
Bounding Box - X (mm):	-38 to 37																																																																																																																																																																																																				
Bounding Box - Y (mm):	-24 to 27																																																																																																																																																																																																				
Centroid - X (mm):	0																																																																																																																																																																																																				
Centroid - Y (mm):	0																																																																																																																																																																																																				
Moments of inertia - X (mm ⁴):	282127																																																																																																																																																																																																				
Moments of inertia - Y (mm ⁴):	556408																																																																																																																																																																																																				
Product of inertia - XY (mm ⁴):	-21465																																																																																																																																																																																																				
Radii of gyration - X (mm):	19																																																																																																																																																																																																				
Radii of gyration - Y (mm):	28																																																																																																																																																																																																				
Principal moments along X-Y (mm ⁴):	280457 along [1 0]																																																																																																																																																																																																				
Principal moments along Y-X (mm ⁴):	558078 along [0 1]																																																																																																																																																																																																				
Elastic Modulus - Zx (mm ²):	1 / y-max= 10645																																																																																																																																																																																																				
Elastic Modulus - Zy (mm ²):	1 / x-max= 14732																																																																																																																																																																																																				
MASS PROPERTIES (UNIT)	VALUES																																																																																																																																																																																																				
Area (mm ²):	2258																																																																																																																																																																																																				
Perimeter (mm):	414																																																																																																																																																																																																				
Bounding Box - X (mm):	-55 to 52																																																																																																																																																																																																				
Bounding Box - Y (mm):	-52 to 28																																																																																																																																																																																																				
Centroid - X (mm):	0																																																																																																																																																																																																				
Centroid - Y (mm):	0																																																																																																																																																																																																				
Moments of inertia - X (mm ⁴):	852401																																																																																																																																																																																																				
Moments of inertia - Y (mm ⁴):	1572292																																																																																																																																																																																																				
Product of inertia - XY (mm ⁴):	-239313																																																																																																																																																																																																				
Radii of gyration - X (mm):	19																																																																																																																																																																																																				
Radii of gyration - Y (mm):	28																																																																																																																																																																																																				
Principal moments along X-Y (mm ⁴):	280106 along [1 0]																																																																																																																																																																																																				
Principal moments along Y-X (mm ⁴):	1644588 along [0 1]																																																																																																																																																																																																				
Elastic Modulus - Zx (mm ²):	1 / y-max= 16319																																																																																																																																																																																																				
Elastic Modulus - Zy (mm ²):	1 / x-max= 28504																																																																																																																																																																																																				
MASS PROPERTIES (UNIT)	VALUES																																																																																																																																																																																																				
Area (mm ²):	1575																																																																																																																																																																																																				
Perimeter (mm):	1022																																																																																																																																																																																																				
Bounding Box - X (mm):	-44 to 57																																																																																																																																																																																																				
Bounding Box - Y (mm):	-49 to 51																																																																																																																																																																																																				
Centroid - X (mm):	0																																																																																																																																																																																																				
Centroid - Y (mm):	0																																																																																																																																																																																																				
Moments of inertia - X (mm ⁴):	1922624																																																																																																																																																																																																				
Moments of inertia - Y (mm ⁴):	1229292																																																																																																																																																																																																				
Product of inertia - XY (mm ⁴):	-245148																																																																																																																																																																																																				
Radii of gyration - X (mm):	36																																																																																																																																																																																																				
Radii of gyration - Y (mm):	28																																																																																																																																																																																																				
Principal moments along X-Y (mm ⁴):	2064933 along [1 0]																																																																																																																																																																																																				
Principal moments along Y-X (mm ⁴):	1157343 along [0 1]																																																																																																																																																																																																				
Elastic Modulus - Zx (mm ²):	1 / y-max= 38825																																																																																																																																																																																																				
Elastic Modulus - Zy (mm ²):	1 / x-max= 21513																																																																																																																																																																																																				
MASS PROPERTIES (UNIT)	VALUES																																																																																																																																																																																																				
Area (mm ²):	35																																																																																																																																																																																																				
Perimeter (mm):	52																																																																																																																																																																																																				
Bounding Box - X (mm):	-7 to 7																																																																																																																																																																																																				
Bounding Box - Y (mm):	-2 to 5																																																																																																																																																																																																				
Centroid - X (mm):	0																																																																																																																																																																																																				
Centroid - Y (mm):	0																																																																																																																																																																																																				
Moments of inertia - X (mm ⁴):	107																																																																																																																																																																																																				
Moments of inertia - Y (mm ⁴):	625																																																																																																																																																																																																				
Product of inertia - XY (mm ⁴):	1																																																																																																																																																																																																				
Radii of gyration - X (mm):	2																																																																																																																																																																																																				
Radii of gyration - Y (mm):	5																																																																																																																																																																																																				
Principal moments along X-Y (mm ⁴):	107 along [1 0]																																																																																																																																																																																																				
Principal moments along Y-X (mm ⁴):	823 along [0 1]																																																																																																																																																																																																				
Elastic Modulus - Zx (mm ²):	1 / y-max= 23																																																																																																																																																																																																				
Elastic Modulus - Zy (mm ²):	1 / x-max= 112																																																																																																																																																																																																				

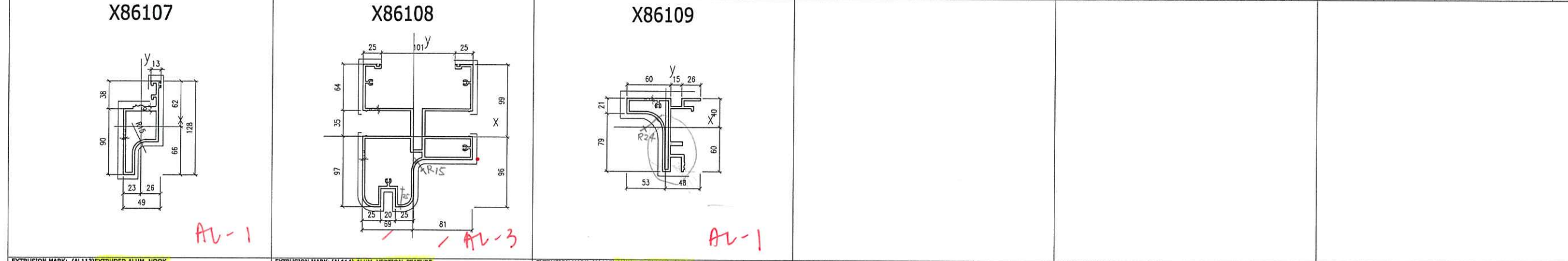

EXTRUSION MARK: (AL113) EXTRUDED ALUM. HOOK GRADE: 6061-T6	EXTRUSION MARK: (AL114) ALUM. VERTICAL FEATURE GRADE: 6063-T5	EXTRUSION MARK: (AL115) ALUM. VERTICAL FEATURE GRADE: 6063-T5	EXTRUSION MARK: GRADE:	EXTRUSION MARK: GRADE:	EXTRUSION MARK: GRADE:																																																																																																
<table border="1"> <tr><th>MASS PROPERTIES (UNIT)</th><th>VALUES</th></tr> <tr><td>Area (mm²):</td><td>1094.9130</td></tr> <tr><td>Perimeter (mm):</td><td>638.8451</td></tr> <tr><td>Bounding Box - X (mm):</td><td>-23.2478 to 28.7502</td></tr> <tr><td>Bounding Box - Y (mm):</td><td>-65.7148 to 62.2858</td></tr> <tr><td>Centroid - X (mm):</td><td>0.0000</td></tr> <tr><td>Centroid - Y (mm):</td><td>0.0000</td></tr> <tr><td>Moments of inertia - X (mm⁴):</td><td>1307844.3610</td></tr> <tr><td>Moments of inertia - Y (mm⁴):</td><td>315297.8198</td></tr> <tr><td>Product of inertia - XY (mm⁴):</td><td>-400226.2593</td></tr> <tr><td>Radii of gyration - X (mm):</td><td>35.2083</td></tr> <tr><td>Radii of gyration - Y (mm):</td><td>17.3011</td></tr> <tr><td>Principal moments along X-Y (mm⁴):</td><td>1436892.4218 along [0.8470 -0.3213]</td></tr> <tr><td>Principal moments along Y-X (mm⁴):</td><td>189741.8469 along [0.3913 0.9470]</td></tr> <tr><td>Elastic Modulus - Zx (mm²):</td><td>1 / y-max= 1898.8469</td></tr> <tr><td>Elastic Modulus - Zy (mm²):</td><td>1 / x-max= 12282.5600</td></tr> </table>	MASS PROPERTIES (UNIT)	VALUES	Area (mm ²):	1094.9130	Perimeter (mm):	638.8451	Bounding Box - X (mm):	-23.2478 to 28.7502	Bounding Box - Y (mm):	-65.7148 to 62.2858	Centroid - X (mm):	0.0000	Centroid - Y (mm):	0.0000	Moments of inertia - X (mm ⁴):	1307844.3610	Moments of inertia - Y (mm ⁴):	315297.8198	Product of inertia - XY (mm ⁴):	-400226.2593	Radii of gyration - X (mm):	35.2083	Radii of gyration - Y (mm):	17.3011	Principal moments along X-Y (mm ⁴):	1436892.4218 along [0.8470 -0.3213]	Principal moments along Y-X (mm ⁴):	189741.8469 along [0.3913 0.9470]	Elastic Modulus - Zx (mm ²):	1 / y-max= 1898.8469	Elastic Modulus - Zy (mm ²):	1 / x-max= 12282.5600	<table border="1"> <tr><th>MASS PROPERTIES (UNIT)</th><th>VALUES</th></tr> <tr><td>Area (mm²):</td><td>3093</td></tr> <tr><td>Perimeter (mm):</td><td>2023</td></tr> <tr><td>Bounding Box - X (mm):</td><td>-69 to 81</td></tr> <tr><td>Bounding Box - Y (mm):</td><td>-96 to 99</td></tr> <tr><td>Centroid - X (mm):</td><td>0</td></tr> <tr><td>Centroid - Y (mm):</td><td>0</td></tr> <tr><td>Moments of inertia - X (mm⁴):</td><td>8732609</td></tr> <tr><td>Moments of inertia - Y (mm⁴):</td><td>7650055</td></tr> <tr><td>Product of inertia - XY (mm⁴):</td><td>-1828799</td></tr> <tr><td>Radii of gyration - X (mm):</td><td>53</td></tr> <tr><td>Radii of gyration - Y (mm):</td><td>50</td></tr> <tr><td>Principal moments along X-Y (mm⁴):</td><td>10098551 along [1 -1]</td></tr> <tr><td>Principal moments along Y-X (mm⁴):</td><td>8284113 along [1 1]</td></tr> <tr><td>Elastic Modulus - Zx (mm²):</td><td>1 / y-max= 8833</td></tr> <tr><td>Elastic Modulus - Zy (mm²):</td><td>1 / x-max= 94379</td></tr> </table>	MASS PROPERTIES (UNIT)	VALUES	Area (mm ²):	3093	Perimeter (mm):	2023	Bounding Box - X (mm):	-69 to 81	Bounding Box - Y (mm):	-96 to 99	Centroid - X (mm):	0	Centroid - Y (mm):	0	Moments of inertia - X (mm ⁴):	8732609	Moments of inertia - Y (mm ⁴):	7650055	Product of inertia - XY (mm ⁴):	-1828799	Radii of gyration - X (mm):	53	Radii of gyration - Y (mm):	50	Principal moments along X-Y (mm ⁴):	10098551 along [1 -1]	Principal moments along Y-X (mm ⁴):	8284113 along [1 1]	Elastic Modulus - Zx (mm ²):	1 / y-max= 8833	Elastic Modulus - Zy (mm ²):	1 / x-max= 94379	<table border="1"> <tr><th>MASS PROPERTIES (UNIT)</th><th>VALUES</th></tr> <tr><td>Area (mm²):</td><td>1374</td></tr> <tr><td>Perimeter (mm):</td><td>878</td></tr> <tr><td>Bounding Box - X (mm):</td><td>-53 to 48</td></tr> <tr><td>Bounding Box - Y (mm):</td><td>-60 to 40</td></tr> <tr><td>Centroid - X (mm):</td><td>0</td></tr> <tr><td>Centroid - Y (mm):</td><td>0</td></tr> <tr><td>Moments of inertia - X (mm⁴):</td><td>1503951</td></tr> <tr><td>Moments of inertia - Y (mm⁴):</td><td>704517</td></tr> <tr><td>Product of inertia - XY (mm⁴):</td><td>-315222</td></tr> <tr><td>Radii of gyration - X (mm):</td><td>33</td></tr> <tr><td>Radii of gyration - Y (mm):</td><td>23</td></tr> <tr><td>Principal moments along X-Y (mm⁴):</td><td>1613078 along [1 0]</td></tr> <tr><td>Principal moments along Y-X (mm⁴):</td><td>595392 along [0 1]</td></tr> <tr><td>Elastic Modulus - Zx (mm²):</td><td>1 / y-max= 24902</td></tr> <tr><td>Elastic Modulus - Zy (mm²):</td><td>1 / x-max= 13284</td></tr> </table>	MASS PROPERTIES (UNIT)	VALUES	Area (mm ²):	1374	Perimeter (mm):	878	Bounding Box - X (mm):	-53 to 48	Bounding Box - Y (mm):	-60 to 40	Centroid - X (mm):	0	Centroid - Y (mm):	0	Moments of inertia - X (mm ⁴):	1503951	Moments of inertia - Y (mm ⁴):	704517	Product of inertia - XY (mm ⁴):	-315222	Radii of gyration - X (mm):	33	Radii of gyration - Y (mm):	23	Principal moments along X-Y (mm ⁴):	1613078 along [1 0]	Principal moments along Y-X (mm ⁴):	595392 along [0 1]	Elastic Modulus - Zx (mm ²):	1 / y-max= 24902	Elastic Modulus - Zy (mm ²):	1 / x-max= 13284			
MASS PROPERTIES (UNIT)	VALUES																																																																																																				
Area (mm ²):	1094.9130																																																																																																				
Perimeter (mm):	638.8451																																																																																																				
Bounding Box - X (mm):	-23.2478 to 28.7502																																																																																																				
Bounding Box - Y (mm):	-65.7148 to 62.2858																																																																																																				
Centroid - X (mm):	0.0000																																																																																																				
Centroid - Y (mm):	0.0000																																																																																																				
Moments of inertia - X (mm ⁴):	1307844.3610																																																																																																				
Moments of inertia - Y (mm ⁴):	315297.8198																																																																																																				
Product of inertia - XY (mm ⁴):	-400226.2593																																																																																																				
Radii of gyration - X (mm):	35.2083																																																																																																				
Radii of gyration - Y (mm):	17.3011																																																																																																				
Principal moments along X-Y (mm ⁴):	1436892.4218 along [0.8470 -0.3213]																																																																																																				
Principal moments along Y-X (mm ⁴):	189741.8469 along [0.3913 0.9470]																																																																																																				
Elastic Modulus - Zx (mm ²):	1 / y-max= 1898.8469																																																																																																				
Elastic Modulus - Zy (mm ²):	1 / x-max= 12282.5600																																																																																																				
MASS PROPERTIES (UNIT)	VALUES																																																																																																				
Area (mm ²):	3093																																																																																																				
Perimeter (mm):	2023																																																																																																				
Bounding Box - X (mm):	-69 to 81																																																																																																				
Bounding Box - Y (mm):	-96 to 99																																																																																																				
Centroid - X (mm):	0																																																																																																				
Centroid - Y (mm):	0																																																																																																				
Moments of inertia - X (mm ⁴):	8732609																																																																																																				
Moments of inertia - Y (mm ⁴):	7650055																																																																																																				
Product of inertia - XY (mm ⁴):	-1828799																																																																																																				
Radii of gyration - X (mm):	53																																																																																																				
Radii of gyration - Y (mm):	50																																																																																																				
Principal moments along X-Y (mm ⁴):	10098551 along [1 -1]																																																																																																				
Principal moments along Y-X (mm ⁴):	8284113 along [1 1]																																																																																																				
Elastic Modulus - Zx (mm ²):	1 / y-max= 8833																																																																																																				
Elastic Modulus - Zy (mm ²):	1 / x-max= 94379																																																																																																				
MASS PROPERTIES (UNIT)	VALUES																																																																																																				
Area (mm ²):	1374																																																																																																				
Perimeter (mm):	878																																																																																																				
Bounding Box - X (mm):	-53 to 48																																																																																																				
Bounding Box - Y (mm):	-60 to 40																																																																																																				
Centroid - X (mm):	0																																																																																																				
Centroid - Y (mm):	0																																																																																																				
Moments of inertia - X (mm ⁴):	1503951																																																																																																				
Moments of inertia - Y (mm ⁴):	704517																																																																																																				
Product of inertia - XY (mm ⁴):	-315222																																																																																																				
Radii of gyration - X (mm):	33																																																																																																				
Radii of gyration - Y (mm):	23																																																																																																				
Principal moments along X-Y (mm ⁴):	1613078 along [1 0]																																																																																																				
Principal moments along Y-X (mm ⁴):	595392 along [0 1]																																																																																																				
Elastic Modulus - Zx (mm ²):	1 / y-max= 24902																																																																																																				
Elastic Modulus - Zy (mm ²):	1 / x-max= 13284																																																																																																				

B.D. REF :
F.S.D. REF :
Note :
1. All dimensions are in mm.
2. All elevations are viewed from outside.
3. All dimensions to be verified on site before fabrication.

GENERAL NOTES
Legend :
1. F.F.L.-- Finished Floor Level
2. S.F.L.-- Structural Floor Level
3. (R) -- Reversed Detail
X1 -- DETAIL MARK NO.
X001 -- REFER SHEET NO.

REV. DATE DESCRIPTION BY
CLIENT :
MARBLE EDGE INVESTMENT LTD.

ARCHITECT :
RONALD LU & PARTNERS
ARCHITECTS | PLANNERS | INTERIOR DESIGNERS

STRUCTURAL ENGINEER :
CMA C-M WONG & ASSOCIATES LTD
TELE: (852) 2322 1000

MAIN CONTRACTOR :
裕民建築有限公司

美特鋁質有限公司
MIDI ALUMINIUM FABRICATOR LTD.
Units 6-8, Sunray Industrial Centre, 1/F
610 Cha Kwo Ling Road, Kowloon
Tel: 23489211-4 Fax: (852) 27727666

PROJECT :
PROPOSED RESIDENTIAL DEVELOPMENT AT NEW KOWLOON INLAND LOT. NO. 6552

TITLE :
SECTION PROPERTIES (PAGE 4 OF 4)

JOB NO. : J-857
DRAWN BY : AN DATE : 18.Oct.2021
CHKD BY : SCALE A1: 1:3 A3:
DWG. NO. : SD-SP-0008 REV. : -

A (No objection)
 B (No objection, subject to comments as noted)
 C (Amendment & resubmission required)
 D (Rejected & resubmission required)
Reviewed by: *[Signature]* Date: *11/11*
Remarks:
• No review is made of detail dimensions/quantities.
• The submission is reviewed for general compliance with the design intent only.
• Any comments or amendments required shall not be deemed to be variation.
• The review does not release the Contractor from his responsibilities to comply with contract requirements.

* COLOUR OF DIE TO BE INDICATED & SUBJECT TO FURTHER REVIEW

* SUBJECT TO INHS COMMENTS
* SUBJECT TO BD'S APPROVAL OF CURTAIN WALL DETAILS
* DIE FOR G/L3 NEED TO RESUBMIT.

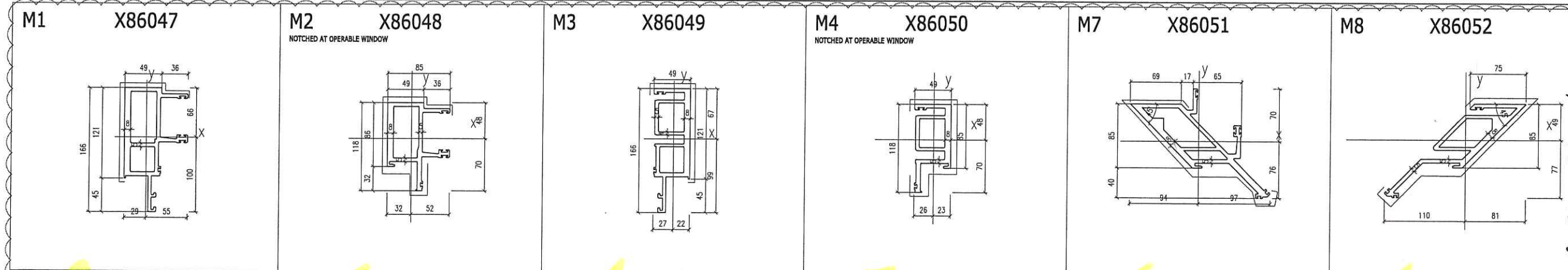

EXTRUSION MARK: (AL03) EXTRUDED ALUM. MALE MULLION GRADE: 6063-T6	EXTRUSION MARK: (AL23A) EXTRUDED ALUM. MALE MULLION GRADE: 6063-T6	EXTRUSION MARK: (AL04) EXTRUDED ALUM. FEMALE MULLION GRADE: 6063-T6	EXTRUSION MARK: (AL04A) EXTRUDED ALUM. FEMALE MULLION GRADE: 6063-T6	EXTRUSION MARK: (AL07) EXTRUDED ALUM. OUTER CORNER MALE MULLION GRADE: 6063-T6	EXTRUSION MARK: (AL08) EXTRUDED ALUM. OUTER CORNER FEMALE MULLION GRADE: 6063-T6																																																																																																																																																																																																
<table border="1"> <tr><th colspan="2">MASS PROPERTIES (UNIT)</th></tr> <tr><td>Area (mm²):</td><td>2743.3827</td></tr> <tr><td>Perimeter (mm):</td><td>1018.3505</td></tr> <tr><td>Bounding Box - X (mm):</td><td>-26.0689 to 53.4311</td></tr> <tr><td>Bounding Box - Y (mm):</td><td>-100.0923 to 65.9078</td></tr> <tr><td>Centroid - X (mm):</td><td>0.0000</td></tr> <tr><td>Centroid - Y (mm):</td><td>0.0000</td></tr> <tr><td>Moments of inertia - X (mm⁴):</td><td>536209.8368</td></tr> <tr><td>Moments of inertia - Y (mm⁴):</td><td>1429726.2081</td></tr> <tr><td>Product of inertia - XY (mm⁴):</td><td>-140585.0386</td></tr> <tr><td>Radii of gyration - X (mm):</td><td>43.7985</td></tr> <tr><td>Radii of gyration - Y (mm):</td><td>22.8268</td></tr> <tr><td>Principal moments along X-Y (mm⁴):</td><td>5268002.4962 along [0.3993 -0.0350]</td></tr> <tr><td>Principal moments along Y-X (mm⁴):</td><td>1424613.5477 along [0.0350 0.8983]</td></tr> <tr><td>Elastic Modulus - Zx (mm²):</td><td>1 / y-max= 52580.4073</td></tr> <tr><td>Elastic Modulus - Zy (mm²):</td><td>1 / x-max= 28782.8308</td></tr> </table>	MASS PROPERTIES (UNIT)		Area (mm ²):	2743.3827	Perimeter (mm):	1018.3505	Bounding Box - X (mm):	-26.0689 to 53.4311	Bounding Box - Y (mm):	-100.0923 to 65.9078	Centroid - X (mm):	0.0000	Centroid - Y (mm):	0.0000	Moments of inertia - X (mm ⁴):	536209.8368	Moments of inertia - Y (mm ⁴):	1429726.2081	Product of inertia - XY (mm ⁴):	-140585.0386	Radii of gyration - X (mm):	43.7985	Radii of gyration - Y (mm):	22.8268	Principal moments along X-Y (mm ⁴):	5268002.4962 along [0.3993 -0.0350]	Principal moments along Y-X (mm ⁴):	1424613.5477 along [0.0350 0.8983]	Elastic Modulus - Zx (mm ²):	1 / y-max= 52580.4073	Elastic Modulus - Zy (mm ²):	1 / x-max= 28782.8308	<table border="1"> <tr><th colspan="2">MASS PROPERTIES (UNIT)</th></tr> <tr><td>Area (mm²):</td><td>2035</td></tr> <tr><td>Perimeter (mm):</td><td>776</td></tr> <tr><td>Bounding Box - X (mm):</td><td>-32 to 52</td></tr> <tr><td>Bounding Box - Y (mm):</td><td>-70 to 48</td></tr> <tr><td>Centroid - X (mm):</td><td>0</td></tr> <tr><td>Centroid - Y (mm):</td><td>0</td></tr> <tr><td>Moments of inertia - X (mm⁴):</td><td>2204639</td></tr> <tr><td>Moments of inertia - Y (mm⁴):</td><td>1207978</td></tr> <tr><td>Product of inertia - XY (mm⁴):</td><td>184774</td></tr> <tr><td>Radii of gyration - X (mm):</td><td>33</td></tr> <tr><td>Radii of gyration - Y (mm):</td><td>24</td></tr> <tr><td>Principal moments along X-Y (mm⁴):</td><td>2231174 along [1 0]</td></tr> <tr><td>Principal moments along Y-X (mm⁴):</td><td>1181441 along [0 1]</td></tr> <tr><td>Elastic Modulus - Zx (mm²):</td><td>1 / y-max= 31472</td></tr> <tr><td>Elastic Modulus - Zy (mm²):</td><td>1 / x-max= 23213</td></tr> </table>	MASS PROPERTIES (UNIT)		Area (mm ²):	2035	Perimeter (mm):	776	Bounding Box - X (mm):	-32 to 52	Bounding Box - Y (mm):	-70 to 48	Centroid - X (mm):	0	Centroid - Y (mm):	0	Moments of inertia - X (mm ⁴):	2204639	Moments of inertia - Y (mm ⁴):	1207978	Product of inertia - XY (mm ⁴):	184774	Radii of gyration - X (mm):	33	Radii of gyration - Y (mm):	24	Principal moments along X-Y (mm ⁴):	2231174 along [1 0]	Principal moments along Y-X (mm ⁴):	1181441 along [0 1]	Elastic Modulus - Zx (mm ²):	1 / y-max= 31472	Elastic Modulus - Zy (mm ²):	1 / x-max= 23213	<table border="1"> <tr><th colspan="2">MASS PROPERTIES (UNIT)</th></tr> <tr><td>Area (mm²):</td><td>2498.2538</td></tr> <tr><td>Perimeter (mm):</td><td>836.8133</td></tr> <tr><td>Bounding Box - X (mm):</td><td>-28.5981 to 22.0019</td></tr> <tr><td>Bounding Box - Y (mm):</td><td>-88.8137 to 67.1864</td></tr> <tr><td>Centroid - X (mm):</td><td>0.0000</td></tr> <tr><td>Centroid - Y (mm):</td><td>0.0000</td></tr> <tr><td>Moments of inertia - X (mm⁴):</td><td>4903458.7044</td></tr> <tr><td>Moments of inertia - Y (mm⁴):</td><td>893889.1321</td></tr> <tr><td>Product of inertia - XY (mm⁴):</td><td>-288316.5498</td></tr> <tr><td>Radii of gyration - X (mm):</td><td>44.5896</td></tr> <tr><td>Radii of gyration - Y (mm):</td><td>16.8235</td></tr> <tr><td>Principal moments along X-Y (mm⁴):</td><td>4929108.2310 along [0.9977 -0.0680]</td></tr> <tr><td>Principal moments along Y-X (mm⁴):</td><td>679248.6005 along [0.0680 0.9977]</td></tr> <tr><td>Elastic Modulus - Zx (mm²):</td><td>1 / y-max= 40663.9539</td></tr> <tr><td>Elastic Modulus - Zy (mm²):</td><td>1 / x-max= 28486.9475</td></tr> </table>	MASS PROPERTIES (UNIT)		Area (mm ²):	2498.2538	Perimeter (mm):	836.8133	Bounding Box - X (mm):	-28.5981 to 22.0019	Bounding Box - Y (mm):	-88.8137 to 67.1864	Centroid - X (mm):	0.0000	Centroid - Y (mm):	0.0000	Moments of inertia - X (mm ⁴):	4903458.7044	Moments of inertia - Y (mm ⁴):	893889.1321	Product of inertia - XY (mm ⁴):	-288316.5498	Radii of gyration - X (mm):	44.5896	Radii of gyration - Y (mm):	16.8235	Principal moments along X-Y (mm ⁴):	4929108.2310 along [0.9977 -0.0680]	Principal moments along Y-X (mm ⁴):	679248.6005 along [0.0680 0.9977]	Elastic Modulus - Zx (mm ²):	1 / y-max= 40663.9539	Elastic Modulus - Zy (mm ²):	1 / x-max= 28486.9475	<table border="1"> <tr><th colspan="2">MASS PROPERTIES (UNIT)</th></tr> <tr><td>Area (mm²):</td><td>1843</td></tr> <tr><td>Perimeter (mm):</td><td>683</td></tr> <tr><td>Bounding Box - X (mm):</td><td>-26 to 23</td></tr> <tr><td>Bounding Box - Y (mm):</td><td>-70 to 48</td></tr> <tr><td>Centroid - X (mm):</td><td>0</td></tr> <tr><td>Centroid - Y (mm):</td><td>0</td></tr> <tr><td>Moments of inertia - X (mm⁴):</td><td>1919453</td></tr> <tr><td>Moments of inertia - Y (mm⁴):</td><td>583911</td></tr> <tr><td>Product of inertia - XY (mm⁴):</td><td>-242993</td></tr> <tr><td>Radii of gyration - X (mm):</td><td>32</td></tr> <tr><td>Radii of gyration - Y (mm):</td><td>17</td></tr> <tr><td>Principal moments along X-Y (mm⁴):</td><td>1901560 along [1 0]</td></tr> <tr><td>Principal moments along Y-X (mm⁴):</td><td>521803 along [0 1]</td></tr> <tr><td>Elastic Modulus - Zx (mm²):</td><td>1 / y-max= 27275</td></tr> <tr><td>Elastic Modulus - Zy (mm²):</td><td>1 / x-max= 21852</td></tr> </table>	MASS PROPERTIES (UNIT)		Area (mm ²):	1843	Perimeter (mm):	683	Bounding Box - X (mm):	-26 to 23	Bounding Box - Y (mm):	-70 to 48	Centroid - X (mm):	0	Centroid - Y (mm):	0	Moments of inertia - X (mm ⁴):	1919453	Moments of inertia - Y (mm ⁴):	583911	Product of inertia - XY (mm ⁴):	-242993	Radii of gyration - X (mm):	32	Radii of gyration - Y (mm):	17	Principal moments along X-Y (mm ⁴):	1901560 along [1 0]	Principal moments along Y-X (mm ⁴):	521803 along [0 1]	Elastic Modulus - Zx (mm ²):	1 / y-max= 27275	Elastic Modulus - Zy (mm ²):	1 / x-max= 21852	<table border="1"> <tr><th colspan="2">MASS PROPERTIES (UNIT)</th></tr> <tr><td>Area (mm²):</td><td>3387.1138</td></tr> <tr><td>Perimeter (mm):</td><td>1158.5177</td></tr> <tr><td>Bounding Box - X (mm):</td><td>-43.5331 to 97.3593</td></tr> <tr><td>Bounding Box - Y (mm):</td><td>-75.9310 to 70.4184</td></tr> <tr><td>Centroid - X (mm):</td><td>0</td></tr> <tr><td>Centroid - Y (mm):</td><td>0</td></tr> <tr><td>Moments of inertia - X (mm⁴):</td><td>4070306.2042</td></tr> <tr><td>Moments of inertia - Y (mm⁴):</td><td>7883123.6456</td></tr> <tr><td>Product of inertia - XY (mm⁴):</td><td>4304391.4419</td></tr> <tr><td>Radii of gyration - X (mm):</td><td>34.6149</td></tr> <tr><td>Radii of gyration - Y (mm):</td><td>48</td></tr> <tr><td>Principal moments along X-Y (mm⁴):</td><td>1189108.3912 along [0.8381 -0.6455]</td></tr> <tr><td>Principal moments along Y-X (mm⁴):</td><td>10354414.1786 along [0.5455 0.8381]</td></tr> <tr><td>Elastic Modulus - Zx (mm²):</td><td>1 / y-max= 53906.5393</td></tr> <tr><td>Elastic Modulus - Zy (mm²):</td><td>1 / x-max= 80269.4313</td></tr> </table>	MASS PROPERTIES (UNIT)		Area (mm ²):	3387.1138	Perimeter (mm):	1158.5177	Bounding Box - X (mm):	-43.5331 to 97.3593	Bounding Box - Y (mm):	-75.9310 to 70.4184	Centroid - X (mm):	0	Centroid - Y (mm):	0	Moments of inertia - X (mm ⁴):	4070306.2042	Moments of inertia - Y (mm ⁴):	7883123.6456	Product of inertia - XY (mm ⁴):	4304391.4419	Radii of gyration - X (mm):	34.6149	Radii of gyration - Y (mm):	48	Principal moments along X-Y (mm ⁴):	1189108.3912 along [0.8381 -0.6455]	Principal moments along Y-X (mm ⁴):	10354414.1786 along [0.5455 0.8381]	Elastic Modulus - Zx (mm ²):	1 / y-max= 53906.5393	Elastic Modulus - Zy (mm ²):	1 / x-max= 80269.4313	<table border="1"> <tr><th colspan="2">MASS PROPERTIES (UNIT)</th></tr> <tr><td>Area (mm²):</td><td>2714</td></tr> <tr><td>Perimeter (mm):</td><td>982</td></tr> <tr><td>Bounding Box - X (mm):</td><td>-110 to 81</td></tr> <tr><td>Bounding Box - Y (mm):</td><td>-77 to 49</td></tr> <tr><td>Centroid - X (mm):</td><td>0</td></tr> <tr><td>Centroid - Y (mm):</td><td>0</td></tr> <tr><td>Moments of inertia - X (mm⁴):</td><td>3043855</td></tr> <tr><td>Moments of inertia - Y (mm⁴):</td><td>5859052</td></tr> <tr><td>Product of inertia - XY (mm⁴):</td><td>-3625052</td></tr> <tr><td>Radii of gyration - X (mm):</td><td>33</td></tr> <tr><td>Radii of gyration - Y (mm):</td><td>48</td></tr> <tr><td>Principal moments along X-Y (mm⁴):</td><td>582716 along [1 3]</td></tr> <tr><td>Principal moments along Y-X (mm⁴):</td><td>8340201 along [-1 1]</td></tr> <tr><td>Elastic Modulus - Zx (mm²):</td><td>1 / y-max= 39484</td></tr> <tr><td>Elastic Modulus - Zy (mm²):</td><td>1 / x-max= 53462</td></tr> </table>	MASS PROPERTIES (UNIT)		Area (mm ²):	2714	Perimeter (mm):	982	Bounding Box - X (mm):	-110 to 81	Bounding Box - Y (mm):	-77 to 49	Centroid - X (mm):	0	Centroid - Y (mm):	0	Moments of inertia - X (mm ⁴):	3043855	Moments of inertia - Y (mm ⁴):	5859052	Product of inertia - XY (mm ⁴):	-3625052	Radii of gyration - X (mm):	33	Radii of gyration - Y (mm):	48	Principal moments along X-Y (mm ⁴):	582716 along [1 3]	Principal moments along Y-X (mm ⁴):	8340201 along [-1 1]	Elastic Modulus - Zx (mm ²):	1 / y-max= 39484	Elastic Modulus - Zy (mm ²):	1 / x-max= 53462
MASS PROPERTIES (UNIT)																																																																																																																																																																																																					
Area (mm ²):	2743.3827																																																																																																																																																																																																				
Perimeter (mm):	1018.3505																																																																																																																																																																																																				
Bounding Box - X (mm):	-26.0689 to 53.4311																																																																																																																																																																																																				
Bounding Box - Y (mm):	-100.0923 to 65.9078																																																																																																																																																																																																				
Centroid - X (mm):	0.0000																																																																																																																																																																																																				
Centroid - Y (mm):	0.0000																																																																																																																																																																																																				
Moments of inertia - X (mm ⁴):	536209.8368																																																																																																																																																																																																				
Moments of inertia - Y (mm ⁴):	1429726.2081																																																																																																																																																																																																				
Product of inertia - XY (mm ⁴):	-140585.0386																																																																																																																																																																																																				
Radii of gyration - X (mm):	43.7985																																																																																																																																																																																																				
Radii of gyration - Y (mm):	22.8268																																																																																																																																																																																																				
Principal moments along X-Y (mm ⁴):	5268002.4962 along [0.3993 -0.0350]																																																																																																																																																																																																				
Principal moments along Y-X (mm ⁴):	1424613.5477 along [0.0350 0.8983]																																																																																																																																																																																																				
Elastic Modulus - Zx (mm ²):	1 / y-max= 52580.4073																																																																																																																																																																																																				
Elastic Modulus - Zy (mm ²):	1 / x-max= 28782.8308																																																																																																																																																																																																				
MASS PROPERTIES (UNIT)																																																																																																																																																																																																					
Area (mm ²):	2035																																																																																																																																																																																																				
Perimeter (mm):	776																																																																																																																																																																																																				
Bounding Box - X (mm):	-32 to 52																																																																																																																																																																																																				
Bounding Box - Y (mm):	-70 to 48																																																																																																																																																																																																				
Centroid - X (mm):	0																																																																																																																																																																																																				
Centroid - Y (mm):	0																																																																																																																																																																																																				
Moments of inertia - X (mm ⁴):	2204639																																																																																																																																																																																																				
Moments of inertia - Y (mm ⁴):	1207978																																																																																																																																																																																																				
Product of inertia - XY (mm ⁴):	184774																																																																																																																																																																																																				
Radii of gyration - X (mm):	33																																																																																																																																																																																																				
Radii of gyration - Y (mm):	24																																																																																																																																																																																																				
Principal moments along X-Y (mm ⁴):	2231174 along [1 0]																																																																																																																																																																																																				
Principal moments along Y-X (mm ⁴):	1181441 along [0 1]																																																																																																																																																																																																				
Elastic Modulus - Zx (mm ²):	1 / y-max= 31472																																																																																																																																																																																																				
Elastic Modulus - Zy (mm ²):	1 / x-max= 23213																																																																																																																																																																																																				
MASS PROPERTIES (UNIT)																																																																																																																																																																																																					
Area (mm ²):	2498.2538																																																																																																																																																																																																				
Perimeter (mm):	836.8133																																																																																																																																																																																																				
Bounding Box - X (mm):	-28.5981 to 22.0019																																																																																																																																																																																																				
Bounding Box - Y (mm):	-88.8137 to 67.1864																																																																																																																																																																																																				
Centroid - X (mm):	0.0000																																																																																																																																																																																																				
Centroid - Y (mm):	0.0000																																																																																																																																																																																																				
Moments of inertia - X (mm ⁴):	4903458.7044																																																																																																																																																																																																				
Moments of inertia - Y (mm ⁴):	893889.1321																																																																																																																																																																																																				
Product of inertia - XY (mm ⁴):	-288316.5498																																																																																																																																																																																																				
Radii of gyration - X (mm):	44.5896																																																																																																																																																																																																				
Radii of gyration - Y (mm):	16.8235																																																																																																																																																																																																				
Principal moments along X-Y (mm ⁴):	4929108.2310 along [0.9977 -0.0680]																																																																																																																																																																																																				
Principal moments along Y-X (mm ⁴):	679248.6005 along [0.0680 0.9977]																																																																																																																																																																																																				
Elastic Modulus - Zx (mm ²):	1 / y-max= 40663.9539																																																																																																																																																																																																				
Elastic Modulus - Zy (mm ²):	1 / x-max= 28486.9475																																																																																																																																																																																																				
MASS PROPERTIES (UNIT)																																																																																																																																																																																																					
Area (mm ²):	1843																																																																																																																																																																																																				
Perimeter (mm):	683																																																																																																																																																																																																				
Bounding Box - X (mm):	-26 to 23																																																																																																																																																																																																				
Bounding Box - Y (mm):	-70 to 48																																																																																																																																																																																																				
Centroid - X (mm):	0																																																																																																																																																																																																				
Centroid - Y (mm):	0																																																																																																																																																																																																				
Moments of inertia - X (mm ⁴):	1919453																																																																																																																																																																																																				
Moments of inertia - Y (mm ⁴):	583911																																																																																																																																																																																																				
Product of inertia - XY (mm ⁴):	-242993																																																																																																																																																																																																				
Radii of gyration - X (mm):	32																																																																																																																																																																																																				
Radii of gyration - Y (mm):	17																																																																																																																																																																																																				
Principal moments along X-Y (mm ⁴):	1901560 along [1 0]																																																																																																																																																																																																				
Principal moments along Y-X (mm ⁴):	521803 along [0 1]																																																																																																																																																																																																				
Elastic Modulus - Zx (mm ²):	1 / y-max= 27275																																																																																																																																																																																																				
Elastic Modulus - Zy (mm ²):	1 / x-max= 21852																																																																																																																																																																																																				
MASS PROPERTIES (UNIT)																																																																																																																																																																																																					
Area (mm ²):	3387.1138																																																																																																																																																																																																				
Perimeter (mm):	1158.5177																																																																																																																																																																																																				
Bounding Box - X (mm):	-43.5331 to 97.3593																																																																																																																																																																																																				
Bounding Box - Y (mm):	-75.9310 to 70.4184																																																																																																																																																																																																				
Centroid - X (mm):	0																																																																																																																																																																																																				
Centroid - Y (mm):	0																																																																																																																																																																																																				
Moments of inertia - X (mm ⁴):	4070306.2042																																																																																																																																																																																																				
Moments of inertia - Y (mm ⁴):	7883123.6456																																																																																																																																																																																																				
Product of inertia - XY (mm ⁴):	4304391.4419																																																																																																																																																																																																				
Radii of gyration - X (mm):	34.6149																																																																																																																																																																																																				
Radii of gyration - Y (mm):	48																																																																																																																																																																																																				
Principal moments along X-Y (mm ⁴):	1189108.3912 along [0.8381 -0.6455]																																																																																																																																																																																																				
Principal moments along Y-X (mm ⁴):	10354414.1786 along [0.5455 0.8381]																																																																																																																																																																																																				
Elastic Modulus - Zx (mm ²):	1 / y-max= 53906.5393																																																																																																																																																																																																				
Elastic Modulus - Zy (mm ²):	1 / x-max= 80269.4313																																																																																																																																																																																																				
MASS PROPERTIES (UNIT)																																																																																																																																																																																																					
Area (mm ²):	2714																																																																																																																																																																																																				
Perimeter (mm):	982																																																																																																																																																																																																				
Bounding Box - X (mm):	-110 to 81																																																																																																																																																																																																				
Bounding Box - Y (mm):	-77 to 49																																																																																																																																																																																																				
Centroid - X (mm):	0																																																																																																																																																																																																				
Centroid - Y (mm):	0																																																																																																																																																																																																				
Moments of inertia - X (mm ⁴):	3043855																																																																																																																																																																																																				
Moments of inertia - Y (mm ⁴):	5859052																																																																																																																																																																																																				
Product of inertia - XY (mm ⁴):	-3625052																																																																																																																																																																																																				
Radii of gyration - X (mm):	33																																																																																																																																																																																																				
Radii of gyration - Y (mm):	48																																																																																																																																																																																																				
Principal moments along X-Y (mm ⁴):	582716 along [1 3]																																																																																																																																																																																																				
Principal moments along Y-X (mm ⁴):	8340201 along [-1 1]																																																																																																																																																																																																				
Elastic Modulus - Zx (mm ²):	1 / y-max= 39484																																																																																																																																																																																																				
Elastic Modulus - Zy (mm ²):	1 / x-max= 53462																																																																																																																																																																																																				

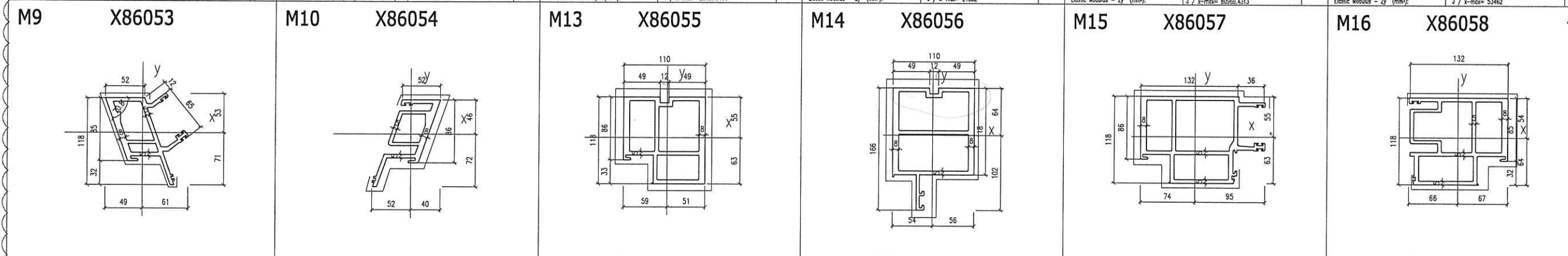

EXTRUSION MARK: (AL86) EXTRUDED ALUM. MALE MULLION GRADE: 6063-T6	EXTRUSION MARK: (AL85) EXTRUDED ALUM. FEMALE MULLION GRADE: 6063-T6	EXTRUSION MARK: (AL85) EXTRUDED ALUM. INTERMEDIATE MULLION GRADE: 6063-T6	EXTRUSION MARK: (AL86) EXTRUDED ALUM. INTERMEDIATE MULLION GRADE: 6063-T6	EXTRUSION MARK: (AL67) EXTRUDED ALUM. MALE MULLION GRADE: 6063-T6	EXTRUSION MARK: (AL88) EXTRUDED ALUM. FEMALE MULLION GRADE: 6063-T6																																																																																																																																																																																																
<table border="1"> <tr><th colspan="2">MASS PROPERTIES (UNIT)</th></tr> <tr><td>Area (mm²):</td><td>2336</td></tr> <tr><td>Perimeter (mm):</td><td>882</td></tr> <tr><td>Bounding Box - X (mm):</td><td>-49 to 81</td></tr> <tr><td>Bounding Box - Y (mm):</td><td>-71 to 53</td></tr> <tr><td>Centroid - X (mm):</td><td>0</td></tr> <tr><td>Centroid - Y (mm):</td><td>0</td></tr> <tr><td>Moments of inertia - X (mm⁴):</td><td>2259019</td></tr> <tr><td>Moments of inertia - Y (mm⁴):</td><td>1797982</td></tr> <tr><td>Product of inertia - XY (mm⁴):</td><td>-890383</td></tr> <tr><td>Radii of gyration - X (mm):</td><td>31</td></tr> <tr><td>Radii of gyration - Y (mm):</td><td>28</td></tr> <tr><td>Principal moments along X-Y (mm⁴):</td><td>1108761 along [1 -1]</td></tr> <tr><td>Principal moments along Y-X (mm⁴):</td><td>2948239 along [1 1]</td></tr> <tr><td>Elastic Modulus - Zx (mm²):</td><td>1 / y-max= 31901</td></tr> <tr><td>Elastic Modulus - Zy (mm²):</td><td>1 / x-max= 29368</td></tr> </table>	MASS PROPERTIES (UNIT)		Area (mm ²):	2336	Perimeter (mm):	882	Bounding Box - X (mm):	-49 to 81	Bounding Box - Y (mm):	-71 to 53	Centroid - X (mm):	0	Centroid - Y (mm):	0	Moments of inertia - X (mm ⁴):	2259019	Moments of inertia - Y (mm ⁴):	1797982	Product of inertia - XY (mm ⁴):	-890383	Radii of gyration - X (mm):	31	Radii of gyration - Y (mm):	28	Principal moments along X-Y (mm ⁴):	1108761 along [1 -1]	Principal moments along Y-X (mm ⁴):	2948239 along [1 1]	Elastic Modulus - Zx (mm ²):	1 / y-max= 31901	Elastic Modulus - Zy (mm ²):	1 / x-max= 29368	<table border="1"> <tr><th colspan="2">MASS PROPERTIES (UNIT)</th></tr> <tr><td>Area (mm²):</td><td>1969</td></tr> <tr><td>Perimeter (mm):</td><td>730</td></tr> <tr><td>Bounding Box - X (mm):</td><td>-52 to 40</td></tr> <tr><td>Bounding Box - Y (mm):</td><td>-72 to 46</td></tr> <tr><td>Centroid - X (mm):</td><td>0</td></tr> <tr><td>Centroid - Y (mm):</td><td>0</td></tr> <tr><td>Moments of inertia - X (mm⁴):</td><td>1965036</td></tr> <tr><td>Moments of inertia - Y (mm⁴):</td><td>1091881</td></tr> <tr><td>Product of inertia - XY (mm⁴):</td><td>-932735</td></tr> <tr><td>Radii of gyration - X (mm):</td><td>32</td></tr> <tr><td>Radii of gyration - Y (mm):</td><td>24</td></tr> <tr><td>Principal moments along X-Y (mm⁴):</td><td>2538304 along [1 -1]</td></tr> <tr><td>Principal moments along Y-X (mm⁴):</td><td>488593 along [1 1]</td></tr> <tr><td>Elastic Modulus - Zx (mm²):</td><td>1 / y-max= 27465</td></tr> <tr><td>Elastic Modulus - Zy (mm²):</td><td>1 / x-max= 20833</td></tr> </table>	MASS PROPERTIES (UNIT)		Area (mm ²):	1969	Perimeter (mm):	730	Bounding Box - X (mm):	-52 to 40	Bounding Box - Y (mm):	-72 to 46	Centroid - X (mm):	0	Centroid - Y (mm):	0	Moments of inertia - X (mm ⁴):	1965036	Moments of inertia - Y (mm ⁴):	1091881	Product of inertia - XY (mm ⁴):	-932735	Radii of gyration - X (mm):	32	Radii of gyration - Y (mm):	24	Principal moments along X-Y (mm ⁴):	2538304 along [1 -1]	Principal moments along Y-X (mm ⁴):	488593 along [1 1]	Elastic Modulus - Zx (mm ²):	1 / y-max= 27465	Elastic Modulus - Zy (mm ²):	1 / x-max= 20833	<table border="1"> <tr><th colspan="2">MASS PROPERTIES (UNIT)</th></tr> <tr><td>Area (mm²):</td><td>3463</td></tr> <tr><td>Perimeter (mm):</td><td>1128</td></tr> <tr><td>Bounding Box - X (mm):</td><td>-59 to 51</td></tr> <tr><td>Bounding Box - Y (mm):</td><td>-72 to 55</td></tr> <tr><td>Centroid - X (mm):</td><td>0</td></tr> <tr><td>Centroid - Y (mm):</td><td>0</td></tr> <tr><td>Moments of inertia - X (mm⁴):</td><td>4954578</td></tr> <tr><td>Moments of inertia - Y (mm⁴):</td><td>9166394</td></tr> <tr><td>Product of inertia - XY (mm⁴):</td><td>922819</td></tr> <tr><td>Radii of gyration - X (mm):</td><td>38</td></tr> <tr><td>Radii of gyration - Y (mm):</td><td>38</td></tr> <tr><td>Principal moments along X-Y (mm⁴):</td><td>4109832 along [1 -1]</td></tr> <tr><td>Principal moments along Y-X (mm⁴):</td><td>3957141 along [1 1]</td></tr> <tr><td>Elastic Modulus - Zx (mm²):</td><td>1 / y-max= 78997</td></tr> <tr><td>Elastic Modulus - Zy (mm²):</td><td>1 / x-max= 86408</td></tr> </table>	MASS PROPERTIES (UNIT)		Area (mm ²):	3463	Perimeter (mm):	1128	Bounding Box - X (mm):	-59 to 51	Bounding Box - Y (mm):	-72 to 55	Centroid - X (mm):	0	Centroid - Y (mm):	0	Moments of inertia - X (mm ⁴):	4954578	Moments of inertia - Y (mm ⁴):	9166394	Product of inertia - XY (mm ⁴):	922819	Radii of gyration - X (mm):	38	Radii of gyration - Y (mm):	38	Principal moments along X-Y (mm ⁴):	4109832 along [1 -1]	Principal moments along Y-X (mm ⁴):	3957141 along [1 1]	Elastic Modulus - Zx (mm ²):	1 / y-max= 78997	Elastic Modulus - Zy (mm ²):	1 / x-max= 86408	<table border="1"> <tr><th colspan="2">MASS PROPERTIES (UNIT)</th></tr> <tr><td>Area (mm²):</td><td>3635.9398</td></tr> <tr><td>Perimeter (mm):</td><td>1200.9982</td></tr> <tr><td>Bounding Box - X (mm):</td><td>-53.5613 to 56.4387</td></tr> <tr><td>Bounding Box - Y (mm):</td><td>-101.7950 to 64.2050</td></tr> <tr><td>Centroid - X (mm):</td><td>0</td></tr> <tr><td>Centroid - Y (mm):</td><td>0</td></tr> <tr><td>Moments of inertia - X (mm⁴):</td><td>7155585.7284</td></tr> <tr><td>Moments of inertia - Y (mm⁴):</td><td>8076895.3523</td></tr> <tr><td>Product of inertia - XY (mm⁴):</td><td>-410077.2108</td></tr> <tr><td>Radii of gyration - X (mm):</td><td>40.3648</td></tr> <tr><td>Radii of gyration - Y (mm):</td><td>40.8482</td></tr> <tr><td>Principal moments along X-Y (mm⁴):</td><td>7293774.6051 along [0.9478 -0.3193]</td></tr> <tr><td>Principal moments along Y-X (mm⁴):</td><td>5926676.4836 along [0.3193 0.9478]</td></tr> <tr><td>Elastic Modulus - Zx (mm²):</td><td>1 / y-max= 70264.0268</td></tr> <tr><td>Elastic Modulus - Zy (mm²):</td><td>1 / x-max= 107671.9904</td></tr> </table>	MASS PROPERTIES (UNIT)		Area (mm ²):	3635.9398	Perimeter (mm):	1200.9982	Bounding Box - X (mm):	-53.5613 to 56.4387	Bounding Box - Y (mm):	-101.7950 to 64.2050	Centroid - X (mm):	0	Centroid - Y (mm):	0	Moments of inertia - X (mm ⁴):	7155585.7284	Moments of inertia - Y (mm ⁴):	8076895.3523	Product of inertia - XY (mm ⁴):	-410077.2108	Radii of gyration - X (mm):	40.3648	Radii of gyration - Y (mm):	40.8482	Principal moments along X-Y (mm ⁴):	7293774.6051 along [0.9478 -0.3193]	Principal moments along Y-X (mm ⁴):	5926676.4836 along [0.3193 0.9478]	Elastic Modulus - Zx (mm ²):	1 / y-max= 70264.0268	Elastic Modulus - Zy (mm ²):	1 / x-max= 107671.9904	<table border="1"> <tr><th colspan="2">MASS PROPERTIES (UNIT)</th></tr> <tr><td>Area (mm²):</td><td>3656.4811</td></tr> <tr><td>Perimeter (mm):</td><td>1469.3973</td></tr> <tr><td>Bounding Box - X (mm):</td><td>-73.8120 to 94.6880</td></tr> <tr><td>Bounding Box - Y (mm):</td><td>-63.3026 to 54.6974</td></tr> <tr><td>Centroid - X (mm):</td><td>0</td></tr> <tr><td>Centroid - Y (mm):</td><td>0</td></tr> <tr><td>Moments of inertia - X (mm⁴):</td><td>5679300.7890</td></tr> <tr><td>Moments of inertia - Y (mm⁴):</td><td>9739097.7624</td></tr> <tr><td>Product of inertia - XY (mm⁴):</td><td>6346.12172</td></tr> <tr><td>Radii of gyration - X (mm):</td><td>38.3104</td></tr> <tr><td>Radii of gyration - Y (mm):</td><td>50.1528</td></tr> <tr><td>Principal moments along X-Y (mm⁴):</td><td>6570060.6577 along [0.9878 -0.1556]</td></tr> <tr><td>Principal moments along Y-X (mm⁴):</td><td>9830257.8336 along [0.1556 0.9878]</td></tr> <tr><td>Elastic Modulus - Zx (mm²):</td><td>1 / y-max= 88715.0301</td></tr> <tr><td>Elastic Modulus - Zy (mm²):</td><td>1 / x-max= 102789.2815</td></tr> </table>	MASS PROPERTIES (UNIT)		Area (mm ²):	3656.4811	Perimeter (mm):	1469.3973	Bounding Box - X (mm):	-73.8120 to 94.6880	Bounding Box - Y (mm):	-63.3026 to 54.6974	Centroid - X (mm):	0	Centroid - Y (mm):	0	Moments of inertia - X (mm ⁴):	5679300.7890	Moments of inertia - Y (mm ⁴):	9739097.7624	Product of inertia - XY (mm ⁴):	6346.12172	Radii of gyration - X (mm):	38.3104	Radii of gyration - Y (mm):	50.1528	Principal moments along X-Y (mm ⁴):	6570060.6577 along [0.9878 -0.1556]	Principal moments along Y-X (mm ⁴):	9830257.8336 along [0.1556 0.9878]	Elastic Modulus - Zx (mm ²):	1 / y-max= 88715.0301	Elastic Modulus - Zy (mm ²):	1 / x-max= 102789.2815	<table border="1"> <tr><th colspan="2">MASS PROPERTIES (UNIT)</th></tr> <tr><td>Area (mm²):</td><td>3739.2482</td></tr> <tr><td>Perimeter (mm):</td><td>1421.5451</td></tr> <tr><td>Bounding Box - X (mm):</td><td>-88.3478 to 66.6502</td></tr> <tr><td>Bounding Box - Y (mm):</td><td>-63.8043 to 54.1957</td></tr> <tr><td>Centroid - X (mm):</td><td>0</td></tr> <tr><td>Centroid - Y (mm):</td><td>0</td></tr> <tr><td>Moments of inertia - X (mm⁴):</td><td>5473264.0311</td></tr> <tr><td>Moments of inertia - Y (mm⁴):</td><td>7191953.4954</td></tr> <tr><td>Product of inertia - XY (mm⁴):</td><td>-376423.3651</td></tr> <tr><td>Radii of gyration - X (mm):</td><td>38.3104</td></tr> <tr><td>Radii of gyration - Y (mm):</td><td>43.6922</td></tr> <tr><td>Principal moments along X-Y (mm⁴):</td><td>5109933.9592 along [0.9270 0.3751]</td></tr> <tr><td>Principal moments along Y-X (mm⁴):</td><td>7441453.5663 along [-0.3751 0.9270]</td></tr> <tr><td>Elastic Modulus - Zx (mm²):</td><td>1 / y-max= 85762.0796</td></tr> <tr><td>Elastic Modulus - Zy (mm²):</td><td>1 / x-max= 106810.8628</td></tr> </table>	MASS PROPERTIES (UNIT)		Area (mm ²):	3739.2482	Perimeter (mm):	1421.5451	Bounding Box - X (mm):	-88.3478 to 66.6502	Bounding Box - Y (mm):	-63.8043 to 54.1957	Centroid - X (mm):	0	Centroid - Y (mm):	0	Moments of inertia - X (mm ⁴):	5473264.0311	Moments of inertia - Y (mm ⁴):	7191953.4954	Product of inertia - XY (mm ⁴):	-376423.3651	Radii of gyration - X (mm):	38.3104	Radii of gyration - Y (mm):	43.6922	Principal moments along X-Y (mm ⁴):	5109933.9592 along [0.9270 0.3751]	Principal moments along Y-X (mm ⁴):	7441453.5663 along [-0.3751 0.9270]	Elastic Modulus - Zx (mm ²):	1 / y-max= 85762.0796	Elastic Modulus - Zy (mm ²):	1 / x-max= 106810.8628
MASS PROPERTIES (UNIT)																																																																																																																																																																																																					
Area (mm ²):	2336																																																																																																																																																																																																				
Perimeter (mm):	882																																																																																																																																																																																																				
Bounding Box - X (mm):	-49 to 81																																																																																																																																																																																																				
Bounding Box - Y (mm):	-71 to 53																																																																																																																																																																																																				
Centroid - X (mm):	0																																																																																																																																																																																																				
Centroid - Y (mm):	0																																																																																																																																																																																																				
Moments of inertia - X (mm ⁴):	2259019																																																																																																																																																																																																				
Moments of inertia - Y (mm ⁴):	1797982																																																																																																																																																																																																				
Product of inertia - XY (mm ⁴):	-890383																																																																																																																																																																																																				
Radii of gyration - X (mm):	31																																																																																																																																																																																																				
Radii of gyration - Y (mm):	28																																																																																																																																																																																																				
Principal moments along X-Y (mm ⁴):	1108761 along [1 -1]																																																																																																																																																																																																				
Principal moments along Y-X (mm ⁴):	2948239 along [1 1]																																																																																																																																																																																																				
Elastic Modulus - Zx (mm ²):	1 / y-max= 31901																																																																																																																																																																																																				
Elastic Modulus - Zy (mm ²):	1 / x-max= 29368																																																																																																																																																																																																				
MASS PROPERTIES (UNIT)																																																																																																																																																																																																					
Area (mm ²):	1969																																																																																																																																																																																																				
Perimeter (mm):	730																																																																																																																																																																																																				
Bounding Box - X (mm):	-52 to 40																																																																																																																																																																																																				
Bounding Box - Y (mm):	-72 to 46																																																																																																																																																																																																				
Centroid - X (mm):	0																																																																																																																																																																																																				
Centroid - Y (mm):	0																																																																																																																																																																																																				
Moments of inertia - X (mm ⁴):	1965036																																																																																																																																																																																																				
Moments of inertia - Y (mm ⁴):	1091881																																																																																																																																																																																																				
Product of inertia - XY (mm ⁴):	-932735																																																																																																																																																																																																				
Radii of gyration - X (mm):	32																																																																																																																																																																																																				
Radii of gyration - Y (mm):	24																																																																																																																																																																																																				
Principal moments along X-Y (mm ⁴):	2538304 along [1 -1]																																																																																																																																																																																																				
Principal moments along Y-X (mm ⁴):	488593 along [1 1]																																																																																																																																																																																																				
Elastic Modulus - Zx (mm ²):	1 / y-max= 27465																																																																																																																																																																																																				
Elastic Modulus - Zy (mm ²):	1 / x-max= 20833																																																																																																																																																																																																				
MASS PROPERTIES (UNIT)																																																																																																																																																																																																					
Area (mm ²):	3463																																																																																																																																																																																																				
Perimeter (mm):	1128																																																																																																																																																																																																				
Bounding Box - X (mm):	-59 to 51																																																																																																																																																																																																				
Bounding Box - Y (mm):	-72 to 55																																																																																																																																																																																																				
Centroid - X (mm):	0																																																																																																																																																																																																				
Centroid - Y (mm):	0																																																																																																																																																																																																				
Moments of inertia - X (mm ⁴):	4954578																																																																																																																																																																																																				
Moments of inertia - Y (mm ⁴):	9166394																																																																																																																																																																																																				
Product of inertia - XY (mm ⁴):	922819																																																																																																																																																																																																				
Radii of gyration - X (mm):	38																																																																																																																																																																																																				
Radii of gyration - Y (mm):	38																																																																																																																																																																																																				
Principal moments along X-Y (mm ⁴):	4109832 along [1 -1]																																																																																																																																																																																																				
Principal moments along Y-X (mm ⁴):	3957141 along [1 1]																																																																																																																																																																																																				
Elastic Modulus - Zx (mm ²):	1 / y-max= 78997																																																																																																																																																																																																				
Elastic Modulus - Zy (mm ²):	1 / x-max= 86408																																																																																																																																																																																																				
MASS PROPERTIES (UNIT)																																																																																																																																																																																																					
Area (mm ²):	3635.9398																																																																																																																																																																																																				
Perimeter (mm):	1200.9982																																																																																																																																																																																																				
Bounding Box - X (mm):	-53.5613 to 56.4387																																																																																																																																																																																																				
Bounding Box - Y (mm):	-101.7950 to 64.2050																																																																																																																																																																																																				
Centroid - X (mm):	0																																																																																																																																																																																																				
Centroid - Y (mm):	0																																																																																																																																																																																																				
Moments of inertia - X (mm ⁴):	7155585.7284																																																																																																																																																																																																				
Moments of inertia - Y (mm ⁴):	8076895.3523																																																																																																																																																																																																				
Product of inertia - XY (mm ⁴):	-410077.2108																																																																																																																																																																																																				
Radii of gyration - X (mm):	40.3648																																																																																																																																																																																																				
Radii of gyration - Y (mm):	40.8482																																																																																																																																																																																																				
Principal moments along X-Y (mm ⁴):	7293774.6051 along [0.9478 -0.3193]																																																																																																																																																																																																				
Principal moments along Y-X (mm ⁴):	5926676.4836 along [0.3193 0.9478]																																																																																																																																																																																																				
Elastic Modulus - Zx (mm ²):	1 / y-max= 70264.0268																																																																																																																																																																																																				
Elastic Modulus - Zy (mm ²):	1 / x-max= 107671.9904																																																																																																																																																																																																				
MASS PROPERTIES (UNIT)																																																																																																																																																																																																					
Area (mm ²):	3656.4811																																																																																																																																																																																																				
Perimeter (mm):	1469.3973																																																																																																																																																																																																				
Bounding Box - X (mm):	-73.8120 to 94.6880																																																																																																																																																																																																				
Bounding Box - Y (mm):	-63.3026 to 54.6974																																																																																																																																																																																																				
Centroid - X (mm):	0																																																																																																																																																																																																				
Centroid - Y (mm):	0																																																																																																																																																																																																				
Moments of inertia - X (mm ⁴):	5679300.7890																																																																																																																																																																																																				
Moments of inertia - Y (mm ⁴):	9739097.7624																																																																																																																																																																																																				
Product of inertia - XY (mm ⁴):	6346.12172																																																																																																																																																																																																				
Radii of gyration - X (mm):	38.3104																																																																																																																																																																																																				
Radii of gyration - Y (mm):	50.1528																																																																																																																																																																																																				
Principal moments along X-Y (mm ⁴):	6570060.6577 along [0.9878 -0.1556]																																																																																																																																																																																																				
Principal moments along Y-X (mm ⁴):	9830257.8336 along [0.1556 0.9878]																																																																																																																																																																																																				
Elastic Modulus - Zx (mm ²):	1 / y-max= 88715.0301																																																																																																																																																																																																				
Elastic Modulus - Zy (mm ²):	1 / x-max= 102789.2815																																																																																																																																																																																																				
MASS PROPERTIES (UNIT)																																																																																																																																																																																																					
Area (mm ²):	3739.2482																																																																																																																																																																																																				
Perimeter (mm):	1421.5451																																																																																																																																																																																																				
Bounding Box - X (mm):	-88.3478 to 66.6502																																																																																																																																																																																																				
Bounding Box - Y (mm):	-63.8043 to 54.1957																																																																																																																																																																																																				
Centroid - X (mm):	0																																																																																																																																																																																																				
Centroid - Y (mm):	0																																																																																																																																																																																																				
Moments of inertia - X (mm ⁴):	5473264.0311																																																																																																																																																																																																				
Moments of inertia - Y (mm ⁴):	7191953.4954																																																																																																																																																																																																				
Product of inertia - XY (mm ⁴):	-376423.3651																																																																																																																																																																																																				
Radii of gyration - X (mm):	38.3104																																																																																																																																																																																																				
Radii of gyration - Y (mm):	43.6922																																																																																																																																																																																																				
Principal moments along X-Y (mm ⁴):	5109933.9592 along [0.9270 0.3751]																																																																																																																																																																																																				
Principal moments along Y-X (mm ⁴):	7441453.5663 along [-0.3751 0.9270]																																																																																																																																																																																																				
Elastic Modulus - Zx (mm ²):	1 / y-max= 85762.0796																																																																																																																																																																																																				
Elastic Modulus - Zy (mm ²):	1 / x-max= 106810.8628																																																																																																																																																																																																				

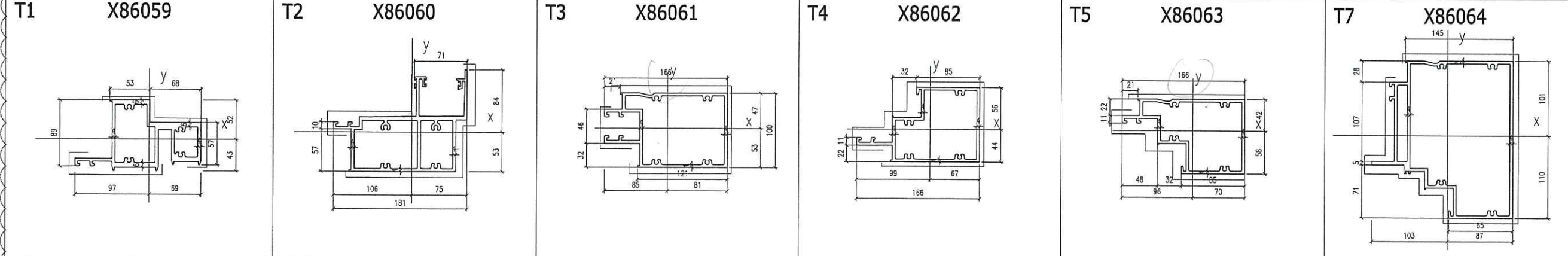

EXTRUSION MARK: (AL11) EXTRUDED ALUM. SILL STACK JOINT GRADE: 6063-T6	EXTRUSION MARK: (AL12) EXTRUDED ALUM. GUTTER STACK JOINT GRADE: 6063-T6	EXTRUSION MARK: (AL13) EXTRUDED ALUM. INTERMEDIATE TRANSOM GRADE: 6063-T6	EXTRUSION MARK: (AL15) EXTRUDED ALUM. INTERMEDIATE TRANSOM GRADE: 6063-T6	EXTRUSION MARK: (AL14) EXTRUDED ALUM. INTERMEDIATE TRANSOM GRADE: 6063-T6	EXTRUSION MARK: (AL69) EXTRUDED ALUM. TRANSOM GRADE: 6063-T6																																																																																																																																																																																																
<table border="1"> <tr><th colspan="2">MASS PROPERTIES (UNIT)</th></tr> <tr><td>Area (mm²):</td><td>2861</td></tr> <tr><td>Perimeter (mm):</td><td>1147</td></tr> <tr><td>Bounding Box - X (mm):</td><td>-37 to 69</td></tr> <tr><td>Bounding Box - Y (mm):</td><td>-43 to 52</td></tr> <tr><td>Centroid - X (mm):</td><td>0</td></tr> <tr><td>Centroid - Y (mm):</td><td>0</td></tr> <tr><td>Moments of inertia - X (mm⁴):</td><td>2407041</td></tr> <tr><td>Moments of inertia - Y (mm⁴):</td><td>5237323</td></tr> <tr><td>Product of inertia - XY (mm⁴):</td><td>-167465</td></tr> <tr><td>Radii of gyration - X (mm):</td><td>29</td></tr> <tr><td>Radii of gyration - Y (mm):</td><td>43</td></tr> <tr><td>Principal moments along X-Y (mm⁴):</td><td>2397167 along [1 0]</td></tr> <tr><td>Principal moments along Y-X (mm⁴):</td><td>5247197 along [0 1]</td></tr> <tr><td>Elastic Modulus - Zx (mm²):</td><td>1 / y-max= 45849</td></tr> <tr><td>Elastic Modulus - Zy (mm²):</td><td>1 / x-max= 54012</td></tr> </table>	MASS PROPERTIES (UNIT)		Area (mm ²):	2861	Perimeter (mm):	1147	Bounding Box - X (mm):	-37 to 69	Bounding Box - Y (mm):	-43 to 52	Centroid - X (mm):	0	Centroid - Y (mm):	0	Moments of inertia - X (mm ⁴):	2407041	Moments of inertia - Y (mm ⁴):	5237323	Product of inertia - XY (mm ⁴):	-167465	Radii of gyration - X (mm):	29	Radii of gyration - Y (mm):	43	Principal moments along X-Y (mm ⁴):	2397167 along [1 0]	Principal moments along Y-X (mm ⁴):	5247197 along [0 1]	Elastic Modulus - Zx (mm ²):	1 / y-max= 45849	Elastic Modulus - Zy (mm ²):	1 / x-max= 54012	<table border="1"> <tr><th colspan="2">MASS PROPERTIES (UNIT)</th></tr> <tr><td>Area (mm²):</td><td>3148</td></tr> <tr><td>Perimeter (mm):</td><td>1258.1408</td></tr> <tr><td>Bounding Box - X (mm):</td><td>-106 to 75</td></tr> <tr><td>Bounding Box - Y (mm):</td><td>-53 to 84</td></tr> <tr><td>Centroid - X (mm):</td><td>0</td></tr> <tr><td>Centroid - Y (mm):</td><td>0</td></tr> <tr><td>Moments of inertia - X (mm⁴):</td><td>4302661</td></tr> <tr><td>Moments of inertia - Y (mm⁴):</td><td>8099841</td></tr> <tr><td>Product of inertia - XY (mm⁴):</td><td>-1612375</td></tr> <tr><td>Radii of gyration - X (mm):</td><td>37</td></tr> <tr><td>Radii of gyration - Y (mm):</td><td>51</td></tr> <tr><td>Principal moments along X-Y (mm⁴):</td><td>3710389 along [1 0]</td></tr> <tr><td>Principal moments along Y-X (mm⁴):</td><td>8632114 along [0 1]</td></tr> <tr><td>Elastic Modulus - Zx (mm²):</td><td>1 / y-max= 51190</td></tr> <tr><td>Elastic Modulus - Zy (mm²):</td><td>1 / x-max= 29224</td></tr> </table>	MASS PROPERTIES (UNIT)		Area (mm ²):	3148	Perimeter (mm):	1258.1408	Bounding Box - X (mm):	-106 to 75	Bounding Box - Y (mm):	-53 to 84	Centroid - X (mm):	0	Centroid - Y (mm):	0	Moments of inertia - X (mm ⁴):	4302661	Moments of inertia - Y (mm ⁴):	8099841	Product of inertia - XY (mm ⁴):	-1612375	Radii of gyration - X (mm):	37	Radii of gyration - Y (mm):	51	Principal moments along X-Y (mm ⁴):	3710389 along [1 0]	Principal moments along Y-X (mm ⁴):	8632114 along [0 1]	Elastic Modulus - Zx (mm ²):	1 / y-max= 51190	Elastic Modulus - Zy (mm ²):	1 / x-max= 29224	<table border="1"> <tr><th colspan="2">MASS PROPERTIES (UNIT)</th></tr> <tr><td>Area (mm²):</td><td>1254.2641</td></tr> <tr><td>Perimeter (mm):</td><td>1574</td></tr> <tr><td>Bounding Box - X (mm):</td><td>-85.3181 to 80.6819</td></tr> <tr><td>Bounding Box - Y (mm):</td><td>-52.5620 to 47.4180</td></tr> <tr><td>Centroid - X (mm):</td><td>0</td></tr> <tr><td>Centroid - Y (mm):</td><td>0</td></tr> <tr><td>Moments of inertia - X (mm⁴):</td><td>3725480.1325</td></tr> <tr><td>Moments of inertia - Y (mm⁴):</td><td>7029288.0999</td></tr> <tr><td>Product of inertia - XY (mm⁴):</td><td>-47558.3228</td></tr> <tr><td>Radii of gyration - X (mm):</td><td>37.6558</td></tr> <tr><td>Radii of gyration - Y (mm):</td><td>54.2745</td></tr> <tr><td>Principal moments along X-Y (mm⁴):</td><td>322735.8831 along [0.9938 -0.1115]</td></tr> <tr><td>Principal moments along Y-X (mm⁴):</td><td>7070706.3394 along [0.1115 0.9938]</td></tr> <tr><td>Elastic Modulus - Zx (mm²):</td><td>1 / y-max= 62284.9524</td></tr> <tr><td>Elastic Modulus - Zy (mm²):</td><td>1 / x-max= 46746.1046</td></tr> </table>	MASS PROPERTIES (UNIT)		Area (mm ²):	1254.2641	Perimeter (mm):	1574	Bounding Box - X (mm):	-85.3181 to 80.6819	Bounding Box - Y (mm):	-52.5620 to 47.4180	Centroid - X (mm):	0	Centroid - Y (mm):	0	Moments of inertia - X (mm ⁴):	3725480.1325	Moments of inertia - Y (mm ⁴):	7029288.0999	Product of inertia - XY (mm ⁴):	-47558.3228	Radii of gyration - X (mm):	37.6558	Radii of gyration - Y (mm):	54.2745	Principal moments along X-Y (mm ⁴):	322735.8831 along [0.9938 -0.1115]	Principal moments along Y-X (mm ⁴):	7070706.3394 along [0.1115 0.9938]	Elastic Modulus - Zx (mm ²):	1 / y-max= 62284.9524	Elastic Modulus - Zy (mm ²):	1 / x-max= 46746.1046	<table border="1"> <tr><th colspan="2">MASS PROPERTIES (UNIT)</th></tr> <tr><td>Area (mm²):</td><td>2071.2051</td></tr> <tr><td>Perimeter (mm):</td><td>1098.1385</td></tr> <tr><td>Bounding Box - X (mm):</td><td>-80.8372 to 87.0528</td></tr> <tr><td>Bounding Box - Y (mm):</td><td>-43.7539 to 56.2461</td></tr> <tr><td>Centroid - X (mm):</td><td>0</td></tr> <tr><td>Centroid - Y (mm):</td><td>0</td></tr> <tr><td>Moments of inertia - X (mm⁴):</td><td>1881663.2595</td></tr> <tr><td>Moments of inertia - Y (mm⁴):</td><td>4860671.2231</td></tr> <tr><td>Product of inertia - XY (mm⁴):</td><td>-88874.0541</td></tr> <tr><td>Radii of gyration - X (mm):</td><td>35.5735</td></tr> <tr><td>Radii of gyration - Y (mm):</td><td>48.9278</td></tr> <tr><td>Principal moments along X-Y (mm⁴):</td><td>233128.4508 along [0.9497 0.3130]</td></tr> <tr><td>Principal moments along Y-X (mm⁴):</td><td>5292728.4988 along [-0.3130 0.9497]</td></tr> <tr><td>Elastic Modulus - Zx (mm²):</td><td>1 / y-max= 46818.3548</td></tr> <tr><td>Elastic Modulus - Zy (mm²):</td><td>1 / x-max= 56233.9751</td></tr> </table>	MASS PROPERTIES (UNIT)		Area (mm ²):	2071.2051	Perimeter (mm):	1098.1385	Bounding Box - X (mm):	-80.8372 to 87.0528	Bounding Box - Y (mm):	-43.7539 to 56.2461	Centroid - X (mm):	0	Centroid - Y (mm):	0	Moments of inertia - X (mm ⁴):	1881663.2595	Moments of inertia - Y (mm ⁴):	4860671.2231	Product of inertia - XY (mm ⁴):	-88874.0541	Radii of gyration - X (mm):	35.5735	Radii of gyration - Y (mm):	48.9278	Principal moments along X-Y (mm ⁴):	233128.4508 along [0.9497 0.3130]	Principal moments along Y-X (mm ⁴):	5292728.4988 along [-0.3130 0.9497]	Elastic Modulus - Zx (mm ²):	1 / y-max= 46818.3548	Elastic Modulus - Zy (mm ²):	1 / x-max= 56233.9751	<table border="1"> <tr><th colspan="2">MASS PROPERTIES (UNIT)</th></tr> <tr><td>Area (mm²):</td><td>2150.2450</td></tr> <tr><td>Perimeter (mm):</td><td>1145.1450</td></tr> <tr><td>Bounding Box - X (mm):</td><td>-86.8631 to 70.3369</td></tr> <tr><td>Bounding Box - Y (mm):</td><td>-52.7270 to 42.2730</td></tr> <tr><td>Centroid - X (mm):</td><td>0</td></tr> <tr><td>Centroid - Y (mm):</td><td>0</td></tr> <tr><td>Moments of inertia - X (mm⁴):</td><td>2248128.2983</td></tr> <tr><td>Moments of inertia - Y (mm⁴):</td><td>541328.0904</td></tr> <tr><td>Product of inertia - XY (mm⁴):</td><td>1130201.8700</td></tr> <tr><td>Radii of gyration - X (mm):</td><td>35.7360</td></tr> <tr><td>Radii of gyration - Y (mm):</td><td>50.6394</td></tr> <tr><td>Principal moments along X-Y (mm⁴):</td><td>2343358.7725 along [0.6420 -0.3357]</td></tr> <tr><td>Principal moments along Y-X (mm⁴):</td><td>5016527.6443 along [0.3357 0.6420]</td></tr> <tr><td>Elastic Modulus - Zx (mm²):</td><td>1 / y-max= 47570.9929</td></tr> <tr><td>Elastic Modulus - Zy (mm²):</td><td>1 / x-max= 52639.7921</td></tr> </table>	MASS PROPERTIES (UNIT)		Area (mm ²):	2150.2450	Perimeter (mm):	1145.1450	Bounding Box - X (mm):	-86.8631 to 70.3369	Bounding Box - Y (mm):	-52.7270 to 42.2730	Centroid - X (mm):	0	Centroid - Y (mm):	0	Moments of inertia - X (mm ⁴):	2248128.2983	Moments of inertia - Y (mm ⁴):	541328.0904	Product of inertia - XY (mm ⁴):	1130201.8700	Radii of gyration - X (mm):	35.7360	Radii of gyration - Y (mm):	50.6394	Principal moments along X-Y (mm ⁴):	2343358.7725 along [0.6420 -0.3357]	Principal moments along Y-X (mm ⁴):	5016527.6443 along [0.3357 0.6420]	Elastic Modulus - Zx (mm ²):	1 / y-max= 47570.9929	Elastic Modulus - Zy (mm ²):	1 / x-max= 52639.7921	<table border="1"> <tr><th colspan="2">MASS PROPERTIES (UNIT)</th></tr> <tr><td>Area (mm²):</td><td>3712</td></tr> <tr><td>Perimeter (mm):</td><td>1885</td></tr> <tr><td>Bounding Box - X (mm):</td><td>-103 to 87</td></tr> <tr><td>Bounding Box - Y (mm):</td><td>-110 to 101</td></tr> <tr><td>Centroid - X (mm):</td><td>0</td></tr> <tr><td>Centroid - Y (mm):</td><td>0</td></tr> <tr><td>Moments of inertia - X (mm⁴):</td><td>18224860</td></tr> <tr><td>Moments of inertia - Y (mm⁴):</td><td>14318458</td></tr> <tr><td>Product of inertia - XY (mm⁴):</td><td>1779096</td></tr> <tr><td>Radii of gyration - X (mm):</td><td>70</td></tr> <tr><td>Radii of gyration - Y (mm):</td><td>62</td></tr> <tr><td>Principal moments along X-Y (mm⁴):</td><td>18913401 along [1 0]</td></tr> <tr><td>Principal moments along Y-X (mm⁴):</td><td>13627918 along [0 1]</td></tr> <tr><td>Elastic Modulus - Zx (mm²):</td><td>1 / y-max= 165053</td></tr> <tr><td>Elastic Modulus - Zy (mm²):</td><td>1 / x-max= 128927</td></tr> </table>	MASS PROPERTIES (UNIT)		Area (mm ²):	3712	Perimeter (mm):	1885	Bounding Box - X (mm):	-103 to 87	Bounding Box - Y (mm):	-110 to 101	Centroid - X (mm):	0	Centroid - Y (mm):	0	Moments of inertia - X (mm ⁴):	18224860	Moments of inertia - Y (mm ⁴):	14318458	Product of inertia - XY (mm ⁴):	1779096	Radii of gyration - X (mm):	70	Radii of gyration - Y (mm):	62	Principal moments along X-Y (mm ⁴):	18913401 along [1 0]	Principal moments along Y-X (mm ⁴):	13627918 along [0 1]	Elastic Modulus - Zx (mm ²):	1 / y-max= 165053	Elastic Modulus - Zy (mm ²):	1 / x-max= 128927
MASS PROPERTIES (UNIT)																																																																																																																																																																																																					
Area (mm ²):	2861																																																																																																																																																																																																				
Perimeter (mm):	1147																																																																																																																																																																																																				
Bounding Box - X (mm):	-37 to 69																																																																																																																																																																																																				
Bounding Box - Y (mm):	-43 to 52																																																																																																																																																																																																				
Centroid - X (mm):	0																																																																																																																																																																																																				
Centroid - Y (mm):	0																																																																																																																																																																																																				
Moments of inertia - X (mm ⁴):	2407041																																																																																																																																																																																																				
Moments of inertia - Y (mm ⁴):	5237323																																																																																																																																																																																																				
Product of inertia - XY (mm ⁴):	-167465																																																																																																																																																																																																				
Radii of gyration - X (mm):	29																																																																																																																																																																																																				
Radii of gyration - Y (mm):	43																																																																																																																																																																																																				
Principal moments along X-Y (mm ⁴):	2397167 along [1 0]																																																																																																																																																																																																				
Principal moments along Y-X (mm ⁴):	5247197 along [0 1]																																																																																																																																																																																																				
Elastic Modulus - Zx (mm ²):	1 / y-max= 45849																																																																																																																																																																																																				
Elastic Modulus - Zy (mm ²):	1 / x-max= 54012																																																																																																																																																																																																				
MASS PROPERTIES (UNIT)																																																																																																																																																																																																					
Area (mm ²):	3148																																																																																																																																																																																																				
Perimeter (mm):	1258.1408																																																																																																																																																																																																				
Bounding Box - X (mm):	-106 to 75																																																																																																																																																																																																				
Bounding Box - Y (mm):	-53 to 84																																																																																																																																																																																																				
Centroid - X (mm):	0																																																																																																																																																																																																				
Centroid - Y (mm):	0																																																																																																																																																																																																				
Moments of inertia - X (mm ⁴):	4302661																																																																																																																																																																																																				
Moments of inertia - Y (mm ⁴):	8099841																																																																																																																																																																																																				
Product of inertia - XY (mm ⁴):	-1612375																																																																																																																																																																																																				
Radii of gyration - X (mm):	37																																																																																																																																																																																																				
Radii of gyration - Y (mm):	51																																																																																																																																																																																																				
Principal moments along X-Y (mm ⁴):	3710389 along [1 0]																																																																																																																																																																																																				
Principal moments along Y-X (mm ⁴):	8632114 along [0 1]																																																																																																																																																																																																				
Elastic Modulus - Zx (mm ²):	1 / y-max= 51190																																																																																																																																																																																																				
Elastic Modulus - Zy (mm ²):	1 / x-max= 29224																																																																																																																																																																																																				
MASS PROPERTIES (UNIT)																																																																																																																																																																																																					
Area (mm ²):	1254.2641																																																																																																																																																																																																				
Perimeter (mm):	1574																																																																																																																																																																																																				
Bounding Box - X (mm):	-85.3181 to 80.6819																																																																																																																																																																																																				
Bounding Box - Y (mm):	-52.5620 to 47.4180																																																																																																																																																																																																				
Centroid - X (mm):	0																																																																																																																																																																																																				
Centroid - Y (mm):	0																																																																																																																																																																																																				
Moments of inertia - X (mm ⁴):	3725480.1325																																																																																																																																																																																																				
Moments of inertia - Y (mm ⁴):	7029288.0999																																																																																																																																																																																																				
Product of inertia - XY (mm ⁴):	-47558.3228																																																																																																																																																																																																				
Radii of gyration - X (mm):	37.6558																																																																																																																																																																																																				
Radii of gyration - Y (mm):	54.2745																																																																																																																																																																																																				
Principal moments along X-Y (mm ⁴):	322735.8831 along [0.9938 -0.1115]																																																																																																																																																																																																				
Principal moments along Y-X (mm ⁴):	7070706.3394 along [0.1115 0.9938]																																																																																																																																																																																																				
Elastic Modulus - Zx (mm ²):	1 / y-max= 62284.9524																																																																																																																																																																																																				
Elastic Modulus - Zy (mm ²):	1 / x-max= 46746.1046																																																																																																																																																																																																				
MASS PROPERTIES (UNIT)																																																																																																																																																																																																					
Area (mm ²):	2071.2051																																																																																																																																																																																																				
Perimeter (mm):	1098.1385																																																																																																																																																																																																				
Bounding Box - X (mm):	-80.8372 to 87.0528																																																																																																																																																																																																				
Bounding Box - Y (mm):	-43.7539 to 56.2461																																																																																																																																																																																																				
Centroid - X (mm):	0																																																																																																																																																																																																				
Centroid - Y (mm):	0																																																																																																																																																																																																				
Moments of inertia - X (mm ⁴):	1881663.2595																																																																																																																																																																																																				
Moments of inertia - Y (mm ⁴):	4860671.2231																																																																																																																																																																																																				
Product of inertia - XY (mm ⁴):	-88874.0541																																																																																																																																																																																																				
Radii of gyration - X (mm):	35.5735																																																																																																																																																																																																				
Radii of gyration - Y (mm):	48.9278																																																																																																																																																																																																				
Principal moments along X-Y (mm ⁴):	233128.4508 along [0.9497 0.3130]																																																																																																																																																																																																				
Principal moments along Y-X (mm ⁴):	5292728.4988 along [-0.3130 0.9497]																																																																																																																																																																																																				
Elastic Modulus - Zx (mm ²):	1 / y-max= 46818.3548																																																																																																																																																																																																				
Elastic Modulus - Zy (mm ²):	1 / x-max= 56233.9751																																																																																																																																																																																																				
MASS PROPERTIES (UNIT)																																																																																																																																																																																																					
Area (mm ²):	2150.2450																																																																																																																																																																																																				
Perimeter (mm):	1145.1450																																																																																																																																																																																																				
Bounding Box - X (mm):	-86.8631 to 70.3369																																																																																																																																																																																																				
Bounding Box - Y (mm):	-52.7270 to 42.2730																																																																																																																																																																																																				
Centroid - X (mm):	0																																																																																																																																																																																																				
Centroid - Y (mm):	0																																																																																																																																																																																																				
Moments of inertia - X (mm ⁴):	2248128.2983																																																																																																																																																																																																				
Moments of inertia - Y (mm ⁴):	541328.0904																																																																																																																																																																																																				
Product of inertia - XY (mm ⁴):	1130201.8700																																																																																																																																																																																																				
Radii of gyration - X (mm):	35.7360																																																																																																																																																																																																				
Radii of gyration - Y (mm):	50.6394																																																																																																																																																																																																				
Principal moments along X-Y (mm ⁴):	2343358.7725 along [0.6420 -0.3357]																																																																																																																																																																																																				
Principal moments along Y-X (mm ⁴):	5016527.6443 along [0.3357 0.6420]																																																																																																																																																																																																				
Elastic Modulus - Zx (mm ²):	1 / y-max= 47570.9929																																																																																																																																																																																																				
Elastic Modulus - Zy (mm ²):	1 / x-max= 52639.7921																																																																																																																																																																																																				
MASS PROPERTIES (UNIT)																																																																																																																																																																																																					
Area (mm ²):	3712																																																																																																																																																																																																				
Perimeter (mm):	1885																																																																																																																																																																																																				
Bounding Box - X (mm):	-103 to 87																																																																																																																																																																																																				
Bounding Box - Y (mm):	-110 to 101																																																																																																																																																																																																				
Centroid - X (mm):	0																																																																																																																																																																																																				
Centroid - Y (mm):	0																																																																																																																																																																																																				
Moments of inertia - X (mm ⁴):	18224860																																																																																																																																																																																																				
Moments of inertia - Y (mm ⁴):	14318458																																																																																																																																																																																																				
Product of inertia - XY (mm ⁴):	1779096																																																																																																																																																																																																				
Radii of gyration - X (mm):	70																																																																																																																																																																																																				
Radii of gyration - Y (mm):	62																																																																																																																																																																																																				
Principal moments along X-Y (mm ⁴):	18913401 along [1 0]																																																																																																																																																																																																				
Principal moments along Y-X (mm ⁴):	13627918 along [0 1]																																																																																																																																																																																																				
Elastic Modulus - Zx (mm ²):	1 / y-max= 165053																																																																																																																																																																																																				
Elastic Modulus - Zy (mm ²):	1 / x-max= 128927																																																																																																																																																																																																				

B.D. REF :
F.S.D. REF :
Note:
1. All dimensions are in mm.
2. All elevations are viewed from outside.
3. All dimensions to be verified on site before fabrication.

GENERAL NOTES

Legend:
F.F.L. -- Finished Floor Level
S.F.L. -- Structural Floor Level
R -- Reversed Detail

DETAIL MARK NO.
REFER SHEET NO.

DATE: _____
REVIEWED BY: _____
REMARKS: _____

NO OBJECTION, SUBJECT TO COMMENTS AS NOTED
G (Amendment & resubmission required)
C (Rejected & resubmission required)

NO REVIEW IS MADE OF DETAIL DIMENSIONS/QUANTITIES.
THE SUBMISSION IS REVIEWED FOR GENERAL COMPLIANCE WITH THE DESIGN INTENT ONLY.
ANY COMMENTS OR AMENDMENTS REQUIRED WILL NOT BE DEEMED TO BE VARIATION.
THE REVIEW DOES NOT RELEASE THE CONTRACTOR FROM HIS RESPONSIBILITIES TO COMPLY WITH CONTRACT REQUIREMENTS.

B Nov.2021 GENERAL REVISION
A 18.Oct.2021 GENERAL REVISION

CLIENT :
MARBLE EDGE INVESTMENT LTD.

ARCHITECT :
RONALD LU & PARTNERS
ARCHITECTS | PLANNERS | INTERIOR DESIGNERS

STRUCTURAL ENGINEER :
CMA C-M WONG & ASSOCIATES LTD
TEL: (852) 2522 1088

MAIN CONTRACTOR :
裕民建築有限公司
美特鋁質有限公司
MIDI ALUMINIUM FABRICATOR LTD.
Units 6-8, Sunray Industrial Centre, 1/F
610 Cha Kwo Ling Road, Kowloon
Tel: 23489211-4 Fax: (852) 27727666

PROJECT :
PROPOSED RESIDENTIAL DEVELOPMENT AT NEW KOWLOON INLAND LOT

