



工程指示 / 要求簡箋 ENGINEER INSTRUCTIONS(E.I.)

工程指示編號:	EI- 8372	修改版本:	-
	HK- 1750		
工程編號:	J 856	工程名稱:	天榮站
收件人:	生統	發件人:	Iris
工程項目:	T2 SU層 Simple-1B單位更換窗玉 (由AW06aR改為AW06a)	日期:	25/09/2024

<input checked="" type="checkbox"/> 原合約工程包	<input type="checkbox"/> 原合約工程加 / 減賬 QT-	<input type="checkbox"/> 新工程報價 QT-
--	--	------------------------------------

信件批核號碼/圖紙參考編號:	批核模具圖紙編號:
客戶指示附件:	管理內部批簽署:

<input type="checkbox"/> 初步鋁料 B.M.	<input type="checkbox"/> 加工拆圖, 然後生產	<input type="checkbox"/> 尺寸表
<input type="checkbox"/> 正式鋁料 B.M.	<input type="checkbox"/> 技術上資料/指示	<input type="checkbox"/> 報價
<input type="checkbox"/> 配件 B.M.	<input type="checkbox"/> 樣辦或貨品說明書	<input type="checkbox"/> 分判合約
<input type="checkbox"/> 其他:		

內容:
 根括LWK於去年10月14日comment, 位於T2 SU層 Simple-1B單位 UTI內的鋁窗要由AW06aR款更改為AW06a. 為趕及交樓小組驗收單位, 需重新訂窗玉及相關配置作更換.

完成上列要求日期: 30/09/2024

國內

<input type="checkbox"/> 生產技術總監	<input type="checkbox"/> 連附件	<input checked="" type="checkbox"/> 技術部	<input checked="" type="checkbox"/> 連附件	<input type="checkbox"/> 生產部	<input type="checkbox"/> 連附件
<input type="checkbox"/> 採購部	<input type="checkbox"/> 連附件	<input checked="" type="checkbox"/> 生產統籌部	<input checked="" type="checkbox"/> 連附件	<input type="checkbox"/> 報關組	<input type="checkbox"/> 連附件
<input type="checkbox"/> 質檢部	<input type="checkbox"/> 連附件	<input type="checkbox"/> 會計部	<input type="checkbox"/> 連附件	<input type="checkbox"/> 機械設計部	<input type="checkbox"/> 連附件
<input type="checkbox"/> 香港辦	<input type="checkbox"/> 連附件	<input type="checkbox"/> 其他:			

香港

<input type="checkbox"/> 行政部	<input type="checkbox"/> 連附件	<input type="checkbox"/> 會計部	<input type="checkbox"/> 連附件	<input type="checkbox"/> 統籌部	<input type="checkbox"/> 連附件	<input type="checkbox"/> 工程部	<input type="checkbox"/> 連附件
<input type="checkbox"/> 採購部	<input type="checkbox"/> 連附件	<input type="checkbox"/> QS部	<input type="checkbox"/> 連附件	<input checked="" type="checkbox"/> 地盤管理	<input checked="" type="checkbox"/> 連附件	<input type="checkbox"/> 維修部	<input type="checkbox"/> 連附件

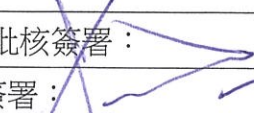
*發件人簽署: Iris	*組別成員批核簽署:
傳遞編號:	項目經理簽署:  25/9/24

Chan Ching Ning

LWK COMMENT @ 14/10/23

寄件者: Ken Law <kenlaw@lwkp.com>
寄件日期: 2023年10月14日星期六 16:57
收件者: Tin Wing Stop - Project
副本: Robert Seng Hok Hung; Jonathan Chan Fuk Keung; Nick Cheng Lik Wai; Petrina Cheung Long Ying; Robert Lam Siu Hung; Lau Chi Kin; Kevin Lam Chun Yin; Chan Kai Lok; Michael Chan Hau Shing; Catherine Yeung; 'Arup-Michael Ku (michael.ku@arup.com)'; 'Arup-James Wong (james-tp.wong@arup.com)'; Arup-Project Email (hkg.tws242744@arup.com); Arup-David Lam (david-ym.lam@arup.com); Arup-Jenny Leung (jenny.leung@arup.com); Arup(RE)-Dixon Wong (dixon.wong@arup.com); Arup-Tommy Ng (tommy-cy.ng@arup.com); Arup-Samson Ho (samson-jl.ho@arup.com); 'Arup(RE)-Tim Chau (tim.chau@arup.com)'; 'Arup(RE)-Leo Lau (leo-cy.lau@arup.com)'; MTR-Dick Yang (dickyang@mtr.com.hk); MTR-Alvin Chan (alvinswchan@mtr.com.hk); MTR-Andrew Tai (andrewystai@mtr.com.hk); MTR-Gary Chan (kaifu@mtr.com.hk); MTR-Sam Lee (wflee@mtr.com.hk); MTR-Tony Chan (tcychan@mtr.com.hk); MTR-Tommy Chan (tommycck@mtr.com.hk); Cheng Shu Yan; TSWTL23 - PC; TSWTL23 - Site Engineer; TSWTL23 - M&E; Terence Cheung Man Chiu; Roger Choi Ka Fat; Lai Yuen Wing; Teddy Chan Kwok Yuen; Alpha project email (J1805-TinWingstop@alpha-c.com.hk); Alpha-Dominic (dominic@alpha-c.com.hk); Alpha-Mr Lau (zhlau@alpha-c.com.hk); suen.wy@alpha-c.com.hk; Lai Yuen Wing; Teddy Chan Kwok Yuen; Carmen Wong; Henry Man; Ko Sze Wing; Ryan Chan; Catherine Yeung; Christopher Lai
主旨: RE: TSWTL23-SDS-0403F 7th Shop Drawing Submission of Aluminium In-Situ Window for Tower 1-3 (46/F)
類別: Elaine

【 External Email 】 Be cautious of any links and attachments included.

Dear all,

Please find in the below link our reply to SDS-0403F for your reference and follow up.

[📄 20231014 Reply to SDS-0403F 7th Shop Drawing Submission of Aluminium In-Situ Window for Tower 1-3 \(46F\)](#)

Best Regards,

+ **Ken Law** | Senior Associate

15/F, NORTH TOWER, WORLD FINANCE CENTRE
HARBOUR CITY, TSIM SHA TSUI, HONG KONG
T +852 25741633 | D +852 25892872 | F +852 25724908

LWKP.COM | FACEBOOK | WECHAT | LINKEDIN | INSTAGRAM | TWITTER

**LWK
+PARTNERS**

HONG KONG | SHENZHEN | GUANGZHOU | SHANGHAI | CHONGQING | BEIJING | SHENYANG | MACAU | MANILA | SIN

Please consider the environment before printing this email.

This communication is intended for the sole use of the person(s) to whom it is addressed and may contain information that is privileged, confidential or subject to copyright. Any unauthorised use, disclosure or copying of this communication is strictly prohibited. If you have received this communication in error, please contact LWK & Partners (HK) Ltd. immediately. Any communication received in error should be deleted and all copies destroyed. C Cheng Holdings Limited and its group companies accept no liability for any errors or omissions in the context of this message as a result of transmission over the internet. If you receive suspicious emails from domains other than lwkp.com / lwkp.com.cn / lwkp.ph, you should call and verify with us at +852 2574 1633.

From: twsproject@shkp.com <twsproject@shkp.com>

Sent: Thursday, August 31, 2023 6:38 PM

To: Carmen Wong <carmenwong@lwkp.com>; Ken Law <kenlaw@lwkp.com>; Ko Sze Wing <swko@lwkp.com>; Ryan Chan <RyanChan@lwkp.com>

Cc: robertseng@shkp.com; jonathanfkchan@shkp.com; nickcheng@shkp.com; lypcheung@shkp.com; shrlam@shkp.com; cklau@shkp.com; kevinlam@shkp.com; kailok@shkp.com; hschan@shkp.com; Catherine Yeung <catherineyeung@lwkp.com>; 'Arup-Michael Ku (michael.ku@arup.com)' <michael.ku@arup.com>; 'Arup-James Wong (james-tp.wong@arup.com)' <james-tp.wong@arup.com>; Arup-Project Email (hkg.tws242744@arup.com) <hkg.tws242744@arup.com>; Arup-David Lam (david-ym.lam@arup.com) <david-ym.lam@arup.com>; Arup-Jenny Leung (jenny.leung@arup.com) <jenny.leung@arup.com>; Arup(RE)-Dixon Wong (dixon.wong@arup.com) <dixon.wong@arup.com>; Arup-Tommy Ng (tommy-cy.ng@arup.com) <tommy-cy.ng@arup.com>; Arup-Samson Ho (samson-jl.ho@arup.com) <samson-jl.ho@arup.com>; 'Arup(RE)-Tim Chau (tim.chau@arup.com)' <tim.chau@arup.com>; 'Arup(RE)-Leo Lau (leo-cy.lau@arup.com)' <leo-cy.lau@arup.com>; MTR-Dick Yang (dickyang@mtr.com.hk) <dickyang@mtr.com.hk>; MTR-Alvin Chan (alvinswchan@mtr.com.hk) <alvinswchan@mtr.com.hk>; MTR-Andrew Tai (andrewystai@mtr.com.hk) <andrewystai@mtr.com.hk>; MTR-Gary Chan (kaifu@mtr.com.hk) <kaifu@mtr.com.hk>; MTR-Sam Lee (wflee@mtr.com.hk) <wflee@mtr.com.hk>; MTR-Tony Chan (tzychan@mtr.com.hk) <tzychan@mtr.com.hk>; MTR-Tommy Chan (tommycck@mtr.com.hk) <tommycck@mtr.com.hk>; sycheng@shkp.com; tswtl23pc@shkp.com; tswtl23se@shkp.com; tswtl23me@shkp.com; manchiu@shkp.com; kfrchoi@shkp.com; yuenwing@shkp.com; kwokyuen@shkp.com; Alpha project email (J1805-TinWingstop@alpha-c.com.hk) <J1805-TinWingstop@alpha-c.com.hk>; Alpha-Dominic (dominic@alpha-c.com.hk) <dominic@alpha-c.com.hk>; Alpha-Mr Lau (zhlau@alpha-c.com.hk) <zhlau@alpha-c.com.hk>; suen.wy@alpha-c.com.hk; yuenwing@shkp.com; kwokyuen@shkp.com

Subject: TSWTL23-SDS-0403F 7th Shop Drawing Submission of Aluminium In-Situ Window for Tower 1-3 (46/F)

Dear all,

We are pleased to attach herewith the shared-link below for reference and action.

Share files

File Name	Valid Until
TSWTL23-SDS-0403F 7th Shop Drawing Submission of Aluminium In-Situ Window for Tower 1-3 (46F).pdf	2023/09/14

Login ID: twsproject@shkp.com

Password: Tw@123tw

Thank you for your kind attention.

Kammy Li

Yee Fai Construction Company Ltd.

Site Clerk for Tin Wing Stop



怡輝建築有限公司

Yee Fai Construction Company Ltd.

Disclaimer: This e-mail message (together with any attachments) is confidential to the addressee and may also be privileged. If you are not the intended recipient, you are hereby notified that any dissemination, distribution or copying of this message is strictly prohibited. Please also notify the sender immediately by return e-mail and delete

it from your system. Internet communications cannot be guaranteed to be secure or error-free. The sender and the entity through which this message is sent therefore do not accept liability for errors or omissions as contained in the message and any spreading of viruses as a result of Internet transmission. Any opinions contained in this message are those of the sender personally and would not bind any entity unless otherwise clearly stated and with the authority of the sender duly verified.



YEE FAI CONSTRUCTION COMPANY LTD.

怡輝建築有限公司

SHOP DRAWING SUBMISSION

PROJECT :	Property Development at LRT Tin Wing Stop at Tin Shui Wai on Lot No. TSWTL23	Document Ref.: TSWTL23/SDS-0403F
We submit herewith the following General Submission to LWK & Partners (HK) Ltd. Attn: Ms. Carmen Wong / Mr. Ken Law / Ms. S. W. Ko Mr. Ryan Chan for <input checked="" type="checkbox"/> approval / <input type="checkbox"/> information / <input type="checkbox"/> Others, please specify : _____		Sub-contractor: Midi Aluminium Fabricator Ltd. <input checked="" type="checkbox"/> Re-submission / <input type="checkbox"/> Supplementary
SUBJECT: 7 th Shop drawing submission of Aluminium In-Situ Window for Tower 1-3 (46/F) Including : <input checked="" type="checkbox"/> Structural Calculation		
We would like to submit herewith the following drawings for your comment and approval.		
Drawing No.	Title	Revision.
	Refer to drawing list	
This submission is attached with the following: <input checked="" type="checkbox"/> Structural Calculation		
Remarks <input checked="" type="checkbox"/> Your prompt reply before <u>10 Sept 23</u> would be much appreciated. Thank you for your attention.		
c.c. (By Email)		Authorized Representative
Best Vision Development Ltd	Mr. Robert Seng / Mr. Jonathan Chan / Mr. Robert Lam / Mr. Nick Cheng / Ms. Petrina Cheung	<input checked="" type="checkbox"/> w/e <input type="checkbox"/> w/o
Sun Hung Kai Architects and Engineers (ST)	Mr. C. K. Lau / Mr. Kevin Lam	<input checked="" type="checkbox"/> <input type="checkbox"/>
Sun Hung Kai Architects and Engineers (ME)	Mr. K. L. Chan / Mr. Michael Chan	<input checked="" type="checkbox"/> <input type="checkbox"/>
Ove Arup & Partners Hong Kong Ltd	Mr. Michael Ku / Mr. James Wong	<input checked="" type="checkbox"/> <input type="checkbox"/>
Ove Arup & Partners Hong Kong Ltd (RP)	Mr. David Lam / Ms. Jenny Leung	<input checked="" type="checkbox"/> <input type="checkbox"/>
Ove Arup & Partners Hong Kong Ltd (RE)	Mr. Dixon Wong / Mr. Tommy Ng / Mr. Samson Ho / Mr. Tim Chau / Mr. Leo Lau	<input checked="" type="checkbox"/> <input type="checkbox"/>
Alpha Consulting	LWK's comments:	<input checked="" type="checkbox"/> <input type="checkbox"/>
MTR Property	1. Detail comment as attached.	<input checked="" type="checkbox"/> <input type="checkbox"/>
Façade Manager	2. Subject to Alpha's and Arup's comments.	<input checked="" type="checkbox"/> <input type="checkbox"/>
Façade Manager	3. Please ensure latest layout is followed.	<input checked="" type="checkbox"/> <input type="checkbox"/>
Site Office	4. Please ensure DA and Contract's requirement is complied.	<input type="checkbox"/> <input checked="" type="checkbox"/>
Prepared by:		Ben Cheng (PM) (Name in Block Letter) 31 AUG 2023 Submission Date

REPLY BY <input checked="" type="checkbox"/> LWKP / <input type="checkbox"/> ARUP / <input type="checkbox"/> SHKAE / <input type="checkbox"/> ANONYMOUS / <input type="checkbox"/> ALPHA / <input type="checkbox"/> _____		
REPLY <input type="checkbox"/> Approved <input checked="" type="checkbox"/> Approved with comments (A) <input type="checkbox"/> Reviewed as Commented (Resubmission Required) (B)		
c.c.		Authorized Representative
Best Vision Development Ltd	Mr. Robert Seng / Mr. Jonathan Chan / Mr. Robert Lam / Mr. Nick Cheng / Ms. Petrina Cheung	<input type="checkbox"/> w/e <input type="checkbox"/> w/o
Sun Hung Kai Architects and Engineers (ST)	Mr. C. K. Lau / Mr. Kevin Lam	<input type="checkbox"/> <input type="checkbox"/>
Sun Hung Kai Architects and Engineers (ME)	Mr. K. L. Chan / Mr. Michael Chan	<input type="checkbox"/> <input type="checkbox"/>
Ove Arup & Partners Hong Kong Ltd	Mr. Michael Ku / Mr. James Wong	<input type="checkbox"/> <input type="checkbox"/>
Ove Arup & Partners Hong Kong Ltd (RP)	Mr. David Lam / Ms. Jenny Leung	<input type="checkbox"/> <input type="checkbox"/>
Ove Arup & Partners Hong Kong Ltd (RE)	Mr. Dixon Wong / Mr. Tommy Ng / Mr. Samson Ho / Mr. Tim Chau / Mr. Leo Lau	<input type="checkbox"/> <input type="checkbox"/>
Alpha Consulting Ltd	Mr. Dominic Yu / Mr. Z. H. Lau / Mr. W.Y.Suen.	<input type="checkbox"/> <input type="checkbox"/>
MTR Property	Mr. Dick Yang / Mr. Alvin Chan / Mr. Andrew Tai / Mr. Gary Chan / Mr. Sam Lee / Mr. Tony Chan / Mr. Tommy Chan	<input type="checkbox"/> <input type="checkbox"/>
Façade Manager(Sanfield)	Mr. Lai Yuen Wing	<input type="checkbox"/> <input type="checkbox"/>
Façade Manager (SHK Purchasing)	Mr. Teddy Chan	<input type="checkbox"/> <input type="checkbox"/>
Site Office		<input type="checkbox"/> <input type="checkbox"/>
		(Name in Block Letter) 14/10/2023 Reply Date

Also make hard copy to the following for their retention and information.

1. PD PM SA ASA SE PC ME QS Safety Officer Site Admin Others: _____

HKC/PMC/mhlA

(* please cross the box and delete any as appropriate)

LWK & PARTNERS (HK) LTD.
 No. 8006
 No Adverse Comment
 No Adverse Comment
 Connected as Planned
 Disapproved
 Date 14/10/2023

This review is for the sole purpose of ascertaining general conformity with the design concept. It is not a guarantee of the structural integrity of the design. The design engineer shall be responsible for errors or omissions in these drawings and shall be responsible for meeting all requirements of the relevant codes and standards. The design engineer shall be responsible for the coordination of all construction with the contractor.

SUN HUNG KAI
 REAL ESTATE AGENCY LTD.
 37/F SUN HUNG KAI CENTRE, WANDONG, HONGKONG

lwk&partners
 ARCHITECTS

怡輝建築有限公司
 Yee Fai Building Contractors Ltd.

ARUP

ALPHA CONSULTING LIMITED
 Steel Structure & Facade Specialist

NOTE:
 1. ALL DIMENSIONS ARE IN mm.
 2. ALL ELEVATIONS ARE VIEWED FROM OUTSIDE.
 3. ALL DIMENSIONS TO BE VERIFIED ON SITE BEFORE FABRICATION.

LEGEND:
 (X) DETAIL MARK NO.
 (Y) REFER SHEET NO.

1. F.F.L. -- FINISHED FLOOR LEVEL
 2. S.F.L. -- STRUCTURAL FLOOR LEVEL
 3. (R) -- REVERSED DETAIL
 4. GLASS LEGEND

EGG-1 -- 8mm+12mm AIR GAP+8mm TP THK. I.G.U.
 EGG-2 -- 10mm THK. CLEAR TEMPERED GLASS
 EGG-4 -- 10mm THK. TEMPERED AND ETCHED GLASS

REV	DATE	REVISION SUBJECT TO AMENDMENT
E	1/9/2023	REVISION SUBJECT TO AMENDMENT
D	28/07/2023	UPDATE GSP
C	10/07/2023	UPDATE GSP
B	10/07/2023	UPDATE GSP
A	30/07/2023	UPDATE GSP

JOB NO.: J-656

PROPOSED DEVELOPMENT ABOVE
 LIGHT RAIL TIN WING STOP/STWLT
 NO.23-AREA 33, TIN SHUI WAI, N.T.

TITLE: PLAN FOR IN-SITU WINDOW
 AT TOWER 2

DATE: 02-Aug-21 SCALE: 1:200
 DRAWN BY: Ivan CHECKED BY:

英特鋁質有限公司
 MIDDI ALUMINIUM FABRICATOR LTD.
 Units 6-8, Sunny Industrial Centre, 1/F
 140-142, Sunny Industrial Centre, 1/F
 142-2488211-4 Fax: (852) 2727556

DWG NO.: JB56-SD-WF-3203 REV.: E

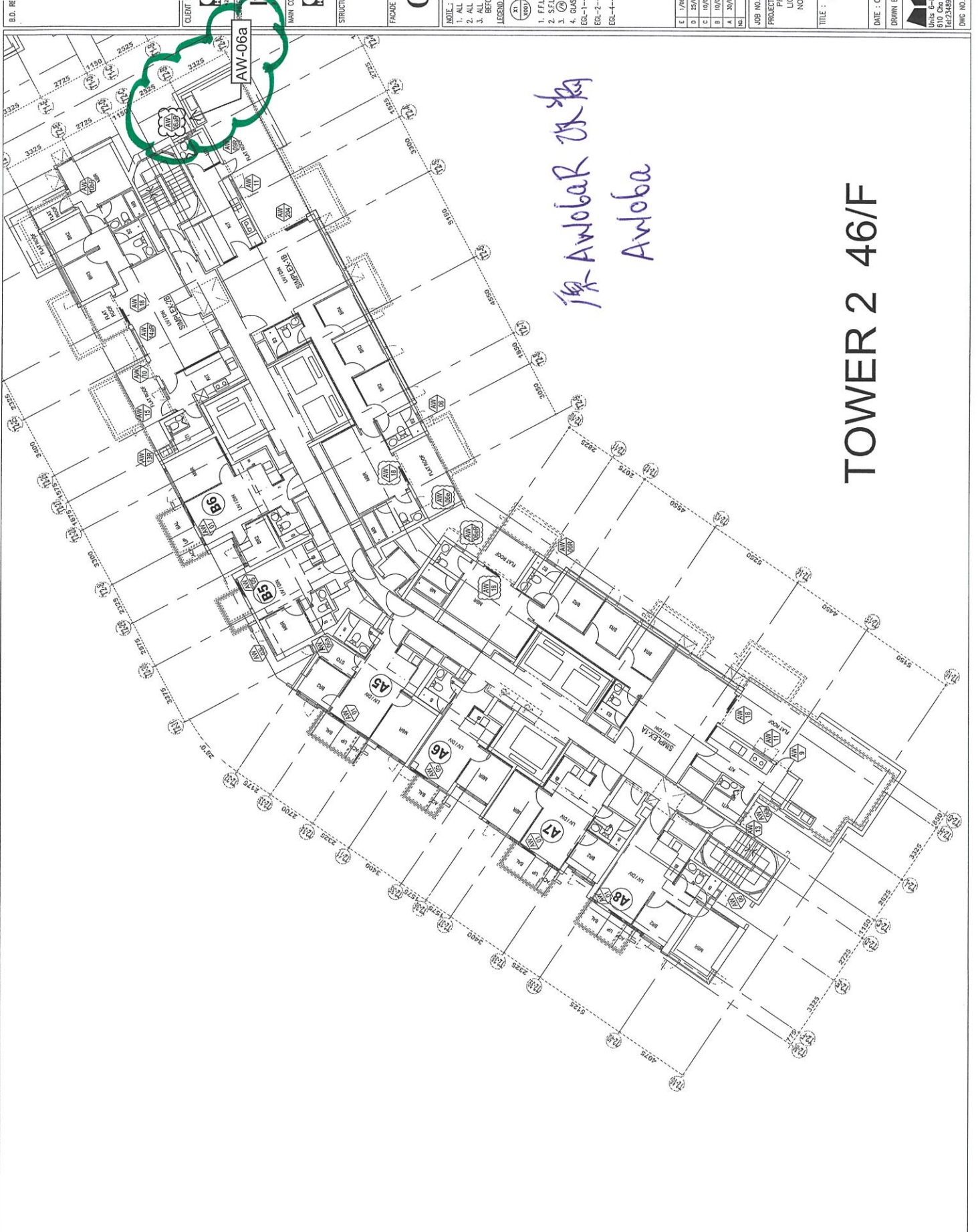

TOWER 2 46/F

 美特鋁質有限公司 MIDI Aluminium Fabricator Ltd.	工程號	J856	拆圖	周廣志	2024.05.22
	地盤	天水圍天榮站	復核	謝永林	2024.06.03
名稱	50後裝窗	顏色	中灰色 (UCT542919XL-3)	批准	

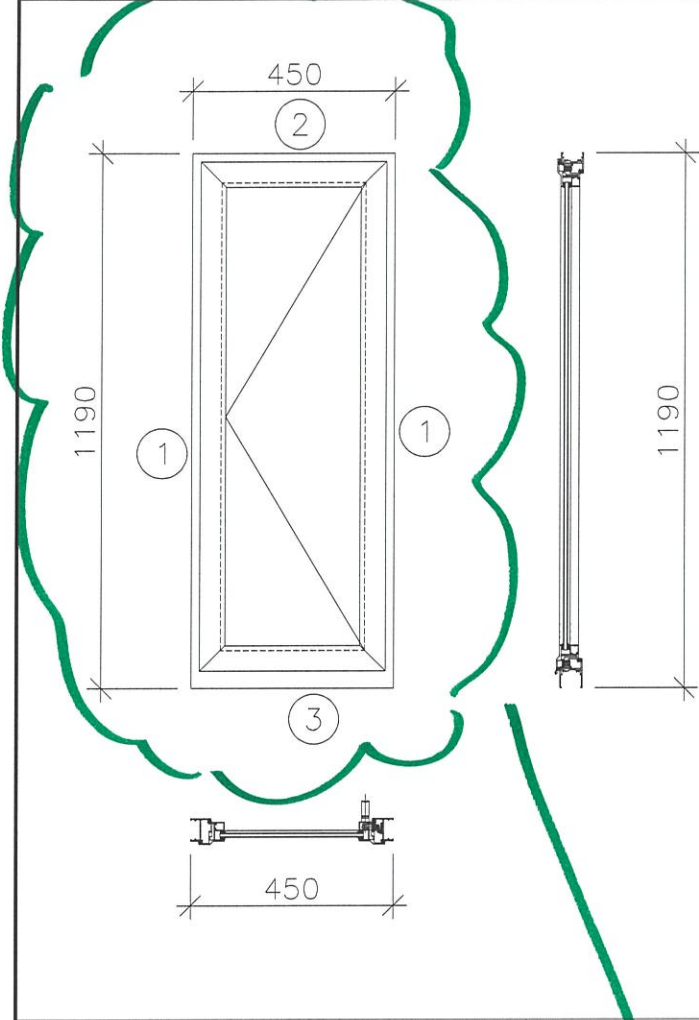

- 注:
- (1) 玻璃線橫碰企。
 - (2) 生窗底料需開長方形去水孔
 - (3) 窗玉搭位7mm
 - (4) 滴水線比窗玉每頭長1mm。
 - (5) S.H窗需裝窗拈1隻/玉。
 - (6) SH窗需裝2組扣碼。
 - (7) SH窗用立興配件, 鎖3點
 - (8) 水線孔在兩邊企料底。

序號	料號	名稱	出苟	長度 (mm)	支/幅	加工說明
1	X86010	50生邊企		1190.0	2	X86010-S11L/P
2	X86012	50生頂橫	避位	414.0	1	X86012-S13L
3	X86013	50生底橫	避位	404.0	1	X86013-S13L

加工細則				
頂留		/		mm
底留		/		mm
企料底部開避位				mm
底橫料防水巴鋸去				mm
水線孔在企料-----	頂		底	
安裝扣碼	NBSF(窗框)/NBSS(窗玉)			
多點鎖芯型號:	平收單向傳動器(立興)			
手柄型號:	MLDFOB-18 手柄(立興)			
扇撐型號:	HHMS 不鏽鋼扇撐(立興)			
T窗最大的開度:				
窗玉搭位數:	7mm			
窗款	寬度	高度	隻/幅	撐長
50SHL窗	412.0	1132.0	1	12"

窗玉用料						
序號	料號	名稱	出苟	長度 (mm)	支/幅	加工說明
1	X86011	窗玉企	45°斜口	1132.0	2	X86011-SHL11-1/2
2	X86011	窗玉橫	45°斜口	412.0	2	X86011-SHL13-T1/2
3	X86017	玉坡線企/手柄	直口/避位	1056.5	1	X86017-S11L
4	X86017	窗玉玻璃線企	直口	1056.5	1	直口開料
5	X86017	窗玉玻璃線橫	直口	300.0	2	直口開料

大圖版次	本圖版	日期	位置	幅數	樓層
1	AW-06a	450	1190	T1-SIM. 1B UTI	1 46/F
圖號	AW-06a				

AW06a 加工圖

↓
(到) 送 T2