

B.D. REF :

CLIENT :  
 信和置業有限公司  
 Sino Land Company Limited

ARCHITECT :  
 ronald lu & partners  
 Architects, Planners, Interior Designers  
 Ronald Lu & Partners (HK) Ltd.  
 呂元祥建築師事務所 (香港) 有限公司  
 MAIN CONTRACTOR :

Gammon  
 STRUCTURAL ENGINEER :  
 AECOM  
 FACADE CONSULTANT:  
 AECOM

NOTE :  
 1. ALL DIMENSIONS ARE IN mm.  
 2. ALL ELEVATIONS ARE VIEWED FROM OUTSIDE.  
 3. ALL DIMENSIONS TO BE VERIFIED ON SITE BEFORE FABRICATE

LEGEND:  
 --- DETAIL MARK NO.  
 (K001) --- REFER SHEET NO.

1. F.F.L. --- FINISHED FLOOR LEVEL  
 2. S.F.L. --- STRUCTURAL FLOOR LEVEL  
 3. (P) --- REVERSED DETAIL

NO.	DATE	REVISED	BY
C	23/02/22	REVISED AS PER COMMENTS	LS
B	20/12/21	REVISED AS PER COMMENTS	LS
A	03/12/21	REVISED AS PER COMMENTS	LS

JOB NO. : J-858  
 PROJECT :  
 PROPOSED RESIDENTIAL DEVELOPMENT  
 AT TKOTL 70RP, PHASE 11, LOHAS PARK  
 TSEUNG KWAN O, N.T.

TITLE :  
 TYPICAL FLOOR PLAN  
 AT TOWER 1

DATE : 22-OCT-21 SCALE : 1:75(A1)  
 DRAWN BY : KY CHECKED BY : YB

美特鋁質有限公司  
 MIDI ALUMINUM FABRICATOR LTD.  
 Units 6-8, Sunray Industrial Centre, 1/F  
 610 Cha Kwo Ling Road, Kowloon  
 Tel:23489211-4 Fax:(852)2727666

DWG NO. : J858-CW-LP101 REV. : C

位置	單元件數	合共	Glass Cladding 件數
1 T1A CW2	7		4
2 T1A CW1	3		
3 T1B CW1	3	13	
4 T1B CW2	1		
5 T1B CW3	4		
6 T1B CW4	6	11	
7 T1B CW5	1		
8 T1A CW6	5		
9 T1A CW5	4	10	
10 T1A CW4	5		4
11 T1A CW3	5	10	
		44	

1 9/F~10/F, 12/F~39/F, 41/F~61/F  
 LAYOUT PLAN FOR TOWER 1(1:75)  
 (13/F, 14/F, 24/F, 34/F, 44/F, 54/F FLOORS OMITTED)

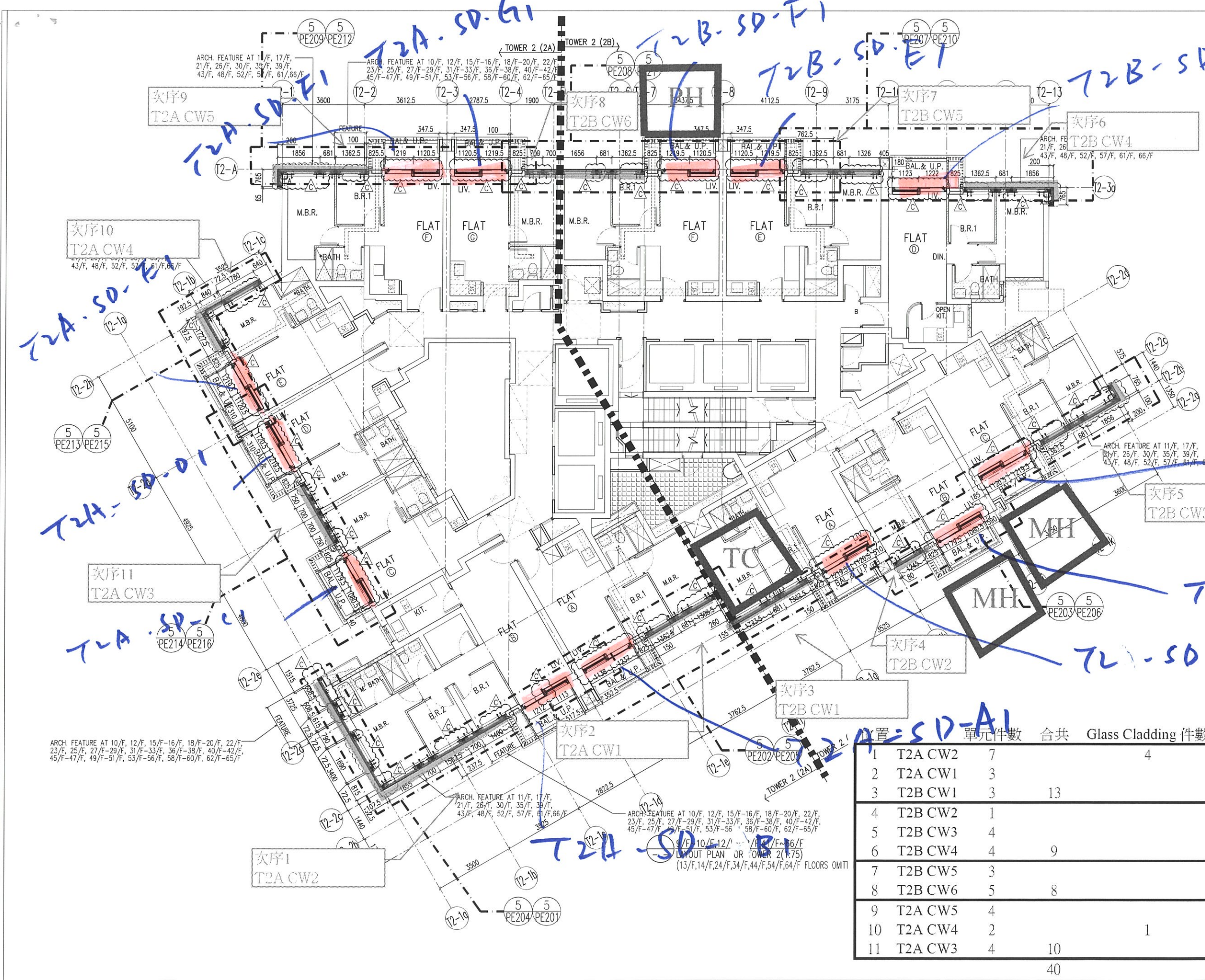

B.D. REF :  
 CLIENT :  
 信和置業有限公司  
 Sino Land Company Limited

ARCHITECT :  
 ronald lu & partners  
 Architects, Planners, Interior Designers  
 Ronald Lu & Partners (HK) Ltd.  
 呂元祥建築師事務所 (香港) 有限公司

MAIN CONTRACTOR :  
 Gammon  
 STRUCTURAL ENGINEER :  
 AECOM

FACADE CONSULTANT :  
 AECOM  
 NOTE:  
 1. ALL DIMENSIONS ARE IN mm.  
 2. ALL ELEVATIONS ARE VIEWED FROM OUTSIDE.  
 3. TO BE VERIFIED ON SITE.

XT -- DETAIL MARK NO.  
 X001 -- REFER SHEET NO.  
 1. F.F.L. -- FINISHED FLOOR LEVEL  
 2. S.F.L. -- STRUCTURAL FLOOR LEVEL  
 3. /R -- REVERSED DETAIL

NO.	DATE	REVISED	BY
C	23/02/22	REVISED AS PER COMMENTS	LS
B	20/12/21	REVISED AS PER COMMENTS	LS
A	03/12/21	REVISED AS PER COMMENTS	LS

JOB NO. : J-858  
 PROJECT :  
 PROPOSED RESIDENTIAL DEVELOPMENT  
 AT TKOIL 70RP, PHASE 11, LOHAS PARK  
 TSEUNG KWAN O, N.T.

TITLE :  
 TYPICAL FLOOR PLAN  
 AT TOWER 2

DATE : 22-OCT-21 SCALE : 1:75(A1)  
 DRAWN BY : KY CHECKED BY : YB

美特鋁質有限公司  
 MIDI ALUMINIUM FABRICATOR LTD.  
 Units 6-8, Sunray Industrial Centre, 1/F  
 610 Cho Kwo Ling Road, Kowloon  
 Tel:23489211-4 Fax:(852)2727666  
 DWG NO. : J858-CW-LP201 REV. : C

單位件數 合共 Glass Cladding 件數

1	T2A CW2	7	4
2	T2A CW1	3	
3	T2B CW1	3	13
4	T2B CW2	1	
5	T2B CW3	4	
6	T2B CW4	4	9
7	T2B CW5	3	
8	T2B CW6	5	8
9	T2A CW5	4	
10	T2A CW4	2	10
11	T2A CW3	4	40

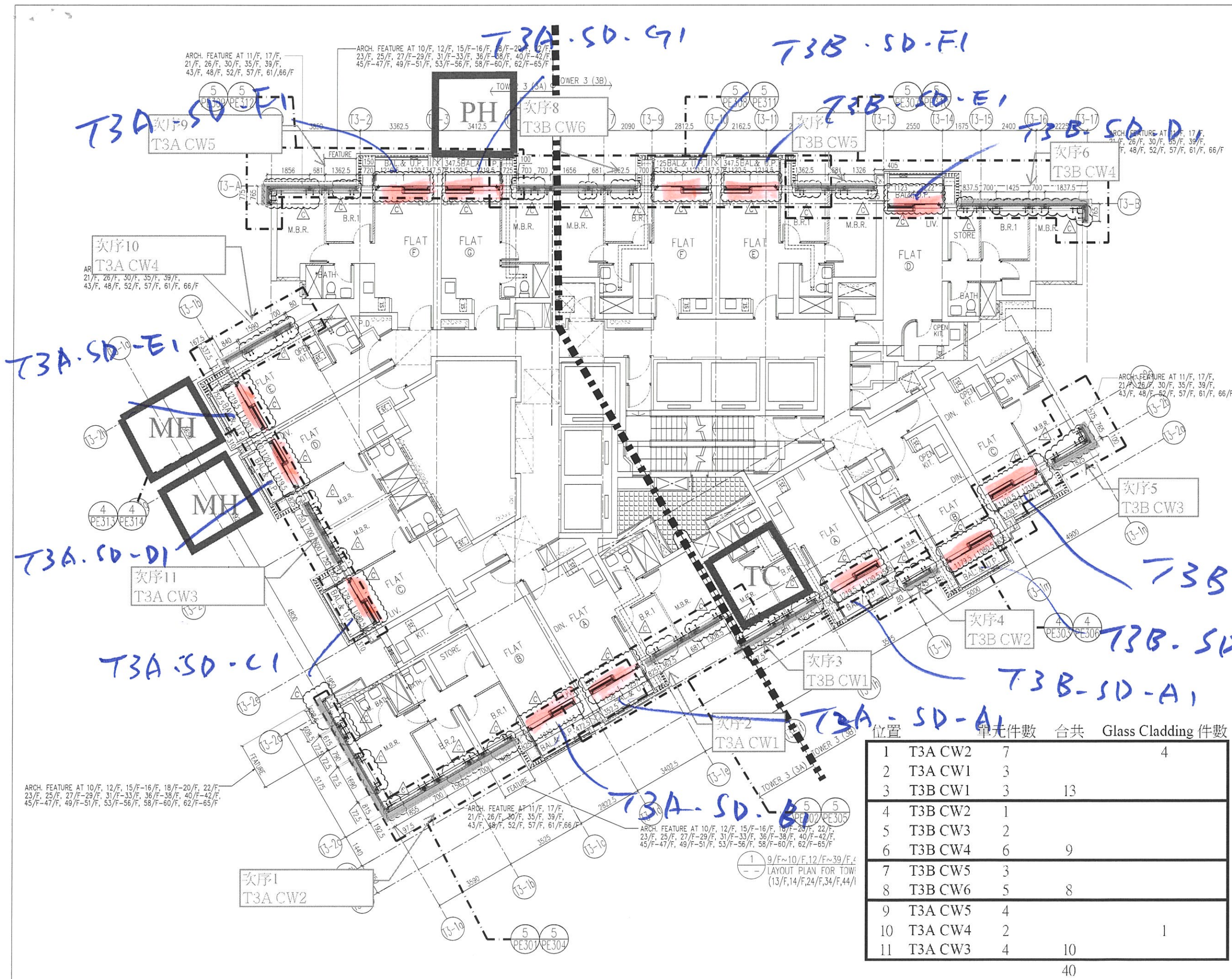

位置	單位件數	合共	Glass Cladding 件數
1 T3A CW2	7		4
2 T3A CW1	3		
3 T3B CW1	3	13	
4 T3B CW2	1		
5 T3B CW3	2		
6 T3B CW4	6	9	
7 T3B CW5	3		
8 T3B CW6	5	8	
9 T3A CW5	4		
10 T3A CW4	2		1
11 T3A CW3	4	10	
		40	

B.D. REF :

---

CLIENT :  
 信和置業有限公司  
 Sino Land Company Limited

---

ARCHITECT :  
 ronald lu & partners  
 Architects, Planners, Interior Designers  
 Ronald Lu & Partners (HK) Ltd.  
 呂元祥建築師事務所 (香港) 有限公司

---

MAIN CONTRACTOR :  
 Gammon

---

STRUCTURAL ENGINEER :  
 AECOM

---

FAÇADE CONSULTANT:  
 AECOM

---

NOTE :  
 1. ALL DIMENSIONS ARE IN mm.  
 2. ALL ELEVATIONS ARE VIEWED FROM OUTSIDE.  
 3. ALL DIMENSIONS TO BE VERIFIED ON SITE BEFORE FABRICATION.

LEGEND :  
 X1 --- DETAIL MARK NO.  
 X001 --- REFER SHEET NO.

1. F.F.L. --- FINISHED FLOOR LEVEL  
 2. S.F.L. --- STRUCTURAL FLOOR LEVEL  
 3. --- REVERSED DETAIL

---

C	23/02/22	REVISED AS PER COMMENTS	LS
B	20/12/21	REVISED AS PER COMMENTS	LS
A	03/12/21	REVISED AS PER COMMENTS	LS

---

NO.	DATE	REVISED	BY
-----	------	---------	----

---

JOB NO. : J-858

PROJECT :  
 PROPOSED RESIDENTIAL DEVELOPMENT  
 AT TKOTL 70RP, PHASE 11, LOHAS PARK  
 TSEUNG KWAN O, N.T.

---

TITLE :  
 TYPICAL FLOOR PLAN  
 AT TOWER 3

---

DATE : 22-OCT-21      SCALE : 1:75(A1)

DRAWN BY : KY      CHECKED BY : YB

---

美特鋁質有限公司  
 MIDI ALUMINIUM FABRICATOR LTD.  
 Units 6-8, Sunray Industrial Centre, 1/F  
 610 Cha Kwo Ling Road, Kowloon  
 Tel: 23489211-4 Fax: (852) 2727666

---

DWG NO. : J858-CW-LP301      REV. : C