



工程指示 / 要求簡箋(E.I.)

工程指示編號：EI/4517 / 22

修改版次：

工程編號：J-853

工程名稱：大窩坪(廷坪路)

工程項目：幕牆(T6)背板 2mm 厚鋁板 (廠用) 大貨

收件人：生統

發件人：大明

日期：28/03/2022

要求提供 / 確認 事項：

- | | | |
|------------------------------------|-------------------------------------|-------------------------------|
| <input type="checkbox"/> 初步鋁料 B.M. | <input type="checkbox"/> 加工拆圖，然後生產 | <input type="checkbox"/> 尺寸表 |
| <input type="checkbox"/> 正式鋁料 B.M. | <input type="checkbox"/> 技術上資料 / 指示 | <input type="checkbox"/> 報 |
| <input type="checkbox"/> 配件 B.M. | <input type="checkbox"/> 樣辦或貨品說明書 | <input type="checkbox"/> 分判合約 |
| <input type="checkbox"/> 其他：_____ | | |

內容：

煩請依附件資料生產 幕牆(T6)鋁板

5/F ~ 16/F 先造第一批

17/F ~ 26/F 第二批

請在 12/05/2022 前完成上列要求。

附有關圖紙 / 文件：附 B.M 表 2 頁, 圖紙 5 頁

以上項目為:

- 原合約工程包 原合約工程加 / 減賬 新工程報價

原因：-

分發東莞各部門：

- () 生產技術總監 連附件 () 技術部 連附件 () 生產部 連附件 () 機械設計部 連附件
 () 採購部 連附件 (✓) 生產統籌部 連附件 **指**
 () 質檢部 連附件 () 會計部 連附件 () 報關組 連附件 () 其他 _____ 連附件

分發香港各部門：

- () 行政部 連附件 () 會計部 連附件 () 統籌部 連附件 () 工程部地盤科文 連附件
 () 採購部 連附件 () QS 部 連附件 () 維修部 連附件 () 其他 _____ 連附件 **謝永村**

傳遞編號：HK 0503

發件人簽署：

項目經理簽署：

FTP

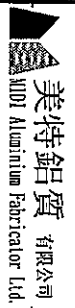

美特鋁質 有限公司
MTP Aluminium Fabricator Ltd.

工程號:	J-853	計算:	陳敏聰	日期:	2022.03.21	送呈:	胡哥
地盤名稱:	延坪道住宅	核對:	謝永林	日期:	2022.03.25	副本:	
廠用鋁背板B.M.表	項目類別: T6座簷牆背板	批准:		日期:		A/C Code:	
修改版本:		總V.F.:	257.66	總重量:	1824.30		

序號	修改內容	鋁板圖號	鋁板名稱	顏色	實用	後備	總數	總重量	單件展開面積m ²	總展開面積m ²	單件V.F. m ²	總V.F. m ²	位置	樓層	類型
1		DBP-6	2mm厚鋁板	UCT542049SC-3(淺灰)	18		18	57.92	0.59	10.69	0.42	7.59	J853-SD-CW-4601	5/F-25/F	標準層
2		DBP-6	2mm厚鋁板	UCT542049SC-3(淺灰)	18		18	57.92	0.59	10.69	0.42	7.59	J853-SD-CW-4602A	5/F-25/F	標準層
3		DBP-6	2mm厚鋁板	UCT542049SC-3(淺灰)	26		26	83.67	0.59	15.44	0.42	10.97	J853-SD-CW-4606	10/F-25/F	標準層
4		DBP-6	2mm厚鋁板	UCT542049SC-3(淺灰)	13		13	41.83	0.59	7.72	0.42	5.48	J853-SD-CW-4607	10/F-25/F	標準層
5		DBP-10	2mm厚鋁板	UCT542049SC-3(淺灰)	18		18	62.57	0.64	11.54	0.46	8.34	J853-SD-CW-4601	5/F-25/F	標準層
6		DBP-10	2mm厚鋁板	UCT542049SC-3(淺灰)	18		18	62.57	0.64	11.54	0.46	8.34	J853-SD-CW-4602A	5/F-25/F	標準層
7		DBP-19	2mm厚鋁板	UCT542049SC-3(淺灰)	18		18	61.87	0.63	11.42	0.46	8.23	J853-SD-CW-4602	5/F-25/F	標準層
8		DBP-19	2mm厚鋁板	UCT542049SC-3(淺灰)	18		18	61.87	0.63	11.42	0.46	8.23	J853-SD-CW-4602	5/F-25/F	標準層
9		DBP-21	2mm厚鋁板	UCT542049SC-3(淺灰)	18		18	99.70	1.02	18.39	0.80	14.34	J853-SD-CW-4602	5/F-25/F	標準層
10		DBP-21	2mm厚鋁板	UCT542049SC-3(淺灰)	18		18	99.70	1.02	18.39	0.80	14.34	J853-SD-CW-4602	5/F-25/F	標準層
11		DBP-50	2mm厚鋁板	UCT542049SC-3(淺灰)	13		13	82.06	1.16	15.14	0.92	11.98	J853-SD-CW-4606	10/F-25/F	標準層
12		DBP-50	2mm厚鋁板	UCT542049SC-3(淺灰)	13		13	82.06	1.16	15.14	0.92	11.98	J853-SD-CW-4607	10/F-25/F	標準層
13		DBP-601	2mm厚鋁板	UCT542049SC-3(淺灰)	18		18	106.66	1.09	19.68	0.86	15.47	J853-SD-CW-4601	5/F-25/F	標準層
14		DBP-602	2mm厚鋁板	UCT542049SC-3(淺灰)	18		18	102.02	1.05	18.82	0.82	14.72	J853-SD-CW-4601	5/F-25/F	標準層
15		DBP-603	2mm厚鋁板	UCT542049SC-3(淺灰)	18		18	134.74	1.38	24.86	1.11	20.01	J853-SD-CW-4602	5/F-25/F	標準層
16		DBP-604	2mm厚鋁板	UCT542049SC-3(淺灰)	18		18	134.74	1.38	24.86	1.11	20.01	J853-SD-CW-4602	5/F-25/F	標準層
17		DBP-605	2mm厚鋁板	UCT542049SC-3(淺灰)	18		18	114.78	1.18	21.18	0.93	16.78	J853-SD-CW-4602A	5/F-25/F	標準層
18		DBP-606	2mm厚鋁板	UCT542049SC-3(淺灰)	18		18	107.82	1.11	19.89	0.87	15.66	J853-SD-CW-4602A	5/F-25/F	標準層
19		DBP-613	2mm厚鋁板	UCT542049SC-3(淺灰)	13		13	81.22	1.15	14.99	0.91	11.85	J853-SD-CW-4606	10/F-25/F	標準層
20		DBP-614	2mm厚鋁板	UCT542049SC-3(淺灰)	13		13	82.90	1.18	15.29	0.93	12.12	J853-SD-CW-4606	10/F-25/F	標準層
21		DBP-615	2mm厚鋁板	UCT542049SC-3(淺灰)	13		13	50.21	0.71	9.26	0.53	6.84	J853-SD-CW-4607	10/F-25/F	標準層
22		DBP-6a	2mm厚鋁板	UCT542049SC-3(淺灰)	1		1	1.64	0.30	0.30	0.19	0.19	J853-SD-CW-4601	26/F	特式層
23		DBP-6a	2mm厚鋁板	UCT542049SC-3(淺灰)	1		1	1.64	0.30	0.30	0.19	0.19	J853-SD-CW-4602A	26/F	特式層
24		DBP-6a	2mm厚鋁板	UCT542049SC-3(淺灰)	2		2	3.27	0.30	0.60	0.19	0.37	J853-SD-CW-4606	26/F	特式層
25		DBP-6a	2mm厚鋁板	UCT542049SC-3(淺灰)	1		1	1.64	0.30	0.30	0.19	0.19	J853-SD-CW-4607	26/F	特式層
26		DBP-10a	2mm厚鋁板	UCT542049SC-3(淺灰)	1		1	1.77	0.33	0.33	0.20	0.20	J853-SD-CW-4601	26/F	特式層
27		DBP-10a	2mm厚鋁板	UCT542049SC-3(淺灰)	1		1	1.77	0.33	0.33	0.20	0.20	J853-SD-CW-4602A	26/F	特式層

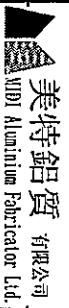

美特鋁質有限公司 Mei Te Aluminum Fabricator Ltd.	工程號: J 853	計算: 陳敏聰	日期: 2022.03.21	送呈: 胡哥
廠用鋁背板B.M.表	地盤名稱: 延坪道住宅	核對: 謝永林	日期: 2022.03.25	副本:
	項目類別: T6墜簾牆背板	批准:	日期:	A/C Code:
	修改版文:	總V.F.:	257.66	總重量:
			1824.30	

序號	修改內容	鋁板圖號	鋁板名稱	顏色	實用	後備	總數	總重量	單件展開面積m ²	總展開面積m ²	單件V.F. m ²	總V.F. m ²	位置	樓層	類型
28		DBP-19a	2mm厚鋁板	UCT542049SC-3(淺灰)	1		1	1.75	0.32	0.32	0.20	0.20	J853-SD-CW-4602	26/F	特式層
29		DBP-19a	2mm厚鋁板	UCT542049SC-3(淺灰)	1		1	1.75	0.32	0.32	0.20	0.20	J853-SD-CW-4602	26/F	特式層
30		DBP-21a	2mm厚鋁板	UCT542049SC-3(淺灰)	1		1	2.82	0.52	0.52	0.35	0.35	J853-SD-CW-4602	26/F	特式層
31		DBP-21a	2mm厚鋁板	UCT542049SC-3(淺灰)	1		1	2.82	0.52	0.52	0.35	0.35	J853-SD-CW-4602	26/F	特式層
32		DBP-50a	2mm厚鋁板	UCT542049SC-3(淺灰)	1		1	3.21	0.59	0.59	0.40	0.40	J853-SD-CW-4606	26/F	特式層
33		DBP-50a	2mm厚鋁板	UCT542049SC-3(淺灰)	1		1	3.21	0.59	0.59	0.40	0.40	J853-SD-CW-4607	26/F	特式層
34		DBP-601a	2mm厚鋁板	UCT542049SC-3(淺灰)	1		1	3.01	0.56	0.56	0.38	0.38	J853-SD-CW-4601	26/F	特式層
35		DBP-602a	2mm厚鋁板	UCT542049SC-3(淺灰)	1		1	2.88	0.53	0.53	0.36	0.36	J853-SD-CW-4601	26/F	特式層
36		DBP-603a	2mm厚鋁板	UCT542049SC-3(淺灰)	1		1	3.81	0.70	0.70	0.49	0.49	J853-SD-CW-4602	26/F	特式層
37		DBP-604a	2mm厚鋁板	UCT542049SC-3(淺灰)	1		1	3.81	0.70	0.70	0.49	0.49	J853-SD-CW-4602	26/F	特式層
38		DBP-605a	2mm厚鋁板	UCT542049SC-3(淺灰)	1		1	3.24	0.60	0.60	0.41	0.41	J853-SD-CW-4602A	26/F	特式層
39		DBP-606a	2mm厚鋁板	UCT542049SC-3(淺灰)	1		1	3.05	0.56	0.56	0.38	0.38	J853-SD-CW-4602A	26/F	特式層
40		DBP-613a	2mm厚鋁板	UCT542049SC-3(淺灰)	1		1	3.18	0.59	0.59	0.40	0.40	J853-SD-CW-4606	26/F	特式層
41		DBP-614a	2mm厚鋁板	UCT542049SC-3(淺灰)	1		1	3.24	0.60	0.60	0.41	0.41	J853-SD-CW-4606	26/F	特式層
42		DBP-615a	2mm厚鋁板	UCT542049SC-3(淺灰)	1		1	1.96	0.36	0.36	0.23	0.23	J853-SD-CW-4607	26/F	特式層
統計:					378		378	1824.30		336.59		257.66			

圖則登記表 DRAWING REGISTER									
工程名稱 Project Title:		延坪道住宅 大貨(T6座)幕牆背板		接收日期 Receiving Date (適用於客戶圖則)					
工程編號 Project No:		J-853		年					
分發予 Distributed To				月					
				日					
				年	22				
				月	3				
				日	26				
圖則編號 Drg. No.	圖則名稱 Drawing Title	修訂編號 Revision No.							
DBP-06	背板-拆圖	1	-						
DBP-6SJ	背板-拆圖尺寸數據	2	-						
DBP-06a	背板-拆圖	3	-						
DBP-6aSJ	背板-拆圖尺寸數據	4	-						
J853-SD-CW-4601	位置圖	5	-						
J853-SD-CW-4602	位置圖	6	-						
J853-SD-CW-4602A	位置圖	7	-						
J853-SD-CW-4606	位置圖	8	-						
J853-SD-CW-4607	位置圖	9	-						

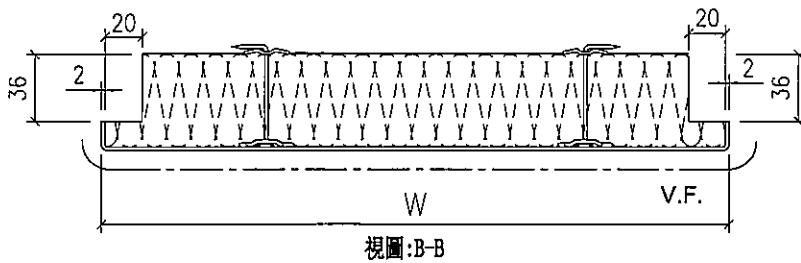
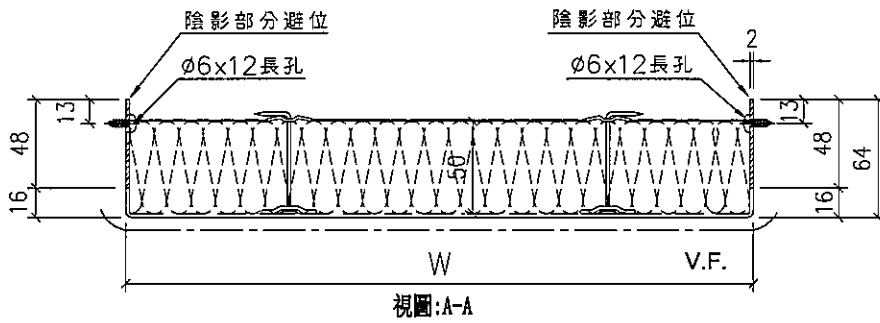
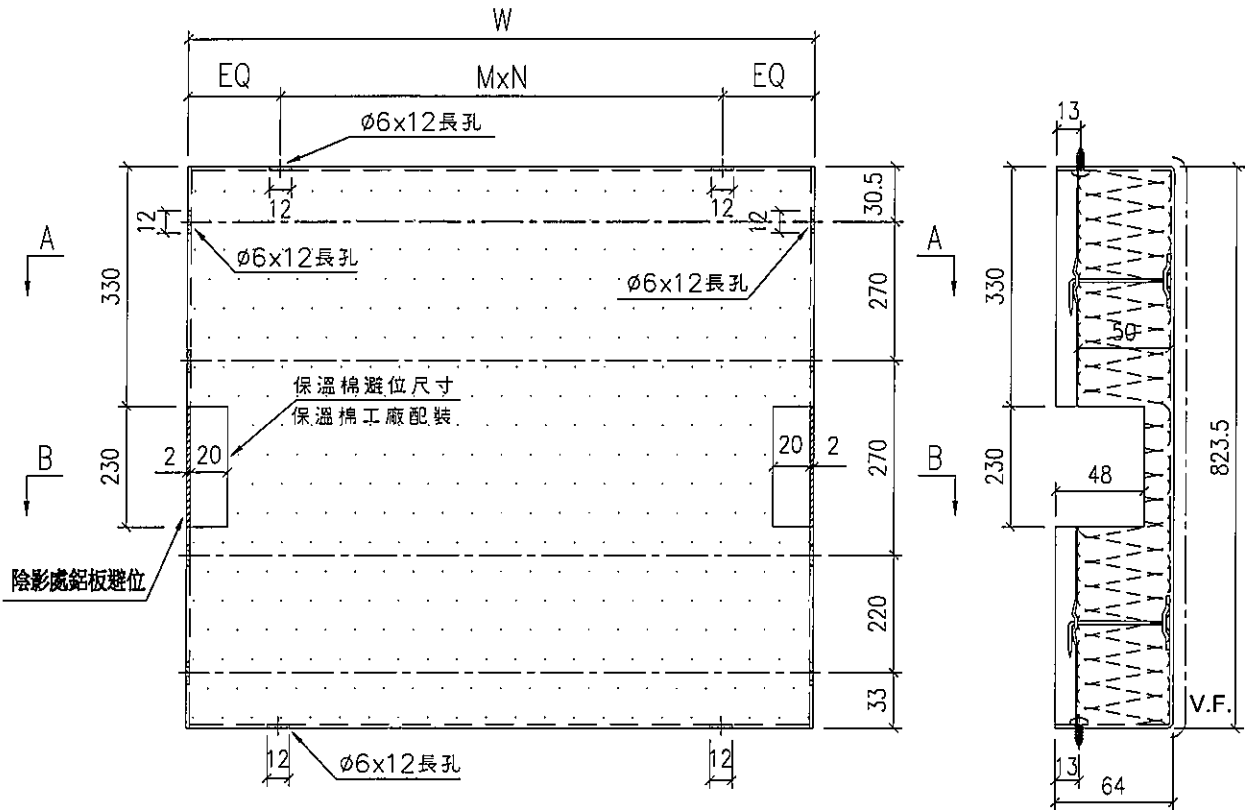

室外

名稱	背板拆圖	制圖	陳敏聰	2022.03.21	修改		
材料	2mm 鋁板	復核	謝永林	2022.03.26	日期		
顏色	UCT542049SC-3(淺灰)	批准	Daniel		圖號	DBP-06	✓

EG-DWG3



美特鋁質有限公司
MIDI Aluminium Fabricator Ltd.

工程號 J-853 地盤 延坪道住宅

序號	物料編號	W	數量	EQ	M	X	N	位置	分格尺寸	樓層	樓層數	每層數量	備註
1	DBP-6	496.0	18	98.0	300	x	1	T6-CW-4601	600	5/F-25/F	18	1	
2		496.0	18	98.0	300	x	1	T6-CW-4602A	600	5/F-25/F	18	1	
3		496.0	26	98.0	300	x	1	T6-CW-4606	600	10/F-25/F	13	2	
4		496.0	13	98.0	300	x	1	T6-CW-4607	600	10/F-25/F	13	1	
5	DBP-10	546.0	18	73.0	200	x	2	T6-CW-4601	650	5/F-25/F	18	1	
6		546.0	18	73.0	200	x	2	T6-CW-4602A	650	5/F-25/F	18	1	
7	DBP-19	538.5	18	69.3	200	x	2	T6-CW-4602	642.5	5/F-25/F	18	1	
8		538.5	18	69.3	200	x	2	T6-CW-4602	642.5	5/F-25/F	18	1	
9	DBP-21	946.0	18	98.0	250	x	3	T6-CW-4602	1050	5/F-25/F	18	1	
10		946.0	18	98.0	250	x	3	T6-CW-4602	1050	5/F-25/F	18	1	
11	DBP-50	1096.0	13	98.0	300	x	3	T6-CW-4606	1200	10/F-25/F	13	1	
12		1096.0	13	98.0	300	x	3	T6-CW-4607	1200	10/F-25/F	13	1	
13	DBP-601	1021.0	18	60.5	300	x	3	T6-CW-4601	1125	5/F-25/F	18	1	
14	DBP-602	971.0	18	110.5	250	x	3	T6-CW-4601	1075	5/F-25/F	18	1	
15	DBP-603	1323.5	18	61.8	300	x	4	T6-CW-4602	1427.5	5/F-25/F	18	1	
16	DBP-604	1323.5	18	61.8	300	x	4	T6-CW-4602	1427.5	5/F-25/F	18	1	
17	DBP-605	1108.5	18	104.3	300	x	3	T6-CW-4602A	1212.5	5/F-25/F	18	1	
18	DBP-606	1033.5	18	66.8	300	x	3	T6-CW-4602A	1137.5	5/F-25/F	18	1	
19	DBP-613	1083.5	13	91.8	300	x	3	T6-CW-4606	1187.5	10/F-25/F	13	1	
20	DBP-614	1108.5	13	104.3	300	x	3	T6-CW-4606	1212.5	10/F-25/F	13	1	
21	DBP-615	621.0	13	60.5	250	x	2	T6-CW-4607	725.0	10/F-25/F	13	1	
		總數:	356										

名稱	背板拆圖	制圖	陳敏聰	2022.03.21	修改		
材料	2mm鋁板	復核	謝永林	2022.03.26	日期		
顏色	UCT542049SC-3(淺灰)	批准	Daniel		圖號	DBP-6SJ	

工程號 J-853 地盤 延坪道住宅

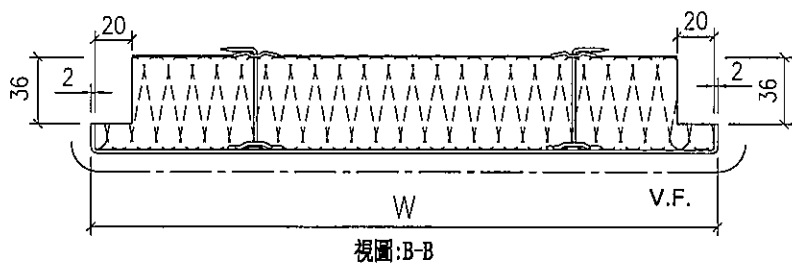
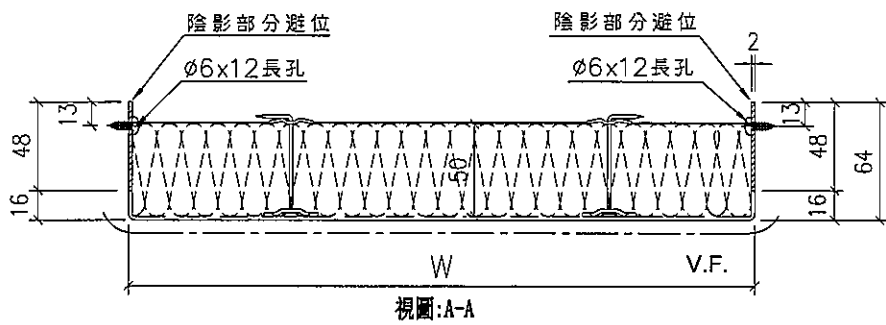
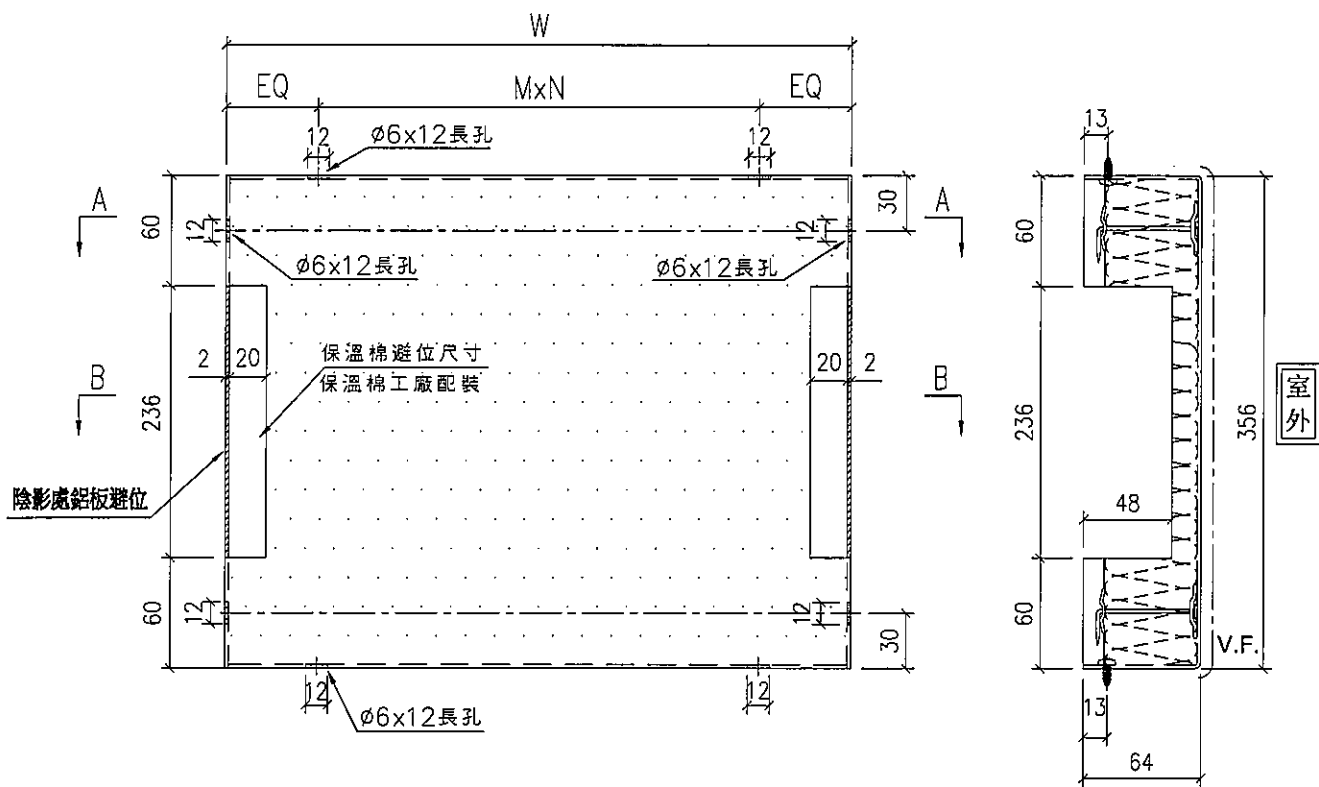

名稱	背板拆圖	制圖	陳敏聰	2022.03.26	修改		
材料	2mm 鋁板	復核	謝永林	2022.03.26	日期		
顏色	UCT542049SC-3(淺灰)	批准	Daniel		圖號	DBP-06a	

EG-DWG3



美特鋁質有限公司
MIDI Aluminium Fabricator Ltd.

工程號 J-853 地盤 延坪道住宅

序號	物料編號	W	數量	EQ	M	X	N	位置	分格尺寸	樓層	樓層數	每層數量	備註
1	DBP-6a	496.0	1	98.0	300	x	1	T6-CW-4601	600	26/F	1	1	
2		496.0	1	98.0	300	x	1	T6-CW-4602A	600	26/F	1	1	
3		496.0	2	98.0	300	x	1	T6-CW-4606	600	26/F	1	2	
4		496.0	1	98.0	300	x	1	T6-CW-4607	600	26/F	1	1	
5	DBP-10a	546.0	1	73.0	200	x	2	T6-CW-4601	650	26/F	1	1	
6		546.0	1	73.0	200	x	2	T6-CW-4602A	650	26/F	1	1	
7	DBP-19a	538.5	1	69.3	200	x	2	T6-CW-4602	642.5	26/F	1	1	
8		538.5	1	69.3	200	x	2	T6-CW-4602	642.5	26/F	1	1	
9	DBP-21a	946.0	1	98.0	250	x	3	T6-CW-4602	1050	26/F	1	1	
10		946.0	1	98.0	250	x	3	T6-CW-4602	1050	26/F	1	1	
11	DBP-50a	1096.0	1	98.0	300	x	3	T6-CW-4606	1200	26/F	1	1	
12		1096.0	1	98.0	300	x	3	T6-CW-4607	1200	26/F	1	1	
13	DBP-601a	1021.0	1	60.5	300	x	3	T6-CW-4601	1125	26/F	1	1	
14	DBP-602a	971.0	1	110.5	250	x	3	T6-CW-4601	1075	26/F	1	1	
15	DBP-603a	1323.5	1	61.8	300	x	4	T6-CW-4602	1427.5	26/F	1	1	
16	DBP-604a	1323.5	1	61.8	300	x	4	T6-CW-4602	1427.5	26/F	1	1	
17	DBP-605a	1108.5	1	104.3	300	x	3	T6-CW-4602A	1212.5	26/F	1	1	
18	DBP-606a	1033.5	1	66.8	300	x	3	T6-CW-4602A	1137.5	26/F	1	1	
19	DBP-613a	1083.5	1	91.8	300	x	3	T6-CW-4606	1187.5	26/F	1	1	
20	DBP-614a	1108.5	1	104.3	300	x	3	T6-CW-4606	1212.5	26/F	1	1	
21	DBP-615a	621.0	1	60.5	250	x	2	T6-CW-4607	725.0	26/F	1	1	
總數:		22											

名稱	背板拆圖	制圖	陳敏聰	2022.03.26	修改		
材料	2mm鋁板	復核	謝永林	2022.03.26	日期		
顏色	UCT542049SC-3(淺灰)	批准	Daniel		圖號	DBP-6aSJ	

請用A3紙打印

DATE:

CLIENT:
SHIMAO GROUP
HOLDINGS LIMITED

PROJECT:
SHIMAO TOWER 2
HONG KONG

MAIN CONTRACTOR:
協興建築有限公司
HP HING CONSTRUCTION CO LTD

STRUCTURAL ENGINEER:
CMA
CM WONG & ASSOCIATES LTD
黃志明建築工程師有限公司

PROJECT CONSULTANT:
MENHARDT

NOTE:
1. ALL DIMENSIONS ARE IN mm.
2. ALL DIMENSIONS ARE VENDED FROM OUTSIDE.
3. ALL DIMENSIONS TO BE VENDED ON SITE.
4. ALL DIMENSIONS TO BE VENDED ON SITE.
5. ALL DIMENSIONS TO BE VENDED ON SITE.

1. DETAIL MARK NO.
2. REIN. SHEET NO.
3. F.F.L. - FINISHED FLOOR LEVEL.
4. S.F.L. - STRUCTURE FLOOR LEVEL.
5. I.R.S. - INVERTED ROOF LEVEL.

FLOOR LEVEL (S.F.L.)	LEVEL	AREA	PRICE
ROOF	+210.00	29.76	\$208,706
25/F	+203.40	22.76	\$200,000
22/F	+196.80	21.76	\$198,850
21/F	+190.20	20.76	\$193,700
20/F	+183.60	19.76	\$187,550
19/F	+177.00	18.76	\$181,400
18/F	+170.40	17.76	\$175,250
17/F	+163.80	16.76	\$169,100
16/F	+157.20	15.76	\$162,950
15/F	+150.60	14.76	\$156,800
14/F	+144.00	13.76	\$150,650
13/F	+137.40	12.76	\$144,500
12/F	+130.80	11.76	\$138,350
11/F	+124.20	10.76	\$132,200
10/F	+117.60	9.76	\$126,050
9/F	+111.00	8.76	\$119,900
8/F	+104.40	7.76	\$113,750
7/F	+97.80	6.76	\$107,600
6/F	+91.20	5.76	\$101,450

PROJECT: PROPOSED RESIDENTIAL DEVELOPMENT AT KALLI 6542 YIM PING ROAD HONGKONG

JOB NO.: J-853

DATE: 12-APR-21 SCALE: 1:50 (A1)

DRAWN BY: ULR

CHECKED BY:

TITLE: PART ELEVATION FOR CURTAIN WALL AT TOWER 2 & 7

SCALE: 1:50 (A1)

DATE: 12-APR-21

PROJECT CONSULTANT: MENHARDT

STRUCTURAL ENGINEER: CMA

MAIN CONTRACTOR: SHIMAO GROUP HOLDINGS LIMITED

CLIENT: SHIMAO GROUP HOLDINGS LIMITED

PROJECT: SHIMAO TOWER 2 HONG KONG

PROJECT CONSULTANT: MENHARDT

STRUCTURAL ENGINEER: CMA

MAIN CONTRACTOR: SHIMAO GROUP HOLDINGS LIMITED

CLIENT: SHIMAO GROUP HOLDINGS LIMITED

LEGEND:

- ① - Open hole strengthened glass (outer clear glass inner) + 12mm fire retardant clear glass (inner)
- ② - Open hole strengthened glass (outer clear glass inner) + 12mm fire retardant clear glass (inner) + 20mm fire retardant clear glass (inner)
- ③ - Open hole strengthened glass (outer clear glass inner) + 12mm fire retardant clear glass (inner) + 20mm fire retardant clear glass (inner) + 20mm fire retardant clear glass (inner)
- ④ - Open hole strengthened glass (outer clear glass inner) + 12mm fire retardant clear glass (inner) + 20mm fire retardant clear glass (inner) + 20mm fire retardant clear glass (inner) + 20mm fire retardant clear glass (inner)
- ⑤ - Open hole strengthened glass (outer clear glass inner) + 12mm fire retardant clear glass (inner) + 20mm fire retardant clear glass (inner) + 20mm fire retardant clear glass (inner) + 20mm fire retardant clear glass (inner) + 20mm fire retardant clear glass (inner)
- ⑥ - Open hole strengthened glass (outer clear glass inner) + 12mm fire retardant clear glass (inner) + 20mm fire retardant clear glass (inner) + 20mm fire retardant clear glass (inner) + 20mm fire retardant clear glass (inner) + 20mm fire retardant clear glass (inner) + 20mm fire retardant clear glass (inner)
- ⑦ - Open hole strengthened glass (outer clear glass inner) + 12mm fire retardant clear glass (inner) + 20mm fire retardant clear glass (inner) + 20mm fire retardant clear glass (inner) + 20mm fire retardant clear glass (inner) + 20mm fire retardant clear glass (inner) + 20mm fire retardant clear glass (inner) + 20mm fire retardant clear glass (inner)
- ⑧ - Open hole strengthened glass (outer clear glass inner) + 12mm fire retardant clear glass (inner) + 20mm fire retardant clear glass (inner) + 20mm fire retardant clear glass (inner) + 20mm fire retardant clear glass (inner) + 20mm fire retardant clear glass (inner) + 20mm fire retardant clear glass (inner) + 20mm fire retardant clear glass (inner) + 20mm fire retardant clear glass (inner)
- ⑨ - Open hole strengthened glass (outer clear glass inner) + 12mm fire retardant clear glass (inner) + 20mm fire retardant clear glass (inner) + 20mm fire retardant clear glass (inner) + 20mm fire retardant clear glass (inner) + 20mm fire retardant clear glass (inner) + 20mm fire retardant clear glass (inner) + 20mm fire retardant clear glass (inner) + 20mm fire retardant clear glass (inner) + 20mm fire retardant clear glass (inner)
- ⑩ - Open hole strengthened glass (outer clear glass inner) + 12mm fire retardant clear glass (inner) + 20mm fire retardant clear glass (inner) + 20mm fire retardant clear glass (inner) + 20mm fire retardant clear glass (inner) + 20mm fire retardant clear glass (inner) + 20mm fire retardant clear glass (inner) + 20mm fire retardant clear glass (inner) + 20mm fire retardant clear glass (inner) + 20mm fire retardant clear glass (inner) + 20mm fire retardant clear glass (inner)

① - STICK JOINT (WIND LOAD)

② - ALUM. EXTENSION OF NO.

③ - SUPPORT POINT (WIND LOAD + DEAD LOAD)

④ - SPECIAL POINT (WIND LOAD)

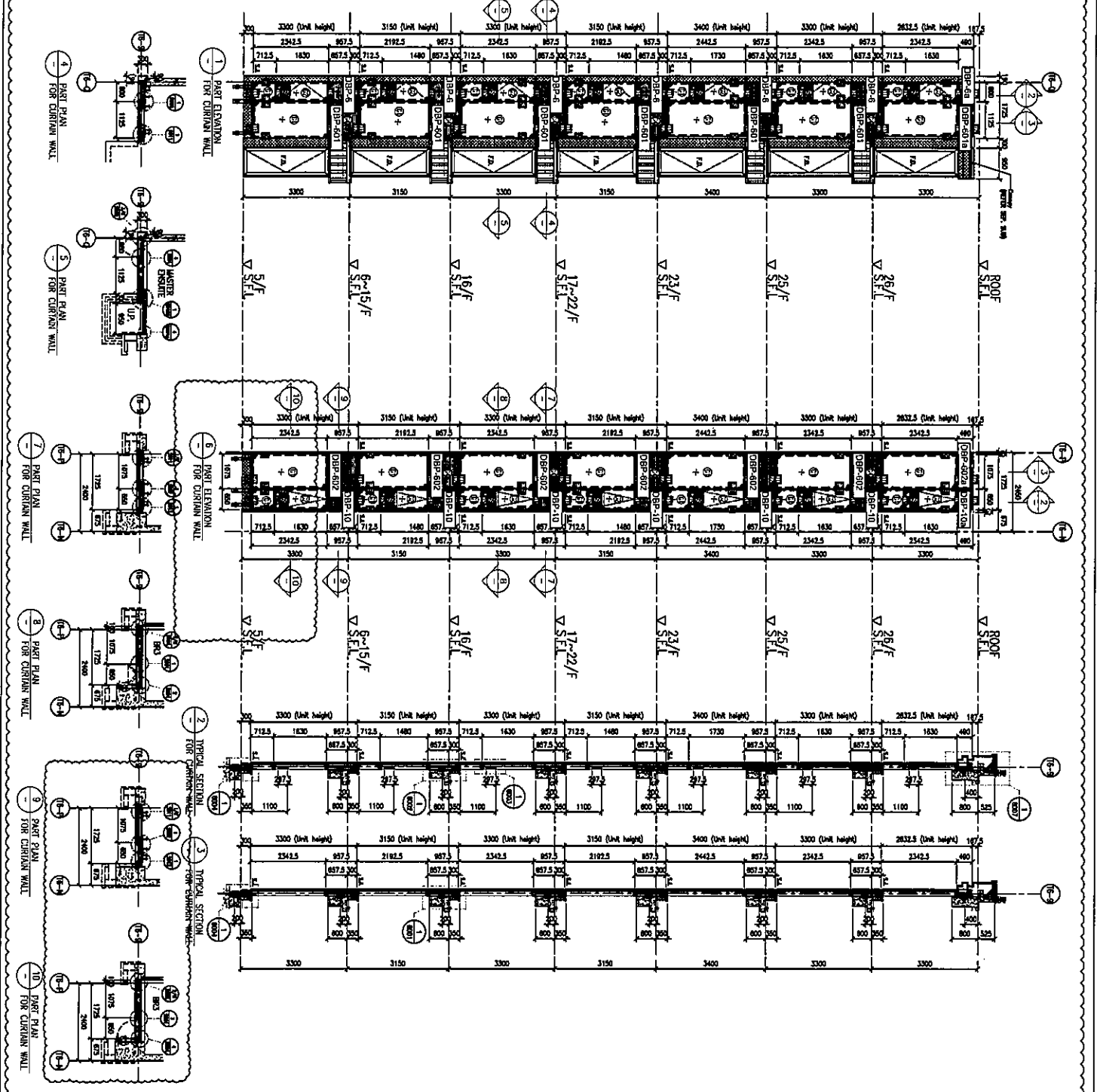

S.A. REF :
請用A3紙打印

CLIENT :
SHIMAD GROUP HOLDINGS LIMITED

PROJECT :
WY
WING TING & PARTNERS LIMITED

MAIN CONTRACTOR :
鴻興建築有限公司
HONG HING CONSTRUCTION CO LTD

STRUCTURAL ENGINEER :
C.M. WONG & ASSOCIATES LTD
黃志明建築工程師有限公司

ARCHITECT CONSULTANT :
MENYARD

NOTE :
1. ALL DIMENSIONS ARE IN MM.
2. ALL DIMENSIONS ARE TAKEN FROM CURSE.
3. ALL DIMENSIONS TO BE TAKEN ON SITE.
4. REFER FABRICATOR.
LEGEND:
(1) - DETAIL SHEET NO.
(2) - REFER SHEET NO.
1. F.F.L. - FINISHED FLOOR LEVEL
2. S.F.L. - STRUCTURAL FLOOR LEVEL
3. - REVERSED DETAIL

PROJECT :
PROPOSED RESIDENTIAL DEVELOPMENT AT P.A.K.I.L. 6542
VINH PHUNG ROAD, KOWLOON

TITLE :
PART ELEVATION FOR CURTAIN WALL AT TOWER 6 & 7

DATE : 12-APR-21 SCALE : 1:50 (A1)

DRAWN BY : LHR CHECKED BY :
JUN NO. : J-653

REV. NO. : J-653

REV. 1 : A

ARCHITECT :
WY
WING TING & PARTNERS LIMITED

STRUCTURAL ENGINEER :
C.M. WONG & ASSOCIATES LTD
黃志明建築工程師有限公司

ARCHITECT CONSULTANT :
MENYARD

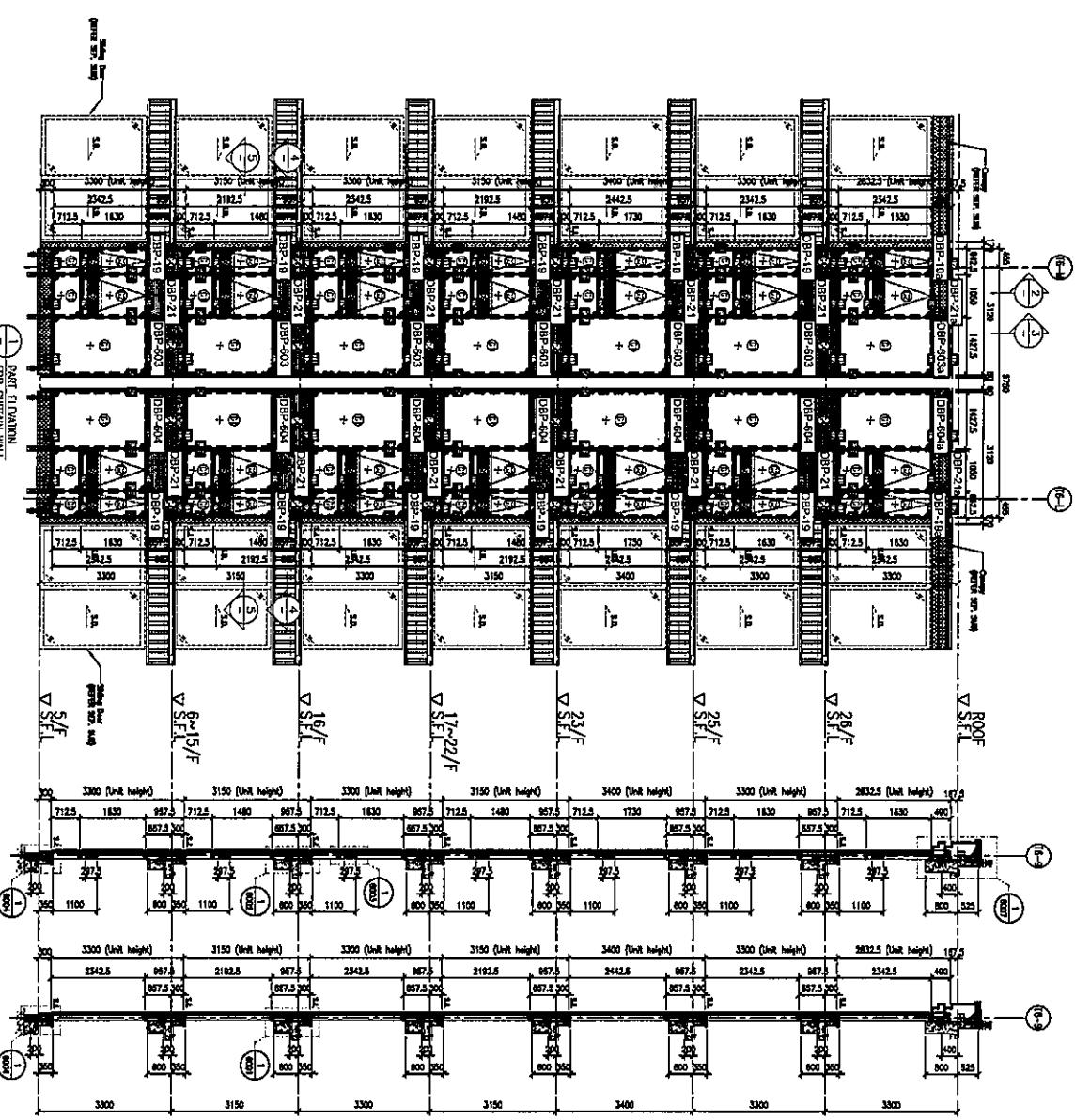

1 PART ELEVATION FOR CURTAIN WALL

2 TYPICAL SECTION FOR CURTAIN WALL

3 TYPICAL SECTION FOR CURTAIN WALL

4 PART PLAN FOR CURTAIN WALL

5 PART PLAN FOR CURTAIN WALL

FLOOR LEVEL (S.F.L.)	LEVEL
FLOOR	+0.00.00
ROOF	+200.00
20/F	+200.00
19/F	+190.00
18/F	+180.00
17/F	+170.00
16/F	+160.00
15/F	+150.00
14/F	+140.00
13/F	+130.00
12/F	+120.00
11/F	+110.00
10/F	+100.00
9/F	+90.00
8/F	+80.00
7/F	+70.00
6/F	+60.00
5/F	+50.00

LEGEND:
 1. Down view strengthened glass (OUTER CLEAR GLASS (INER) + 12mm THK. (PERFORATED) + 12mm AIR SPACE + 12mm THK. (PERFORATED) CLEAR GLASS (INER)
 2. When the heat strengthened glass & 2mm THK. ALUM. BACKING (SMALLER GLASS) (INTERNAL PROTECTIVE BARBER)
 3. When the ALUM. CLADDING
 4. STICK JOINT (WIND LOAD)
 5. ALUM. EXTENSION OF NO.
 6. SUPPORT POINT (WIND LOAD + DEAD LOAD)
 7. SUPPORT POINT (WIND LOAD)

請用A3紙打印

CLIENT :
SHIMAO GROUP
HOLDINGS LIMITED

PROJECT :
協興建設有限公司
HP HING CONSTRUCTION CO LTD

STRUCTURAL ENGINEER :
CMA
C.M. HONG & ASSOCIATES LTD
黃少明建築工程師有限公司

PACKAGE CONSULTING:
MENHARDT

NOTE:
1. ALL DIMENSIONS ARE IN MM.
2. ALL DIMENSIONS ARE TAKEN FROM OUTSIDE.
3. EXISTING DIMENSIONS TO BE SHOWN ON SITE.
4. DIMENSIONS TO BE SHOWN ON SITE.
5. DIMENSIONS TO BE SHOWN ON SITE.

DATE: 13-APR-21
SCALE: 1:500 (A1)

PROJECT: PROPOSED RESIDENTIAL DEVELOPMENT AT MALL 6542 YIN PING ROAD KOWLOON

TITLE: PART ELEVATION FOR CURTAIN WALL AT TOWER 6 & 7

DATE: 13-APR-21
SCALE: 1:500 (A1)

PROJECT: PROPOSED RESIDENTIAL DEVELOPMENT AT MALL 6542 YIN PING ROAD KOWLOON

TITLE: PART ELEVATION FOR CURTAIN WALL AT TOWER 6 & 7

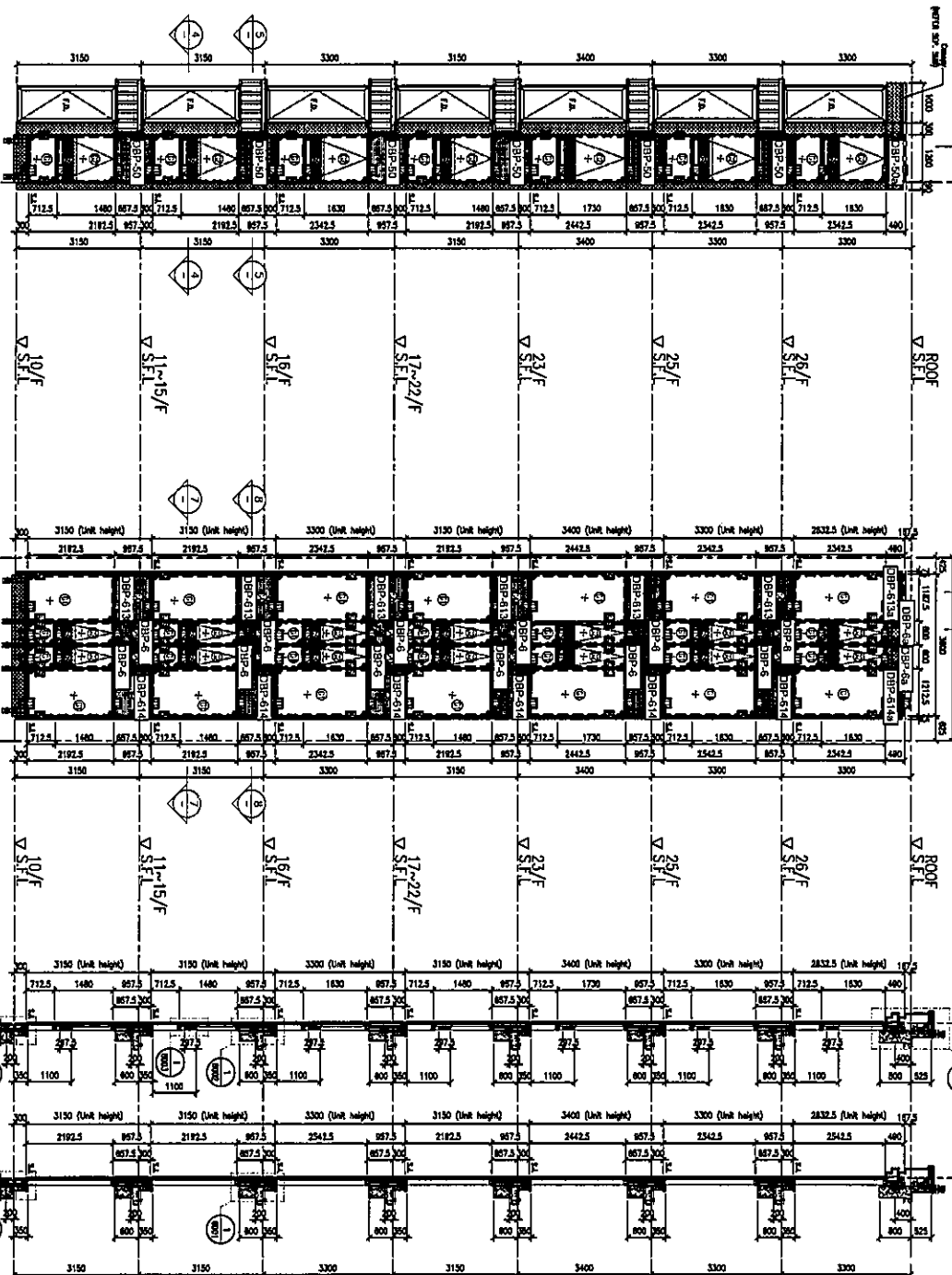

FLOOR LEVEL (SEA LEVEL)

FLOOR	LEVEL
ROOF	+210.00
29/F	+200.70
28/F	+200.00
27/F	+199.30
26/F	+198.60
25/F	+197.90
24/F	+197.20
23/F	+196.50
22/F	+195.80
21/F	+195.10
20/F	+194.40
19/F	+193.70
18/F	+193.00
17/F	+192.30
16/F	+191.60
15/F	+190.90
14/F	+190.20
13/F	+189.50
12/F	+188.80
11/F	+188.10
10/F	+187.40

- LEGEND:
- ① - Open HEAT STRENGTHENED GLASS (OUTER CLEAR GLASS)
 - ② - Open HEAT STRENGTHENED GLASS (INNER CLEAR GLASS)
 - ③ - 12mm HEAT STRENGTHENED GLASS (OUTER CLEAR GLASS)
 - ④ - 12mm HEAT STRENGTHENED GLASS (INNER CLEAR GLASS)
 - ⑤ - 12mm HEAT STRENGTHENED GLASS (OUTER CLEAR GLASS)
 - ⑥ - 12mm HEAT STRENGTHENED GLASS (INNER CLEAR GLASS)
 - ⑦ - 12mm HEAT STRENGTHENED GLASS (OUTER CLEAR GLASS)
 - ⑧ - 12mm HEAT STRENGTHENED GLASS (INNER CLEAR GLASS)
 - ⑨ - 12mm HEAT STRENGTHENED GLASS (OUTER CLEAR GLASS)
 - ⑩ - 12mm HEAT STRENGTHENED GLASS (INNER CLEAR GLASS)
 - ⑪ - 12mm HEAT STRENGTHENED GLASS (OUTER CLEAR GLASS)
 - ⑫ - 12mm HEAT STRENGTHENED GLASS (INNER CLEAR GLASS)
 - ⑬ - 12mm HEAT STRENGTHENED GLASS (OUTER CLEAR GLASS)
 - ⑭ - 12mm HEAT STRENGTHENED GLASS (INNER CLEAR GLASS)
 - ⑮ - 12mm HEAT STRENGTHENED GLASS (OUTER CLEAR GLASS)
 - ⑯ - 12mm HEAT STRENGTHENED GLASS (INNER CLEAR GLASS)
 - ⑰ - 12mm HEAT STRENGTHENED GLASS (OUTER CLEAR GLASS)
 - ⑱ - 12mm HEAT STRENGTHENED GLASS (INNER CLEAR GLASS)
 - ⑲ - 12mm HEAT STRENGTHENED GLASS (OUTER CLEAR GLASS)
 - ⑳ - 12mm HEAT STRENGTHENED GLASS (INNER CLEAR GLASS)
 - ㉑ - 12mm HEAT STRENGTHENED GLASS (OUTER CLEAR GLASS)
 - ㉒ - 12mm HEAT STRENGTHENED GLASS (INNER CLEAR GLASS)
 - ㉓ - 12mm HEAT STRENGTHENED GLASS (OUTER CLEAR GLASS)
 - ㉔ - 12mm HEAT STRENGTHENED GLASS (INNER CLEAR GLASS)
 - ㉕ - 12mm HEAT STRENGTHENED GLASS (OUTER CLEAR GLASS)
 - ㉖ - 12mm HEAT STRENGTHENED GLASS (INNER CLEAR GLASS)
 - ㉗ - 12mm HEAT STRENGTHENED GLASS (OUTER CLEAR GLASS)
 - ㉘ - 12mm HEAT STRENGTHENED GLASS (INNER CLEAR GLASS)
 - ㉙ - 12mm HEAT STRENGTHENED GLASS (OUTER CLEAR GLASS)
 - ㉚ - 12mm HEAT STRENGTHENED GLASS (INNER CLEAR GLASS)
 - ㉛ - 12mm HEAT STRENGTHENED GLASS (OUTER CLEAR GLASS)
 - ㉜ - 12mm HEAT STRENGTHENED GLASS (INNER CLEAR GLASS)
 - ㉝ - 12mm HEAT STRENGTHENED GLASS (OUTER CLEAR GLASS)
 - ㉞ - 12mm HEAT STRENGTHENED GLASS (INNER CLEAR GLASS)
 - ㉟ - 12mm HEAT STRENGTHENED GLASS (OUTER CLEAR GLASS)
 - ㊱ - 12mm HEAT STRENGTHENED GLASS (INNER CLEAR GLASS)
 - ㊲ - 12mm HEAT STRENGTHENED GLASS (OUTER CLEAR GLASS)
 - ㊳ - 12mm HEAT STRENGTHENED GLASS (INNER CLEAR GLASS)
 - ㊴ - 12mm HEAT STRENGTHENED GLASS (OUTER CLEAR GLASS)
 - ㊵ - 12mm HEAT STRENGTHENED GLASS (INNER CLEAR GLASS)
 - ㊶ - 12mm HEAT STRENGTHENED GLASS (OUTER CLEAR GLASS)
 - ㊷ - 12mm HEAT STRENGTHENED GLASS (INNER CLEAR GLASS)
 - ㊸ - 12mm HEAT STRENGTHENED GLASS (OUTER CLEAR GLASS)
 - ㊹ - 12mm HEAT STRENGTHENED GLASS (INNER CLEAR GLASS)
 - ㊺ - 12mm HEAT STRENGTHENED GLASS (OUTER CLEAR GLASS)
 - ㊻ - 12mm HEAT STRENGTHENED GLASS (INNER CLEAR GLASS)
 - ㊼ - 12mm HEAT STRENGTHENED GLASS (OUTER CLEAR GLASS)
 - ㊽ - 12mm HEAT STRENGTHENED GLASS (INNER CLEAR GLASS)
 - ㊾ - 12mm HEAT STRENGTHENED GLASS (OUTER CLEAR GLASS)
 - ㊿ - 12mm HEAT STRENGTHENED GLASS (INNER CLEAR GLASS)

DATE: 13-APR-21
SCALE: 1:500 (A1)

PROJECT: PROPOSED RESIDENTIAL DEVELOPMENT AT MALL 6542 YIN PING ROAD KOWLOON

TITLE: PART ELEVATION FOR CURTAIN WALL AT TOWER 6 & 7

DATE: 13-APR-21
SCALE: 1:500 (A1)

PROJECT: PROPOSED RESIDENTIAL DEVELOPMENT AT MALL 6542 YIN PING ROAD KOWLOON

TITLE: PART ELEVATION FOR CURTAIN WALL AT TOWER 6 & 7

請用A3紙打印

B.LK. REF. :

CLIENT :
SHIMAO GROUP HOLDINGS LIMITED

ARCHITECT :
SHIMAO GROUP HOLDINGS LIMITED

MAIN CONTRACTOR :
協興建築有限公司
HOP HING CONSTRUCTION CO. LTD.

STRUCTURAL ENGINEER :
C.M. HONG & ASSOCIATES LTD.
黃志明建築師事務所

PROJECT CONSULTANTS:
JENNYHART

NOTE:
1. ALL DIMENSIONS ARE IN MM.
2. ALL DIMENSIONS ARE TAKEN FROM OUTSIDE BEFORE FINISHWORK.
3. ALL DIMENSIONS TO BE VERIFIED ON SITE.

LEGEND:
① - ALUM. MARK NO.
② - REFER SHEET NO.
1. F.F.I. - FINISHED FLOOR LEVEL
2. S.F.I. - STRUCTURE FLOOR LEVEL
3. - INVERTED FLOOR.

DOOR LEVEL (SEAL)

FLOOR	LEVEL	MARK
ROOF	+210.00	
20/F	+208.70	
21/F	+203.00	
22/F	+198.85	
23/F	+193.70	
24/F	+188.55	
19/F	+187.40	
17/F	+181.10	
16/F	+177.80	
15/F	+174.50	
11/F	+168.30	

JENNYHART

PROJECT :
PROPOSED RESIDENTIAL DEVELOPMENT AT NALL 6542
YAN PING ROAD
KOWLOON

JENNYHART

DATE : 13-APR-21
SCALE : 1:50 (A1)

DRAWN BY : LHM
CHECKED BY :

協興建築有限公司
HOP HING CONSTRUCTION CO. LTD.
1105-B-6, Shenyi Industrial Centre, 1/F
1105-B-6, Shenyi Industrial Centre, 1/F
KOWLOON
TEL: (852) 27727286
FAX: (852) 27727286

REV. : A

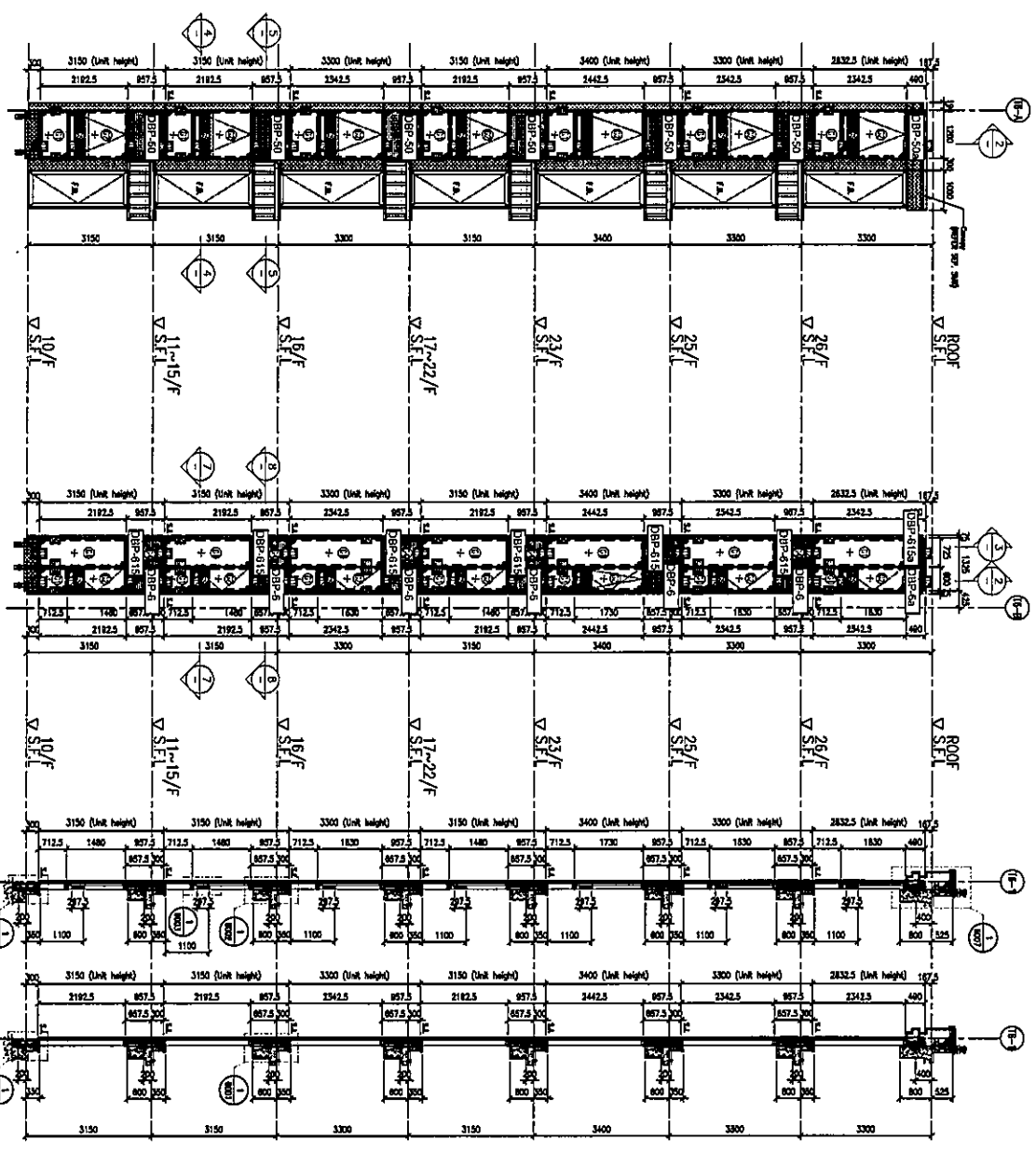

LEGEND:
① - 12mm HEAT STRENGTHENED GLASS (OUTER)
② - 12mm AIR SPACE + 12mm HEAT STRENGTHENED GLASS (INNER)
③ - 12mm HEAT STRENGTHENED GLASS (OUTER)
④ - 12mm AIR SPACE + 12mm HEAT STRENGTHENED GLASS (INNER)
⑤ - 12mm HEAT STRENGTHENED GLASS & 20mm THE CLEAR TEMPERED GLASS (INTERNAL PROTECTIVE BARBER)

① - ALUM. EXPANSION JOINT NO.
② - ALUM. EXPANSION JOINT NO. + 020 (LWD)
③ - ALUM. EXPANSION JOINT NO. + 020 (LWD)

① - STACK JOINT (END LWD)
② - STACK JOINT (END LWD)

MATERIAL SUBMISSION				CONTRACT NO. J031740	
NKIL6542, YIN PING ROAD, TAI WO PING, KOWLOON, HONG KONG				HH REFERENCE S0189/HC202104-K15/WCL/SCH	
CONTRACT TITLE		Main Contract		SUBMISSION No. MC/MS/013(AR-MIDI)	
MAIN CONTRACTOR		Hip Hing Construction Co. Ltd.		TOTAL PAGE No. 3	Page <u>1</u> of <u>3</u>
We submit herewith the following material(s) to <u>WT</u> for <input checked="" type="checkbox"/> approval <input type="checkbox"/> Others, please specify <input type="checkbox"/> information _____					
SUBJECT: <u>1ST MATERIAL SUBMISSION OF ALUMINIUM CLADDING COLOR SAMPLE (AL5)</u>					
DETAILS: Enclosed herewith aluminium cladding AL5 colour sample photo for your endorsement: 1. AL5 – Grey for Aluminium Cladding - Color Code: UCT542049SC-3 (3 coatings) Location of Use: Curtain Wall Spandrel Backpan					
Material Sample Prepared by: MIDI ALUMINIUM FABRICATOR LTD.			Name: Marco Tam (Director)		
Submission Date (Y/M/D) 2021/07/09			Signature: <i>Marco Tam</i>		
cc.	<input checked="" type="checkbox"/> ASL w/ <u>1</u> sets of encl.	<input type="checkbox"/> DCDA w/ ___ sets of encl.	<input type="checkbox"/> RA w/ ___ sets of encl.	Authorized Representative	Date Issued
	<input type="checkbox"/> ARC w/ ___ sets of encl.	<input type="checkbox"/> RE w/ ___ sets of encl.	<input checked="" type="checkbox"/> COW w/ <u>1</u> sets of encl.	Mr. Kelvin Leung (Senior Project Manager)	2021/07/14 RECEIVED 15 JUL 2021
	<input checked="" type="checkbox"/> CMW w/ <u>1</u> sets of encl.	<input checked="" type="checkbox"/> MIDI w/ - sets of encl.	<input type="checkbox"/> URBIS w/ ___ sets of encl.	Signature <i>Kelvin Leung</i>	
	<input checked="" type="checkbox"/> JRP w/ <u>1</u> sets of encl.	<input type="checkbox"/> RB w/ ___ sets of encl.	<input type="checkbox"/> Telemax w/ ___ sets of encl.	Submission Date (Y/M/D) 2021/07/14	
	<input type="checkbox"/> MFT w/ <u>1</u> sets of encl.	<input type="checkbox"/> DCDA w/ ___ sets of encl.	<input type="checkbox"/> RA w/ ___ sets of encl.		
WCL/TC/MPC/AST/HL/EL/CH					WONG TUNG & PARTNERS LTD.
CONSULTANT'S REPLY					
<input type="checkbox"/> CONSULTANT'S NAME: REMARK:			Authorized Representative		Date Received
(Refer also attached reply to the submission list for approval status)			(Name in Block Letter)		
			Signature		
			Date (Y/M/D)		
<input checked="" type="checkbox"/> REPLY BY WONG TUNG & PARTNERS LIMITED (WTPL): - NO ADVERSE COMMENT FOR UCT542049SC-3 - CONTRACTOR SHALL COMPLY WITH CONTRACT SPECIFICATIONS.			For Office Use		
(Refer also attached reply to the submission list for approval status)			Authorized Representative		
			BENNY YIP (Name in Block Letter)		
			Signature <i>B.</i>		
			Date (Y/M/D) 11 AUG 2021		
cc.	<input type="checkbox"/> ASL w/ ___ sets of encl.	<input type="checkbox"/> RA w/ ___ sets of encl.	<input type="checkbox"/> RE w/ ___ sets of encl.		
	<input type="checkbox"/> ARC w/ ___ sets of encl.	<input type="checkbox"/> COW w/ ___ sets of encl.	<input type="checkbox"/> URBIS w/ ___ sets of encl.		
	<input type="checkbox"/> CMW w/ ___ sets of encl.	<input type="checkbox"/> RB w/ ___ sets of encl.	<input type="checkbox"/> DCDA w/ ___ sets of encl.		
	<input type="checkbox"/> MFT w/ ___ sets of encl.	<input type="checkbox"/> Telemax w/ ___ sets of encl.	<input type="checkbox"/> RA w/ ___ sets of encl.		