

工程指示 / 要求簡箋 ENGINEER INSTRUCTIONS(E.I.)

工程指示編號:	EI- 8507	修改版本:	-
	HK- /		
工程編號:	J 853	工程名稱:	延坪道
收件人:	Maggie Lor	發件人:	Joe Chan
工程項目:	佛沙富地盤用玻璃	日期:	30/10/2024

<input type="checkbox"/> 原合約工程包	<input type="checkbox"/> 原合約工程加 / 減脹 QT-	<input type="checkbox"/> 新工程報價 QT-
---------------------------------	--	------------------------------------

信件批核號碼/圖紙參考編號:	批核模具圖紙編號:
客戶指示附件:	管理內部批簽署:

<input type="checkbox"/> 初步鋁料 B.M.	<input type="checkbox"/> 加工拆圖, 然後生產	<input type="checkbox"/> 尺寸表
<input type="checkbox"/> 正式鋁料 B.M.	<input type="checkbox"/> 技術上資料/指示	<input type="checkbox"/> 報價
<input type="checkbox"/> 配件 B.M.	<input type="checkbox"/> 樣辦或貨品說明書	<input type="checkbox"/> 分判合約
<input type="checkbox"/> 其他:		

內容: 請依附件資料, 生產玻璃, 送地盤.

- 按 BS EN 14179-1:2016 標準熱浸.

- 請一批過出貨.

完成上列要求日期: 25/11/2024

國內

<input type="checkbox"/> 生產技術總監	<input type="checkbox"/> 連附件	<input type="checkbox"/> 技術部	<input type="checkbox"/> 連附件	<input type="checkbox"/> 生產部	<input type="checkbox"/> 連附件
<input type="checkbox"/> 採購部	<input type="checkbox"/> 連附件	<input type="checkbox"/> 生產統籌部	<input type="checkbox"/> 連附件	<input type="checkbox"/> 報關組	<input type="checkbox"/> 連附件
<input type="checkbox"/> 質檢部	<input type="checkbox"/> 連附件	<input type="checkbox"/> 會計部	<input type="checkbox"/> 連附件	<input type="checkbox"/> 機械設計部	<input type="checkbox"/> 連附件
<input type="checkbox"/> 香港辦	<input type="checkbox"/> 連附件	<input type="checkbox"/> 其他:			

香港

<input type="checkbox"/> 行政部	<input type="checkbox"/> 連附件	<input type="checkbox"/> 會計部	<input type="checkbox"/> 連附件	<input type="checkbox"/> 統籌部	<input type="checkbox"/> 連附件	<input type="checkbox"/> 工程部	<input type="checkbox"/> 連附件
<input type="checkbox"/> 採購部	<input type="checkbox"/> 連附件	<input type="checkbox"/> QS部	<input type="checkbox"/> 連附件	<input checked="" type="checkbox"/> 地盤管理	<input checked="" type="checkbox"/> 連附件	<input type="checkbox"/> 維修部	<input type="checkbox"/> 連附件

*發件人簽署:		*組別成員批核簽署:	
傳遞編號:	-	項目經理簽署:	

地盤用玻璃B.M.表

修改版次: 總計玻璃數量(塊): #REF! 總計玻璃面積(平方米): 6.027 正式數

序號	修改內容	玻璃編號	顏色與類型	厚度 (mm)	玻璃尺寸		數量 (塊)	總面積 (平方米)	使用位置	使用屋號	樓層
					寬度W (mm)	高度H (mm)					
1		GL01-133	GL01	32	570	1430.0	1	0.815	WD.19/D1	HC2	1/F
2		GL01-133	GL01	32	570	1430.0	1	0.815	WD.19/D1	HD2	1/F
3		GL01-134	GL01	32	490	1390	1	0.681	WD.19a/D1	HD3	1/F
4		GL01-135	GL01	32	490	1565	1	0.767	WE.07/E1	HD1	G/F
5		GL01-136	GL01	32	490	1390	1	0.681	WE.11/E1	HD1	1/F
6		GL01-137	GL01	32	490	1315	1	0.644	WE.09/E1	HD1	2/F
7		GL01-138	GL01	32	565	1430	1	0.808	WG.14/G	HC1	1/F
8		GL01-139	GL01	32	565	1444	1	0.816	WG.28/G	HC1	2/F
9		GL01-140	GL01	32	472	2083	1	0.983	WF.24/F	HOUSE A 大屋	1/F
10		GL01-140	GL01	32	472	2083	1	0.983	WF.26/F	HOUSE A 大屋	1/F
						合計:	10	6.027			

(1).本表中玻璃采用三鑫公司產玻璃，樣板代號亦為三鑫產品代號。

(2).本表中所有玻璃對角線尺寸偏差要求不超過負2mm。

(3).本表中玻璃要求粗磨邊處理並倒棱角，攔河玻璃頂底要精磨邊，而所有玻璃之入爐方向需保持一致。

(4).本表中所有玻璃成品均需做雙面保護，用透明靜電膠紙加四周一寸PK白膠紙做雙面加固保護處理。

(5).本表中所有玻璃成品均需注明室內外及其玻璃編號/使用位置/樓層，以便識別。

G01: 10mm HS. +12mm AIR GAP+10mm T.P THK. I.G.U.

加工注意
事項/玻璃
類
型描述:



美特鋁質有限公司
MIDI Aluminium Fabricator Ltd.

類別		物料號	
制圖	周廣志	2024.07.15	圖號 GL01
修改			
日期			
復核	謝永林	2024.07.19	數量 見BOM表
批准			位置 見BOM表

Sample no. :D21031909

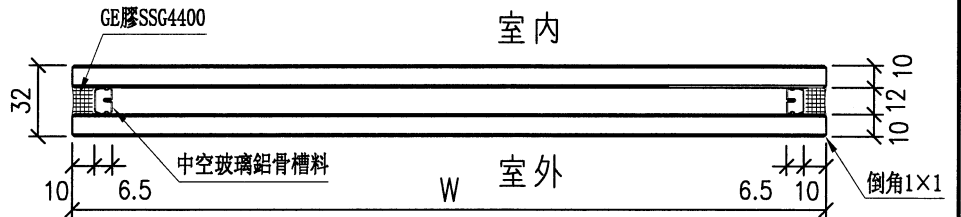
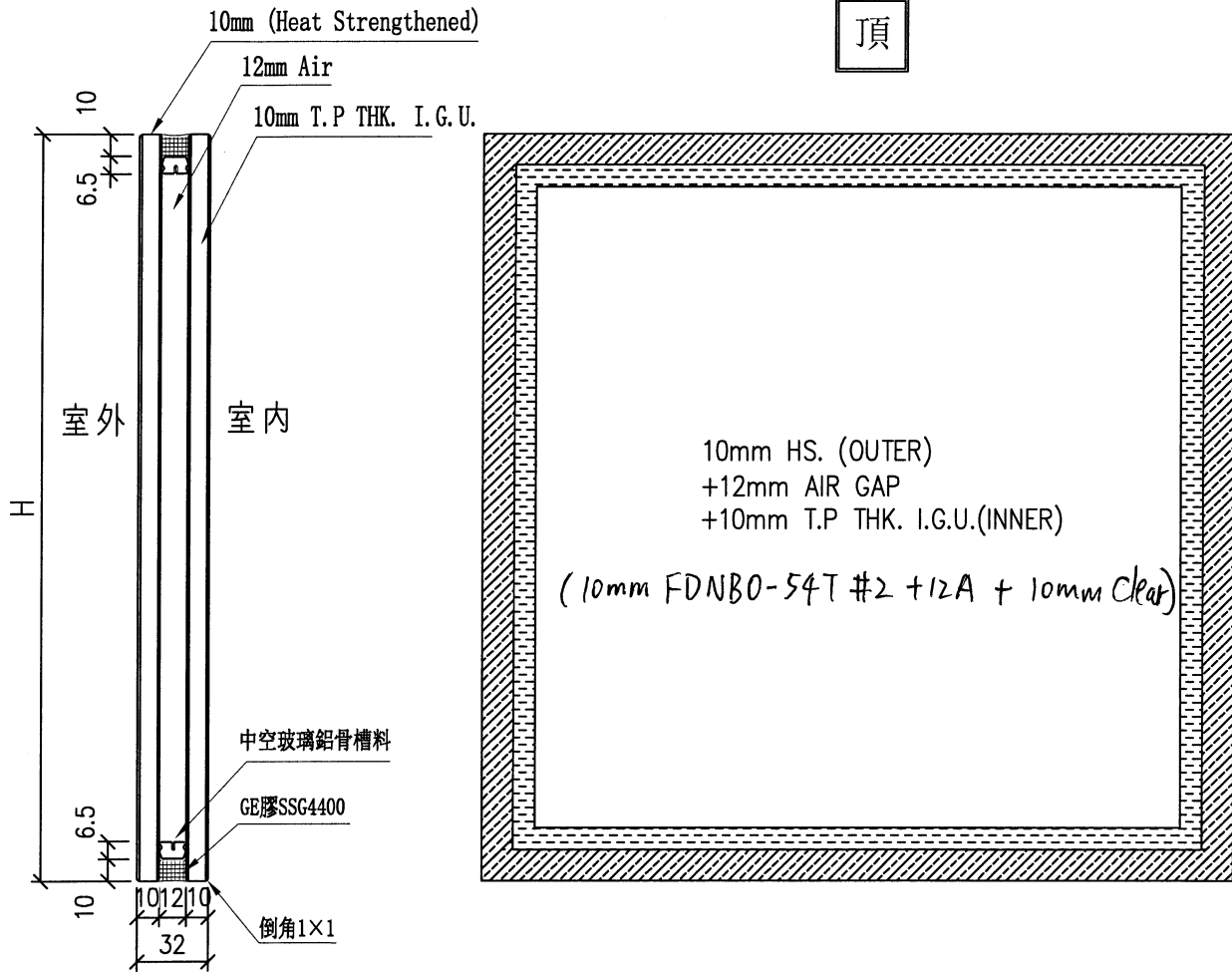

工程號	J-853	地盤	九龍延坪道	附件
名稱	玻璃加工圖 (生窗 / FD / GD) 採用			
材料	地盤			
顏色	工廠			

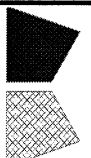

美特鋁質 有限公司
MIDI Aluminium Fabricator Ltd.

地盤用玻璃B.M.表

分屋數量表

修改版次：

正式數

序號	修改內容	玻璃圖號	樓層	正式數							窗號
				HC1	HC2	HD1	HD2	HD3	HOUSE A	總數	
1		GL01-133	1/F		1		1			2	WD19/D1
2		GL01-134	1/F					1		1	WD19a/D1
3		GL01-135	G/F			1				1	WE07/E1
4		GL01-136	1/F			1				1	WE11/E1
5		GL01-137	2/F			1				1	WE09/E1
6		GL01-138	1/F	1						1	WG14/G
7		GL01-139	2/F	1						1	WG28/G
8		GL01-140	1/F						2	2	WF24,26
9											
			匯總	2	1	3	1	1		10	

B.O. REF :

CLIENT :

SHIMAO GROUP HOLDINGS LIMITED

ARCHITECT : HONG KONG & ASSOCIATES LIMITED



MAIN CONTRACTOR : 協興建築有限公司 SHIP HING CONSTRUCTION CO LTD

STRUCTURAL ENGINEER :

CGMA C.M WONG & ASSOCIATES LTD 黃志邦建築工程師有限公司

FAÇADE CONSULTANT :



NOTE :

1. ALL DIMENSIONS ARE IN MM.
2. ALL DIMENSIONS ARE MARKED FROM OUTSIDE.
3. BEFORE FABRICATION.

LEGEND :

- ① DETAIL MARK NO.
- REF. SHEET NO.
- ② F.F.L. --- FINISHED FLOOR LEVEL
- ③ S.F.L. --- STRUCTURAL FLOOR LEVEL
- ④ --- REVERSED DETAIL
- ⑤ --- FINING LOCATION
- ⑥ --- FINING LINE LOCATION
- ⑦ GLASS LEGEND
- GL01 --- 10mm+12mm AIR GAP+10mm IHK, 10L1
- ⑧ ALU1
- ⑨ DRYS COATED ALUMINIUM SPRAY FINISH (4 COAT SYSTEM) COLOR: CE-06-DJ1723 COLOR : 0017 07/093 KENTLE

NO.	DATE	REVISION	BY
E	18/10/2023	REVISION SUBJECT TO BODI COMMENT Y1	
D	29/08/2023	GENERAL REVISED	
C	17/07/2023	GENERAL REVISED	
B	18/06/2023	GENERAL REVISED	
A	27/04/2023	GENERAL REVISED	

DWG NO. : J-553

PROJECT : PROPOSED RESIDENTIAL DEVELOPMENT AT NICKL 6542 TIN FINNG ROAD KOWLOON

DATE : 12-FEB-23 SCALE : 1:40 (A3) DRAWN BY : ASING CHECKED BY :

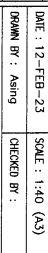

美特經貿有限公司 MIDORI MITSUBISHI KAISHA LTD. Unit 6-8, Sunny Industrial Centre, 1/F, P.O. Box 111, Tin Finng Road, Kowloon. Tel: 25258211-1 Fax: 60392777/6969

DWG NO. : 4853-SD-HPW-2011 REV. : E

GL01-133

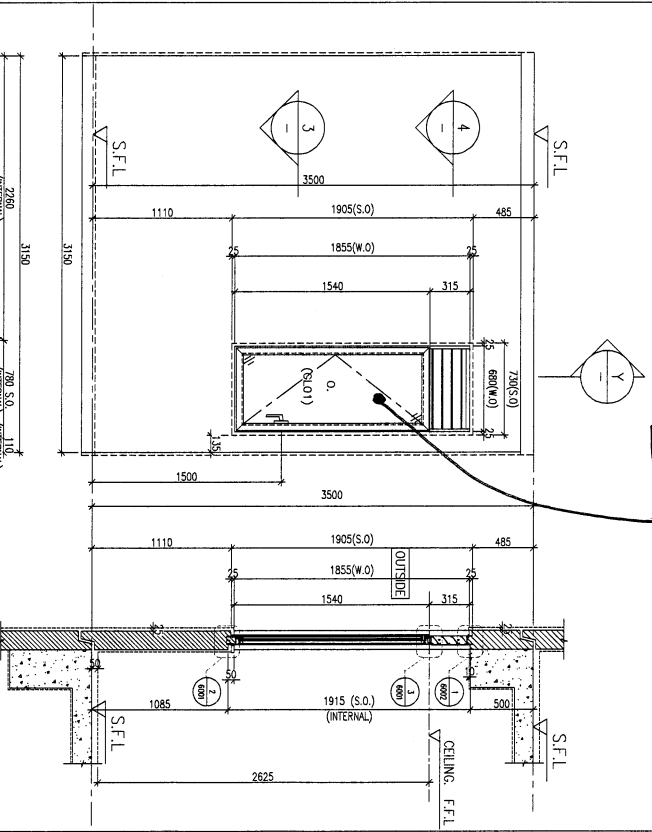

PROVIDED	
GLAZING AREA	0.769 m ²
OPENABLE AREA	0.886 m ²
FREE AREA	50.1 %

WINDOW MARK: **ALU1**

LOCATION: HOUSE TYPE D1 - 1/F EN. BATH 4

SECTION: 70mm ALUM. SECTION AL1

QUANTITY: 2 Nos.

REMARKS: HOUSE NO. HC2 & HD2

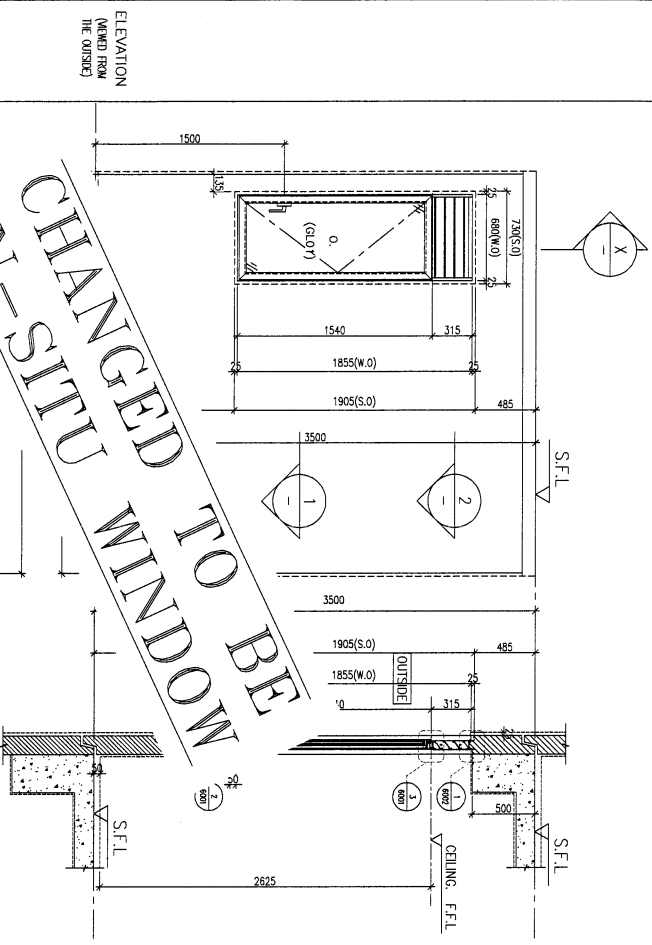

PROVIDED	
GLAZING AREA	0.769 m ²
OPENABLE AREA	0.886 m ²
FREE AREA	50.1 %

WINDOW MARK: **ALU1**

LOCATION: HOUSE TYPE D - 1/F EN. BATH 4

SECTION: 70mm ALUM. SECTION AL1

QUANTITY: 1 No.

REMARKS: HOUSE NO. HC3

CHANGED TO BE SITU IN

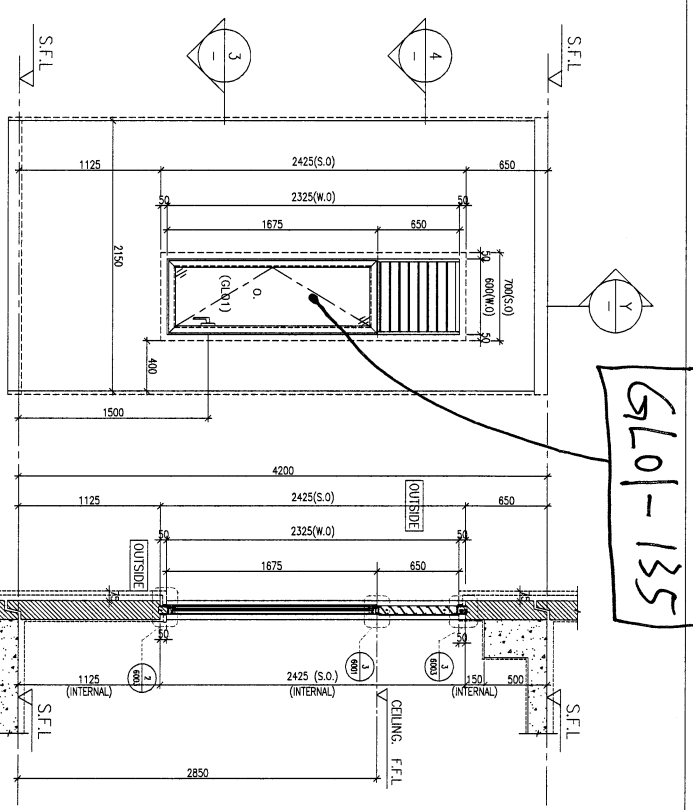
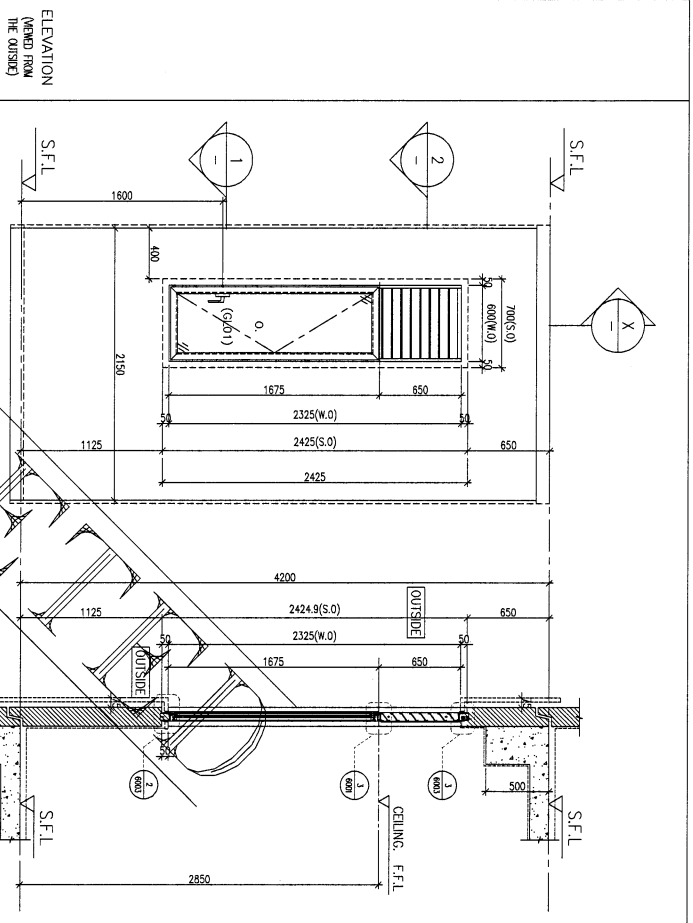

GLO1-135

WINDOW MARK	HOUSE TYPE E - G/F LAV.
LOCATION	70mm ALUM. SECTION A11
SECTION	GL01
GLAZING	2 Nos
QUANTITY	HOUSE NO. HG6, HD7
REMARKS	

PROVIDED	
GLAZING AREA	0.878 m ²
OPENABLE AREA	0.956 m ²
FREE AREA	50.1 %

WINDOW MARK	HOUSE TYPE E1 - G/F LAV.
LOCATION	70mm ALUM. SECTION A11
SECTION	GL01
GLAZING	1 No.
QUANTITY	HOUSE NO. HD1
REMARKS	

PROVIDED	
GLAZING AREA	0.878 m ²
OPENABLE AREA	0.956 m ²
FREE AREA	50.1 %

BAO. REF :

CLIENT : SHIMAO GROUP HOLDINGS LIMITED

ARCHITECT : WPT WONG PING TUNG & PARTNERS LIMITED

MAIN CONTRACTOR : 協興建築有限公司 SHIP HING CONSTRUCTION CO LTD

STRUCTURAL ENGINEER : C.M WONG & ASSOCIATES LTD

TRACER CONSULTANT : WENYARDT

PROJECT : PROPOSED RESIDENTIAL DEVELOPMENT AT 40 L.T. 6542 TAI PING ROAD KOWLOON

DATE : 12-FEB-23 SCALE : 1:40 (A3)

DRAWN BY : Asing CHECKED BY :

PROJECT : PROPOSED RESIDENTIAL DEVELOPMENT AT 40 L.T. 6542 TAI PING ROAD KOWLOON

TITLE : PRECAST ALUM. WINDOW & LINDRE SCHEDULE FOR HOUSE TYPE E / E1 (1)

REVISIONS:

NO.	DATE	REVISION
F	18/10/2023	REVISION SUBJECT TO ARCH COMMENT
E	29/08/2023	GENERAL REVISION
D	17/07/2023	GENERAL REVISION
C	12/06/2023	GENERAL REVISION
B	27/04/2023	GENERAL REVISION
A	08/03/2023	GENERAL REVISION

LEGEND:

- F.F.L. --- FINISHED FLOOR LEVEL.
- S.F.L. --- STRUCTURAL FLOOR LEVEL.
- ▲ --- REVERSED DETAIL.
- △ --- FINING LOCATION.
- △ --- FINING LINE LOCATION.
- GLAZING LEGEND
- GL01 --- 10mm+12mm AIR GAP+10mm THK. LGUL.
- [A11]

--- PRECAST ALUMINUM SPRAY FINISH (4 COAT SYSTEM) CORE EC-95-03A/2322 COLOR : 0017 07/003 MENTALC

DATE : 12-FEB-23 SCALE : 1:40 (A3)

DRAWN BY : Asing CHECKED BY :

PROJECT : PROPOSED RESIDENTIAL DEVELOPMENT AT 40 L.T. 6542 TAI PING ROAD KOWLOON

TITLE : PRECAST ALUM. WINDOW & LINDRE SCHEDULE FOR HOUSE TYPE E / E1 (1)

REVISIONS:

NO.	DATE	REVISION
F	18/10/2023	REVISION SUBJECT TO ARCH COMMENT
E	29/08/2023	GENERAL REVISION
D	17/07/2023	GENERAL REVISION
C	12/06/2023	GENERAL REVISION
B	27/04/2023	GENERAL REVISION
A	08/03/2023	GENERAL REVISION

LEGEND:

- F.F.L. --- FINISHED FLOOR LEVEL.
- S.F.L. --- STRUCTURAL FLOOR LEVEL.
- ▲ --- REVERSED DETAIL.
- △ --- FINING LOCATION.
- △ --- FINING LINE LOCATION.
- GLAZING LEGEND
- GL01 --- 10mm+12mm AIR GAP+10mm THK. LGUL.
- [A11]

--- PRECAST ALUMINUM SPRAY FINISH (4 COAT SYSTEM) CORE EC-95-03A/2322 COLOR : 0017 07/003 MENTALC

WONG PING TUNG & PARTNERS LIMITED
 Suite 6-8, Sunway Industrial Centre, 1/F
 142-148, 211-4
 Tel: 2488211-4
 Fax: 2488211-4
 PRC NO. : 3853-SD-HPW-2013 REV : F

GL01-137

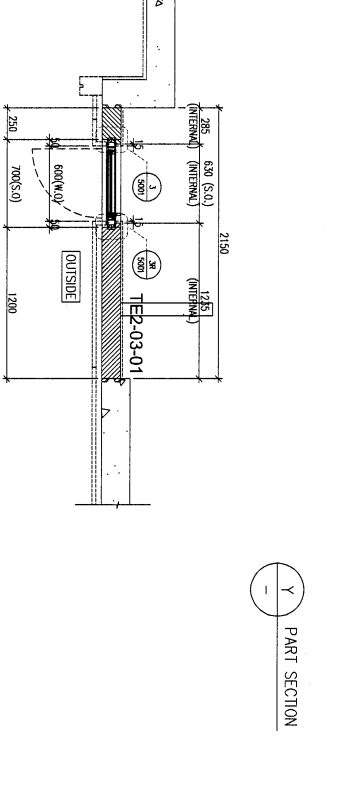
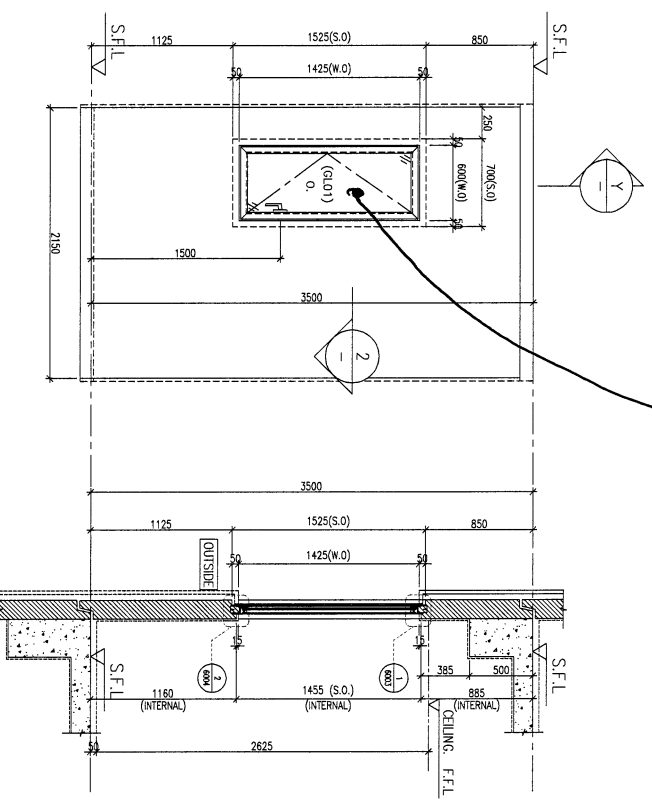
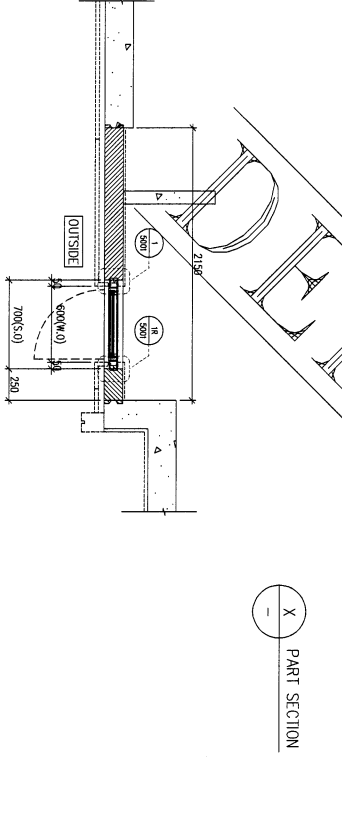
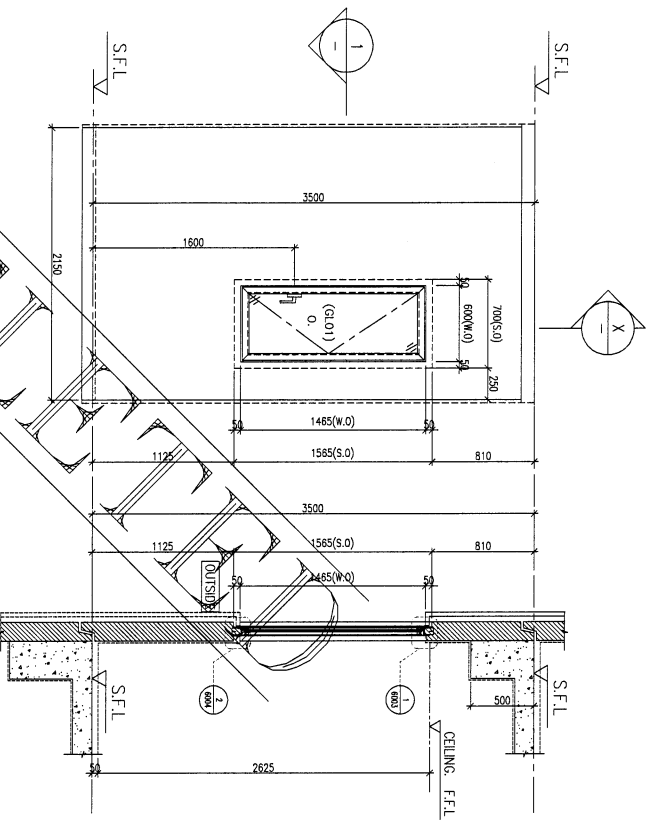

PROVIDED	
GLAZING AREA	0.602 m ²
OPENABLE AREA	0.707 m ²
FREE AREA	%

WINDOW MARK	E
LOCATION	HOUSE TYPE E - 2/F WALK-IN CLOSET
SECTION	70mm ALUM. SECTION A11
GLAZING	GL01
QUANTITY	2 Nos
REMARKS	HOUSE NO. HG6, HD7

WINDOW MARK	E1
LOCATION	HOUSE TYPE E1 - 2/F WALK-IN CLOSET
SECTION	70mm ALUM. SECTION A11
GLAZING	GL01
QUANTITY	1 No.
REMARKS	HOUSE NO. HD1

SHIMAO GROUP HOLDINGS LIMITED

WTF ARCHITECTS & ENGINEERS LIMITED

MAIN CONTRACTOR: 協興建築有限公司
HOP HING CONSTRUCTION CO LTD

STRUCTURAL ENGINEER: C M WONG & ASSOCIATES LTD
黃志明建築工程師有限公司

FAÇADE CONSULTANT: WENHARDT

DATE: 12-FEB-23 **SCALE:** 1:40 (A3)

PROJECT: PROPOSED RESIDENTIAL DEVELOPMENT AT NIKL 6542 YIN PING ROAD KOWLOON.

TITLE: PRECAST ALUM. WINDOW & LOUVER SCHEDULE FOR HOUSE TYPE E / E1 (3)

REVISIONS:

NO.	DATE	REVISION
F	18/10/2023	REVISION SUBJECT TO ARCH COMMENT
E	29/08/2023	GENERAL REVISION
D	17/07/2023	GENERAL REVISION
C	12/06/2023	GENERAL REVISION
B	27/04/2023	GENERAL REVISION
A	09/03/2023	GENERAL REVISION

JOB NO.: J-653

PROJECT: PROPOSED RESIDENTIAL DEVELOPMENT AT NIKL 6542 YIN PING ROAD KOWLOON.

DATE: 12-FEB-23 **SCALE:** 1:40 (A3)

DRAWN BY: Aising **CHECKED BY:**

WTF ARCHITECTS & ENGINEERS LIMITED
Unit 6-8, Sunray Industrial Centre, 1/F
162-248/251-4 Road 65/27272766

WENHARDT

WONG TUNG & ASSOCIATES LTD
黃志明建築工程師有限公司

LEGEND:

- ALL DIMENSIONS ARE IN MM.
- ALL DIMENSIONS TO BE TAKEN FROM OUTSIDE.
- ALL DIMENSIONS TO BE TAKEN ON SITE BEFORE FABRICATION.

DETAIL MARK NO.: RETER SHEET NO.

- F.F.L. --- FINISHED FLOOR LEVEL
- S.F.L. --- STRUCTURAL FLOOR LEVEL
- ▽ --- REVERSED DETAIL
- ▲ --- FRANG LOCATION
- △ --- FRANG LUC LOCATION
- GLASS LEGEND
- GL01 --- 10mm+12mm AIR GAP+10mm THK. LGCL

NOTES:

- PRECAST ALUMINUM SPRAY FINISH (4 COAT SYSTEM) COLOR: GS-05-93/9228 COLOR: 8017 07/093 METALLIC.

ELEVATION
(VIEWED FROM
THE OUTSIDE)

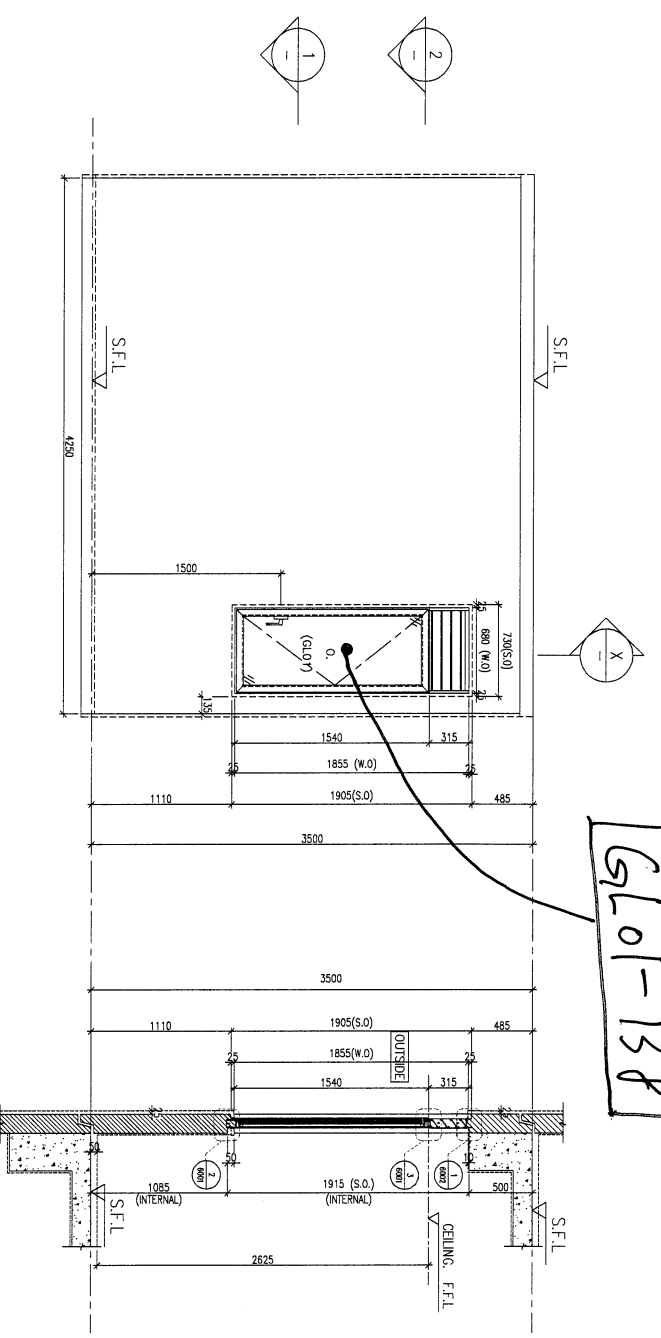

GL01-138

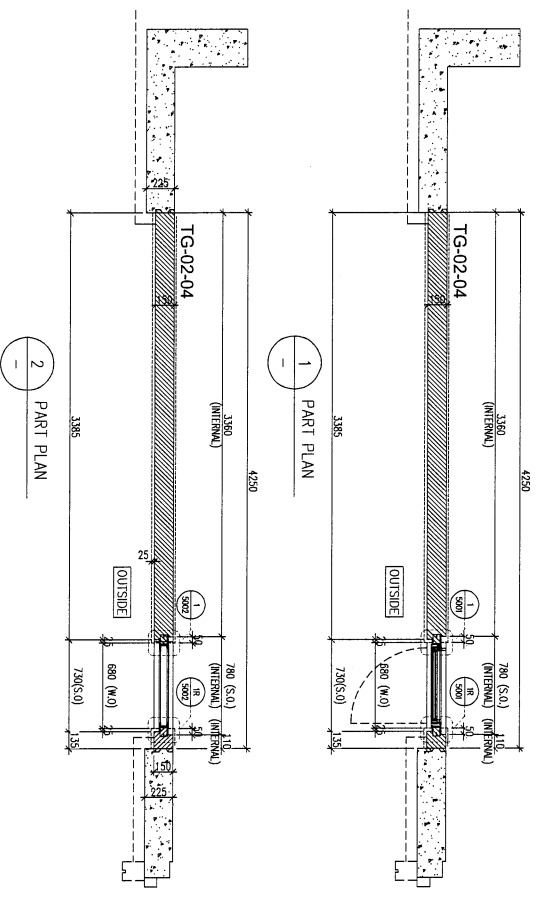

PROVIDED	
GLAZING AREA	0.769 m ²
OPENABLE AREA	0.835 m ²
FREE AREA	50.1 %

WINDOW MARK	AC1A
LOCATION	HOUSE TYPE G - 1/F. BATH 3
SECTION	70mm ALUM. SECTION ALT1
GLAZING	GL01
QUANTITY	1 No
REMARKS	HOUSE NO. H-C1

8.0. REF :

CLIENT : SHIMAO GROUP HOLDINGS LIMITED

ARCHITECT : HONG TUNG & PARTNERS LIMITED

MAIN CONTRACTOR : 協興建築有限公司 HING HING CONSTRUCTION CO. LTD

STRUCTURAL ENGINEER : C.M WONG & ASSOCIATES LTD

FAÇADE CONSULTANT : WENHARDT

NOTE :
1. ALL DIMENSIONS ARE IN MM.
2. ALL DIMENSIONS ARE VIEWED FROM OUTSIDE.
3. ALL DIMENSIONS TO BE VERIFIED ON SITE BEFORE FABRICATION.

LEGEND :
 (X) DETAIL MARK NO.
 (NO) REFER SHEET NO.
 1. F.F.L. --- FINISHED FLOOR LEVEL
 2. S.F.L. --- STRUCTURAL FLOOR LEVEL
 3. (R) --- REVERSED DETAIL
 4. (A) --- FINING LOCATION
 5. (L) --- FINING LINC LOCATION
 6. GLASS LEGEND
 GL01 --- 10mm+12mm AIR GAP+10mm THK. LGU
 7. F.A.L. --- F.A.C.T.

PROJECT : PROPOSED RESIDENTIAL DEVELOPMENT AT NIKILL 6542 YIN PING ROAD KOWLOON

DATE : 12-FEB-23 SCALE : 1:40 (AS)

DESIGNED BY : Aung CHECKED BY :

PROJECT NO. : J-653

NO.	DATE	REVISION
0	18/10/2023	ISSUE SUBJECT TO ARCHITECTURE
1	12/06/2023	GENERAL REVISED
2	27/04/2023	GENERAL REVISED
3	08/03/2023	GENERAL REVISED

PRECAST ALUM. WINDOW & LOUVER SCHEDULE FOR HOUSE TYPE G (1)

INGE & ASSOCIATES LTD
 1/F, 8-8, Sanyo Industrial Centre, 1/F
 162,480211-1 Tel: 852(2727)7666
 162,480211-1 Fax: 852(2727)7666

INGE & ASSOCIATES LTD
 1/F, 8-8, Sanyo Industrial Centre, 1/F
 162,480211-1 Tel: 852(2727)7666
 162,480211-1 Fax: 852(2727)7666

PROJECT NO. : J-653

DATE : 12-FEB-23 SCALE : 1:40 (AS)

DESIGNED BY : Aung CHECKED BY :

PROJECT NO. : J-653

PRECAST ALUM. WINDOW & LOUVER SCHEDULE FOR HOUSE TYPE G (1)

INGE & ASSOCIATES LTD
 1/F, 8-8, Sanyo Industrial Centre, 1/F
 162,480211-1 Tel: 852(2727)7666
 162,480211-1 Fax: 852(2727)7666

B.O. REF :

QUANT :

SHIMAO GROUP HOLDINGS LIMITED

ARCHITECT : SHIMAO GROUP HOLDINGS LIMITED



MAIN CONTRACTOR : 協興建築有限公司

HP HING CONSTRUCTION CO LTD

STRUCTURAL ENGINEER : C.M WONG & ASSOCIATES LTD

FACE CONSULTANT : 美志邦建築工程師有限公司



NOTE :

1. ALL DIMENSIONS ARE IN MM.
2. ALL FINISHES ARE TO BE VERIFIED FROM OUTSIDE BEFORE FABRICATION.

LEGEND :

- 1. F.F.L. --- FINISHED FLOOR LEVEL.
- 2. S.F.L. --- STRUCTURAL FLOOR LEVEL.
- 3. △ --- REVERSED DETAIL.
- 4. ▲ --- FINING LOCATION.
- 5. △ --- FINING LINE LOCATION.
- 6. GLASS LEGEND
GL01 --- 10mm+12mm AIR GAP+10mm THK. IGUL.
- 7. [ALU] --- BRUSH COATED ALUMINUM SPRAY FINISH (1 COAT SYSTEM COLOR EC-90-93/9224 COLOR : 9007 07/903 METALLIC).

NO.	DATE	REVISION	BY
C	13/11/2023	REVISION SUBJECT TO BE COMMENT	YI
B	18/10/2023	REVISION SUBJECT TO ARCH COMMENT	YI
A	12/06/2023	GENERAL REVISION	YI

JOB NO. : J-553

PROJECT : PROPOSED RESIDENTIAL DEVELOPMENT AT KAI LIL 6542 TIN PING ROAD KOWLOON

TITLE : PRECAST ALUM. WINDOW & LOBBY SCHEDULE FOR HOUSE TYPE G (3)

DATE : 12-FEB-23 SCALE : 1:40 (A3)

DRAWN BY : ASING CHECKED BY :

美特堅有限公司
MIDI Aluminium Fabrication Ltd.
Units: G-8, Sunny Industrial Centre, 1/F
162-488/211-4
Tel: 2488211-4 Fax: 2488212-6
E-mail: info@midialu.com.hk

DWG NO. : 3553-SD-HPW-2019 REV. : C

GL01-139

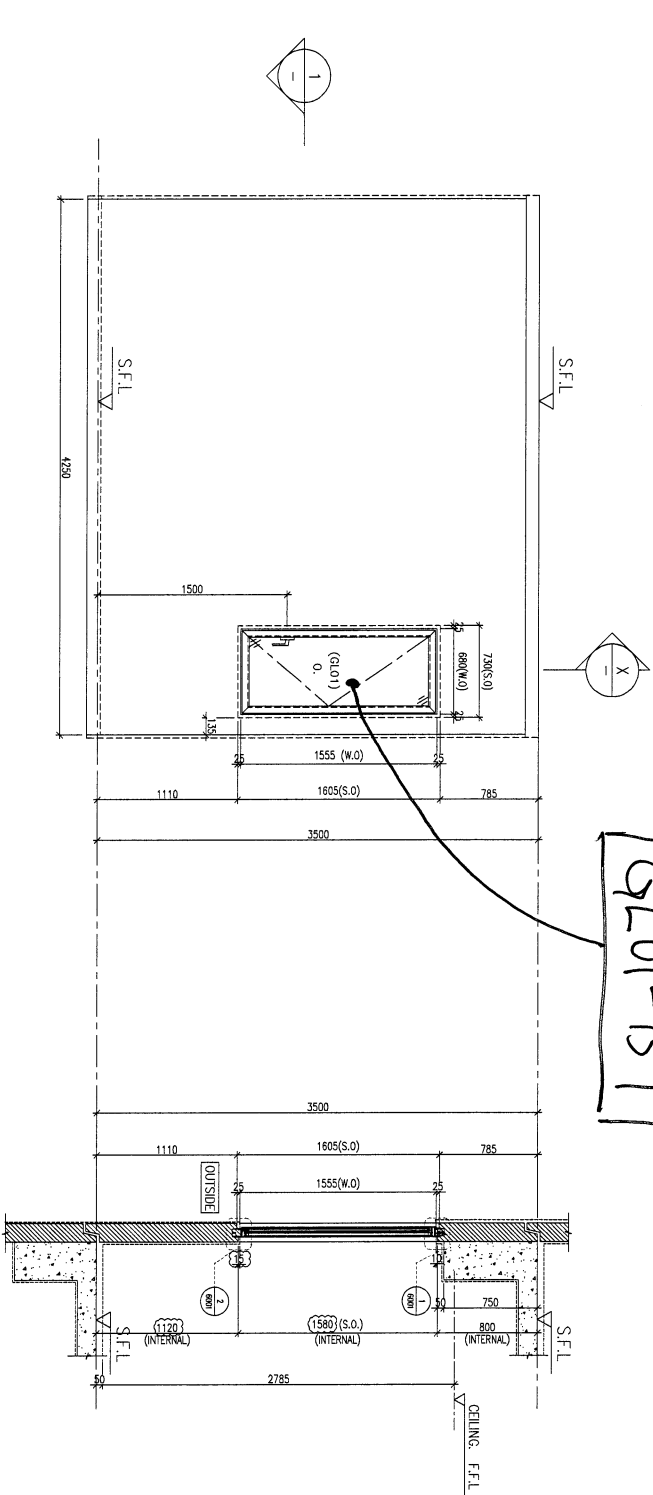

1 PART PLAN

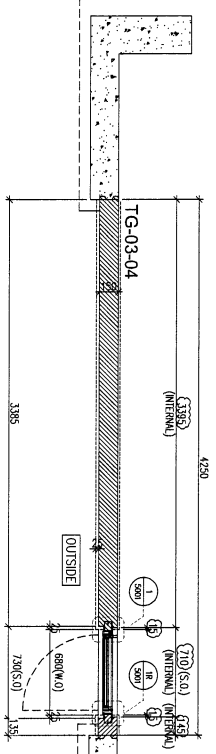

X PART SECTION

ELEVATION (VIEWED FROM THE OUTSIDE)

GLAZING AREA	0.858	m ²
OPENABLE AREA	0.985	m ²
FREE AREA	50.1	%

WINDOW MARK

LOCATION HOUSE TYPE G - 2/F MASTER ENSUITE

SECTION 70mm ALUM. SECTION AL1

GLAZING GL01

QUANTITY 1 No

REMARKS HOUSE NO. HCl

