

工程指示 / 要求簡箋(E.I.)

工程指示編號：EI / 3991 / 21 修改版次：-
 工程編號 : J - 852 工程名稱 : 亞皆老街中電
 工程項目 : 吊趟 雙吊趟款連接器報價
 收件人 : Maggie 發件人 : Ant Yeung 日期 : 04/11/2021

要求提供 / 確認 事項：

- | | | |
|------------------------------------|-------------------------------------|-------------------------------|
| <input type="checkbox"/> 初步鋁料 B.M. | <input type="checkbox"/> 加工拆圖，然後生產 | <input type="checkbox"/> 尺寸表 |
| <input type="checkbox"/> 正式鋁料 B.M. | <input type="checkbox"/> 技術上資料 / 指示 | <input type="checkbox"/> 報價 |
| <input type="checkbox"/> 配件 B.M. | <input type="checkbox"/> 樣辦或貨品說明書 | <input type="checkbox"/> 分判合約 |

內容：

請按附件資料訂購配件，為雙趟款吊趟用連接器，總數:164+36(後備)，共 200 隻
 不鏽鋼料，請先報價，再作批核

馮鵬報價

謝謝

請在 2020.11.27 前完成上列要求。

附：

以上項目為：

- 原合約工程包 原合約工程加 / 減賬 新工程報價

原因：-

分發東莞各部門：

- | | | | |
|--|---|--|--|
| <input type="checkbox"/> 生產技術總監 <input type="checkbox"/> 連附件 | <input type="checkbox"/> 技術部 <input type="checkbox"/> 連附件 | <input type="checkbox"/> 生產部 <input type="checkbox"/> 連附件 | <input type="checkbox"/> 機械設計部 <input type="checkbox"/> 連附件 |
| <input type="checkbox"/> 採購部 <input type="checkbox"/> 連附件 | <input type="checkbox"/> 生產統籌部 <input type="checkbox"/> 連附件 | <input type="checkbox"/> 小羅&清 <input type="checkbox"/> 連附件 | |
| <input type="checkbox"/> 質檢部 <input type="checkbox"/> 連附件 | <input type="checkbox"/> 會計部 <input type="checkbox"/> 連附件 | <input type="checkbox"/> 報關組 <input type="checkbox"/> 連附件 | <input type="checkbox"/> 其他 _____ <input type="checkbox"/> 連附件 |

分發其他分判：

- (v) 水洪 連附件

分發香港各部門：

- | | | | |
|--|--|---|--|
| <input type="checkbox"/> 行政部 <input type="checkbox"/> 連附件 | <input type="checkbox"/> 會計部 <input type="checkbox"/> 連附件 | <input type="checkbox"/> 統籌部 <input type="checkbox"/> 連附件 | <input type="checkbox"/> 工程部地盤科文 <input type="checkbox"/> 連附件 祥哥 |
| <input checked="" type="checkbox"/> 採購部 <input type="checkbox"/> 連附件 | <input type="checkbox"/> QS 部 <input type="checkbox"/> 連附件 | <input type="checkbox"/> 維修部 <input type="checkbox"/> 連附件 | <input type="checkbox"/> 其他 _____ <input type="checkbox"/> 連附件 |

傳遞編號：

HK / 21

發件人簽署：

項目經理簽署：

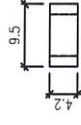
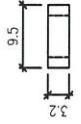

名称:	定计	名称:	轴承	名称:	小胶套	名称:	轴承管
材料:	302	材料:	316	材料:	橡胶	材料:	302
适用范围:	S1R1535, S1R1513 SS1R1549, SS1R1512	适用范围:	S1R1535, S121535, S1R1513, S121513 SS1R1549, SS121549, SS1R1514, SS121514, S121529	适用范围:	S1R1535, S121535, S1R1513, S121513 SS1R1549, SS121549, SS1R1514, SS121514, S121529	适用范围:	S1R1535, S1R1513 SS1R1549, SS1R1513

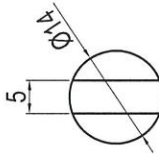
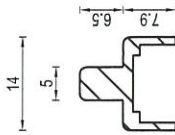

名称:	胶套
材料:	尼龙
适用范围:	

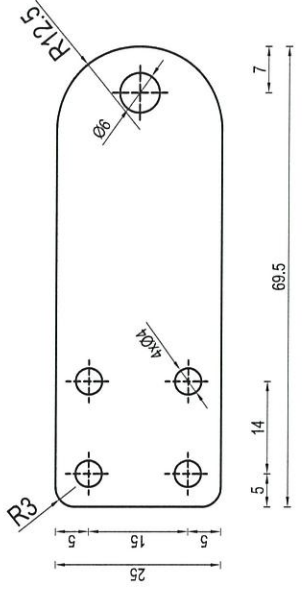
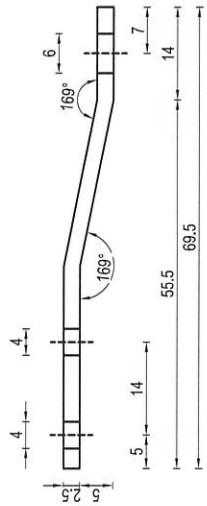

名称:	扣帽底座
材料:	316
适用范围:	

02. REF :

T0 = 祥哥, 布哥

2021. 10. 15

CLIENT :

ARCHITECT :



MAIN CONTRACTOR :



STRUCTURAL ENGINEER :



FAÇADE CONSULTANT :



NOTE :

1. ALL DIMENSIONS ARE IN METRE.
2. ALL ELEVATIONS ARE VIEWED FROM OUTSIDE.
3. ALL DIMENSIONS TO BE VERIFIED ON SITE.

LEGEND :

- ① --- DETAIL MARK NO.
- ② --- REFER SHEET NO.
- ③ --- FINISHED FLOOR LEVEL.
- ④ --- STRUCTURAL FLOOR LEVEL.
- ⑤ --- REVERSED DIM.

樓底有

JOB NO. :	J-832
PROJECT :	PROPOSED RESIDENTIAL DEVELOPMENT AT 139 - 147 ARROYO STREET, NKEL 6035, 6035 R.P., 6036 R.P., 6037 R.P. & 6038 R.P.
TITLE :	LAYOUT PLAN FOR CURTAIN WALL AT 1/F
DATE :	22-NOV-19
SCALE :	1:300
DRAWN BY :	MN
CHECKED BY :	JDW
COMPANY :	美特铝业有限公司 MIDI Aluminium Co., Ltd. Units 6-B, Sunny Industrial Centre, 1/F 812 Cheong Cheong Road, Kowloon Tel: 2548511-4 Fax: 254277866
DWG NO. :	J852-SB-CW-3001
REV. :	-

吊钩变门连接扣 Total: 156 + 5 + 3 = 164 件

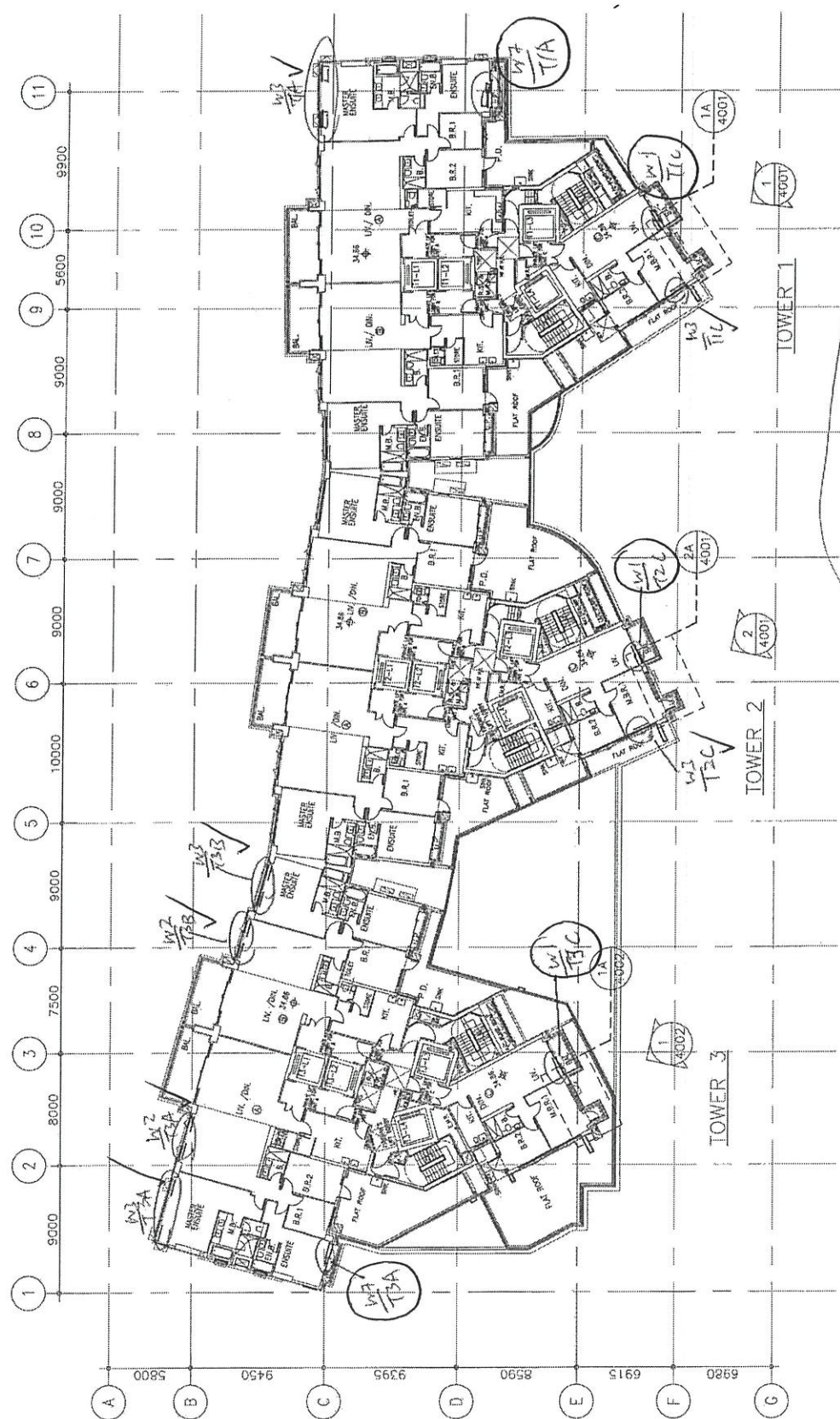

1/F only

FIRST FLOOR PLAN

SUPERSEDED DIM: 2.54mm
ALL DIMENSIONS SAME AS TYPICAL FLOOR (2/F TO 21/F) UNLESS OTHERWISE STATED.

S.D. REF :

1-21/F
12-5/F
2-21/F
3-21/F

CLIENT :

ARCHITECT : AGC



MARK CONTRACTOR :



STRUCTURAL ENGINEER :



FAÇADE CONSULTANT :



- NOTE:
1. ALL DIMENSIONS ARE IN MM.
 2. ALL ELEVATIONS ARE VIEWED FROM OUTSIDE.
 3. ALL DIMENSIONS TO BE VERIFIED ON SITE.
 4. BEFORE FABRICATING.

LEGEND:

- (A) DETAIL MARK NO.
- (B) REFER SHEET NO.
- (C) F.F.L. -- FINISHED FLOOR LEVEL
- (D) S.F.L. -- STRUCTURAL FLOOR LEVEL
- (E) -- REVERSED DETAIL

DES NO. : J-852

PROJECT :
 PROPOSED RESIDENTIAL DEVELOPMENT
 AT 139 - 147 ARGYLE STREET,
 PHIL 6005, 6035 R.P., 6036 R.P.,
 6037 R.P. & 6038 R.P.

TITLE :
 LAYOUT PLAN FOR
 CURTAIN WALL
 AT 21/F - 21/F

DATE : 22-NOV-19

SCALE : 1:300

DRAWN BY : HAN

CHECKED BY : DW

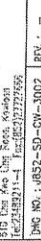

UNIK B. B. Bury Indonesia Centre, 1/F
 419 Jln. Pulo, Bekasi, West Java
 17131, Indonesia
 TEL: (62) 21 7272995

DWG NO. : MS2-SD-CW-3002

REV. : -



156

2/F - 21/F PLAN
 SUPERIMPOSED LAYOUT : 25%
 AT 12/F & 13/F TO BE OMITTED

B.O. REF :			
CLIENT :			
ARCHITECT :	AGC ARCHITECTS CORPORATION		
MAIN CONTRACTOR :	Gammon STRUCTURAL ENGINEER :		
	ARUP		
	MEINHARDT		
	FRACOE CONSULTANT:		
NOTE :	1. ALL DIMENSIONS ARE IN MM. 2. ALL ELEVATIONS ARE VIEWED FROM OUTSIDE. 3. DIMENSIONS TO BE TOPPED ON SITE. 4. SQUARE FINISHWORK.		
LEGEND :	(DT) - DETAIL MARK NO. (RS) - REFER SHEET NO. 1. F.F.L. - FINISHED FLOOR LEVEL. 2. S.F.L. - STRUCTURAL FLOOR LEVEL. 3. (R) - REVERSED DETAIL.		
NO.	DATE	NO.	DATE
JOB NO. : J-852		PROJECT :	
		PROPOSED RESIDENTIAL DEVELOPMENT AT 139 - 147 ARCYLE STREET, NKL 6005, 6035 R.P., 6036 R.P., 6037 R.P. & 6038 R.P.	
TITLE :		LAYOUT PLAN FOR CURTAIN WALL AT 22/F	
DATE :	22-NOV-19	SCALE :	1:300
DRAWN BY :	MM	CHECKED BY :	LOM
		 MIDI 慕得有限公司 Units 6-8, Sanyo Building, 400-402, Prince Street, Singapore 238461. Tel: 65-6334-1144 Fax: 65-6334-2299	
DWG NO. : J852-S0-CW-3003		REV. : -	

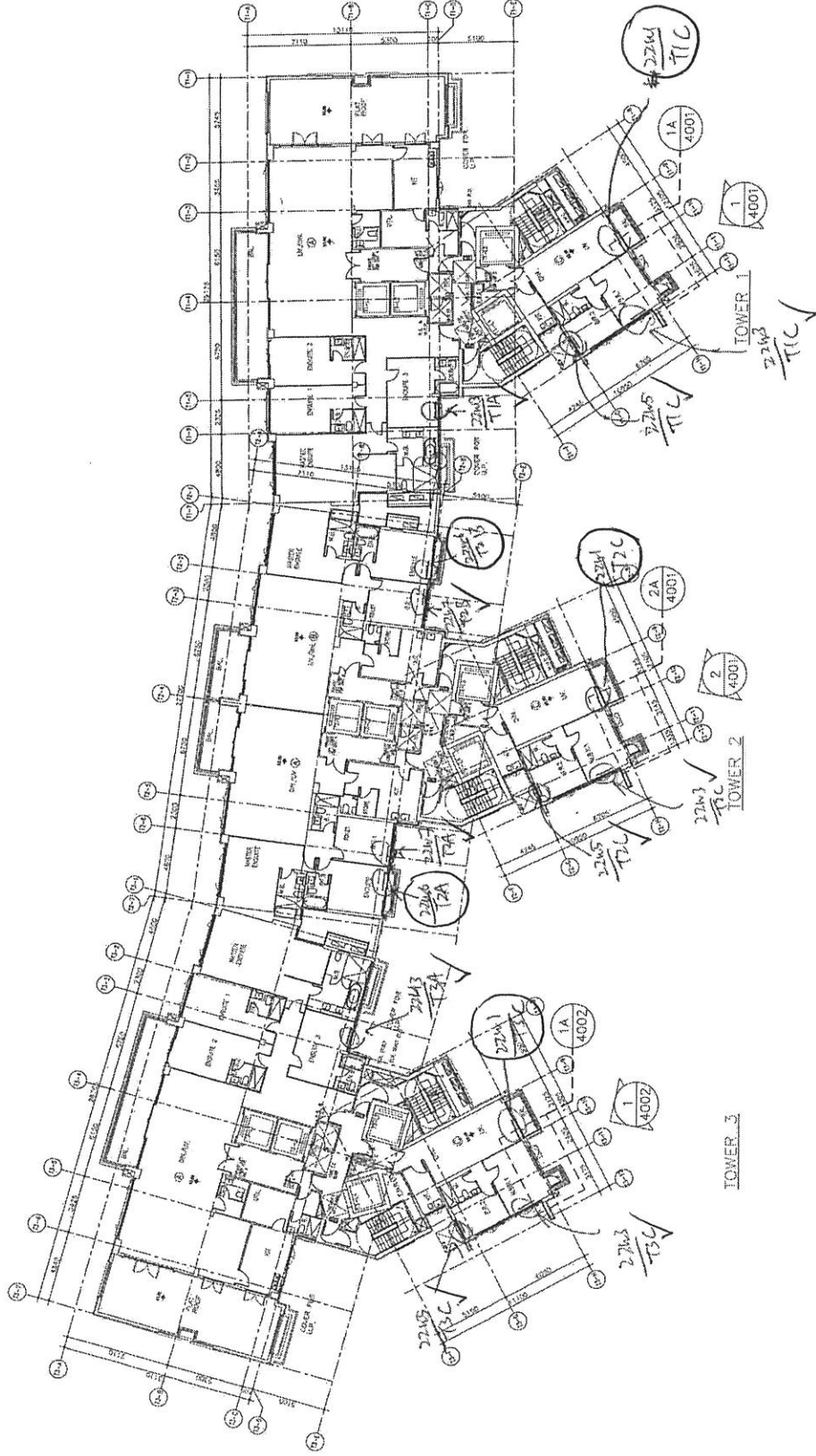

22/F only

22/F PLAN

UNLESS OTHERWISE SPECIFIED,
ALL DIMENSIONS SHALL BE IN MILLIMETERS (1/8" = 3.175mm)

B.D. REF :

CLIENT :

ARCHITECT :



MAIN CONTRACTOR :



STRUCTURAL ENGINEER :



FAÇADE CONSULTANT :



NOTE :

- 1. ALL DIMENSIONS ARE IN MM.
- 2. ALL EXPANSIONS ARE VIEWED FROM OUTSIDE.
- 3. ALL DIMENSIONS TO BE VERIFIED ON SITE BEFORE FABRICATION.

GENERAL :

- 1. F.F.L. --- FINISHED FLOOR LEVEL
- 2. S.F.L. --- STRUCTURAL FLOOR LEVEL
- 3. (R) --- REVERSED DETAIL

DETAIL MARK NO. REFER SHEET NO.

SCALE	DATE	NO.	REVISION
1:1	22-NOV-19	J-852	
PROJECT :			
PROPOSED RESIDENTIAL DEVELOPMENT			
AT 139 - 147 ARGYLE STREET,			
HKHL 6035, 6036 R.P., 6038 R.P.,			
6037 R.P. & 6038 R.P.			
TITLE :			
LAYOUT PLAN FOR			
CURTAIN WALL			
AT 23/F			
DATE :	SCALE :	CHECKED BY :	
22-NOV-19	1:300	OW	
DRAWN BY :			
MIN			
美特建築有限公司 MIDY ARCHITECTS LIMITED Unit 6-8, Sunny Heritage Centre, 8/F, One Suning Way, Kowloon TEL: 24242111-4, Fax: 252727255			
DWG NO. :	REV. :		
JR02-SD-CW-3004	-		

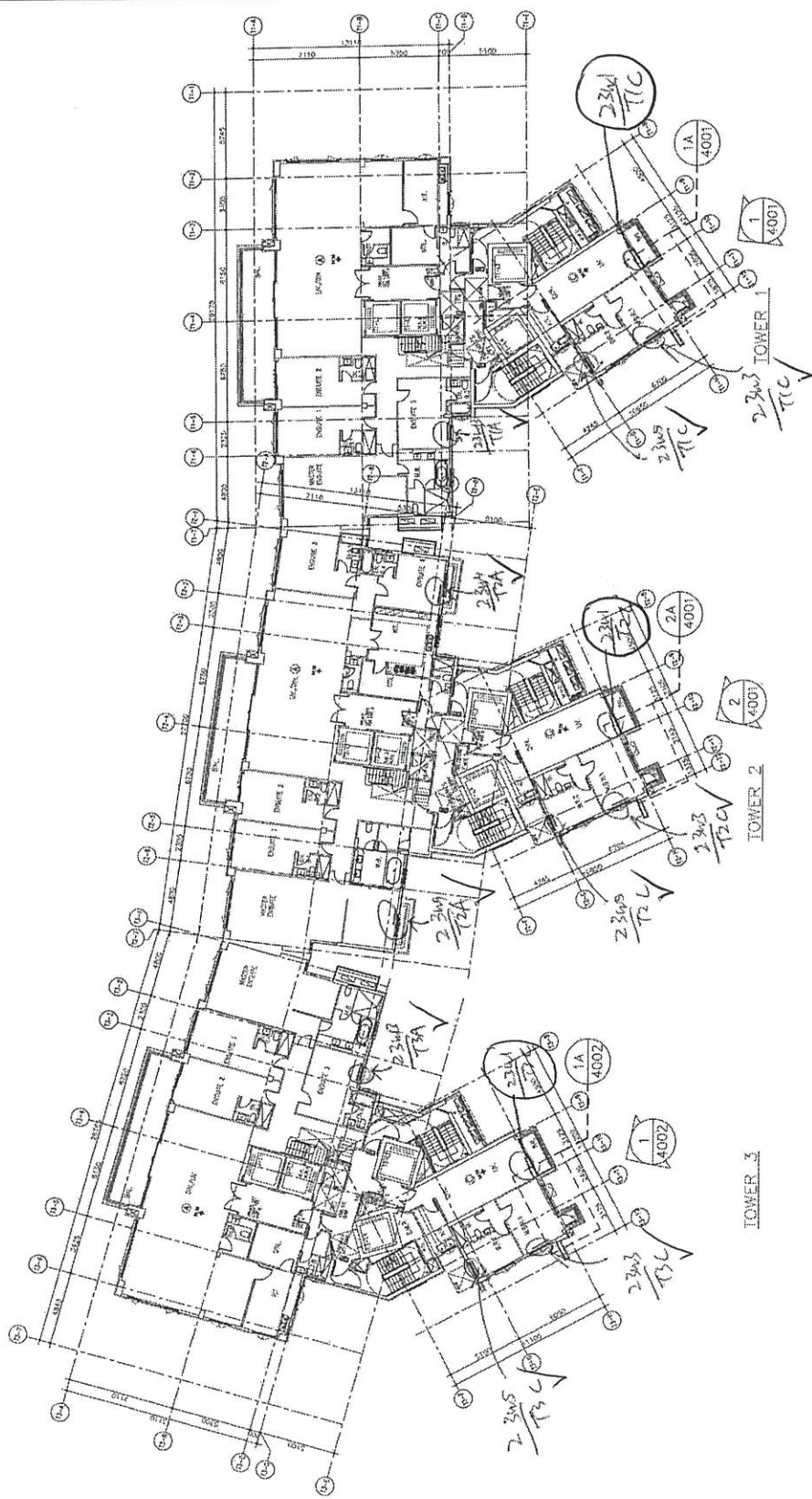

23/F

23/F PLAN
SUPERSEDED (ASD) 7.5.04

3