



工程指示 / 要求簡箋(E.I.)

工程指示編號：EI / 3765 / 21

修改版次：-

工程編號：J - 852

工程名稱：亞皆老街中電

工程項目：磨沙玻璃 Bending Test (玻璃樣板+安排公証行測試)

收件人：Maggie

發件人：Ant Yeung 日期：27/08/2021

要求提供 / 確認 事項：

- | | | |
|------------------------------------|-------------------------------------|-------------------------------|
| <input type="checkbox"/> 初步鋁料 B.M. | <input type="checkbox"/> 加工拆圖，然後生產 | <input type="checkbox"/> 尺寸表 |
| <input type="checkbox"/> 正式鋁料 B.M. | <input type="checkbox"/> 技術上資料 / 指示 | <input type="checkbox"/> 報價 |
| <input type="checkbox"/> 配件 B.M. | <input type="checkbox"/> 樣辦或貨品說明書 | <input type="checkbox"/> 分判合約 |

內容：

因應入則要求，請安排三鑫提供玻璃樣板及安排公証行為 10mm 及 6mm 磨沙片做 Bending Test

玻璃樣板：共 2 款 (全幅磨沙 pattern，已與少顏溝通有此款玻璃)

BENDING TEST 詳細資料已在後頁報告封面上提供

請留意，因應入則要求，玻璃名稱按以下：

1) 10mm thk. low-iron fritted pattern tempered glass 尺寸 1100X360mm，10 件 (D21070875)

2) 6mm thk. low-iron fritted pattern tempered glass 尺寸 1100X360mm，10 件 (D21070874)

請在 2021.09.30 前完成上列要求。

附：頁

以上項目為：

- 原合約工程包 原合約工程加 / 減賬 新工程報價

原因：-

分發東莞各部門：

- () 生產技術總監 連附件 () 技術部 連附件 () 生產部 連附件 () 機械設計部 連附件
 () 採購部 連附件 () 生產統籌部 連附件 () 小羅 & 清 連附件
 () 質檢部 連附件 () 會計部 連附件 () 報關組 連附件 () 其他 _____ 連附件

分發其他分判：

分發香港各部門：

- () 行政部 連附件 () 會計部 連附件 () 統籌部 連附件 () 工程部地盤科文 連附件 祥哥
 () 採購部 連附件 () QS 部 連附件 () 維修部 連附件 () 其他 _____ 連附件

傳遞編號：

HK / 21

發件人簽署：

項目經理簽署：

REPORT NO : GAL1712-121

DATE : DECEMBER 15, 2017

PAGE 1 OF 5

TEST REPORT

BENDING STRENGTH OF GLASS

Customer's Information

Customer and Address : *Gamma Engineering & Construction Company Limited (Main Contractor)*
~~Teamfield Building Contractors Ltd. (Main Contractor) / Midi Aluminium Fabricator Ltd.~~
Units 6-8, 1/F., Sunray Industrial Centre, 610 Cha Kwo Ling Road, Yau Tong, Kowloon, Hong Kong

Project and Address : ~~Yiu Sha Road, Whitehead, Ma On Shan, S.T.T.L. 581.~~ → *見批則信*

Glass information : Glass type and name : ~~8 mm thick tempered glass with fritted pattern (grey)~~
Nominal specimen size : 1100mm long x 360mm wide
No. of test specimens : (i) 5 pieces (pattern surface on tensile side)
(ii) 5 pieces (clear surface on tensile side)
Supplier : AVIC Sanxin Co., Ltd.
Pattern description : Fully fritted pattern (~~grey~~)

Test information

Test Performed : Bending Strength of Glass to BS EN 1288-3:2000.

Test Procedure : As described in Technical Manual : TM15 of Facadetech Laboratory Limited that is complied with Glass in Building – Determination of the Bending Strength of Glass to BS EN 1288-3:2000.

Specimen Received on : December 12, 2017

Equipment I.D. : Loading Machine S/N – FTL/PT/162

Date of Test : December 13, 2017

Tested by : Mr. Pang Chi Kin

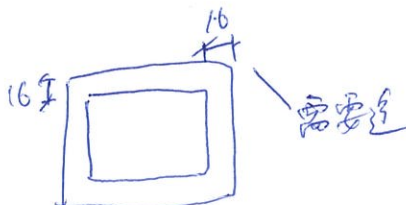

TESTED BY :

Pang
Mr. Pang Chi Kin

APPROVED SIGNATORY :

Chui Pui-Tak
Dr. Chui Pui-Tak, Peter

BD 零件名稱

① 10mm THK Fritted pattern tempered

② 6mm THK Fritted pattern tempered

批則信

Mr SIU Koon Hoi, Carmine
22/F Great Smart Tower,
230 Wanchai Road,
Wan Chai,
Hong Kong

2 June 2021

(42) →

project and
address

Dear Mr SIU

139-147 Argyle Street, Kowloon - K.I.L. 6038 R.P.,
K.I.L. 6037 R.P., K.I.L. 6036 R.P., K.I.L. 6035
R.P. and K.I.L. 6005

I refer to your application dated received on 5 May 2021 for approval of proposals in respect of Structural (Curtain Wall and Window) Amendment and the application for consent to the commencement and carrying out of the above building works.

2. Your submission of plans has been checked under the curtailed check system announced in Practice Note for Authorized Persons, Registered Structural Engineers and Registered Geotechnical Engineers ADM-19. On this basis, I am satisfied that your submission is fundamentally acceptable and may be approved.

3. You are reminded that the curtailed check system covers only the fundamental issues of a building proposal. Although non-fundamental issues will not be raised as reasons for disapproving a submission, I expect that all contraventions of the Buildings Ordinance and its subsidiary legislation are rectified as and when they are discovered and in any event, before completion of the works is certified. In this connection, I ask you to note that the Building Authority attaches great importance to the proper assumption of duties and responsibilities by authorized persons and registered structural engineers.

4. In accordance with the provisions of regulation 30(1) of the Building (Administration) Regulations, this is to notify that the above - mentioned plans submitted with your application dated received on 5 May 2021 are hereby approved. One set of the said plans, on which I have signified my approval, is enclosed. Your client has been sent a copy of this letter but I would request that you ensure that the contents are understood by him.

5. This approval should not be deemed to confer any title to land or to act as a waiver of any term in any lease or licence. Section 14(2) of the Buildings Ordinance refers.

6. Consent to the commencement and carrying out of the above Structural (Curtain Wall and Window) Amendment is given in the Form BD103 enclosed. You are reminded to ensure that the plans now approved are compatible with all previously approved plans, any conditions imposed are fulfilled and no works are carried out before all required plans have been approved and consent given. Your attention is drawn to paragraph 10 of Practice Note for Authorized Persons, Registered Structural Engineers and Registered Geotechnical Engineers APP-97.

/7.

S.L.9A (11/2009)

CW BD 466 B1)

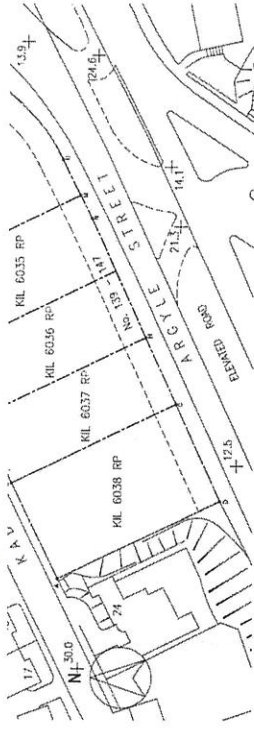

SAFETY TEST
 SAFETY TEST TO CLAUSE 8.3.1 OF CODE OF PRACTICE FOR STRUCTURAL USE OF GLASS 2018 WILL BE CARRIED OUT AT HOKIUS ACCREDITED LABORATORY. (EXTENT REFER TO DRAWING CE101)

(1) THE WORKING LOAD PER LOCK
 & THE CHARACTERISTIC STRENGTH
 DEVICE SHOULD BE VERIFIED
 AND TEST AS PER CRITERIA
 APP21

LEGEND:
 - S.S. KEEPER & S.S. LOCKING PIN (GRADE 304)
 - S.S. ANGLE KEEPER (GRADE 304)

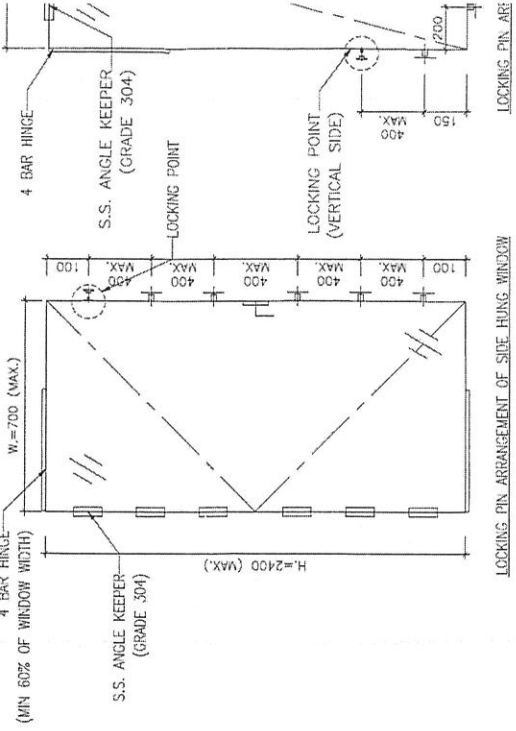

- GLO1 - 8mm THK. HEAT STRENGTHENED GLASS+12mm AIR GAP+10mm THK. TEMPERED GLASS (DEFLECTION LIMIT: 1260/60 = 21.00)
- GLO1a - 8mm THK. HEAT STRENGTHENED GLASS+9mm AIR GAP+12mm THK. TEMPERED GLASS (DEFLECTION LIMIT: 2060/60 = 34.33)
- GLO2 - 10mm THK. HEAT STRENGTHENED GLASS (SPANDREL GLASS) (DEFLECTION LIMIT: 880/60 = 14.67)
- GLO3 - 6mm THK. HEAT STRENGTHENED GLASS+12mm AIR GAP+6mm THK. TEMPERED GLASS (DEFLECTION LIMIT: 577/60 = 9.62)
- GLO4 - 10mm THK. TEMPERED GLASS (PROTECTIVE BARRIER) (DEFLECTION LIMIT: 746/60 = 11.67) FOR A.W.
- GLO11 - 8mm THK. HEAT STRENGTHENED GLASS+10mm THK. FRITTED PATTERN TEMPERED GLASS (DEFLECTION LIMIT: 470/60 = 7.83)
- GLO31 - 6mm THK. HEAT STRENGTHENED GLASS+12mm AIR GAP+6mm THK. FRITTED PATTERN TEMPERED GLASS (DEFLECTION LIMIT: 364/60 = 6.07)

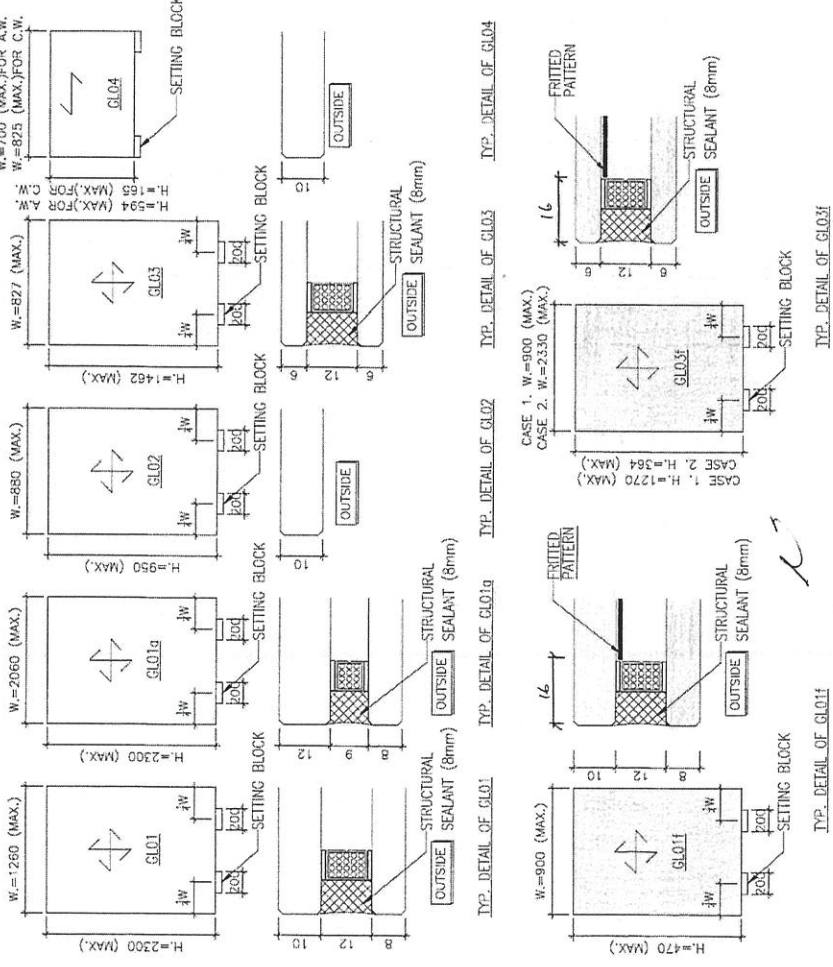

SEALANT, GASKET AND SETTING BLOCK

ALL STRUCTURAL SEALANT TO BE 'DOW CORNING 983' (HD-SS-001). ALLOWABLE STRESS = 1.38MPa.
 SECONDARY SEAL FOR GCU SHOULD BE 'DOW CORNING 983' SILICON STRUCTURAL SEALANT (HD-SS-001). ALLOWABLE STRESS = 1.38MPa.
 ALL WEATHER SEALANT TO BE 'DOW CORNING 791'. (FOR INFORMATION ONLY)
 ALL SETTING BLOCK SHALL BE SILICONE RUBBER WITH HARDNESS OF 65±5 SHORE A.
 MINIMUM 200mm IN LENGTH AT 1/8 SPAN UNLESS OTHERWISE STATED
 ALL GASKET SHALL BE NEOPRENE OR SILICONE RUBBER WHEN IN CONTACT WITH SEALANT. WITH HARDNESS OF 65±5 SHORE A.

RS (FOR DOMESTIC USE)

TO BE APPLIED ON ANY PART OF THE INFILL BETWEEN FLOOR AND TOP RAIL	(mm)
	0.5

RELIABLE STRUCTURAL STEEL AND S FOR OTHER SECTIONS.
 WITH MIN 85 μm COATING THICKNESS.
 AS TWO COATS OF ZINC RICH PRIMER TO BS 4652.

BS EN 755-2 AND BS EN 573-3.

EN 573-3.

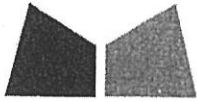

美特鋁質有限公司
MIDI ALUMINIUM FABRICATOR LTD.

Our ref. MC/40383/852

19th August 2021

Gammon Engineering & Construction Company Limited
139 - 147 Argyle Street,
Kowloon, Hong Kong

By Email & Hand

Attn.: Mr. Dick Yuen / Ms. Penny Chau

Dear Sir,

已上封報
解問已結

Re : Design, Supply & Installation of Aluminium Window & Cladding, Curtain Wall, Glass Wall, Louvers and Glass Balustrade Nominated Sub-Contract at K.I.L. 6038RP, K.I.L.6037RP, K.I.L. 6036RP, K.I.L. 6035RP & K.I.L. 6005, Nos. 139-147 Argyle Street, Kowloon.
Submission of Glass Sample for Bulk Order - Transparency Fritted Pattern Glass for Tower (MS092)

Regarding the captioned project, we would like to submit the transparency fritted pattern glass sample for bulk order for your review and comment.

- 1.) 8mm Low Iron Low-E(SEE0-83T) HS + 12A + 10mm Low Iron#3 Fritted pattern IGU
Size: 600x1200x30mm
Sample Code: D21070875
- 2.) 6mm Low Iron Low-E(SEE0-83T) HS + 12A + 6mm Low Iron#3 Fritted pattern IGU
Size: 600x1200x24mm
Sample Code: D21070874

Remarks:

1. The transparency fritted pattern glass sample with actual size are installed at T3,6B Ensuite bathroom.

Thank you for your kind attention.

Yours faithfully,
MIDI ALUMINIUM FABRICATOR LTD.

Francis Mau
Managing Director

Encl - 3 page(s)

cc. Gammon	- Mr. Chris Kwok / Ms. Myra Li / - Ms. Esther Chung / Mr. Sam Tang / - Mr. Jackson Mok / Mr. Joe Ng	(w/e)
Sino	- Mr. Billy Tang / Mr. Jimmy Cheung / - Mr. Terry Wan / Mr. Jaja Wong	(w/e) (Email Only)
AGC	- Mr. Raymond Ho / Mr. Eliot Chan	(w/e) (Email Only)
MFT	- Mr. Brian Leung / Mr. Nigel Lo - Ms. Eunice Yan / Ms. Cosimo Wong/ Mr. Neo Wong	(w/e) (Email Only)

M/MT/DW/AY/EL/KL/y1
九龍梨樂嶺道610號生利工業中心1樓6-8號
Units 6-8, 1st Floor, Sunray Industrial Centre, 610 Cha Kwo Ling Road, Kln.
TEL. (電話): 2348 9211 FAX. (傳真): 2772 7666 E-mail Address (電郵): midi@midiltd.com.hk.



ISO 9001 : 2015
Certificate No: CC 1795