

工程指示 / 要求簡箋(E.I.)

工程指示編號：EI 13244/21

修改版次：

工程編號：J - 852

工程名稱：亞皆老街中電

工程項目：鐘樓欄河用鋁板色辦

收件人：生統/平少

發件人：Bessie Lau

日期：01/04/2021

要求提供 / 確認 事項：

- | | | |
|------------------------------------|-------------------------------------|-------------------------------|
| <input type="checkbox"/> 初步鋁料 B.M. | <input type="checkbox"/> 加工拆圖，然後生產 | <input type="checkbox"/> 尺寸表 |
| <input type="checkbox"/> 正式鋁料 B.M. | <input type="checkbox"/> 技術上資料 / 指示 | <input type="checkbox"/> 報價 |
| <input type="checkbox"/> 配件 B.M. | <input type="checkbox"/> 樣辦或貨品說明書 | <input type="checkbox"/> 分判合約 |
| <input type="checkbox"/> 其他：_____ | | |

內容：

(白色)

煩請配鋁板色辦共 6 塊，色號:RAL9016, PPG, 3 COATING

請在 10/4/2021 前完成上列要求。

附有關圖紙 / 文件：

以上項目為：

- 原合約工程包 原合約工程加 / 減賬 新工程報價

原因：-

分發東莞各部門：

- () 生產技術總監 連附件 () 技術部 連附件 () 生產部 連附件 () 機械設計部 連附件
 () 採購部 連附件 () 生產統籌部 連附件
 () 質檢部 連附件 () 會計部 連附件 () 報關組 連附件 () 其他 平少 連附件

分發其他分判：

- () 水洪 連附件

分發香港各部門：

- () 行政部 連附件 () 會計部 連附件 () 統籌部 連附件 () 工程部地盤科文 連附件
 () 採購部 連附件 () QS 部 連附件 () 維修部 連附件 () 其他 _____ 連附件

傳遞編號：

JE 0692/21

發件人簽署：

項目經理簽署：

From: "Eliot Chan" <eliotchan@agcdesign.com.hk>
To: "' Dan Yuen Chung Ho' " <Dan.Ho@gammonconstruction.com>,
' Chris Ching Wa Kwok' " <Chris.Kwok@gammonconstruction.com>,
' Myra Pui Lai Li' " <Myra.Li@gammonconstruction.com>,
<midi@midiltd.com.hk>, <bessie.lps.midi@gmail.com>,
<marcotam@midiltd.com.hk>, "' J3860' " <j3860@gammonconstruction.com>
Copies to: "' Billy Tang \ (Development)' " <billytang@sino.com>,
<jimmynhcheung@sino.com>, <peterchong@sino.com>, <kil6038@sino.com>,
' Jackson Chor Chiu Mok' " <Jackson.Mok@gammonconstruction.com>,
<j554@agcdesign.com.hk>, "' Tse, Dennis Chun-Pan' " <Dennis.Tse@wsp.com>,
<Mirage.Li@wsp.com>
Subject: CLP - CTB - Colour of metal works at Clock tower
Date sent: Thu, 1 Apr 2021 15:20:06 +0800

Dear Gammon/Midi,

Regarding your previous query on the colour of handrail at staircase, alum. capping at glass balustrade, etc., please note that "semi matt tusky white" (RAL9016) will be used for metal works on the exit staircase handrail and balustrade (refer to attached location for reference). Nosing tile to be white non-slip mosaic (CT-33 on material schedule) and the epoxy paint colour on floor shall follow colour of adjacent wall.

Please prepare your material/sample submission based on the above accordingly for our review.

Thank you.

Warm regards,

Eliot Chan

AGC Design Ltd.

16/F Olympia Plaza 255 King's Road Hong Kong

香港北角英皇道二五五號國都廣場十六樓

(D) 2503 6626 (T) 2219 7188 (F) 2219 7133

Disclaimer:

This e-mail message (together with any attachments) is confidential to the addressee and may also be privileged. If you are not the intended recipient, you are hereby notified that any dissemination, distribution or copying of this message is strictly prohibited. Please also notify the sender immediately by return e-mail and delete it from your system.

Internet communications cannot be guaranteed to be secure or error-free. The sender and the entity through which this message is sent therefore do not accept liability for errors or omissions as contained in the message and any spreading of viruses as a result of Internet transmission.

Any opinions contained in this message are those of the sender personally and would not bind any entity unless otherwise clearly stated and with the authority of the sender duly verified.

From: "Eliot Chan" <eliotchan@agcdesign.com.hk>
To: "Dan Yuen Chung Ho" <Dan.Ho@gammonconstruction.com>, "Chris Ching Wa Kwok" <Chris.Kwok@gammonconstruction.com>, "Myra Pui Lai Li" <Myra.Li@gammonconstruction.com>, <midi@midiltd.com.hk>, <bessie.lps.midi@gmail.com>, <marcotam@midiltd.com.hk>, "J3860" <j3860@gammonconstruction.com>
Subject: CLP - CTB - Colour of metal works at Clock tower
Date sent: Thu, 1 Apr 2021 15:20:06 +0800
Copies to: "Billy Tang \ (Development)" <billytang@sino.com>, <jimmynhcheung@sino.com>, <peterchong@sino.com>, <kil6038@sino.com>, "Jackson Chor Chiu Mok" <Jackson.Mok@gammonconstruction.com>, <j554@agcdesign.com.hk>, "Tse, Dennis Chun-Pan" <Dennis.Tse@wsp.com>, <Mirage.Li@wsp.com>

Dear Gammon/Midi,

Regarding your previous query on the colour of handrail at staircase, alum. capping at glass balustrade, etc., please note that "semi matt tusky white" (RAL9016) will be used for metal works on the exit staircase handrail and balustrade (refer to attached location for reference). Nosing tile to be white non-slip mosaic (CT-33 on material schedule) and the epoxy paint colour on floor shall follow colour of adjacent wall.

Please prepare your material/sample submission based on the above accordingly for our review.

Thank you.

Warm regards,
Eliot Chan

AGC Design Ltd.

16/F Olympia Plaza 255 King's Road Hong Kong
香港北角英皇道二五五號國都廣場十六樓
(D) 2503 6626 (T) 2219 7188 (F) 2219 7133

柯可揚
揚

頁 3 2 44

Disclaimer:

This e-mail message (together with any attachments) is confidential to the addressee and may also be privileged. If you are not the intended recipient, you are hereby notified that any dissemination, distribution or copying of this message is strictly prohibited. Please also notify the sender immediately by return e-mail and delete it from your system.

Internet communications cannot be guaranteed to be secure or error-free. The sender and the entity through which this message is sent therefore do not accept liability for errors or omissions as contained in the message and any spreading of viruses as a result of Internet transmission.

Any opinions contained in this message are those of the sender personally and would not bind any entity unless otherwise clearly stated and with the authority of the sender duly verified.

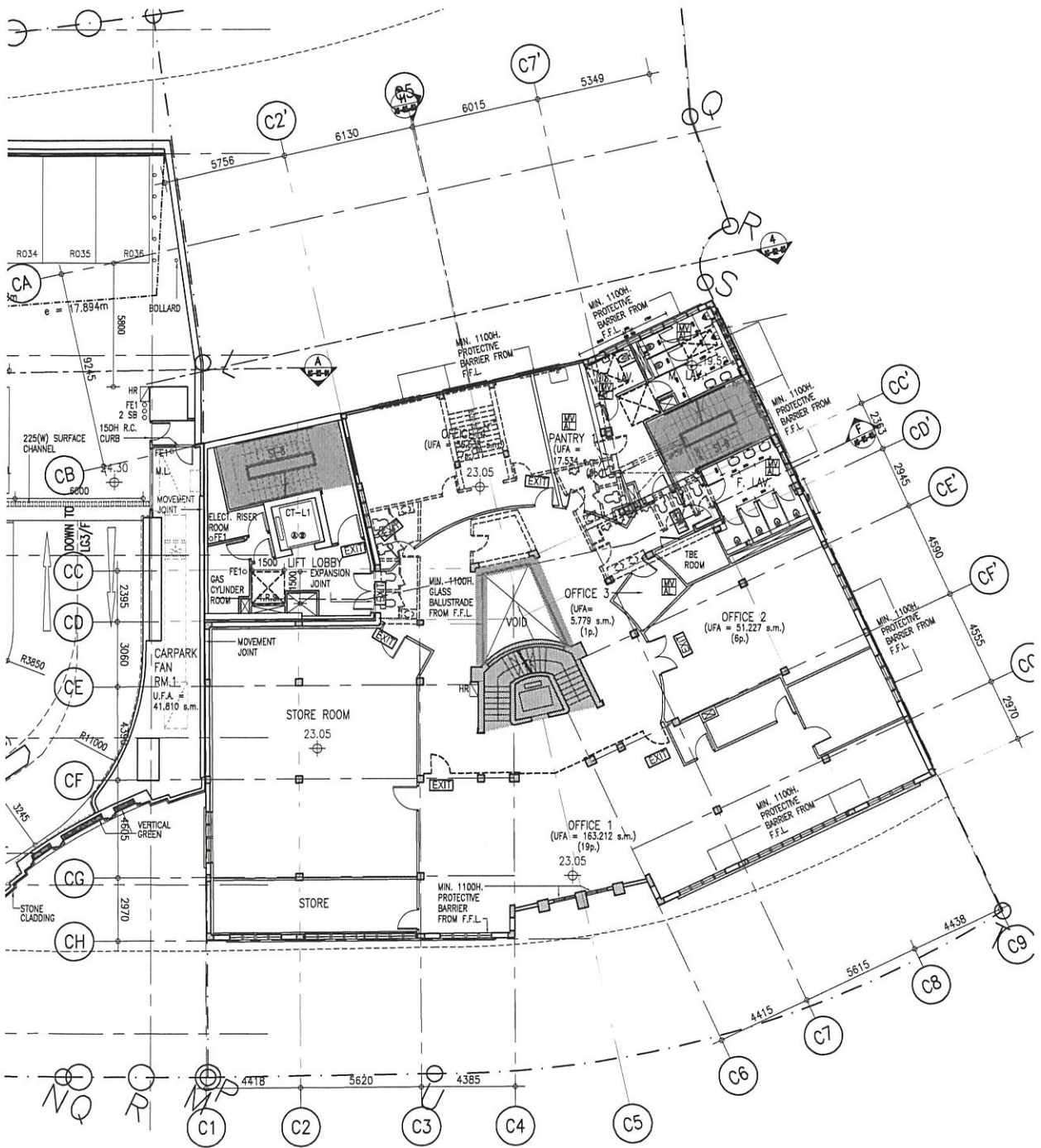

CLOCK TOWER BUILDING SECOND FLOOR PLAN