

工程指示 / 要求簡箋(E.I.)

工程指示編號：EI / 3175 / 21

修改版次：G

工程編號：J - 852

工程名稱：亞皆老街中電

工程項目：佛沙窗 地盤用玻璃 B.M. 大貨 (T1-T3) (1-21/F) (3006 件) 暫停磨砂玻璃

收件人：Maggie

發件人：Ant Yeung

日期：16/07/2021

要求提供 / 確認 事項：

- () 初步鋁料 B.M. () 加工拆圖，然後生產 () 尺寸表
 () 正式鋁料 B.M. () 技術上資料 / 指示 () 報價
 內容：

G 版：因顧問拒絕批核 acid etched 磨砂玻璃。現暫停生產所有磨砂玻璃。

F 版：按三鑫要求修改 BM 內玻璃款式位置表示方式。尺寸+數量沒有更改。

E 版：因則師要求修改磨沙玻璃位置，請留意部份磨沙的玻璃改為清片。

D 版：可放行生產及欄河玻璃+浴室磨沙玻璃。EI2549~EI2551 已生產 T1-T3: 5/F 欄河玻璃。附上完整位置圖。

C 版：業主要求浴室玻璃更改為磨沙玻璃，玻璃厚度需重新計算。請暫停生產廁所位置的玻璃。

B 版：本司和判頭也已同意確認包箱方法，無位置暫存，必須是分座分層。大玻璃獨立包，廚廁分開包
請按 BM 訂購 T1-T3: 1-21/F 佛沙窗玻璃 (共 2,992 件) (T1: 1,067 件. T2: 958 件. T3: 981 件) 直送地盤。
包裝要分座分層。* T3 優先出貨

GL01a-01: D21010039 (2390x2070) (共:35 件- 分 T1, T3) 為大玻璃 (未能入沙機) 須另外分箱包裝。

IGU 膠用 DC983 結構膠

玻璃要做熱浸。 Low-E: SEE0-83T.

請留意玻璃加工時不要固定的鋼化及熱浸標籤。玻璃出貨時需加上"可移除" 標籤。

單片：標籤在室外面 (注明半鋼化/ 鋼化); IGU: 標籤在室內外面 (注明半鋼化/ 鋼化)

附： 3 頁 BM+ 12 頁 MFT Comment

以上項目為：

- 原合約工程包 原合約工程加 / 減賬 新工程報價

原因：-

分發東莞各部門：

- () 生產技術總監口連附件 () 技術部 口連附件 () 生產部 口連附件 () 機械設計部口連附件
 () 採購部 口連附件 () 生產統籌部口連附件 () 小羅&清 口連附件
 () 質檢部 口連附件 () 會計部 口連附件 () 報關組 口連附件 () 其他 楊榮輝 口連附件

分發其他分判：

- (v) 水洪 口連附件

分發香港各部門：

- () 行政部口連附件 () 會計部口連附件 () 統籌部口連附件 () 工程部地盤科文口連附件 祥哥
 () 採購部口連附件 () QS 部 口連附件 () 維修部口連附件 () 其他 口連附件

傳遞編號：

發件人簽署：

項目經理簽署：

MATERIAL / SAMPLE SUBMISSION FORM

To : Mr Brian Leung / Mr Nigel Lo / Ms Eunice Yan
Meinhardt Façade Technology (HK) Ltd
 22/F Great Smart Tower,
 230 Wanchai Road,
 Wan Chai, Hong Kong

No. MS/A/334 (Rev. 0)

Date: 28 May 2021

REQUIRED APPROVAL DATE: 11 June 2021

Ref. J3860/304.6/D10245

We submit the following material for your comment / approval by the date indicated above.

 Sub-Contractor / Trade: Midi Aluminium Fabrication Ltd/ Curtain Wall, Aluminium Windows and Louvres, Aluminium Cladding and Glass Balustrade

 Material Description: Submission of Glass Samples for Bulk Order - Acid Etched Glass for Tower (MS083)
 Comply fully w/ Specification MFT's specification **Not comply fully with Specification (Deviation Listed herein)** N.A.

Equipment Originally Offered

 Type : N.A.
 Manufacturer : N.A.
 Origin : N.A.
 Model No : N.A.

Equipment Offer

 Type : Glass
 Manufacturer : Avic Sanxin
 Origin : China
 Model No : Refer to attachment

 Reason for change if any : N.A.
Location for use: Windows for 1 - 23/F Bathroom, 22 - 23/F Master Ensuite as per attached marked up
Enclosures: Catalogue Data / Specification Certificate / Approval
 Test Report Material Sample Installation Drawing
 Job Reference Schedule Other (specify):

Remarks: There are 2 sets of sample kept on site for review and approval.

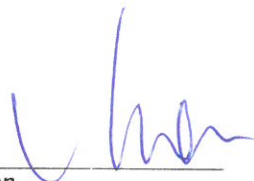
<p>cc <input checked="" type="checkbox"/> Pacific Shine - Mr Billy Tang / Mr Kocher Wong / Mr Edwin Chow / Mr Simon Chung / Mr Ross Pau / Mr Ken Ng / Mr Wyman Fong / Mr Jimmy Cheung / Mr C F Lee / Mr Peter Chong</p> <p><input checked="" type="checkbox"/> AGC - Ms Grace Cheng / Mr Raymond Ho</p> <p><input type="checkbox"/> ARUP (Stru) - Mr Johnson Po / Mr Keith Ng / Mr Wayne Ke / Mr Andrew Tai</p> <p><input type="checkbox"/> W&O - Mr Nier Chan / Mr Anson Lau</p> <p><input checked="" type="checkbox"/> Arcadis - Ms Brenda Mok / Ms Emily Chu</p> <p><input type="checkbox"/> AXXA - Ms Siuman Hung / Ms Sammy Tang / Mr Oscar Leung / Ms Yvonne Yau</p> <p><input type="checkbox"/> ARUP (Traffic) - Ms Carmen Chu / Mr Eddy Cheung</p> <p><input type="checkbox"/> WSP - Ms Anthea Ng / Mr Dennis Tse</p> <p><input type="checkbox"/> Ramboll - Mr Calvin Chiu / Mr Peter Leung / Mr Alvin Chan</p> <p><input type="checkbox"/> RE - Mr Edwin Lui / Mr Raymond Hui / Mr Jayden Wong</p> <p><input checked="" type="checkbox"/> MFT RE - Ms Cosimo Wong / Mr Neo Wong</p> <p><input checked="" type="checkbox"/> OSR - Mr H T Tseung / Mr Poon Tsz Kit / Mr Jaja Wong / Mr Elvis Lam</p> <p><input type="checkbox"/> BSI (Sino) - Mr Kelvin Tam</p> <p><input type="checkbox"/> RBSE (W&O) - Mr Kevin Lee</p> <p><input checked="" type="checkbox"/> S/C - Midi (By Email)</p>	 Dick Yuen Senior Project Manager Gammon Engineering & Construction Company Limited DY/JM/CK/PC/wym
---	--

Encl

Architect's / Consultant's Reply
 Approved (A) Approved with comment (B) Approved with comment & resubmit (C) Rejected (D)

Comments : Coatings of glass shall be referred to facade specification.

 Signed : PP = Yuen Designation : MFT Date : 14 Jul 2021

 Remarks : w/encl. w/o encl



美特鋁質有限公司
MIDI ALUMINIUM FABRICATOR LTD.

Our ref. MC/40172/852

26th May 2021

Gammon Engineering & Construction Company Limited
139 - 147 Argyle Street,
Kowloon, Hong Kong

By Email & Hand

Attn.: Mr. Dick Yuen / Ms. Penny Chau

Dear Sir,

Re : Design, Supply & Installation of Aluminium Window & Cladding, Curtain Wall, Glass Wall, Louvers and Glass Balustrade Nominated Sub-Contract at K.I.L. 6038RP, K.I.L.6037RP, K.I.L. 6036RP, K.I.L. 6035RP & K.I.L. 6005, Nos. 139-147 Argyle Street, Kowloon.

Submission of Glass Samples for Bulk Order - Acid Etched Glass for Tower (MS083)

Further to the captioned project, we would like to submit acid etched glass samples for bulk order for your review and comment.

- 1) 8mm low-iron HS (with low-e coating in light grey colour at surface #2) + 12mm Air Gap + 10mm low-iron HST (acid etched at surface #3)
Sample Code : D21041726 (8SEE0-83T (HS)+12A+10CBYP)
Location: Fixed Windows - 1~23/F Bathroom, 22~23/F Master Ensuite
- 2) 6mm low-iron HS (with low-e coating in light grey colour at surface #2) + 12mm Air Gap + 6mm low-iron HST (acid etched at surface #3)
Sample Code : D21041725 (6SEE0-83T (HS)+12A+6CBYP)
Location: Openable Windows - 1~23/F Bathroom, 22~23/F Master Ensuite

We would deliver glass samples to site and each type of glass sample would be submitted in 2 sets. For details, please refer to the attached location plan, glass data and sample photos.

Thank you for your kind attention.

Yours faithfully,
MIDI ALUMINIUM FABRICATOR LTD.

Francis Mau
Managing Director

Encl

cc. Gammon	- Mr. Chris Kwok / Ms. Myra Li / - Ms. Esther Chung / Mr. Sam Tang / - Mr. Jackson Mok /	(w/e)
Sino	- Mr. Billy Tang / Mr. Jimmy Cheung / - Mr. Terry Wan / Mr. Jaja Wong	(w/e) (Email Only)
AGC	- Mr. Raymond Ho / Mr. Eliot Chan	(w/e) (Email Only)
Arup	- Mr. Edwin Lui / Mr. Andrew Tai	(w/e) (Email Only)
MFT	- Mr. Brian Leung / Mr. Nigel Lo - Ms. Eunice Yan / Ms. Cosimo Wong / Mr. Neo Wong	(w/e) (Email Only)

九龍茶葉領道610號生利工業中心1樓6-8號

Units 6-8, 1st Floor, Sunray Industrial Centre, 610 Cha Kwo Ling Road, Kln.

TEL. (電話) : 2348 9211 FAX. (傳真) : 2772 7666 E-mail Address (電郵) : midi@midiltd.com.hk.



ISO 9001 : 2015
Certificate No: CC 1795



MIDI ALUMINIUM FABRICATOR LTD.

Units 6, 7, 8 Sunway Industrial Centre, 1st Floor, 610 Cha Kwo Ling Road Kowloon.

Project : Nos. 139-147 Argyle Street, Kowloon.

Subject : Glass Samples for Bulk Order - Acid Etched Glass for Tower (MS083)

6mm low-iron HS (with low-e coating in light grey colour at surface #2) +
12mm Air Gap + 6mm low-iron HST (acid etched at surface #3)

Sample Code : D21041725 (6SEED-83T (HS)+12A+6CBYP)

Location : Openable Windows - 1-23/F Bathroom, 22-23/F Master Ensuite

Letter ref. : MC/40172/852

Date : 26th May 2021

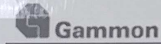

J3860 - Proposed Residential Development, At 139 – 147 Argyle Street, Kowloon

Submission Ref. no.:	MC/ 40172 /852	Authorized Representative:	<input type="checkbox"/> Pacific Shine <input type="checkbox"/> AGC <input type="checkbox"/> ARUP <input type="checkbox"/> WOY	<input type="checkbox"/> MFT <input type="checkbox"/> AXXA <input type="checkbox"/> <input type="checkbox"/>
Material Description:	Submission of Glass Samples for Bulk Order - Acid Etched Glass for Tower (MS083)	Name:		
Submission Date:	26/05/2021	Signature:		
Approval Date:		Signature Date:		
Comment:				





MIDI ALUMINIUM FABRICATOR LTD.

Units 6, 7, 8 Survey Industrial Centre, 1st Floor, 610 Che Kwo Ling Road, Kowloon.

Project : Nos. 139-147 Argyle Street, Kowloon

Subject : Glass Samples for Bulk Order - Acid Etched Glass for Tower (MS083)

Notes: low-iron ISG (with low-e coating in light grey colour at surface #2) -
12mm Air Gap - 10mm low-iron HST (acid etched at surface #1)

Sample Code : D21041726 (KSEEN-KYT (125)-124-10C18V9)

Location : Fixed Windows - 1-25/F Bathroom, 22-25/F Master Bedroom

Letter ref : MC/40172/852

Date : 26th May 2021



Gammon

J3860 - Proposed Residential Development, At 139 - 147 Argyle Street, Kowloon

Submission Ref. no.:	MC/ 40172 /852	Authorized Representative:	<input type="checkbox"/> Pacific Shine <input type="checkbox"/> AGC <input type="checkbox"/> ARUP <input type="checkbox"/> WOY	<input type="checkbox"/> MFT <input type="checkbox"/> AXXA <input type="checkbox"/> <input type="checkbox"/>
Material Description:	Submission of Glass Samples for Bulk Order - Acid Etched Glass for Tower (MS083)	Name:		
Submission Date:	26/05/2021	Signature:		
Approval Date:		Signature Date:		
Comment:				



玻璃性能参数

PHOTOMETRIC PROPERTIES

客户名称：美特

项目名： 亚皆老街中电

时间：20/5-2021

玻璃产品 Class Product	厚度 (毫米) Thickness (mm)	可见光 Light characteristics			太阳热能 Energy characteristics					U-值
		透光率 trans (%)	反光率Reflection		热直透率 trans (%)	热反射率 Reflection(%)	热吸收率 Abs (%)	热能系数 SolarFactor	遮阳系数 Shading Coefficient	U-Value
			外Out (%)	内In (%)						空气 (W/M ²)
L.T.	L.R.	L.R.	D.E.T	E.R	E.A.	S.F.	S.C.	AIR		
8mm low iron #2 SEE-83T+12A+10mm low iron #3 acid etched <i>D21041726</i>		77%	12%	12%	56%	24%	20%	0.59	0.68	1.73
6mm low iron #2 SEE-83T+12A+6mm low iron #3 acid etched <i>D21041725</i>		77%	12%	12%	56%	24%	20%	0.59	0.68	1.75

1. The performance data shown are nominal and subject to variations due to manufacturing tolerances.
2. A slight shift in visible light reflectance or transmission may be noticed after heat-treatment.
3. The tolerance of data with respect to photometric properties is ± 3 points.
4. The U-value tolerance is ± 0.1 W/m².k.
5. Specifications technical and other data are based on information available at the time of preparation this document and are subject to change without prior notice.
6. The above performance parameters calculated in accordance with WINDOW6 software.All data are just for your reference, not as an official contract.

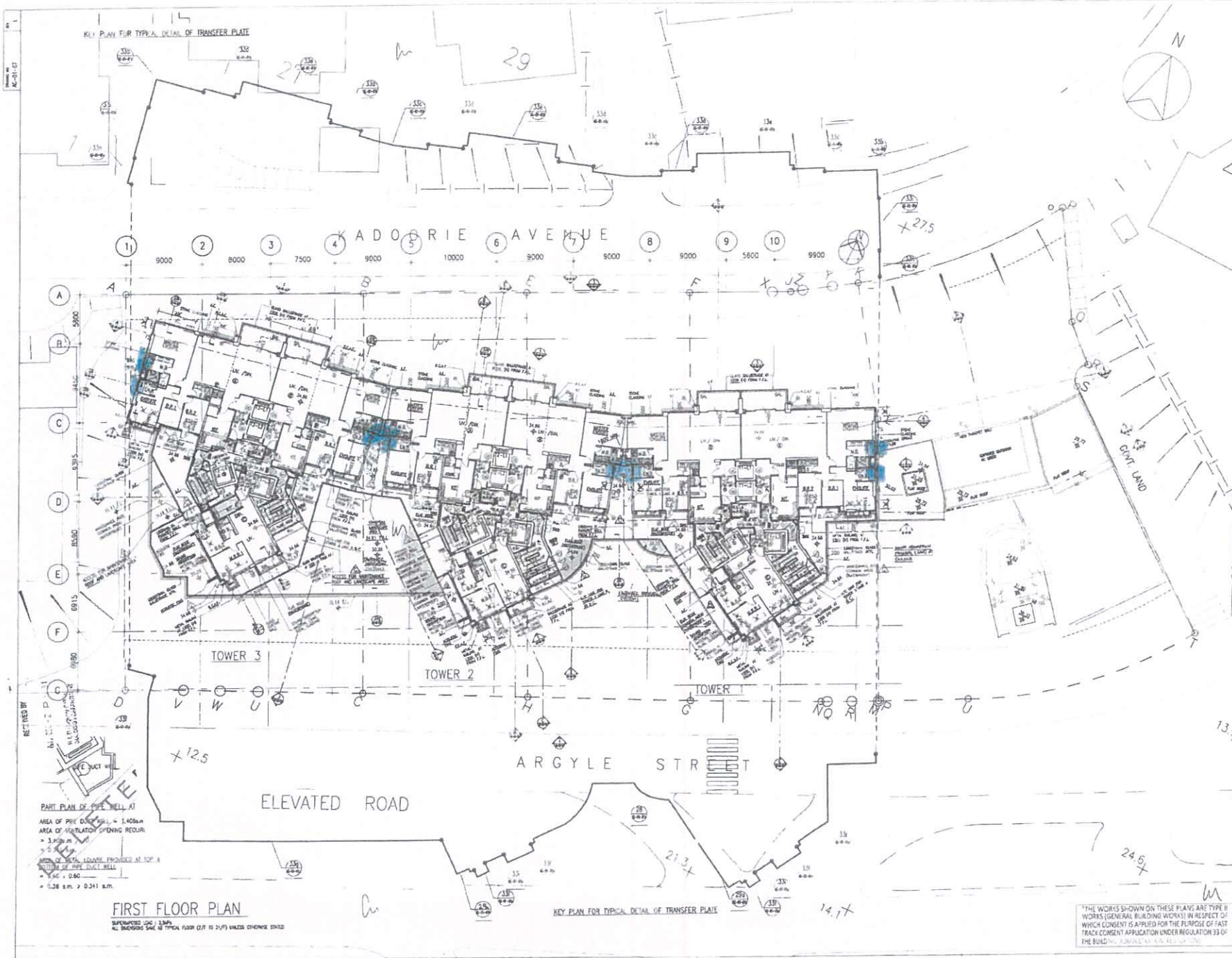

NO. 107 / 107 / 107 / 107 (1/1)
 NO. 107 / 107 / 107 / 107

- LEGEND:**
- PRECAST FACADE
 - MAX 500mm SUMMER SLAB
 - CONTAINING ACCESS ROUTES FOR MAINTENANCE UNDER APP-93
 - AB * ACOUSTIC BALCONY
 - AD * ACOUSTIC DOOR (BATLE TYPE)
 - AW * ACOUSTIC WINDOW
 - M * FIBRE GLASS / FIBRE GLASS WITH MAINTENANCE
 - SC * WITH SELF-CLOSING MECHANISM FOR L.L.S. DOOR
 - SA * SOUND ABSORPTIVE MATERIAL
 - OA * WINDOW OPENABLE AREA
 - AF * ARCHITECTURAL FEATURE

MAINTENANCE ACCESS BY SERVICE
 AS APPLICABLE

WING Yan-yan
 Senior Building Surveyor
 for BUILDING AUTHORITY
 30 DEC 2019

Grace Chang
 Grace Chang
 for and on behalf of
 AGC Design Ltd.

BD
AMENDED PLAN 02 DEC 2019

NO.	DESCRIPTION	DATE
A	BD RE-SUBMISSION	12.2011 CC
B	MAJOR AMENDMENT	03.2011 CC
C	MAJOR AMENDMENT	11.2011 CC
D	MINOR AMENDMENT	04.2013 CC
E	MINOR AMENDMENT	02.2013 CC
F	MINOR AMENDMENT	11.2013 CC
G	MAJOR AMENDMENT	07.2015 CC
H	AMENDMENT	01.2016 CC
J	AMENDMENT	07.2016 CC
K	AMENDMENT	10.2016 CC
L	AMENDMENT	12.2016 CC

AGC
DESIGN LTD

新加坡建築師有限公司
 181, Cross Street, 201, Singapore, Singapore
 Tel: (65) 63371818; Fax: (65) 63371813; Email: agc@agc.com.sg

PROPOSED RESIDENTIAL DEVELOPMENT
 AT 139-147 ARGYLE STREET,
 KOWLOON INLAND LOT Nos. 6005,
 6035 R.P., 6036 R.P., 6037 R.P.
 & 6038 R.P.

FIRST FLOOR PLAN
 (1/F)

NO.	DATE	BY	CHK	APP
107	12/11/19	WY	GC	AC-01-02-04
107	12/11/19	WY	GC	AC-01-02-04
107	12/11/19	WY	GC	AC-01-02-04

THE WORKS SHOWN ON THESE PLANS ARE TYPE B WORKS (GENERAL BUILDING WORKS) IN RESPECT OF WHICH CONSENT IS APPLIED FOR THE PURPOSE OF FAST TRACK CONSENT APPLICATION UNDER REGULATION 33 OF THE BUILDING (CONSTRUCTION) REGULATIONS 2012.

FIRST FLOOR PLAN

SUPERPOSED SCALE: 1:200
 ALL DIMENSIONS SHOWN ON TYPICAL FLOOR (0/1 TO 21/F) UNLESS OTHERWISE STATED

PART PLAN OF PIPE WELL AT
 AREA OF PIPE DIA. 1500mm
 AREA OF VENTILATION CROWDING REQUIRED
 = 3.20sq.m
 = 3.20sq.m
 AREA OF OPEN LOUVER PROVIDED AT TOP A
 WIDTH OF PIPE DIA. WELL
 = 1.50 x 0.50
 = 0.75 sq.m > 0.341 sq.m.

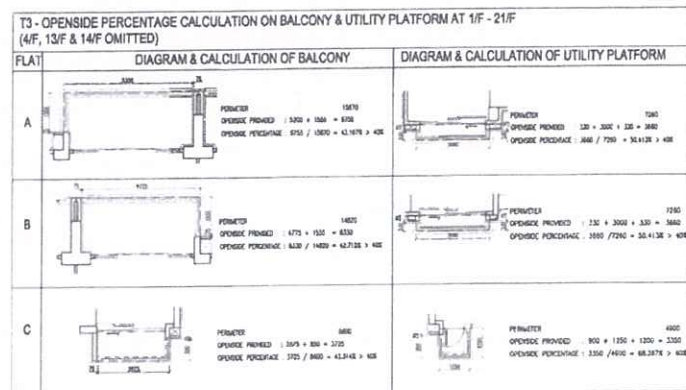
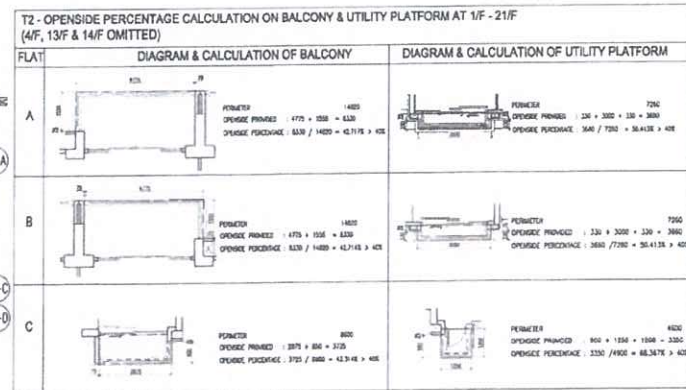
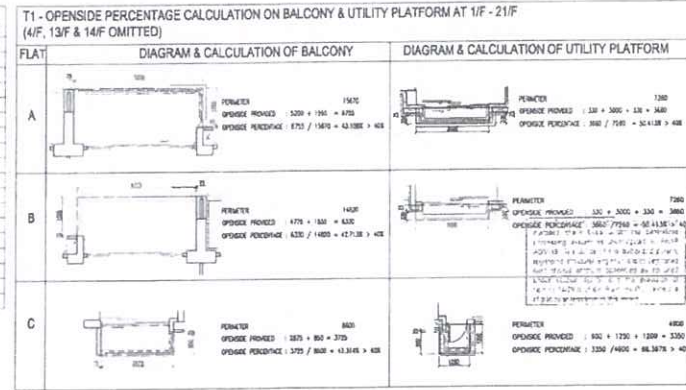
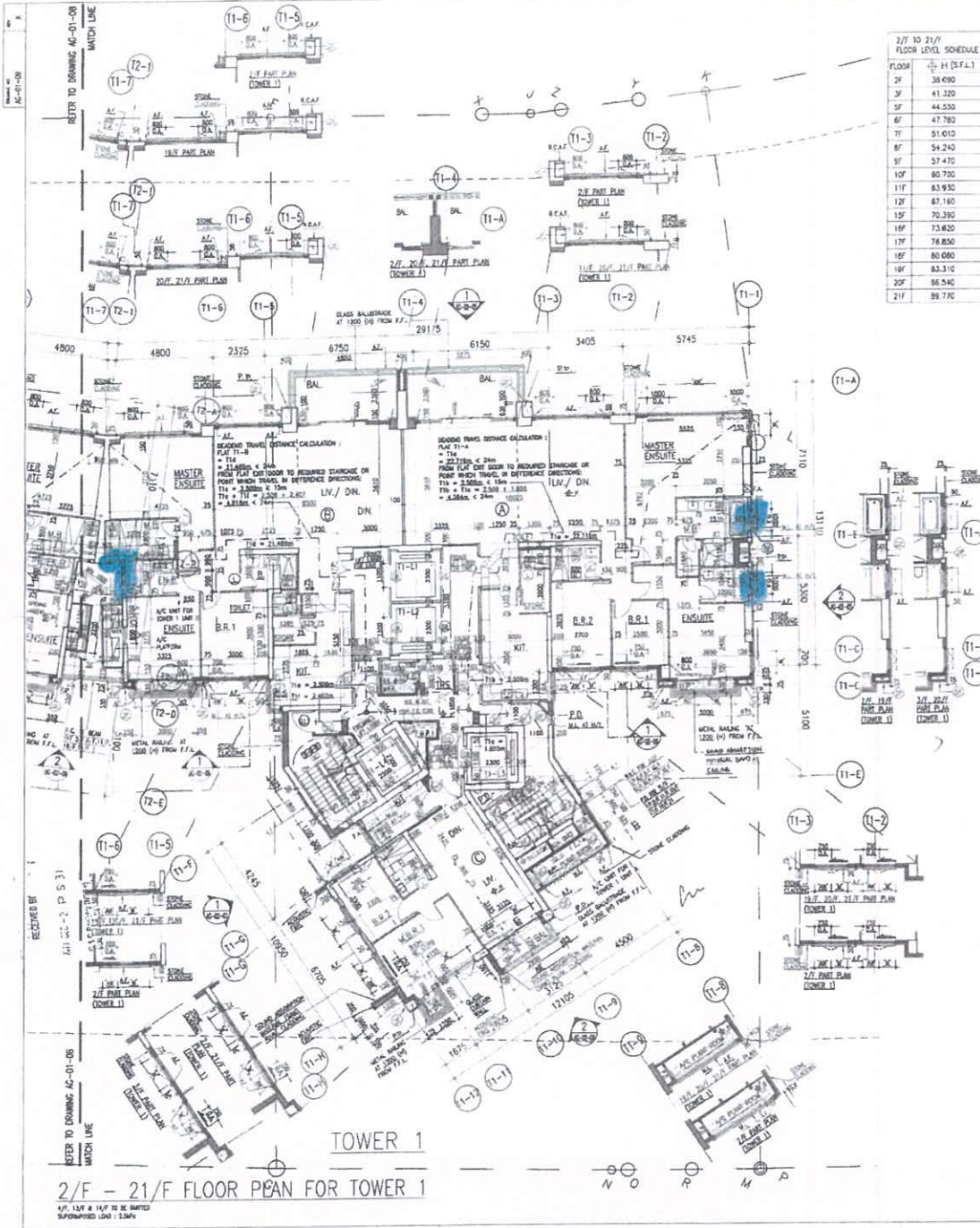

LEGEND:

- PHILDS' FACADE
- MAX 500mm SUNKEN SLAB
- COMMON ACCESS ROUTES FOR MAINTENANCE LADDER APP-93
- AB' ACOUSTIC BALCONY
- AD' ACOUSTIC DOOR (BATTLE TYPE)
- AW' ACOUSTIC WINDOW
- M' FIXED GLAZING FIELD GLAZING WITH MAINTENANCE
- SC' WITH SELF-CLOSING MECHANISM FOR HELP SCOR
- SA' SOUND ABSORBENT MATERIAL
- QA' WINDOW OPENABLE AREA
- AF' ARCHITECTURAL FEATURE

Plan Approved *[Signature]*
WONG Yan-Yan
 Senior Building Surveyor
 for BUILDING AUTHORITY
 30 DEC 2019

Cheng Chung
 Cheng Yan Ying Group
 for and on behalf of
 AGC Design Ltd
 Authorized Person
 (List of Architects)
BD
AMENDED PLAN 02 DEC 2019

REVISION	DESCRIPTION	BY	DATE	APPROVAL
A	BD RE-SUBMISSION	WPK	02.2019	CC
B	MAJOR AMENDMENT	WPK	03.2019	CC
C	MAJOR AMENDMENT	WPK	11.2019	CC
D	MINOR AMENDMENT	WPK	03.2019	CC
E	MINOR AMENDMENT	WPK	05.2019	CC
F	MAJOR AMENDMENT	WPK	07.2019	CC
G	AMENDMENT	SM	03.2019	CC
H	AMENDMENT	SM	07.2019	CC
J	AMENDMENT	WPK	09.2019	CC
K	AMENDMENT	AC	12.2019	CC

AGC DESIGN LTD

AGC DESIGN LIMITED
 11/F, 12/F, 13/F, 14/F, 15/F, 16/F, 17/F, 18/F, 19/F, 20/F, 21/F, 22/F, 23/F, 24/F, 25/F, 26/F, 27/F, 28/F, 29/F, 30/F, 31/F, 32/F, 33/F, 34/F, 35/F, 36/F, 37/F, 38/F, 39/F, 40/F, 41/F, 42/F, 43/F, 44/F, 45/F, 46/F, 47/F, 48/F, 49/F, 50/F, 51/F, 52/F, 53/F, 54/F, 55/F, 56/F, 57/F, 58/F, 59/F, 60/F, 61/F, 62/F, 63/F, 64/F, 65/F, 66/F, 67/F, 68/F, 69/F, 70/F, 71/F, 72/F, 73/F, 74/F, 75/F, 76/F, 77/F, 78/F, 79/F, 80/F, 81/F, 82/F, 83/F, 84/F, 85/F, 86/F, 87/F, 88/F, 89/F, 90/F, 91/F, 92/F, 93/F, 94/F, 95/F, 96/F, 97/F, 98/F, 99/F, 100/F

PROPOSED RESIDENTIAL DEVELOPMENT
 AT 139-147 ARGYLE STREET,
 KOWLOON INLAND LOT Nos. 6005,
 6035 R.P., 6036 R.P., 6037 R.P.
 & 6038 R.P.

TYPICAL FLOOR PLAN
 (2/F TO 21/F)
 (SHEET 2)

[Signature]

"THE WORKS SHOWN ON THESE PLANS ARE TYPE II WORKS (GENERAL BUILDING WORKS) IN RESPECT OF WHICH CONSENT IS APPLIED FOR THE PURPOSE OF FAST TRACK CONSENT APPLICATION UNDER REGULATION 33 OF THE BUILDING (ADMINISTRATION) REGULATIONS."

Scale: 1:100 and 1:50 to be inserted
 Date: 04/01/2019
 Project No: 254

ISSUED FOR CONSTRUCTION
A.I. NO. AI-MC-0075
5 JAN 2021

- LEGEND:
- FRENCH FINISH
 - MAX. 500mm SURVEY SLAB
 - COMMON ACCESS ROUTES FOR MAINTENANCE UNDER APP-93
 - AB - ACOUSTIC SCREEN
 - AD - ACOUSTIC DOOR (BUFFLE TYPE)
 - AW - ACOUSTIC WINDOW
 - M - FIBRE GLASS / FINED GLAZING WITH MAINTENANCE
 - SC - WITH SELF-CLOSING MECHANISM FOR A.P. DOOR
 - O.A. - WINDOW OPERABLE AREA
 - A.F. - ARCHITECTURAL FEATURE

Cheng Yung
Cheng Yung Gricen
for and on behalf of
AGC Design Ltd
Authorized Person
(List of Architects)

BD AMENDED PLAN 14 AUG 2020

REVISION	DESCRIPTION	DATE
A	BD RE-SUBMISSION	08/02/2019 CC
B	MAJOR AMENDMENT	14/03/2019 CC
C	MAJOR AMENDMENT	11/04/2019 CC
D	MAJOR AMENDMENT	04/20/19 CC
E	MAJOR AMENDMENT	05/21/19 CC
F	MAJOR AMENDMENT	07/22/19 CC
G	AMENDMENT	08/20/19 CC
H	AMENDMENT	07/20/19 CC
I	AMENDMENT	10/20/19 CC
J	AMENDMENT	12/20/19 CC
K	AMENDMENT	08/20/20 CC

AGC DESIGN LTD

AGC DESIGN LTD
111, 113, 115, 117, 119, 121, 123, 125, 127, 129, 131, 133, 135, 137, 139, 141, 143, 145, 147, 149, 151, 153, 155, 157, 159, 161, 163, 165, 167, 169, 171, 173, 175, 177, 179, 181, 183, 185, 187, 189, 191, 193, 195, 197, 199, 201, 203, 205, 207, 209, 211, 213, 215, 217, 219, 221, 223, 225, 227, 229, 231, 233, 235, 237, 239, 241, 243, 245, 247, 249, 251, 253, 255, 257, 259, 261, 263, 265, 267, 269, 271, 273, 275, 277, 279, 281, 283, 285, 287, 289, 291, 293, 295, 297, 299, 301, 303, 305, 307, 309, 311, 313, 315, 317, 319, 321, 323, 325, 327, 329, 331, 333, 335, 337, 339, 341, 343, 345, 347, 349, 351, 353, 355, 357, 359, 361, 363, 365, 367, 369, 371, 373, 375, 377, 379, 381, 383, 385, 387, 389, 391, 393, 395, 397, 399, 401, 403, 405, 407, 409, 411, 413, 415, 417, 419, 421, 423, 425, 427, 429, 431, 433, 435, 437, 439, 441, 443, 445, 447, 449, 451, 453, 455, 457, 459, 461, 463, 465, 467, 469, 471, 473, 475, 477, 479, 481, 483, 485, 487, 489, 491, 493, 495, 497, 499, 501, 503, 505, 507, 509, 511, 513, 515, 517, 519, 521, 523, 525, 527, 529, 531, 533, 535, 537, 539, 541, 543, 545, 547, 549, 551, 553, 555, 557, 559, 561, 563, 565, 567, 569, 571, 573, 575, 577, 579, 581, 583, 585, 587, 589, 591, 593, 595, 597, 599, 601, 603, 605, 607, 609, 611, 613, 615, 617, 619, 621, 623, 625, 627, 629, 631, 633, 635, 637, 639, 641, 643, 645, 647, 649, 651, 653, 655, 657, 659, 661, 663, 665, 667, 669, 671, 673, 675, 677, 679, 681, 683, 685, 687, 689, 691, 693, 695, 697, 699, 701, 703, 705, 707, 709, 711, 713, 715, 717, 719, 721, 723, 725, 727, 729, 731, 733, 735, 737, 739, 741, 743, 745, 747, 749, 751, 753, 755, 757, 759, 761, 763, 765, 767, 769, 771, 773, 775, 777, 779, 781, 783, 785, 787, 789, 791, 793, 795, 797, 799, 801, 803, 805, 807, 809, 811, 813, 815, 817, 819, 821, 823, 825, 827, 829, 831, 833, 835, 837, 839, 841, 843, 845, 847, 849, 851, 853, 855, 857, 859, 861, 863, 865, 867, 869, 871, 873, 875, 877, 879, 881, 883, 885, 887, 889, 891, 893, 895, 897, 899, 901, 903, 905, 907, 909, 911, 913, 915, 917, 919, 921, 923, 925, 927, 929, 931, 933, 935, 937, 939, 941, 943, 945, 947, 949, 951, 953, 955, 957, 959, 961, 963, 965, 967, 969, 971, 973, 975, 977, 979, 981, 983, 985, 987, 989, 991, 993, 995, 997, 999, 1001, 1003, 1005, 1007, 1009, 1011, 1013, 1015, 1017, 1019, 1021, 1023, 1025, 1027, 1029, 1031, 1033, 1035, 1037, 1039, 1041, 1043, 1045, 1047, 1049, 1051, 1053, 1055, 1057, 1059, 1061, 1063, 1065, 1067, 1069, 1071, 1073, 1075, 1077, 1079, 1081, 1083, 1085, 1087, 1089, 1091, 1093, 1095, 1097, 1099, 1101, 1103, 1105, 1107, 1109, 1111, 1113, 1115, 1117, 1119, 1121, 1123, 1125, 1127, 1129, 1131, 1133, 1135, 1137, 1139, 1141, 1143, 1145, 1147, 1149, 1151, 1153, 1155, 1157, 1159, 1161, 1163, 1165, 1167, 1169, 1171, 1173, 1175, 1177, 1179, 1181, 1183, 1185, 1187, 1189, 1191, 1193, 1195, 1197, 1199, 1201, 1203, 1205, 1207, 1209, 1211, 1213, 1215, 1217, 1219, 1221, 1223, 1225, 1227, 1229, 1231, 1233, 1235, 1237, 1239, 1241, 1243, 1245, 1247, 1249, 1251, 1253, 1255, 1257, 1259, 1261, 1263, 1265, 1267, 1269, 1271, 1273, 1275, 1277, 1279, 1281, 1283, 1285, 1287, 1289, 1291, 1293, 1295, 1297, 1299, 1301, 1303, 1305, 1307, 1309, 1311, 1313, 1315, 1317, 1319, 1321, 1323, 1325, 1327, 1329, 1331, 1333, 1335, 1337, 1339, 1341, 1343, 1345, 1347, 1349, 1351, 1353, 1355, 1357, 1359, 1361, 1363, 1365, 1367, 1369, 1371, 1373, 1375, 1377, 1379, 1381, 1383, 1385, 1387, 1389, 1391, 1393, 1395, 1397, 1399, 1401, 1403, 1405, 1407, 1409, 1411, 1413, 1415, 1417, 1419, 1421, 1423, 1425, 1427, 1429, 1431, 1433, 1435, 1437, 1439, 1441, 1443, 1445, 1447, 1449, 1451, 1453, 1455, 1457, 1459, 1461, 1463, 1465, 1467, 1469, 1471, 1473, 1475, 1477, 1479, 1481, 1483, 1485, 1487, 1489, 1491, 1493, 1495, 1497, 1499, 1501, 1503, 1505, 1507, 1509, 1511, 1513, 1515, 1517, 1519, 1521, 1523, 1525, 1527, 1529, 1531, 1533, 1535, 1537, 1539, 1541, 1543, 1545, 1547, 1549, 1551, 1553, 1555, 1557, 1559, 1561, 1563, 1565, 1567, 1569, 1571, 1573, 1575, 1577, 1579, 1581, 1583, 1585, 1587, 1589, 1591, 1593, 1595, 1597, 1599, 1601, 1603, 1605, 1607, 1609, 1611, 1613, 1615, 1617, 1619, 1621, 1623, 1625, 1627, 1629, 1631, 1633, 1635, 1637, 1639, 1641, 1643, 1645, 1647, 1649, 1651, 1653, 1655, 1657, 1659, 1661, 1663, 1665, 1667, 1669, 1671, 1673, 1675, 1677, 1679, 1681, 1683, 1685, 1687, 1689, 1691, 1693, 1695, 1697, 1699, 1701, 1703, 1705, 1707, 1709, 1711, 1713, 1715, 1717, 1719, 1721, 1723, 1725, 1727, 1729, 1731, 1733, 1735, 1737, 1739, 1741, 1743, 1745, 1747, 1749, 1751, 1753, 1755, 1757, 1759, 1761, 1763, 1765, 1767, 1769, 1771, 1773, 1775, 1777, 1779, 1781, 1783, 1785, 1787, 1789, 1791, 1793, 1795, 1797, 1799, 1801, 1803, 1805, 1807, 1809, 1811, 1813, 1815, 1817, 1819, 1821, 1823, 1825, 1827, 1829, 1831, 1833, 1835, 1837, 1839, 1841, 1843, 1845, 1847, 1849, 1851, 1853, 1855, 1857, 1859, 1861, 1863, 1865, 1867, 1869, 1871, 1873, 1875, 1877, 1879, 1881, 1883, 1885, 1887, 1889, 1891, 1893, 1895, 1897, 1899, 1901, 1903, 1905, 1907, 1909, 1911, 1913, 1915, 1917, 1919, 1921, 1923, 1925, 1927, 1929, 1931, 1933, 1935, 1937, 1939, 1941, 1943, 1945, 1947, 1949, 1951, 1953, 1955, 1957, 1959, 1961, 1963, 1965, 1967, 1969, 1971, 1973, 1975, 1977, 1979, 1981, 1983, 1985, 1987, 1989, 1991, 1993, 1995, 1997, 1999, 2001, 2003, 2005, 2007, 2009, 2011, 2013, 2015, 2017, 2019, 2021, 2023, 2025, 2027, 2029, 2031, 2033, 2035, 2037, 2039, 2041, 2043, 2045, 2047, 2049, 2051, 2053, 2055, 2057, 2059, 2061, 2063, 2065, 2067, 2069, 2071, 2073, 2075, 2077, 2079, 2081, 2083, 2085, 2087, 2089, 2091, 2093, 2095, 2097, 2099, 2101, 2103, 2105, 2107, 2109, 2111, 2113, 2115, 2117, 2119, 2121, 2123, 2125, 2127, 2129, 2131, 2133, 2135, 2137, 2139, 2141, 2143, 2145, 2147, 2149, 2151, 2153, 2155, 2157, 2159, 2161, 2163, 2165, 2167, 2169, 2171, 2173, 2175, 2177, 2179, 2181, 2183, 2185, 2187, 2189, 2191, 2193, 2195, 2197, 2199, 2201, 2203, 2205, 2207, 2209, 2211, 2213, 2215, 2217, 2219, 2221, 2223, 2225, 2227, 2229, 2231, 2233, 2235, 2237, 2239, 2241, 2243, 2245, 2247, 2249, 2251, 2253, 2255, 2257, 2259, 2261, 2263, 2265, 2267, 2269, 2271, 2273, 2275, 2277, 2279, 2281, 2283, 2285, 2287, 2289, 2291, 2293, 2295, 2297, 2299, 2301, 2303, 2305, 2307, 2309, 2311, 2313, 2315, 2317, 2319, 2321, 2323, 2325, 2327, 2329, 2331, 2333, 2335, 2337, 2339, 2341, 2343, 2345, 2347, 2349, 2351, 2353, 2355, 2357, 2359, 2361, 2363, 2365, 2367, 2369, 2371, 2373, 2375, 2377, 2379, 2381, 2383, 2385, 2387, 2389, 2391, 2393, 2395, 2397, 2399, 2401, 2403, 2405, 2407, 2409, 2411, 2413, 2415, 2417, 2419, 2421, 2423, 2425, 2427, 2429, 2431, 2433, 2435, 2437, 2439, 2441, 2443, 2445, 2447, 2449, 2451, 2453, 2455, 2457, 2459, 2461, 2463, 2465, 2467, 2469, 2471, 2473, 2475, 2477, 2479, 2481, 2483, 2485, 2487, 2489, 2491, 2493, 2495, 2497, 2499, 2501, 2503, 2505, 2507, 2509, 2511, 2513, 2515, 2517, 2519, 2521, 2523, 2525, 2527, 2529, 2531, 2533, 2535, 2537, 2539, 2541, 2543, 2545, 2547, 2549, 2551, 2553, 2555, 2557, 2559, 2561, 2563, 2565, 2567, 2569, 2571, 2573, 2575, 2577, 2579, 2581, 2583, 2585, 2587, 2589, 2591, 2593, 2595, 2597, 2599, 2601, 2603, 2605, 2607, 2609, 2611, 2613, 2615, 2617, 2619, 2621, 2623, 2625, 2627, 2629, 2631, 2633, 2635, 2637, 2639, 2641, 2643, 2645, 2647, 2649, 2651, 2653, 2655, 2657, 2659, 2661, 2663, 2665, 2667, 2669, 2671, 2673, 2675, 2677, 2679, 2681, 2683, 2685, 2687, 2689, 2691, 2693, 2695, 2697, 2699, 2701, 2703, 2705, 2707, 2709, 2711, 2713, 2715, 2717, 2719, 2721, 2723, 2725, 2727, 2729, 2731, 2733, 2735, 2737, 2739, 2741, 2743, 2745, 2747, 2749, 2751, 2753, 2755, 2757, 2759, 2761, 2763, 2765, 2767, 2769, 2771, 2773, 2775, 2777, 2779, 2781, 2783, 2785, 2787, 2789, 2791, 2793, 2795, 2797, 2799, 2801, 2803, 2805, 2807, 2809, 2811, 2813, 2815, 2817, 2819, 2821, 2823, 2825, 2827, 2829, 2831, 2833, 2835, 2837, 2839, 2841, 2843, 2845, 2847, 2849, 2851, 2853, 2855, 2857, 2859, 2861, 2863, 2865, 2867, 2869, 2871, 2873, 2875, 2877, 2879, 2881, 2883, 2885, 2887, 2889, 2891, 2893, 2895, 2897, 2899, 2901, 2903, 2905, 2907, 2909, 2911, 2913, 2915, 2917, 2919, 2921, 2923, 2925, 2927, 2929, 2931, 2933, 2935, 2937, 2939, 2941, 2943, 2945, 2947, 2949, 2951, 2953, 2955, 2957, 2959, 2961, 2963, 2965, 2967, 2969, 2971, 2973, 2975, 2977, 2979, 2981, 2983, 2985, 2987, 2989, 2991, 2993, 2995, 2997, 2999, 3001, 3003, 3005, 3007, 3009, 3011, 3013, 3015, 3017, 3019, 3021, 3023, 3025, 3027, 3029, 3031, 3033, 3035, 3037, 3039, 3041, 3043, 3045, 3047, 3049, 3051, 3053, 3055, 3057, 3059, 3061, 3063, 3065, 3067, 3069, 3071, 3073, 3075, 3077, 3079, 3081, 3083, 3085, 3087, 3089, 3091, 3093, 3095, 3097, 3099, 3101, 3103, 3105, 3107, 3109, 3111, 3113, 3115, 3117, 3119, 3121, 3123, 3125, 3127, 3129, 3131, 3133, 3135, 3137, 3139, 3141, 3143, 3145, 3147, 3149, 3151, 3153, 3155, 3157, 3159, 3161, 3163, 3165, 3167, 3169, 3171, 3173, 3175, 3177, 3179, 3181, 3183, 3185, 3187, 3189, 3191, 3193, 3195, 3197, 3199, 3201, 3203, 3205, 3207, 3209, 3211, 3213, 3215, 3217, 3219, 3221, 3223, 3225, 3227, 3229, 3231, 3233, 3235, 3237, 3239, 3241, 3243, 3245, 3247, 3249, 3251, 3253, 3255, 3257, 3259, 3261, 3263, 3265, 3267, 3269, 3271, 3273, 3275, 3277, 3279, 3281, 3283, 3285, 3287, 3289, 3291, 3293, 3295, 3297, 3299, 3301, 3303, 3305, 3307, 3309, 3311, 3313, 3315, 3317, 3319, 3321, 3323, 3325, 3327, 3329, 3331, 3333, 3335, 3337, 3339, 3341, 3343, 3345, 3347, 3349, 3351, 3353, 3355, 3357, 3359, 3361, 3363, 3365, 3367, 3369, 3371, 3373, 3375, 3377, 3379, 3381, 3383, 3385, 3387, 3389, 3391, 3393, 3395, 3397, 3399, 3401, 3403, 3405, 3407, 3409, 3411, 3413, 3415, 3417, 3419, 3421, 3423, 3425, 3427, 3429, 3431, 3433, 3435, 3437, 3439, 3441, 3443, 3445, 3447, 3449, 3451, 3453, 3455, 3457, 3459, 3461, 3463, 3465, 3467, 3469, 3471, 3473, 3475, 3477, 3479, 3481, 3483, 3485, 3487, 3489, 3491, 3493, 3495, 3497, 3499, 3501, 3503, 3505, 3507, 3509, 3511, 3513, 3515, 3517, 3519, 3521, 3523, 3525, 3527, 3529, 3531, 3533, 3535, 3537, 3539, 3541, 3543, 3545, 3547, 3549, 3551, 3553, 3555, 3557, 3559, 3561, 3563, 3565, 3567, 3569, 3571, 3573, 3575, 3577, 3579, 3581, 3583, 3585, 3587, 3589, 3591, 3593, 3595, 3597, 3599, 3601, 3603, 3605, 3607, 3609, 3611, 3613, 3615, 3617, 3619, 3621, 3623, 3625, 3627, 3629, 3631, 3633, 3635, 3637, 3639, 3641, 3643, 3645, 3647, 3649, 3651, 3653, 3655, 3657, 3659, 3661, 3663, 3665, 3667, 3669, 3671, 3673, 3675, 3677, 3679, 3681, 3683, 3685, 3687, 3689, 3691, 3693, 3695, 3697, 3699, 3701, 3703, 3705, 3707, 3709, 3711, 3713, 3715, 3717, 3719, 3721, 3723, 3725, 3727, 3729, 3731, 3733, 3735, 3737, 3739, 3741, 3743, 3745, 3747, 3749, 3751, 3753, 3755, 3757, 3759, 3761, 3763, 3765, 3767, 3769, 3771, 3773, 3775, 3777, 3779, 3781, 3783, 3785, 3787, 3789, 3791, 3793, 3795, 3797, 3799, 3801, 3803, 3805, 3807, 3809, 3811, 3813, 3815, 3817, 3819, 3821, 3823, 3825, 3827, 3829, 3831, 3833, 3835, 3837, 3839, 3841, 3843, 3845, 3847, 3849, 3851, 3853, 3855, 3857, 3859, 3861, 3863, 3865, 3867, 3869, 3871, 3873, 3875, 3877, 3879, 3881, 3883, 3885, 3887, 3889, 3891, 3893, 3895, 3897, 3899, 3901, 3903, 3905, 3907, 3909, 3911, 3913, 3915, 3917, 3919, 3921, 3923, 3925, 3927, 3929, 3931, 3933, 3935, 3937, 3939, 3941, 3943, 3945, 3947, 3949, 3951, 3953, 3955, 3957, 3959, 3961, 3963, 3965, 3967, 3969, 3971, 3973, 3975, 3977, 3979, 3981, 3983, 3985, 3987, 3989, 3991, 3993, 3995, 3997, 3999, 4001, 4003, 4005, 4007, 4009, 4011, 4013, 4015, 4017, 4019, 4021, 4023, 4025, 4027, 4029, 4031, 4033, 4035, 4037, 4039, 4041, 4043, 4045, 4047, 4049, 4051, 405

ISSUED FOR CONSTRUCTION
 A.I. NO. AJ-MC-007
 5 JAN 2021

- LEGEND:**
- BREAKFAST FACILITY
 - MAX. SLOPE SURFEN SLAB
 - COMMONAL ACCESS ROUTES FOR MAINTENANCE UNDER RFP-3.2
 - AB ACoustic BALCONY
 - AD ACoustic DOOR (BATTLER TYPE)
 - AW ACoustic WINDOW
 - M FIXED GLAZING / FIXED GLAZING WITH MAINTENANCE
 - SC WITH SELF-CLOSING MECHANISM FOR U.P. DOOR
 - OA WINDOW OPENABLE AREA
 - A.F. ARCHITECTURAL FEATURE

Chang Yung
 Chang Yung Group
 for and on behalf of
 AGC Design Ltd
 Authorized Person
 (List of Architects)

BD AMENDED PLAN 14 AUG 2020

A	30 RE-SUBMISSION	19/08/2011	CC
B	MAJOR AMENDMENT	19/03/2011	CC
C	MAJOR AMENDMENT	19/11/2011	CC
D	MINOR AMENDMENT	19/04/2011	CC
E	MINOR AMENDMENT	19/03/13	CC
F	MINOR AMENDMENT	17/2015	CC
G	AMENDMENT	04/05/2018	CC
H	AMENDMENT	15/07/2018	CC
J	AMENDMENT	16/2019	CC
K	AMENDMENT	12/2019	CC
L	AMENDMENT	14/2020	CC

AGC DESIGN LTD

AGC DESIGN LTD
 22/F, 220 Argyle Street, Kowloon, Hong Kong
 Tel: 2322 8718 Fax: 2322 8717 Email: agc@agc.com.hk

PROPOSED RESIDENTIAL DEVELOPMENT
 AT 139-147 ARGYLE STREET,
 KOWLOON INLAND LOT Nos. 6005,
 6035 R.P., 6036 R.P., 6037 R.P.
 & 6038 R.P.

23th FLOOR PLAN (SHEET 2)

Paul Appleton

 Senior Building Surveyor
 THE BUILDING AUTHORITY
 11 SEP 2020

"THE WORKS SHOWN ON THESE P-ANS ARE TYPE II WORKS (GENERAL BUILDING WORKS) IN RESPECT OF WHICH CONSENT IS APPLIED FOR THE PURSUE OF FAST-TRACK CONSENT APPLICATION UNDER REGULATION 33 OF THE BUILDING (ADMINISTRATION) REGULATIONS"

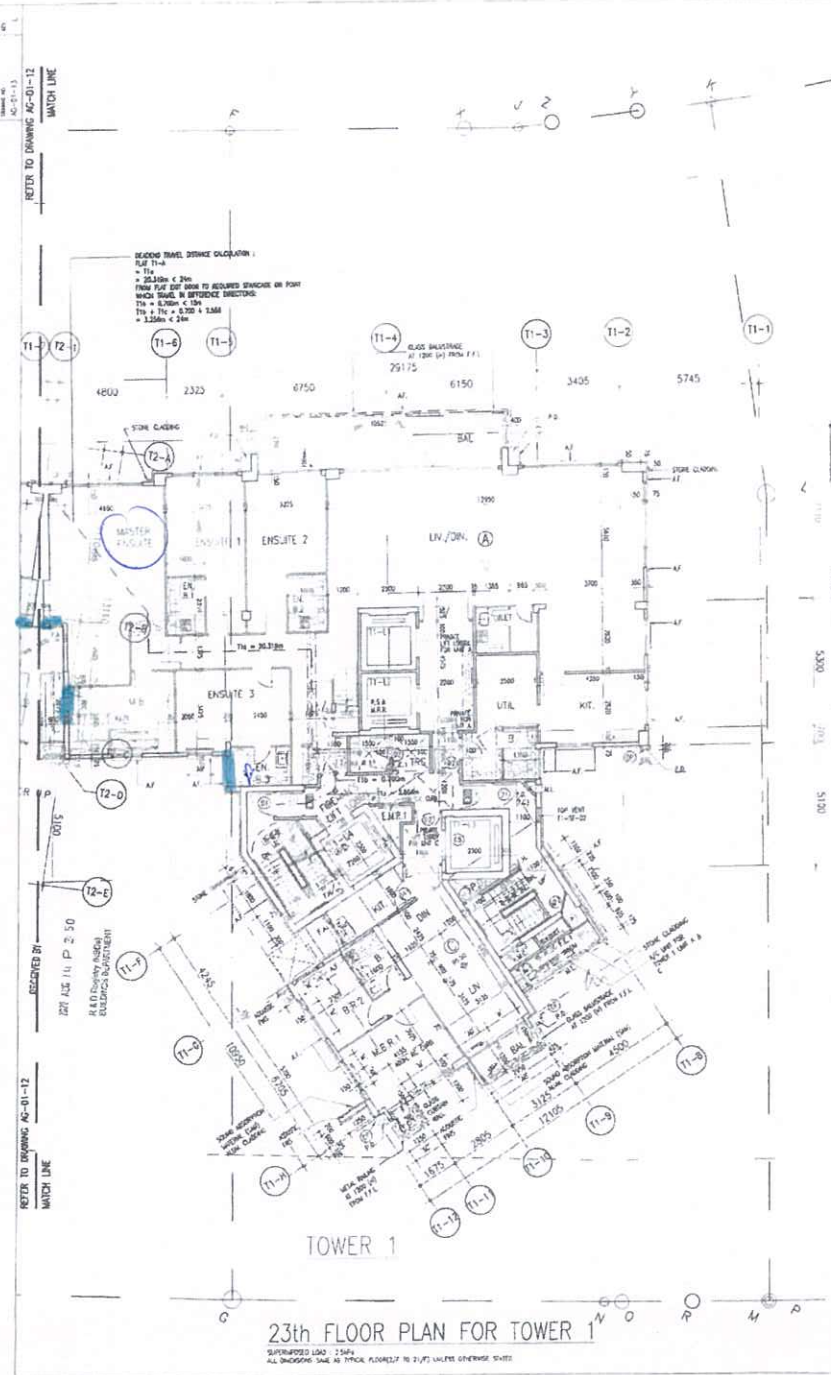

23th FLOOR PLAN FOR TOWER 1
 SUPERIMPOSED LOAD: 2.5kPa
 ALL DIMENSIONS SHOWN AS PERMITTED TO 2,1/2 UNLESS OTHERWISE STATED