

工程指示 / 要求簡箋(E.I.)

編號: EI / 3121 / 21 修改版次: -
項目: J - 852 工程名稱: 亞皆老街中電
工程項目: 大樓 佛沙窗, 後裝窗, 幕牆, 欄河, Glass Cladding 玻璃 BM 備料(LOW-E)
收件人: Maggie / 生統 發件人: Ant Yeung 日期: 05/03/2021

要求提供 / 確認 事項:

- | | | |
|------------------------------------|-------------------------------------|-------------------------------|
| <input type="checkbox"/> 初步鋁料 B.M. | <input type="checkbox"/> 加工拆圖, 然後生產 | <input type="checkbox"/> 尺寸表 |
| <input type="checkbox"/> 正式鋁料 B.M. | <input type="checkbox"/> 技術上資料 / 指示 | <input type="checkbox"/> 報價 |
| <input type="checkbox"/> 配件 B.M. | <input type="checkbox"/> 樣辦或貨品說明書 | <input type="checkbox"/> 分判合約 |

此為初步玻璃 BM, 只供參考備料用。 本工程使用 Low Iron

附上 Glass Code

佛沙窗 : (3200 件) 2706 m2

後裝窗、FD、SD : (1329 件) 2005 m2

幕牆 : (480 件) 372 m2

欄河 : (630 件) 743 m2

Glass Cladding : (240 件) 280 m2 20T

共約 (5879 件) 6107 m2

注意: 已批核 Low E 色為 SEE0-83T, 請按此款 Low E 預備原片

拆圖注意: 正式 BM, 請使用此(D字頭)玻璃編號

排期: 4 月尾開始到第一批玻璃到地盤

請在 2021 / 03 / 08 前完成上列要求。

附: 頁 附錄件 MC 4002 記錄

以上項目為:

- 原合約工程包 原合約工程加 / 減賬 新工程報價

分發東莞各部門:

- () 生產技術總監 連附件 () 技術部 連附件 () 生產部 連附件 () 機械設計部 連附件
() 採購部 連附件 () 生產統籌部 連附件
() 質檢部 連附件 () 會計部 連附件 () 報關組 連附件 () 其他 楊榮輝 連附件

分發其他分判:

- (v) 水洪 連附件

分發香港各部門:

- () 行政部 連附件 () 會計部 連附件 () 統籌部 連附件 () 工程部地盤科文 連附件
() 採購部 連附件 () QS 部 連附件 () 維修部 連附件 () 其他 _____ 連附件

傳遞編號:

HK 424 / 21

發件人簽署:

項目經理簽署:



1/8

玻璃性能参数

PHOTOMETRIC PROPERTIES

客户名称: 美特

项目名: 亚皆老街

玻璃产品 Class Product	厚度 (毫米) Thickness (mm)	可见光 Light characteristics			太阳热能 Energy characteristics					U-值
		透光率 trans (%)	反光率Reflection		热直透率 trans (%)	热反射率 Reflection(%)	热吸收率 Abs (%)	热能系数 SolarFactor	遮阳系数 Shading Coefficient	U-Value 空气 (W/M ²)
			外Out (%)	内In (%)						
GL01 8mm low iron #2 SYDE-55T+12A+10mm low iron D20070681	Fix (起角)	52%	13%	12%	21%	31%	48%	0.28	0.32	1.73
GL01a 8mm low iron #2 SYDE-55T+9A+12mm low iron D20070684	大Fix	51%	13%	12%	21%	31%	48%	0.29	0.33	1.92
GL02 10mm low iron with coating#2 (SSC- 50T) D20070699	幕墙(G.C)	52%	19%	13%	50%	14%	36%	0.60	0.69	5.32
GL03 6mm low iron #2 SYDE-55T+12A+6mm low iron D20070685	生窗	52%	13%	12%	21%	31%	48%	0.28	0.32	1.75
GL04 10mm low iron D20070686	护栏	90%	8%	8%	87%	8%	5%	0.89	1.02	5.66
GL05 6mm low iron #2 SYDE-55T+12A+8mm low iron D20070687	F.O.P	52%	13%	12%	24%	38%	38%	0.28	0.32	1.74
GL02-BAL 10mm low iron+1.52PVB+10mm low iron D20070688	BAL 护栏	88%	8%	8%	75%	7%	18%	0.80	0.92	5.14

- The performance data shown are nominal and subject to variations due to manufacturing tolerances.
- A slight shift in visible light reflectance or transmission may be noticed after heat-treatment.
- The tolerance of data with respect to photometric properties is ± 3 points.
- The U-value tolerance is ± 0.1 W/m².k.
- Specifications technical and other data are based on information available at the time of preparation this document and are subject to change without prior notice.
- The above performance parameters calculated in accordance with WINDOW6 software.All data are just for your reference, not as an official contract.

玻璃性能参数

PHOTOMETRIC PROPERTIES

客户名称: 美特

项目名: 亚皆老街中电

GL01
GL01a
GL03
GL05
GL02

玻璃产品 Class Product	厚度 (毫米) Thickness (mm)	可见光 Light characteristics			太阳热能 Energy characteristics					U-值	
		透光率 trans (%)	反光率Reflection		热直透率 trans (%)	热反射率 Reflection(%)	热吸收率 Abs (%)	热能系数 SolarFactor	遮阳系数 Shading Coefficient	U-Value 空气 (W/M ²)	
			外Out (%)	内In (%)							
		L.T.	L.R.	L.R.	D.E.T	E.R	E.A.	S.F.	S.C.	AIR	
8mm SEE0-83T#2+12A+10mm low iron D20040325		77%	12%	12%	56%	24%	20%	0.59	0.68	1.73	(FFR)
8mm SEE0-83T#2+9A+12mm low iron D2 1/11/0039		76%	12%	12%	54%	24%	22%	0.59	0.68	1.92	(大FFR)
6mm SEE0-83T#2+12A+6mm low iron D2 0/0040		77%	12%	12%	56%	24%	20%	0.59	0.68	1.75	(电窗)
6mm SEE0-83T#2+12A+8mm low iron D2 0/0041		77%	12%	12%	56%	24%	20%	0.59	0.68	1.75	(FOPF)
10mm SSC0-70T#2		69%	16%	17%	70%	12%	18%	0.75	0.86	5.62	(死墙/G.C.)

- The performance data shown are nominal and subject to variations due to manufacturing tolerances.
- A slight shift in visible light reflectance or transmission may be noticed after heat-treatment.
- The tolerance of data with respect to photometric properties is ± 3 points.
- The U-value tolerance is ± 0.1 W/m².k.
- Specifications technical and other data are based on information available at the time of preparation this document and are subject to change without prior notice.
- The above performance parameters calculated in accordance with WINDOW6 software. All data are just for your reference, not as an official contract.

Precast Window					
編號	位置	款式	Fabricator code	件	m2
GL01	FIX, SD	8mm Low Iron Low E HS+12 A + 10mm Low Iron Temper - I.G.U	D20040325	620	647.1
GL01a	超大Fix	8mm Low Iron Low E HS+9 A + 12mm Low Iron Temper - I.G.U	D21010039	40	195.1
GL03	生窗	6mm Low Iron Low E HS +12 A + 6mm Low Iron Temper - I.G.U	D21010040	1533	1495.3
GL04	欄河	10 mm Thk Low Iron Temper	D20070686	1007	368.8

Insitu Window FD / SD					
編號	位置	款式	Fabricator code	件	m2
GL01	FIX, SD	8mm Low Iron Low E HS+12 A + 10mm Low Iron Temper - I.G.U	D20040325	1050	1812.2
GL03	生窗	6mm Low Iron Low E HS +12 A + 6mm Low Iron Temper - I.G.U	D21010040	273	182.9
GL05	FD	6mm Low Iron Low E HS +12 A + 8mm Low Iron Temper - I.G.U	D21010041	6	10.3

Curtain Wall					
編號	位置	款式	Fabricator code	件	m2
GL01	FIX, SD	8mm Low Iron Low E HS+12 A + 10mm Low Iron Temper - I.G.U	D20040325	180	137.1
GL02	死牆	10 mm Thk Reflective-Low Iron HS		120	98.3
GL01	生窗	8mm Low Iron Low E HS+12 A + 10mm Low Iron Temper - I.G.U	D20040325	60	48.5
GL04	欄河	10 mm Thk Low Iron Temper	D20070686	60	7.6
GL05	FD	6mm Low Iron Low E HS +12 A + 8mm Low Iron Temper - I.G.U	D21010041	60	81.5

Balustrades					
編號	位置	款式	Fabricator code	件	m2
GL02-BAL	Balustrades	10 mm Low Iron Temper +1.52 mm PVB 10 mm Low Iron Temper Lam	D20070688	630	743.2

Glass Cladding					
編號	位置	款式	Fabricator code	件	m2
G1-GC	Glass Cladding	10 mm Thk Reflective-Low Iron HS		240	280
				Total	
				5879	6107.9

按型號分

編號	位置	款式	最大 (WxH)	件	m2
GL01	FIX, SD	8mm Low Iron Low E HS+12 A + 10mm Low Iron Temper - I.G.U	1016mm x2410mm	1850	2596.4
GL01a	超大Fix	8mm Low Iron Low E HS+9 A + 12mm Low Iron Temper - I.G.U	2380mm x2060mm	40	195.1
GL02	死牆	10 mm Thk Reflective-Low Iron HS	910mm x980mm	120	98.3
GL03	生窗	6mm Low Iron Low E HS +12 A + 6mm Low Iron Temper - I.G.U	930mm x2305mm	1866	1726.7
GL04	欄河	10 mm Thk Low Iron Temper	676mm x593mm	1067	376.4
GL05	FD	6mm Low Iron Low E HS +12 A + 8mm Low Iron Temper - I.G.U	595mm x2525mm	66	91.8

GL02-BAL	Balustrades	Lam	2585mm x995mm	630	743.2
G1-GC	Glass Cladding	10 mm Low Iron HS	600mm x1950mm	240	280
				Total	
				5879	6107.9

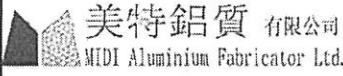
 美特鋁質 有限公司 MIDI Aluminium Fabricator Ltd.	工程號:	J852	計算:	Ivan	日期:	2020.07.10	送呈:	
	地盤名稱:		核對:		日期:		副本:	
地盤用玻璃B.M.表	項目類別:	佛沙窗玻璃	批准:		日期:		A/C Code:	
BM編號:		修改版次:		總計玻璃面積 (平方米):	2706.43			

序號	修改內容	玻璃圖號	顏色與類型	厚度 (mm)	玻璃尺寸		數量 (塊)	總面積 (平方米)	使用位置	加工圖參考
					寬度 (W mm)	高度 (H mm)				
1		GL03-01	6mm+12mm AIR GAP+6mm THK. I.G.U.	24.0	606.0	1937.0	360	422.58	佛沙窗	GL03-01
1		GL03-02			807.0	1222.0	126	125.00	佛沙窗	GL03-02
		GL03-03			807.0	1267.0	72	73.62	佛沙窗	GL03-03
		GL03-04			602.0	1937.0	284	331.17	佛沙窗	GL03-04
		GL03-05			352.0	1232.0	108	46.84	佛沙窗	GL03-05
		GL03-06			402.0	1937.0	68	52.95	佛沙窗	GL03-06
		GL03-07			327.0	1267.0	72	29.83	佛沙窗	GL03-07
		GL03-08			252.0	1267.0	72	22.99	佛沙窗	GL03-08
		GL03-09			526.0	1937.0	136	138.57	佛沙窗	GL03-09
		GL03-10			606.0	2207.0	40	53.50	佛沙窗	GL03-10
		GL03-11			427.0	1537.0	8	5.25	佛沙窗	GL03-11
		GL03-12			857.0	1492.0	4	5.11	佛沙窗	GL03-12
		GL03-13			352.0	1502.0	12	6.34	佛沙窗	GL03-13
		GL03-14			402.0	2207.0	6	5.32	佛沙窗	GL03-14
		GL03-15			602.0	2207.0	20	26.57	佛沙窗	GL03-15
		GL03-16			360.0	2234.0	5	4.02	佛沙窗	GL03-16
		GL03-17			327.0	1537.0	3	1.51	佛沙窗	GL03-17
		GL03-18			252.0	1537.0	3	1.16	佛沙窗	GL03-18

 美特鋁質 有限公司 MIDI Aluminium Fabricator Ltd.		工程號:	J852	計算:	Ivan	日期:	2020.07.10	送呈:		
		地盤名稱:		核對:		日期:		副本:		
地盤用玻璃B.M.表		項目類別:	佛沙窗玻璃	批准:		日期:		A/C Code:		
BM編號:		修改版次:		總計玻璃面積 (平方米):		2706.43				
序號	修改內容	玻璃圖號	顏色與類型	厚度 (mm)	玻璃尺寸		數量 (塊)	總面積 (平方米)	使用位置	加工圖參考
					寬度 (W mm)	高度 (H mm)				
		GL03-19			526.0	2207.0	4	4.64	佛沙窗	GL03-19
		GL03-20			477.0	1537.0	2	1.47	佛沙窗	GL03-20
		GL03-21			526.0	1502.0	2	1.58	佛沙窗	GL03-21
		GL03-22			452.0	2252.0	6	6.11	佛沙窗	GL03-22
		GL03-23			402.0	1982.0	34	27.09	佛沙窗	GL03-23
		GL03-24			602.0	1982.0	72	85.91	佛沙窗	GL03-24
		GL03-25			402.0	2252.0	6	5.43	佛沙窗	GL03-25
		GL03-26			602.0	2252.0	8	10.85	佛沙窗	GL03-26
							合計:		1533	1495.39
3		GL01-01	8mm+12mm AIR GAP+10mm THK. I.G.U.	30.0	1290.0	2060.0	108	287.00	佛沙窗	GL01-01
4		GL01-02			890.0	2060.0	72	132.00	佛沙窗	GL01-02
5		GL01-03			807.0	612.0	122	60.25	佛沙窗	GL01-03
6		GL01-04			807.0	462.0	72	26.84	佛沙窗	GL01-04
5		GL01-05			327.0	462.0	75	11.33	佛沙窗	GL01-05
5		GL01-06			252.0	462.0	75	8.73	佛沙窗	GL01-06
5		GL01-07			500.0	2060.0	68	70.04	佛沙窗	GL01-07
5		GL01-08			1290.0	2330.0	8	24.05	佛沙窗	GL01-08
5		GL01-09			890.0	2330.0	8	16.59	佛沙窗	GL01-09

		工程號:	J852	計算:	Ivan	日期:	2020.07.10	送呈:		
		地盤名稱:		核對:		日期:		副本:		
地盤用玻璃B.M.表		項目類別:	佛沙窗玻璃	批准:		日期:		A/C Code:		
BM編號:		修改版次:		總計玻璃面積 (平方米):	2706.43					
序號	修改內容	玻璃圖號	顏色與類型	厚度 (mm)	玻璃尺寸		數量 (塊)	總面積 (平方米)	使用位置	加工圖參考
					寬度 (W mm)	高度 (H mm)				
5		GL01-10			957.0	462.0	4	1.77	佛沙窗	GL01-10
5		GL01-11			857.0	1492.0	4	5.11	佛沙窗	GL01-11
5		GL01-12			500.0	2230.0	2	2.23	佛沙窗	GL01-12
5		GL01-13			1057.0	462.0	1	0.49	佛沙窗	GL01-13
5		GL01-14			375.0	1502.0	1	0.56	佛沙窗	GL01-14
5						合計:	620	647.00		
10		GL01a-01	8mm+9mm AIR GAP+12mm THK. I.G.U.	29.0	2380.0	2060.0	36	176.50	佛沙窗	GL01a-01
11		GL01a-02			2090.0	2230.0	4	18.64	佛沙窗	GL01a-02
11						合計:	40	195.14		
5		GL04-01	10mm THK. TEMPERED GLASS (PROTECTIVE BARRIER)	10.0	676.0	593.0	402	161.15	佛沙窗	GL04-01
5		GL04-02			626.0	593.0	346	128.44	佛沙窗	GL04-02
5		GL04-03			426.0	593.0	114	28.80	佛沙窗	GL04-03
5		GL04-04			596.0	593.0	140	49.48	佛沙窗	GL04-04
5		GL04-05			425.0	478.0	5	1.02	佛沙窗	GL04-05
5						合計:	1007	368.88		
13						總合計:	3200	2706.4266		
加工注意事項:		1). 本表中之所有玻璃顏色待定。 2). 本表中所有玻璃對角線尺寸偏差要求不超過負2mm。 3). 本表中玻璃要求粗磨邊處理並倒棱角，而所有玻璃之入爐方向需保持一致。								

 美特鋁質 有限公司 MIDI Aluminium Fabricator Ltd.		工程號:	J852	計算:	Ivan	日期:	2020.07.10	送呈:		
		地盤名稱:		核對:		日期:		副本:		
地盤用玻璃B.M.表		項目類別:	佛沙窗玻璃	批准:		日期:		A/C Code:		
BM編號:		修改版次:		總計玻璃面積 (平方米):		2706.43				
序號	修改內容	玻璃圖號	顏色與類型	厚度 (mm)	玻璃尺寸		數量 (塊)	總面積 (平方米)	使用位置	加工圖參考
					寬度 (W mm)	高度 (H mm)				
4).本表中所有玻璃成品均需做雙面保護，用透明靜電膠紙加四周一寸FK白膠紙做雙面加固保護處理。										
5).本表中所有玻璃成品均需注明室內外及其玻璃編號，以便識別。										

 美寺鋁質 有限公司 MEDI Aluminium Fabricator Ltd.		工程號:	J852	計算:	Ivan	日期:	2020.07.14	送呈:		
		地盤名稱:		核對:		日期:		副本:		
工廠用玻璃B.M.表		項目類別:	后裝窗玻璃	批准:		日期:		A/C Code:		
BM編號:		修改版次:		總計玻璃面積 (平方米):		2005.38				
序號	修改內容	玻璃圖號	顏色與類型	厚度 (mm)	玻璃尺寸		數量 (塊)	總面積 (平方米)	使用位置	加工圖參考
					寬度 (W mm)	高度 (H mm)				
1		GL03-001	6mm+12mm AIR GAP+6mm THK. I.G.U.	24.0	512.0	1229.0	54	33.98	后裝窗	GL03-001
1		GL03-002			537.0	1229.0	72	47.52	后裝窗	GL03-002
		GL03-003			577.0	1207.0	54	37.61	后裝窗	GL03-003
		GL03-004			880.0	2305.0	2	4.06	后裝窗	GL03-004
		GL03-005			930.0	2305.0	1	2.14	后裝窗	GL03-005
		GL03-006			526.0	1229.0	72	46.54	后裝窗	GL03-006
		GL03-007			501.0	1229.0	18	11.08	后裝窗	GL03-007
							合計:		273	182.93
3		GL01-001	8mm+12mm AIR GAP+10mm THK. I.G.U.	30.0	366.0	2410.0	2	1.76	后裝窗	GL01-001
4		GL01-002			536.0	2279.0	108	131.93	后裝窗	GL01-002
5		GL01-003			799.0	2333.5	72	134.24	后裝窗	GL01-003
6		GL01-004			824.0	2333.5	72	138.44	后裝窗	GL01-004
5		GL01-005			880.5	2279.0	108	216.72	后裝窗	GL01-005
5		GL01-006			936.5	2333.5	72	157.34	后裝窗	GL01-006
5		GL01-007			1016.0	2410.0	4	9.79	后裝窗	GL01-007
5		GL01-008			1116.0	197.0	18	3.96	后裝窗	GL01-008
5		GL01-009			1127.0	412.0	18	8.36	后裝窗	GL01-009
5		GL01-010			1166.0	197.0	18	4.13	后裝窗	GL01-010

 美特鋁質 有限公司 MIDI Aluminium Fabricator Ltd.		工程號:	J852	計算:	Ivan	日期:	2020.07.14	送呈:		
		地盤名稱:		核對:		日期:		副本:		
工廠用玻璃B.M.表		項目類別:	后裝窗玻璃	批准:		日期:		A/C Code:		
BM編號:		修改版次:		總計玻璃面積 (平方米):		2005.38				
序號	修改內容	玻璃圖號	顏色與類型	厚度 (mm)	玻璃尺寸		數量 (塊)	總面積 (平方米)	使用位置	加工圖參考
					寬度 (W mm)	高度 (H mm)				
5		GL01-011			1198.0	2283.0	108	295.38	后裝窗	GL01-011
5		GL01-012			1266.0	197.0	54	13.47	后裝窗	GL01-012
5		GL01-013			134.0	1576.0	18	3.80	后裝窗	GL01-013
5		GL01-014			244.0	1576.0	36	13.84	后裝窗	GL01-014
5		GL01-015			339.0	1576.0	18	9.62	后裝窗	GL01-015
5		GL01-016			855.5	2279.0	108	210.57	后裝窗	GL01-016
5		GL01-017			889.0	2262.0	72	144.79	后裝窗	GL01-017
5		GL01-018			914.0	2262.0	72	148.86	后裝窗	GL01-018
5		GL01-019			1014.0	2262.0	72	165.14	后裝窗	GL01-019
5						合計:	1050	1812.15		
5		GL05-001	6mm+12mm AIR GAP+8mm THK. I.G.U.	26.0	745.0	2305.0	6	10.30	后裝窗	GL05-001
5						合計:	6	10.30		
13						總合計:	1329	2005.38		
加工注意事項:		1).本表中之所有玻璃顏色待定。								
		2).本表中所有玻璃對角線尺寸偏差要求不超過負2mm。								
		3).本表中玻璃要求粗磨邊處理並倒棱角,而所有玻璃之入爐方向需保持一致。								
		4).本表中所有玻璃成品均需做雙面保護,用透明靜電膠紙加四周一寸FK白膠紙做雙面加固保護處理。								
		5).本表中所有玻璃成品均需注明室內外及其玻璃編號,以便識別。								

 美特鋁質 有限公司 MIDI Aluminium Fabricator Ltd.		工程號: J852	計算: Ivan	日期: 2020.07.14	送呈:					
工廠用玻璃B.M.表		地盤名稱:	核對:	日期:	副本:					
BM編號:		項目類別: 幕牆玻璃	批准:	日期:	A/C Code:					
修改版次:		總計玻璃面積 (平方米):		372.89						
序號	修改內容	玻璃圖號	顏色與類型	厚度 (mm)	玻璃尺寸		數量 (塊)	總面積 (平方米)	使用位置	加工圖參考
					寬度 (W mm)	高度 (H mm)				
1		GL03-C01	6mm+12mm AIR GAP+6mm THK. I.G.U.	24.0	707.0	1117.0	54	42.64	幕牆	GL03-C01
1		GL03-C02			707.0	1387.0	6	5.88	幕牆	GL03-C02
						合計:	60	48.53		
3		GL01-C01	8mm+12mm AIR GAP+10mm THK. I.G.U.	30.0	910.0	650.0	60	35.49	幕牆	GL01-C01
4		GL01-C02			830.0	650.0	60	32.37	幕牆	GL01-C02
5		GL01-C03			910.0	1240.0	54	60.93	幕牆	GL01-C03
6		GL01-C04			910.0	1510.0	6	8.24	幕牆	GL01-C04
5						合計:	180	137.04		
5		GL02-C01	10mm THK. HEAT STRENGTHENED GLASS	10.0	910.0	205.0	3	0.56	幕牆	GL02-C01
5		GL02-C02			830.0	205.0	3	0.51	幕牆	GL02-C02
5		GL02-C03			910.0	980.0	57	50.83	幕牆	GL02-C03
5		GL02-C04			830.0	980.0	57	46.36	幕牆	GL02-C04
5						合計:	120	98.27		
5		GL04-C01	10mm THK. TEMPERED GLASS	10.0	776.0	163.0	60	7.59	幕牆	GL04-C01
5						合計:	60	7.59		
5		GL05-C01	6mm+12mm AIR GAP+8mm THK.	26.0	595.0	2255.0	54	72.45	幕牆	GL05-C01

 美特鋁質 有限公司 MIDI Aluminium Fabricator Ltd.		工程號:	J852	計算:	Ivan	日期:	2020.07.14	送呈:		
		地盤名稱:		核對:		日期:		副本:		
工廠用玻璃B.M.表		項目類別:	幕牆玻璃	批准:		日期:		A/C Code:		
BM編號:		修改版次:		總計玻璃面積 (平方米):		372.89				
序號	修改內容	玻璃圖號	顏色與類型	厚度 (mm)	玻璃尺寸		數量 (塊)	總面積 (平方米)	使用位置	加工圖參考
					寬度 (W mm)	高度 (H mm)				
5		GL05-C02	I.G.U. 	26.0	995.0	2525.0	6	9.01	幕牆	GL05-C02
5						合計:	60	81.47		
13						总合计:	480	372.89		
加工注意事項:		1).本表中之所有玻璃顏色待定。								
		2).本表中所有玻璃對角線尺寸偏差要求不超過負2mm。								
		3).本表中玻璃要求粗磨邊處理並倒稜角，而所有玻璃之入爐方向需保持一致。								
		4).本表中所有玻璃成品均需做雙面保護，用透明靜電膠紙加四周一寸FK白膠紙做雙面加固保護處理。								
		5).本表中所有玻璃成品均需注明室內外及其玻璃編號，以便識別。								

 美特鋁質 有限公司 MIDI Aluminium Fabricator Ltd.		工程號: J852	計算: Ivan	日期: 2020.07.14	送呈:					
工廠用玻璃B.M.表		地盤名稱:	核對:	日期:	副本:					
BM編號:		項目類別: 攔河玻璃	批准:	日期:	A/C Code:					
		修改版次:	總計玻璃面積 (平方米):	743.16						
序號	修改內容	玻璃圖號	顏色與類型	厚度 (mm)	玻璃尺寸		數量 (塊)	總面積 (平方米)	使用位置	加工圖參考
					寬度 (W mm)	高度 (H mm)				
1		G2-01			450.0	720.0	2	0.65	攔河	G2-01
1		G2-02			560.0	995.0	3	1.67	攔河	G2-02
		G2-03			560.0	820.0	57	26.17	攔河	G2-03
		G2-04			975.0	720.0	4	2.81	攔河	G2-04
		G2-05			1055.0	720.0	3	2.28	攔河	G2-05
		G2-06			1109.0	995.0	2	2.21	攔河	G2-06
		G2-07			1109.0	820.0	36	32.74	攔河	G2-07
3		G2-08			1157.5	720.0	4	3.33	攔河	G2-08
4		G2-09			1174.0	995.0	2	2.34	攔河	G2-09
5		G2-10			1174.0	820.0	36	34.66	攔河	G2-10
6		G2-11			1221.0	995.0	2	2.43	攔河	G2-11
5		G2-12			1221.0	820.0	36	36.04	攔河	G2-12
5		G2-13			1240.0	720.0	8	7.14	攔河	G2-13
5		G2-14			1260.0	720.0	2	1.81	攔河	G2-14
5		G2-15			1265.0	995.0	6	7.55	攔河	G2-15
5		G2-16			1265.0	820.0	114	118.25	攔河	G2-16
5		G2-17			1287.0	995.0	2	2.56	攔河	G2-17
5		G2-18			1287.0	820.0	36	37.99	攔河	G2-18

 美特鋁質 有限公司 MIDI Aluminium Fabricator Ltd.		工程號:	J852	計算:	Ivan	日期:	2020.07.14	送呈:		
		地盤名稱:		核對:		日期:		副本:		
工廠用玻璃B.M.表		項目類別:	攔河玻璃	批准:		日期:		A/C Code:		
BM編號:		修改版次:		總計玻璃面積 (平方米):		743.16				
序號	修改內容	玻璃圖號	顏色與類型	厚度 (mm)	玻璃尺寸		數量 (塊)	總面積 (平方米)	使用位置	加工圖參考
					寬度 (W mm)	高度 (H mm)				
5		G2-19	10mm+1.52mm PVB+10mm CLEAR LAM. GLASS	21.52	1310.0	720.0	4	3.77	攔河	G2-19
5		G2-20			1457.0	720.0	1	1.05	攔河	G2-20
5		G2-21			1962.0	995.0	2	3.90	攔河	G2-21
5		G2-22			1962.0	820.0	36	57.92	攔河	G2-22
5		G2-23			2162.0	995.0	2	4.30	攔河	G2-23
5		G2-24			2162.0	820.0	36	63.82	攔河	G2-24
5		G2-25			2400.0	720.0	1	1.73	攔河	G2-25
5		G2-26			2480.0	720.0	1	1.79	攔河	G2-26
5		G2-27			2585.0	995.0	3	7.72	攔河	G2-27
5		G2-28			2585.0	820.0	57	120.82	攔河	G2-28
5		G2-29			1149.0	995.0	2	2.29	攔河	G2-29
5		G2-30			1149.0	820.0	40	37.69	攔河	G2-30
5		G2-31			1184.0	995.0	2	2.36	攔河	G2-31
5		G2-32			1184.0	820.0	40	38.84	攔河	G2-32
5		G2-33			1463.0	720.0	1	1.05	攔河	G2-33
5		G2-34			1546.0	720.0	1	1.11	攔河	G2-34
5		G2-35	1912.0	995.0	2	3.80	攔河	G2-35		
5		G2-36	1912.0	820.0	40	62.71	攔河	G2-36		

 美特鋁質 有限公司 MIDI Aluminium Fabricator Ltd.		工程號:	J852	計算:	Ivan	日期:	2020.07.14	送呈:		
		地盤名稱:		核對:		日期:		副本:		
工廠用玻璃B.M.表		項目類別:	攔河玻璃	批准:		日期:		A/C Code:		
BM編號:		修改版次:		總計玻璃面積 (平方米):		743.16				
序號	修改內容	玻璃圖號	顏色與類型	厚度 (mm)	玻璃尺寸		數量 (塊)	總面積 (平方米)	使用位置	加工圖參考
					寬度 (W mm)	高度 (H mm)				
5		G2-37			445.0	720.0	2	0.64	攔河	G2-37
5		G2-38			2100.0	720.0	1	1.51	攔河	G2-38
5		G2-39			2350.0	720.0	1	1.69	攔河	G2-39
5						合計:	630	743.16		
13						总合计:	630	743.16		
加工注意事項:		1).本表中之所有玻璃顏色待定。								
		2).本表中所有玻璃對角線尺寸偏差要求不超過負2mm。								
		3).本表中玻璃要求粗磨邊處理並倒稜角，而所有玻璃之入爐方向需保持一致。								
		4).本表中所有玻璃成品均需做雙面保護，用透明靜電膠紙加四周一寸FK白膠紙做雙面加固保護處理。								
		5).本表中所有玻璃成品均需注明室內外及其玻璃編號，以便識別。								

CW & Window

ALL GLASS PANELS SHALL BE COMPLIED WITH BS 952 AND DESIGN TO CODE OF PRACTICE FOR STRUCTURAL USE OF GLASS 2018.

IMPACT TEST TO BE COMPLIED WITH BS EN 12600.

DENSITY 26kN/m³

YOUNG'S MODULUS 70,000MPa

ULTIMATE DESIGN STRENGTH OF GLASS (NO COMPOSITE ACTION IS APPLIED FOR THIS SUBMISSION)

LOAD DURATION

SHORT

HEAT STRENGTHENED GLASS 40MPa

TEMPERED GLASS 80MPa

ALL TEMPERED GLASS TO BE HEAT-SOAK TESTED TO CODE OF PRACTICE FOR STRUCTURAL USE OF GLASS 2018 AND EN 14179-1:2016.

GL01 - 8mm THK. HEAT STRENGTHENED GLASS+12mm AIR GAP+10mm THK. TEMPERED GLASS

(DEFLECTION LIMIT: $1260/60 = 21.00$)

GL01a - 8mm THK. HEAT STRENGTHENED GLASS+9mm AIR GAP+12mm THK. TEMPERED GLASS

(DEFLECTION LIMIT: $2060/60 = 34.33$)

GL02 - 8mm THK. HEAT STRENGTHENED GLASS (SPANDREL GLASS)

(DEFLECTION LIMIT: $880/60 = 14.67$)

GL03 - 6mm THK. HEAT STRENGTHENED GLASS+12mm AIR GAP+6mm THK. TEMPERED GLASS

(DEFLECTION LIMIT: $57760 = 9.62$)

GL04 - 10mm THK. TEMPERED GLASS (PROTECTIVE BARRIER)

(DEFLECTION LIMIT: $700/60 = 11.67$) FOR A.W.

(DEFLECTION LIMIT: $746/60 = 12.43$) FOR C.W.

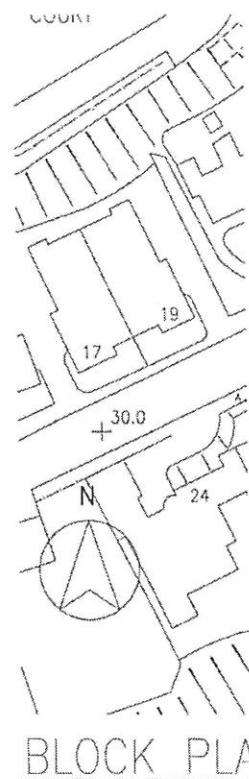
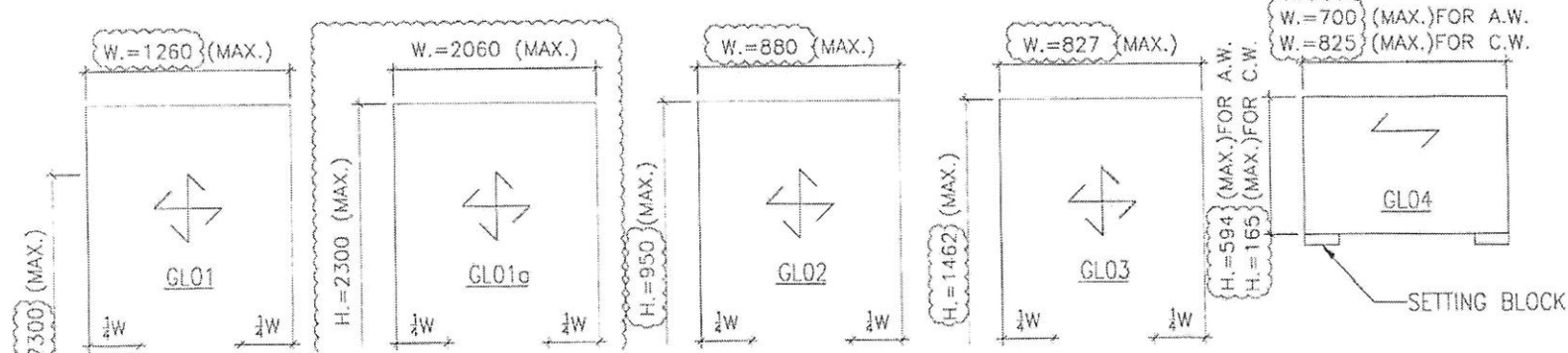

Balustrade

b) HORIZONTAL IMPOSED LOAD ON PROTECTIVE BARRIER : (FOR DOMESTIC USE)

AREA WHERE

- LINE LOAD APPLIED AT HEIGHT OF 1.1M ABOVE F.F.L: 1.5KN/m
- UDL APPLIED ON THE INFILL BETWEEN FLOOR AND TOP RAIL: 1.5KPa
- CONCENTRATE LOAD APPLIED ON ANY PART ON INFILL BETWEEN FLOOR AND TOP RAIL: 1.5KN

3. GLASS :

a) GLASS USED TO BE :

1) GLASS BALUSTRADE FOR G/F AND 1/F FREE STAND BALUSTRADE: (MAX SIZE: 1200mm(W) X 925mm(H))

G1: 12mm THK CLEAR TEMPERED + 1.52mm THK(PVB) + 12mm THK CLEAR TEMPERED LAMINATED GLASS

2) GLASS BALUSTRADE FOR TOWER BALUSTRADE: (MAX SIZE: 2575mm(W) X 987mm(H))

G2: 10mm THK CLEAR TEMPERED + 1.52mm THK(PVB) + 10mm THK CLEAR TEMPERED LAMINATED GLASS

b) DESIGN OF GLASS SHALL COMPLY TO CODE OF PRACTICE FOR STRUCTURE USE OF GLASS 2018 AND BS EN 14179-1:2016

-LOAD DURATION : SHORT

-ULTIMATE DESIGN STRENGTH (TEMPERED) = 80 MPa

-YOUNG'S MODULUS = 70,000 N/mm²

-DENSITY = 26 kN/m³

c) GLASS MATERIALS SHALL COMPLY TO BS 952

d) ALL TEMPERED GLASS TO BE HEAT-SOAK TESTS TO CODE OF PRACTICE FOR STRUCTURAL USE OF GLASS 2018 & BS EN 14179-1:2016

e) IMPACT TEST TO BE CLASS 1 COMPLIED WITH NO GLASS BREAKAGE TO BS EN 12600

4. ALUMINIUM ALLOY :

ALL ALUMINIUM EXTRUSIONS TO BE GRADE 6063-T5 AND 6063-T6 TO BS EN 755-2 AND BS EN 573-3

DENSITY = 27.2kN/m³

MODULUS OF ELASTICITY = 70000 MPa

	6063-T5	6063-T6
0.2% PROOF STRENGTH	= 130 MPa	= 170 MPa
MINIMUM TENSILE STRENGTH	= 175 MPa	= 215 MPa
LIMITING BENDING STRENGTH	= 110 MPa	= 160 MPa
LIMITING TENSILE STRENGTH	= 130 MPa	= 175 MPa
LIMITING SHEAR STRENGTH	= 85 MPa	= 95 MPa

ALL ALUMINIUM SHEET TO BE GRADE 3003-H14 TO BS EN 485-2 AND BS EN 573-3

DENSITY = 27.2kN/m³

MODULUS OF ELASTICITY = 70000 MPa

PVC TAPE TO BE APPLIED BETWEEN DISJUNCTION METAL TO PREVENT BIMETALLIC CORROSION
PVC TAPE TO BE APPLIED BETWEEN METAL AND CONCRETE SURFACE

11. CONCRETE (UNDER SEPARATED SUBMISSION)

ALL CONCRETE STRUCTURE SHOWN IN THE SUBMISSION ARE FOR INFORMATION ONLY.
CONCRETE ELEMENTS TO BE MINIMUM GRADE C45.

12. ANCHOR BOLT

ANCHOR BOLT TO BE "HILTI", DESIGN AND INSTALLATION TO BE IN ACCORDANCE WITH

B.D. REF.	TYPE (FOR CRACKED CONCRETE)	MINIMUM	EFFECTIVE	MINIM
		CONCRETE THICKNESS (mm)	ANCHORAGE DEPTH (mm)	EDGE C (m)
BD-AF 149	'HILTI' HST3-R M10	120	60	4

CONSIDER CONCRETE GRADE FACTOR: $\sqrt{\frac{45}{25}} = 1.342$

FACTOR OF SAFETY = 3.0

13. TYPICAL DETAIL OF GLASS

1) GLASS BALUSTRADE FOR G/F AND 1/F FREE-STAND BALUSTRADE: (MAX SIZE: 1200mm(W) X 925mm(H))
G1: 12mm THK CLEAR TEMPERED + 1.52mm THK(PVB) + 12mm THK CLEAR TEMPERED LAMINATED GLASS

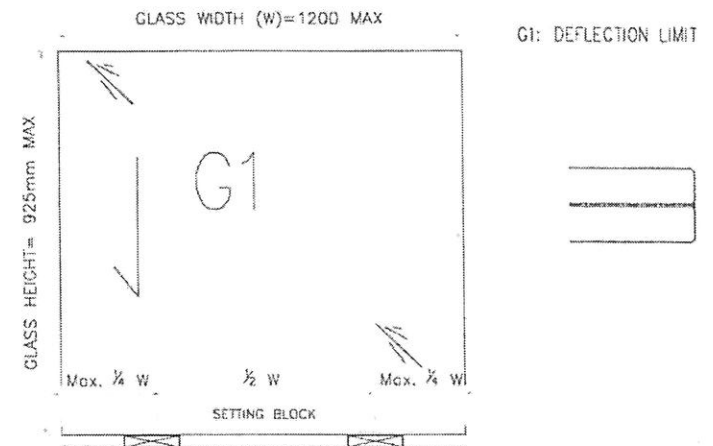

Glass Cladding

2. DESIGN LOADS :

a) WIND LOAD :

HEIGHT ABOVE GROUND LEVEL = 92.70M

DESIGN WIND PRESSURE FOR GLASS CLADDING

BASE WIND LOAD: 2.82 KPa

DESIGN WIND LOAD ($C_p = +1.0/-1.4$) : $2.82 \times (C_p = +1.0) = 2.82 \text{ KPa}$ (FOR INWARD)
 $2.82 \times (C_p = -1.4) = -3.948 \text{ KPa}$ (FOR OUTWARD)

3. GLASS :

a) FACIAL GLASS FOR GLASS CLADDING USED TO BE :

i) GI : 10 mm THK. HEAT STRENGTHENED GLASS

b) DESIGN OF GLASS SHALL COMPLY TO CODE OF PRACTICE FOR STRUCTURE USE OF GLASS 2018

-LOAD DURATION : SHORT

-ULTIMATE DESIGN STRENGTH (HEAT STRENGTHENED) = 40 N/mm²

-YOUNG'S MODULUS = 70,000 N/mm²

-DENSITY = 26 kN/m³

c) GLASS MATERIALS SHALL COMPLY TO ASTM C1036 & ASTM C1048

4. ALUMINIUM ALLOY :

DESIGN DEAD LOAD - ALUM. WEIGHT: 27.2kN/m³

a) ALUMINIUM SHEET :

ALL ALUMINIUM SHEET TO BE ALLOY 3003-H14 TO ALUMINIUM DESIGN MANUAL: BS EN485-2:2008

0.2% PROOF (YIELD) STRENGTH = 125 MPa

MINIMUM ULTIMATE TENSILE STRESS = 145 MPa

MODULUS OF ELASTICITY (E) = 70000 MPa.

b) ALUMINIUM EXTRUSION : IN ACCORDANCE WITH DESIGN CODE BS: 8118-1:1991, COMPLY TO BS EN 755-2, 2008

i) ALUMINIUM EXTRUSION - TO BE ALLOY 6061-T6

0.2% PROOF STRENGTH = 240 MPa

MINIMUM TENSILE STRENGTH = 260 MPa

MODULUS OF ELASTICITY = 70000 MPa.

ii) ALUMINIUM EXTRUSION - TO BE ALLOY 6063-T6

0.2% PROOF STRENGTH = 160 MPa

MINIMUM TENSILE STRENGTH = 175 MPa

MODULUS OF ELASTICITY = 70000 MPa.

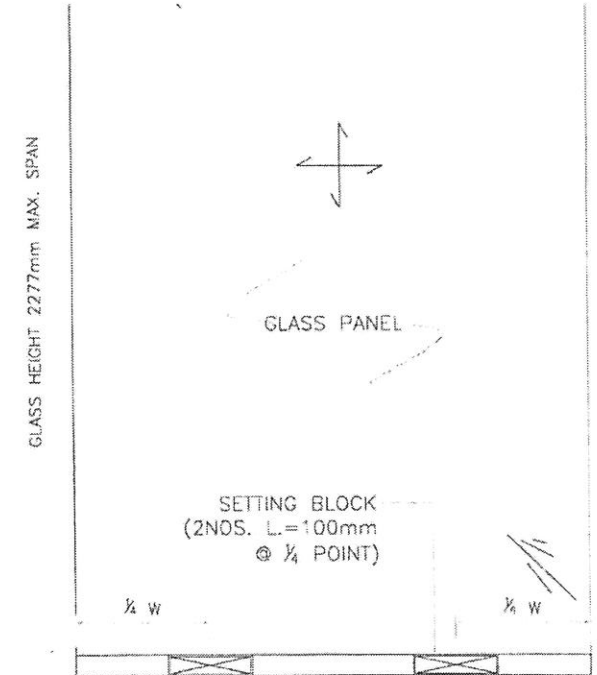

" TYPICAL ELEVATION FOR SETTING BLOCK LOC/
(N.T.S.)

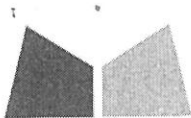

美特鋁質有限公司
MIDI ALUMINIUM FABRICATOR LTD.

Our ref. MC/40002/852

2021年3月4日

金門建築有限公司
何文田亞皆老街 139-147 號

電郵及郵遞

收件人: Mr Dick Yuen / Ms Penny Chau

3299A

Dear Sir,

項目: 何文田亞皆老街 139-147 號
有關訂大貨玻璃事宜

您們好!

因應地盆進度緊迫，於二零二一年三月二日會議中本司通知 貴司，已經按 MC/39867/852 批板玻璃的 Low-E SEE0-83T#2，訂購大貨玻璃。各項目(包括 Curtain Wall、Glass Cladding、Insitu Window and Door、Precast Window、Balustrade) 的玻璃已按最後批圖的尺寸生產。

如後來尺寸或款式修改，導致重做。請先發出 A.I 確認更改，以便跟進。附上批玻璃批板相片。此作記錄，謝謝留意。

此謝

美特鋁質有限公司

繆靄超

董事總經理

附件：共七頁

抄送：	金門	- Mr. Chris Kwok / Ms. Myra Li /	(電郵)
		- Ms. Esther Chung / Ms. Angel Man /	
		- Mr. Jackson Mok	
	信和	- Mr. Billy Tang / Mr. Jimmy Cheung /	(電郵)
		- Mr. Terry Wan / Mr. Jaja Wong	
	AGC	- Mr. Raymond Ho / Mr. Eliot Chan	(電郵)
	邁進	- Mr. Brian Leung / Mr. Nigel Lo	(電郵)
		- Ms. Yoanna Chan / Ms. Cosimo Wong	
		- Mr. Neo Wong	

EM/MT/DW/AY/BE/KL/Y
九龍葵涌領道610號生利工業中心1樓6-8號
Units 6-8, 1st Floor, Sunray Industrial Centre, 610 Cha Kwo Ling Road, Kln.
TEL. (電話): 2348 9211 FAX. (傳真): 2772 7666 E-mail Address (電郵): midi@midiltd.com.hk.



ISO 9001 : 2015
Certificate No: CC 1795



MIDI ALUMINIUM FABRICATOR LTD.

Units 6, 7, 8 Sanyo Industrial Centre, 1st floor, 610 Cho Kwong Road, Kowloon

Project : No. 139-147 Argyle Street, Kowloon

Subject : Re-submission of Glass Sample (Low Iron IGU, Silver Tinted IOL with SC-0.68) (MS623)

Silver Tinted IOL with SC-0.68
 8mm Low-Iron HS (with low-e coating in light grey colour at surface #2) +
 12mm Air Gap + 10mm Low-Iron HS
 Sample Code : D20120140
 (KSELU-83THS) + 12A + IUCB)

Letter ref. : MC/39867/652

Date : 14th December 2020

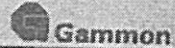

Gammon 13860 - Proposed Residential Development, At 139 - 147 Argyle Street, Kowloon

Submission Ref. no.:	MC/39867/652	Authorized Representative:	<input checked="" type="checkbox"/> Pacific Shine <input checked="" type="checkbox"/> AGC <input type="checkbox"/> ARUP <input type="checkbox"/> WOY	<input checked="" type="checkbox"/> MFT <input type="checkbox"/> AXXA <input type="checkbox"/> <input type="checkbox"/>	approval on application only
Material Description:	SC-0.68 Silver Tinted IOL	Name:	BEAT TANG		
Submission Date:	14/12/2020	Signature:	<i>[Signature]</i>	BEAT TANG	All advice comment technically refer to submittal comment's comment on performance data BRIAN LAUNG
Approval Date:		Signature Date:	16.12.2020	17/12/2020	
Comment:					M. Chen 17 Dec 2020



J3860 - PROPOSED RESIDENTIAL DEVELOPMENT,
AT 139 - 147 ARGYLE STREET, KOWLOON

SHOP DRAWING SUBMISSION FORM

To: Mr Brian Leung / Ms Yoanna Chan / Mr Nigel Lo
Meinhardt Façade Technology (HK) Ltd
22/F Great Smart Tower,
230 Wanchai Road,
Wan Chai, Hong Kong

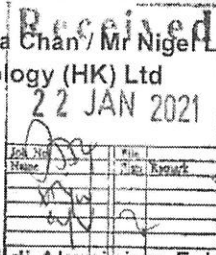

No. : SD/A/007 (Rev. 6)
Ref : J3860/304.8/D08236
Date : 20 January 2021

On behalf of Subcontractor Midi Aluminium Fabrication Ltd, we would submit the shop drawing(s) on the attached list for your approval / endorsement / record.

Expected Reply Date: 03 February 2021

Regarding: Shop Drawing Submission for Slick Curtain Wall (6th Submission)
(Midi Ref: SD095)

Remarks: With Drawing List Attached (36 Nos. Drawings); SD/A/007 (Rev.5) commented by AGC on 17 November 2020; by MFT on 19 November 2020; soft copies received by GECCL by email on 18 January 2021; hard copies received by GECCL on 20 January 2021

Dick Yuen
Senior Project Manager
Gammon Engineering &
Construction Company Limited

full set

DYNAMIC/wym

Encl

Comment:

- (A) Approved
- (B) Approved with comment
- (C) Approved with comment & resubmit
- (D) Rejected

Other Remarks:

① THE CLADDING AT 23/F BELOW THE R.D. PROTECTION SHOULD MATCH THE SLOPE DIVISION ABOVE AND SHOULD NOT EXPOSED THE MULLION

② DRAWINGS APPROVED PREVIOUSLY SHALL REFER TO SD/A/007 (REV.5)

Signed By: Raymond Ho

Date: 2.2.2021

Distribution:

- cc Pacific Shine - Mr Billy Tang / Mr Kocher Wong / Mr Edwin Chow / Mr Simon Chung / Mr Terry Wan / Mr Ross Pau / Mr Ken Ng / Mr Wyman Fong / Mr Jimmy Cheung / Mr C F Lee / Mr Peter Chong
- AGC - Ms Grace Cheng / Mr Raymond Ho
- ARUP (Stru) - Mr Johnson Po / Mr Don Ho / Ms Jessie Zhang / Mr Andrew Tai
- W&O - Mr Nier Chan / Mr Anson Lau
- Arcadis - Ms Brenda Mok / Ms Emily Chu
- AXXA - Ms Siuman Hung / Ms Sammy Tang / Mr Oscar Leung / Ms Yvonne Yau
- ARUP (Traffic) - Ms Carmen Chu / Mr Eddy Cheung
- WSP - Ms Anthea Ng / Mr Dennis Tse
- RE - Mr Edwin Lui / Mr Yang Li / Mr Raymond Hui
- MFT RE - Ms Cosimo Wong / Mr Neo Wong
- OSR - Mr K M Pang / Mr H T Tseung / Mr Poon Tsz Kit / Mr S T Chan / Mr Ben Li
- BSI (Sino) - Mr Kelvin Tam
- RBSE (W&O) - Mr Kevin Lee
- GECCL - QS / Setting Out
- S/C - Midi / Temmex / Zui Loong / Chit Tat / Pyfyoe / Kammon / Keio / Alpha Idea / Wing Hong Shun (By Email)
- S/C - Wah Cheong

**Remarks : w/encl w/o encl.



J3860 - PROPOSED RESIDENTIAL DEVELOPMENT,
AT 139 - 147 ARGYLE STREET, KOWLOON

SHOP DRAWING SUBMISSION FORM

To: **Mr Brian Leung / Ms Yoanna Chan / Mr Nigel Lo** No. : SD/A/015 (Rev.2)
Meinhardt Façade Technology (HK) Ltd
 22/F Great Smart Tower, Ref : J3860/304.8/D04312
 230 Wanchai Road, Date : 11 June 2020
 Wan Chai, Hong Kong

On behalf of Subcontractor Midi Aluminium Fabrication Ltd, we would submit the shop drawing(s) on the attached list for your approval / endorsement / record.

Expected Reply Date: 26 June 2020

Regarding: Shop Drawing submission for Glass Cladding at Spandrel (Midi's Ref:SD038)
(3rd Submission)

Remarks: With Drawing List Attached (18 Nos. Drawings); soft copies received by GECCL
On 9 June 2020; hard copies received on 10 June 2020, SD/A/015 (Rev.1) commented
by AGC received on 12-Mar-2020; by MFT on 6-Apr-2020

[Signature]
Dick Yuen
 Senior Project Manager
 Gammon Engineering &
 Construction Company Limited

full set

DY/AM/JM/CK/PC/wym

Encl

Comment:

- (A) Approved
- (B) Approved with comment
- (C) Approved with comment & resubmit
- (D) Rejected

Other Remarks:
(1) Submitter to comment from MFAÇADE
(2) Stru Ltd follow layout on GSP.

Signed By: Raymond Ho Date: 26.7.2020

Distribution:

- | | | |
|----|---|--|
| cc | <input checked="" type="checkbox"/> Pacific Shine | Mr Billy Tang / Mr Kocher Wong / Mr Edwin Chow / Mr Simon Chung / Mr Terry Wan / Mr Ross Pau / Mr Ken Ng / Mr Wyman Fong / Mr Jimmy Cheung / Mr C F Lee / Mr Peter Chong |
| | <input checked="" type="checkbox"/> AGC | - Ms Grace Cheng / Mr Raymond Ho |
| | <input checked="" type="checkbox"/> ARUP (Stru) | - Mr Johnson Po / Mr Don Ho / Ms Jessie Zhang |
| | <input checked="" type="checkbox"/> W&O | - Mr Nier Chan / Mr Anson Lau |
| | <input type="checkbox"/> Arcadis | - Ms Brenda Mok / Ms Emily Chu |
| | <input type="checkbox"/> AXXA | - Ms Siunan Hung / Ms Sammy Tang / Mr Oscar Leung / Ms Yvonne Yau |
| | <input type="checkbox"/> ARUP (Traffic) | - Ms Carmen Chu / Mr Eddy Cheung |
| | <input type="checkbox"/> WSP | - Ms Anthea Ng / Mr Dennis Tse |
| | <input checked="" type="checkbox"/> RE | - Mr Mathew Au / Mr Andrew Tai / Mr Yang Li |
| | <input checked="" type="checkbox"/> OSR | - Mr K M Pang / Mr H T Tseung / Mr Poon Tsz Kit / Mr S T Chung / Mr Ben Li |
| | <input checked="" type="checkbox"/> BSI (Sino) | - Mr Kelvin Tam |
| | <input checked="" type="checkbox"/> RBSE (W&C) | - Mr Kevin Lee |
| | <input checked="" type="checkbox"/> GECCL | - DY / LCW / QS / Setting Out / BS Team / Structural Team |
| | <input checked="" type="checkbox"/> S/C | - Midi / Temmex / Zul Loong (By Email) |
| | <input checked="" type="checkbox"/> S/C | - Wah Cheong (Hard Copy) |

**Remarks : w/encl wo encl.



J3860 - PROPOSED RESIDENTIAL DEVELOPMENT,
AT 139 - 147 ARGYLE STREET, KOWLOON

SHOP DRAWING SUBMISSION FORM

To: Mr Brian Leung / Ms Yoanna Chan
Meinhardt Façade Technology (HK) Ltd
22/F Great Smart Tower,
230 Wanchai Road,
Wan Chai, Hong Kong

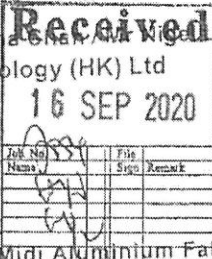

No. : SD/A/006 (Rev.4)
Ref : J3860/304.6/D06069
Date : 14 September 2020

On behalf of Subcontractor Midi Aluminium Fabrication Ltd., we would submit the shop drawing(s) on the attached list for your approval / endorsement / record.

Expected Reply Date: 29 September 2020

Regarding: Shop Drawing Submission of Metal Balustrade and Glass Balustrade (4th Submission) (Midi Ref: SD059)

Remarks: With Drawing List Attached (111 Nos. Drawings); hard copies received from Midi on 14 September 2020; soft copies received from Midi on 11 September 2020. SD/A/006 (Rev.3) commented by MFT on 29 July 2020 and AGC on 11 August 2020

Dick Yuen
Senior Project Manager
Gammon Engineering &
Construction Company Limited

full set

DY/AMT/ATCK/PC/wym

Encl

Comment:

- (A) Approved
- (B) Approved with comment
- (C) Approved with comment & resubmit
- (D) Rejected

Other Remarks:

① Detail and appearance should follow TRIS (AS-BUILD) BALUSTRADE
② All structural & timber set out to be completed by
Midi
Signed By: *[Signature]* Date: 20.10.2020

Distribution:

- Pacific Stone - Mr Billy Tang / Mr Kookler Wong / Mr Edwin Chow / Mr Terry Wan / Mr Simon Chung / Mr Ross Pau / Mr Ken Ng / Mr Wyman Fong / Mr Jimmy Cheung / Mr C F Lee / Mr Peter Chong
- AGC - Ms Grace Cheng / Mr Raymond Ho
- ARJP (Stru) - Mr Johnson Po / Mr Don Ho / Ms Jessie Zhang
- W&O - Mr Nier Chan / Mr Anson Lau
- Arcadis - Ms Brenda Mok / Ms Emily Chu
- AXXA - Ms Siuman Hung / Ms Sammy Tang / Mr Oscar Leung / Ms Yvonne Yau
- ARUP (Traffic) - Ms Carmen Chu / Mr Eddy Cheung
- WSP - Ms Anthea Ng / Mr Dennis Tse
- RE - Mr Andrew Tai / Mr Yang Li / Mr Oscar Tam
- OSR - Mr K M Pang / Mr H T Tseung / Mr Poon Tsz Kit / Mr S T Chung / Mr Ben Li
- BSI (Sino) - Mr Kelvin Tam
- RESE (W&O) - Mr Kevin Lee
- GECCL - OS / Setting Out / BS Team / LCW / Structural Team
- S/C - Midi / Wing Hong Shun / Kammon / Temmex / Chit Tai / Zui I ong/Ke o (By Email)
- S/C - Wah Cheong

③

Comment only refer to aesthetic appearance of Balustrade and Detail. Technical performance and material specification should refer to comment of facade

**Remarks: w/end w/o end.



J3860 - PROPOSED RESIDENTIAL DEVELOPMENT,
AT 139 - 147 ARGYLE STREET, KOWLOON

SHOP DRAWING SUBMISSION FORM

To: **Mr Brian Leung / Ms Yoanna Chan / Mr Nigel Lo** No. : SD/A/005 (Rev.6)
Meinhardt Façade Technology (HK) Ltd Ref : J3860/304.8/D04856
 22/F Great Smart Tower, Date : 14 July 2020
 230 Wanchai Road,
 Wan Chai, Hong Kong

AGC received on 15.7.2020

On behalf of Subcontractor Midi Aluminium Fabrication Ltd., we would submit the shop drawing(s) on the attached list for your approval / endorsement / record.

Expected Reply Date: 28 July 2020

Regarding: 6th Shop Drawing Submission of Aluminum Windows at Precast Facade
 (Midi Ref: SD042)

Remarks: With Drawing List Attached (157 Nos. Drawings); hard copies received from Midi on 14 July 2020; soft copies received from Midi on 13 July 2020; comments received by AGC on 5th submission on 01 June 2020; by MFT on 22 June 2020.

Dick Yuen
 Senior Project Manager
 Gammon Engineering &
 Construction Company Limited

Call set

DY/AM/JM/CK/BS/wym

Encl

Comment:

- (A) Approved
- (B) Approved with comment
- (C) Approved with comment & resubmit
- (D) Rejected

Other Remarks:

- ① All calculation should round up to 3 digit.
- ② PLEASE REVIEW ALL DETAIL WITH PRECAST FACADE DRAWING
- ③ PLEASE REVIEW DETAIL AS PER COMMENT ON REBAR MOCK-UP
- ④ SUBJECT TO COMMENT FROM M/FACADE

Signed By: *[Signature]*

Date: 23.7.2020

Distribution:

- | | | |
|----|---|--|
| cc | <input checked="" type="checkbox"/> Pacific Shine | - Mr Billy Tang / Mr Kocher Wong / Mr Edwin Chow / Mr Terry Wan / Mr Simon Chung / Mr Ross Pau / Mr Ken Ng / Mr Wyman Fong / Mr Jimmy Cheung / Mr C F Lee / Mr Peter Chong |
| | <input checked="" type="checkbox"/> AGC | - Ms Grace Cheng / Mr Raymond Ho |
| | <input checked="" type="checkbox"/> ARUP (Stru) | - Mr Johnson Po / Mr Don Ho / Ms Jessie Zhang |
| | <input checked="" type="checkbox"/> W&O | - Mr Nier Chan / Mr Anson Lau |
| | <input checked="" type="checkbox"/> Arcadis | - Ms Brenda Mok / Ms Emily Chu |
| | <input type="checkbox"/> AXXA | - Ms Siuman Hung / Ms Sammy Tang / Mr Oscar Leung / Ms Yvonne Yau |
| | <input type="checkbox"/> ARUP (Traffic) | - Ms Carmen Chu / Mr Eddy Cheung |
| | <input type="checkbox"/> WSP | - Ms Anthea Ng / Mr Dennis Tse |
| | <input type="checkbox"/> RE | - Mr Andrew Tai / Mr Yang Li / Mr Oscar Tam |
| | <input checked="" type="checkbox"/> OSR | - Mr K M Pang / Mr H T Tseung / Mr Poon Tsz Kit / Mr S T Chung / Mr Ben Li |
| | <input checked="" type="checkbox"/> BSI (Sino) | - Mr Kelvin Tam |
| | <input checked="" type="checkbox"/> RBSE (W&O) | - Mr Kevin Lee |
| | <input checked="" type="checkbox"/> GECCL | - QS / Setting Out / BS Team / LCW |
| | <input checked="" type="checkbox"/> S/C | - Midi / Wing Hong Shun / Temmex / Keio / Chit Tat / Pyrofoe / Kammon / Zui Loong (By Email) |
| | <input checked="" type="checkbox"/> S/C | - Wah Cheong |

**Remarks : w/encl w/o encl.



J3860 - PROPOSED RESIDENTIAL DEVELOPMENT,
AT 139 - 147 ARGYLE STREET, KOWLOON

SHOP DRAWING SUBMISSION FORM

To: **Mr Brian Leung / Ms Yoanna Chan / Mr Nigel Lo** No. : SD/A/019 (Rev.2)
Meinhardt Façade Technology (HK) Ltd Ref : J3860/304.8/D03805
 22/F Great Smart Tower, Date : 14 May 2020
 230 Wanchai Road,
 Wan Chai, Hong Kong

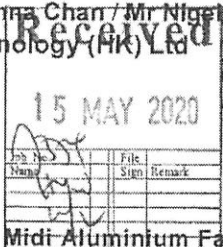

On behalf of Subcontractor **Midi Aluminium Fabrication Ltd.**, we would submit the shop drawing(s) on the attached list for your approval / endorsement / record.

Expected Reply Date: 28 May 2020

Regarding: 3rd Shop Drawing Submission of In Situ Aluminium Windows, French Doors & Sliding Doors for 1/F - 21/F (Midi Ref: SD032)

Remarks: With Drawing List Attached (59 Nos. Drawings); SD/A/019 (Rev.1) commented by AGC on 31 March 2020; soft copies received by GECCL on 11 May 2020; hard Copies received on 13 May 2020.

full set

Dick Yuen
Senior Project Manager
Gammon Engineering &
Construction Company Limited

DY/AM/JMK/HS/wym

Encl

Comment:

(A) Approved
 (B) Approved with comment
 (C) Approved with comment & resubmit
 (D) Rejected

Other Remarks:
 ① - TO REVISE LOWER DETAIL
 ② - KEEP THE F.O. OF ALL KITCHEN WINDOW AND TO FOLLOW G.B.P.
 ③ - SHOW FINISHING LINE INTERFACE WITH WINDOW FRAME.

Signed By: Date: 18-5-2020

- Distribution:
- cc Pacific Shine - Mr Billy Tang / Mr Kocher Wong / Mr Edwin Chow / Mr Simon Chung / Mr Ross Pau / Mr Ken Ng / Mr Wyman Fong / Mr Jimmy Cheung / Mr C F Lee / Mr Peter Chong
 - AGC - Ms Grace Cheng / Mr Raymond Ho
 - ARUP (Stru) - Mr Johnson Po / Mr Don Ho / Ms Jessy Zhang
 - W&O - Mr Nier Chan / Mr Anson Lau
 - Arcadis - Ms Brenda Mok / Ms Emily Chu
 - AXXA - Ms Siuman Hung / Ms Sammy Tang / Mr Oscar Leung / Ms Yvonne Yau
 - ARUP (Traffic) - Ms Carmen Chu / Mr Eddy Cheung
 - WSP - Ms Anthea Ng / Mr Dennis Tse
 - RE - Mr Matthew Au / Mr Andrew Tai / Mr Yang Li
 - OSR - Mr K M Pang / Mr H T Tseung / Mr Poon Tsz Kit / Mr S T Chan / Mr Ben Li
 - BSI (Sino) - Mr Kelvin Tam
 - RBSE (W&O) - Mr Kevin Lee
 - GECCL - DY / QS / Setting Out / BS Team / LCW
 - S/C - Midi / Wing Hong Shun / Temmex / Keio / Chit Tat / Pyrofoe / Kammon / Zui Loong (By Email)
 - S/C - Wah Cheong

**Remarks : w/encl w/o encl.



J3860 - PROPOSED RESIDENTIAL DEVELOPMENT,
AT 139 - 147 ARGYLE STREET, KOWLOON

SHOP DRAWING SUBMISSION FORM

To: Mr Brian Leung / Ms Yoanna Chan / Mr Nigel Lo
Meinhardt Façade Technology
22/F Great Smart Tower,
230 Wanchai Road,
Wan Chai, Hong Kong

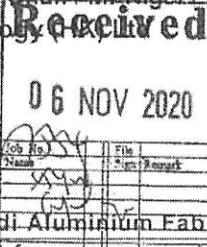

No. : SD/A/019 (Rev.5)
Ref : J3860/304.8/D06870
Date : 04 November 2020

On behalf of Subcontractor Midi Aluminium Fabrication Ltd., we would submit the shop drawing(s) on the attached list for your approval / endorsement / record.

Expected Reply Date: 18 November 2020

Regarding: Shop Drawing Submission of In Situ Aluminium Windows, French Doors & Sliding Doors (5th Submission) (Midi Ref: SD073)

Remarks: With Drawing List Attached (74 Nos. Drawings); SD/A/019 (Rev.4) commented by AGC on 28 September 2020, by MFT on 22 September 2020; soft copies received by GECCL on 3 November 2020; hard copies received on 4 November 2020.

Dick Yuen
Senior Project Manager
Gammon Engineering &
Construction Company Limited

Revised drawing only

DY/AM/TM/CK/PC/wym

Encl

Comment:

- (A) Approved
- (B) Approved with comment
- (C) Approved with comment & resubmit
- (D) Rejected

Other Remarks:

① THE DIMENSION OF CLEAR OPENING OF SLIDING DOOR / FRENCH DOOR / WINDOW (AND) BEEN TOTALLY CORRECTED IN THIS DRAWING SUBMISSION. DO YOU MEAN THAT THE DIMENSION OF THESE SIMILAR CLEAR OPENING IN THOSE PREVIOUS APPROVED DRAWING ARE WRONG? PLEASE CLARIFY AS

Signed By: Raymond Ho Date: 11.11.2020

Distribution:

- cc Pacific Shine - Mr Billy Tang / Mr Kocher Wong / Mr Edwin Chow / Mr Terry Wan / Mr Simon Chung / Mr Ross Pau / Mr Ken Ng / Mr Wyman Fong / Mr Jimmy Cheung / Mr C F Lee / Mr Peter Chong
- AGC - Ms Grace Cheng / Mr Raymond Ho
- ARUP (Stru) - Mr Johnson Po / Mr Don Ho / Ms Jessie Zhang
- W&O - Mr Nier Chan / Mr Anson Lau
- Arcadis - Ms Brenda Mok / Ms Emily Chu
- AXXA - Ms Siuman Hung / Ms Sammy Tang / Mr Oscar Leung / Ms Yvonne Yau
- ARUP (Traffic) - Ms Carmen Chu / Mr Eddy Cheung
- WSP - Ms Anthea Ng / Mr Dennis Tse
- RE - Mr Andrew Tai / Mr Yang Li / Mr Oscar Tam
- MFT RE - Ms Cosimo Wong / Mr Neo Wong
- OSR - Mr K M Pang / Mr H T Tseung / Mr Poon Tsz Kit / Mr S T Chan / Mr Ben Li
- BS: (Sino) - Mr Kelvin Tam
- RBSE (W&O) - Mr Kevin Lee
- MOTY - Mr Terence Tse / Mr Ringo Lee
- GECCL - QS / Setting Out
- S/C - Midi / Wing Hong Shun / Zui Loong (By Email) Wah Cheong

more on previous approved consultation wrong!

② Sample of detachable hinge still not returned
③ DETACHABLE HANDLE SHOULD BE INDICATED FOR BM MAINTENANCE WITH ANNOTATED UNDER GEP.

**Remarks: w/encl w/o encl.