

工程指示 / 要求簡箋(E.I.)

工程指示編號：EI / 2201 / 20

修改版次：-

工程編號：J - 852

工程名稱：亞皆老街中電

工程項目：佛沙窗 夾通位置鑽孔

收件人：生統 / 王良

發件人：Ant Yeung

日期：29/07/2020

要求提供 / 確認 事項：

- | | | |
|------------------------------------|-------------------------------------|-------------------------------|
| <input type="checkbox"/> 初步鋁料 B.M. | <input type="checkbox"/> 加工拆圖，然後生產 | <input type="checkbox"/> 尺寸表 |
| <input type="checkbox"/> 正式鋁料 B.M. | <input type="checkbox"/> 技術上資料 / 指示 | <input type="checkbox"/> 報價 |
| <input type="checkbox"/> 配件 B.M. | <input type="checkbox"/> 樣辦或貨品說明書 | <input type="checkbox"/> 分判合約 |
| <input type="checkbox"/> 其他：_____ | | |

內容：

請按佛沙場和 RE 要求，因夾通加長後，會阻鋼筋。

因佛沙窗 EI 1971 和 EI 2091 已送佛沙場。請在佛沙場加開 20mm 圓孔。

請通知駐廠人員，謝謝

EI 2092 (T1) 在廠開，謝謝

謝謝

請在 2020.07.31 前完成上列要求。

附有關圖紙 / 文件：

以上項目為：

- 原合約工程包 原合約工程加 / 減賬 新工程報價

原因：-

分發東莞各部門：

- | | | | |
|---|---|--|--|
| <input type="checkbox"/> 生產技術總監 <input type="checkbox"/> 連附件 | <input type="checkbox"/> 技術部 <input type="checkbox"/> 連附件 | <input type="checkbox"/> 生產部 <input type="checkbox"/> 連附件 | <input type="checkbox"/> 機械設計部 <input type="checkbox"/> 連附件 |
| <input type="checkbox"/> 採購部 <input type="checkbox"/> 連附件 | <input checked="" type="checkbox"/> 生產統籌部 <input checked="" type="checkbox"/> 連附件 | <input checked="" type="checkbox"/> 小羅 & 清 <input checked="" type="checkbox"/> 連附件 | |
| <input checked="" type="checkbox"/> 質檢部 <input checked="" type="checkbox"/> 連附件 | <input type="checkbox"/> 會計部 <input type="checkbox"/> 連附件 | <input type="checkbox"/> 報關組 <input type="checkbox"/> 連附件 | <input type="checkbox"/> 其他 _____ <input type="checkbox"/> 連附件 |

分發其他分判：

- 水洪 連附件

分發香港各部門：

- | | | | |
|---|--|---|--|
| <input type="checkbox"/> 行政部 <input type="checkbox"/> 連附件 | <input type="checkbox"/> 會計部 <input type="checkbox"/> 連附件 | <input type="checkbox"/> 統籌部 <input type="checkbox"/> 連附件 | <input type="checkbox"/> 工程部地盤科文 <input type="checkbox"/> 連附件 |
| <input type="checkbox"/> 採購部 <input type="checkbox"/> 連附件 | <input type="checkbox"/> QS 部 <input type="checkbox"/> 連附件 | <input type="checkbox"/> 維修部 <input type="checkbox"/> 連附件 | <input type="checkbox"/> 其他 _____ <input type="checkbox"/> 連附件 |

傳遞編號：

HK 1591 / 20

發件人簽署：

項目經理簽署：

20mm x 20mm slot hole for passing through a Y16 rebar

FINISHED (UNDER SEPARATED SUBMISSION)

OUTSIDE

W.O. DIMENSION POINT

EDGE OF FACADE

1 VERTICAL DETAIL SCALE 1:2

FINISHED (UNDER SEPARATED SUBMISSION)

OUTSIDE

W.O. DIMENSION POINT

EDGE OF FACADE

3 VERTICAL DETAIL SCALE 1:2

OUTSIDE

W.O. DIMENSION POINT

EDGE OF FACADE

FINISHED (UNDER SEPARATED SUBMISSION)

2 VERTICAL DETAIL SCALE 1:2

FINISHED (UNDER SEPARATED SUBMISSION)

OUTSIDE

W.O. DIMENSION POINT

EDGE OF FACADE

4 VERTICAL DETAIL SCALE 1:2

20mm x 20mm slot hole for passing through a Y16 rebar

灰面位置
圖力是
阻鋼板

窗洞 20x20 圓孔

配 2201
HK 1591

窗洞
阻鋼板
圓孔

e1209
e1209
19X1

B.D. REF :

CLIENT :

ARCHITECT :



MAIN CONTRACTOR :



STRUCTURAL ENGINEER :



FACADE CONSULTANT :



NOTE:

1. ALL DIMENSIONS ARE IN MM.
2. ALL ELEVATIONS ARE VIEWED FROM OUTSIDE.
3. ALL DIMENSIONS TO BE VERIFIED ON SITE BEFORE FABRICATION.

LEGEND:

⊗ DETAIL MARK NO.

⊗ REFER SHEET NO.

1. F.F.L. -- FINISHED FLOOR LEVEL

2. S.F.L. -- STRUCTURAL FLOOR LEVEL

3. ⊗ -- REVERSED DETAIL

4. ▲ -- FIXING LOCATION

5. △ -- FIXING LUG LOCATION

6. CLASS LEGEND

GL01 -- 6mm+12mm AIR GAP+10mm THK. L.G.U.

GL01a -- 8mm+9mm AIR GAP+12mm THK. L.G.U.

GL02 -- 10mm THK. TEMPERED GLASS (SPANDREL GLASS)

GL03 -- 6mm+12mm AIR GAP+6mm THK. L.G.U.

GL04 -- 10mm THK. TEMPERED GLASS (PROTECTIVE BARRED)

GL05 -- 6mm+12mm AIR GAP+8mm THK. L.G.U.

REV.	DATE	REVISION SUBJECT TO ARCH.COMMENT	BY
B	24/04/2020	REVISION SUBJECT TO ARCH.COMMENT	MAN
A	16/04/2020	REVISION SUBJECT TO ARCH.COMMENT	MAN

JOB NO. : J-852

PROJECT :
PROPOSED RESIDENTIAL DEVELOPMENT
AT 139 - 147 ARGYLE STREET,
NKIL 6005, 6035 R.P., 6036 R.P.,
6037 R.P. & 6038 R.P.

TITLE :
DETAIL FOR
ALUM. WINDOW

DATE : 05-Dec-19 SCALE : 1:2

DRAWN BY : MN CHECKED BY : DW

美特經貿有限公司
MIDI (HONGKONG) CORPORATION LTD.
Units 6-8, Sunny Industrial Centre, 1/F
610 Che Kwo Ling Road, Kowloon
Tel: 2348211-4 Fax: (852) 27272666

DWG NO. : J852-SD-PW-6004 REV. : B

OUTSIDE

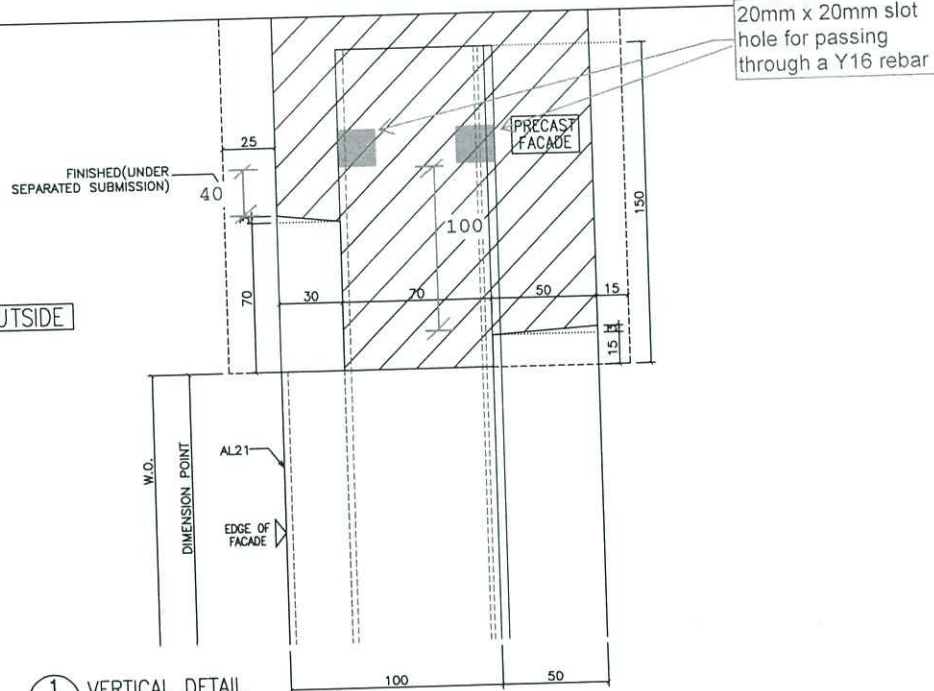

1 VERTICAL DETAIL SCALE 1:2

OUTSIDE

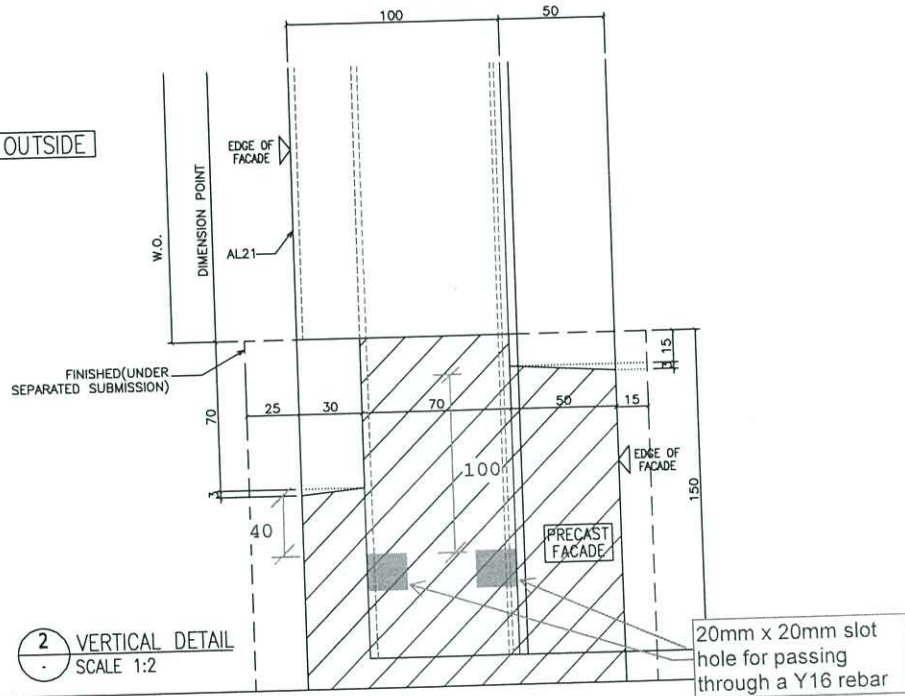

2 VERTICAL DETAIL SCALE 1:2

B.D. REF :
.....

CLIENT :

ARCHITECT :
AGC
DESIGN LTD

MAIN CONTRACTOR :
Gammon

STRUCTURAL ENGINEER :
ARUP

FACADE CONSULTANT:
MEINHARDT

NOTE:
1. ALL DIMENSIONS ARE IN mm.
2. ALL ELEVATIONS ARE VIEWED FROM OUTSIDE.
3. ALL DIMENSIONS TO BE VERIFIED ON SITE BEFORE FABRICATION.

LEGEND:
X1 --- DETAIL MARK NO.
XXXXX --- REFER SHEET NO.

1. F.F.L --- FINISHED FLOOR LEVEL
2. S.F.L --- STRUCTURAL FLOOR LEVEL
3. (⊙) --- REVERSED DETAIL
4. ▲ --- FIXING LOCATION
5. △ --- FIXING LUG LOCATION
6. GLASS LEGEND
GLD1 --- 8mm+12mm AIR GAP+10mm THK. L.G.U.
GLD1a --- 8mm+9mm AIR GAP+12mm THK. L.G.U.
GLD2 --- 10mm THK. TEMPERED GLASS (SPANDREL GLASS)
GLD3 --- 6mm+12mm AIR GAP+6mm THK. L.G.U.
GLD4 --- 10mm THK. TEMPERED GLASS (PROTECTIVE BARRIER)
GLD5 --- 6mm+12mm AIR GAP+8mm THK. L.G.U.

NO.	DATE	REVISED	BY

JOB NO. : J-852
PROJECT : PROPOSED RESIDENTIAL DEVELOPMENT AT 139 - 147 ARGYLE STREET, NKIL 8005, 6035 R.P., 6036 R.P., 6037 R.P. & 6038 R.P.

TITLE : DETAIL FOR ALUM. WINDOW

DATE : 05-Dec-19 SCALE : 1:2

DRAWN BY : MN CHECKED BY : DW

美特铝质有限公司
MIDI ALUMINIUM FABRICATOR LTD.
Units 6-8, Sunny Industrial Centre, 1/F
810 Cha Kwo Ling Road, Kowloon
Tel: 2348211-4 Fax: (852) 2727666

DWG NO. : JB52-SD-PW-6008 REV. : -

midi@midiltd.com.hk

From: Calvin Lee <calvinlee@whse.com.hk>
Date sent: Tue, 28 Jul 2020 15:38:35 +0800
Subject: Argyle Street 139-147 - Slot Hole for Aluminum Mullion with
Additional 80mm Intrusion
To: midi@midiltd.com.hk
Copies to: Yuen <mandick.yuen@gammonconstruction.com>,
Jackson Chor Chiu Mok <Jackson.Mok@gammonconstruction.com>,
Penny Pui Ying Chau <Penny.Chau@gammonconstruction.com>

Dear Bessie,

As discussed, we are queried by the MFT's RE that whether the additional 80mm intrusion of aluminum mullion will structurally affect the precast facade. After checking with our facade consultant, a 20mmx20mm slot hole would be required as per the attached markup in order to fulfill the structural calculation. Would you please check and advise whether it is feasible to form the slot holes before delivering the window to precast factory.

Thanks and regards,

Calvin Lee

Wing Hong Shun Enterprises Limited
Tel: 3101 1312 / 6233 7904
Fax: 3101 9196
E-mail: calvinlee.whse@gmail.com