



工程指示 / 要求簡箋(E.I.)

工程指示編號：EI / 1872 / 20

修改版次：A

工程編號：J - 852

工程名稱：亞皆老街中電

工程項目：幕牆 - 繪畫模圖 12 個

收件人：Maggie Lor / 生統 / 王良

發件人：Bessie Lau

日期：04/06/2020

要求提供 / 確認 事項：

- | | | |
|------------------------------------|-------------------------------------|-------------------------------|
| <input type="checkbox"/> 初步鋁料 B.M. | <input type="checkbox"/> 加工拆圖，然後生產 | <input type="checkbox"/> 尺寸表 |
| <input type="checkbox"/> 正式鋁料 B.M. | <input type="checkbox"/> 技術上資料 / 指示 | <input type="checkbox"/> 報價 |
| <input type="checkbox"/> 配件 B.M. | <input type="checkbox"/> 樣辦或貨品說明書 | <input type="checkbox"/> 分判合約 |

現確認不重開跟幕牆配套的佛沙窗鋁模，煩請繪畫加工模圖共 12 個。

謝謝

CAD 檔已放在 MAGGIE 姐名下，文件夾名稱: EI1872A CAD

請在 2020.06.10 前完成上列要求。

附：1 張模圖總結表 + 12 張模圖 + CAD

以上項目為：

- | | | |
|---------------------------------|--------------------------------------|--------------------------------|
| <input type="checkbox"/> 原合約工程包 | <input type="checkbox"/> 原合約工程加 / 減賬 | <input type="checkbox"/> 新工程報價 |
|---------------------------------|--------------------------------------|--------------------------------|

原因：-

分發東莞各部門：

- | | | | |
|--|---|---|--|
| <input type="checkbox"/> 生產技術總監 <input type="checkbox"/> 連附件 | <input type="checkbox"/> 技術部 <input type="checkbox"/> 連附件 | <input type="checkbox"/> 生產部 <input type="checkbox"/> 連附件 | <input type="checkbox"/> 機械設計部 <input type="checkbox"/> 連附件 |
| <input type="checkbox"/> 採購部 <input type="checkbox"/> 連附件 | <input type="checkbox"/> 生產統籌部 <input type="checkbox"/> 連附件 | | |
| <input type="checkbox"/> 質檢部 <input type="checkbox"/> 連附件 | <input type="checkbox"/> 會計部 <input type="checkbox"/> 連附件 | <input type="checkbox"/> 報關組 <input type="checkbox"/> 連附件 | <input type="checkbox"/> 其他 _____ <input type="checkbox"/> 連附件 |
- 其他分判 (水洪) 連附件

分發香港各部門：

- | | | | |
|---|--|---|--|
| <input type="checkbox"/> 行政部 <input type="checkbox"/> 連附件 | <input type="checkbox"/> 會計部 <input type="checkbox"/> 連附件 | <input type="checkbox"/> 統籌部 <input type="checkbox"/> 連附件 | <input type="checkbox"/> 工程部地盤科文 <input type="checkbox"/> 連附件 |
| <input type="checkbox"/> 採購部 <input type="checkbox"/> 連附件 | <input type="checkbox"/> QS 部 <input type="checkbox"/> 連附件 | <input type="checkbox"/> 維修部 <input type="checkbox"/> 連附件 | <input type="checkbox"/> 其他 _____ <input type="checkbox"/> 連附件 |

傳遞編號：

HK 1034 / 20

發件人簽署：

項目經理簽署：

Handwritten initials 'BTL' at the bottom center.

21/5

CUSTOMER	CUSTOMER APPROVAL	CUST PART NO.	AL-01(0)
		SECTION NO.	X85825

- a=0.1r
- b=0.2r
- c=0.3r
- d=0.4r
- e=0.5r
- f=0.8r

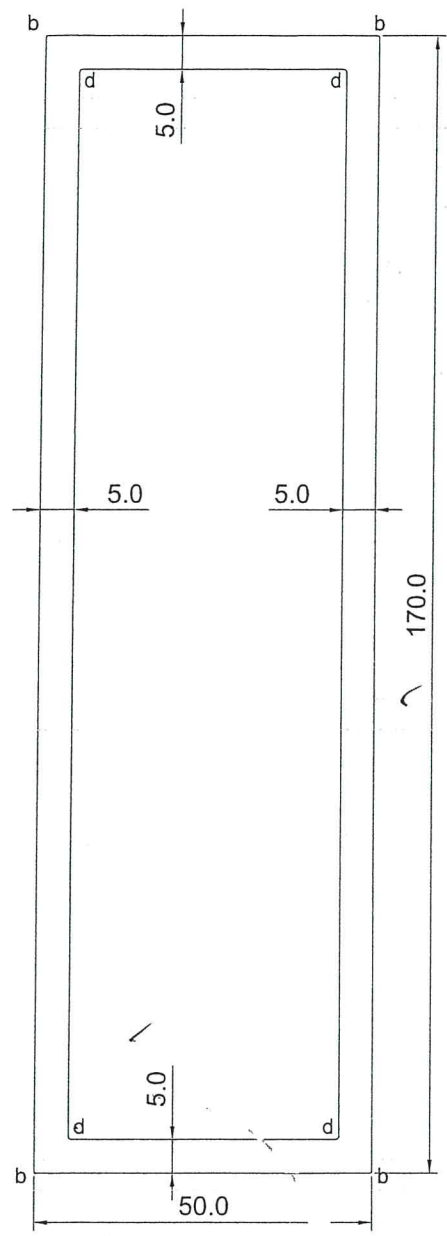

X85825

美特鋁質有限公司
承認圖面
日期 2-6-20

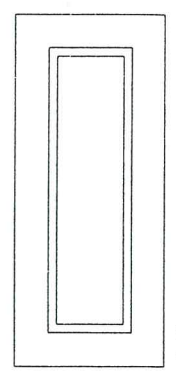

SCALE 1:4

SIGNATURE GRADEING	HIGH SIGNATURE GRADEING	C.C.DIA(MM)							
AREA (SQ MM)	2100.10	UNSPECIFIED THICKNESS	5.0	PERIMETER (MM)	838.97	STANDARD		SCALE	1:1
MASS (KG/M)	5.670	UNSPECIFIED CORNERS	-	SURFACE AREA	439.65	ALLOY	6063-T6	VERSION	
COMPANY ISSUE			DRAWN	CJM	DATE	2020-04-29	APELLATION	PAGE OF	
			STANDARDIZATION		DATE				
			TO SIGN		DATE				
			AUDITING		DATE				
MARKER	MODIFY	FILE NO	SIGNATURE	DATE	APPROV	DATE			

CUSTOMER	CUSTOMER APPROVAL	CUST PART NO.	AL-04(0)
		SECTION NO.	125827

$a=0.1r$
 $b=0.2r$
 $c=0.3r$
 $d=0.4r$
 $e=0.5r$
 $f=0.8r$

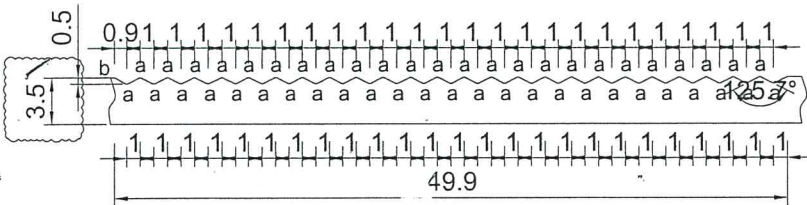
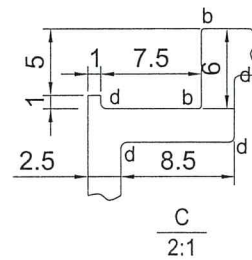
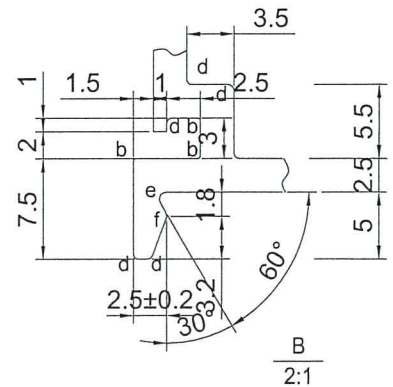
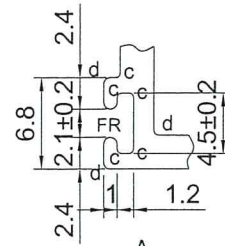
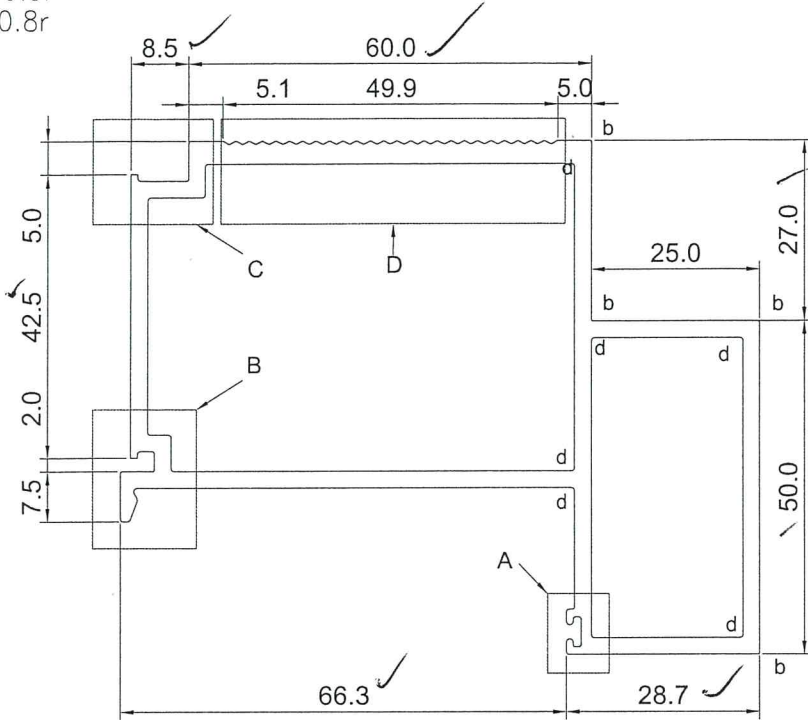

D
2:1

美特鋁質有限公司
 承認圖面
 日期 2-6-20

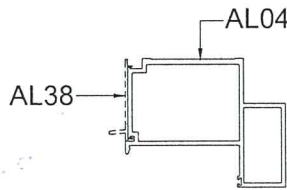

SCALE 1:4

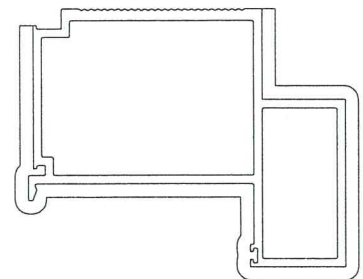

SCALE 1:2

SIGNATURE GRADEING	HIGH SIGNATURE GRADEING	C.C.DIA(MM)							
AREA (SQ MM)	945.7	UNSPECIFIED THICKNESS	2.5	PERIMETER (MM)	730.5	STANDARD		SCALE	1:1
MASS (KG/M)	2.562	UNSPECIFIED CORNERS	-	SURFACE AREA	297.78	ALLOY	6063-T6	VERSION	A
COMPANY ISSUE			DRAWA	CJM	DATE	2020-04-29	APELLATION	PAGE OF	
			STANDARDIZATION		DATE				
			TO SIGN		DATE				
			AUDITING		DATE				
MARKER	MODIFY	FILE NO	SIGNATURE	DATE	APPROV				

美特鋁質有限公司
 MIDI Aluminium Fabricator Ltd

CUSTOMER	CUSTOMER APPROVAL	CUST PART NO.	AL-FD04(0)
		SECTION NO.	x85828

$a=0.1r$
 $b=0.2r$
 $c=0.3r$
 $d=0.4r$
 $e=0.5r$
 $f=0.8r$

RD 09 x85828

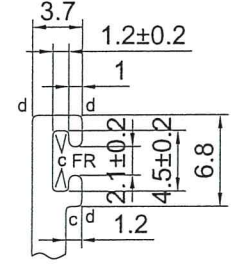
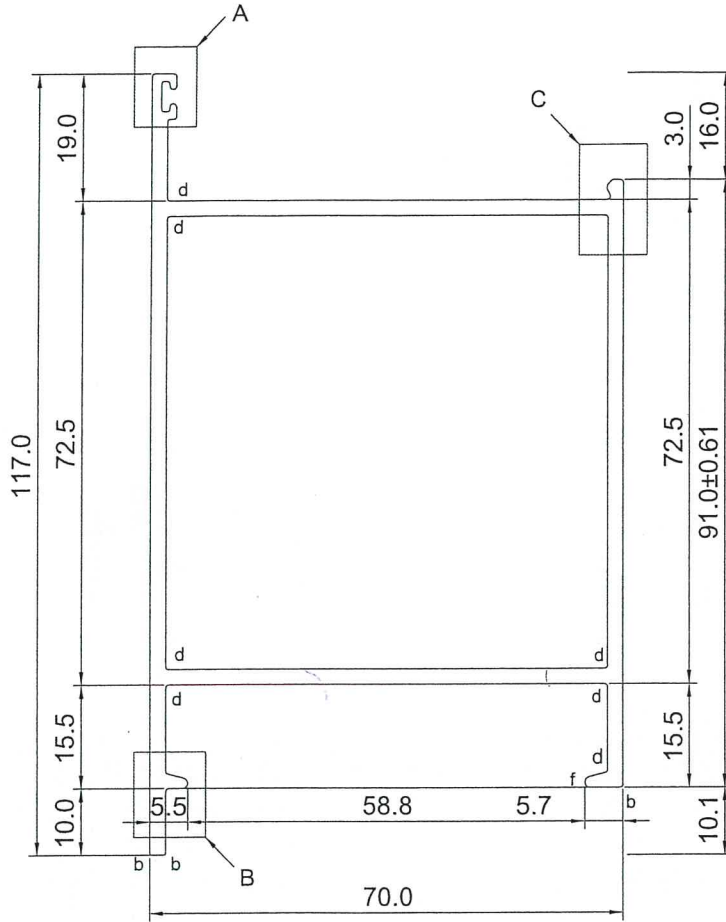

A
2:1

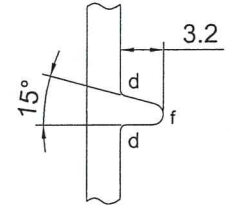

B
2:1

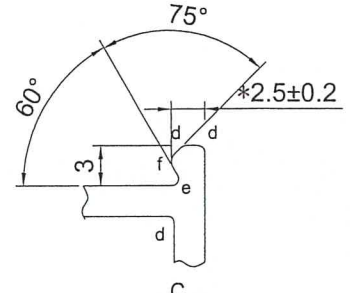

C
2:1

美特鋁質有限公司
 承認圖面
 日期 2-6-20

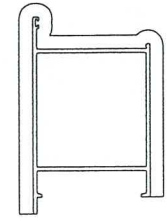

V.F

SCALE 1:4

SIGNATURE GRADEING	HIGH SIGNATURE GRADEING	C.C.DIA(MM)							
AREA (SQ MM)	792.04	UNSPECIFIED THICKNESS	2.3	PERIMETER (MM)	695.79	STANDARD		SCALE	1:1
MASS (KG/M)	2.138	UNSPECIFIED CORNERS	-	SURFACE AREA	309.42	ALLOY	6063-T6	VERSION	
COMPANY ISSUE			DRAWN	CJM	DATE	2020-04-29	APPELLATION	PAGE OF	
			STANDARDIZATION		DATE				
			TO SIGN		DATE				
			AUDITING		DATE				
MARKER	MODIFY	FILE NO	SIGNATURE	DATE	APPROV				

CUSTOMER	CUSTOMER APPROVAL	CUST PART NO.	AL-11(0)
		SECTION NO.	285829

$a=0.1r$
 $b=0.2r$
 $c=0.3r$
 $d=0.4r$
 $e=0.5r$
 $f=0.8r$
 $h=5r$

285829

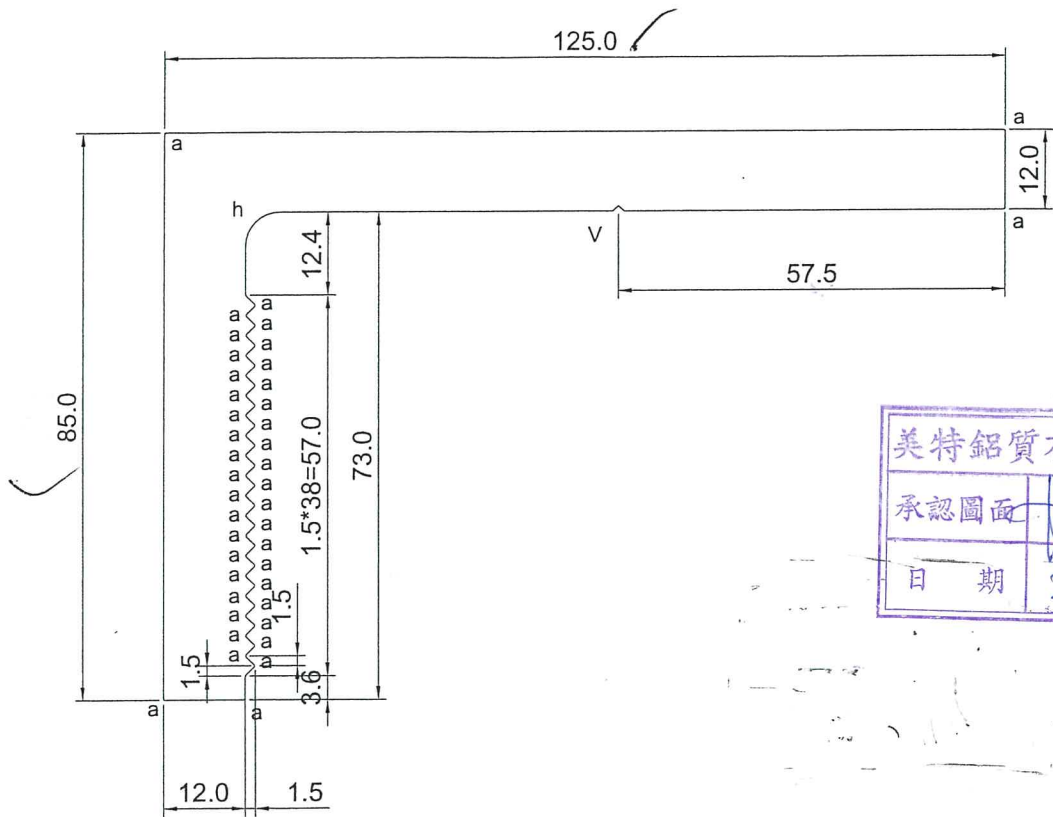

美特鋁質有限公司
 承認圖面
 日期 26-20

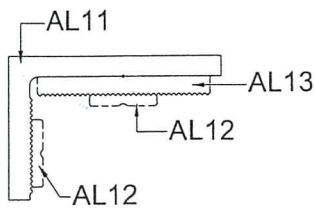

SCALE 1:4

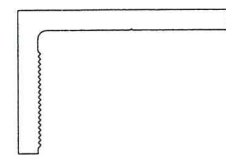

SCALE 1:4

6063-T6

SIGNATURE GRADEING	HIGH SIGNATURE GRADEING	C.C.DIA(MM)							
AREA (SQ MM)	2423.35	UNSPECIFIED THICKNESS	12.0	PERIMETER (MM)	438.54	STANDARD		SCALE	1:1
MASS (KG/M)	6.545	UNSPECIFIED CORNERS	-	SURFACE AREA	-	ALLOY	6063-T6	VERSION	
COMPANY ISSUE			DRAWN	CJM	DATE	2020-04-29	APELLATION	PAGE OF	
			STANDARDIZATION		DATE				
			TO SIGN		DATE				
			AUDITING		DATE				
MARKER	MODIFY	FILE NO	SIGNATURE	DATE	APPROV				

 美特鋁質有限公司
 MIDI Aluminium Fabricator Ltd.

CUSTOMER	CUSTOMER APPROVAL	CUST PART NO.	AL-12
		SECTION NO.	XJ5830

$a=0.1r$
 $b=0.2r$
 $c=0.3r$
 $d=0.4r$
 $e=0.5r$
 $f=0.8r$
 $g=1r$
 $h=5r$

XJ5830

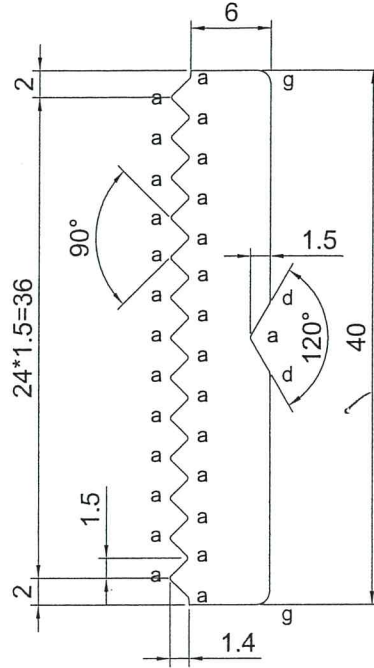

SCALE 2:1

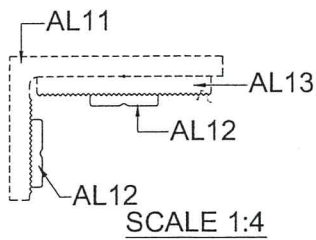

SCALE 1:1

6063-T6

SIGNATURE GRADEING	HIGH SIGNATURE GRADEING	C.C.DIA(MM)							
AREA (SQ MM)	264.92	UNSPECIFIED THICKNESS	6.0	PERIMETER (MM)	105.91	STANDARD		SCALE	1:1
MASS (KG/M)	0.715	UNSPECIFIED CORNERS	-	SURFACE AREA	-	ALLOY	6063-T6	VERSION	
COMPANY ISSUE			DRAWN	CJM	DATE	2020-04-29	APELLATION	PAGE OF	
			STANDARDIZATION		DATE				
			TO SIGN		DATE				
			AUDITING		DATE				
MARKER	MODIFY	FILE NO	SIGNATURE	DATE	APPROV	DATE			

CUSTOMER	CUSTOMER APPROVAL	CUST PART NO.	AL-13(0)
		SECTION NO.	X85831

$a=0.1r$
 $b=0.2r$
 $c=0.3r$
 $d=0.4r$
 $e=0.5r$
 $f=0.8r$
 $g=1r$
 $h=5r$

X85831

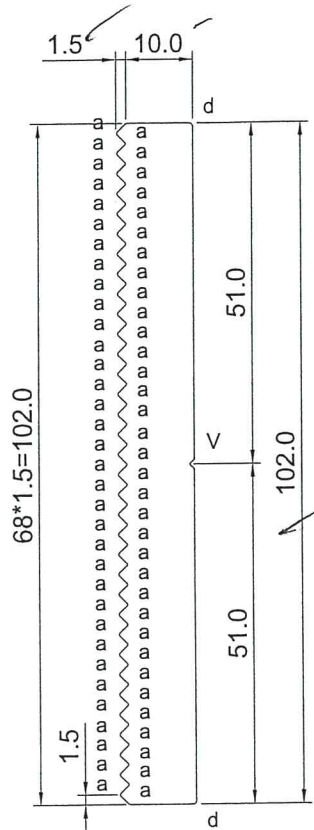

美特鋁質有限公司
 承認圖面
 日期 2-6-20

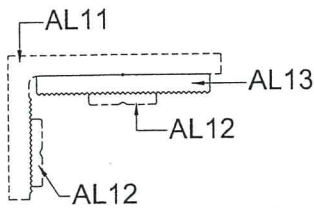

SCALE 1:4



SCALE 1:2

6063-T6

SIGNATURE GRADEING	HIGH SIGNATURE GRADEING	C.C.DIA(MM)							
AREA (SQ MM)	1095.93	UNSPECIFIED THICKNESS	10.0	PERIMETER (MM)	260.72	STANDARD		SCALE	1:1
MASS (KG/M)	2.959	UNSPECIFIED CORNERS	-	SURFACE AREA	-	ALLOY	6063-T6	VERSION	
COMPANY ISSUE			DRAWA	CJM	DATE	2020-04-29	APELLATION	PAGE OF	
			STANDA-RDIZATION		DATE				
			TO SIGN		DATE				
			AUDITING		DATE				
MARKER	MODIFY	FILE NO	SIGNATURE	DATE	APPROV				

美特鋁質有限公司
 MIDI Aluminium Fabricator Ltd

CUSTOMER	CUSTOMER APPROVAL	CUST PART NO. <u>AL-38(0)</u>
		SECTION NO. <u>X85832</u>

a=0.1r
b=0.2r
c=0.3r
d=0.4r
e=0.5r
f=0.8r
g=1r
h=5r

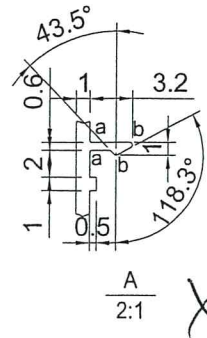

X 85832

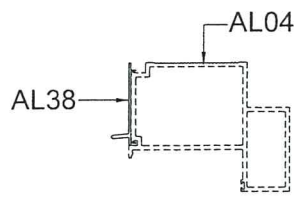
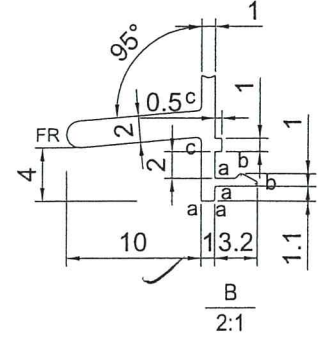
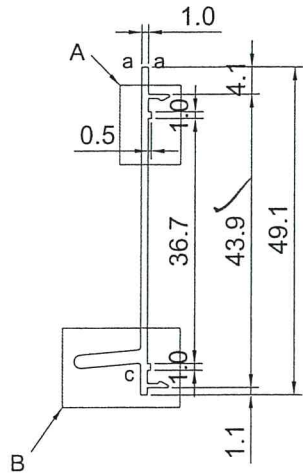

SCALE 1:4

美特鋁質有限公司
承認圖面
日期 2-6-20

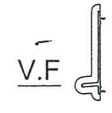

SCALE 1:4

SIGNATURE GRADEING	HIGH SIGNATURE GRADEING	C.C.DIA(MM)							
AREA (SQ MM)	73.93	UNSPECIFIED THICKNESS	1.0	PERIMETER (MM)	133.49	STANDARD		SCALE	1:1
MASS (KG/M)	0.199	UNSPECIFIED CORNERS	-	SURFACE AREA	69.76 ✓	ALLOY	6063-T6	VERSION	
COMPANY ISSUE			DRAWN	CJM	DATE	2020-04-29	APELLATION	PAGE OF	
			STANDARDIZATION		DATE		美特鋁質有限公司 MIDI Aluminium Fabricator Ltd.		
			TO SIGN		DATE				
			AUDITING		DATE				
MARKER	MODIFY	FILE NO	SIGNATURE	DATE	APPROV	DATE			

CUSTOMER	CUSTOMER APPROVAL	CUST PART NO.	AL-39(0)
		SECTION NO.	785833

$a=0.1r$
 $b=0.2r$
 $c=0.3r$
 $d=0.4r$
 $e=0.5r$
 $f=0.8r$
 $g=1r$
 $h=5r$

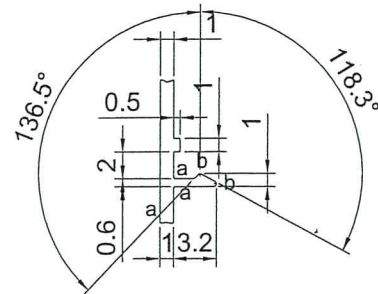

A
2:1

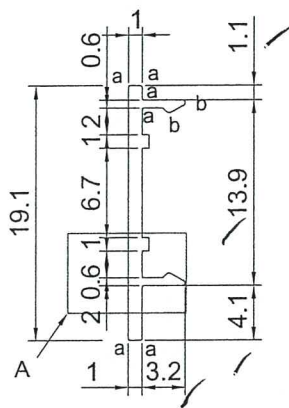

SCALE 2:1

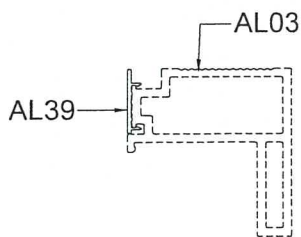

SCALE 1:2



SCALE 1:1

SIGNATURE GRADEING	HIGH SIGNATURE GRADEING	C.C.DIA(MM)						
AREA (SQ MM)	24.25	UNSPECIFIED THICKNESS	1.0	PERIMETER (MM)	54.54	STANDARD		SCALE 1:1
MASS (KG/M)	0.065	UNSPECIFIED CORNERS	-	SURFACE AREA	20.81	ALLOY	6063-T5	VERSION
COMPANY ISSUE			DRAWN	CJM	DATE	2020-04-29	APELLATION	PAGE OF
			STANDARDIZATION		DATE			
			TO SIGN		DATE			
			AUDITING		DATE			
MARKER	MODIFY	FILE NO	SIGNATURE	DATE	APPROV			

美特鋁質有限公司
 MIDI Aluminium Fabricator Ltd.

6063-T6

1509

CUSTOMER	CUSTOMER APPROVAL	CUST PART NO.	AL-14(0)
		SECTION NO.	X85835

$a=0.1r$
 $b=0.2r$
 $c=0.3r$
 $d=0.4r$
 $e=0.5r$
 $f=0.8r$
 $g=1r$
 $h=5r$

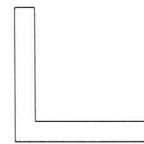
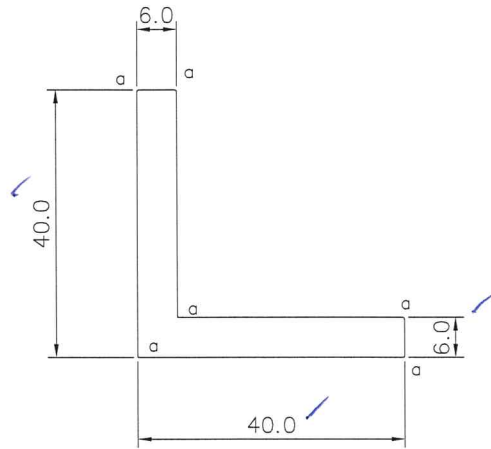

SCALE 1:2

SIGNATURE GRADEING	HIGH SIGNATURE GRADEING	C.C.DIA(MM)							
AREA (SQ MM)	443.97	UNSPECIFIED THICKNESS	6.0	PERIMETER (MM)	838.97	STANDARD		SCALE	1:1
MASS (KG/M)	1.198	UNSPECIFIED CORNERS	-	SURFACE AREA	-	ALLOY	6063-T6	VERSION	
COMPANY ISSUE			DRAWA	CJM	DATE	2020-04-29	APPELLATION		PAGE OF
			STANDA- RDIZATION		DATE				
			TO SIGN		DATE				
			AUDITING		DATE				
(-)	MODIFY	FILE NO	SIGNATURE	DATE	APPROV	DATE			

X85836
AL-41(0)

CUSTOMER	CUSTOMER APPROVAL	CUST PART NO.	AL-41(0)
		SECTION NO.	-

a=0.1r
b=0.2r
c=0.3r
d=0.4r
e=0.5r
f=0.8r

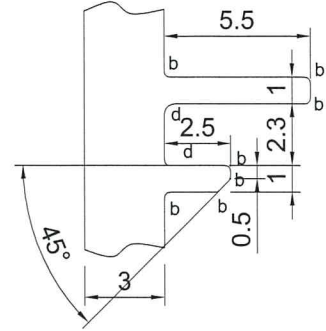

A
4:1

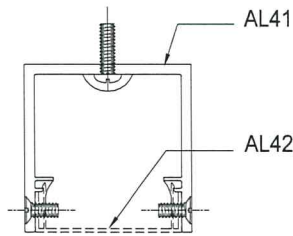
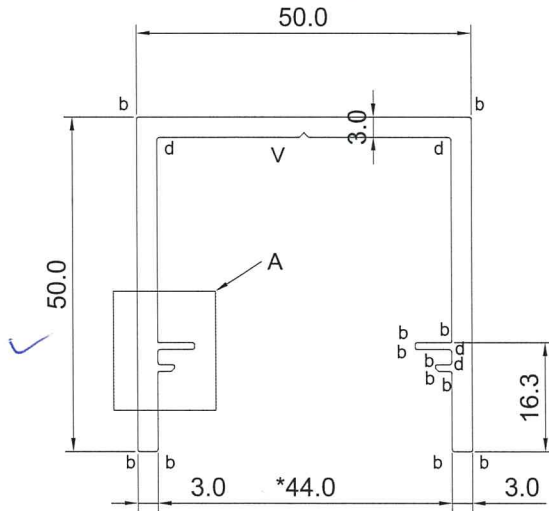

SCALE
1:2

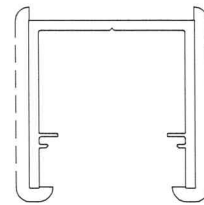

SCALE
1:2

V.F

SIGNATURE GRADEING	HIGH SIGNATURE GRADEING	C.C.DIA(MM)							
AREA (SQ MM)	447.34	UNSPECIFIED THICKNESS	3	PERIMETER (MM)	323.38	STANDARD		SCALE	1:1
MASS (KG/M)	1.208	UNSPECIFIED CORNERS	-	SURFACE AREA	106.51	ALLOY	6063-T6	VERSION	
COMPANY ISSUE			DRAWA	CJM	DATE	2020-06-02	APELLATION	PAGE OF	
			STANDA-RDIZATION		DATE				
			TO SIGN		DATE				
			AUDITING		DATE				
MARKER	MODIFY	FILE NO	SIGNATURE	DATE	APPROV				

X85837
AL-42(0)

CUSTOMER	CUSTOMER APPROVAL	CUST PART NO.	AL-42(0)
		SECTION NO.	-

a=0.1r
b=0.2r
c=0.3r
d=0.4r
e=0.5r
f=0.8r

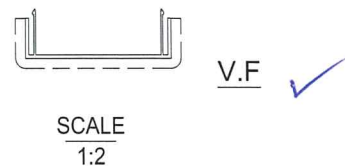
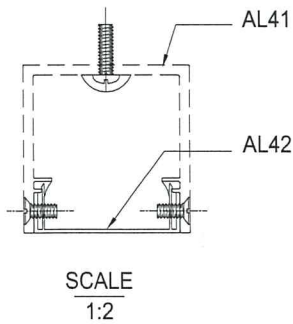
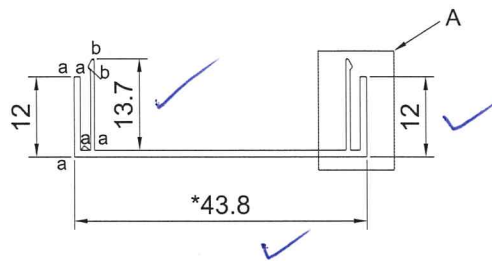
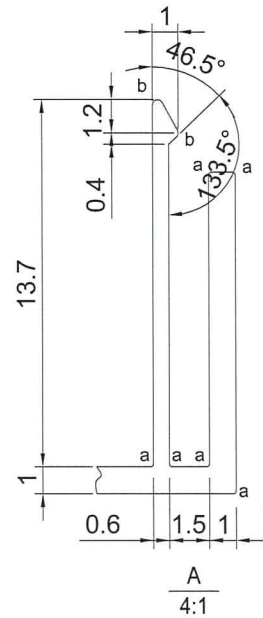
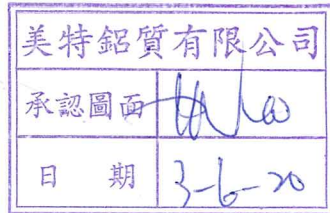

SIGNATURE GRADEING	HIGH SIGNATURE GRADEING	C.C.DIA(MM)							
AREA (SQ MM)	82.54	UNSPECIFIED THICKNESS	1	PERIMETER (MM)	187.81	STANDARD		SCALE	1:1
MASS (KG/M)	0.223	UNSPECIFIED CORNERS	-	SURFACE AREA	67.83	ALLOY	6063-T6	VERSION	
COMPANY ISSUE			DRAWA	CJM	DATE	2020-06-02	APELLATION	PAGE OF	
			STANDA-RDIZATION		DATE				
			TO SIGN		DATE				
			AUDITING		DATE				
MARKER	MODIFY	FILE NO	SIGNATURE	DATE	APPROV	DATE			