



工程指示 / 要求簡箋(E.I.)

工程指示編號：EI / 18071:20 修改版次：
 工程編號：J - 852 工程名稱：亞皆老街中電
 工程項目：SHOW FLAT 幕牆用鋁飾線
 收件人：生統 發件人：Bessie Lau 日期：15/05/2020

要求提供 / 確認 事項：

- | | | |
|------------------------------------|-------------------------------------|-------------------------------|
| <input type="checkbox"/> 初步鋁料 B.M. | <input type="checkbox"/> 加工拆圖，然後生產 | <input type="checkbox"/> 尺寸表 |
| <input type="checkbox"/> 正式鋁料 B.M. | <input type="checkbox"/> 技術上資料 / 指示 | <input type="checkbox"/> 報價 |
| <input type="checkbox"/> 配件 B.M. | <input type="checkbox"/> 樣辦或貨品說明書 | <input type="checkbox"/> 分判合約 |
| <input type="checkbox"/> 其他：_____ | | |

內容：

煩請按此加工幕牆用鋁飾線

(辦用)

附 SI

急!

(SI)

請在 21/5/2020 前完成上列要求。

附有關圖紙 / 文件：

以上項目為：

- 原合約工程包 原合約工程加 / 減賬 新工程報價

原因：-

分發東莞各部門：

- 生產技術總監 連附件 技術部 連附件 生產部 連附件 機械設計部 連附件
 採購部 連附件 生產統籌部 連附件
 質檢部 連附件 會計部 連附件 報關組 連附件 其他 _____ 連附件

分發香港各部門：

- 行政部 連附件 會計部 連附件 統籌部 連附件 工程部地盤科文 連附件
 採購部 連附件 QS 部 連附件 維修部 連附件 其他 _____ 連附件

傳遞編號：

HK0839/20

發件人簽署：

項目經理簽署：

(Handwritten signatures)

PCW

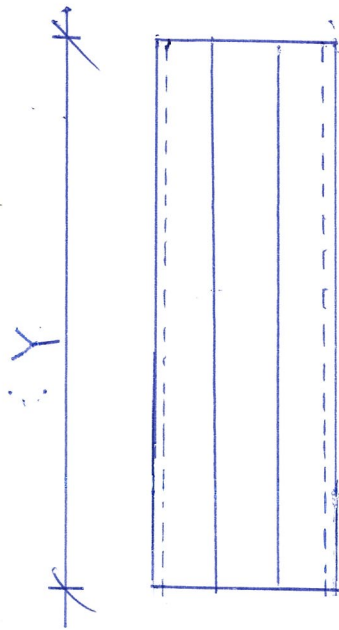
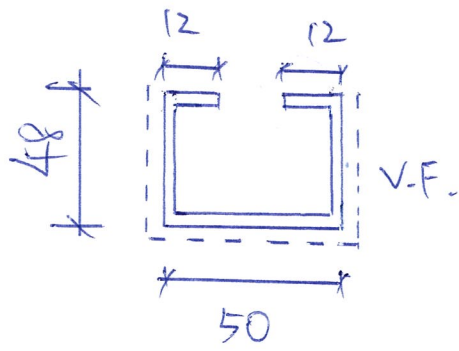

材料: 1.5mm 鋁板

圖號: CW-01 及 CW-02

顏色: UCT201498xL(A)-3

圖號	Y	數量
CW-01	2180	3
CW-02	1020	3

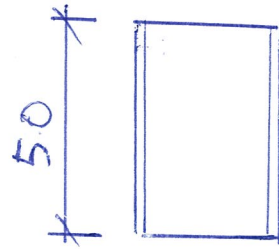
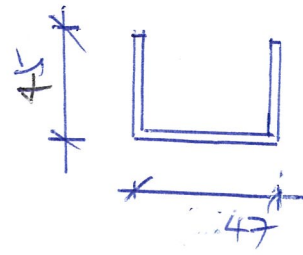

托片

材料: 1mm 鋁板

圖號: CW-03

顏色: Mill 料

數量: 6 件

see Part

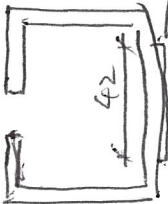

1mm β_2
3
3

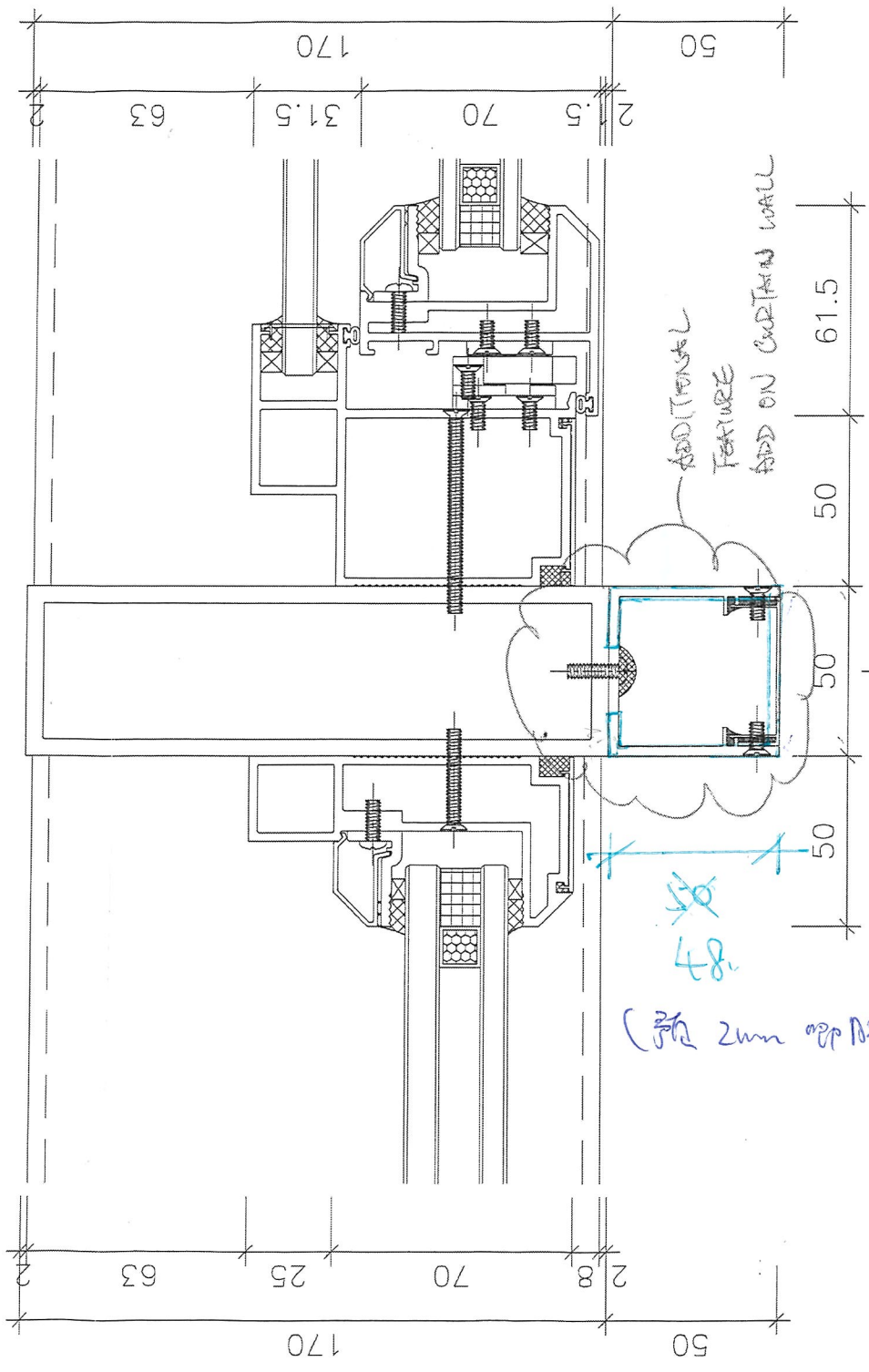

50
170
2.5
63
31.5
70

50
170
2.8
63
25
70

ADD TENSILE FEATURE
ADD ON CURTAIN WALL

48
(for 2mm β_2)

50
50
50
61.5

DIM. MODULE

DIM. MODULE



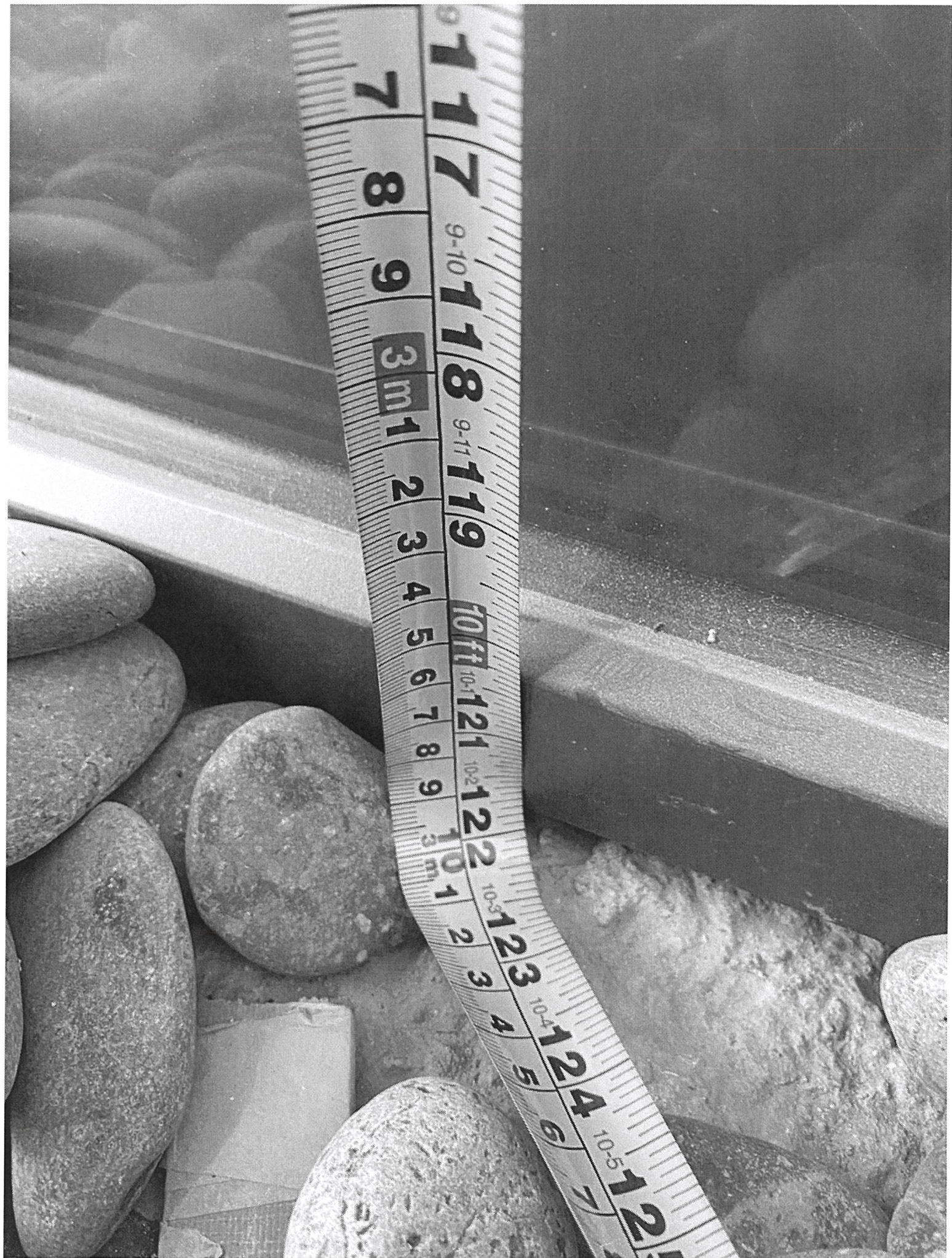



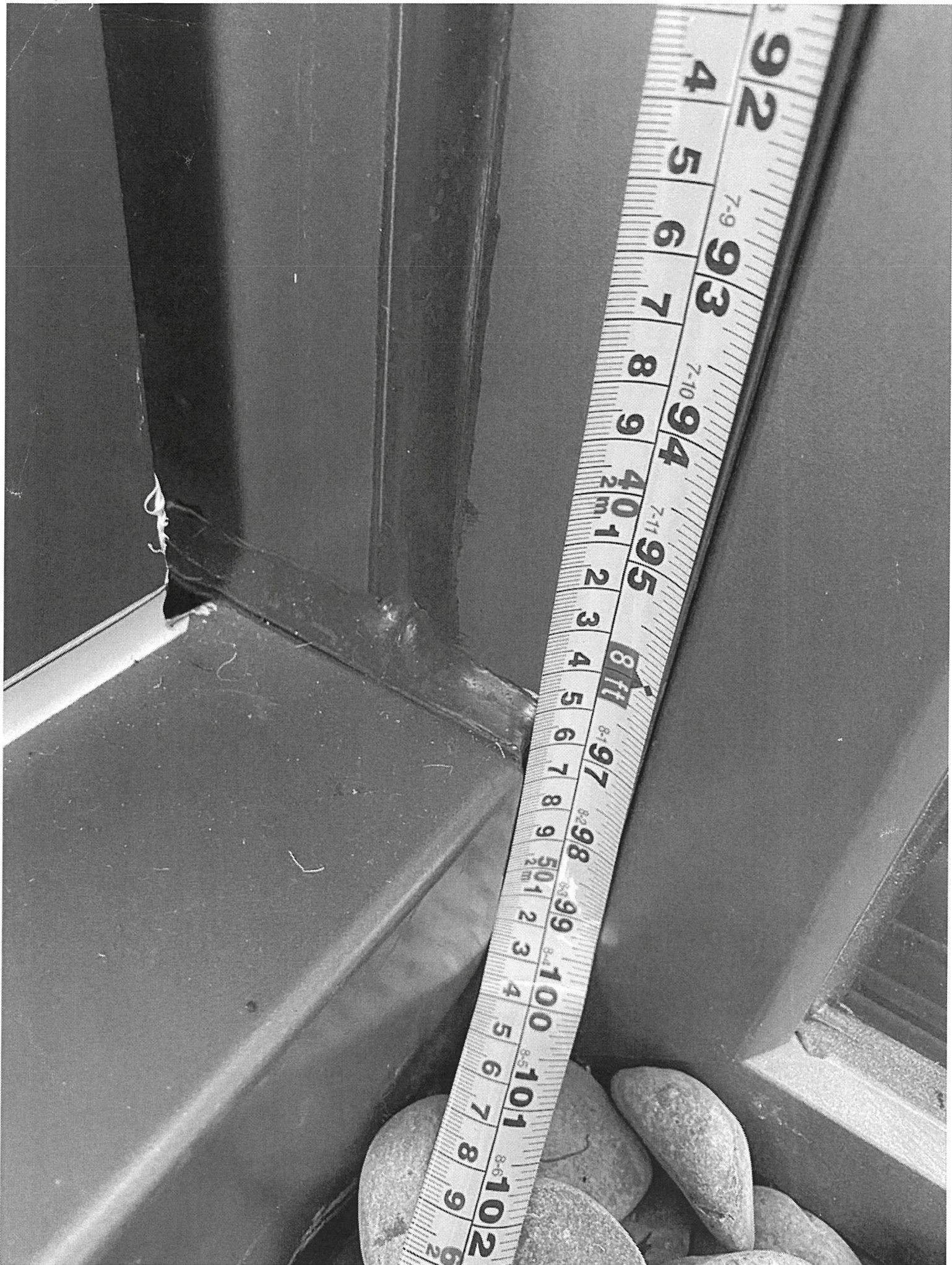

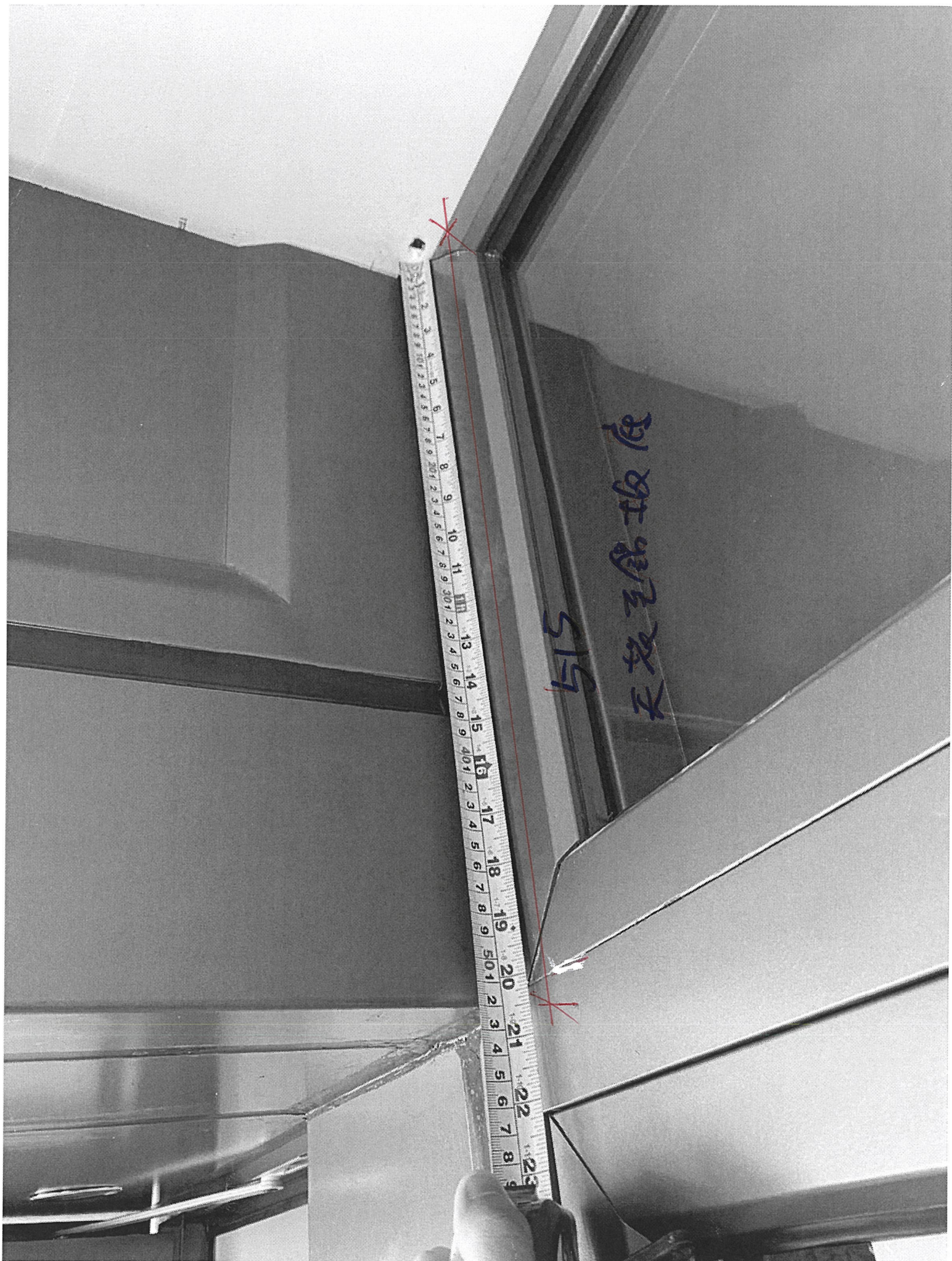

515

天板玻璃板底

(底)



130

JD

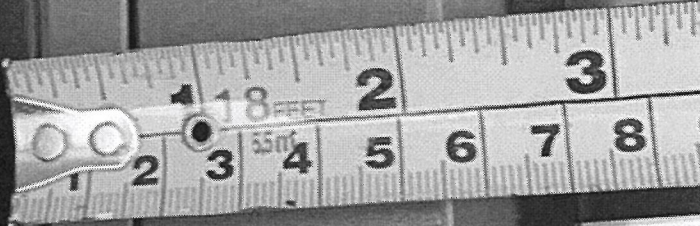

15

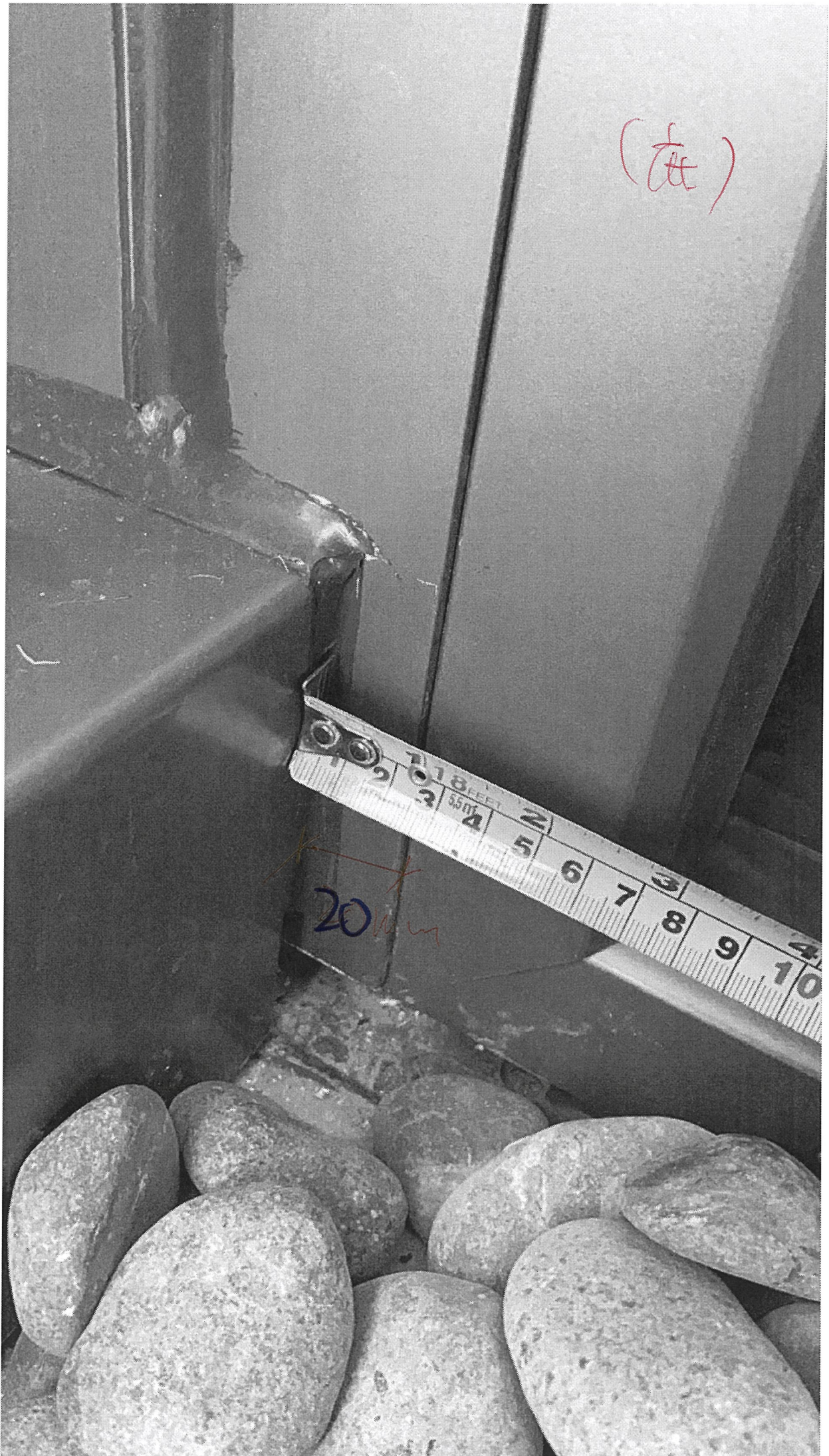

金料

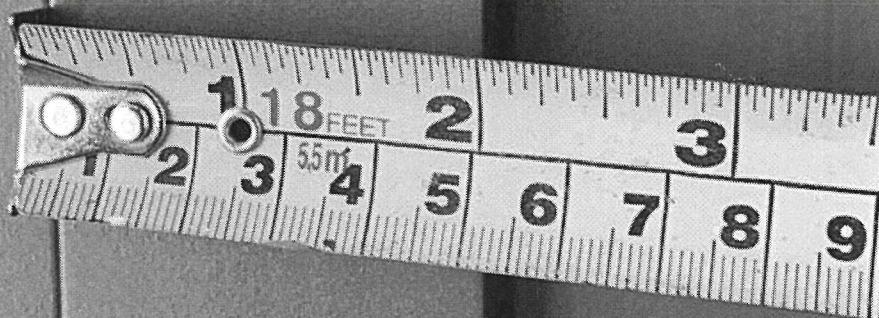

50

Project: CLP Re-development Project

Site Instructions

S.I. No.: A.C.H. P.S. / J.C. 2020 / 4 / 15 / 17:00
(Parties / Company / Issued Person / Year / Month / Date / Time)

To (Contractor): Hidi Aluminium Fabricator Limited

Location : Exchange Tower Showflat Unit C

Instructions:

Supply and install curtain wall
feature outside Unit C MBR1

For your immediate action on site

Drawing No. / Sketches No. 20200415-SI-Hidi-SK01

(4 pages)

Reasons for this Instruction:

Design develop of curtain wall

Issued By:

Jimmy Cheung
A.C.H.

Name, Title & Signature

Acknowledge Receipt:

Benie On

Name, Title & Signature

Project coordinator

Total Pages:

Employer's Copy

From: [Yoanna Chan](#)
Sent: Tuesday, April 14, 2020 6:02 PM
To: [Jackson Chor Chiu Mok](#)
Cc: [Jimmy Cheung Ngai Hang](#); raymondho@agcdesign.com.hk; eliotchan@agcdesign.com.hk; [Penny Pui Ying Chau](#); [Man Dick Yuen](#); [Brian Leung](#); [Chris Ching Wa Kwok](#); [Esther Chui Ling Chung](#); [YY Yau Yan Fong](#); [Angel Nga Chi Man](#); [Nigel Lo](#); [Billy Tang \(Development\)](#); midi@midiltd.com.hk
Subject: RE: CLP - J3860 139 -147 Argyle Street - Additional feature for curtain wall

Dear all,

We have no adverse comment on the extrusion profile. And the interface shall be further coordinated.

Thanks & regards,
Yoanna

From: Jackson Chor Chiu Mok <Jackson.Mok@gammonconstruction.com>
Sent: Thursday, April 2, 2020 6:46 PM
To: Brian Leung <brian.leung@mfacade.com>
Cc: [Jimmy Cheung Ngai Hang](#) <jimmynhcheung@sino.com>; raymondho@agcdesign.com.hk; eliotchan@agcdesign.com.hk; [Penny Pui Ying Chau](mailto:Penny.Chau@gammonconstruction.com) <Penny.Chau@gammonconstruction.com>; [Man Dick Yuen](mailto:ManDick.Yuen@gammonconstruction.com) <ManDick.Yuen@gammonconstruction.com>; [Chris Ching Wa Kwok](mailto:Chris.Kwok@gammonconstruction.com) <Chris.Kwok@gammonconstruction.com>; [Esther Chui Ling Chung](mailto:Esther.Chung@gammonconstruction.com) <Esther.Chung@gammonconstruction.com>; [YY Yau Yan Fong](mailto:YY.Fong@gammonconstruction.com) <YY.Fong@gammonconstruction.com>; [Angel Nga Chi Man](mailto:Angel.Man@gammonconstruction.com) <Angel.Man@gammonconstruction.com>; [Yoanna Chan](mailto:yoanna.chan@mfacade.com) <yoanna.chan@mfacade.com>; [Nigel Lo](mailto:nigel.lo@mfacade.com) <nigel.lo@mfacade.com>; [Billy Tang \(Development\)](#) <billytang@sino.com>; midi@midiltd.com.hk
Subject: RE: CLP - J3860 139 -147 Argyle Street - Additional feature for curtain wall

Dear Brian,

Further to our discussion in TQ meeting yesterday, please kindly be reminded to review and comment the additional feature submitted by Midi on 26 Mar 2020.

Thanks.

Best Regards,
Jackson

From: [Jimmy Cheung Ngai Hang](mailto:jimmynhcheung@sino.com) [<mailto:jimmynhcheung@sino.com>]
Sent: 30 March, 2020 2:16 PM
To: midi@midiltd.com.hk; brian.leung@mfacade.com; raymondho@agcdesign.com.hk
Cc: eliotchan@agcdesign.com.hk; [Penny Pui Ying Chau](mailto:Penny.Chau@gammonconstruction.com) <Penny.Chau@gammonconstruction.com>; [Man Dick Yuen](mailto:ManDick.Yuen@gammonconstruction.com) <ManDick.Yuen@gammonconstruction.com>; [Chris Ching Wa Kwok](mailto:Chris.Kwok@gammonconstruction.com) <Chris.Kwok@gammonconstruction.com>; [Esther Chui Ling Chung](mailto:Esther.Chung@gammonconstruction.com) <Esther.Chung@gammonconstruction.com>; [YY Yau Yan Fong](mailto:YY.Fong@gammonconstruction.com) <YY.Fong@gammonconstruction.com>; [Jackson Chor Chiu Mok](mailto:Jackson.Mok@gammonconstruction.com) <Jackson.Mok@gammonconstruction.com>; [Angel Nga Chi Man](mailto:Angel.Man@gammonconstruction.com) <Angel.Man@gammonconstruction.com>; [Yoanna Chan](mailto:yoanna.chan@mfacade.com) <yoanna.chan@mfacade.com>; Nigel Lo

<nigel.lo@mfacade.com>; Billy Tang (Development) <billytang@sino.com>
Subject: [E] RE: CLP - J3860 139 -147 Argyle Street - Additional feature for curtain wall

This email is sent from an External source

Dear Brian / Yoanna

Pls review and revert by tomorrow COB. Thanks.

Regards,

Jimmy Cheung
Assistant Manager (Construction)
Development Division
Sino Land Company Limited
DL (852) 2132 8758 M (852) 6032 9371

11-12/F, Tsim Sha Tsui Centre, Salisbury Road, Tsim Sha Tsui, Kowloon, Hong Kong
www.sino.com

From: midi@midiltd.com.hk
Sent: Thursday, March 26, 2020 6:18 PM
To: brian.leung@mfacade.com; raymondho@agcdesign.com.hk
Cc: eliotchan@agcdesign.com.hk; Penny Pui Ying Chau; Man Dick Yuen; Chris Ching Wa Kwok; Esther Chui Ling Chung; YY Yau Yan Fong; Jackson Chor Chiu Mok; Angel Nga Chi Man; Yoanna Chan; Nigel Lo; Jimmy Cheung Ngai Hang; Billy Tang (Development)
Subject: CLP - J3860 139 -147 Argyle Street - Additional feature for curtain wall

Dear Brian Gor / Raymond Gor,

Further to our site meeting yesterday, we would like to attach details of additional feature for curtain wall for your review and comment.

Regards,
Bessie

