

工程指示 / 要求簡箋(E.I.)

工程指示編號：EI / 1573 / 20 修改版次：

工程編號：J - 852 工程名稱：亞皆老街中電

工程項目：佛沙窗 - 鋁料模圖 (21個)

收件人：Maggie Lor 發件人：Bessie Lau 日期：06/03/2020

要求提供 / 確認 事項：

- () 初步鋁料 B.M. () 加工拆圖，然後生產 () 尺寸表
- () 正式鋁料 B.M. () 技術上資料 / 指示 () 報價
- () 配件 B.M. () 樣辦或貨品說明書 () 分判合約
- () 其他：_____

內容：

煩請開畫新模圖 (共 21 個)

1) 預計完成模圖日期為: 13 / 3 / 2020

2) 預計完成開模和試模日期為: 30 / 4 / 2020

3) 鋁料到貨期為: 20 / 5 / 2020

請在 _____ 前完成上列要求。

附有關圖紙 / 文件：1 張模圖總結表 + 21 張模圖

以上項目為：

- 原合約工程包 原合約工程加 / 減賬 新工程報價

原因：-

分發東莞各部門：

- () 生產技術總監 連附件 () 技術部 連附件 () 生產部 連附件 () 機械設計部 連附件
- () 採購部 連附件 () 生產統籌部 連附件
- () 質檢部 連附件 () 會計部 連附件 () 報關組 連附件 () 其他 _____ 連附件

分發香港各部門：

- () 行政部 連附件 () 會計部 連附件 () 統籌部 連附件 () 工程部地盤科文 連附件
- () 採購部 連附件 () QS 部 連附件 () 維修部 連附件 () 其他 _____ 連附件

傳遞編號：

發件人簽署：

項目經理簽署：

Aluminium Die for J852

Item	Die no.	Member no.	Grade	EI			Remark
				0	A	B	
1	X85759	AL-PW01(0)	6063 T6	v			
2	X85760	AL-PW01M(0)	6063 T6	v			
3	X85761	AL-PW02(0)	6063 T6	v			
4	X85762	AL-PW03(0)	6063 T6	v			
5	X85763	AL-PW04(0)	6063 T6	v			
6	X85764	AL-PW05(0)	6063 T6	v			
7	X85765	AL-PW11(0)	6063 T6	v			
8	X85766	AL-PW12(0)	6063 T6	v			
9	X85767	AL-PW21(0)	6063 T6	v			
10	X85768	AL-PW22(0)	6063 T6	v			
11	X85769	AL02(0)	6063 T6	v			
12	X85770	AL21(0)	6063 T6	v			
13	X85771	AL22(0)	6063 T6	v			
14	X85772	AL23(0)	6063 T6	v			
15	X85773	AL24(0)	6063 T6	暫停			待定 (待Gary Lam通知)
16	X85774	AL25(0)	6063 T6	v			
17	X85775	AL26(0)	6063 T6	v			
18	X85776	AL27(0)	6063 T6	v			
19	X85777	AL30(0)	6063 T6	v			
20	X85778	AL32(0)	6063 T6	v			
21	X85779	AL33(0)	6063 T6	v			

X85759

CUSTOMER	CUSTOMER APPROVAL	CUST PART NO.	AL-PW01(0) 70生窗邊框
		SECTION NO.	X85759

美特鋁質有限公司
承認圖面
日期 6-3-20

a=0.1r
b=0.2r
c=0.3r
d=0.4r
e=0.5r
f=0.8r

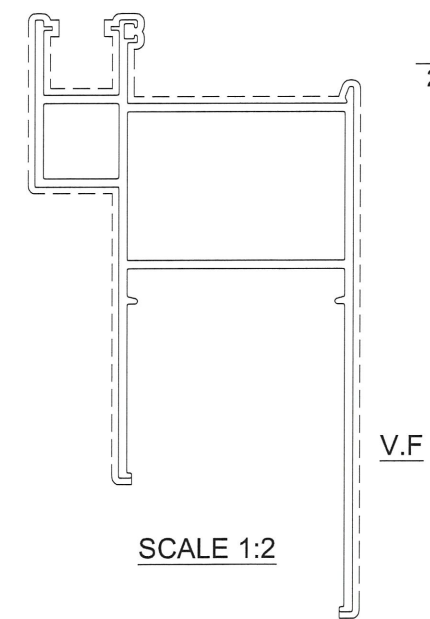
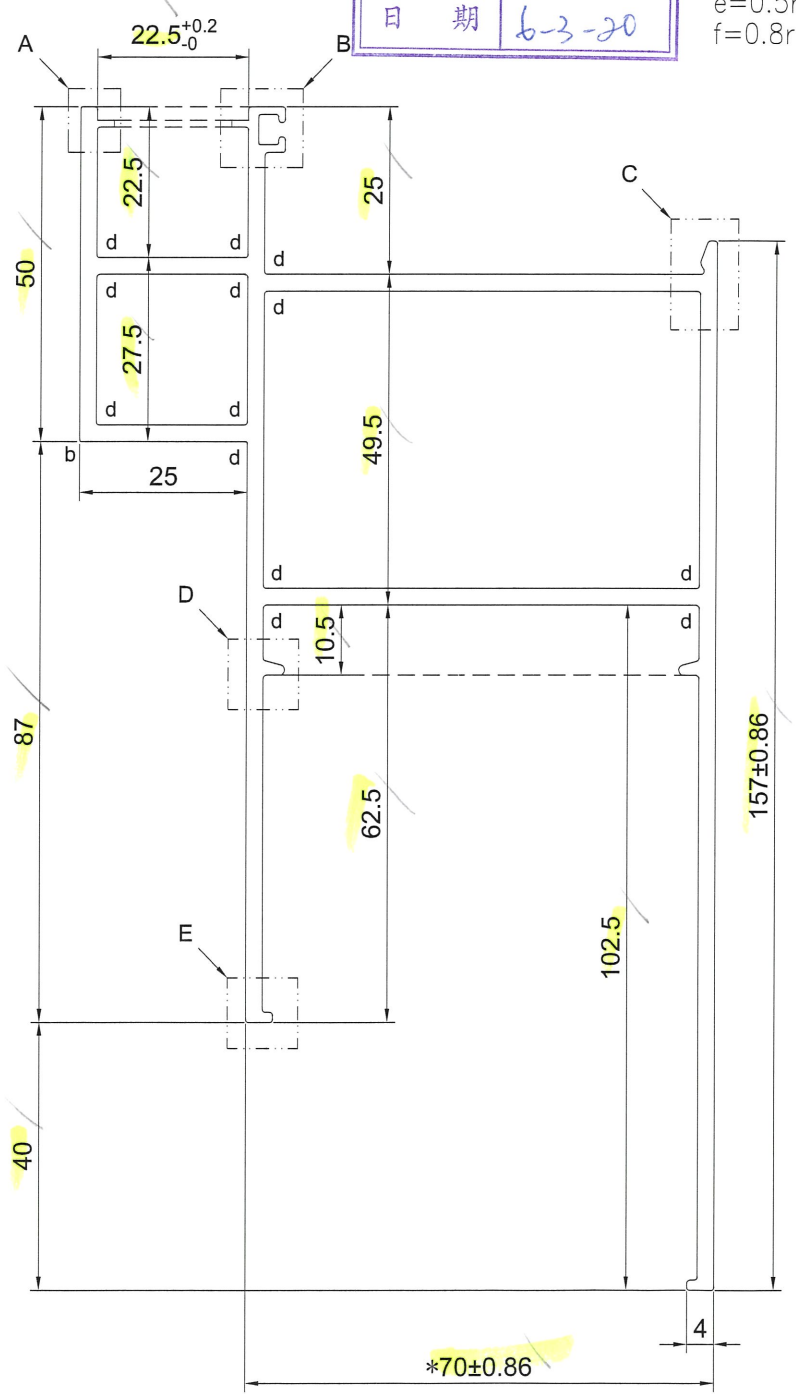
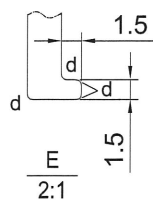
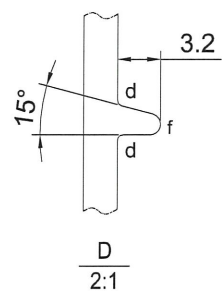
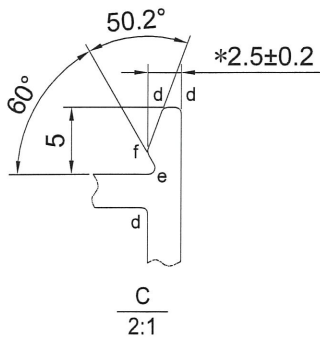
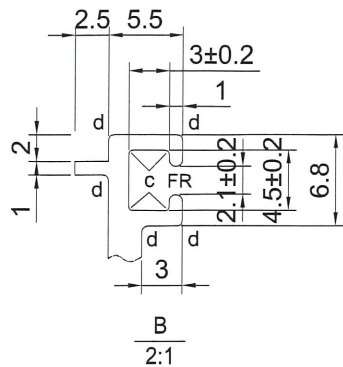
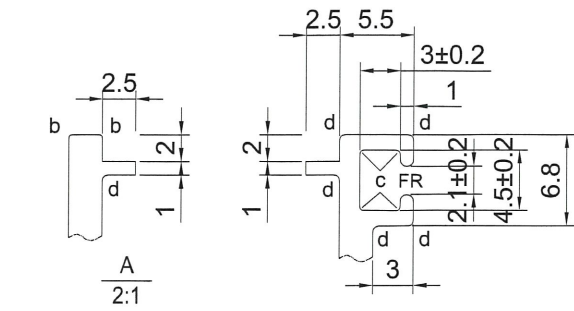

SIGNATURE GRADEING	HIGH SIGNATURE GRADEING	C.C.DIA(MM)							
AREA (SQ MM)	1320.54	UNSPECIFIED THICKNESS	2.5	PERIMETER (MM)	762.39	STANDARD		SCALE	1:1
MASS (KG/M)	3.579	UNSPECIFIED CORNERS	-	SURFACE AREA	521.84	ALLOY	6063-T6	VERSION	
COMPANY ISSUE			DRAWN	LHR	DATE	2020-02-26	APPELLATION	PAGE OF	
			STANDARDIZATION		DATE				
			TO SIGN		DATE				
			AUDITING		DATE				
MARKER	MODIFY	FILE NO	SIGNATURE	DATE	APPROV				

X85760

CUSTOMER	CUSTOMER APPROVAL	CUST PART NO.	AL-PW01M(0) 70生窗主企框
		SECTION NO.	X85760

a=0.1r
b=0.2r
c=0.3r
d=0.4r
e=0.5r
f=0.8r

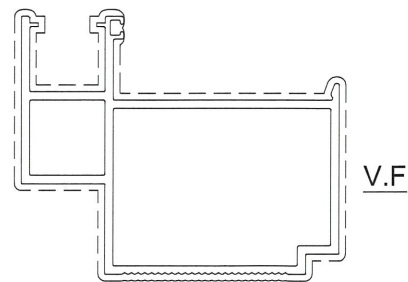
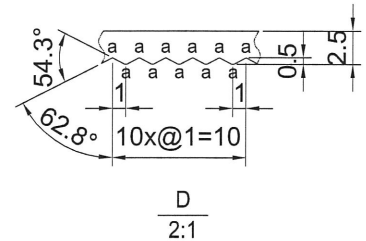
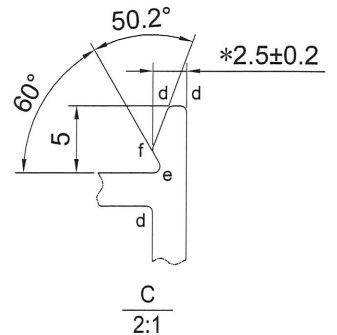
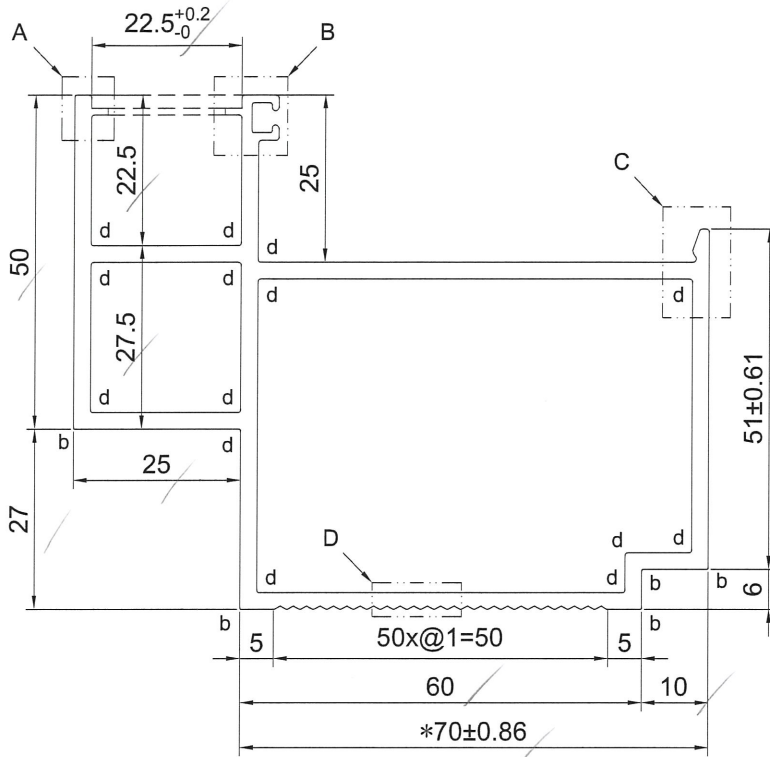
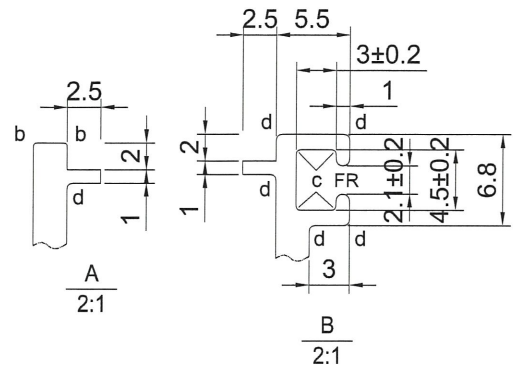
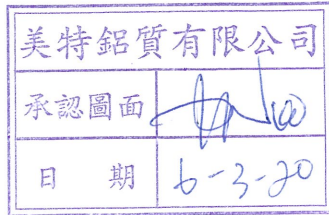

SCALE 1:2

SIGNATURE GRADEING	HIGH SIGNATURE GRADEING	C.C.DIA(MM)							
AREA (SQ MM)	888.73	UNSPECIFIED THICKNESS	2.5	PERIMETER (MM)	422.04	STANDARD		SCALE	1:1
MASS (KG/M)	2.408	UNSPECIFIED CORNERS	-	SURFACE AREA	340.80	ALLOY	6063-T6	VERSION	
COMPANY ISSUE			DRAWN	LHR	DATE	2020-02-26	APPELLATION	PAGE OF	
			STANDARDIZATION		DATE				
			TO SIGN		DATE				
			AUDITING		DATE				
MARKER	MODIFY	FILE NO	SIGNATURE	DATE	APPROV				

X85761

CUSTOMER	CUSTOMER APPROVAL	CUST PART NO.	AL-PW02(0) 70生窗頂框
		SECTION NO.	X85761

美特鋁質有限公司
承認圖面
日期 6-3-20

a=0.1r
b=0.2r
c=0.3r
d=0.4r
e=0.5r
f=0.8r

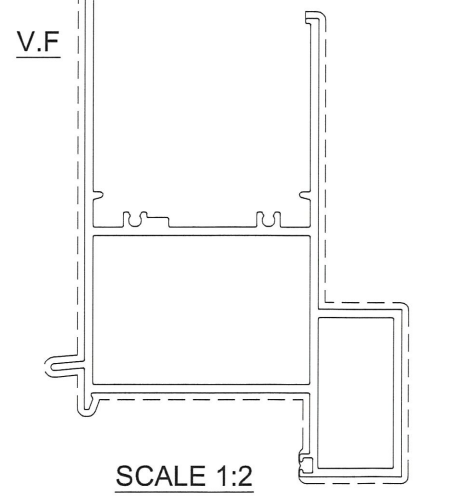
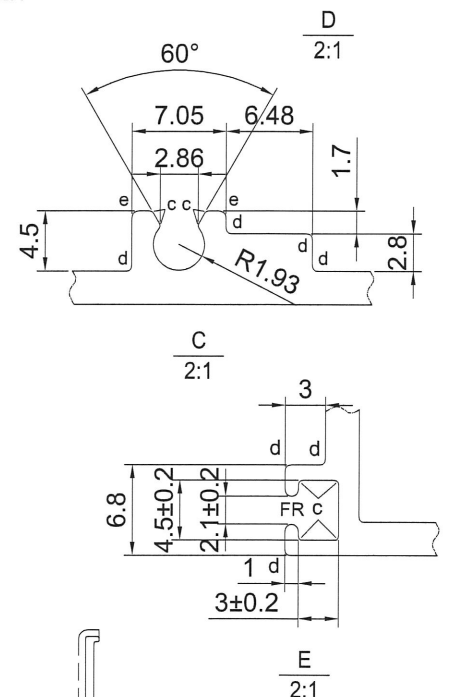
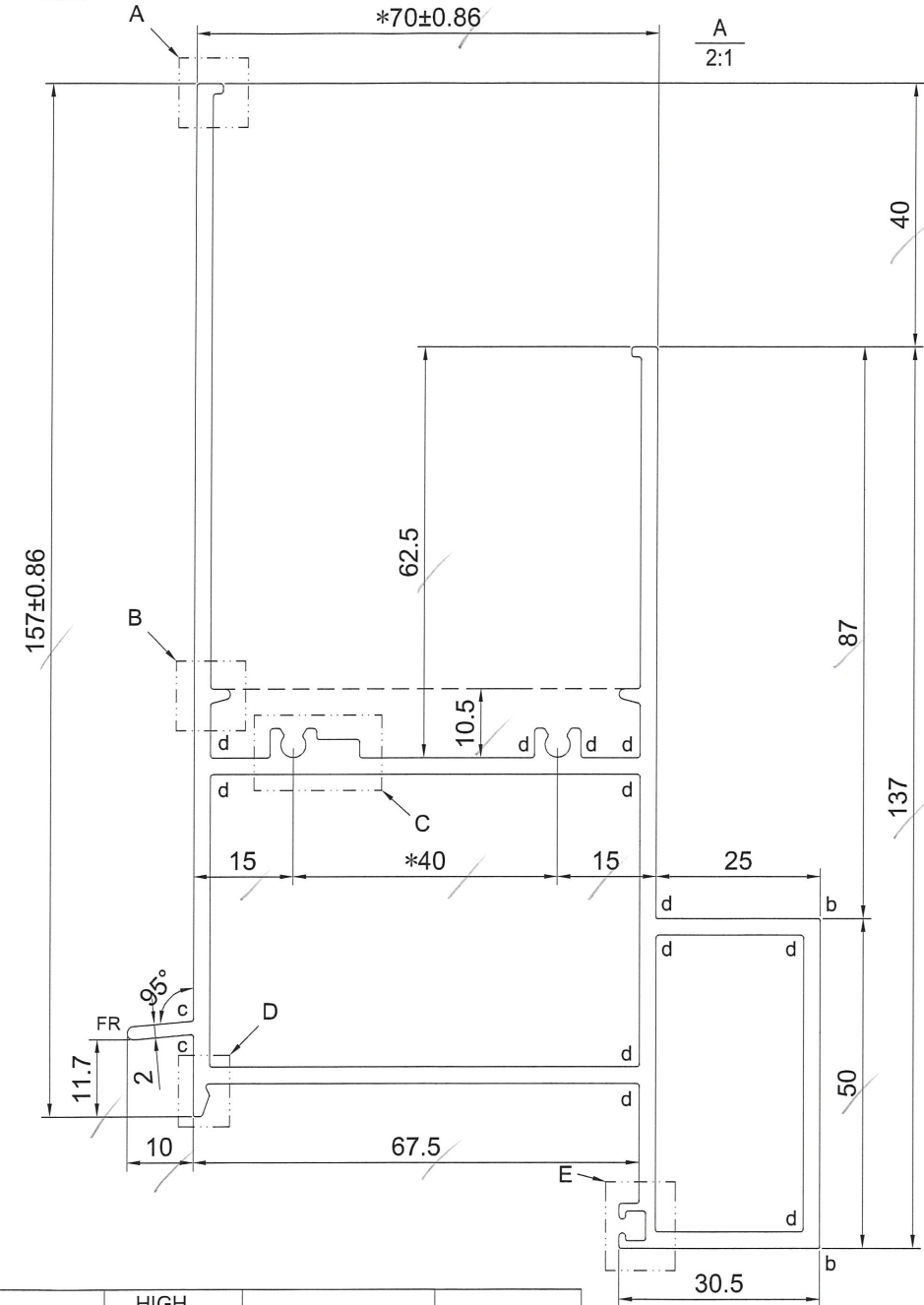
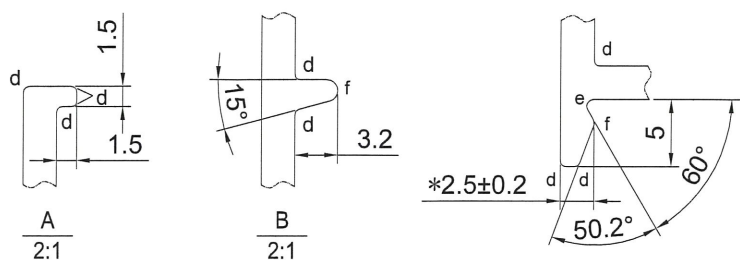

SIGNATURE GRADEING	HIGH SIGNATURE GRADEING	C.C.DIA(MM)	PERIMETER							
AREA (SQ MM)	1383.57	UNSPECIFIED THICKNESS	2.5	(MM)	751.28	STANDARD		SCALE	1:1	
MASS (KG/M)	3.750	UNSPECIFIED CORNERS	-	SURFACE AREA	479.66	ALLOY	6063-T6	VERSION		
COMPANY ISSUE			DRAWA	LHR	DATE	2020-02-26	APELLATION	PAGE OF		
			STANDA-RDIZATION		DATE					
			TO SIGN		DATE					
			AUDITING		DATE					
MARKER	MODIFY	FILE NO	SIGNATURE	DATE	APPROV	DATE				

美特鋁質有限公司
MIDI Aluminium Fabricator Ltd.

X85762

CUSTOMER	CUSTOMER APPROVAL	CUST PART NO.	AL-PW03(0) 70生窗底框
		SECTION NO.	X85762

a=0.1r
b=0.2r
c=0.3r
d=0.4r
e=0.5r
f=0.8r

美特鋁質有限公司
承認圖面
日期 6-3-20

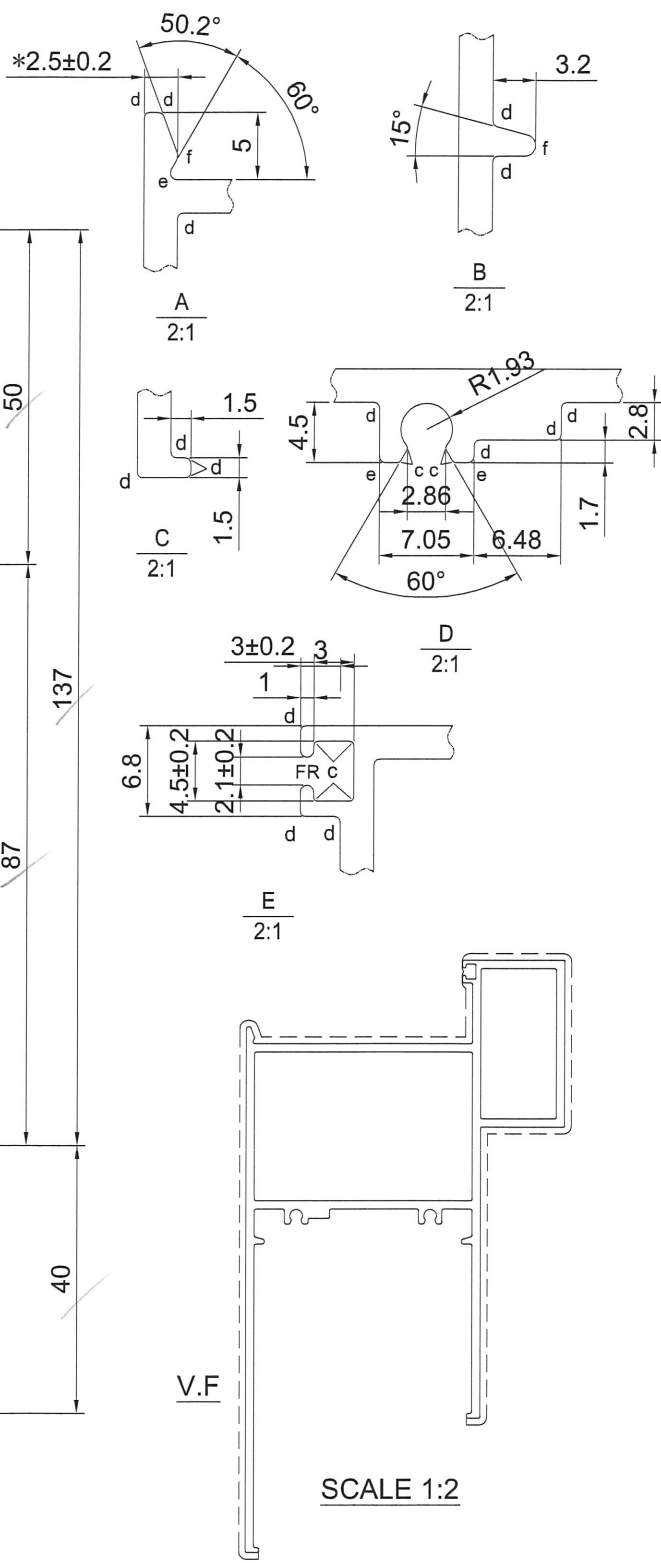
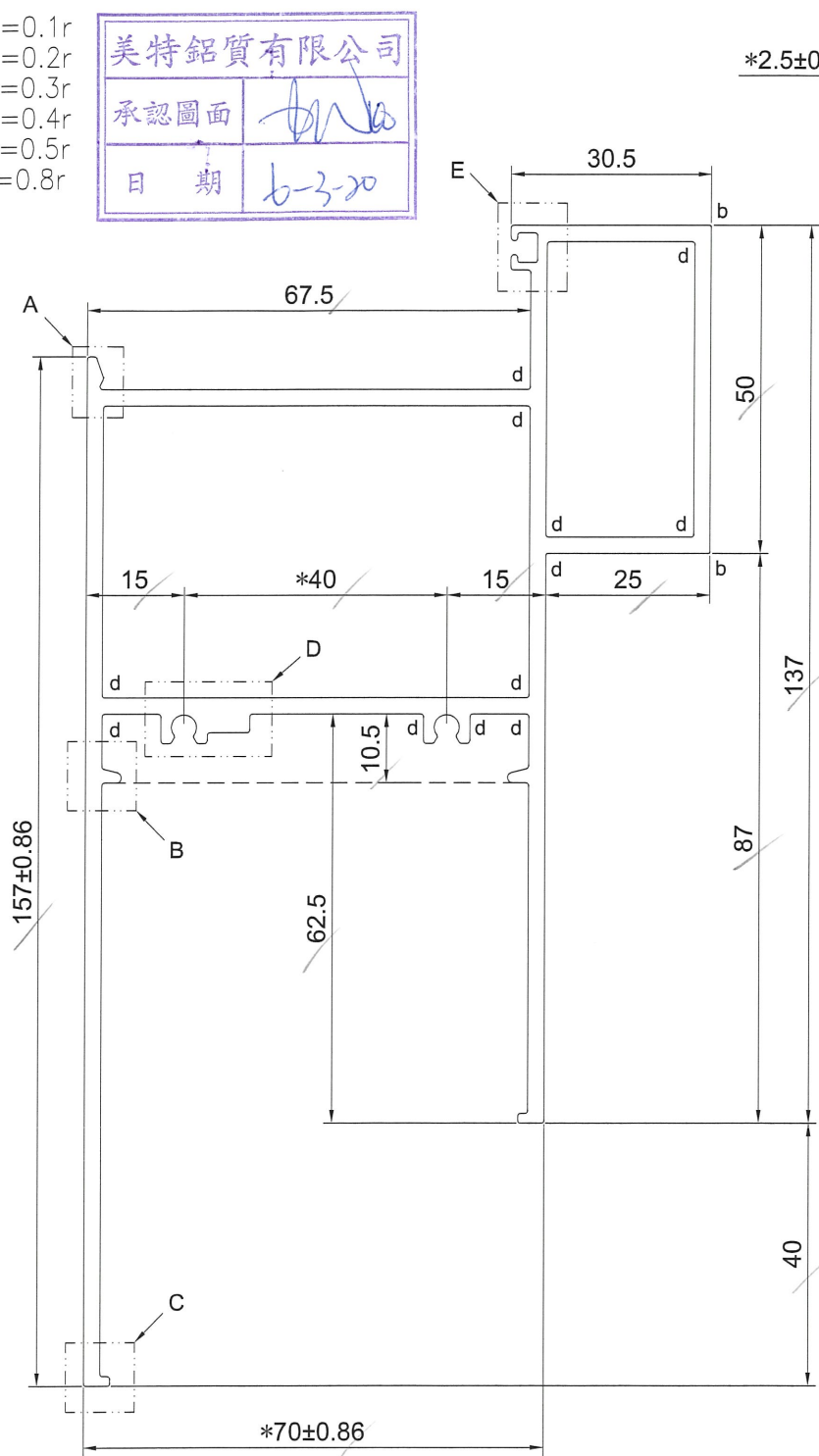

SCALE 1:2

SIGNATURE GRADEING	HIGH SIGNATURE GRADEING	C.C.DIA(MM)							
AREA (SQ MM)	1363.89	UNSPECIFIED THICKNESS	2.5	PERIMETER (MM)	732.33	STANDARD		SCALE	1:1
MASS (KG/M)	3.696	UNSPECIFIED CORNERS	-	SURFACE AREA	460.71	ALLOY	6063-T6	VERSION	
COMPANY ISSUE			DRAWN	LHR	DATE	2020-02-26	APPELLATION	PAGE OF	
			STANDARDIZATION		DATE				
			TO SIGN		DATE				
			AUDITING		DATE				
MARKER	MODIFY	FILE NO	SIGNATURE	DATE	APPROV				

X85763

CUSTOMER	CUSTOMER APPROVAL	CUST PART NO.	AL-PW04(0) 70 梗窗邊框
		SECTION NO.	X85763

a=0.1r
b=0.2r
c=0.3r
d=0.4r
e=0.5r
f=0.8r

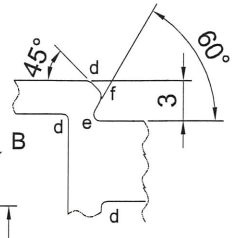
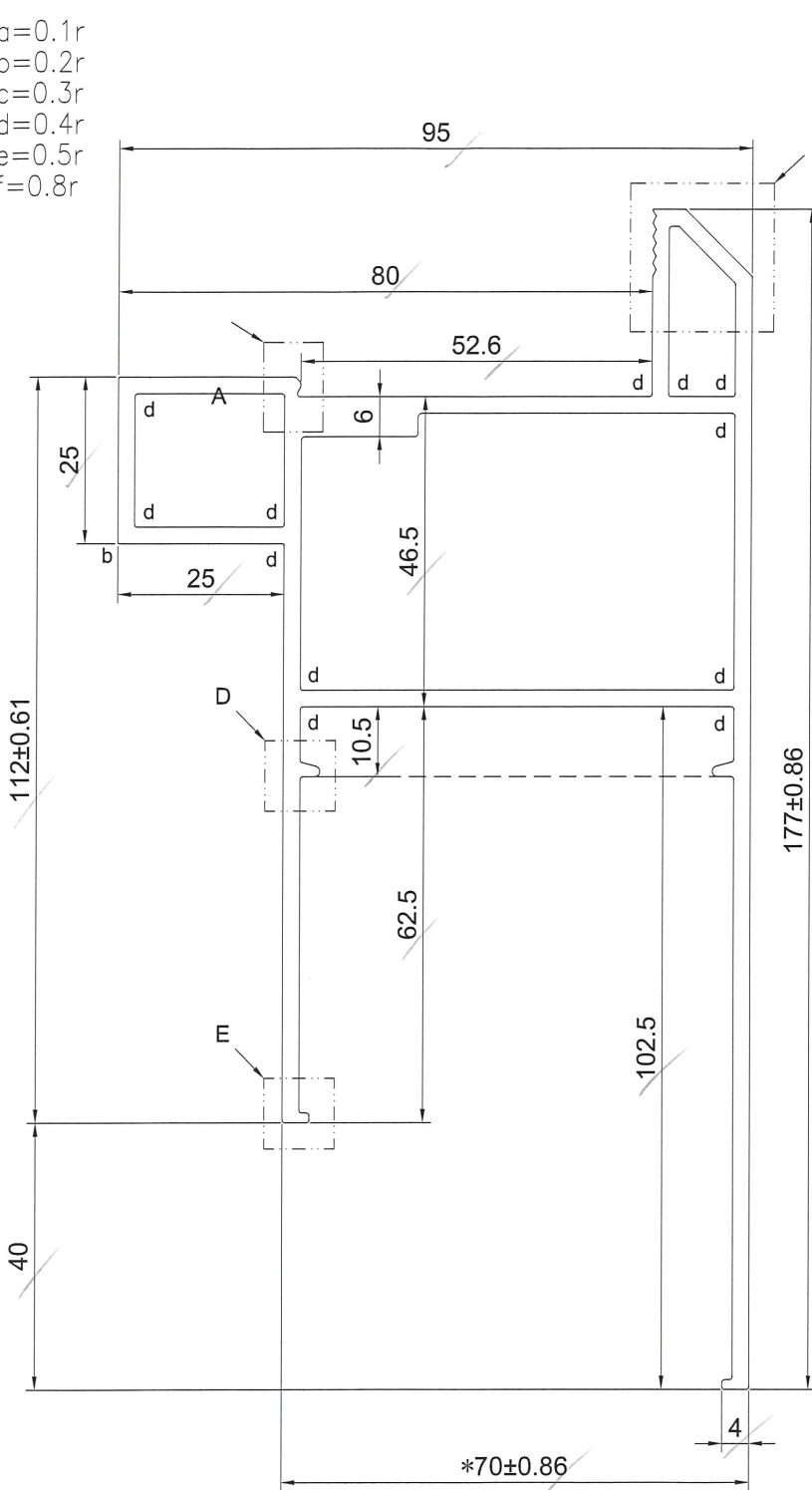

A
2:1

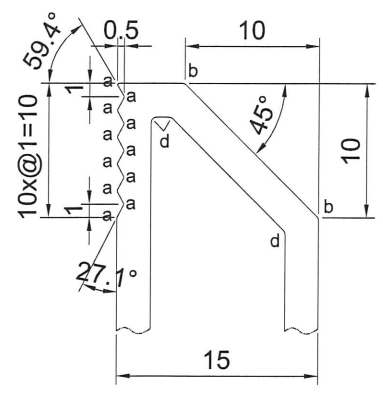

B
2:1

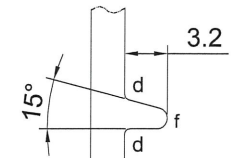

D
2:1

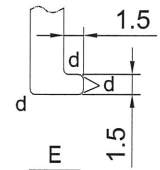

E
2:1

美特鋁質有限公司
承認圖面
日期 6-3-20

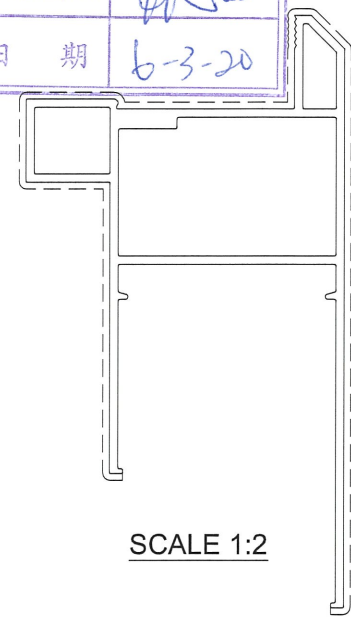

SCALE 1:2

SIGNATURE GRADEING	HIGH SIGNATURE GRADEING	C.C.DIA(MM)							
AREA (SQ MM)	1316.15	UNSPECIFIED THICKNESS	2.5	PERIMETER (MM)	683.41	STANDARD		SCALE	1:1
MASS (KG/M)	3.567	UNSPECIFIED CORNERS	-	SURFACE AREA	357.80	ALLOY	6063-T6	VERSION	
COMPANY ISSUE			DRAWN	LHR	DATE	2020-02-26	APPELLATION	PAGE OF	
			STANDARDIZATION		DATE				
			TO SIGN		DATE				
			AUDITING		DATE				
MARKER	MODIFY	FILE NO	SIGNATURE	DATE	APPROV				

美特鋁質有限公司
MIDI Aluminium Fabricator Ltd.

X85764

CUSTOMER		CUSTOMER APPROVAL	CUST PART NO.	AL-PW05(0) 70生窗框拍凸
			SECTION NO.	X85764

a=0.1r
b=0.2r
c=0.3r
d=0.4r
e=0.5r
f=0.8r

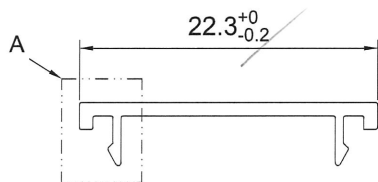
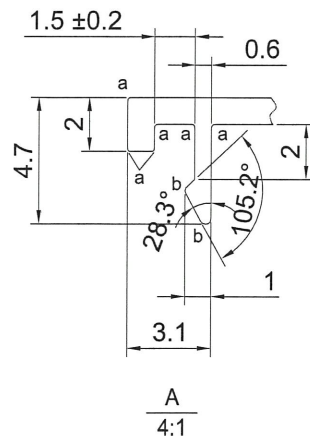
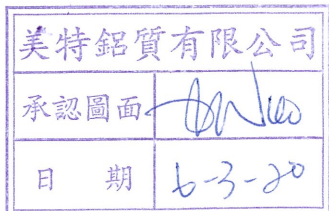

SCALE 2:1

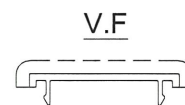

SCALE 1:1

SIGNATURE GRADEING	HIGH SIGNATURE GRADEING	C.C.DIA(MM)							
AREA (SQ MM)	29.05	UNSPECIFIED THICKNESS	1.0	PERIMETER (MM)	64.81	STANDARD		SCALE	1:1
MASS (KG/M)	0.079	UNSPECIFIED CORNERS	-	SURFACE AREA	26.33	ALLOY	6063-T6	VERSION	
COMPANY ISSUE			DRAWN	LHR	DATE	2020-02-26	APELLATION	PAGE OF	
			STANDARDIZATION		DATE				
			TO SIGN		DATE				
			AUDITING		DATE				
MARKER	MODIFY	FILE NO	SIGNATURE	DATE	APPROV				

X85765

CUSTOMER	CUSTOMER APPROVAL	CUST PART NO.	AL-PW11(0) 70窗反拍線
		SECTION NO.	X85765

a=0.1r
b=0.2r
c=0.3r
d=0.4r
e=0.5r
f=0.8r

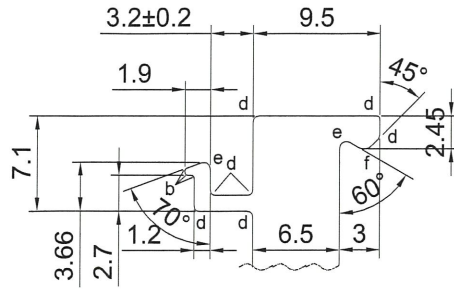

A
2:1

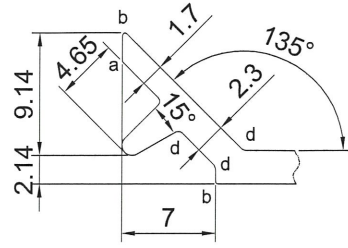

B
2:1

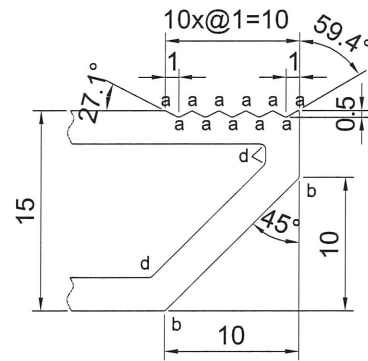
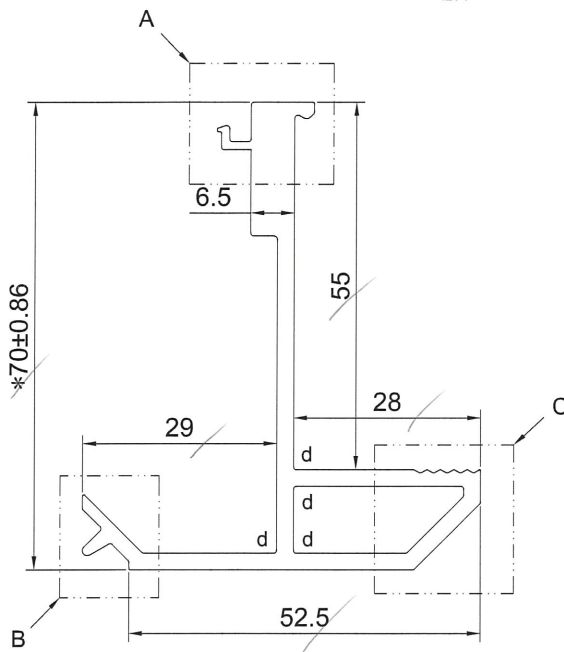

C
2:1

美特鋁質有限公司	
承認圖面	<i>[Signature]</i>
日期	6-3-20

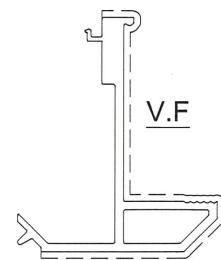

SCALE 1:2

SIGNATURE GRADEING	HIGH SIGNATURE GRADEING	C.C.DIA(MM)							
AREA (SQ MM)	442.48	UNSPECIFIED THICKNESS	2.5	PERIMETER (MM)	308.87	STANDARD		SCALE	1:1
MASS (KG/M)	1.199	UNSPECIFIED CORNERS	-	SURFACE AREA	71.68	ALLOY	6063-T6	VERSION	
COMPANY ISSUE			DRAWN	LHR	DATE	2020-02-26	APELLATION	PAGE OF	
			STANDARDIZATION		DATE				
			TO SIGN		DATE				
			AUDITING		DATE				
MARKER	MODIFY	FILE NO	SIGNATURE	DATE	APPROV				

X85767

CUSTOMER	CUSTOMER APPROVAL	CUST PART NO.	AL-PW21(0) 70生窗玉
		SECTION NO.	X85767

a=0.1r
b=0.2r
c=0.3r
d=0.4r
e=0.5r
f=0.8r

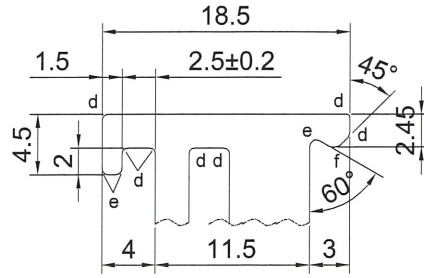
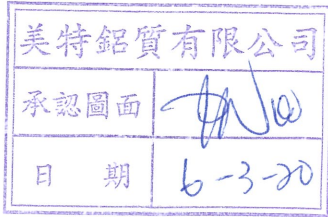

A
2:1

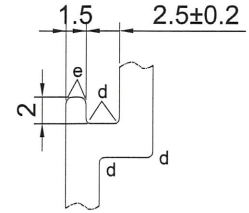

B
2:1

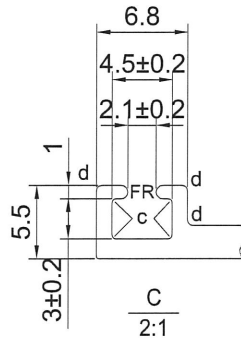

C
2:1

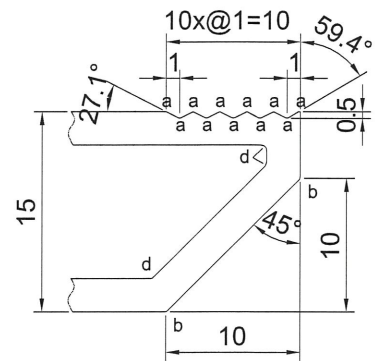

D
2:1

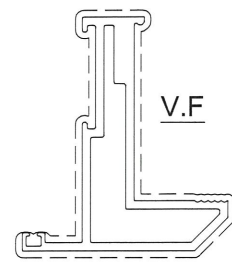
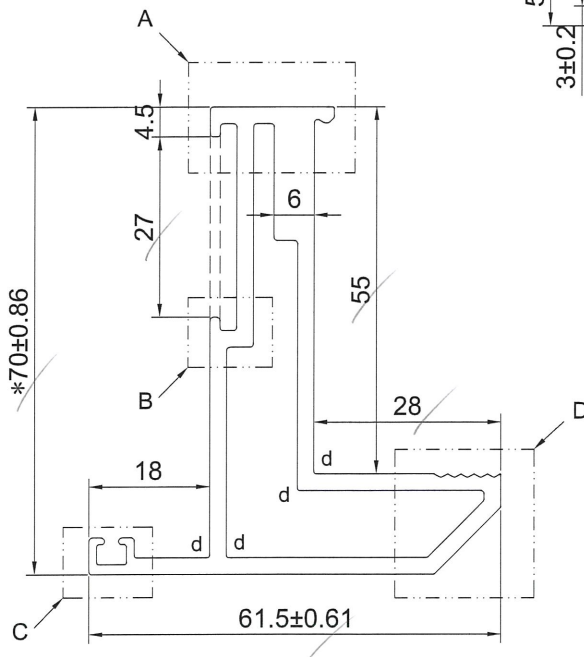

SCALE 1:2

SIGNATURE GRADEING	HIGH SIGNATURE GRADEING	C.C.DIA(MM)							
AREA (SQ MM)	594.37	UNSPECIFIED THICKNESS	2.5	PERIMETER (MM)	287.39	STANDARD		SCALE	1:1
MASS (KG/M)	1.610	UNSPECIFIED CORNERS	-	SURFACE AREA	200.82	ALLOY	6063-T6	VERSION	
COMPANY ISSUE			DRAWN	LHR	DATE	2020-02-26	APELLATION	PAGE OF	
			STANDARDIZATION		DATE				
			TO SIGN		DATE				
			AUDITING		DATE				
MARKER	MODIFY	FILE NO	SIGNATURE	DATE	APPROV				

X85769

CUSTOMER	CUSTOMER APPROVAL	CUST PART NO.	AL02(0) 70榑窗主企榑
		SECTION NO.	X85769

a=0.1r
b=0.2r
c=0.3r
d=0.4r
e=0.5r
f=0.8r

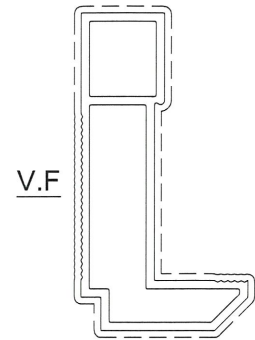
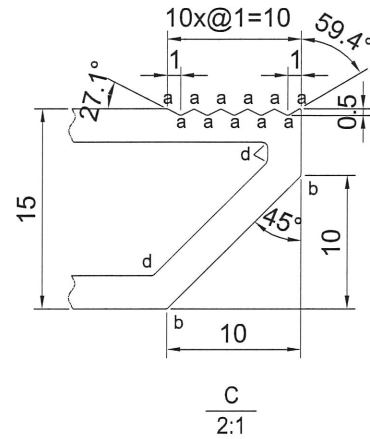
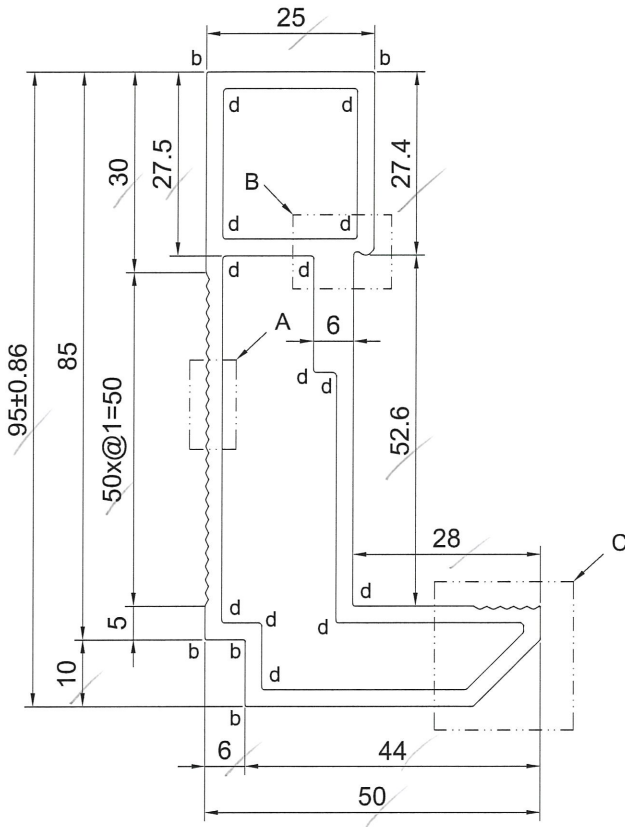
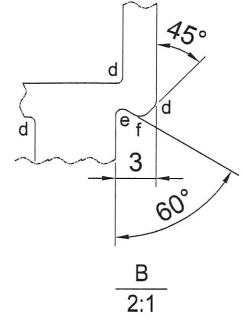
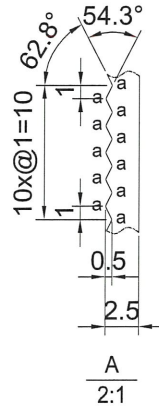
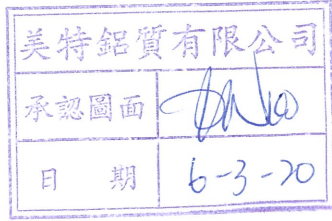

SCALE 1:2

SIGNATURE GRADEING	HIGH SIGNATURE GRADEING	C.C.DIA(MM)							
AREA (SQ MM)	728.36	UNSPECIFIED THICKNESS	2.5	PERIMETER (MM)	296.39	STANDARD		SCALE	1:1
MASS (KG/M)	1.974	UNSPECIFIED CORNERS	-	SURFACE AREA	190.14	ALLOY	6063-T6	VERSION	
COMPANY ISSUE			DRAWN	LHR	DATE	2020-02-26	APELLATION	PAGE OF	
			STANDARDIZATION		DATE				
			TO SIGN		DATE				
			AUDITING		DATE				
MARKER	MODIFY	FILE NO	SIGNATURE	DATE	APPROV				

X85770

CUSTOMER	CUSTOMER APPROVAL	CUST PART NO.	AL21(0) 70窗轉角企
		SECTION NO.	X85770

a=0.1r
b=0.2r
c=0.3r
d=0.4r
e=0.5r
f=0.8r

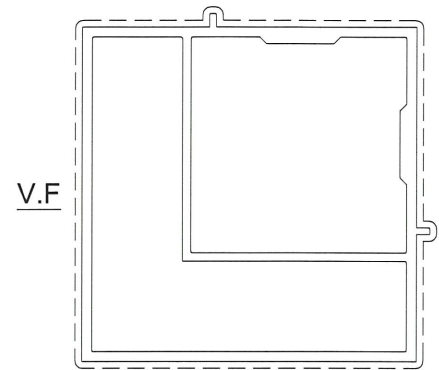
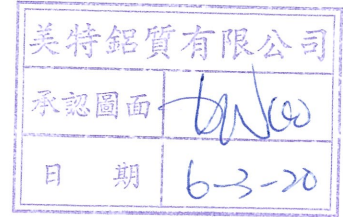
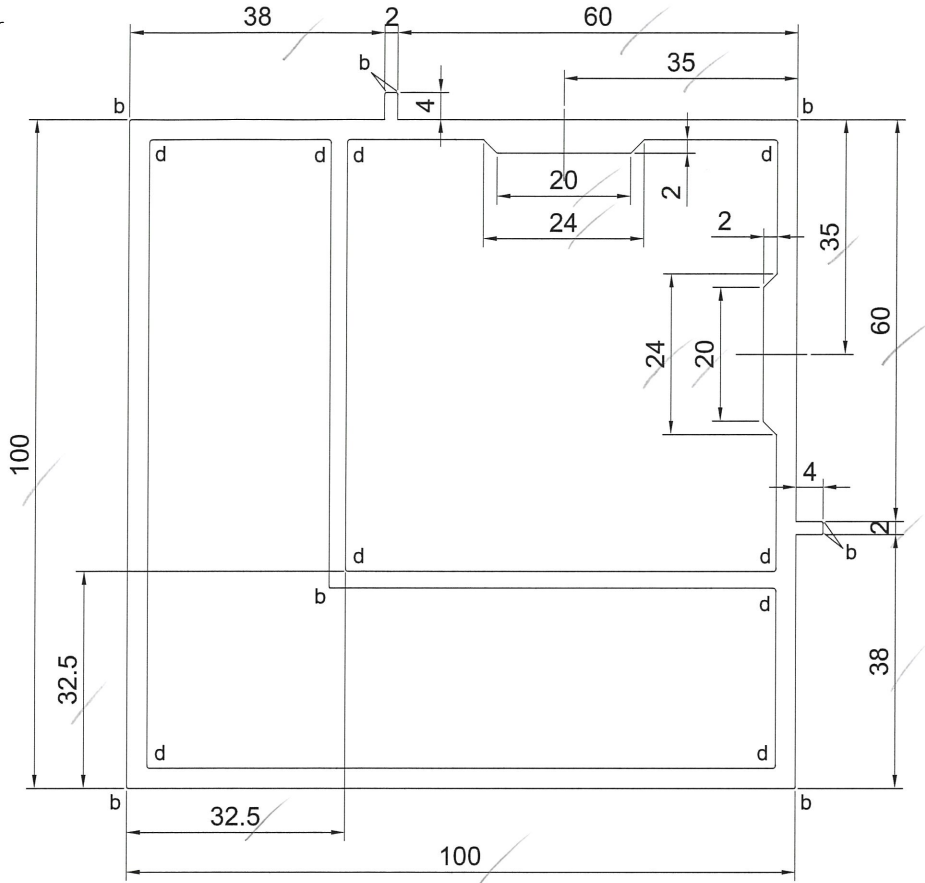

SCALE 1:2

SIGNATURE GRADEING	HIGH SIGNATURE GRADEING	C.C.DIA(MM)							
AREA (SQ MM)	1596.98	UNSPECIFIED THICKNESS	3.0	PERIMETER (MM)	415.31	STANDARD		SCALE	1:1
MASS (KG/M)	4.328	UNSPECIFIED CORNERS	-	SURFACE AREA	415.31	ALLOY	6063-T6	VERSION	
COMPANY ISSUE			DRAWN	LHR	DATE	2020-02-26	APELLATION	PAGE OF	
			STANDARDIZATION		DATE				
			TO SIGN		DATE				
			AUDITING		DATE				
MARKER	MODIFY	FILE NO	SIGNATURE	DATE	APPROV				

X85771

CUSTOMER	CUSTOMER APPROVAL	CUST PART NO.	AL22(0) 70窗200主企
		SECTION NO.	X85771

a=0.1r
b=0.2r
c=0.3r
d=0.4r
e=0.5r
f=0.8r

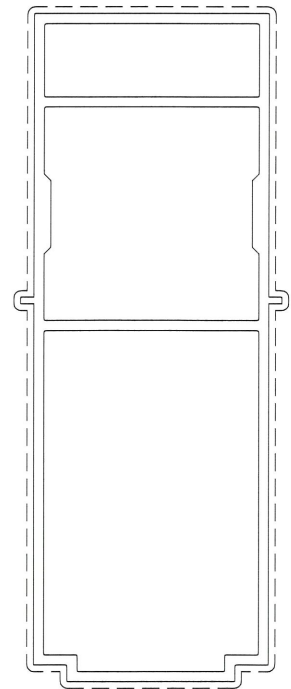
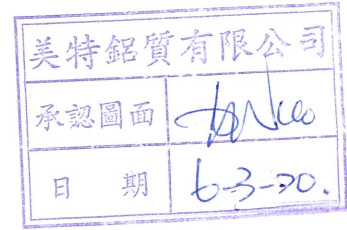
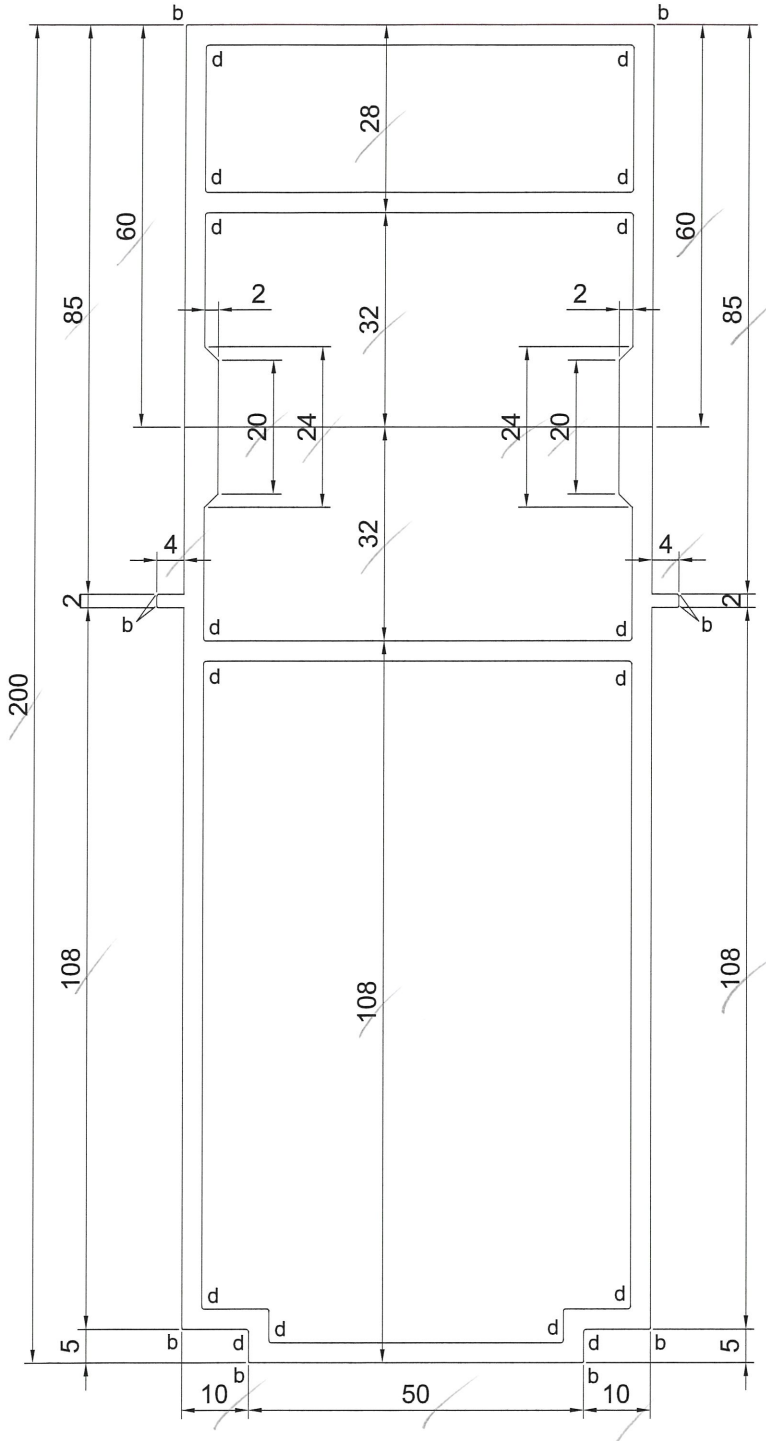

SCALE 1:2

SIGNATURE GRADEING	HIGH SIGNATURE GRADEING	C.C.DIA(MM)							
AREA (SQ MM)	2072.45	UNSPECIFIED THICKNESS	3.0	PERIMETER (MM)	554.80	STANDARD		SCALE	1:1
MASS (KG/M)	5.616	UNSPECIFIED CORNERS	-	SURFACE AREA	554.80	ALLOY	6063-T6	VERSION	
COMPANY ISSUE			DRAWN	LHR	DATE	2020-02-26		APPELLATION	PAGE OF
			STANDARDIZATION		DATE				
			TO SIGN		DATE				
			AUDITING		DATE				
MARKER	MODIFY	FILE NO	SIGNATURE	DATE	APPROV				

X85772

CUSTOMER	CUSTOMER APPROVAL	CUST PART NO.	AL23(0) 70窗150主企
		SECTION NO.	X85772

a=0.1r
b=0.2r
c=0.3r
d=0.4r
e=0.5r
f=0.8r

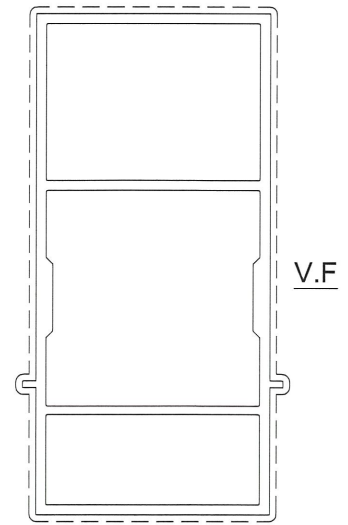
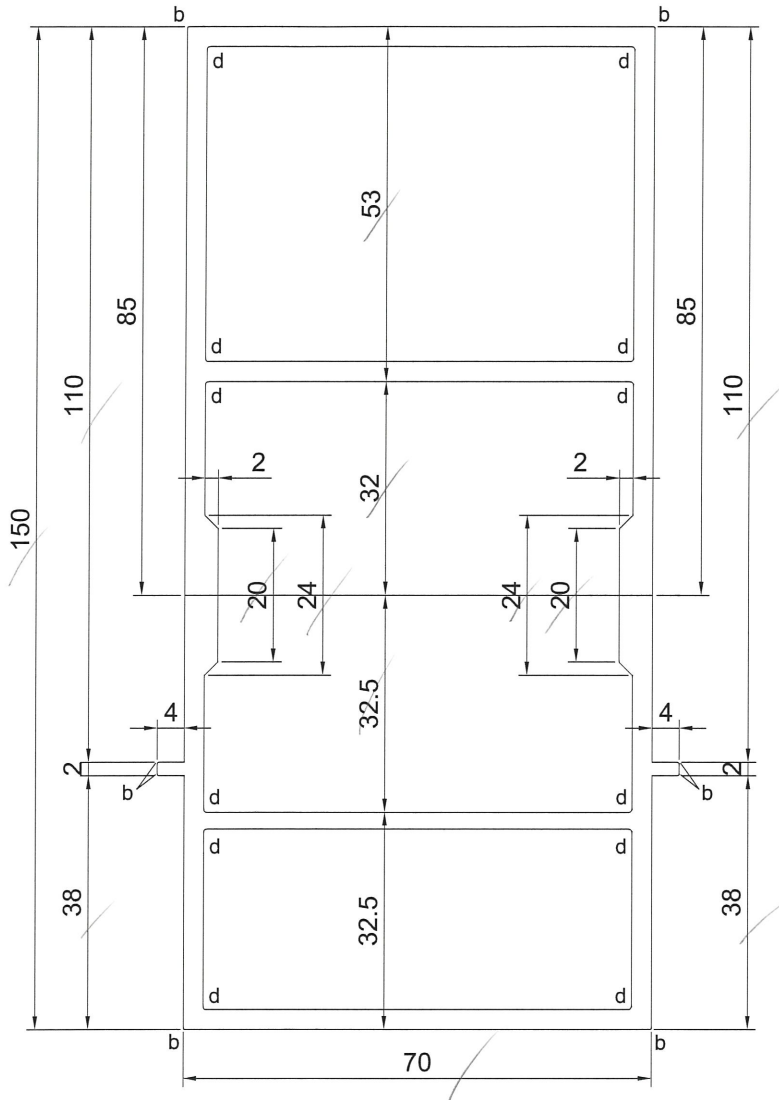
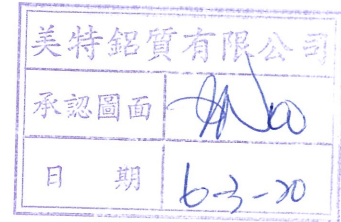

SCALE 1:2

SIGNATURE GRADEING	HIGH SIGNATURE GRADEING	C.C.DIA(MM)							
AREA (SQ MM)	1740.34	UNSPECIFIED THICKNESS	3.0	PERIMETER (MM)	455.31	STANDARD		SCALE	1:1
MASS (KG/M)	4.716	UNSPECIFIED CORNERS	-	SURFACE AREA	455.31	ALLOY	6063-T6	VERSION	
COMPANY ISSUE			DRAWN	LHR	DATE	2020-02-26		APELLATION	PAGE OF
			STANDARDIZATION		DATE				
			TO SIGN		DATE				
			AUDITING		DATE				
MARKER	MODIFY	FILE NO	SIGNATURE	DATE	APPROV				

X85773

CUSTOMER	CUSTOMER APPROVAL	CUST PART NO.	AL24(0) 70生窗夾企
		SECTION NO.	X85773

a=0.1r
b=0.2r
c=0.3r
d=0.4r
e=0.5r
f=0.8r

美特鋁質有限公司
承認圖面
日期

Hold

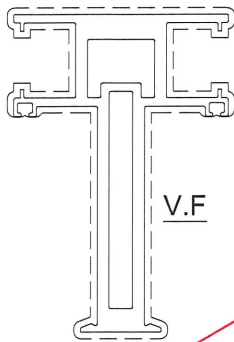
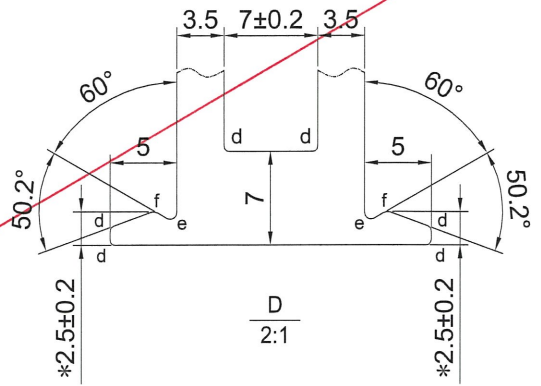
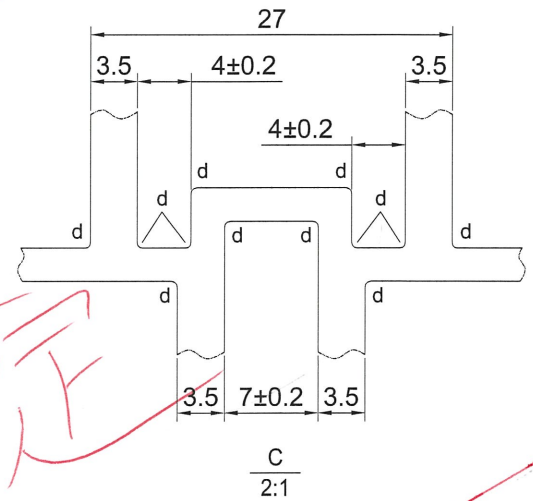
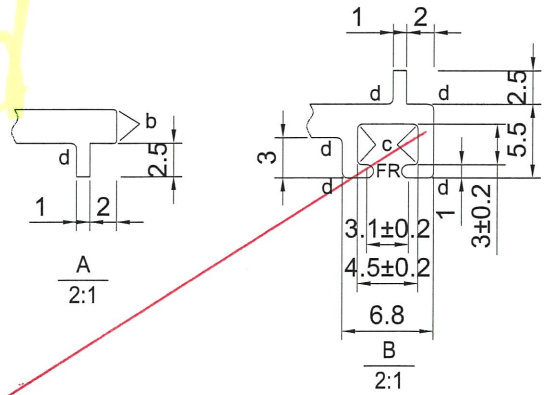
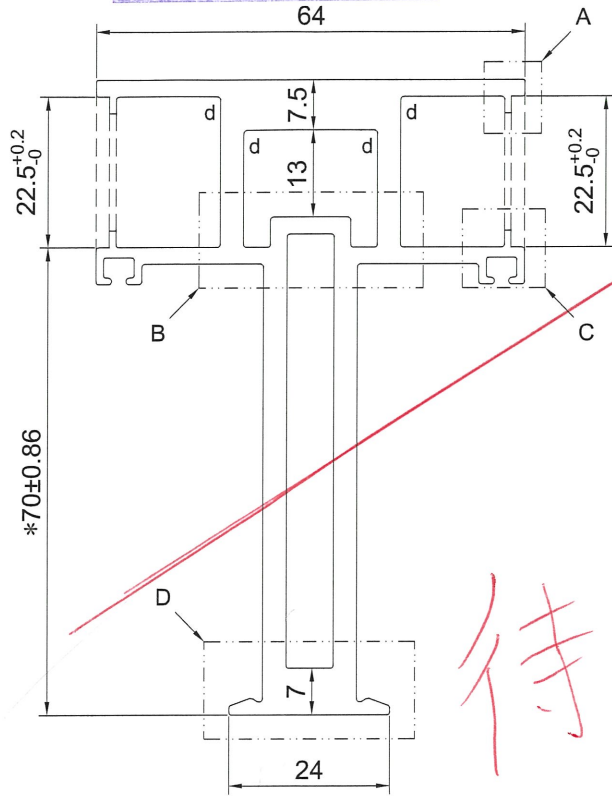

SCALE 1:2

待選

SIGNATURE GRADEING	HIGH SIGNATURE GRADEING	C.C.DIA(MM)							
AREA (SQ MM)	1153.07	UNSPECIFIED THICKNESS	2.5	PERIMETER (MM)	447.48	STANDARD		SCALE	1:1
MASS (KG/M)	3.125	UNSPECIFIED CORNERS	-	SURFACE AREA	447.48	ALLOY	6063-T6	VERSION	
COMPANY ISSUE			DRAWN	LHR	DATE	2020-02-26		APPELLATION	PAGE OF
			STANDARDIZATION		DATE				
			TO SIGN		DATE				
			AUDITING		DATE				
MARKER	MODIFY	FILE NO	SIGNATURE	DATE	APPROV				

X85774

CUSTOMER	CUSTOMER APPROVAL	CUST PART NO.	AL25(0) 70上生下梗中横
		SECTION NO.	X85774

a=0.1r
b=0.2r
c=0.3r
d=0.4r
e=0.5r
f=0.8r

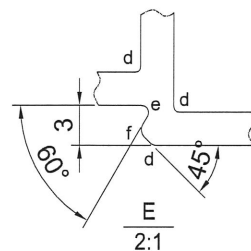
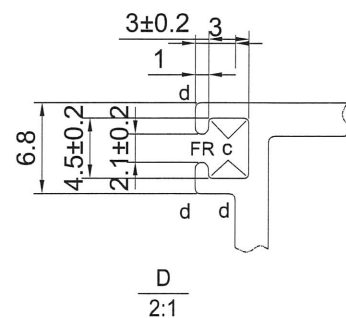
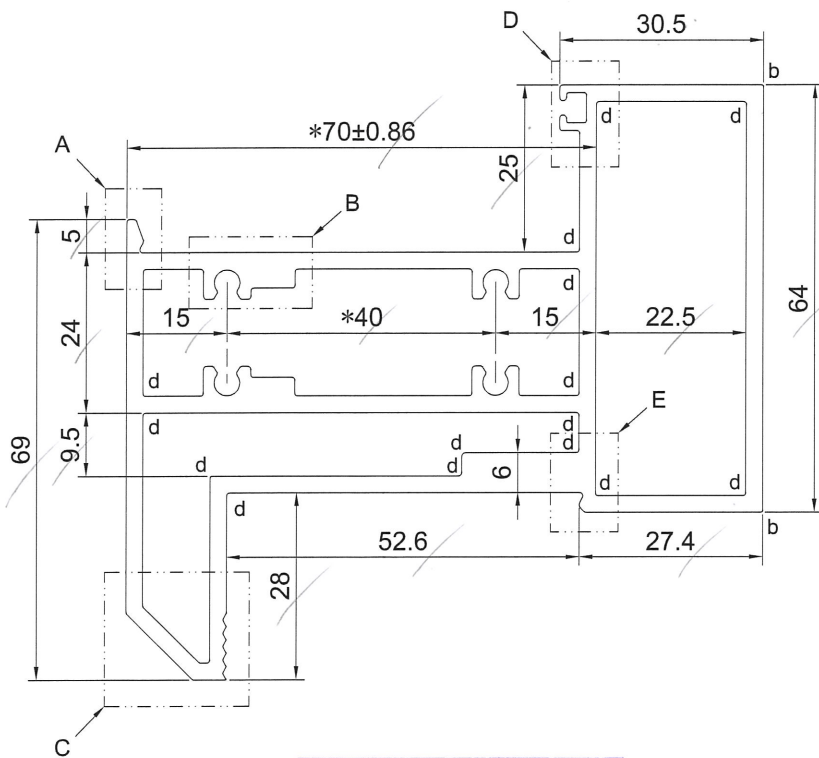
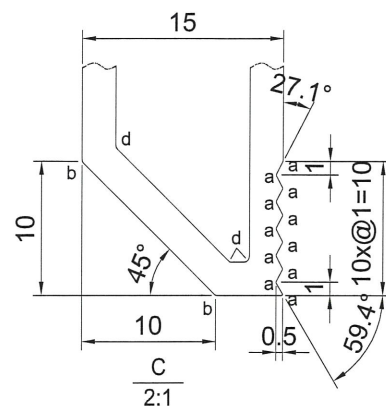
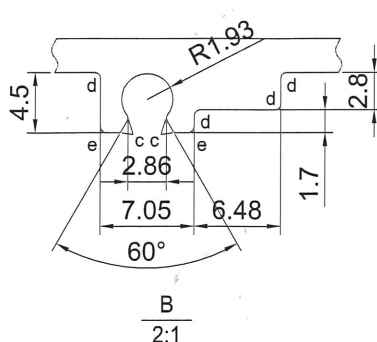
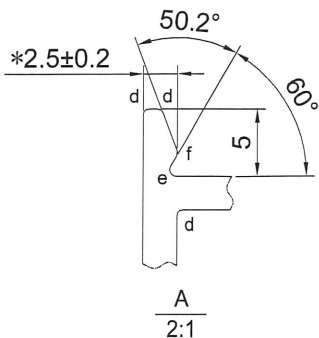

美特鋁質有限公司
承認圖面
日期 6-3-20

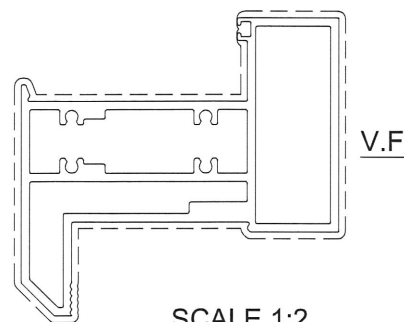

SIGNATURE GRADEING	HIGH SIGNATURE GRADEING	C.C.DIA(MM)							
AREA (SQ MM)	1248.94	UNSPECIFIED THICKNESS	2.5	PERIMETER (MM)	387.68	STANDARD		SCALE	1:1
MASS (KG/M)	3.385	UNSPECIFIED CORNERS	-	SURFACE AREA	302.64	ALLOY	6063-T6	VERSION	
COMPANY ISSUE			DRAWN	LHR	DATE	2020-02-26	APPELLATION	PAGE OF	
			STANDARDIZATION		DATE				
			TO SIGN		DATE				
			AUDITING		DATE				
MARKER	MODIFY	FILE NO	SIGNATURE	DATE	APPROV				

X85775

CUSTOMER	CUSTOMER APPROVAL	CUST PART NO.	AL26(0) 70上生下生中橫
		SECTION NO.	X85775

a=0.1r
b=0.2r
c=0.3r
d=0.4r
e=0.5r
f=0.8r

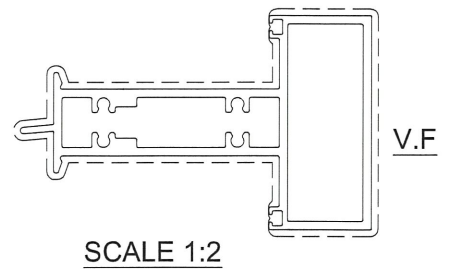
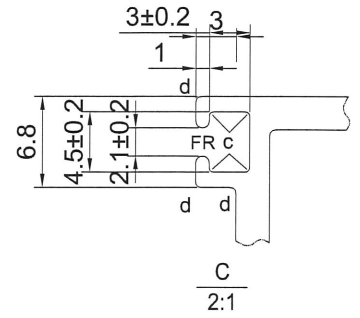
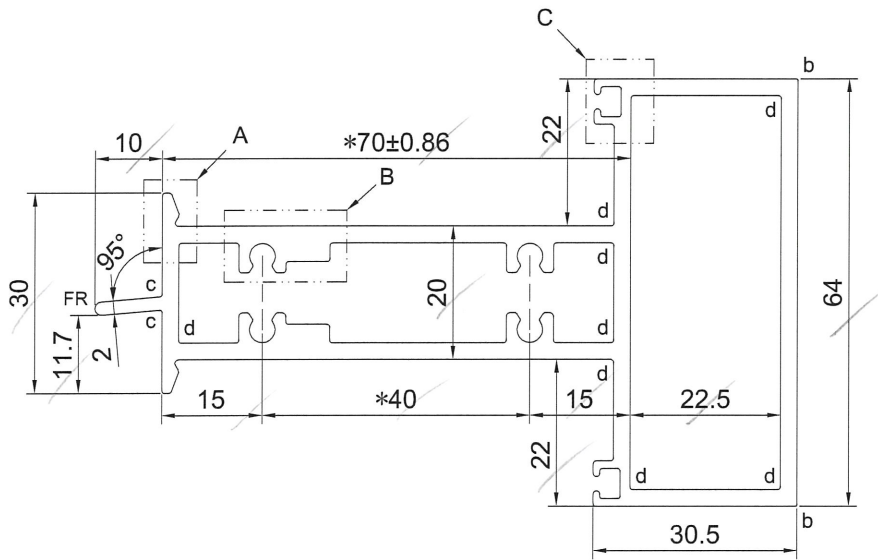
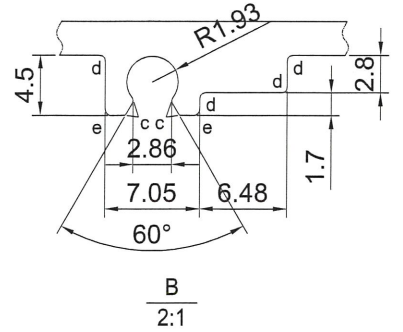
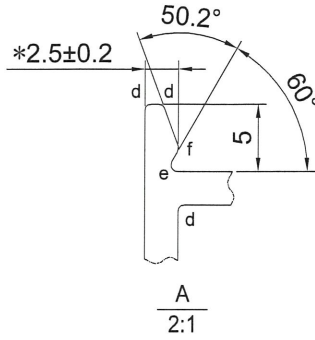
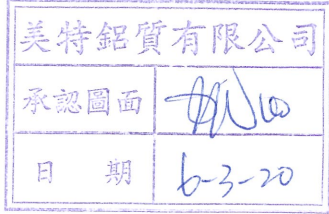

SIGNATURE GRADEING	HIGH SIGNATURE GRADEING	C.C.DIA(MM)							
AREA (SQ MM)	953.76	UNSPECIFIED THICKNESS	2.5	PERIMETER (MM)	374.49	STANDARD		SCALE	1:1
MASS (KG/M)	2.585	UNSPECIFIED CORNERS	-	SURFACE AREA	374.49	ALLOY	6063-T6	VERSION	
COMPANY ISSUE			DRAWN	LHR	DATE	2020-02-26	APELLATION	PAGE OF	
			STANDARDIZATION		DATE				
			TO SIGN		DATE				
			AUDITING		DATE				
MARKER	MODIFY	FILE NO	SIGNATURE	DATE	APPROV				

X85776

CUSTOMER		CUSTOMER APPROVAL		CUST PART NO.	AL27(0) 70窗玻璃夾角
				SECTION NO.	X85776

a=0.1r
b=0.2r
c=0.3r
d=0.4r
e=0.5r
f=0.8r

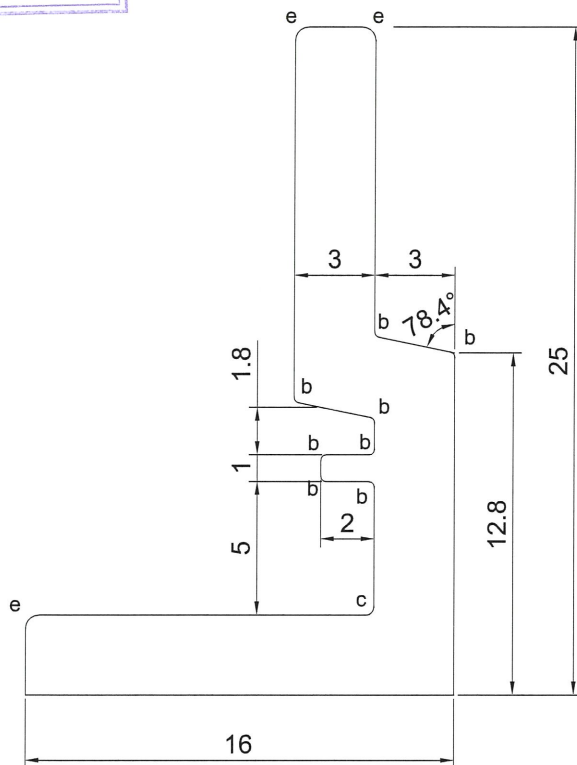
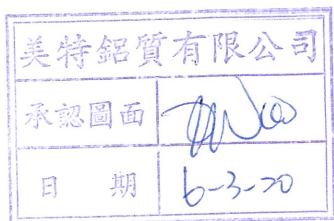

SCALE 4:1

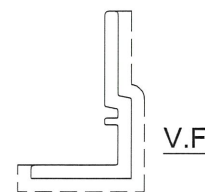

SCALE 1:1

SIGNATURE GRADEING	HIGH SIGNATURE GRADEING	C.C.DIA(MM)							
AREA (SQ MM)	123.20	UNSPECIFIED THICKNESS	3.0	PERIMETER (MM)	89.57	STANDARD		SCALE	1:1
MASS (KG/M)	0.334	UNSPECIFIED CORNERS	-	SURFACE AREA	-	ALLOY	6063-T6	VERSION	
COMPANY ISSUE			DRAWN	LHR	DATE	2020-02-26		APELLATION	PAGE OF
			STANDARDIZATION		DATE				
			TO SIGN		DATE				
			AUDITING		DATE				
MARKER	MODIFY	FILE NO	SIGNATURE	DATE	APPROV				

CUSTOMER	CUSTOMER APPROVAL	CUST PART NO.	AL30(0) 70上梗下梗中橫
		SECTION NO.	X85777

a=0.1r
b=0.2r
c=0.3r
d=0.4r
e=0.5r
f=0.8r

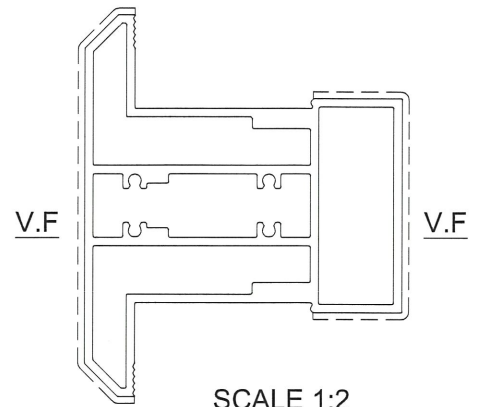
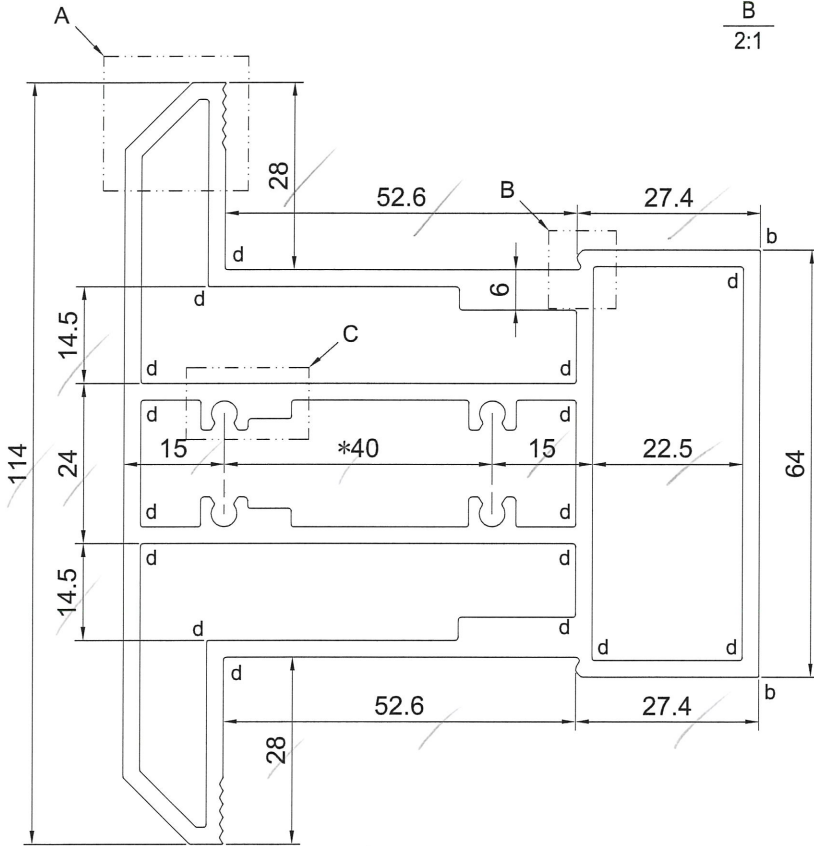
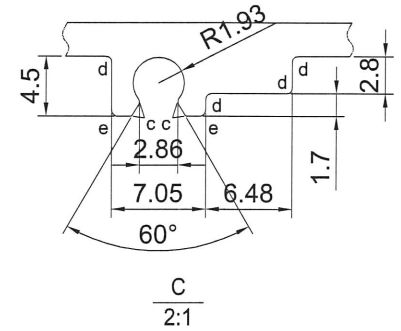
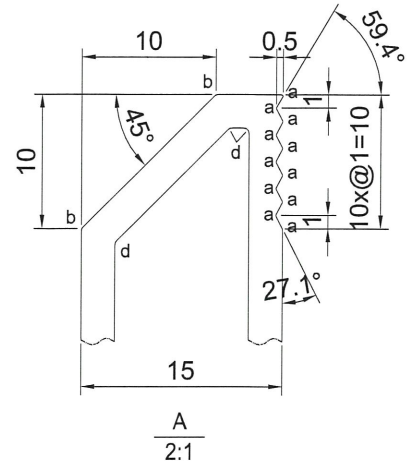
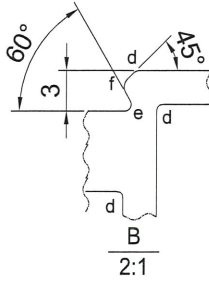
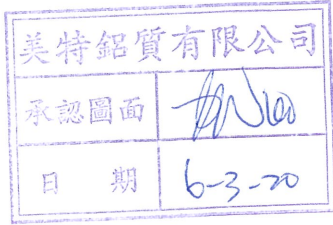

SCALE 1:2

SIGNATURE GRADEING	HIGH SIGNATURE GRADEING	C.C.DIA(MM)							
AREA (SQ MM)	1578.81	UNSPECIFIED THICKNESS	2.5	PERIMETER (MM)	419.82	STANDARD		SCALE	1:1
MASS (KG/M)	4.279	UNSPECIFIED CORNERS	-	SURFACE AREA	249.43	ALLOY	6063-T6	VERSION	
COMPANY ISSUE			DRAWN	LHR	DATE	2020-02-26	APELLATION	PAGE OF	
			STANDARDIZATION		DATE				
			TO SIGN		DATE				
			AUDITING		DATE				
MARKER	MODIFY	FILE NO	SIGNATURE	DATE	APPROV				

X85778

CUSTOMER	CUSTOMER APPROVAL	CUST PART NO.	-AL32(0) 70窗百葉雞仔網框
		SECTION NO.	X85778

a=0.1r
b=0.2r
c=0.3r
d=0.4r
e=0.5r
f=0.8r

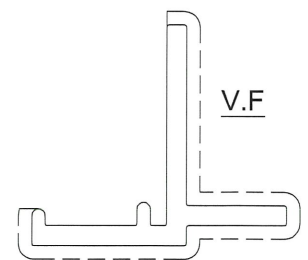
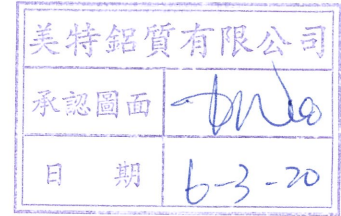
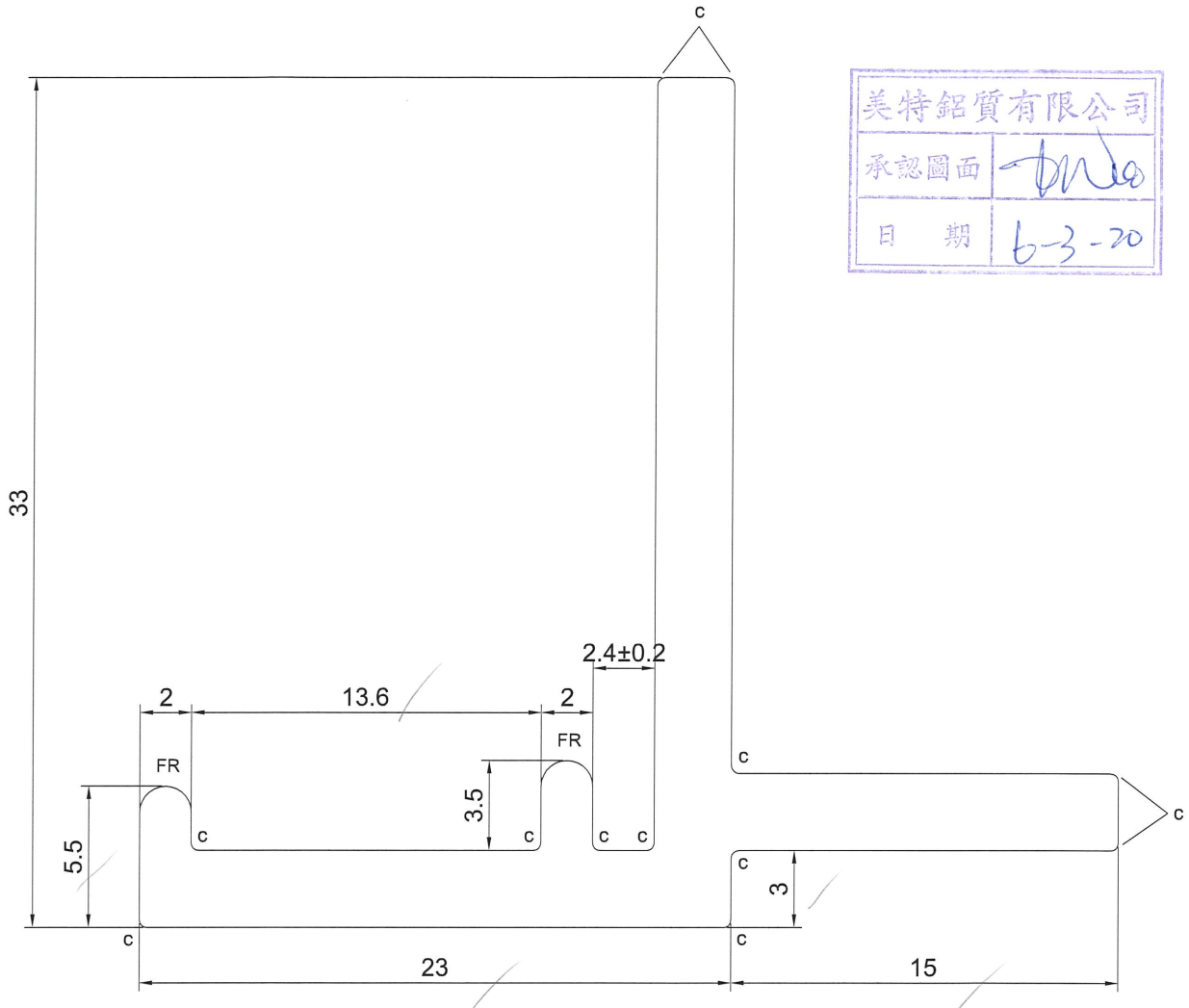

SCALE 4:1

SCALE 1:1

SIGNATURE GRADEING	HIGH SIGNATURE GRADEING	C.C.DIA(MM)							
AREA (SQ MM)	215.14	UNSPECIFIED THICKNESS	3.0	PERIMETER (MM)	150.74	STANDARD		SCALE	1:1
MASS (KG/M)	0.583	UNSPECIFIED CORNERS	-	SURFACE AREA	94.34	ALLOY	6063-T6	VERSION	
COMPANY ISSUE			DRAWN	LHR	DATE	2020-02-26	APPELLATION	PAGE OF	
			STANDARDIZATION		DATE				
			TO SIGN		DATE				
			AUDITING		DATE				
MARKER	MODIFY	FILE NO	SIGNATURE	DATE	APPROV				

X857.79

CUSTOMER	CUSTOMER APPROVAL	CUST PART NO.	AL33(0) 百葉滴水角
		SECTION NO.	X857.79

a=0.1r
b=0.2r
c=0.3r
d=0.4r
e=0.5r
f=0.8r
g=1.0r

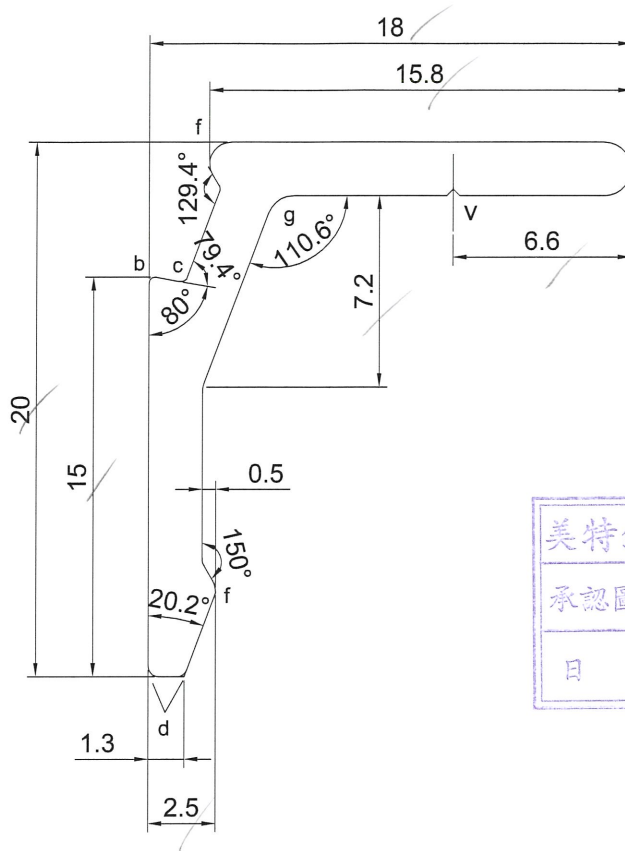

美特鋁質有限公司	
承認圖面	<i>[Signature]</i>
日期	6-3-20

SCALE 4:1

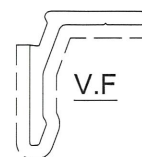

SCALE 1:1

SIGNATURE GRADEING	HIGH SIGNATURE GRADEING	C.C.DIA(MM)							
AREA (SQ MM)	70.27	UNSPECIFIED THICKNESS	2.0	PERIMETER (MM)	71.53	STANDARD		SCALE	1:1
MASS (KG/M)	0.190	UNSPECIFIED CORNERS	-	SURFACE AREA	48.93	ALLOY	6063-T 6	VERSION	
COMPANY ISSUE			DRAWN	LHR	DATE	2020-02-26	APELLATION	PAGE OF	
			STANDARDIZATION		DATE		美特鋁質有限公司 MIDI Aluminium Fabricator Ltd.		
			TO SIGN		DATE				
			AUDITING		DATE				
MARKER	MODIFY	FILE NO	SIGNATURE	DATE	APPROV	DATE			