



工程指示 / 要求簡箋(E.I.)

工程指示編號：EI / 9486 / 18

修改版次：A

工程編號：J - 837

工程名稱：觀塘裕民坊

工程項目：預留碼 (PE1 四腳款) (大樓隔音門及平台 5/F 泳池用)

收件人：Maggie

發件人：Eric Liu

日期：10/09/2018

要求提供 / 確認 事項：

- () 初步鋁料 B.M. () 加工拆圖，然後生產
() 正式鋁料 B.M. () 技術上資料 / 指示
() 配件 B.M. () 樣辦或貨品說明書
() 其他：_____

- () 尺寸表
() 報價
() 分判合約
- 下：銀同-劉小姐
原版 EI/9486/18, 貨已生產, 現放行 100 件

內容：

請送出 100 隻到地盤，作 Podium 5/F 泳池 Glass Wall 及大樓 acoustic 趟門，WP 用

早前已完成此 EI 原數量(1000 隻)，但因趟門勾企取消，此款預留碼大貨已取消

驗焊: Visual: 100%, MPI: 10% (請驗焊, 100 隻先) For Curtain Wall

謝謝！

請在 2018/ 09 / 20 前完成上列要求。

附：

以上項目為：

- 原合約工程包 原合約工程加 / 減賬 新工程報價

原因：-

分發東莞各部門：

- () 生產技術總監 連附件 () 技術部 連附件 () 生產部 連附件 () 機械設計部 連附件
() 採購部 連附件 () 生產統籌部 連附件
() 質檢部 連附件 () 會計部 連附件 () 報關組 連附件 () 其他 楊榮輝 連附件

分發其他分判：

- () 王禮秋 連附件

分發香港各部門：

- () 行政部 連附件 () 會計部 連附件 () 統籌部 連附件 () 工程部地盤科文 連附件 () 採購部 連附件 () QS 部 連附件 () 維修部 連附件 () 其他 _____ 連附件

傳遞編號：

發件人簽署：

項目經理簽署：

629886A

J237

2018.7.6

3.

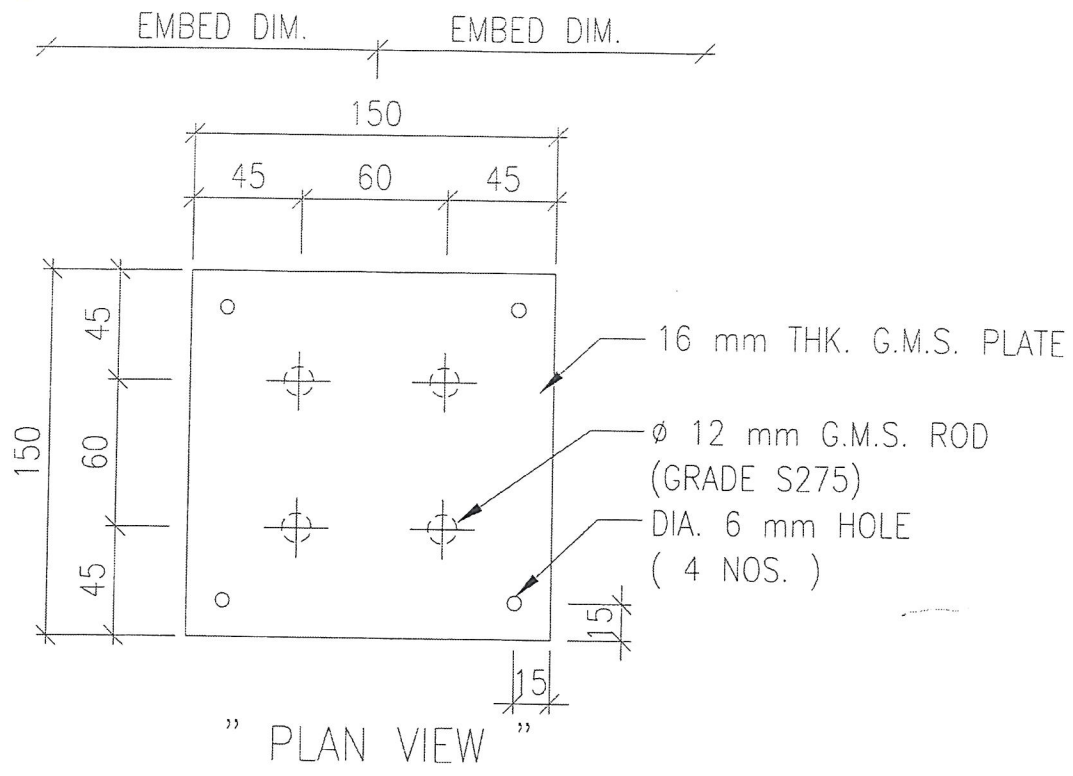

" CAST IN EMBED DETAILED DIMENSION "

TYPE : PE1
SCALE : 1:4

~~1000~~
2

出100隻
到地盤

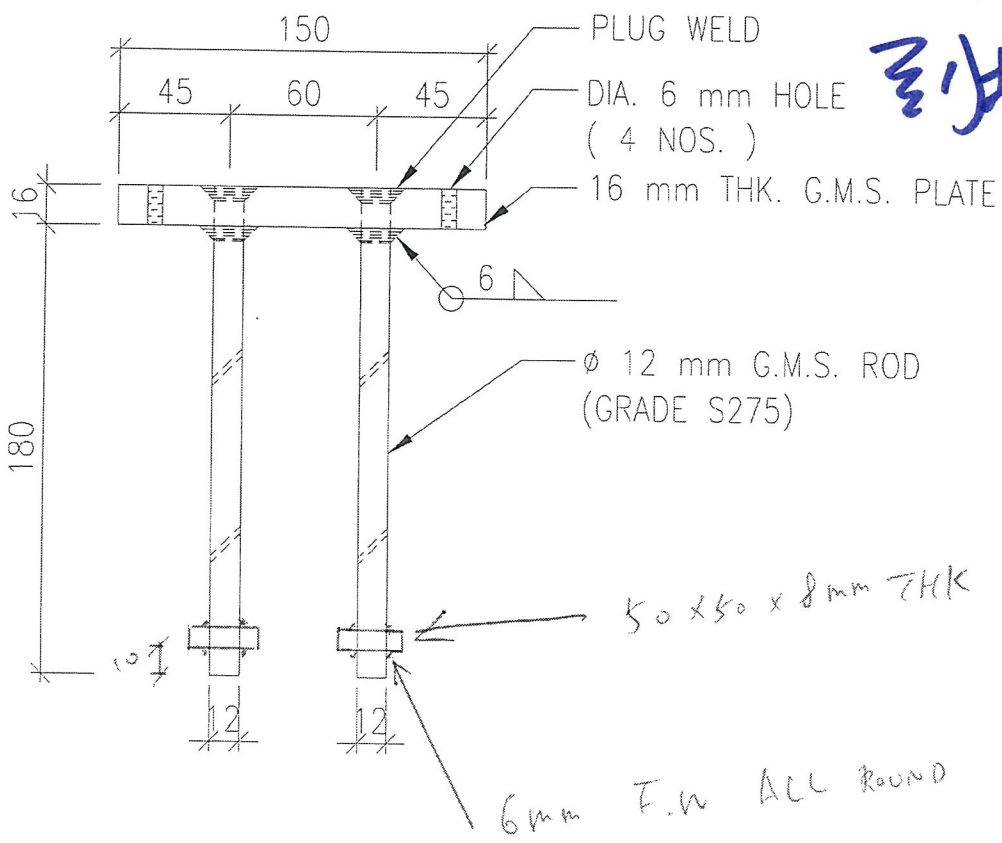

大樓 Acoustic UP

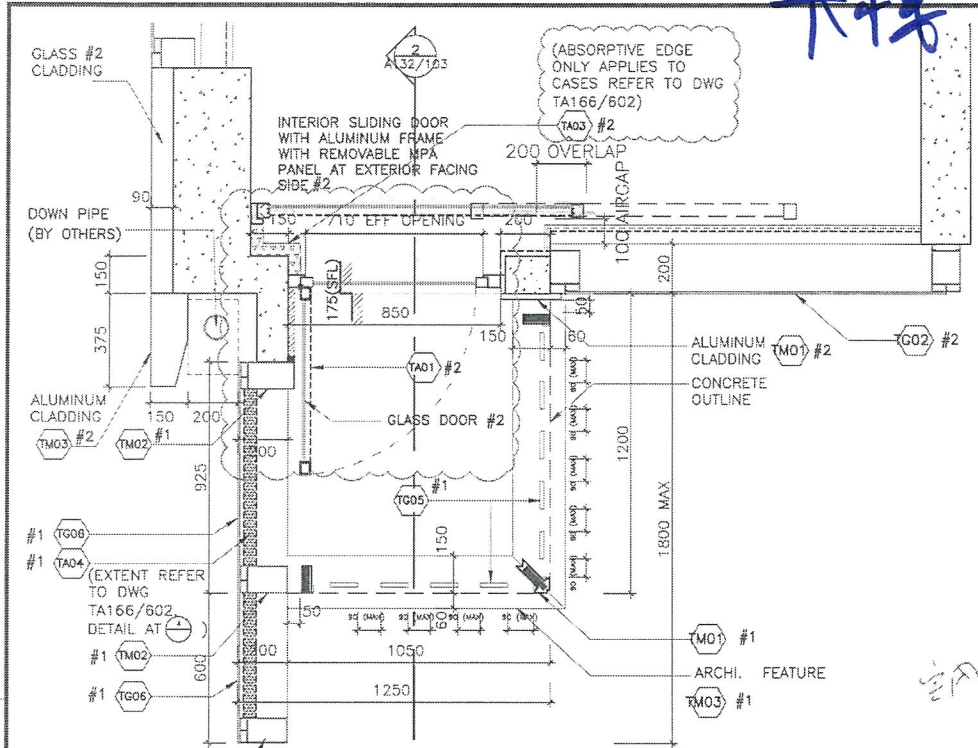

1 TYPICAL UP PLAN AT END UNIT ACOUSTIC FIN

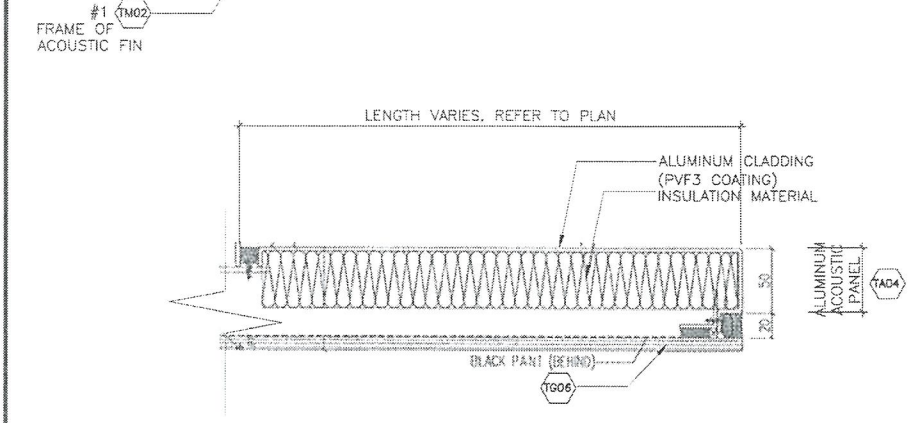

4 DETAIL OF ACOUSTIC FIN SCALE 1:5

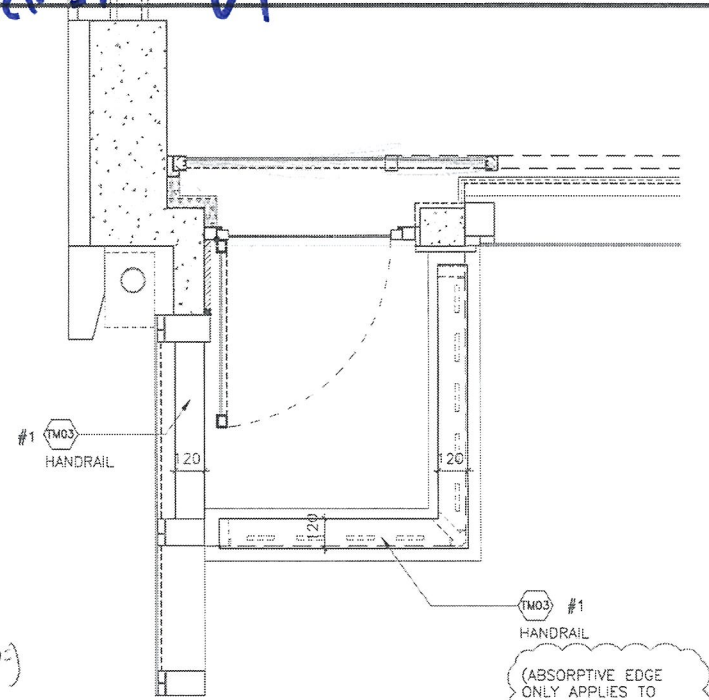

2 TOP PLAN AT END UNIT ACOUSTIC FIN

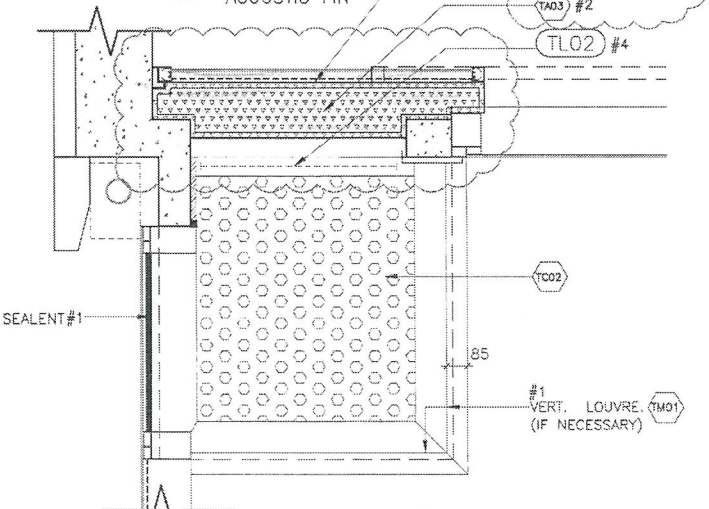

3 TOP REFLECTED CEILING PART PLAN ACOUSTIC FIN

NOTES
DO NOT SCALE DRAWING. FIGURED DIMENSIONS ARE TO BE FOLLOWED.
READ THIS DRAWING IN CONNECTION WITH GENERAL ARCHITECTURAL PLANS, STRUCTURAL PLANS, AND OTHER RELATED DRAWINGS. THE ARCHITECT SHALL BE NOTIFIED IMMEDIATELY OF ANY DISCREPANCY FOUND THEREIN.
COPYRIGHT OF THIS DRAWING RESERVED BY ARCHITECT.

- NOTE:
- #1 BY AL CLADDING/ BALUSTRADE/ CEILING NSC
 - #2 BY CURTAIN WALL(TOWER) NSC
 - #3 BY MAIN CONTRACTOR
 - #4 BY ELE. NSC

- GENERAL NOTES:
1. THE EXACT LOCATION AND TYPE OF ACOUSTIC WINDOW/BALCONY/UP SHOULD REFER TO DWG T/A166/602.
 2. THE OVERLAPPING LENGTH OF INNER SLIDING DOOR SHALL SUBJECT TO LAB TEST RESULT.
 3. THE SIZE OF GLAZING MATERIALS SHALL REFER TO WINDOW SCHEDULE.
 4. EFFECTIVE OPENING SHALL COMPLY WITH BD STATUTORY REQUIREMENT OF LIGHTING AND VENTILATION.
 5. SHOP DRAWING SHALL BE SUBMITTED FOR ARCHITECT'S APPROVAL.
 6. UNLESS OTHERWISE SPECIFIED, DETAILS SHALL REFER TO TYPICAL WINDOW/BALCONY/UP DWG.

NO.	DATE	REVISIONS	DESIGNED	CHECKED	REVIEWED	DATE

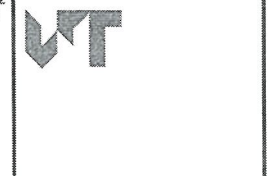

WONG TUNG & PARTNERS LIMITED ARCHITECTS & PLANNERS
30th Floor, Cityplaza 3, 300 Neo Star, Hong Kong
T: 852-2803 5988 F: 852-2811 1228 www.wongtung.com

PROJECT:
URA KWUN TONG TOWN CENTRE REDEVELOPMENT (AREA 2 & 3) AT KWUN TONG, KOWLOON

TITLE:
ACOUSTIC UP 2 DETAILS PART PLAN & ELEVATION

DATE	11/2017	SCALE	1:20
DRAWN	CHKD	DESIGNED	REVIEWED
(DPS)	(CLC)	(DPS)	(CP)
JOB NO.	DRAWING NO.	REV. NO.	
31690	T/A141/402	(03)	

03/06/2018
 PART 1: CIVIL WORKS - Engineering Drawing of Pool For Swimming Pool AT 5F
 20180329 REV A01
 2018.03.10 10:12:02
 Project Management Unit: Designer: Checked: Approved: ISO A1 841mm x 594mm

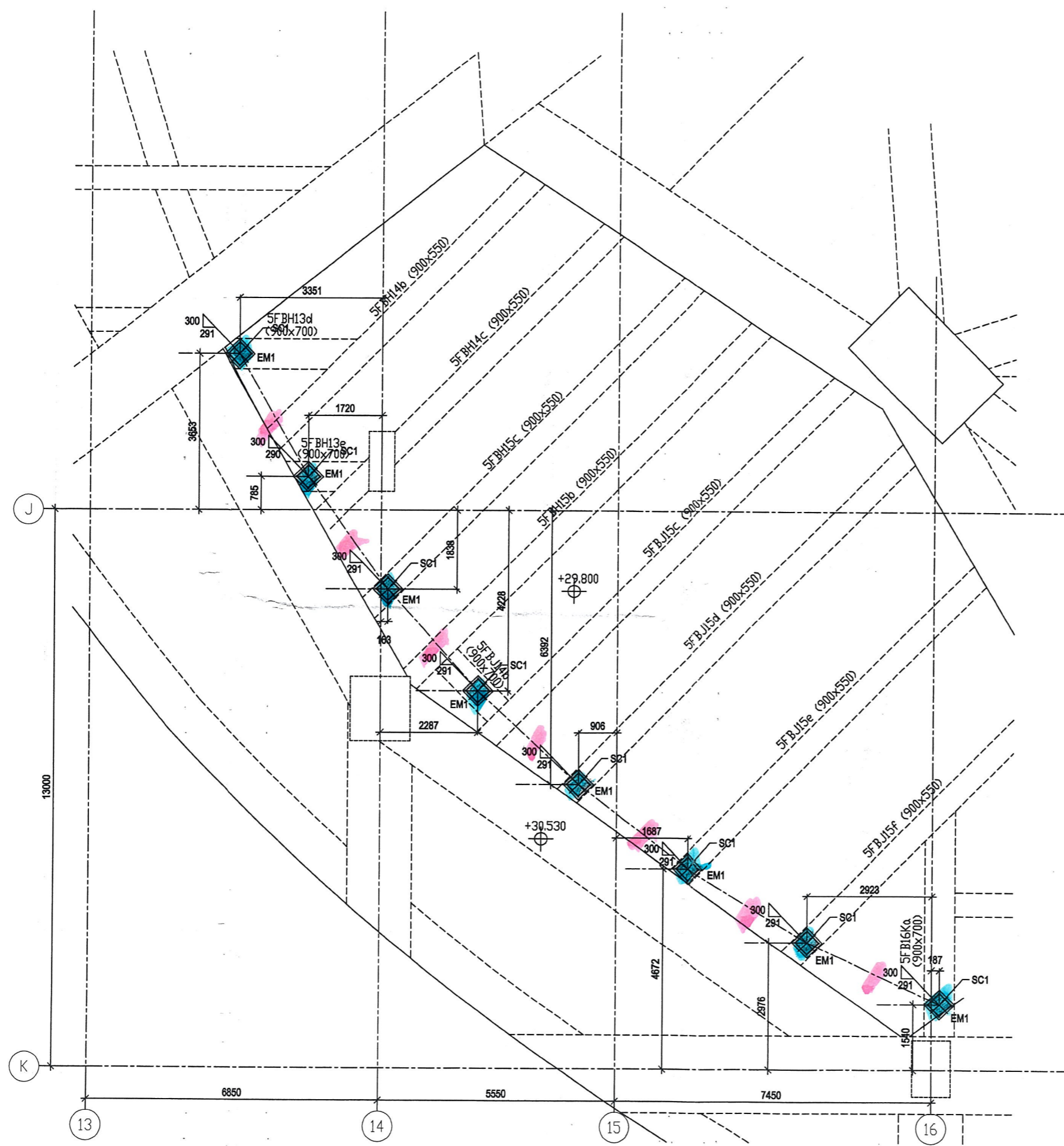

PLAN OF COLUMN FOR SWIMMING POOL AT 5F

■ 大柱位
■ Midi 白石位
 (冰渣待定)
 (粉修提供)

PODIUM

5/F 泳池

Note: This drawing is for reference only. It is not to be used for construction without the approval of the Building Authority. The Engineer shall be responsible for the design and construction of the structure.

Plan Approved

 CHIONG Kam-yung, Jacky
 Chief Structural Engineer
 for BUILDING AUTHORITY
 - 6 JUN 2018

AECOM

PROJECT
 URA KWUN TONG
 TOWN CENTRE
 REDEVELOPMENT
 (AREA 2 & 3)
 NKIL6514

CLIENT
 UNION SCORE
 INVESTMENT LTD

CONSULTANT
 AECOM Asia Company Ltd.
 www.aecom.com

SUB-CONSULTANTS

MAIN CONTRACTOR:

 華管建築有限公司
 CR CONSTRUCTION COMPANY LIMITED

AECOM Asia Company Limited

Wong Pong Loi
 Registered Structural Engineer RSE 3598

ISSUE/REVISION

NO.	DATE	DESCRIPTION	CHK.
03	23-03-2018	REVISED AS COMMENT	CT
02	28-02-2018	REVISED AS COMMENT	CT
01	15-11-2017	FOR APPROVAL	CT

NO.	DATE	DESCRIPTION	CHK.
03	23-03-2018	REVISED AS COMMENT	CT
02	28-02-2018	REVISED AS COMMENT	CT
01	15-11-2017	FOR APPROVAL	CT

STATUS
 BD SUBMISSION

SCALE
 N.T.S.

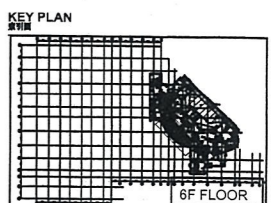

PROJECT NO.
 60333876

SHEET TITLE
 COLUMN PLAN
 for Swimming Pool AT 5F

SHEET NUMBER
 603149-5F-SM-SD02

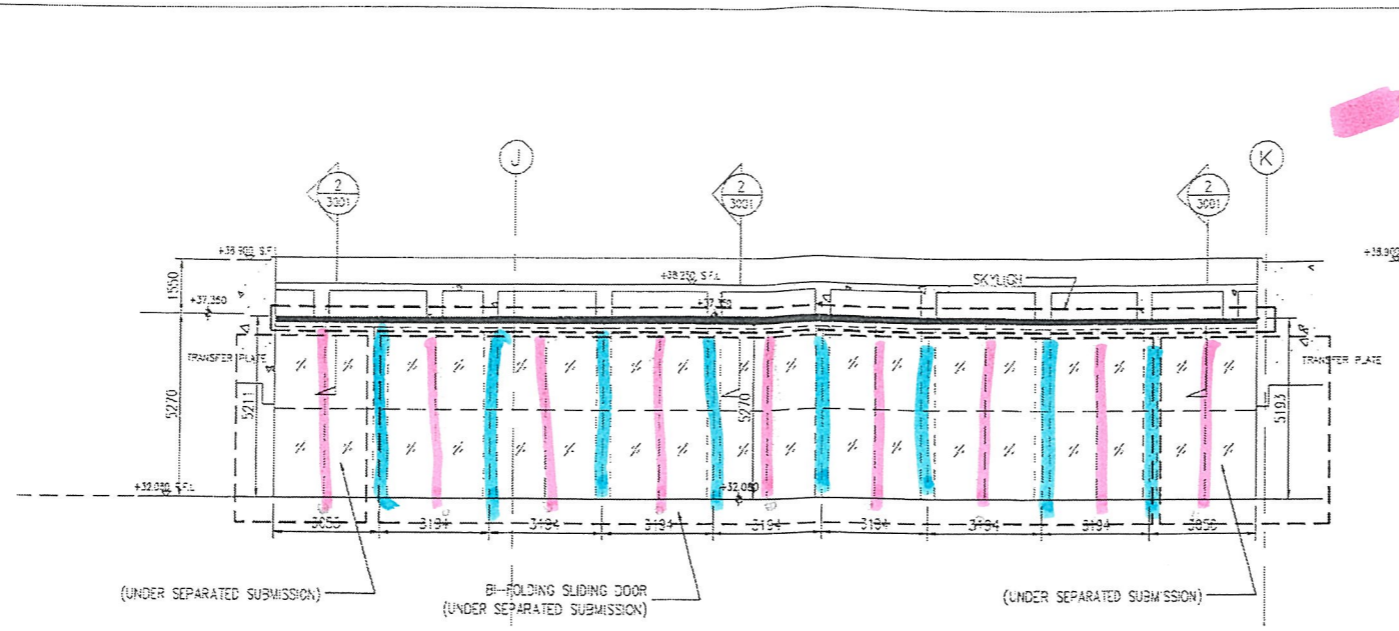

1 ELEVATION OF SKYLIGHT

Midi
 材料
 大判鋁架
 5/F 泳池位

LEGEND:
 EG2 15+1.52PVB+15mm THK. CLEAR LAMINATED TEMPERED GLASS
 3mm THK. ALUM. CLADDING

B.D. REF :
 CLIENT : 信和置業有限公司 Sino Land Company Limited
 ARCHITECT : WONG TUNG & PARTNERS LIMITED ARCHITECTS & PLANNERS
 MAIN CONTRACTOR : CR Construction Company Limited
 STRUCTURAL ENGINEER : AECOM
 FACADE CONSULTANT : AECOM

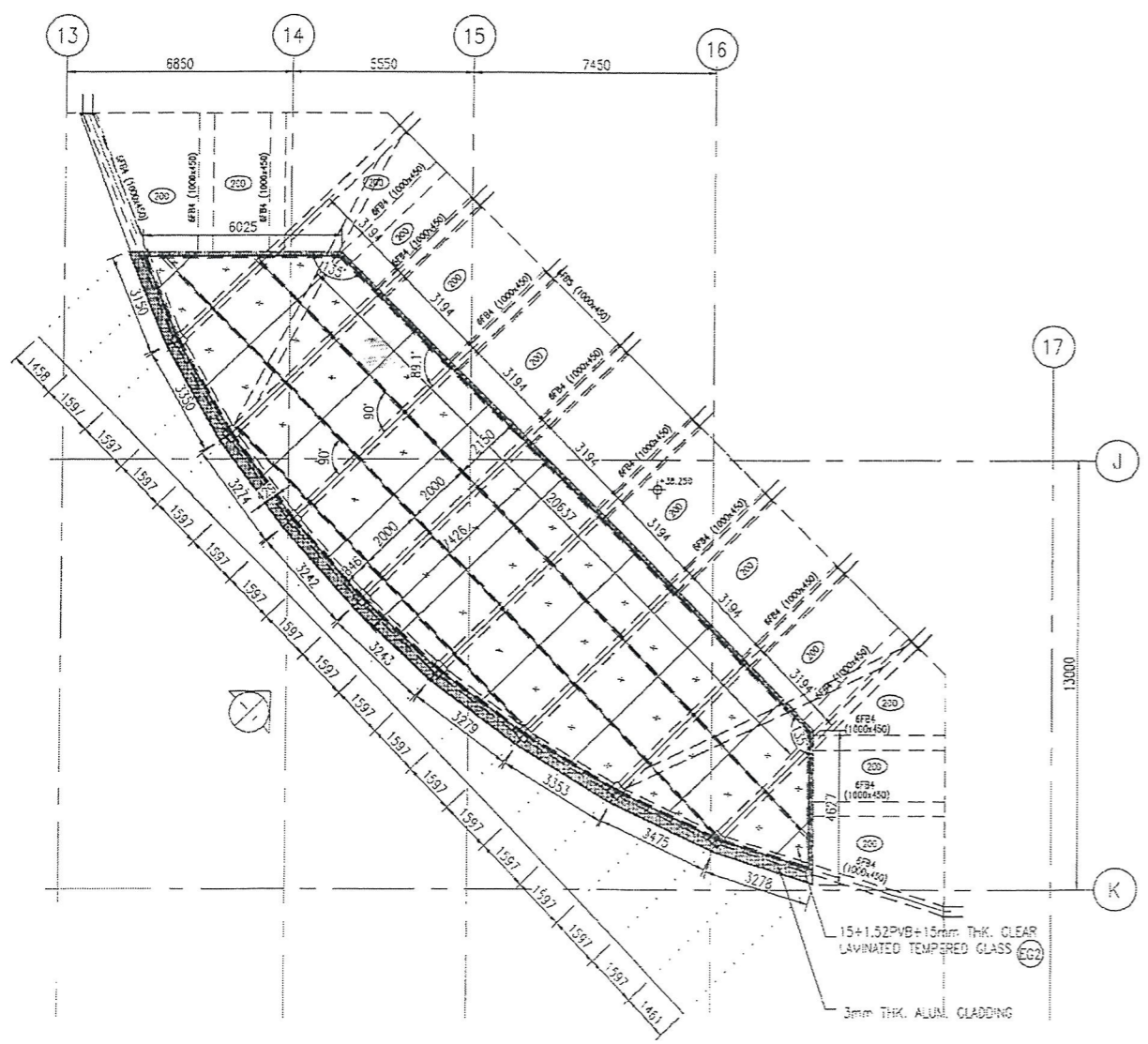

1 LAYOUT PLAN OF SKYLIGHT

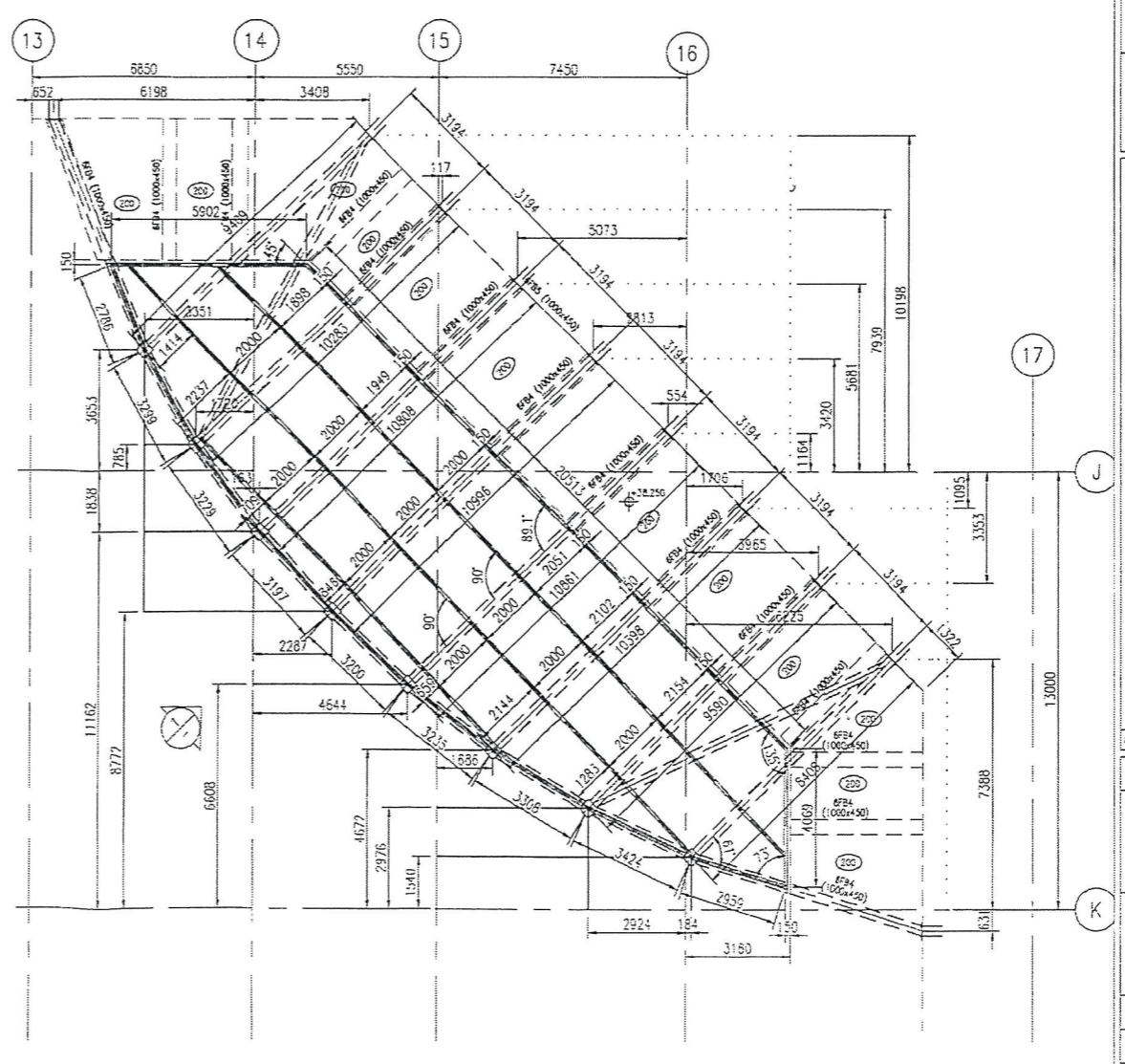

2 STEEL FRAME PLAN OF SKYLIGHT

NOTE:
 1. ALL DIMENSIONS ARE IN mm.
 2. ALL ELEVATIONS ARE VIEWED FROM OUTSIDE.
 3. ALL DIMENSIONS TO BE VERIFIED ON SITE BEFORE FABRICATION.
 LEGEND:
 X1 - DETAIL MARK NO.
 X001 - REFER SHEET NO.
 1. F.F.L. -- FINISHED FLOOR LEVEL
 2. S.F.L. -- STRUCTURAL FLOOR LEVEL
 3. R -- REVERSED DETAIL

NO.	DATE	REVISED	BY
JOB NO. : J-837			
PROJECT : URA KWUN TONG TOWN CENTRE REDEVELOPMENT (AREA 2 & 3) AT NKIL 6514, KWUN TONG, KWLOON			
TITLE : ELEVATION & PLAN OF SKYLIGHT (6/F)			
DATE : 27-08-2018		SCALE : 1:100 (A1)	
DRAWN BY : ASING		CHECKED BY :	
美特鋁質有限公司 MIDI ALUMINIUM FABRICATOR LTD. Units 6-8, Sunray Industrial Centre, 1/F 610 Cho Kwo Ling Road, Kowloon Tel: 23489211-4 Fax: (852) 2727666			
DWG NO. : J837-SK-1001		REV. :	