



工程指示 / 要求簡箋(E.I.)

工程指示編號：EI / 0439 / 19

修改版次：A

工程編號：J - 837

工程名稱：觀塘裕民坊

工程項目：Glass Cladding 防水片(大貨)(T1-T5)

收件人：生統 / 永林

發件人：Eric Liu

日期：24/04/2019

要求提供 / 確認 事項：

- |                                    |                                     |                               |
|------------------------------------|-------------------------------------|-------------------------------|
| <input type="checkbox"/> 初步鋁料 B.M. | <input type="checkbox"/> 加工拆圖，然後生產  | <input type="checkbox"/> 尺寸表  |
| <input type="checkbox"/> 正式鋁料 B.M. | <input type="checkbox"/> 技術上資料 / 指示 | <input type="checkbox"/> 報價   |
| <input type="checkbox"/> 配件 B.M.   | <input type="checkbox"/> 樣辦或貨品說明書   | <input type="checkbox"/> 分判合約 |
| <input type="checkbox"/> 其他：_____  |                                     |                               |

內容：

請按加工圖生產 Glass Cladding 防水片(大貨)(T1-T5) 送地盤安裝

A 版: 修改使用位置標示，分清楚座數及單位

1) EI0130 已出 7-9/F 數量

2) EI0156 已出部份泥水位置防水片，大貨數量會減少

3) EI0405 已出 1/5005 改款防水片

4) FS-001 及 FS-004 請按附頁 GC-NF01 加工圖加工(3/5003 改款防水片)

4) 包裝分座，每 5 層一批，分批出貨

謝謝！

(A版已改好加工圖)  
請按FS-001及FS-004  
加工

請在 2019/ 04 / 30 前完成上列要求。

附： 30 頁加工圖，~~7 頁位置圖~~ 7 頁位置圖

以上項目為：

- 原合約工程包                       原合約工程加 / 減賬                       新工程報價

原因：-

分發東莞各部門：

- ( ) 生產技術總監  連附件    ( ) 技術部  連附件 永林    ( ) 生產部     連附件    ( ) 機械設計部  連附件  
 ( ) 採購部     連附件    ( ) 生產統籌部  連附件 梅  
 ( ) 質檢部     連附件    ( ) 會計部     連附件    ( ) 報關組     連附件    ( ) 其他 楊榮輝  連附件

分發香港各部門：

- ( ) 行政部  連附件    ( ) 會計部  連附件    ( ) 統籌部  連附件    ( ) 工程部地盤科文  連附件 文  
 ( ) 採購部  連附件    ( ) QS 部  連附件    ( ) 維修部  連附件    ( ) 其他 \_\_\_\_\_  連附件

傳遞編號：

HK 0979/19

發件人簽署：

項目經理簽署：



美特铝质有限公司  
MIDI Aluminium Fabricator Ltd.

工程号 J-837 地盘 观塘裕民坊

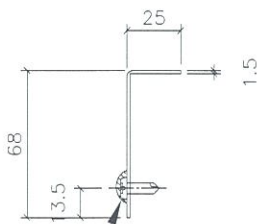
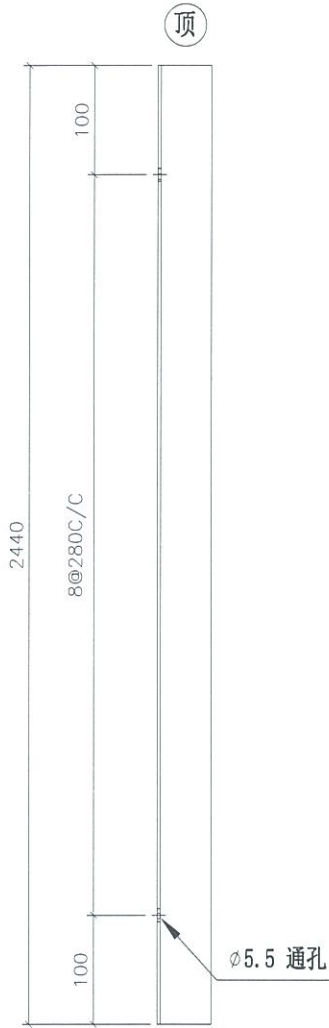

M5. 5\*25圆头自攻自钻螺丝

物料编号	层数	总数	使用位置	楼层	备注
FS-001	1	1	T1-A	06F	
FS-001	1	1	T1-H	06F	
FS-001	1	1	T2-B	06F	
FS-001	1	1	T3-B	06F	
FS-001	1	1	T5-A	06F	
FS-001	1	1	T5-M	06F	
FS-001	14	18	T1-A	10~26F	
FS-001	14	18	T1-H	10~26F	
FS-001	14	18	T2-B	10~26F	
FS-001	14	18	T3-B	10~26F	
FS-001	14	18	T5-A	10~26F	
FS-001	14	18	T5-M	10~26F	
FS-001	1	1	T1-A	27F	
FS-001	1	1	T1-H	27F	
FS-001	1	1	T2-B	27F	
FS-001	1	1	T3-B	27F	
FS-001	1	1	T5-A	27F	
FS-001	1	1	T5-M	27F	
FS-001	1	1	T1-A	28F	
FS-001	1	1	T1-H	28F	
FS-001	1	1	T2-B	28F	
FS-001	1	1	T3-B	28F	
FS-001	1	1	T5-A	28F	
FS-001	1	1	T5-M	28F	
FS-001	19	26	T1-A	29~49F	
FS-001	19	26	T1-H	29~49F	
FS-001	19	26	T5-A	29~49F	
FS-001	19	26	T5-M	29~49F	
FS-001	21	28	T3-B	29~51F	
FS-001	23	31	T2-B	29~53F	
FS-001	1	1	T1-A	50F	
FS-001	1	1	T1-H	50F	
FS-001	1	1	T5-A	50F	
FS-001	1	1	T5-M	50F	
FS-001	1	2	T5-A	51F	
FS-001	1	2	T3-B	52F	
FS-001	1	1	T2-B	55F	

A

地盘安装

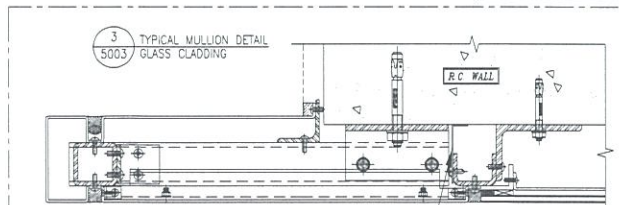

名称	防水片拆图	制图	JH	2019.3.27	修改	A	
材料	1.5mm 铝板	复核	DL	2019.3.28	日期	2019.4.15	
颜色	MILL A	批准			图号	FS-001	



美特铝质有限公司  
MIDI Aluminium Fabricator Ltd.

工程号 J-837 地盘 观塘裕民坊

物料编号	层数	总数	使用位置	楼层	备注
FS-002	1	1	T1-H	06F	
FS-002	1	1	T2-B	06F	
FS-002	1	1	T3-B	06F	
FS-002	14	18	T1-H	10~26F	
FS-002	14	18	T2-B	10~26F	
FS-002	14	18	T3-B	10~26F	
FS-002	1	1	T1-H	27F	
FS-002	1	1	T2-B	27F	
FS-002	1	1	T3-B	27F	
FS-002	1	1	T1-H	28F	
FS-002	1	1	T2-B	28F	
FS-002	1	1	T3-B	28F	
FS-002	19	26	T1-H	29~49F	
FS-002	21	28	T3-B	29~51F	
FS-002	23	31	T2-B	29~53F	
FS-002	1	1	T1-H	50F	
FS-002	1	2	T3-B	52F	
FS-002	1	1	T2-B	55F	



A

地盘安装

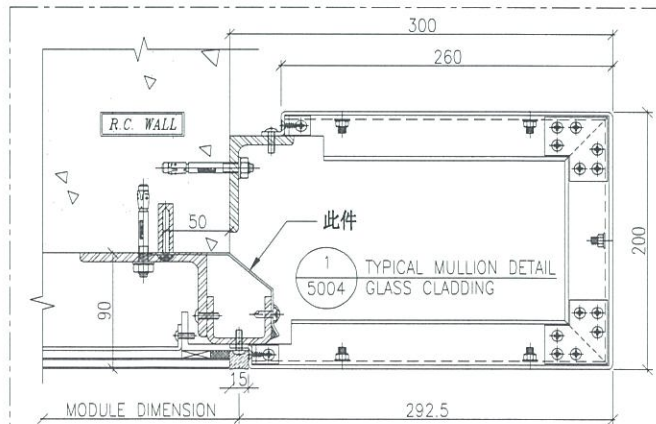
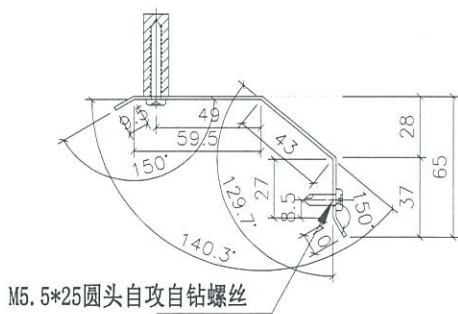

名称	防水片拆图	制图	JH	2019.3.27	修改	A	
材料	1.5mm 铝板	复核	DL	2019.3.28	日期	2019.4.15	
颜色	MILL A	批准			图号	FS-002	



美特铝质有限公司  
MIDI Aluminium Fabricator Ltd.

工程号 J-837 地盘 观塘裕民坊

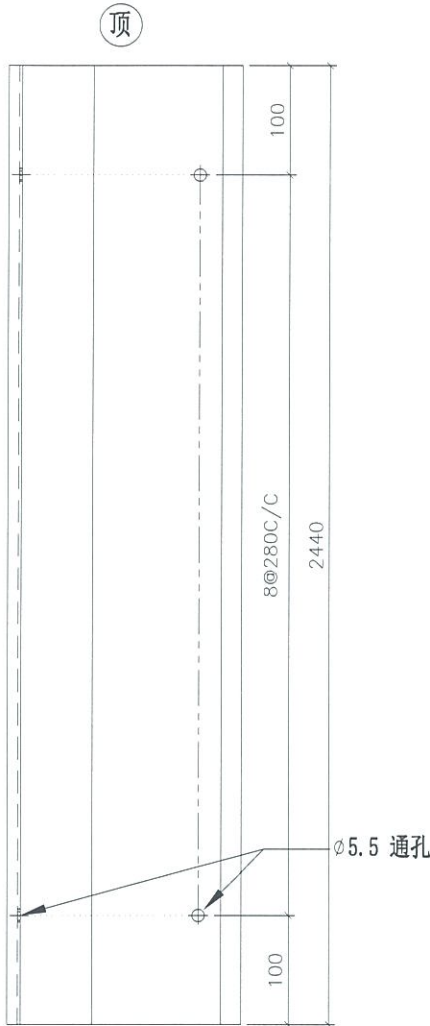

物料编号	层数	总数	使用位置	楼层	备注
FS-003	1	1	T1-B	06F	
FS-003	1	1	T1-G	06F	
FS-003	1	1	T2-A	06F	
FS-003	1	1	T3-A	06F	
FS-003	14	18	T1-B	10~26F	
FS-003	14	18	T1-G	10~26F	
FS-003	14	18	T2-A	10~26F	
FS-003	14	18	T3-A	10~26F	
FS-003	1	1	T1-B	27F	
FS-003	1	1	T1-G	27F	
FS-003	1	1	T2-A	27F	
FS-003	1	1	T3-A	27F	
FS-003	1	1	T1-B	28F	
FS-003	1	1	T1-G	28F	
FS-003	1	1	T2-A	28F	
FS-003	1	1	T3-A	28F	
FS-003	19	26	T1-B	29~49F	
FS-003	19	26	T1-G	29~49F	
FS-003	21	28	T3-A	29~51F	
FS-003	23	31	T2-A	29~53F	
FS-003	1	1	T1-B	50F	
FS-003	1	1	T1-G	50F	
FS-003	1	2	T3-A	52F	
FS-003	1	1	T2-A	55F	

A

地盘安装

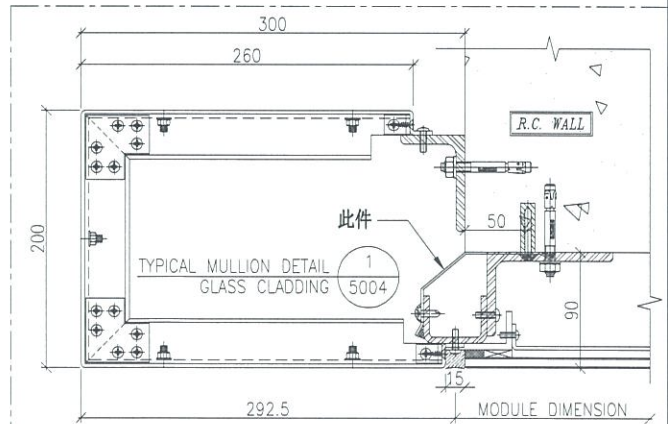
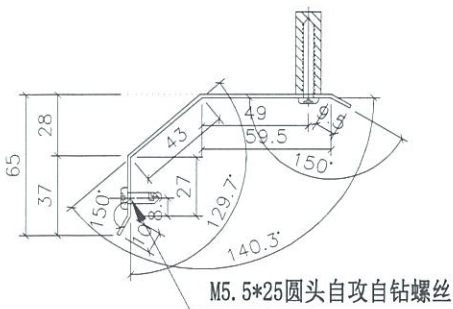

名称	防水片拆图	制图	JH	2019.3.27	修改	A	
材料	1.5mm 铝板	复核	DL	2019.3.28	日期	2019.4.15	
颜色	MILL A	批准			图号	FS-003	



美特铝质有限公司  
MIDI Aluminium Fabricator Ltd.

工程号 J-837 地盘 观塘裕民坊

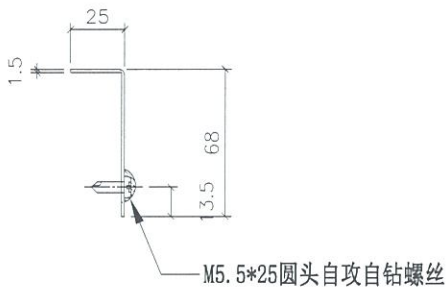
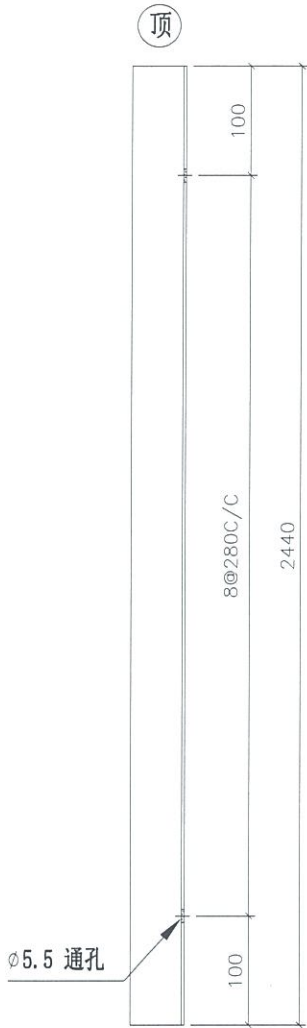

物料编号	层数	总数	使用位置	楼层	备注
FS-004	1	1	T1-B	06F	
FS-004	1	1	T1-E	06F	
FS-004	1	1	T1-G	06F	
FS-004	1	1	T2-A	06F	
FS-004	1	1	T2-M	06F	
FS-004	1	1	T3-A	06F	
FS-004	1	1	T3-F	06F	
FS-004	1	1	T5-L	06F	
FS-004	14	18	T1-B	10~26F	
FS-004	14	18	T1-E	10~26F	
FS-004	14	18	T1-G	10~26F	
FS-004	14	18	T2-A	10~26F	
FS-004	14	18	T2-M	10~26F	
FS-004	14	18	T3-A	10~26F	
FS-004	14	18	T3-F	10~26F	
FS-004	14	18	T5-L	10~26F	
FS-004	1	1	T1-B	27F	
FS-004	1	1	T1-E	27F	
FS-004	1	1	T1-G	27F	
FS-004	1	1	T2-A	27F	
FS-004	1	1	T2-M	27F	
FS-004	1	1	T3-A	27F	
FS-004	1	1	T3-F	27F	
FS-004	1	1	T5-L	27F	
FS-004	1	1	T1-B	28F	
FS-004	1	1	T1-E	28F	
FS-004	1	1	T1-G	28F	
FS-004	1	1	T2-A	28F	
FS-004	1	1	T2-M	28F	
FS-004	1	1	T3-A	28F	

A

地盘安装

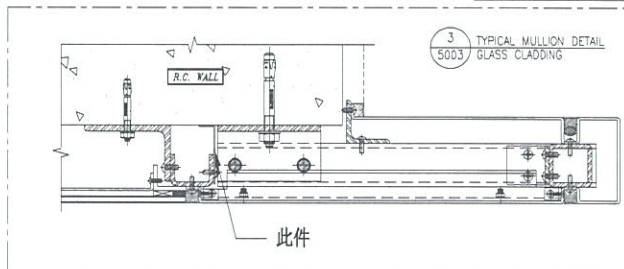

名称	防水片拆图	制图	JH	2019.3.27	修改	A	
材料	1.5mm 铝板	复核	DL	2019.3.28	日期	2019.4.15	
颜色	MILL	批准			图号	FS-004 (1 of 2)	



美特铝质有限公司  
MIDI Aluminium Fabricator Ltd.

美特铝质有限公司 MIDI Aluminium Fabricator Ltd.				物料编号	层数	总数	使用位置	楼层	备注
工程号	J-837	地盘	观塘裕民坊	FS-004	1	1	T3-F	28F	
				FS-004	1	1	T5-L	28F	
				FS-004	19	26	T1-B	29~49F	
				FS-004	19	26	T1-E	29~49F	
				FS-004	19	26	T1-G	29~49F	
				FS-004	19	26	T5-L	29~49F	
				FS-004	21	28	T3-A	29~51F	
				FS-004	21	28	T3-F	29~51F	
				FS-004	23	31	T2-A	29~53F	
				FS-004	23	31	T2-M	29~53F	
				FS-004	1	1	T1-B	50F	
				FS-004	1	1	T1-E	50F	
				FS-004	1	1	T1-G	50F	
				FS-004	1	1	T5-L	50F	
				FS-004	1	2	T3-A	52F	
				FS-004	1	2	T3-F	52F	
				FS-004	1	1	T2-A	55F	
				FS-004	1	1	T2-M	55F	
									A

名称	防水片拆图 (数据表)	制图	JH	2019.3.27	修改	A	
材料	1.5mm 铝板	复核	DL	2019.3.28	日期	2019.4.15	
颜色	MILL	批准			图号	FS-004 (2 of 2)	



美特铝质有限公司  
MIDI Aluminium Fabricator Ltd.

工程号 J-837 地盘 观塘裕民坊

物料编号	层数	总数	使用位置	楼层	备注
FS-005	1	1	T1-E	06F	
FS-005	145	187	T1-E	10-26F	21-26
FS-005	1	1	T1-E	27F	
FS-005	1	1	T1-E	28F	
FS-005	19	26	T1-E	29~49F	
FS-005	1	1	T1-E	50F	

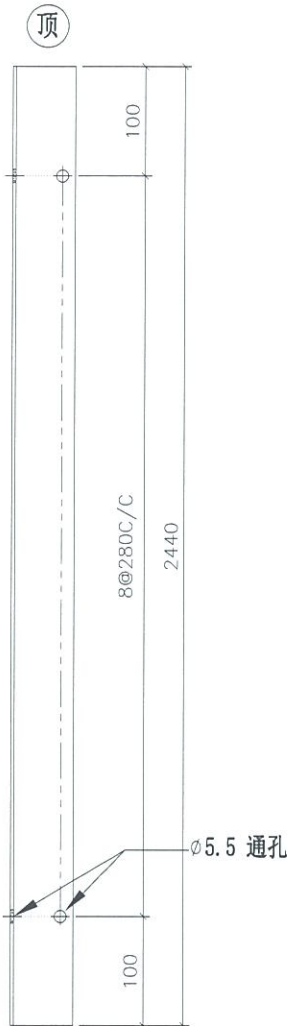

地盘安装

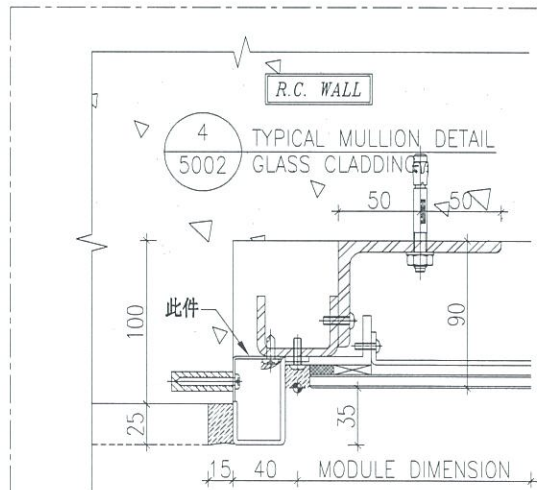
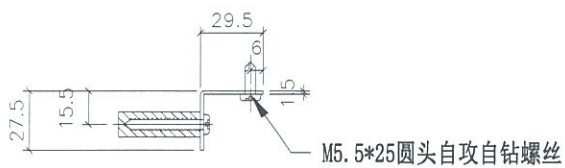

名称	防水片拆图	制图	JH	2019.3.27	修改	A	
材料	1.5mm 铝板	复核	DL	2019.3.28	日期	2019.4.15	
颜色	MILL	批准			图号	FS-005	



美特铝质有限公司  
MIDI Aluminium Fabricator Ltd.

工程号 J-837 地盘 观塘裕民坊

物料编号	层数	总数	使用位置	楼层	备注
FS-006	1	1	T1-E	06F	
FS-006	14	14	T1-E	10~26F	
FS-006	1	1	T1-E	28F	
FS-006	19	19	T1-E	29~49F	
FS-006	1	1	T1-E	50F	
				A	

顶

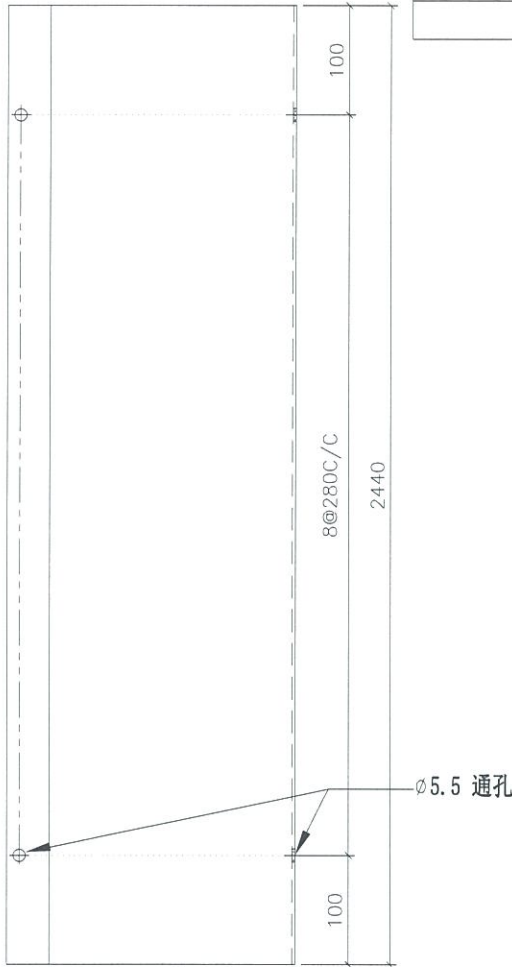

地盘安装

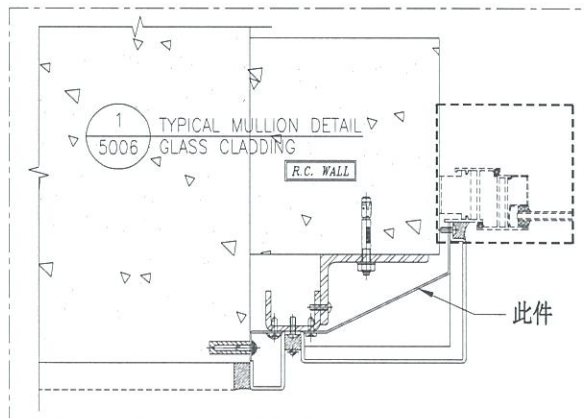
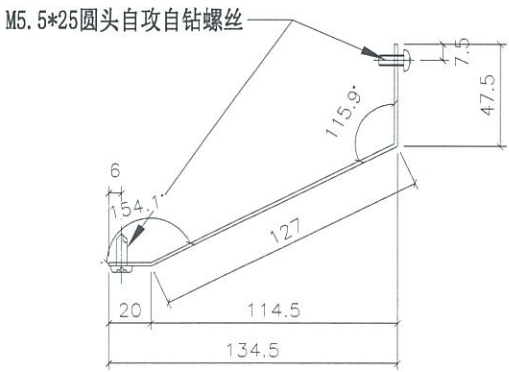

名称	防水片拆图	制图	JH	2019.3.27	修改	A	
材料	1.5mm 铝板	复核	DL	2019.3.28	日期	2019.4.15	
颜色	MILL <span style="border: 1px solid black; border-radius: 50%; padding: 2px;">A</span>	批准			图号	FS-006	



美特铝质有限公司  
MIDI Aluminium Fabricator Ltd.

工程号 J-837 地盘 观塘裕民坊

物料编号	层数	总数	使用位置	楼层	备注
FS-007	1	1	T1-E	06F	
FS-007	1	2	T2-M	06F	
FS-007	14	14	T1-E	10~26F	
FS-007	14	28	T2-M	10~26F	
FS-007	1	1	T1-E	28F	
FS-007	1	2	T2-M	28F	
FS-007	19	19	T1-E	29~49F	
FS-007	23	46	T2-M	29~53F	
FS-007	1	1	T1-E	50F	
FS-007	1	2	T2-M	55F	

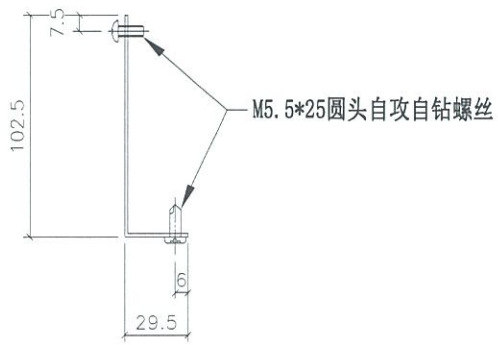
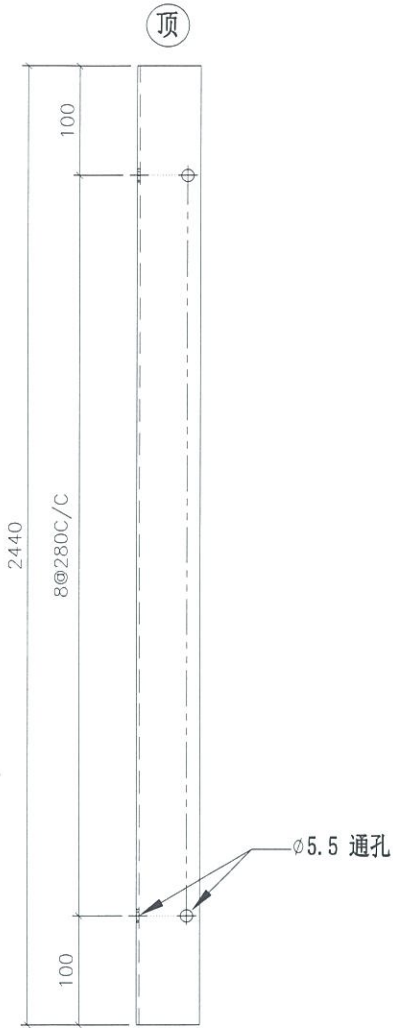

地盘安装

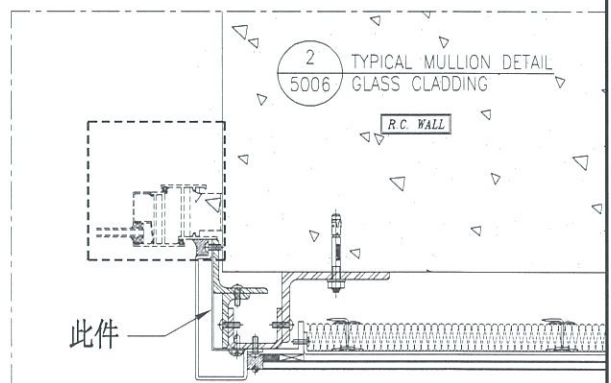

名称	防水片拆图	制图	JH	2019.3.27	修改	A	
材料	1.5mm 铝板	复核	DL	2019.3.28	日期	2019.4.15	
颜色	MILL A	批准			图号	FS-007	



美特铝质有限公司  
MIDI Aluminium Fabricator Ltd.

工程号 J-837 地盘 观塘裕民坊

物料编号	层数	总数	使用位置	楼层	备注
FS-008	1	2	T1-E	06F	
FS-008	1	1	T5-H	06F	
FS-008	14	36	T1-E	10~26F	
FS-008	14	18	T5-H	10~26F	
FS-008	1	2	T1-E	27F	
FS-008	1	1	T5-H	27F	
FS-008	1	2	T1-E	28F	
FS-008	1	1	T5-H	28F	
FS-008	19	52	T1-E	29~49F	
FS-008	19	26	T5-H	29~49F	
FS-008	1	2	T1-E	50F	
FS-008	1	1	T5-H	50F	
					△ A

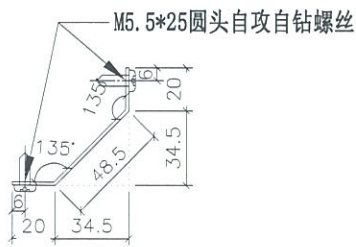
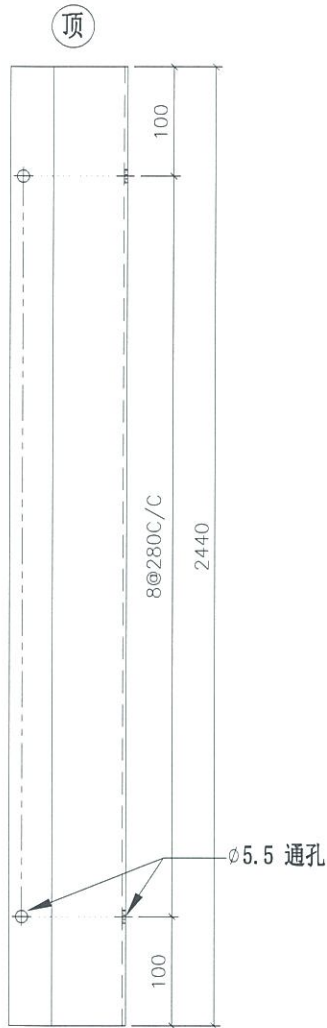

地盘安装

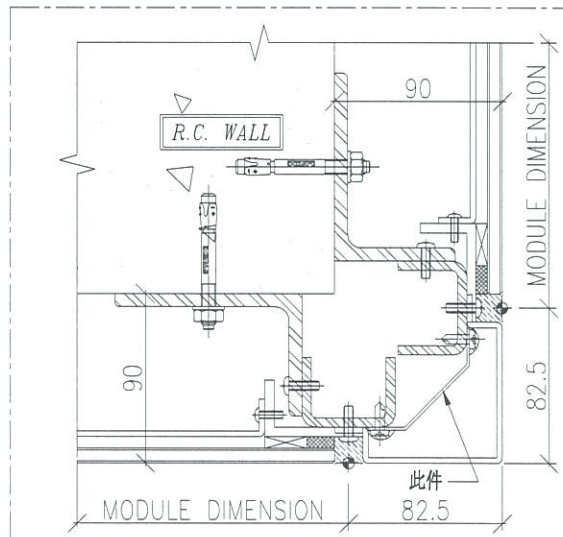

名称	防水片拆图	制图	JH	2019.3.27	修改	A	
材料	1.5mm 铝板	复核	DL	2019.3.28	日期	2019.4.15	
颜色	MILL △ A	批准			图号	FS-008	



美特铝质有限公司  
MIDI Aluminium Fabricator Ltd.

工程号 J-837 地盘 观塘裕民坊

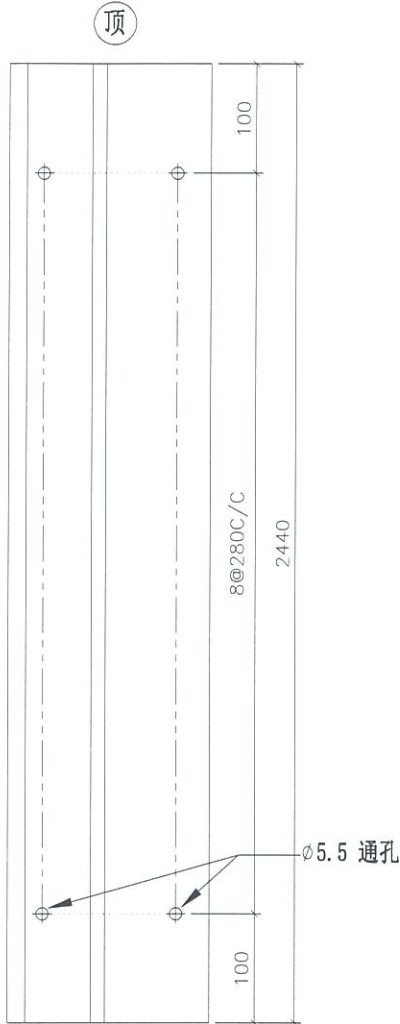

物料编号	层数	总数	使用位置	楼层	备注
FS-009	1	2	T1-A	06F	
FS-009	1	1	T1-B	06F	
FS-009	1	1	T1-G	06F	
FS-009	1	1	T1-H	06F	
FS-009	1	1	T2-A	06F	
FS-009	1	1	T2-B	06F	
FS-009	1	1	T2-H	06F	
FS-009	1	1	T2-M	06F	
FS-009	1	1	T3-A	06F	
FS-009	1	1	T3-B	06F	
FS-009	1	1	T3-F	06F	
FS-009	1	2	T5-A	06F	
FS-009	1	1	T5-H	06F	
FS-009	1	1	T5-L	06F	
FS-009	1	1	T5-M	06F	
FS-009	14	36	T1-A	10~26F	
FS-009	14	18	T1-B	10~26F	
FS-009	14	18	T1-G	10~26F	
FS-009	14	18	T1-H	10~26F	
FS-009	14	18	T2-A	10~26F	
FS-009	14	18	T2-B	10~26F	
FS-009	14	18	T2-H	10~26F	
FS-009	14	18	T2-M	10~26F	
FS-009	14	18	T3-A	10~26F	
FS-009	14	18	T3-B	10~26F	
FS-009	14	18	T3-F	10~26F	
FS-009	14	36	T5-A	10~26F	

A

地盘安装

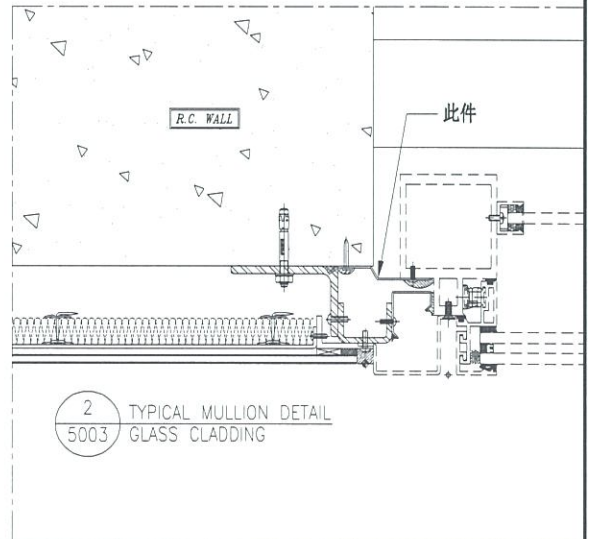
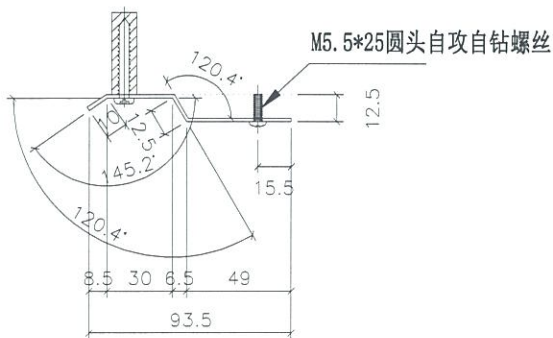

名称	防水片拆图	制图	JH	2019.3.27	修改	A	
材料	1.5mm 铝板	复核	DL	2019.3.28	日期	2019.4.15	
颜色	MILL	批准			图号	FS-009 (1 of 2)	





美特铝质有限公司  
MIDI Aluminium Fabricator Ltd.

工程号 J-837 地盘 观塘裕民坊

物料编号	层数	总数	使用位置	楼层	备注
FS-015	1	1	T1-E	06F	
FS-015	14	14	T1-E	10~26F	
FS-015	1	1	T1-E	28F	
FS-015	19	19	T1-E	29~49F	
FS-015	1	1	T1-E	50F	

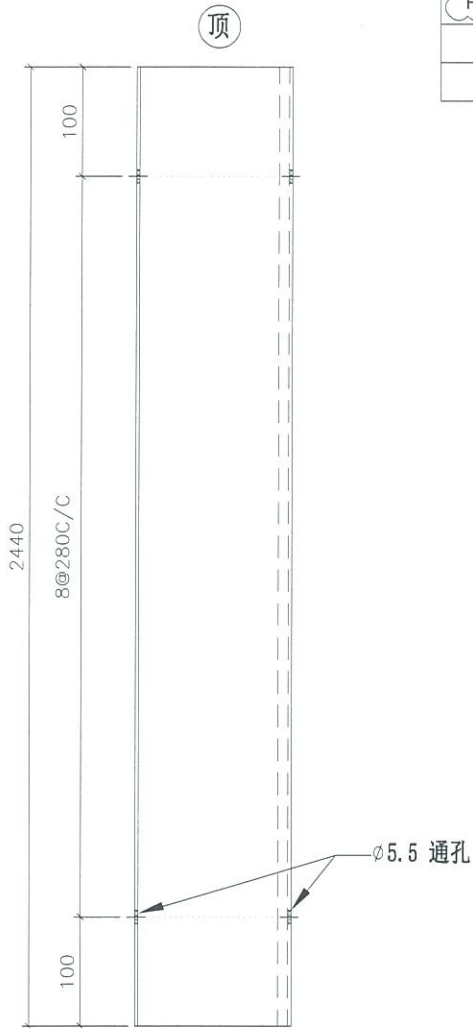

地盘安装

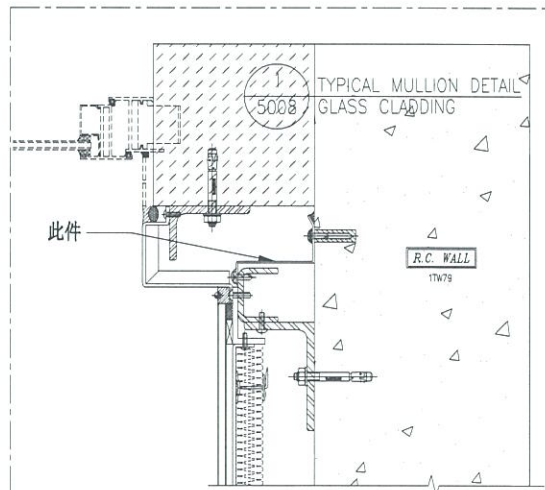
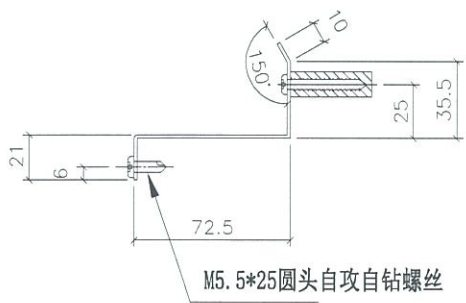

名称	防水片拆图	制图	JH	2019.3.27	修改	A	
材料	1.5mm 铝板	复核	DL	2019.3.28	日期	2019.4.15	
颜色	MILL	批准			图号	FS-015	



美特铝质有限公司  
MIDI Aluminium Fabricator Ltd.

物料编号	层数	总数	使用位置	楼层	备注
FS-016	1	1	T2-J	06F	
				A	

工程号 J-837 地盘 观塘裕民坊

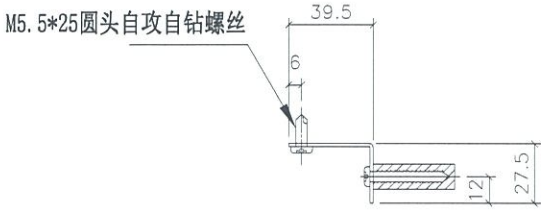
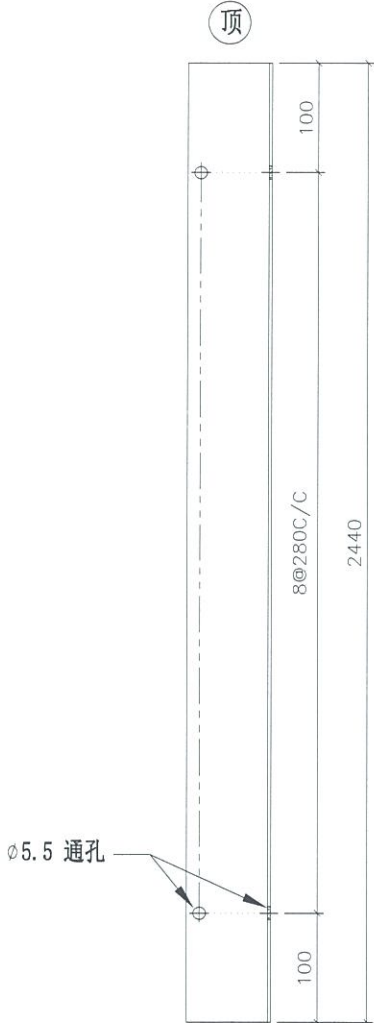

地盘安装

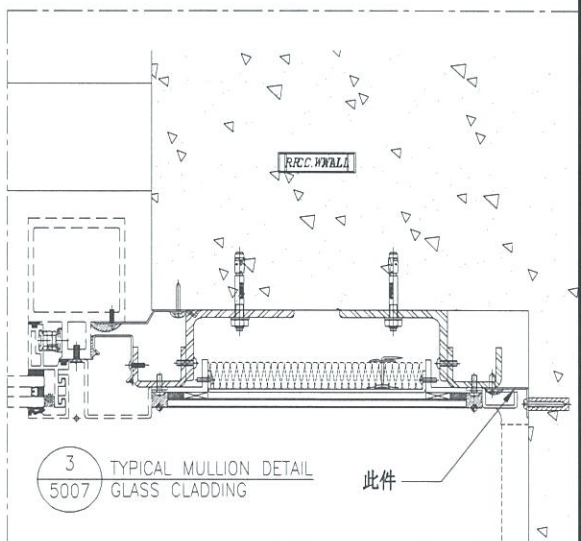

名称	防水片拆图	制图	JH	2019.3.27	修改	A	
材料	1.5mm 铝板	复核	DL	2019.3.28	日期	2019.4.15	
颜色	MILL A	批准			图号	FS-016	



美特铝质有限公司  
MIDI Aluminium Fabricator Ltd.

工程号 J-837 地盘 观塘裕民坊

物料编号	层数	总数	使用位置	楼层	备注
FS-017	1	1	T2-H	06F	
FS-017	1	1	T2-J	06F	
FS-017	1	1	T5-A	06F	
FS-017	1	1	T5-H	06F	
FS-017	14	18	T2-H	10~26F	
FS-017	3	5	T2-J (样板层)	07~09F	
FS-017	14	18	T2-J	10~26F	
FS-017	14	18	T5-A	10~26F	
FS-017	14	18	T5-H	10~26F	
FS-017	1	1	T2-H	27F	
FS-017	1	1	T2-J	27F	
FS-017	1	1	T5-A	27F	
FS-017	1	1	T5-H	27F	
FS-017	1	1	T2-H	28F	
FS-017	1	1	T2-J	28F	
FS-017	1	1	T5-A	28F	
FS-017	1	1	T5-H	28F	
FS-017	19	26	T5-A	29~49F	
FS-017	19	26	T5-H	29~49F	
FS-017	23	31	T2-H	29~53F	
FS-017	23	31	T2-J	29~53F	
FS-017	1	1	T5-A	50F	
FS-017	1	1	T5-H	50F	
FS-017	1	2	T5-A	51F	
FS-017	1	1	T2-H	55F	
FS-017	1	1	T2-J	55F	

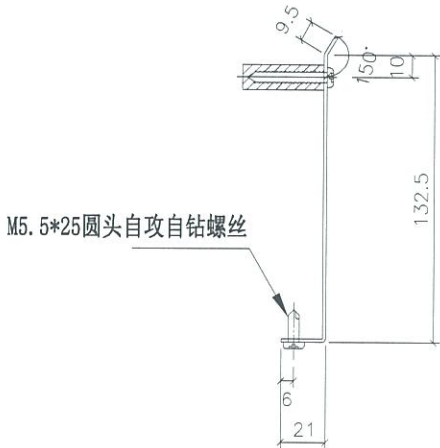
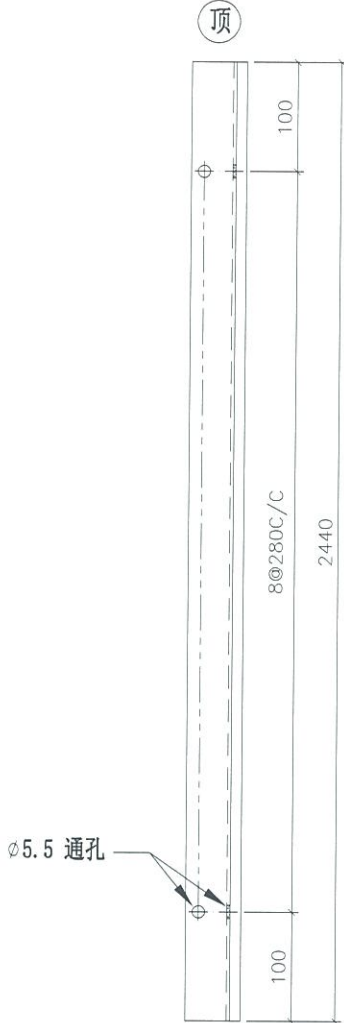

地盘安装

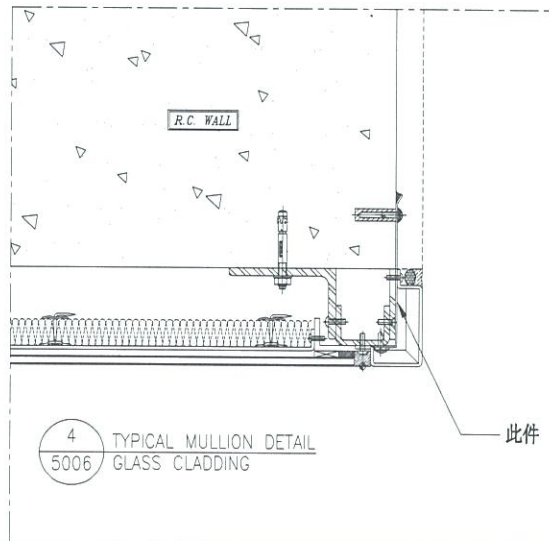

名称	防水片拆图	制图	JH	2019.3.27	修改	A	
材料	1.5mm 铝板	复核	DL	2019.3.28	日期	2019.4.15	
颜色	MILL	批准			图号	FS-017	



美特铝质有限公司  
MIDI Aluminium Fabricator Ltd.

工程号 J-837 地盘 观塘裕民坊

物料编号	层数	总数	使用位置	楼层	备注
FS-018	1	1	T2-H	06F	
FS-018	14	18	T2-H	10~26F	
FS-018	1	1	T2-H	27F	
FS-018	1	1	T2-H	28F	
FS-018	23	31	T2-H	29~53F	
FS-018	1	1	T2-H	55F	

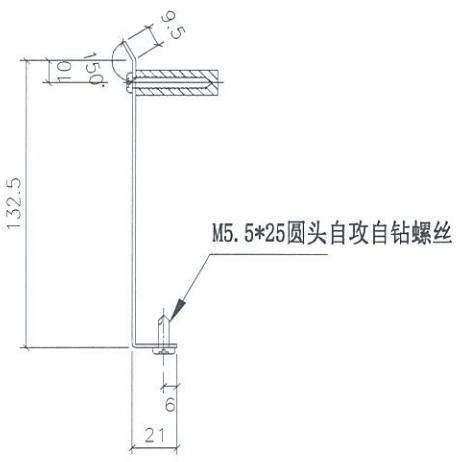
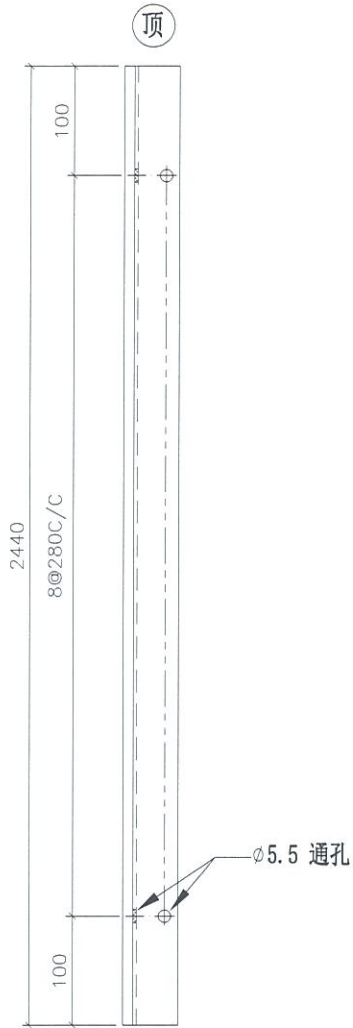

地盘安装

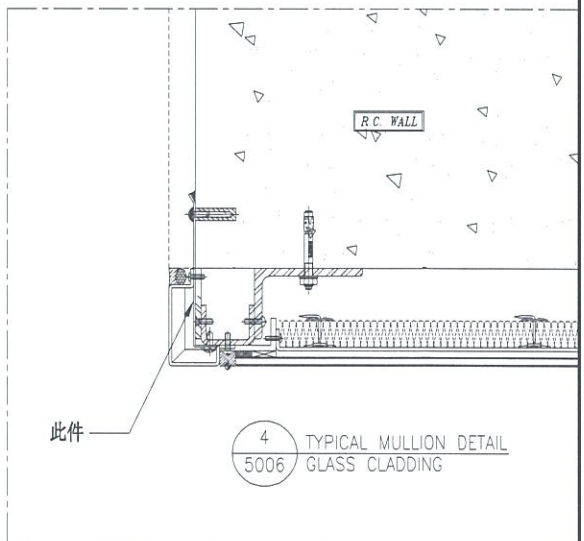

名称	防水片拆图	制图	JH	2019.3.27	修改	A	
材料	1.5mm 铝板	复核	DL	2019.3.28	日期	2019.4.15	
颜色	MILL <span style="border: 1px solid black; border-radius: 50%; padding: 2px;">A</span>	批准			图号	FS-018	



美特铝质有限公司  
MIDI Aluminium Fabricator Ltd.

工程号 J-837 地盘 观塘裕民坊

物料编号	层数	总数	使用位置	楼层	备注
FS-019	1	1	T2-M	06F	
FS-019	14	18	T2-M	10~26F	
FS-019	1	1	T2-M	27F	
FS-019	1	1	T2-M	28F	
FS-019	23	31	T2-M	29~53F	
FS-019	1	1	T2-M	55F	



待定

地盘安装

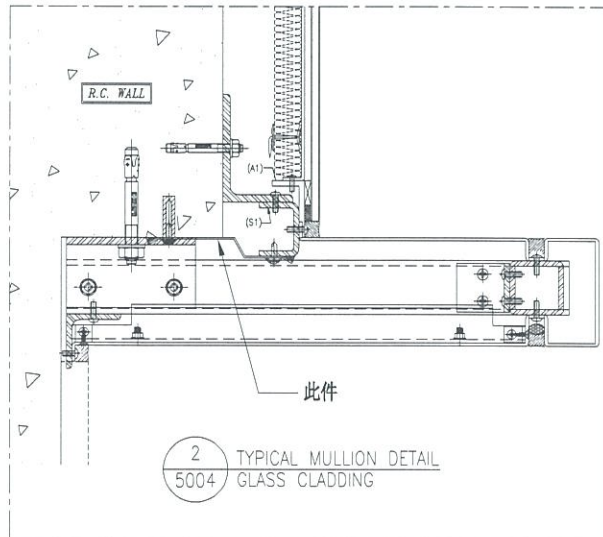
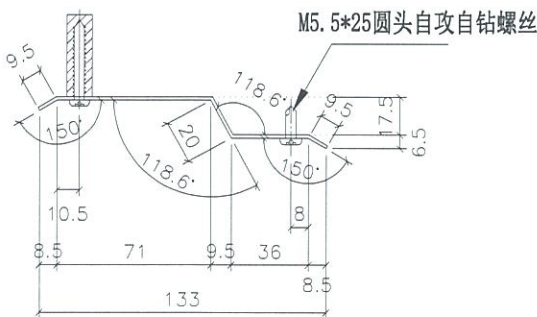

名称	防水片拆图	制图	JH	2019.3.27	修改	A	
材料	1.5mm 铝板	复核	DL	2019.3.28	日期	2019.4.15	
颜色	MILL	批准			图号	FS-019	



美特铝质有限公司  
MIDI Aluminium Fabricator Ltd.

工程号 J-837 地盘 观塘裕民坊

物料编号	层数	总数	使用位置	楼层	备注
FS-020	1	1	T2-M	06F	
FS-020	14	14	T2-M	10~26F	
FS-020	1	1	T2-M	28F	
FS-020	23	23	T2-M	29~53F	
FS-020	1	1	T2-M	55F	

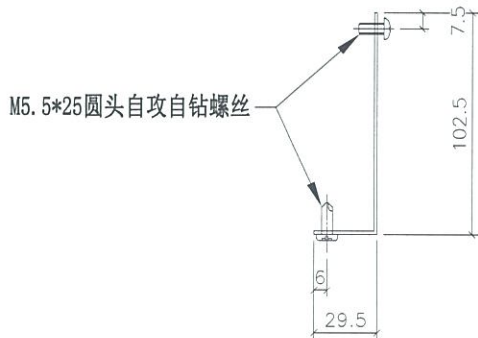
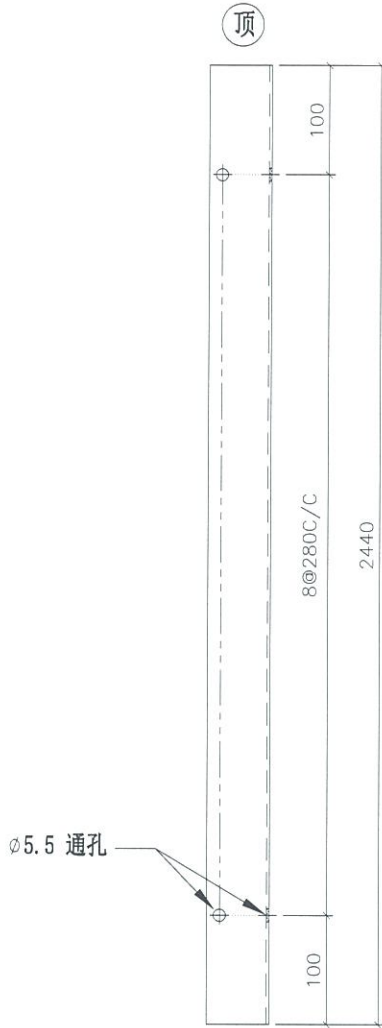

地盘安装

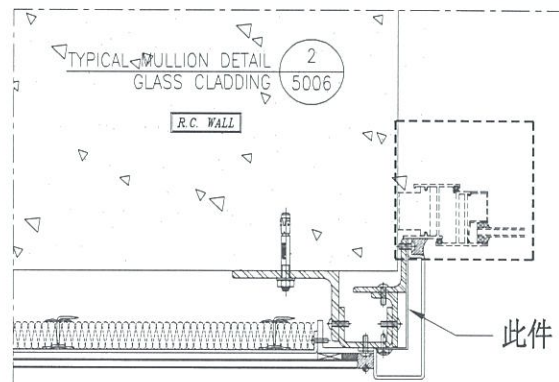

名称	防水片拆图	制图	JH	2019.3.27	修改	A		
材料	1.5mm 铝板	复核	DL	2019.3.28	日期	2019.4.15		
颜色	MILL	批准			图号	FS-020		



美特铝质有限公司  
MIDI Aluminium Fabricator Ltd.

工程号 J-837 地盘 观塘裕民坊

物料编号	层数	总数	使用位置	楼层	备注
FS-021	1	1	T3-F	06F	
FS-021	14	18	T3-F	10~26F	
FS-021	1	1	T3-F	27F	
FS-021	1	1	T3-F	28F	
FS-021	21	28	T3-F	29~51F	
FS-021	1	2	T3-F	52F	

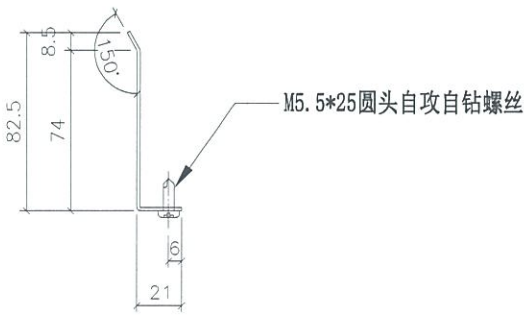
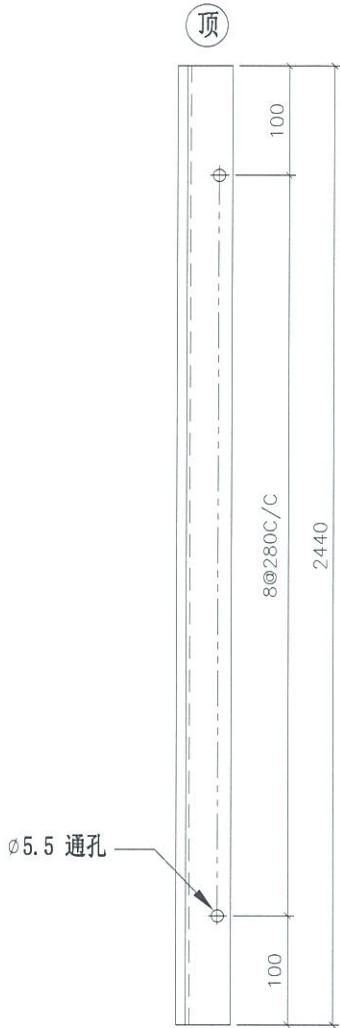

地盘安装

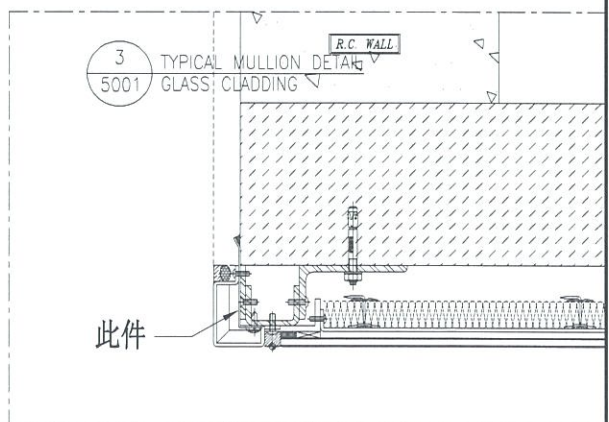

名称	防水片拆图	制图	JH	2019.3.27	修改	A	
材料	1.5mm 铝板	复核	DL	2019.3.28	日期	2019.4.15	
颜色	MILL <span style="border: 1px solid black; border-radius: 50%; padding: 2px;">A</span>	批准			图号	FS-021	



美特铝质有限公司  
MIDI Aluminium Fabricator Ltd.

工程号 J-837 地盘 观塘裕民坊

物料编号	层数	总数	使用位置	楼层	备注
FS-022	1	1	T3-F	06F	
FS-022	14	18	T3-F	10~26F	
FS-022	1	1	T3-F	27F	
FS-022	1	1	T3-F	28F	
FS-022	21	28	T3-F	29~51F	
FS-022	1	2	T3-F	52F	

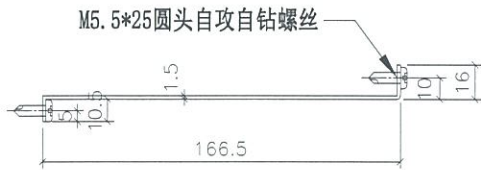
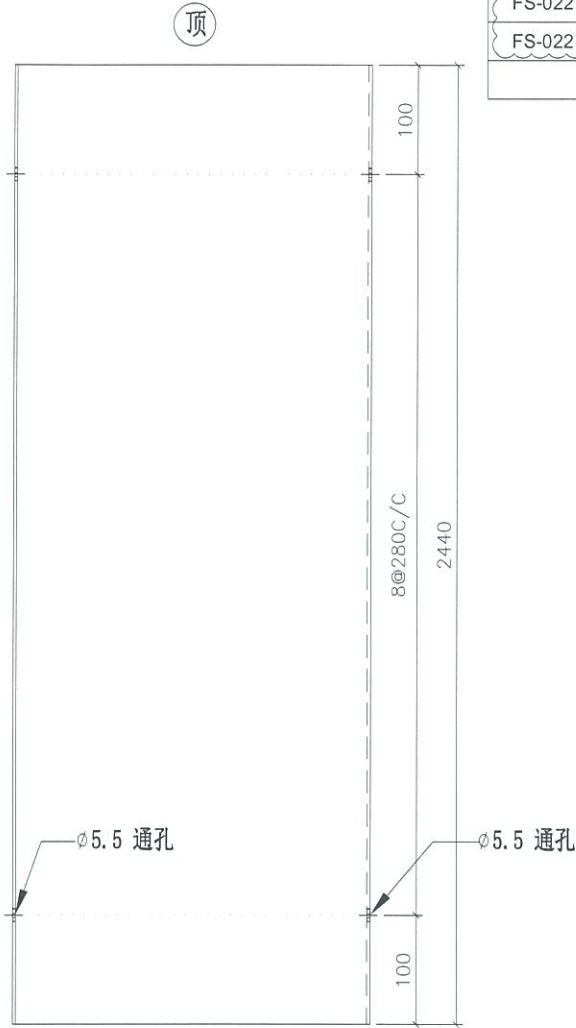

地盘安装

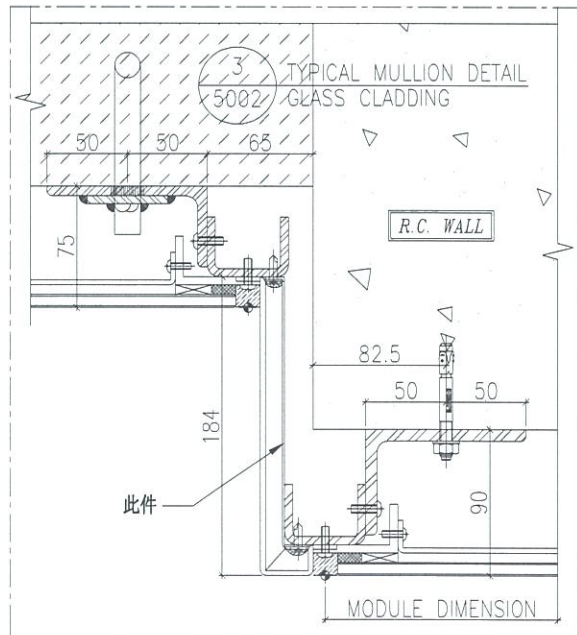

名称	防水片拆图	制图	JH	2019.3.27	修改	A	
材料	1.5mm 铝板	复核	DL	2019.3.28	日期	2019.4.15	
颜色	MILL	批准			图号	FS-022	



美特铝质有限公司  
MIDI Aluminium Fabricator Ltd.

工程号 J-837 地盘 观塘裕民坊

物料编号	层数	总数	使用位置	楼层	备注
FS-027	1	1	T5-H	06F	
FS-027	14	18	T5-H	10~26F	
FS-027	1	1	T5-H	27F	
FS-027	1	1	T5-H	28F	
FS-027	19	26	T5-H	29~49F	
FS-027	1	1	T5-H	50F	

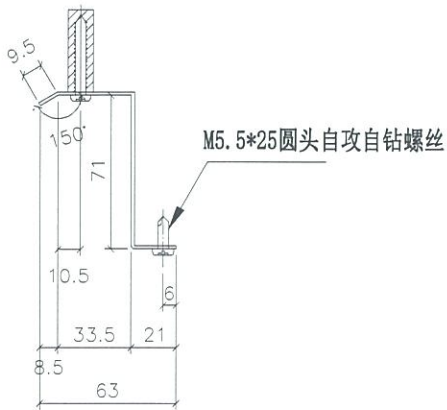
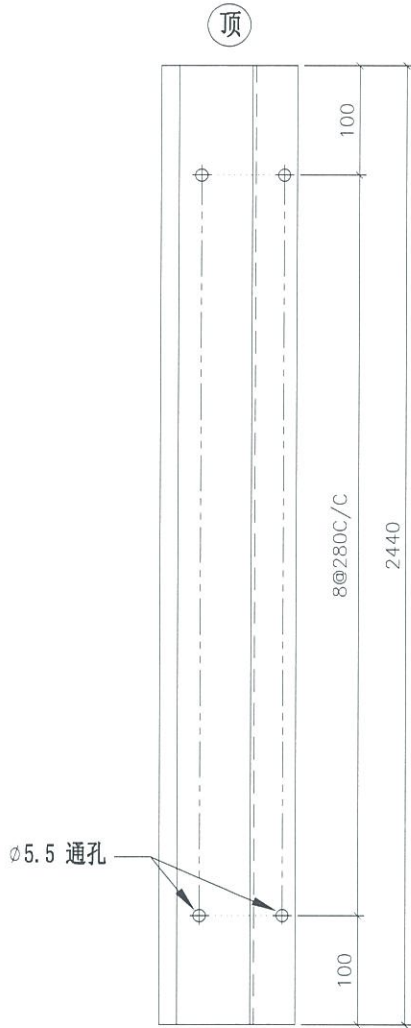

地盘安装

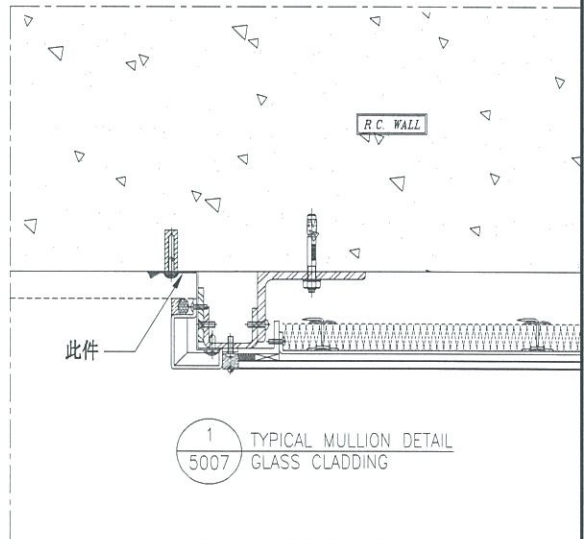

名称	防水片拆图	制图	JH	2019.3.27	修改	A	
材料	1.5mm 铝板	复核	DL	2019.3.28	日期	2019.4.15	
颜色	MILL	批准			图号	FS-027	



美特铝质有限公司  
MIDI Aluminium Fabricator Ltd.

工程号 J-837 地盘 观塘裕民坊

物料编号	层数	总数	使用位置	楼层	备注
FS-028	1	1	T5-H	06F	
FS-028	14	18	T5-H	10~26F	
FS-028	1	1	T5-H	27F	
FS-028	1	1	T5-H	28F	
FS-028	19	26	T5-H	29~49F	
FS-028	1	1	T5-H	50F	



待定

地盘安装

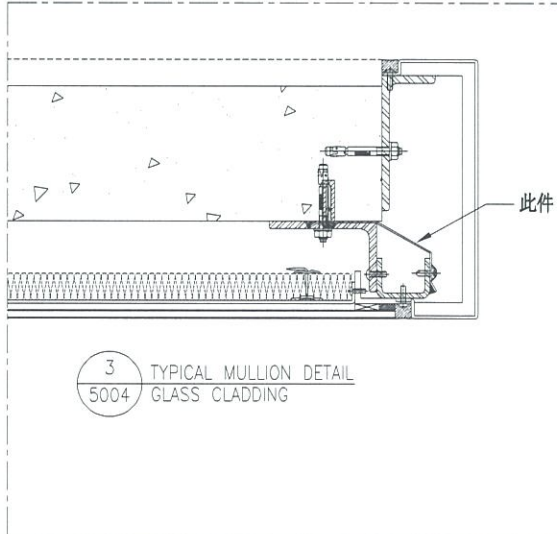
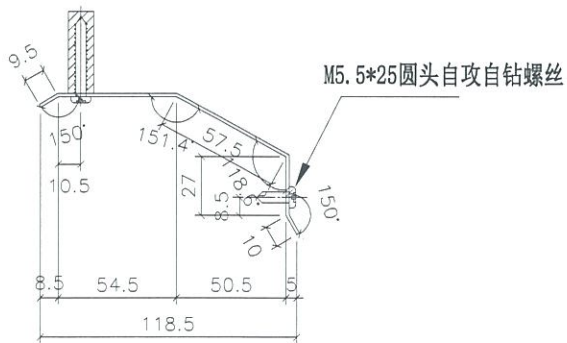

名称	防水片拆图	制图	JH	2019.3.27	修改	A	
材料	1.5mm 铝板	复核	DL	2019.3.28	日期	2019.4.15	
颜色	MILL	批准			图号	FS-028	



美特铝质有限公司  
MIDI Aluminium Fabricator Ltd.

工程号 J-837 地盘 观塘裕民坊

物料编号	层数	总数	使用位置	楼层	备注
FS-029	1	1	T5-H	06F	
FS-029	14	18	T5-H	10~26F	
FS-029	1	1	T5-H	27F	
FS-029	1	1	T5-H	28F	
FS-029	19	26	T5-H	29~49F	
FS-029	1	1	T5-H	50F	

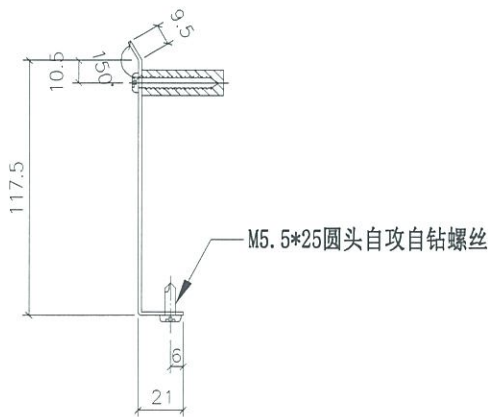
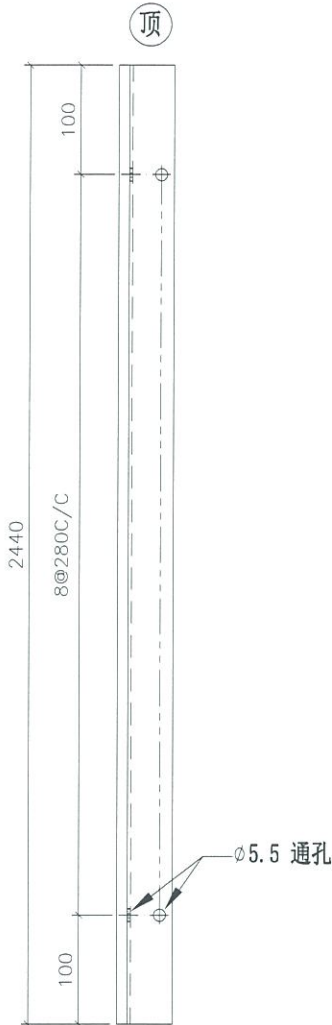

地盘安装

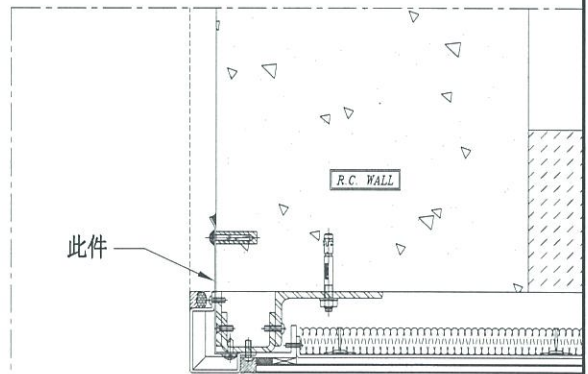

1 TYPICAL MULLION DETAIL  
5001 GLASS CLADDING

名称	防水片拆图	制图	JH	2019.3.27	修改	A	
材料	1.5mm 铝板	复核	DL	2019.3.28	日期	2019.4.15	
颜色	MILL A	批准			图号	FS-029	



美特铝质有限公司  
MIDI Aluminium Fabricator Ltd.

工程号 J-837 地盘 观塘裕民坊

物料编号	层数	总数	使用位置	楼层	备注
FS-030	1	1	T1-E	06F	
FS-030	1	2	T2-M	06F	
FS-030	14	14	T1-E	10~26F	
FS-030	14	28	T2-M	10~26F	
FS-030	1	1	T1-E	28F	
FS-030	1	2	T2-M	28F	
FS-030	19	19	T1-E	29~49F	
FS-030	23	46	T2-M	29~53F	
FS-030	1	1	T1-E	50F	
FS-030	1	2	T2-M	55F	
				A	

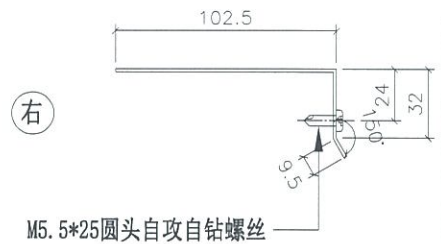

地盘安装

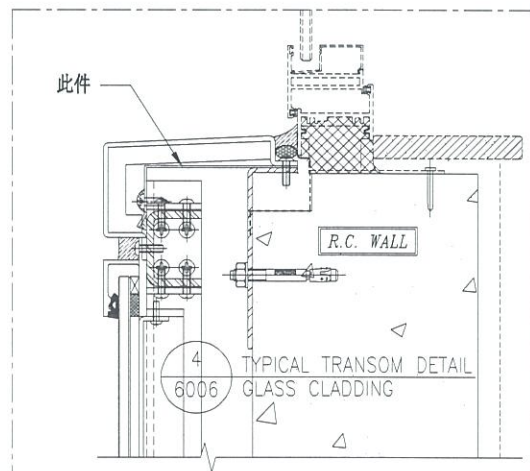

名称	防水片拆图	制图	JH	2019.3.27	修改	A	
材料	1.5mm 铝板	复核	DL	2019.3.28	日期	2019.4.15	
颜色	MILL A	批准			图号	FS-030	



美特铝质有限公司  
MIDI Aluminium Fabricator Ltd.

工程号 J-837 地盘 观塘裕民坊

物料编号	层数	总数	使用位置	楼层	备注
FS-031	1	1	T1-E	06F	
FS-031	14	14	T1-E	10~26F	
FS-031	1	1	T1-E	28F	
FS-031	19	19	T1-E	29~49F	
FS-031	1	1	T1-E	50F	
				A	

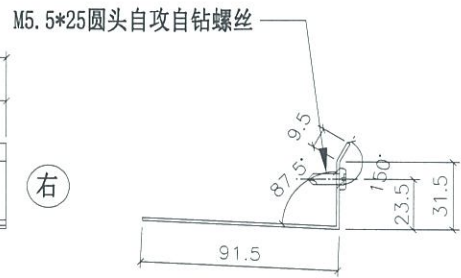

地盘安装

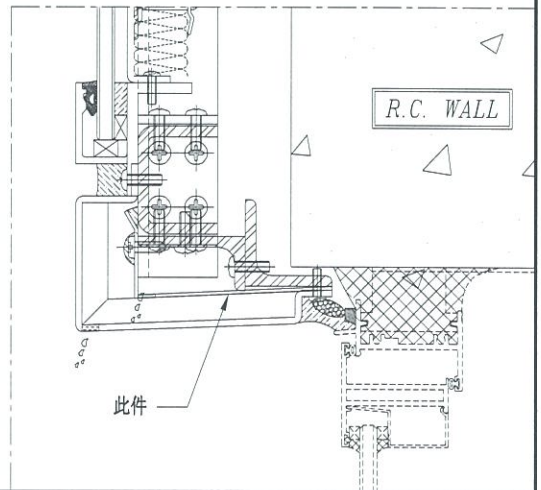

名称	防水片拆图	制图	JH	2019.3.27	修改	A		
材料	1.5mm 铝板	复核	DL	2019.3.28	日期	2019.4.15		
颜色	MILL A	批准			图号	FS-031		



美特铝质有限公司  
MIDI Aluminium Fabricator Ltd.

物料编号	层数	总数	使用位置	楼层	备注
FS-032	1	2	T1-A	06F	
FS-032	1	2	T1-B	06F	
FS-032	1	2	T1-G	06F	
FS-032	1	2	T1-H	06F	
FS-032	1	2	T2-A	06F	
FS-032	1	2	T2-B	06F	
FS-032	1	2	T2-H	06F	
FS-032	1	2	T2-M	06F	
FS-032	1	2	T3-A	06F	
FS-032	1	2	T3-B	06F	
FS-032	1	2	T3-F	06F	
FS-032	1	2	T5-A	06F	
FS-032	1	2	T5-H	06F	
FS-032	1	2	T5-L	06F	
FS-032	1	2	T5-M	06F	

工程号 J-837 地盘 观塘裕民坊

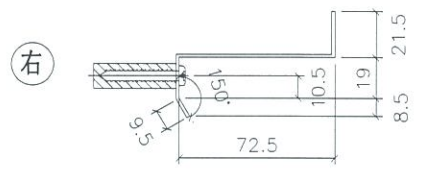

地盘安装

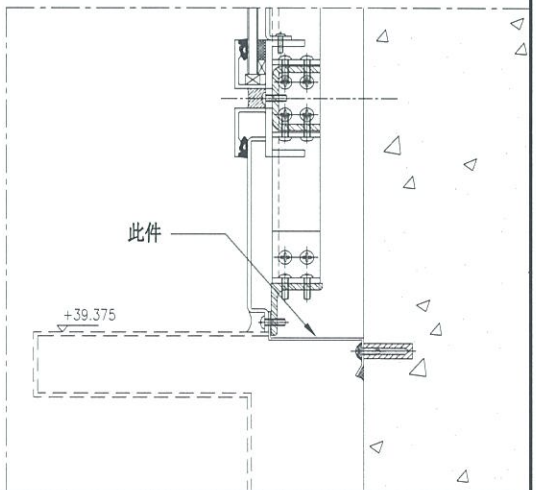

名称	防水片拆图	制图	JH	2019.3.27	修改	A
材料	1.5mm 铝板	复核	DL	2019.3.28	日期	2019.4.15
颜色	MILL	批准			图号	FS-032



美特铝质有限公司  
MIDI Aluminium Fabricator Ltd.

工程号 J-837 地盘 观塘裕民坊

物料编号	层数	总数	使用位置	楼层	备注
FS-033	1	3	T1-E	06F	
FS-033	1	3	T2-M	06F	
FS-033	1	1	T3-F	06F	
FS-033	1	1	T5-A	06F	
FS-033	1	2	T5-H	06F	
				A	

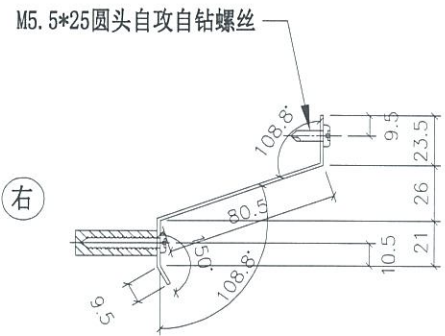
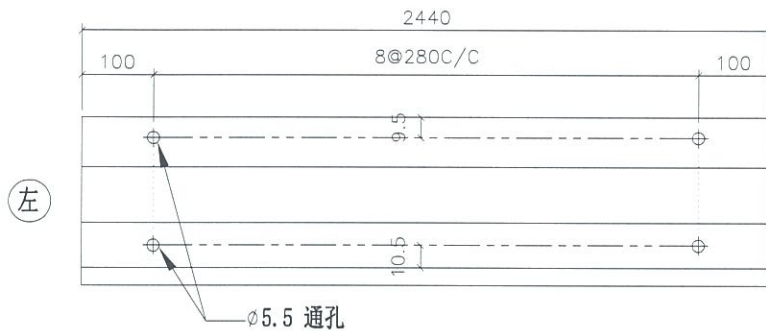

地盘安装

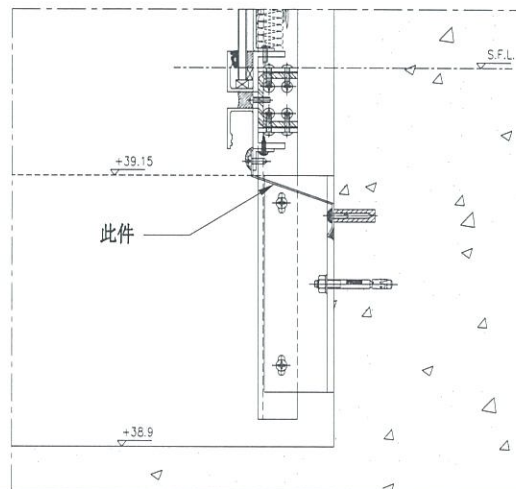

名称	防水片拆图	制图	JH	2019.3.27	修改	A		
材料	1.5mm 铝板	复核	DL	2019.3.28	日期	2019.4.15		
颜色	MILL A	批准			图号	FS-033		



美特铝质有限公司  
MIDI Aluminium Fabricator Ltd.

物料编号	层数	总数	使用位置	楼层	备注
FS-034	1	3	T1-E	06F	
FS-034	1	1	T2-J	06F	
FS-034	1	1	T2-M	06F	
FS-034	1	1	T3-F	06F	
FS-034	1	1	T5-A	06F	
				A	

工程号 J-837 地盘 观塘裕民坊

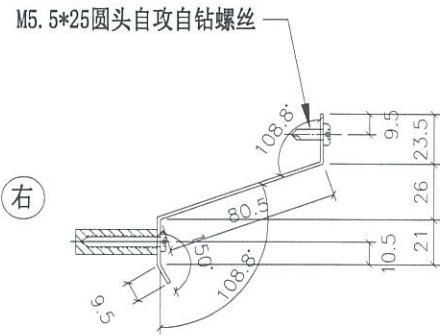
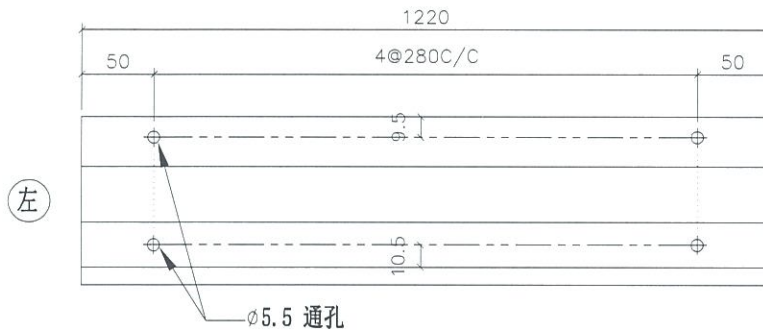

地盘安装

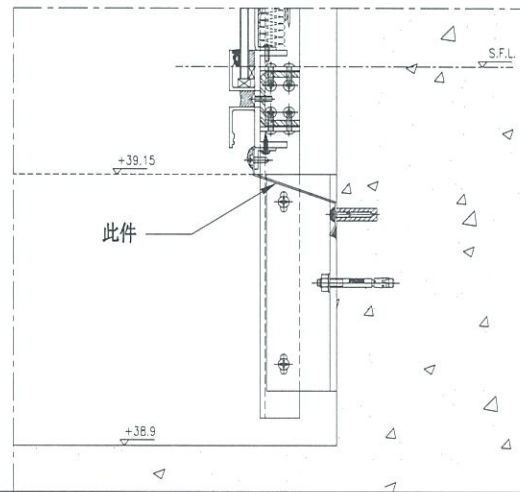

名称	防水片拆图	制图	JH	2019.3.27	修改	A	
材料	1.5mm 铝板	复核	DL	2019.3.28	日期	2019.4.15	
颜色	MILL <span style="border: 1px solid black; border-radius: 50%; padding: 2px;">A</span>	批准			图号	FS-034	



美特铝质有限公司  
MIDI Aluminium Fabricator Ltd.

工程号 J-837 地盘 观塘裕民坊

物料编号	层数	总数	使用位置	楼层	备注
FS-035	1	1	T2-M	06F	
FS-035	1	1	T3-F	06F	
FS-035	1	1	T5-A	06F	
FS-035	1	1	T5-H	06F	

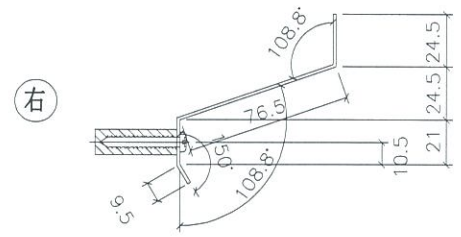
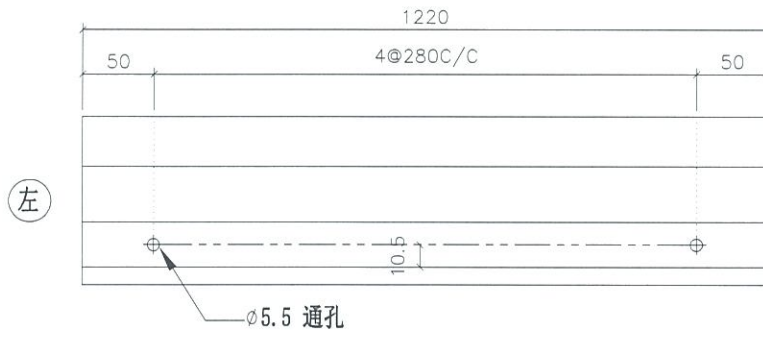

地盘安装

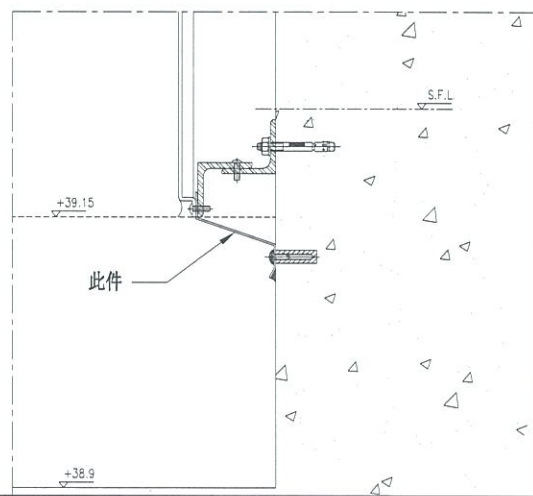

名称	防水片拆图	制图	JH	2019.3.27	修改	A	
材料	1.5mm 铝板	复核	DL	2019.3.28	日期	2019.4.15	
颜色	MILL <span style="border: 1px solid black; padding: 2px;">A</span>	批准			图号	FS-035	



美特铝质有限公司  
MIDI Aluminium Fabricator Ltd.

工程号 J-837 地盘 观塘裕民坊

物料编号	层数	总数	使用位置	楼层	备注
FS-036	1	2	T1-A	50F	
FS-036	1	2	T1-B	50F	
FS-036	1	1	T1-E	50F	
FS-036	1	2	T1-G	50F	
FS-036	1	2	T1-H	50F	
FS-036	1	2	T5-H	50F	
FS-036	1	2	T5-L	50F	
FS-036	1	2	T5-M	50F	
FS-036	1	2	T5-A	51F	
FS-036	1	2	T3-A	52F	
FS-036	1	2	T3-B	52F	
FS-036	1	4	T3-F	52F	
FS-036	1	2	T2-A	55F	
FS-036	1	2	T2-B	55F	
FS-036	1	2	T2-H	55F	
FS-036	1	1	T2-J	55F	
FS-036	1	2	T2-M	55F	

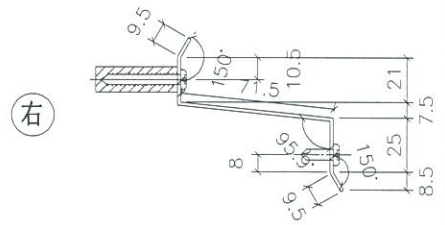
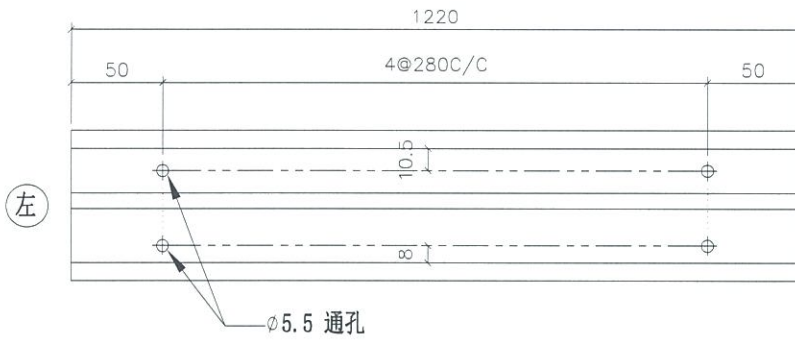

地盘安装

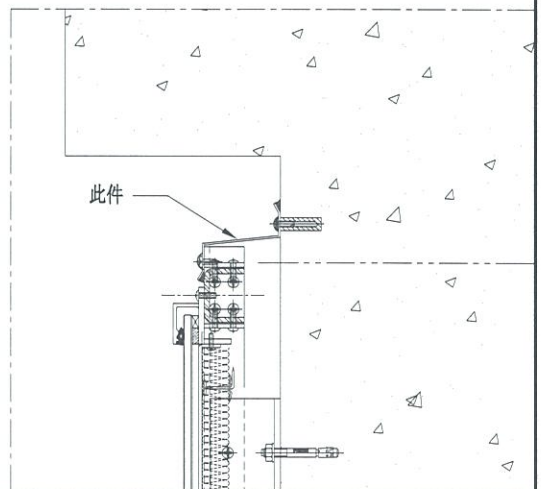

名称	防水片拆图	制图	JH	2019.3.27	修改	A
材料	1.5mm 铝板	复核	DL	2019.3.28	日期	2019.4.15
颜色	MILL	批准			图号	FS-036

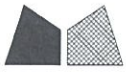

美特铝质有限公司  
MIDI Aluminium Fabricator Ltd.

工程号 J-837 地盘 观塘裕民坊

物料编号	层数	总数	使用位置	楼层	备注
FS-037	1	4	T1-E	50F	
FS-037	1	2	T5-H	50F	
FS-037	1	2	T5-A	51F	
FS-037	1	1	T3-F	52F	
FS-037	1	4	T2-M	55F	
				A	

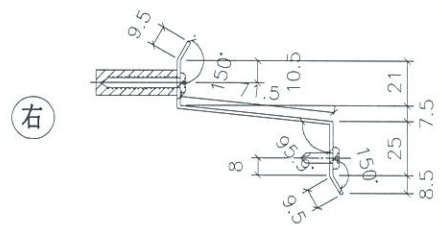
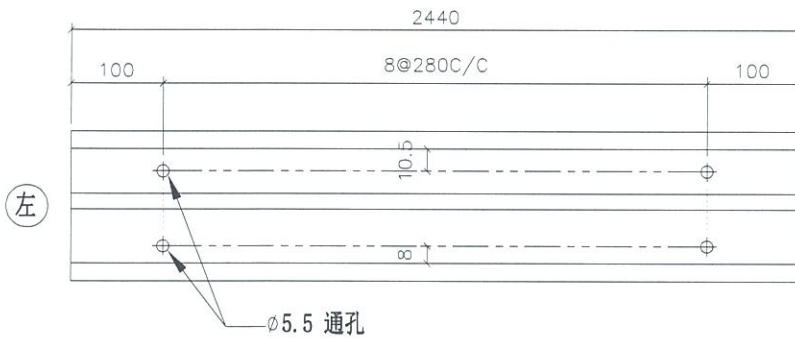

地盘安装

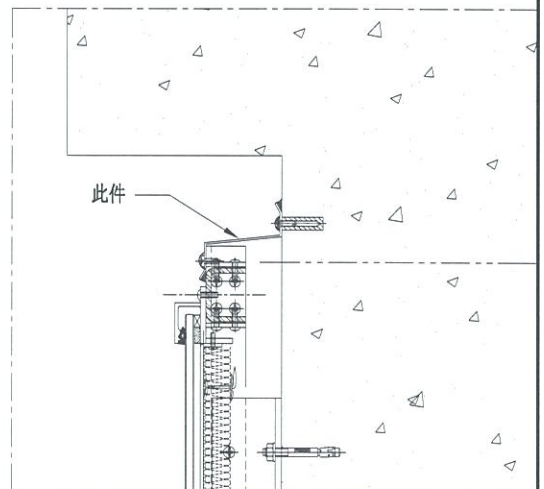

名称	防水片拆图	制图	JH	2019.3.27	修改	A	
材料	1.5mm 铝板	复核	DL	2019.3.28	日期	2019.4.15	
颜色	MILL	批准			图号	FS-037	



美特铝质有限公司  
MIDI Aluminium Fabricator Ltd.

工程号 J-837 地盘 观塘裕民坊

物料编号	层数	总数	使用位置	楼层	备注
FS-038	1	1	T2-M	06F	
FS-038	14	18	T2-M	10~26F	
FS-038	1	1	T2-M	27F	
FS-038	1	1	T2-M	28F	
FS-038	23	31	T2-M	29~53F	
FS-038	1	1	T2-M	55F	

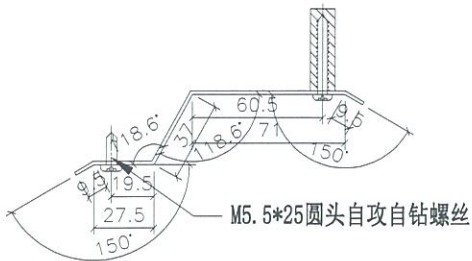
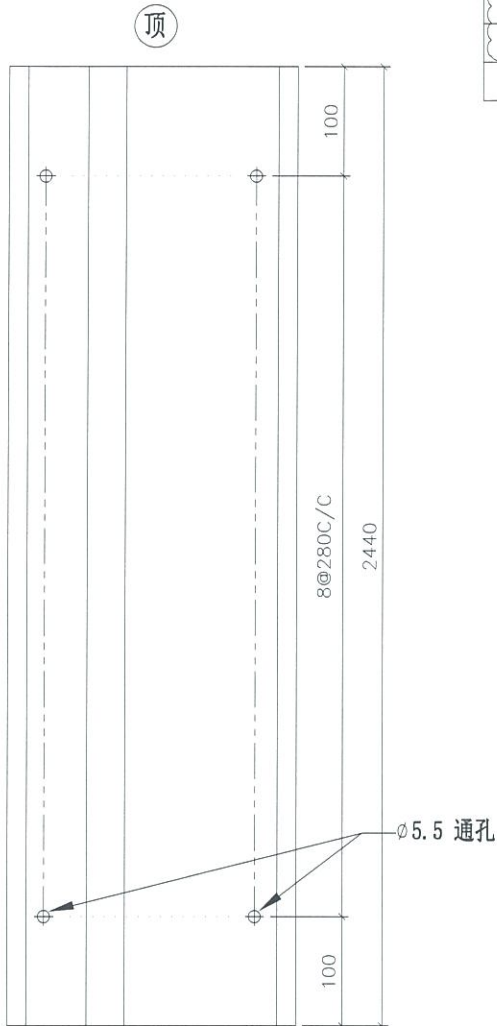

地盘安装

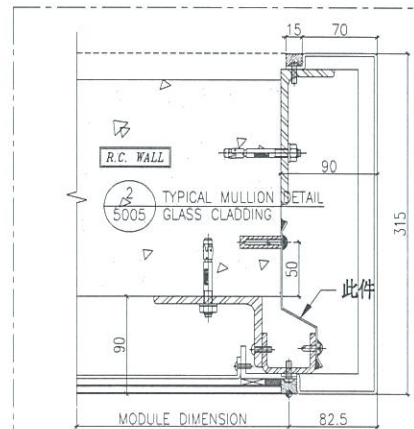

名称	防水片拆图	制图	JH	2019.3.27	修改	A	
材料	1.5mm 铝板	复核	DL	2019.3.28	日期	2019.4.15	
颜色	MILL	批准			图号	FS-038	

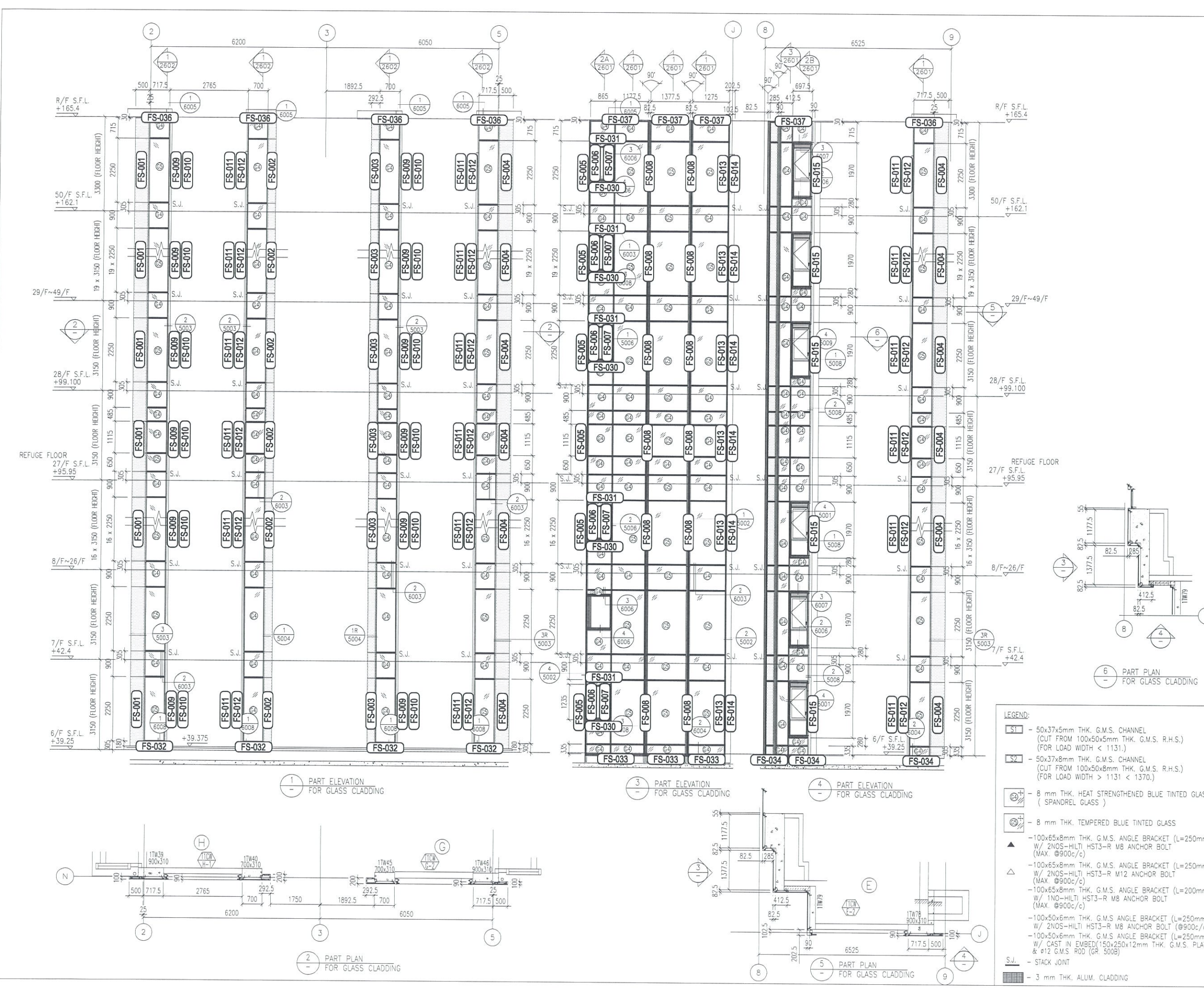

B.D. REF :

CLIENT :  
 信和置業有限公司  
 Sino Land Company Limited

ARCHITECT :  
 WONG TUNG & PARTNERS LIMITED  
 ARCHITECTS & PLANNERS

MAIN CONTRACTOR :  
 CR Construction Company Limited

STRUCTURAL ENGINEER :  
 AECOM

FAÇADE CONSULTANT:  
 AECOM

NOTE :  
 1. ALL DIMENSIONS ARE IN MM.  
 2. ALL ELEVATIONS ARE VIEWED FROM OUTSIDE.  
 3. ALL DIMENSIONS TO BE VERIFIED ON SITE BEFORE FABRICATION.

LEGEND :  
 x1 -- DETAIL MARK NO.  
 x001 -- REFER SHEET NO.  
 1. F.F.L. -- FINISHED FLOOR LEVEL  
 2. S.F.L. -- STRUCTURAL FLOOR LEVEL  
 3. (R) -- REVERSED DETAIL

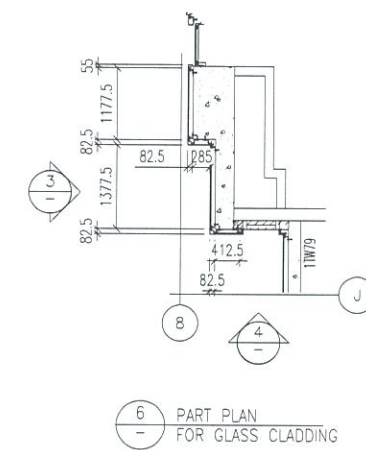

LEGEND:

- S1 - 50x37x5mm THK. G.M.S. CHANNEL (CUT FROM 100x50x5mm THK. G.M.S. R.H.S.) (FOR LOAD WIDTH < 1131.)
- S2 - 50x37x8mm THK. G.M.S. CHANNEL (CUT FROM 100x50x8mm THK. G.M.S. R.H.S.) (FOR LOAD WIDTH > 1131 < 1370.)
- G1 - 8 mm THK. HEAT STRENGTHENED BLUE TINTED GLASS ( SPANDREL GLASS )
- G2 - 8 mm THK. TEMPERED BLUE TINTED GLASS
- A1 - 100x65x8mm THK. G.M.S. ANGLE BRACKET (L=250mm) W/ 2N05-HILT3-HST3-R M8 ANCHOR BOLT (MAX. @900c/c)
- A2 - 100x65x8mm THK. G.M.S. ANGLE BRACKET (L=250mm) W/ 2N05-HILT3-R M12 ANCHOR BOLT (MAX. @900c/c)
- A3 - 100x65x8mm THK. G.M.S. ANGLE BRACKET (L=200mm) W/ 1N0-HILT3-HST3-R M8 ANCHOR BOLT (MAX. @900c/c)
- A4 - 100x50x6mm THK. G.M.S. ANGLE BRACKET (L=250mm) W/ 2N05-HILT3-R M8 ANCHOR BOLT (@900c/c)
- A5 - 100x50x6mm THK. G.M.S. ANGLE BRACKET (L=250mm) W/ CAST IN EMBED(150x250x12mm THK. G.M.S. PLATE & #12 G.M.S. ROD (GR 500B))
- S.J. - STACK JOINT
- 3 mm THK. ALUM. CLADDING

NO.	DATE	REVISED	BY

JOB NO. : J-837

PROJECT :  
 URA KWUN TONG TOWN CENTRE  
 REDEVELOPMENT (AREA 2 & 3) AT  
 NKIL 6514, KWUN TONG, KWLOON

TITLE :  
 PART ELEVATION  
 OF GLASS CLADDING  
 AT TOWER 1

DATE : 04-JUL-18      SCALE : 1:60 (A1)

DRAWN BY : ASING      CHECKED BY : -

MIDI ALUMINUM FABRICATOR LTD.  
 Units 6-8, Sunray Industrial Centre, 1/F  
 610 Cha Kwo Ling Road, Kowloon  
 Tel: 23489211-4 Fax: (852) 27727666

DWG NO. : JB37-GC-FT-2101      REV. : -

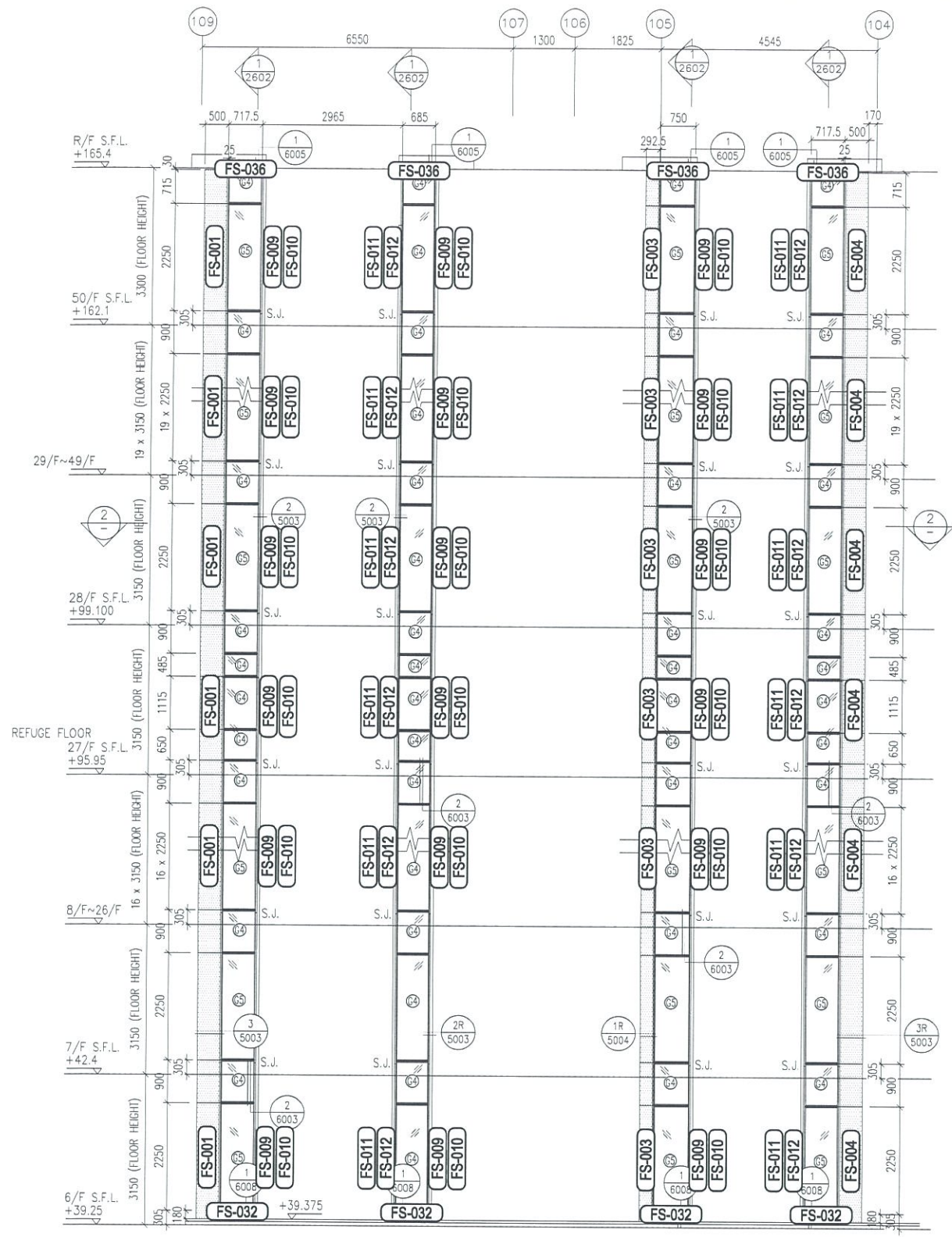

1 PART ELEVATION FOR GLASS CLADDING

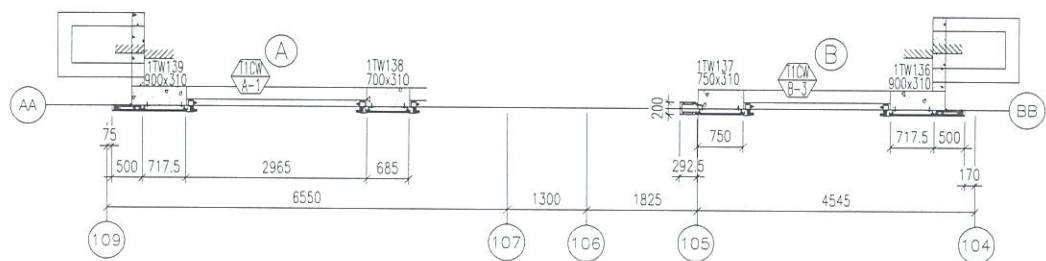

2 PART PLAN FOR GLASS CLADDING

B.D. REF :

CLIENT :  
 信和置業有限公司  
 Sino Land Company Limited

ARCHITECT :  
 WONG TUNG & PARTNERS LIMITED  
 ARCHITECTS & PLANNERS

MAIN CONTRACTOR :  
 CR Construction Company Limited

STRUCTURAL ENGINEER :  
 A-ZCOM

FACADE CONSULTANT:  
 A-ZCOM

NOTE :  
 1. ALL DIMENSIONS ARE IN mm.  
 2. ALL ELEVATIONS ARE VIEWED FROM OUTSIDE.  
 3. ALL DIMENSIONS TO BE VERIFIED ON SITE BEFORE FABRICATION.

LEGEND :  
 X1 --- DETAIL MARK NO.  
 X001 --- REFER SHEET NO.  
 1. F.F.L. --- FINISHED FLOOR LEVEL  
 2. S.F.L. --- STRUCTURAL FLOOR LEVEL  
 3. (R) --- REVERSED DETAIL

NO.	DATE	REVISED	BY

JOB NO. : J-B37  
 PROJECT :  
 URA KWUN TONG TOWN CENTRE  
 REDEVELOPMENT (AREA 2 & 3) AT  
 NKIL 6514, KWUN TONG, KWLOON

TITLE :  
 PART ELEVATION  
 OF GLASS CLADDING  
 AT TOWER 1

DATE : 04-JUL-18 SCALE : 1:60 (A1)

DRAWN BY : ASING CHECKED BY : -

美特鋁質有限公司  
 MIDI ALUMINIUM FABRICATOR LTD.  
 Units 6-8, Sunray Industrial Centre, 1/F  
 610 Cha Kwo Ling Road, Kowloon  
 Tel:23489211-4 Fax:(652)27727666

DWG NO. : JB37-GC-FT-2102 REV. : -

- LEGEND:
- 50x37x5mm THK. G.M.S. CHANNEL (CUT FROM 100x50x5mm THK. G.M.S. R.H.S.)
  - 8 mm THK. HEAT STRENGTHENED BLUE TINTED GLASS (SPANDREL GLASS)
  - 8 mm THK. TEMPERED BLUE TINTED GLASS
  - 100x65x8mm THK. G.M.S. ANGLE BRACKET (L=250mm) W/ 2NOS-HILTI HST3-R MB ANCHOR BOLT (MAX. @900c/c)
  - 100x65x8mm THK. G.M.S. ANGLE BRACKET (L=250mm) W/ 2NOS-HILTI HST3-R M12 ANCHOR BOLT (MAX. @900c/c)
  - S.J. - STACK JOINT
  - 3 mm THK. ALUM. CLADDING

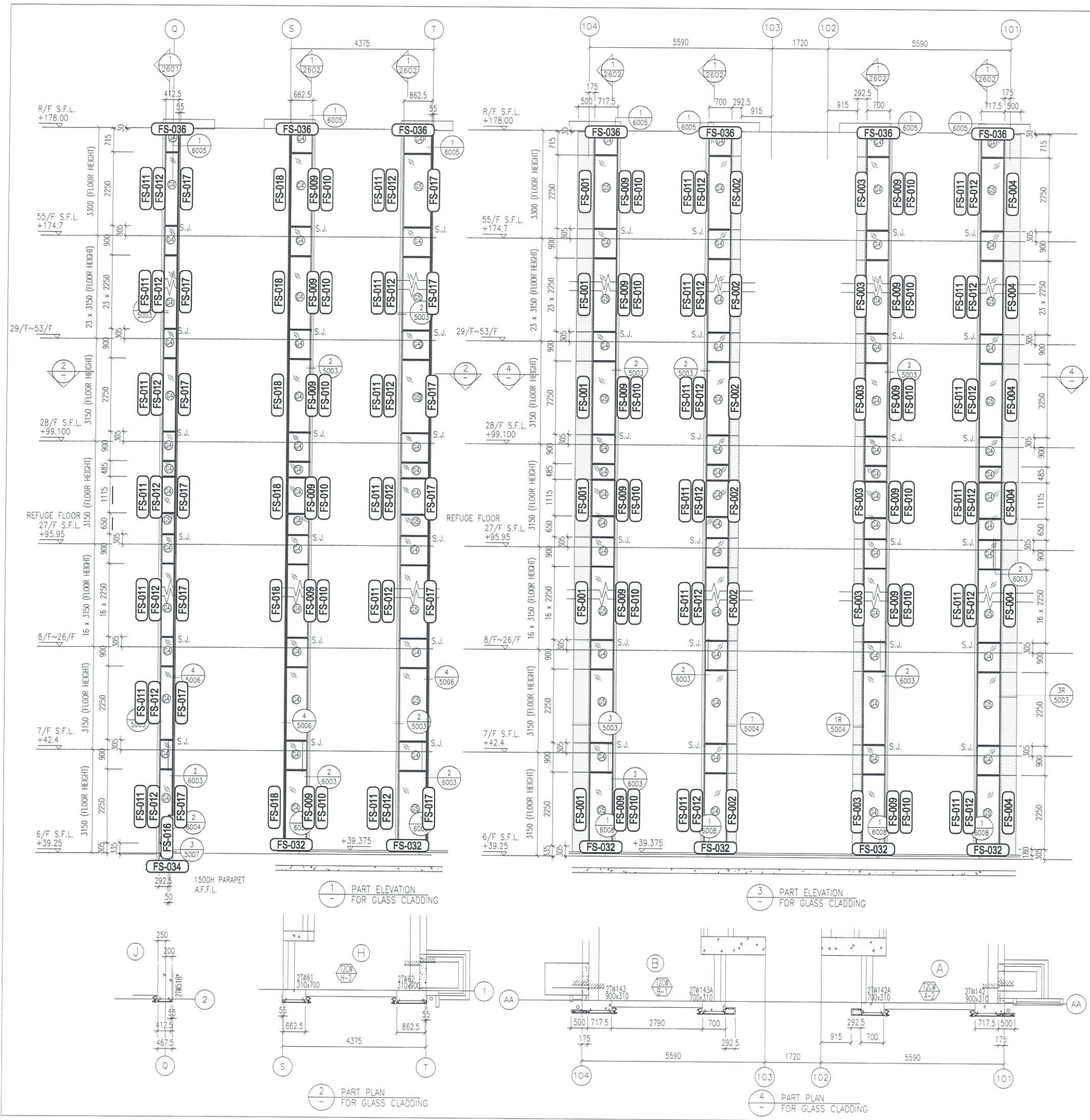

B.D. REF :

CLIENT :  
 信和置業有限公司  
 Sino Land Company Limited

ARCHITECT :  
 WONG TUNG & PARTNERS LIMITED  
 ARCHITECTS & PLANNERS

MAIN CONTRACTOR :  
 CR Construction Company Limited

STRUCTURAL ENGINEER :  
 AECOM

FAÇADE CONSULTANT:  
 AECOM

NOTE :  
 1. ALL DIMENSIONS ARE IN mm.  
 2. ALL ELEVATIONS ARE VIEWED FROM OUTSIDE.  
 3. ALL DIMENSIONS TO BE VERIFIED ON SITE BEFORE FABRICATION.

LEGEND :  
 x1 --- DETAIL MARK NO.  
 x001 --- REFER SHEET NO.  
 1. F.F.L. --- FINISHED FLOOR LEVEL  
 2. S.F.L. --- STRUCTURAL FLOOR LEVEL  
 3. (R) --- REVERSED DETAIL

NO.	DATE	REVISED	BY

JOB NO. : J-837  
 PROJECT :  
 URA KWUN TONG TOWN CENTRE  
 REDEVELOPMENT (AREA 2 & 3) AT  
 NKIL 6514, KWUN TONG, KWLOON

TITLE :  
 PART ELEVATION  
 OF GLASS CLADDING  
 AT TOWER 2

DATE : 04-JUL-18 SCALE : 1:60 (A1)  
 DRAWN BY : ASING CHECKED BY : -

美特鋁質有限公司  
 MIDI ALUMINIUM FABRICATOR LTD.  
 Units 6-8, Sunray Industrial Centre, 1/F  
 610 Cha Kwo Ling Road, Kowloon  
 Tel: 23489211-4 Fax: (852) 2772666  
 DWG NO. : JB37-GC-FT-2201 REV. : -

- LEGEND:
- 50x37x5mm THK. G.M.S. CHANNEL (CUT FROM 100x50x5mm THK. G.M.S. R.H.S.)
  - 8 mm THK. HEAT STRENGTHENED BLUE TINTED GLASS (SPANDREL GLASS)
  - 8 mm THK. TEMPERED BLUE TINTED GLASS
  - 100x65x8mm THK. G.M.S. ANGLE BRACKET (L=250mm) W/ 2NOS-HILTI HST3-R M8 ANCHOR BOLT (MAX. @900c/c)
  - 100x65x8mm THK. G.M.S. ANGLE BRACKET (L=250mm) W/ 2NOS-HILTI HST3-R M12 ANCHOR BOLT (MAX. @900c/c)
  - 100x65x8mm THK. G.M.S. ANGLE BRACKET (L=200mm) W/ 1NO-HILTI HST3-R M8 ANCHOR BOLT (MAX. @900c/c)
  - S.J. - STACK JOINT
  - 3 mm THK. ALUM. CLADDING

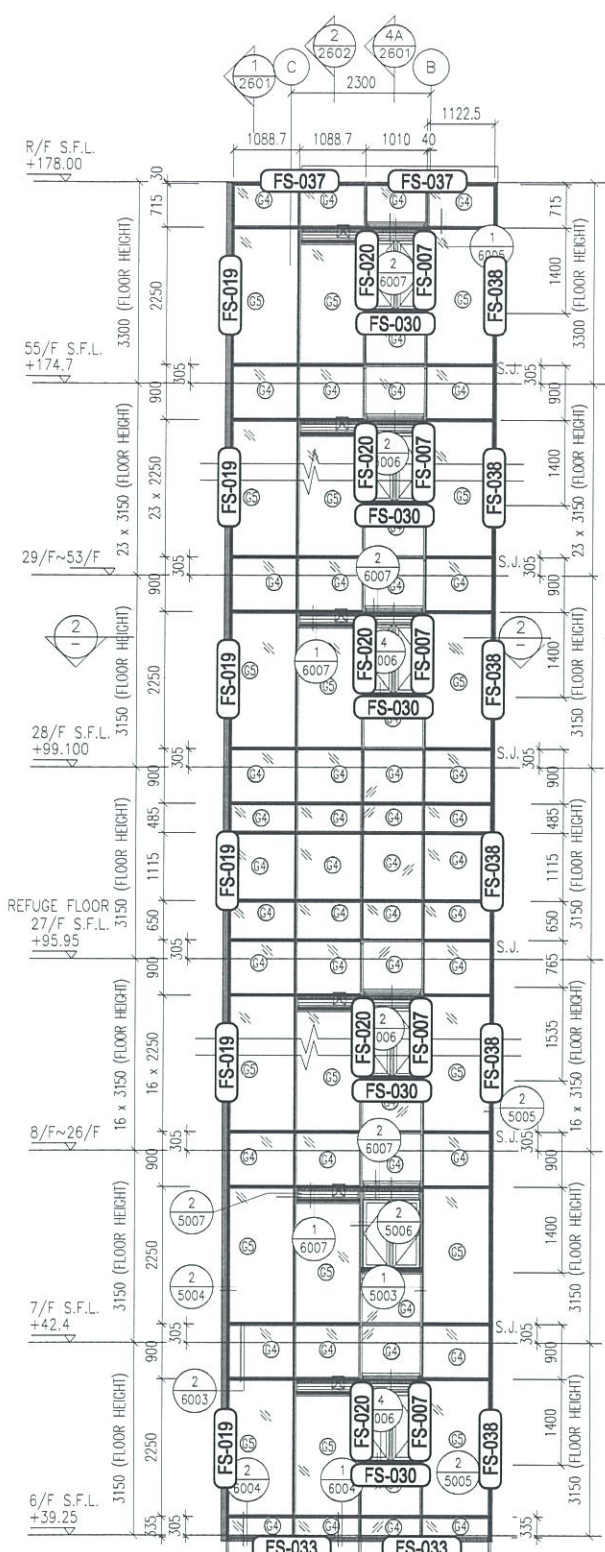

1 - PART ELEVATION FOR GLASS CLADDING

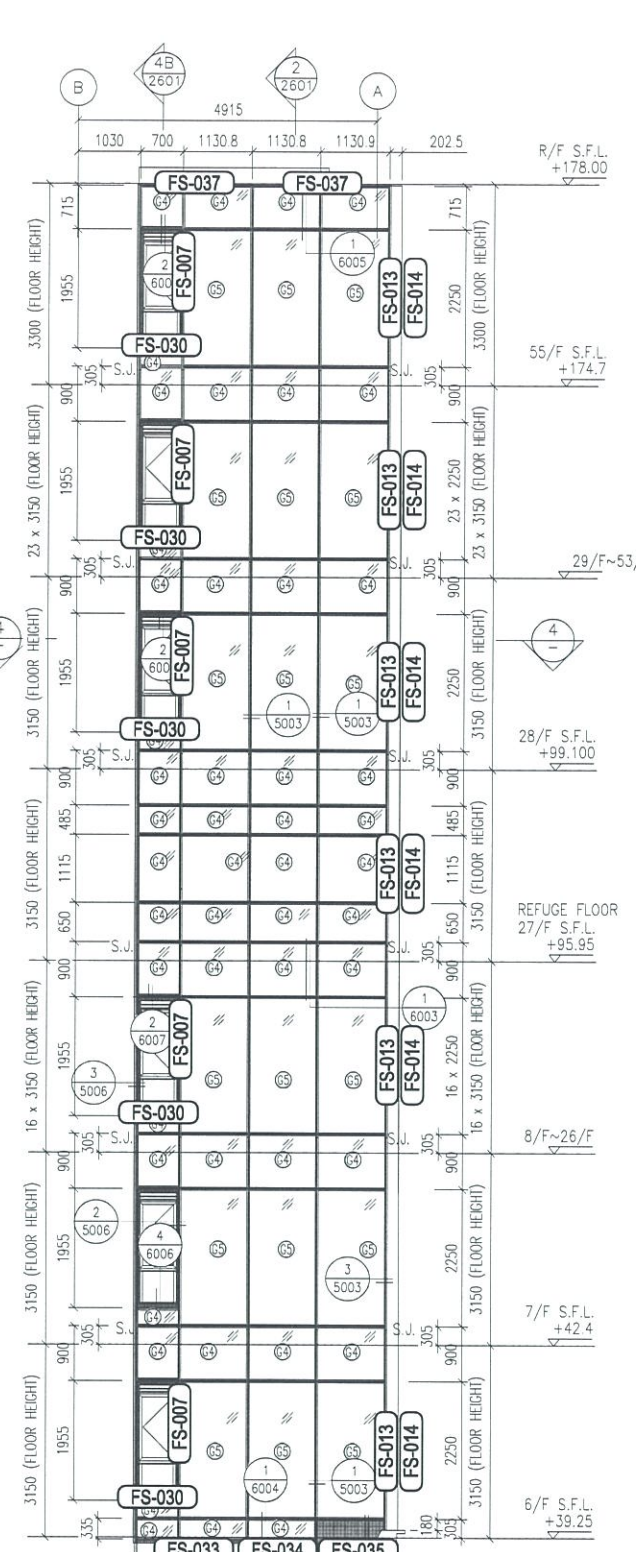

3 - PART ELEVATION FOR GLASS CLADDING

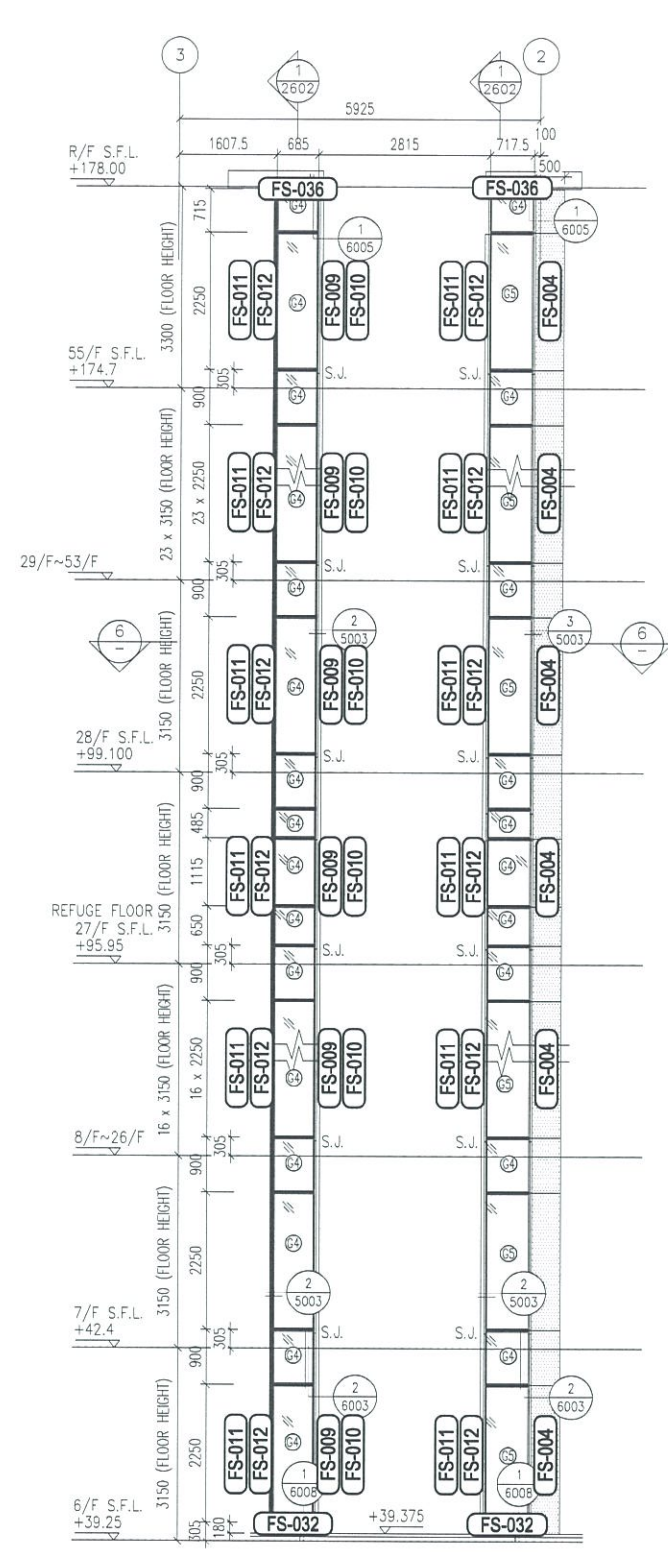

5 - PART ELEVATION FOR GLASS CLADDING

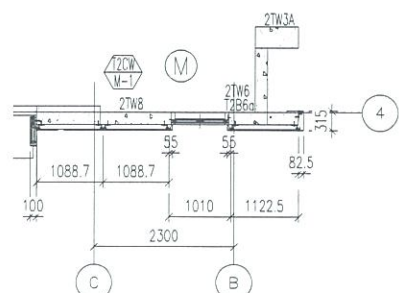

2 - PART PLAN FOR GLASS CLADDING

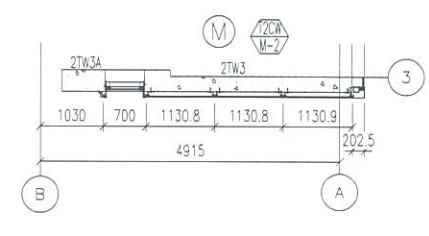

4 - PART PLAN FOR GLASS CLADDING

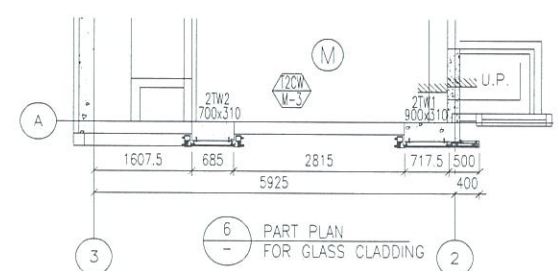

6 - PART PLAN FOR GLASS CLADDING

- LEGEND:**
- 50x37x5mm THK. G.M.S. CHANNEL (CUT FROM 100x50x5mm THK. G.M.S. R.H.S.) (FOR LOAD WIDTH < 1131.)
  - 8 mm THK. HEAT STRENGTHENED BLUE TINTED GLASS (SPANDREL GLASS)
  - 8 mm THK. TEMPERED BLUE TINTED GLASS
  - 100x65x8mm THK. G.M.S. ANGLE BRACKET (L=250mm) W/ 2NDS-H/LTI HST3-R MB ANCHOR BOLT (MAX. @900c/c)
  - 100x65x8mm THK. G.M.S. ANGLE BRACKET (L=200mm) W/ 1ND-H/LTI HST3-R MB ANCHOR BOLT (MAX. @900c/c)
  - STACK JOINT
  - 3 mm THK. ALUM. CLADDING

B.D. REF :

CLIENT :  
 信和置業有限公司  
 Sino Land Company Limited

ARCHITECT :  
 WONG TUNG & PARTNERS LIMITED  
 ARCHITECTS & PLANNERS

MAIN CONTRACTOR :  
 CR Construction Company Limited

STRUCTURAL ENGINEER :  
 AECOM

FAÇADE CONSULTANT:  
 AECOM

**NOTE :**  
 1. ALL DIMENSIONS ARE IN mm.  
 2. ALL ELEVATIONS ARE VIEWED FROM OUTSIDE.  
 3. ALL DIMENSIONS TO BE VERIFIED ON SITE BEFORE FABRICATION.

**LEGEND :**  
 - DETAIL MARK NO.  
 - REFER SHEET NO.  
 1. F.F.L. -- FINISHED FLOOR LEVEL  
 2. S.F.L. -- STRUCTURAL FLOOR LEVEL  
 3. -- REVERSED DETAIL

NO.	DATE	REVISED	BY

JOB NO. : J-837  
 PROJECT :  
 URA KWUN TONG TOWN CENTRE  
 REDEVELOPMENT (AREA 2 & 3) AT  
 NKIL 6514, KWUN TONG, KWLOON

TITLE :  
 PART ELEVATION  
 OF GLASS CLADDING  
 AT TOWER 2

DATE : 04-JUL-18 SCALE : 1:60 (A1)

DRAWN BY : ASING CHECKED BY : -

美特鋁質有限公司  
 MIDI ALUMINIUM FABRICATOR LTD.  
 Units 6-B, Sunray Industrial Centre, 1/F  
 610 Cha Kwo Ling Road, Kowloon  
 Tel:23489211-4 Fax:(852)27727666

DWG NO. : J837-GC-FT-2202 REV. : -

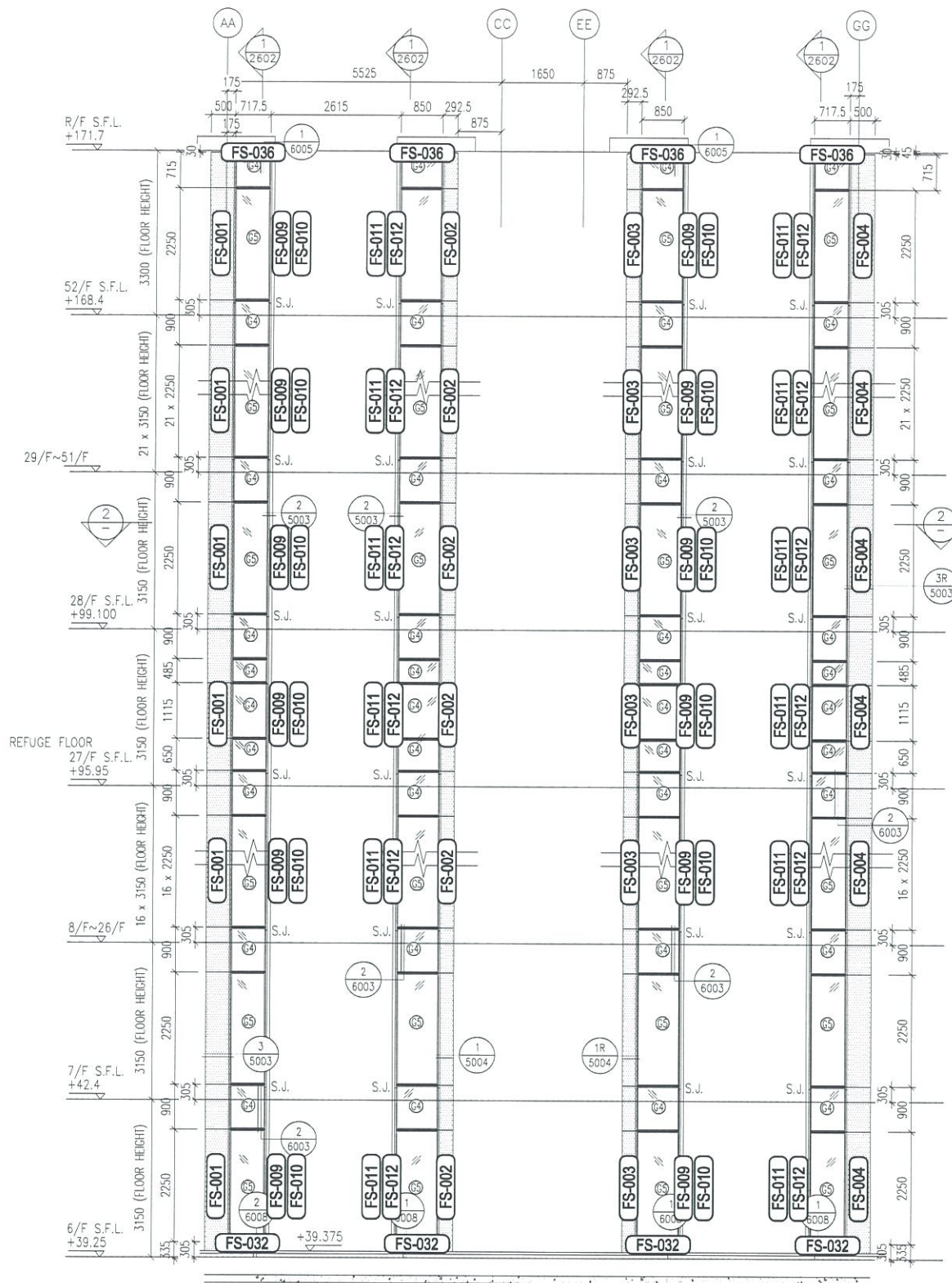

1 PART ELEVATION FOR GLASS CLADDING

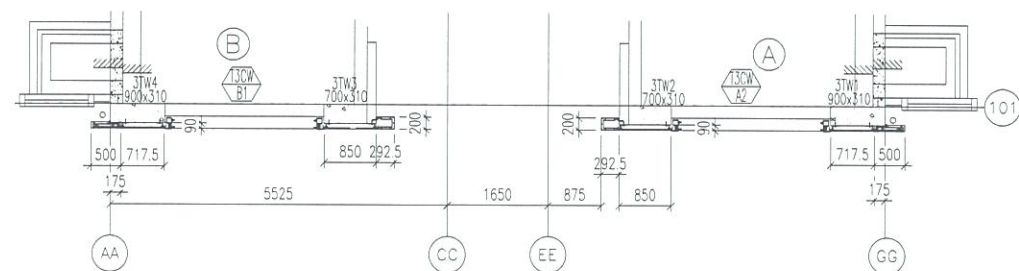

2 PART PLAN FOR GLASS CLADDING

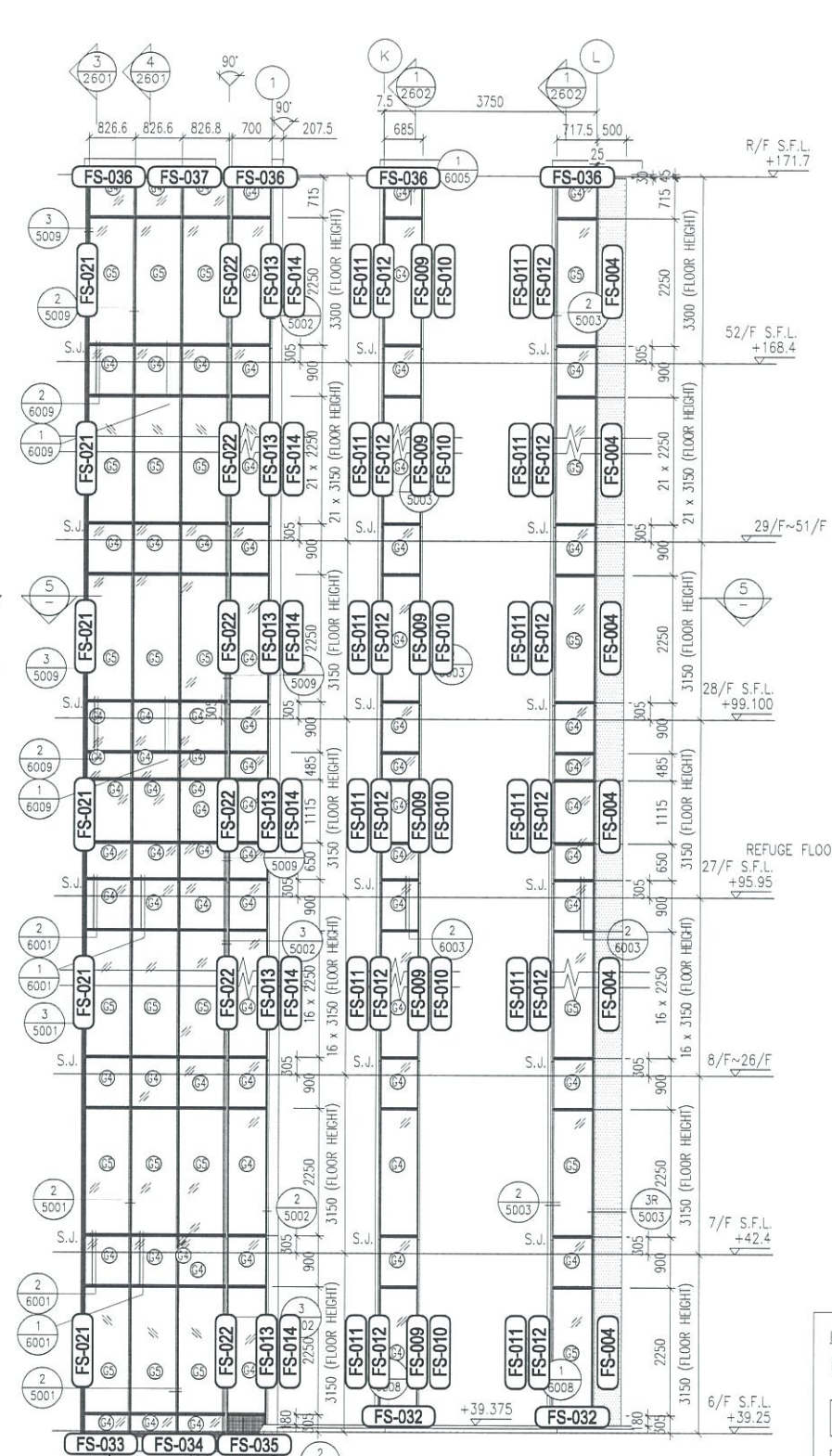

3 PART ELEVATION FOR GLASS CLADDING

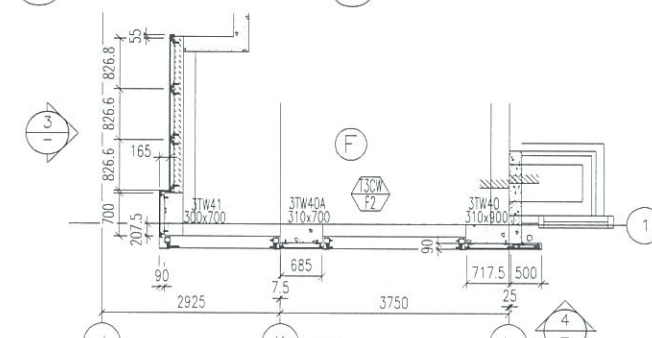

4 PART PLAN FOR GLASS CLADDING

LEGEND:

- ST - 50x37x5mm THK. G.M.S. CHANNEL (CUT FROM 100x50x5mm THK. G.M.S. R.H.S.)
- G4 - 8 mm THK. HEAT STRENGTHENED BLUE TINTED GLASS (SPANDREL GLASS)
- G5 - 8 mm THK. TEMPERED BLUE TINTED GLASS
- ▲ - 100x65x8mm THK. G.M.S. ANGLE BRACKET (L=250mm) W/ 2NOS-HILTI HST3-R M8 ANCHOR BOLT (MAX. @900c/c)
- △ - 100x65x8mm THK. G.M.S. ANGLE BRACKET (L=250mm) W/ 2NOS-HILTI HST3-R M12 ANCHOR BOLT (MAX. @900c/c)
- △ - 100x65x8mm THK. G.M.S. ANGLE BRACKET (L=200mm) W/ 1NO-HILTI HST3-R M8 ANCHOR BOLT (MAX. @900c/c)
- △ - 100x50x6mm THK. G.M.S. ANGLE BRACKET (L=250mm) W/ 2NOS-HILTI HST3-R M8 ANCHOR BOLT (@900c/c)
- △ - 100x50x6mm THK. G.M.S. ANGLE BRACKET (L=200mm) W/ 1NO-HILTI HST3-R M8 ANCHOR BOLT (@900c/c)
- △ - 100x50x6mm THK. G.M.S. ANGLE BRACKET (L=250mm) W/ CAST IN EMBED(250x150x12mm THK. G.M.S. PLATE & #12 G.M.S. ROD (GR. 500B))
- △ - 100x50x6mm THK. G.M.S. ANGLE BRACKET (L=200mm) W/ CAST IN EMBED(300x250x12mm THK. G.M.S. PLATE & #12 G.M.S. ROD (GR. 500B))
- S.J. - STACK JOINT
- - 3 mm THK. ALUM. CLADDING

B.D. REF :

CLIENT :  
 信和置業有限公司  
 Sino Land Company Limited

ARCHITECT :  
 WONG TUNG & PARTNERS LIMITED  
 ARCHITECTS & PLANNERS

MAIN CONTRACTOR :  
 CR Construction Company Limited

STRUCTURAL ENGINEER :  
 AECOM

FAÇADE CONSULTANT:  
 AECOM

NOTE :  
 1. ALL DIMENSIONS ARE IN mm.  
 2. ALL ELEVATIONS ARE VIEWED FROM OUTSIDE.  
 3. ALL DIMENSIONS TO BE VERIFIED ON SITE BEFORE FABRICATION.

LEGEND :  
 X1 - DETAIL MARK NO.  
 X001 - REFER SHEET NO.  
 1. F.F.L. -- FINISHED FLOOR LEVEL  
 2. S.F.L. -- STRUCTURAL FLOOR LEVEL  
 3. (R) -- REVERSED DETAIL

NO.	DATE	REVISED	BY

JOB NO. : J-B37  
 PROJECT :  
 URA KWUN TONG TOWN CENTRE  
 REDEVELOPMENT (AREA 2 & 3) AT  
 NKIL 6514, KWUN TONG, KWLOON

TITLE :  
 PART ELEVATION  
 OF GLASS CLADDING  
 AT TOWER 3

DATE : 04-JUL-18 SCALE : 1:60 (A1)

DRAWN BY : ASING CHECKED BY : -

MIDI ALUMINIUM FABRICATOR LTD.  
 Units 6-8, Sunray Industrial Centre, 1/F  
 610 Cha Kwo Ling Road, Kowloon  
 Tel:23489211-4 Fax:(852)2727666

DWG NO. : J837-GC-FT-2301 REV. : -

- LEGEND:
- ST-1 50x37x5mm THK. G.M.S. CHANNEL  
(CUT FROM 100x50x5mm THK. G.M.S. R.H.S.)
  - 8 mm THK. HEAT STRENGTHENED BLUE TINTED GLASS  
(SPANDREL GLASS)
  - 8 mm THK. TEMPERED BLUE TINTED GLASS
  - 100x65x8mm THK. G.M.S. ANGLE BRACKET (L=250mm)  
W/ 2NOS-HILTI HS13-R M8 ANCHOR BOLT  
(MAX. @900c/c)
  - 100x65x8mm THK. G.M.S. ANGLE BRACKET (L=200mm)  
W/ 1NO-HILTI HS13-R M8 ANCHOR BOLT  
(MAX. @900c/c)
  - S.J. - STACK JOINT
  - 3 mm THK. ALUM. CLADDING

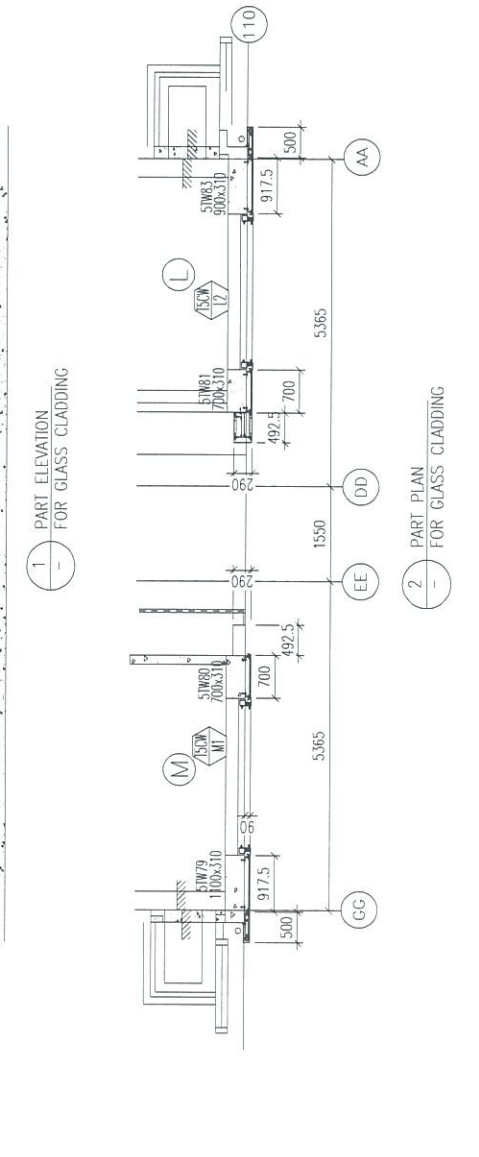
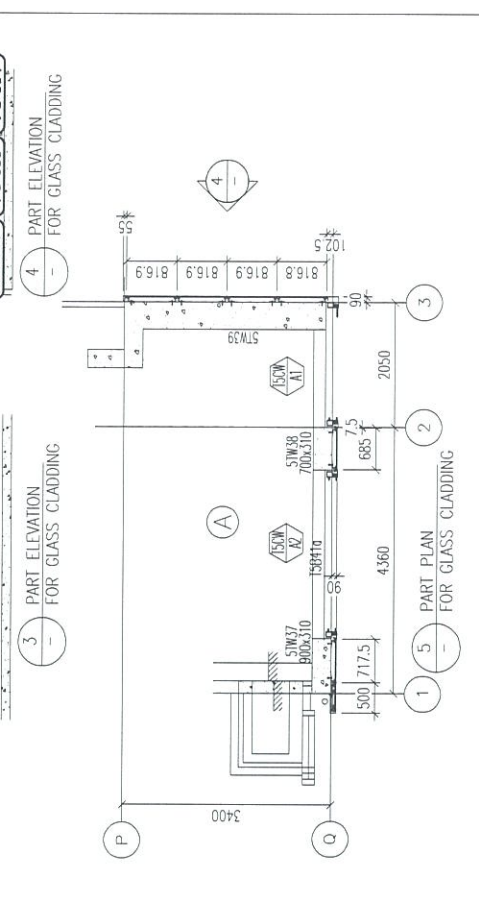
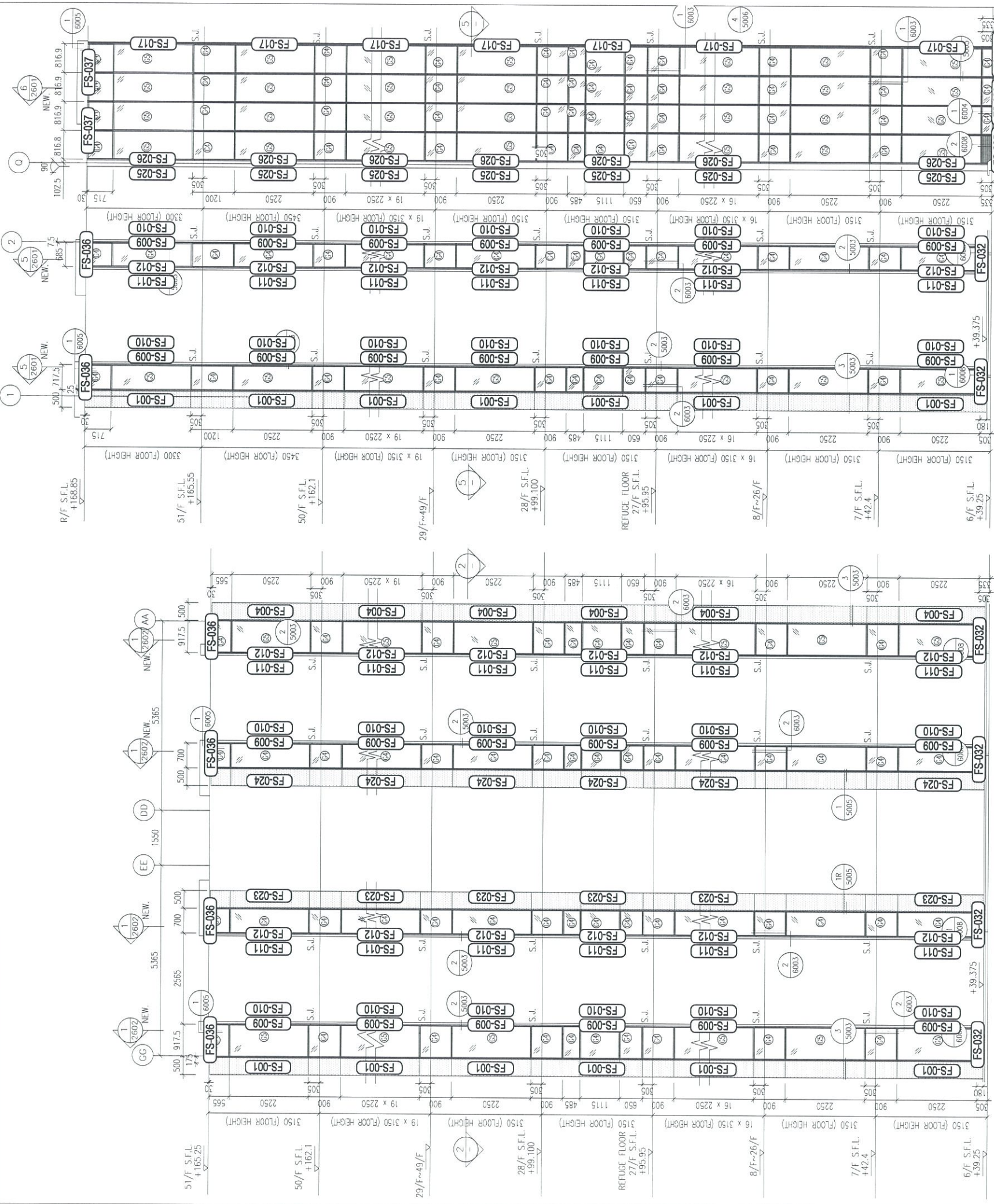

B.D. REF :

CLIENT : 信和置業有限公司 Sino Land Company Limited

ARCHITECT : WONG TUNG & PARTNERS LIMITED ARCHITECTS & PLANNERS

MAIN CONTRACTOR : CR Construction Company Limited

STRUCTURAL ENGINEER : ACOM

FAÇADE CONSULTANT : ACOM

NOTE :

- ALL DIMENSIONS ARE IN MM.
- ALL ELEVATIONS ARE VIEWED FROM OUTSIDE.
- ALL DIMENSIONS TO BE VERIFIED ON SITE BEFORE FABRICATION.

LEGEND :

- X1 - DETAIL MARK NO.
- X001 - REFER SHEET NO.

- F.F.L. -- FINISHED FLOOR LEVEL
- S.F.L. -- STRUCTURAL FLOOR LEVEL
- (R) -- REVERSED DETAIL

NO.	DATE	REVISED	BY

JOB NO. : J-837

PROJECT : URA KWUN TONG TOWN CENTRE REDEVELOPMENT (AREA 2 & 3) AT NKIL 6514, KWUN TONG, KWLOON

TITLE : PART ELEVATION OF GLASS CLADDING AT TOWER 5

DATE : 04-JUL-18 SCALE : 1:60 (A1)

DRAWN BY : ASING CHECKED BY : -

MIDI ALUMINIUM FABRICATOR LTD.  
Units 6-8, Sunray Industrial Centre, 1/F  
610 Cha Kwo Ling Road, Kowloon  
Tel:23489211-4 Fax:(852)27727666

DWG NO. : J837-GC-FT-2501 REV. : -

B.D. REF :

CLIENT :  
  
 信和置業有限公司  
 Sino Land Company Limited

ARCHITECT :  
 WONG TUNG & PARTNERS LIMITED  
 ARCHITECTS & PLANNERS  

MAIN CONTRACTOR :  
  
 CR Construction Company Limited

STRUCTURAL ENGINEER :  
  
 AECOM

FACADE CONSULTANT:  
  
 AECOM

NOTE :  
 1. ALL DIMENSIONS ARE IN mm.  
 2. ALL ELEVATIONS ARE VIEWED FROM OUTSIDE.  
 3. ALL DIMENSIONS TO BE VERIFIED ON SITE BEFORE FABRICATION.

LEGEND :  
  
 x1 -- DETAIL MARK NO.  
 x001 -- REFER SHEET NO.  
 1. F.F.L. -- FINISHED FLOOR LEVEL  
 2. S.F.L. -- STRUCTURAL FLOOR LEVEL  
 3. (R) -- REVERSED DETAIL

NO.	DATE	REVISED	BY

JOB NO. : J-837  
 PROJECT :  
 URA KWUN TONG TOWN CENTRE  
 REDEVELOPMENT (AREA 2 & 3) AT  
 NKIL 6514, KWUN TONG, KWLOON

TITLE :  
 PART ELEVATION  
 OF GLASS CLADDING  
 AT TOWER 5

DATE : 04-JUL-18 SCALE : 1:60 (A1)  
 DRAWN BY : ASING CHECKED BY : -

  
 MIDI ALUMINIUM FABRICATOR LTD.  
 Units 6-8, Sunray Industrial Centre, 1/F  
 610 Cha Kwo Ling Road, Kowloon  
 Tel: 23489211-4 Fax: (852) 2727666



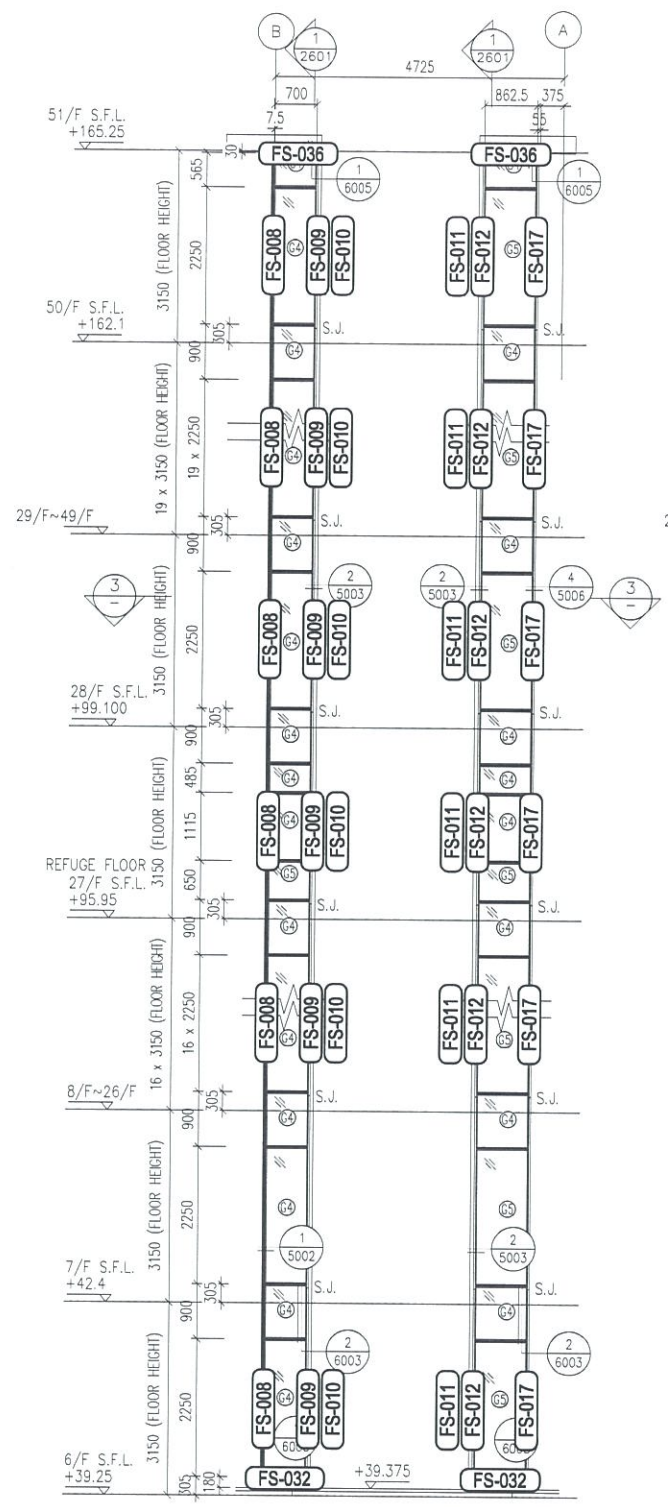



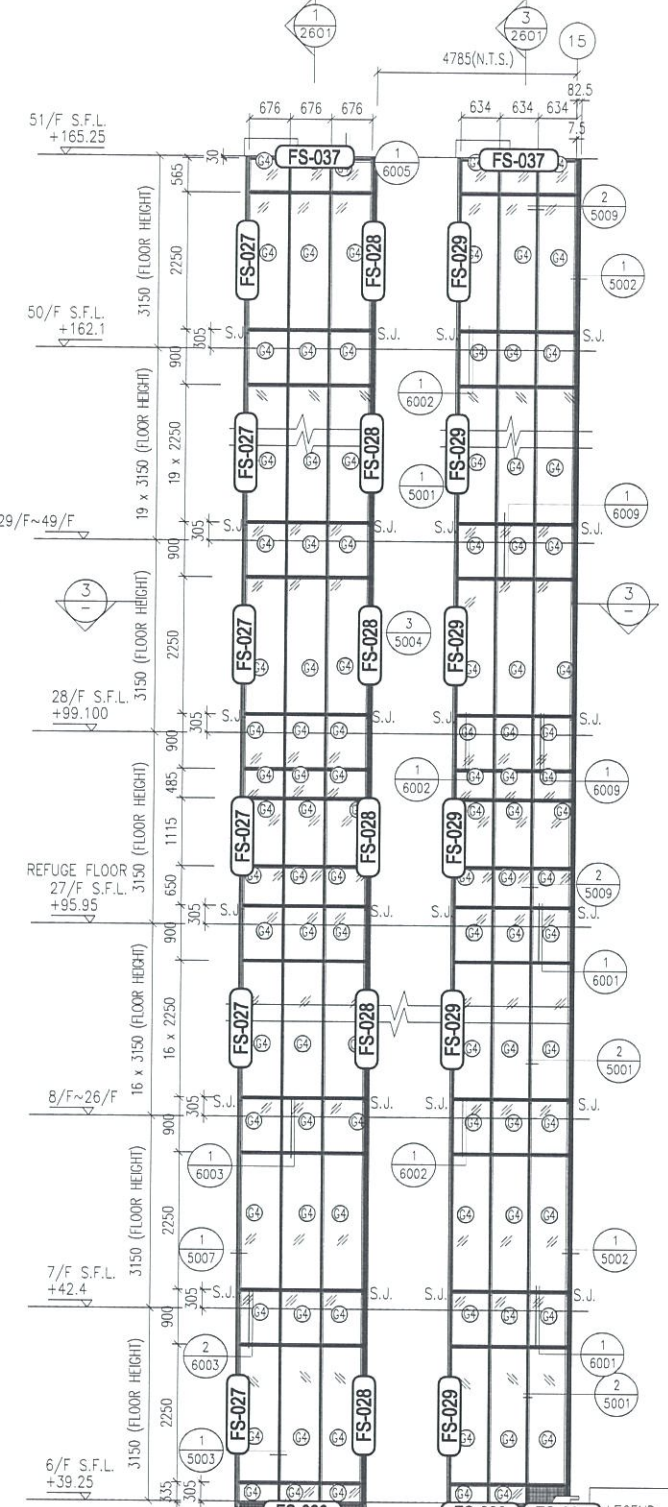



DWG NO. : J837-GC-FT-2502 REV. : -



1 PART ELEVATION FOR GLASS CLADDING



2 PART PLAN FOR GLASS CLADDING

- LEGEND:
-  ST - 50x37x5mm THK. G.M.S. CHANNEL (CUT FROM 100x50x5mm THK. G.M.S. R.H.S.)
  -  (R) - 8 mm THK. HEAT STRENGTHENED BLUE TINTED GLASS (SPANDREL GLASS)
  -  (R) - 8 mm THK. TEMPERED BLUE TINTED GLASS
  -  - 100x65x8mm THK. G.M.S. ANGLE BRACKET (L=250mm) W/ 2NOS-HILTI HST3-R M8 ANCHOR BOLT (MAX. @900c/c)
  -  - 100x65x8mm THK. G.M.S. ANGLE BRACKET (L=200mm) W/ 1NO-HILTI HST3-R M8 ANCHOR BOLT (MAX. @900c/c)
  -  - 100x50x6mm THK. G.M.S. ANGLE BRACKET (L=250mm) W/ 2NOS-HILTI HST3-R M8 ANCHOR BOLT (@900c/c)
  -  - 100x50x6mm THK. G.M.S. ANGLE BRACKET (L=200mm) W/ 1NO-HILTI HST3-R M8 ANCHOR BOLT (@900c/c)
  -  - 100x50x6mm THK. G.M.S. ANGLE BRACKET (L=200mm) W/ CAST IN EMBED(300x250x12mm THK. G.M.S. PLATE & #12 G.M.S. ROD (GR. 500B)
  -  S.J. - STACK JOINT
  -  - 3 mm THK. ALUM. CLADDING

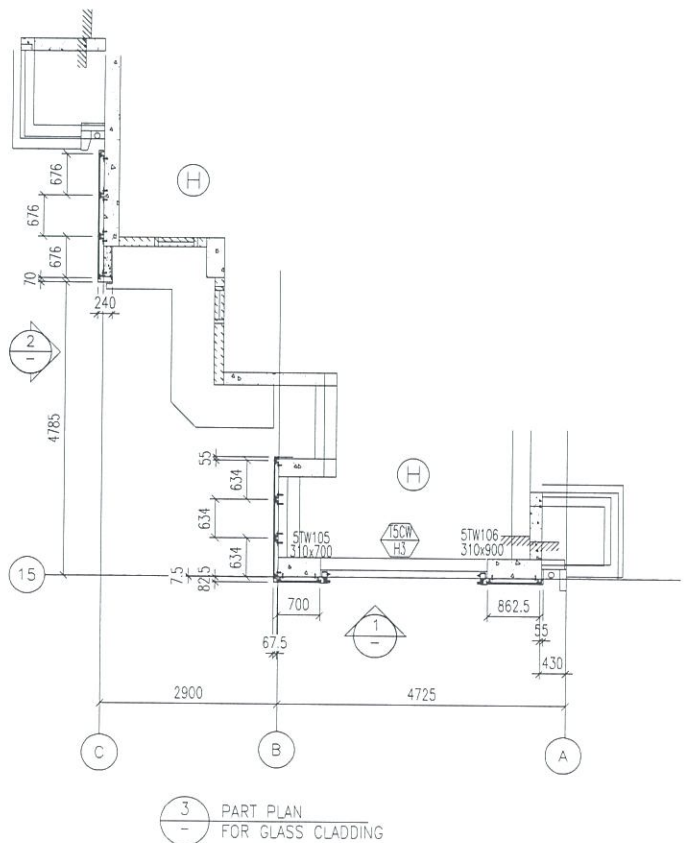

3 PART PLAN FOR GLASS CLADDING