

工程指示 / 要求簡箋(E.I.)

工程指示編號：EI/ 9808 /18

修改版次：

工程編號：J836

工程名稱：日出康城7期平台

工程項目：Cooling Tower Louver 鐵件

收件人：Maggie Lor

發件人：Joe Chan

日期：3/10/2018

要求提供 / 確認 事項：

- () 初步鋁料 B.M. () 加工拆圖，然後生產 () 尺寸表
- () 正式鋁料 B.M. () 技術上資料 / 指示 () 報價
- () 配件 B.M. () 樣辦或貨品說明書 () 分判合約
- () 其他：_____

內容：請依附件資料，安排訂購鐵件送地盤

★註：請以散件出貨，不用焊接！

請在 3/10/2018 前完成上列要求。

附有關圖紙 / 文件：

38頁

以上項目為：

- 原合約工程包 原合約工程加 / 減賬 新工程報價

原因：-

分發東莞各部門：

- () 生產技術總監 連附件 () 技術部 連附件 () 生產部 連附件 () 機械設計部 連附件
- () 採購部 連附件 () 生產統籌部 連附件
- () 質檢部 連附件 () 會計部 連附件 () 報關組 連附件 () 其他 _____ 連附件

分發香港各部門：

- () 行政部 連附件 () 會計部 連附件 () 統籌部 連附件 () 工程部地盤科文 連附件
- () 採購部 連附件 () QS 部 連附件 () 維修部 連附件 () 其他 _____ 連附件

積哥, 豪哥

傳遞編號：

發件人簽署：

項目經理簽署：

	美特鋁質有限公司	工程號: J836	計算:	日期: 3/10/2018	送呈:
	MIDI Aluminium Fabricator	地盤名稱: 日出康城7期平台	核對:	日期: 3/10/2018	副本:

地盤用鐵件B.M.表		項目類別: 鐵件 (Cooling Tower)	批准:	日期: 3/10/2018	總重量:	1433.3 KG
-------------------	--	--------------------------	-----	---------------	------	-----------

序號	修改標示	配件圖號	物料編號	配件名稱	顏色	實用	後備	總數	單位	單件重量	總重量	備注
鐵件拆圖					熱浸鋅							
1			M278	50x50x6mm 厚鐵角 L=100	熱浸鋅	275	14	289	件	0.44	127.16	
2			M708	75x50x5mm 厚鐵角 L=100	熱浸鋅	19	1	20	件	0.47	9.40	
3			M661	50x50x6mm 厚鐵角 L=100	熱浸鋅	19	1	20	件	0.44	8.80	
4			M683	100x50x5mm 厚鐵槽 L=564	熱浸鋅	17		17	件	5.12	87.01	
5			M683	100x50x5mm 厚鐵槽 L=570	熱浸鋅	49		49	件	5.17	253.46	
6			M684	100x50x5mm 厚鐵槽 L=2988	熱浸鋅	1		1	件	27.12	27.12	
7			M685	100x50x5mm 厚鐵槽 L=2521	熱浸鋅	1		1	件	22.88	22.88	
8			M686	100x50x5mm 厚鐵槽 L=2444	熱浸鋅	1		1	件	22.18	22.18	
9			M687	100x50x5mm 厚鐵槽 L=1913	熱浸鋅	1		1	件	17.36	17.36	
10			M688	100x50x5mm 厚鐵槽 L=1774	熱浸鋅	1		1	件	16.10	16.10	
11			M689	100x50x5mm 厚鐵槽 L=1636	熱浸鋅	1		1	件	14.85	14.85	
12			M690	100x50x5mm 厚鐵槽 L=1497	熱浸鋅	1		1	件	13.59	13.59	
13			M691	100x50x5mm 厚鐵槽 L=1358	熱浸鋅	1		1	件	12.32	12.32	
14			M692	100x50x5mm 厚鐵槽 L=1220	熱浸鋅	1		1	件	11.07	11.07	
15			M693	100x50x5mm 厚鐵槽 L=1834	熱浸鋅	1		1	件	16.64		
16			M694	100x50x5mm 厚鐵槽 L=3130	熱浸鋅	6		6	件	28.40	170.43	
17			M695	100x50x5mm 厚鐵槽 L=2990	熱浸鋅	16		16	件	27.13	434.15	
18			M696	100x50x5mm 厚鐵槽 L=3012	熱浸鋅	1		1	件	27.33	27.33	
19			M697	100x50x5mm 厚鐵槽 L=2170	熱浸鋅	1		1	件	19.69	19.69	
20			M698	100x50x5mm 厚鐵槽 L=1222	熱浸鋅	1		1	件	11.09	11.09	
21			M699	100x50x5mm 厚鐵槽 L=1269	熱浸鋅	1		1	件	11.52	11.52	
22			M700	100x50x5mm 厚鐵槽 L=1307	熱浸鋅	1		1	件	11.86	11.86	

2

		美特鋁質有限公司		工程號: J836		計算:		日期: 3/10/2018		送呈:		
MIDI Aluminium Fabricator		MIDI Aluminium Fabricator		項目類別: 鐵件 (Cooling Tower)		核對:		日期: 3/10/2018		副本:		
地盤用鐵件B.M.表		地盤名稱: 日出康城7期平台		批准:		日期: 3/10/2018		總重量:		1433.3 KG		
序號	修改標示	配件圖號	物料編號	配件名稱	顏色	實用	後備	總數	單位	單件重量	總重量	備注
23		T2-.11	M701	100x50x5mm 厚鐵槽 L=1335	熱浸鋅	1		1	件	12.12	12.12	
24		T2-.12	M702	100x50x5mm 厚鐵槽 L=1354	熱浸鋅	1		1	件	12.29	12.29	
25		T2-.13	M703	100x50x5mm 厚鐵槽 L=1384	熱浸鋅	1		1	件	12.56	12.56	
26		T2-.14	M703	100x50x5mm 厚鐵槽 L=1364	熱浸鋅	1		1	件	12.38	12.38	
27		T2-.15	M704	100x50x5mm 厚鐵槽 L=3019	熱浸鋅	1		1	件	27.40	27.40	
28		T2-.16	M705	100x50x5mm 厚鐵槽 L=1294	熱浸鋅	1		1	件	11.74	11.74	
29		T2-.17	M706	100x50x5mm 厚鐵槽 L=1706	熱浸鋅	1		1	件	15.48	15.48	
							總計	439	件		1433.33	

4

构件编号	规格(mm)	数量	单重(kg)	共重(kg)	长度(m)	重量(kg)
M278	RSAS075075	100	4	0.38	1.52	0.02
M683	PFC-100*50*5	1	5.53	5.53	0.24	0.24
M278	RSAS075075	4	0.38	1.52	1.52	0.02
合计:				7.05		

50x50x6mm THK GMS
KNAUF (L=100)

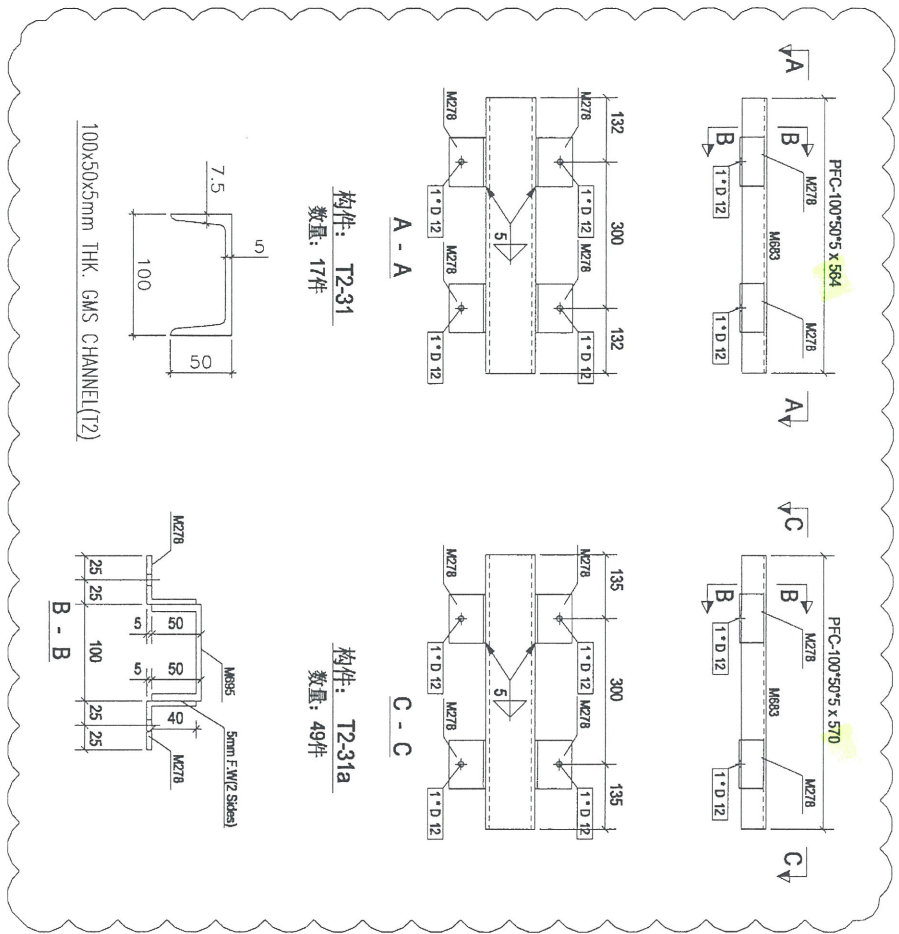

构件: T2-31
数量: 17件

构件: T2-31a
数量: 49件

100x50x5mm THK GMS CHANNEL(T2)

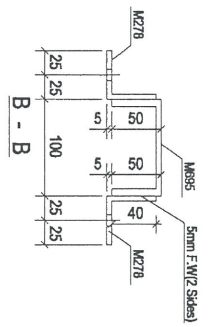

112

Rev	Description	Date
A	第2次报批	2018-08-10

PROJECT: PROPOSED SITE C1
DEVELOPMENT IN AREA 08,
KOTU LORIP, TISING RIVANJO,
NEW TERRITORIES

CLIENT: 美特经贸有限公司
MIDI ALUMINUM PRODUCTS LTD.
Units 5-8, Sunny Industrial Centre, 1/F
610 Cho Kuo Ling Road, Kowloon
Tel: 23489211-4 Fax: 65227272/7665

银同有限公司
Silver Town Limited
Tel: 0789-4339888 Fax: 0789-4339854
E-MAIL: A008553@silvertown.hk.com

DRAWING TITLE: T2-31

Designated by	Drawn by	Reviewed by	Approved by	Scale

CAD File Name :
DWG NO.: FL-C.T - T2-31

REV	DATE
A	

5

料件编号	规格(单位)	数量	重量(吨)	共重(吨)	表面面积(平方米)
M278	SSA5075075	100	0.39	3.04	0.02
M894	PC-10075075	2988	1	27.69	1.17
合计:				30.73	

50x50x6mm 7K GMS
K1615 (L=100)

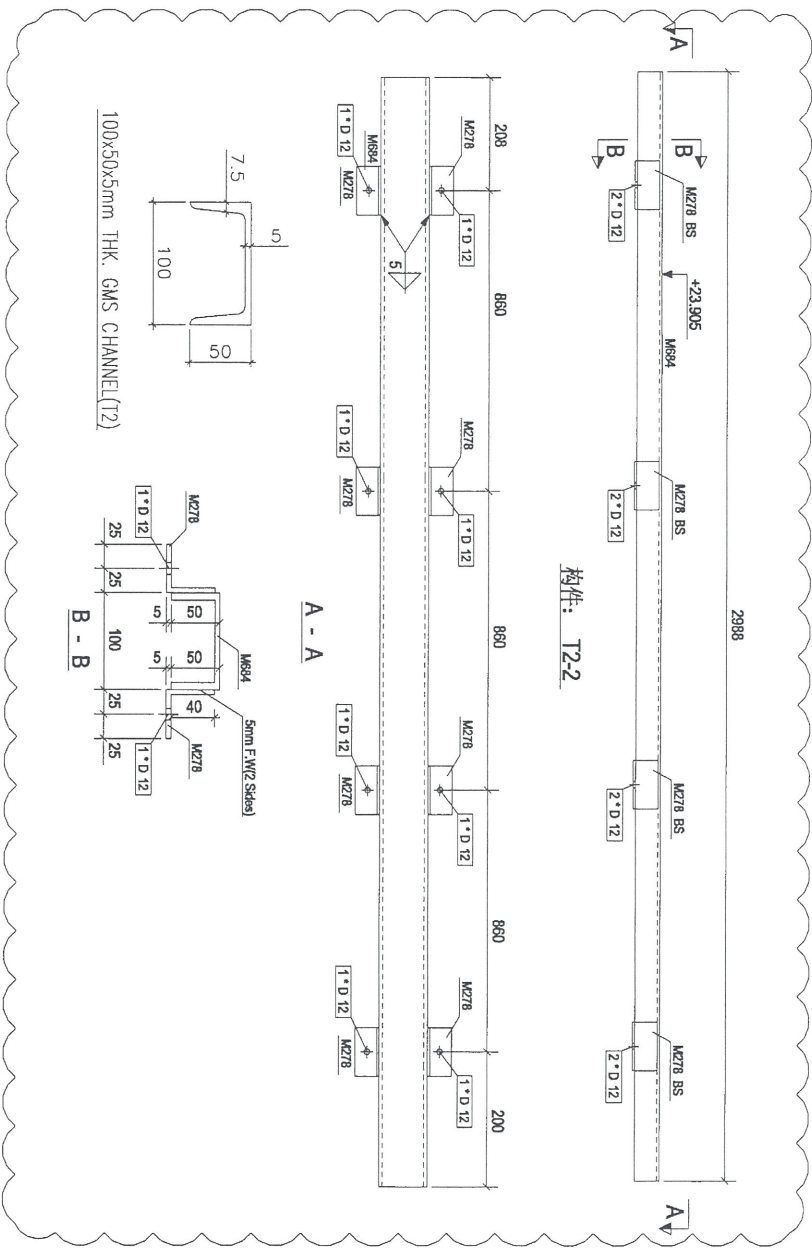

83

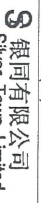
Rev	A	第2次批准	2018-08-10
PROJECT:	PROPOSED SITE C1 DEVELOPMENT AT BEGA BR, TKOTI TO BE IN SENANGKANG, NEW TERRITORIES		
CLIENT:	 美特经贸有限公司 MID AUTOMOTIVE MANUFACTURE LTD. Units 9-R, Sunray Industrial Centre, 1/F 51D Chiu Kee Long Road, Kowloon Tel: 23883111-4 Fax: (852) 27276585		
DRAWING TITLE:	 银同有限公司 Silver Town Limited Tel: 0789-8356998 Fax: 0789-8339994 E-MAIL: ADMIN@SILVERTOWN.HK.COM		
CAD File Name:	[T2-2]		
Designed by			
Drawn by			
Reviewed by			
Approved by			
Scale			
IMG NO.:	F.L.C.T - [T2-2]		RRK
			A

6

物料编号	规格	长度(m)	数量	重量(kg)	共重量(kg)	重量(m³)
M278	RS360*50*5	100	8	0.38	3.04	0.02
M895	PC-100*50*5	2821	1	23.39	23.39	0.99
合计:				28.43		

50x50x5mm THK GMS
Angles (L=100)

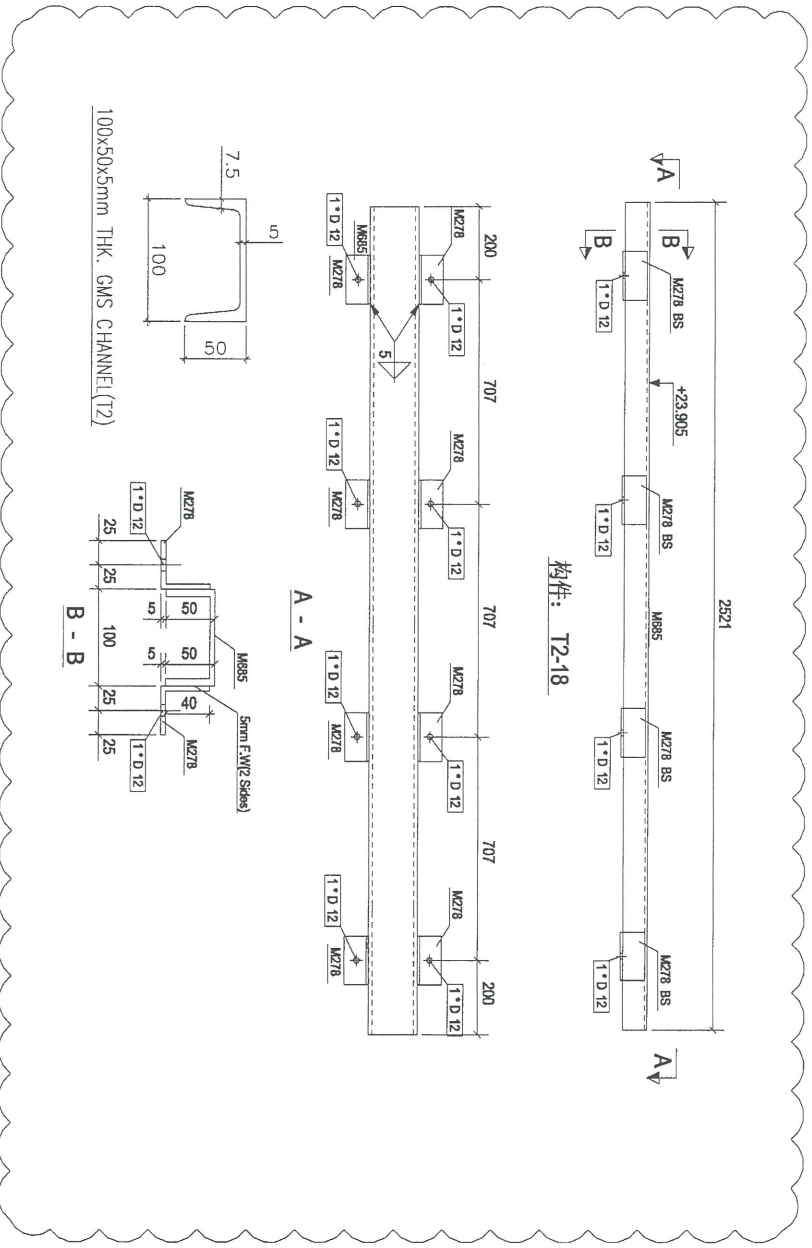

937

Rev.	Description	Date
A	第2次排批	2018-08-10

PROJECT: PROPOSED SITE C1
DEVELOPMENT AT AGEN 88,
TJOI L10/F, TSEUNG KUAN O,
NEW TERRITORIES

CLIENT: 美特铝业有限公司
MIDI Aluminium Manufacturing Ltd.
Units 6-8, Sunny Industrial Centre, 1/F
610 Chee Koo Eng Road, Kwun Tong
Tel: (852) 4892711-4 Fax: (852) 71727655

银同有限公司
Silver Town Limited
Tel: (852) 63534968 Fax: (852) 63535854
E-Mail: ADDRESS@silvertown.com.hk

DRAWING TITLE: T2-181

Scale	Scale
Scale	

Design by	Drawn by	Reviewed by	Approved by

DWG NO.: FL-C.T - [T2-181]

7

零件编号	材料	长度(mm)	数量	重量(kg)	共重量(kg)	表面积(m ²)
M278	MS30505	100	6	0.38	3.04	0.02
M886	PPC-1005305	2444	1	22.71	22.71	0.98
合计:				25.75		

50x50x6mm THK GUNS
ANKLE (L=100)

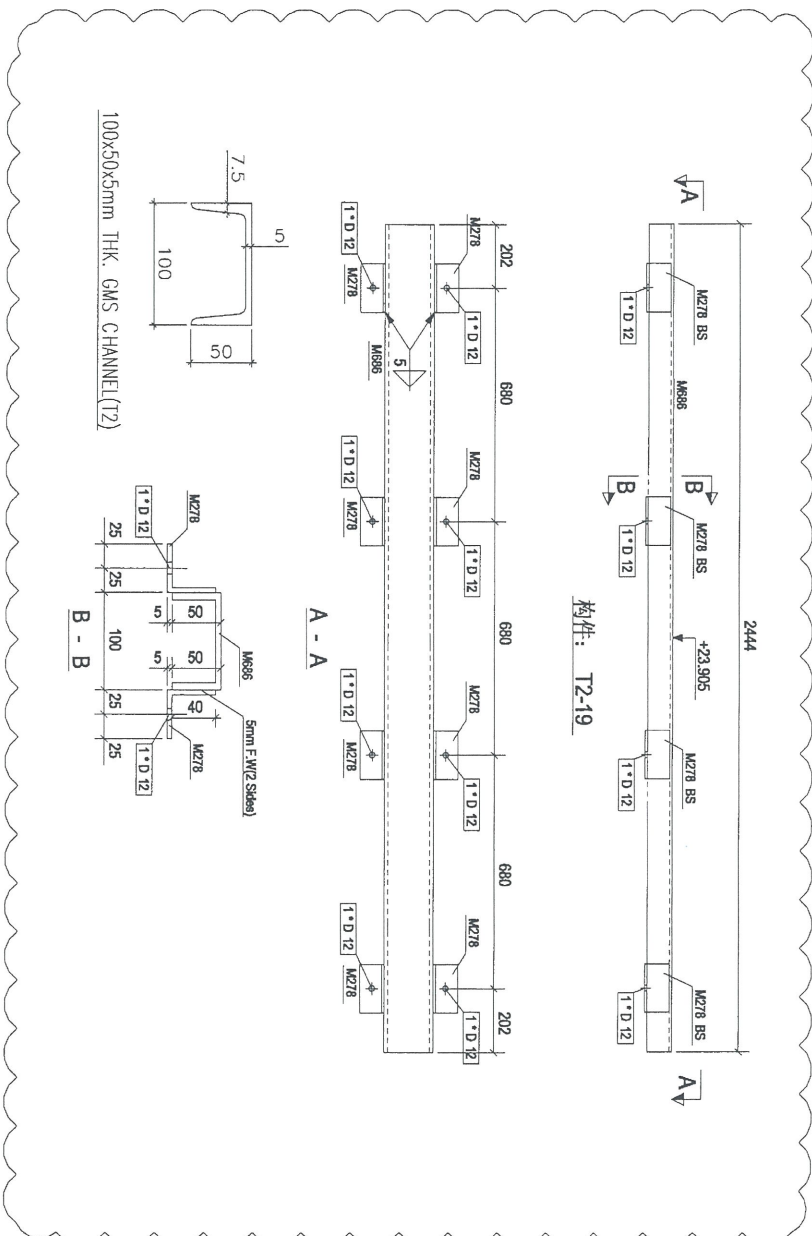

Rev	A	第2次推批	2018-08-10
PROJECT:	PROPOSED SITE C1 DEVELOPMENT AT AGEN 08, TWO LING TSI, TSUNG KUAN O, NEW TERRITORIES		
CLIENT:	美特铝业有限公司 MIDI Aluminium Fabrication Ltd. Units 6-8, Sunny Industrial Centre, 1/F 610 Chee Kwo Ling Road, Kowloon Tel: 23489211-4 Fax: (852) 27276868 E-MAIL: ADDRESS@midialuminium.com.hk		
DRAWING TITLE:	银同有限公司 Silver Town Limited Tel: 0769-83334988 Fax: 0769-83339854 E-MAIL: ADDRESS@silvertown.com.hk		
CAD File Name:	T2-191		
Designed by			
Drawn by			
Reviewed by			
Approved by			
Scale			
DWG NO.:	F.L.C.T - (T2-191)		
REV	A		

8

零件编号	数量	重量	体积	长度	直径	重量	长度	直径
M278	100	0.38	2.28	1913	17.82	17.82	0.76	0.02
M887	1	17.82	17.82	1913	17.82	17.82	0.76	0.02
合计:	101	18.20	20.10					

50x50x5mm THK studs
Anchors (C2100)

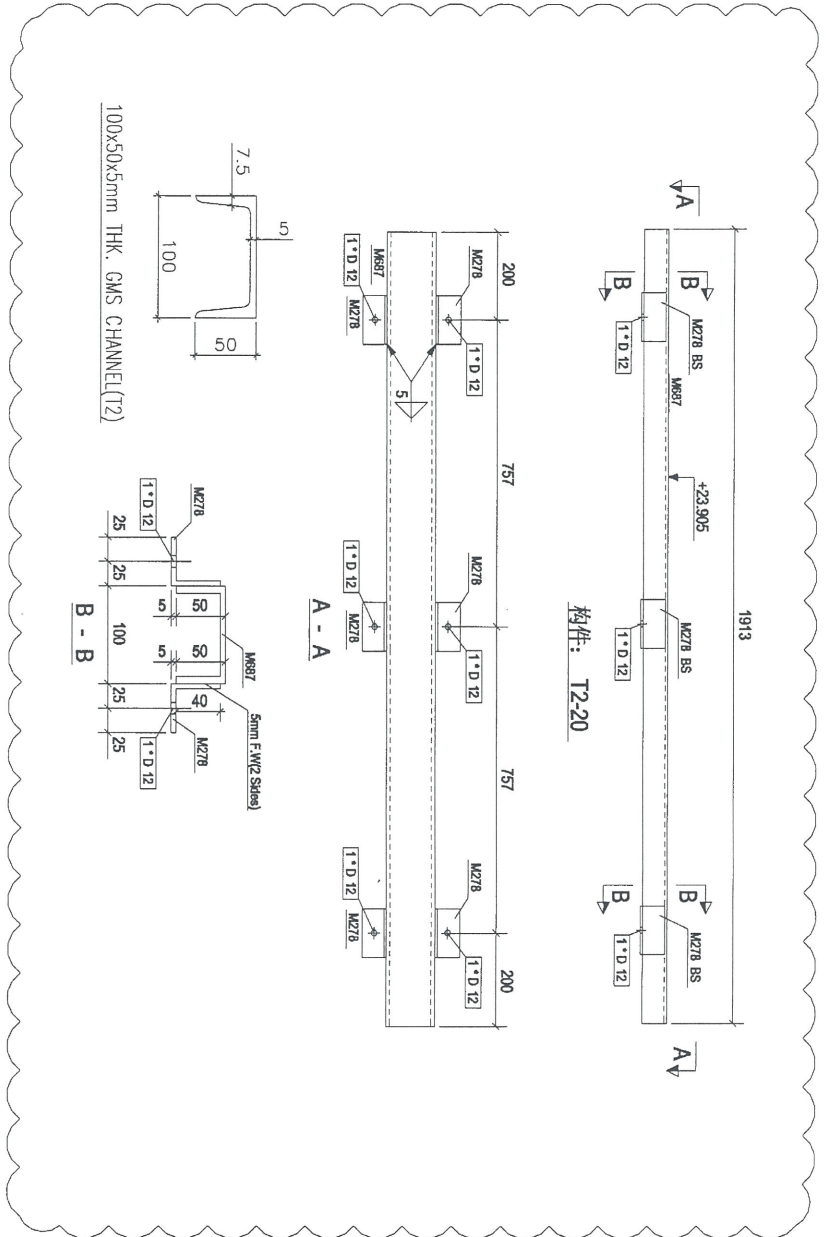

101

Rev.	Description	Date
A	第2次排板	2018-08-10

PROJECT: PROPOSED SITE C1
DEVELOPMENT AT AGEN 88,
KOTEL ROAD, TSEUNGKWAN O,
NEW TERRORIES

CLIENT: 美特鋁質有限公司
MIDI Aluminium Fabricator Ltd.
Units 6-8, Sunny Industrial Centre, 1/F
610 Chee Kwo Eng Road, Kowloon
Tel: 24248921-4 Fax: (852) 7777656

銀同有限公司
Silver Town Limited
Tel: 078-4339486 Fax: 078-4339854
E-MAIL: ADRES@silvertown.com.hk

DRAWING TITLE: [T2-201]

CAD File Name:

Designed by

Drawn by

Reviewed by

Approved by

Scale

DWGNO.: FL-C1 - [T2-201]

REV. A

9

零件编号	数量	单位	重量	共重
M278	100	个	0.38	38.00
M898	1	个	16.56	16.56
合计:				54.56

50x50x5mm THK CMS CHANNEL (12)
 50x50x5mm THK CMS

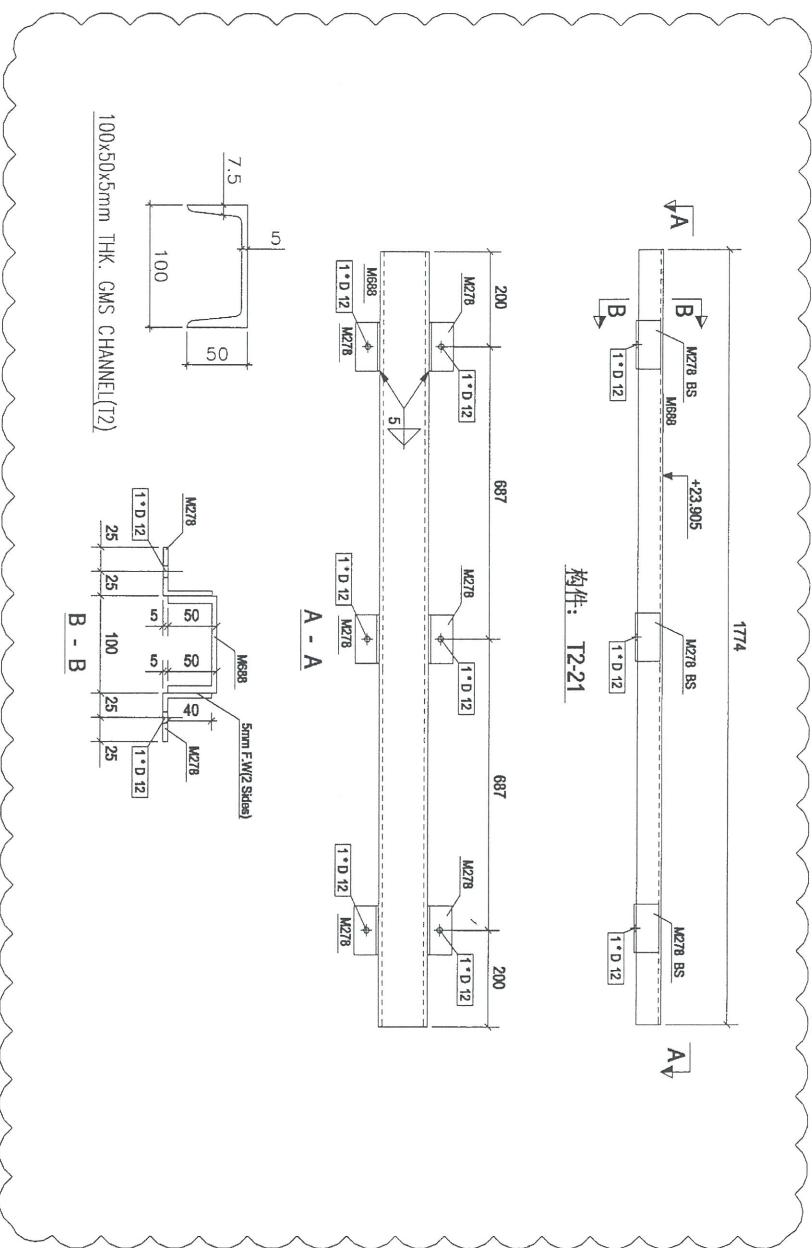

102

Rev.	A	第2次排批	2018-08-10
PROJECT:	PROPOSED SITE C1 DEVELOPMENT AT AGEN 88, TIOU TUNG TUNG TUNG TUNG, NEW TERRITORIES		
CLIENT:	美特铝业有限公司 MID I Aluminum Fabricators Ltd. Units 5-8, Sangr Industrial Centre, 1/F 610 Chee Kee Ling Road, Kowloon Tel: 23498211-4 Fax: (852) 27277686		
	银同有限公司 Silver Town Limited Tel: 076-8339868 Fax: 076-8339854 E-MAIL: ADDRESS@silvertown.com.hk		
DRAWING TITLE:	T2-211		
CAD File Name:			
Designed by:			
Drawn by:			
Reviewed by:			
Approved by:			
Scale:			
DWG NO.:	FL-CT - T2-211		
REV.	A		

10

零件编号:	T2-22	零件数量:	1	零件重量:	17.58
图存编号:	原形图	长度(mm)	100	重量(g)	0.38
M278	RS3A75075	数量	6	重量(g)	2.28
M899	PTC-10075075	长度(mm)	1636	重量(g)	15.30
		数量	1	重量(g)	0.85
合计:				17.58	

50x50x5mm T1K-GMS
Axis LG (L=100)

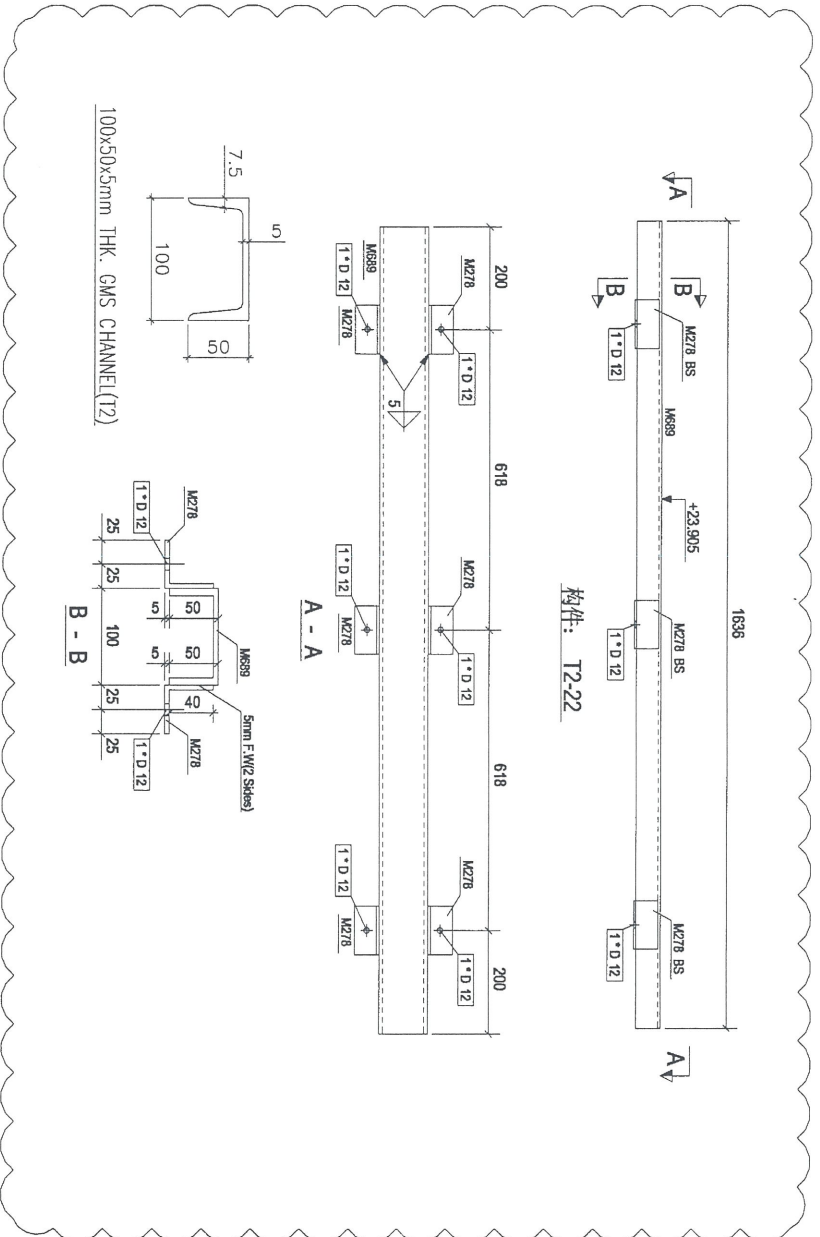

103

Rev	A	第2次改批	2018-08-10
PROJECT:	PROPOSED SITE C1 DEVELOPMENT AT AREA 88, TKOIL TOWN, TSEUNG KUN WAI, NEW TERRITORIES		
CLIENT:	美特銀寶有限公司 MIDI Aluminium Fabricator Ltd. Unit 6-8, Sunny Industrial Centre, 1/F 610 Chee Koo Ling Road, Kwunshan Tel: 23489271-4 Fax: (852) 27727855		
	銀同有限公司 Silver Town Limited Tel: 0769-8335958 Fax: 0769-8335954 E-mail: address@silvertown.com.hk		
DRAWING TITLE:	[T2-22]		
CAD File Name:			
Designed by			
Drawn by			
Reviewed by			
Approved by			
Scale			
DWG NO.:	F.L-C-1	-	[T2-22]
REV	A		

111

零件编号	172-23	零件数量	1	零件重量	16.32
零件编号	规格(mm)	长度(mm)	重量	单重(吨)	共重(吨)
MZ78	RSAS975	100	0.38	2.28	0.02
M690	PC-100*975	1497	1	14.04	0.80
合计:				16.32	

50x50x6mm THK GMS
 174
 16.32

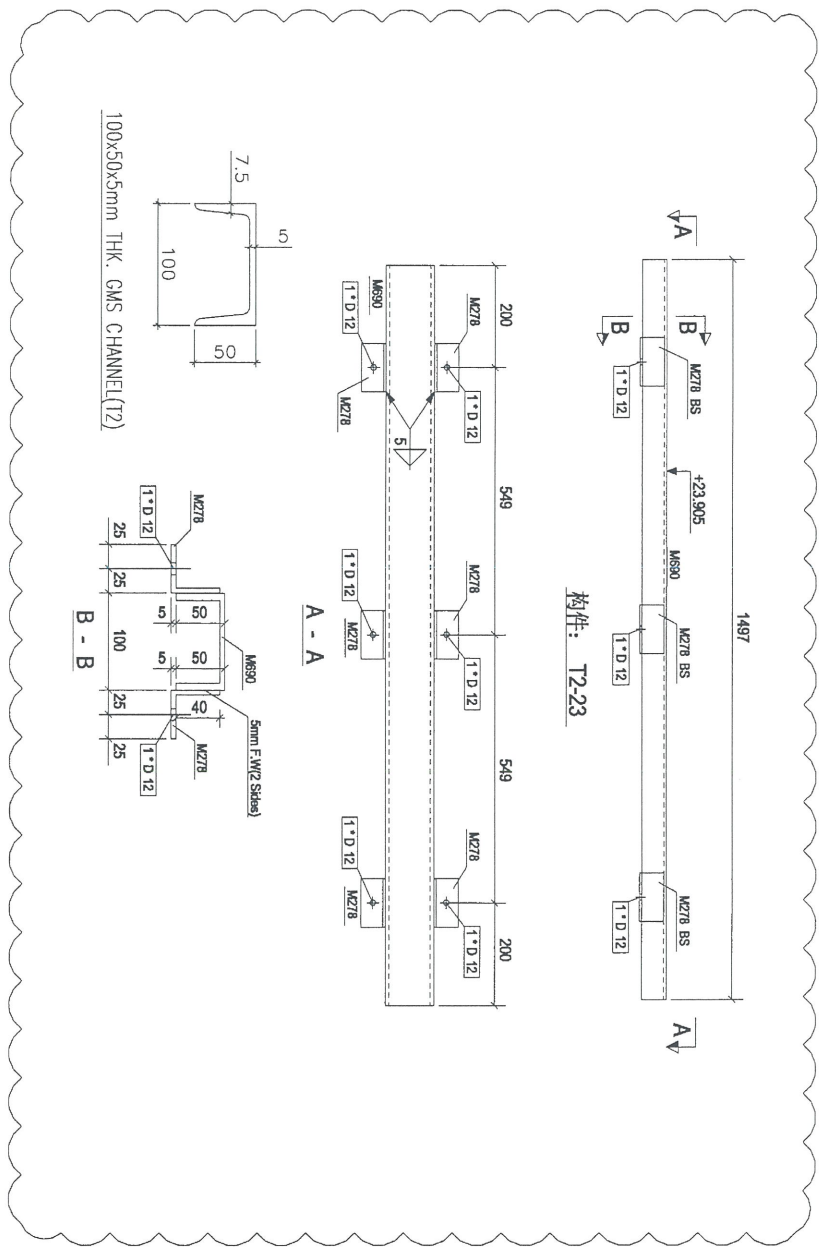

100x50x5mm THK. GMS CHANNEL(T2)

构件: T2-23

174

Rev	A	第2次批准	2018-08-10
PROJECT:	PROPOSED SITE C1 DEVELOPMENT IN AGRIC. TRACT FOR THE TSDONG NANNO. NEW THERMIDRES		
CLIENT:	美特铝质有限公司 MID I Aluminum Fabrication Ltd. Unit 5-B, Sang Industrial Centre, 1/F 510 Chee Koo Ling Road, Kowloon Tel: (852) 27277686 Fax: (852) 27277686		
	银同有限公司 Silver Town Limited Tel: 0769-8359988 Fax: 0769-8359954 E-mail: admin@silvertown.com.hk 1831309		
DRAWING TITLE:	T2-231		
CAD File Name:			
Designed by			
Drawn by			
Reviewed by			
Approved by			
Scale			
DWG NO.:	FL-C.T	-	T2-231
REV	A		

12

零件编号	数量	材料	长度(m)	重量(kg)	共重(kg)	备注
M278	100	RS450S05	4	0.38	1.52	
M891	1358	PC-100*50*5	1	12.78	12.78	
合计:					14.30	

50x50x6mm THK 6mm
 ANGLE (L=100)

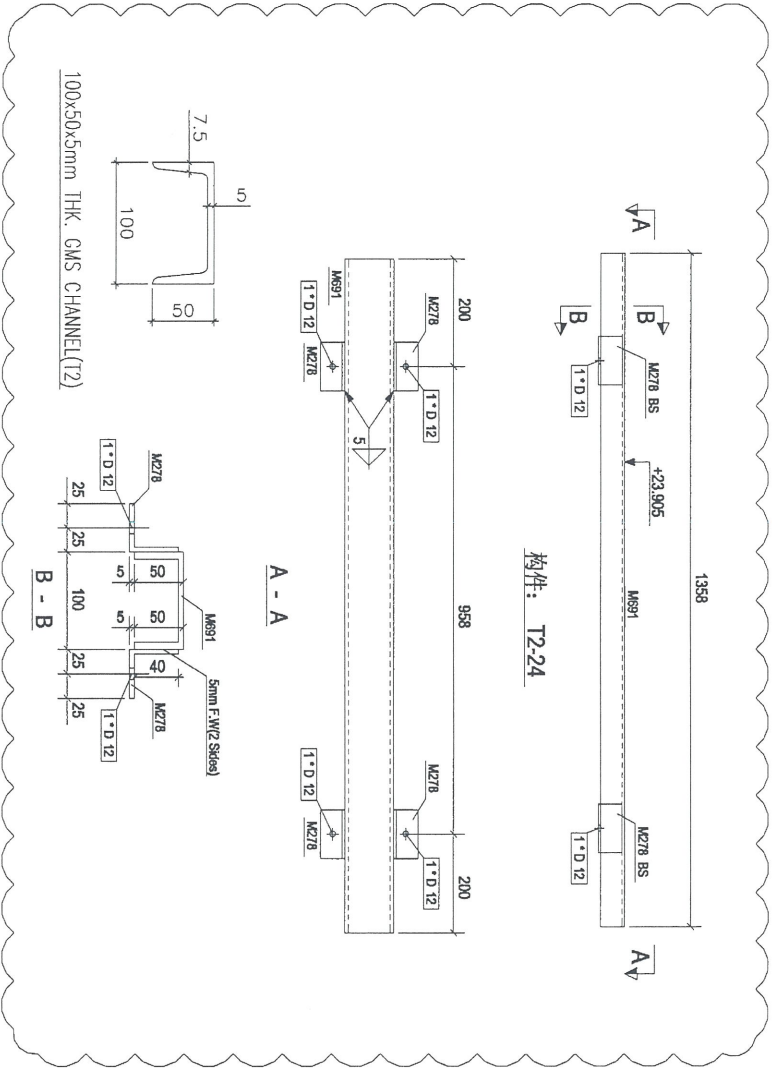

(25)

Rev.	Description	Date
A	第2次排数	2018-08-10

PROJECT: PROPOSED SITE C1
 DEVELOPMENT AT AGEN 08,
 TAOILITHIP, NISUNGKHAM O,
 NEW TERRITORIES

CLIENT: 美特铝质有限公司
 MID I Aluminium Fabricator Ltd.
 Units 6-8, Sanyong Industrial Centre, 1/F
 610 Chee Koo Eng Road, Kowloon
 Tel: (852) 27277888 Fax: (852) 27277888

银同有限公司
 Silver Town Limited
 Tel: 076-8335488 Fax: 076-8335854
 E-mail: a00855@silvertown.com.hk

DRAWING TITLE: [T2-24]

CAD File Name:	
Designed by	
Drawn by	
Reviewed by	
Approved by	
Scale	

DWG NO.: FL-C1 - [T2-24]

13

零件编号	数量	单重(kg)	共重(kg)	长度(m)	数量	单重(kg)	共重(kg)	长度(m)
M278	4	0.38	1.52	100	4	0.38	1.52	0.02
M892	1	11.52	11.52	1220	1	11.52	11.52	0.48
合计			13.03					

100x50x5mm THK
 100x50x5mm THK
 100x50x5mm THK
 100x50x5mm THK

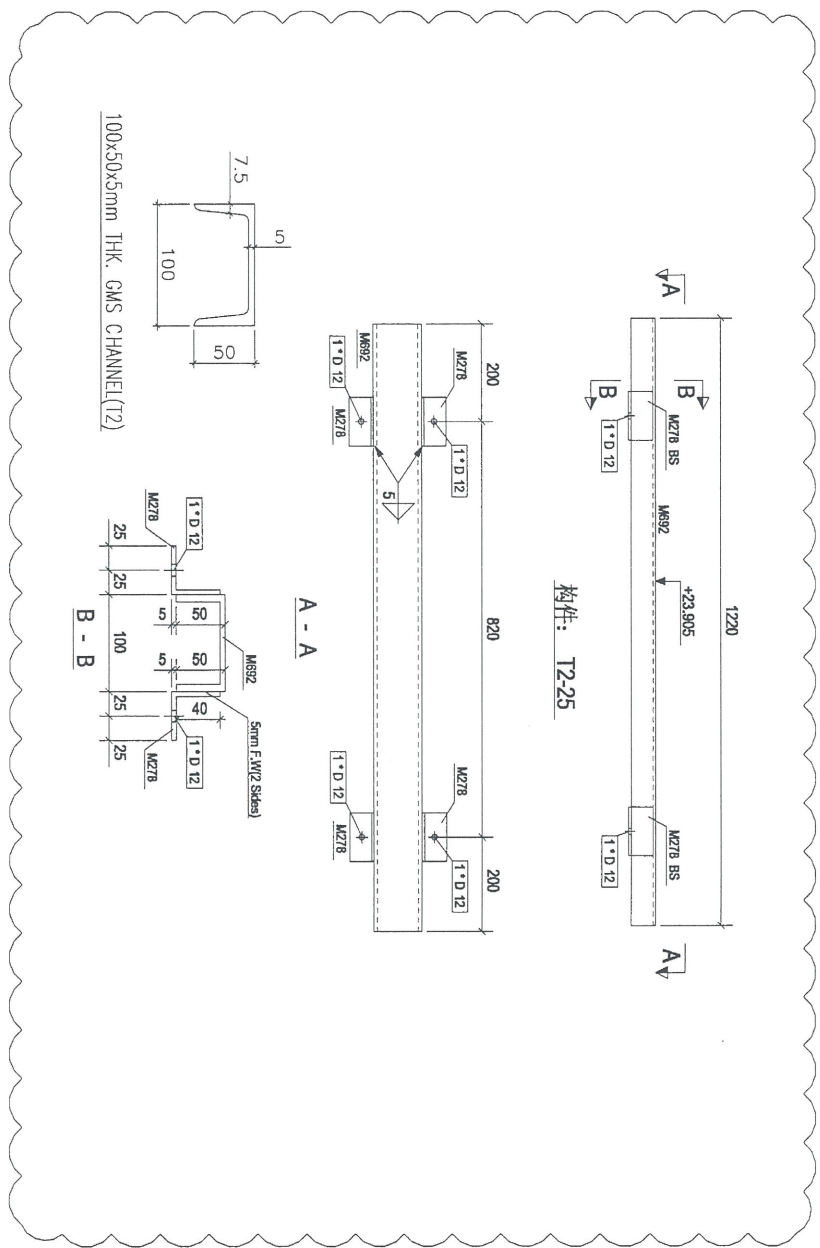

构件: T2-25

100x50x5mm THK, GMS CHANNEL(12)

13

Rev	A	第2次拆批	2018-08-10
PROJECT:	PROPOSED SITE C1 DEVELOPMENT AT AREA B8, TKOIT ZHUI PEI TSEUNG KWAN O, NEW TERRITORIES		
CLIENT:	美特铝质有限公司 MID I ALUMINIUM FABRICATOR LTD. Units 6-8, Sunny Industrial Centre, 1/F 510 Chee Koo Ling Road, Kowloon Tel: 23483211-4 Fax: (852) 2727885		
DRAWING TITLE:	银同有限公司 Silver Town Limited Tel: 0769-8334964 Fax: 0769-8335954 E-mail: ADDRESS@silvertown.hk		
CAD File Name:	T2-251		
Designed by			
Drawn by			
Reviewed by			
Approved by			
Scale			
DWG NO.:	FL-C-T	- [T2-25]	
REV			A

14

零件编号	12-30	数量	1	单重(kg)	共重(kg)	容重(kg/m ³)
M961	ISA50*50*5	100	3	0.38	1.14	0.02
M963	PLC-100*50*5	1834	1	16.92	16.92	0.72
M708	ISA75*50*5	100	3	0.47	1.41	0.03
合计:					19.38	

50x50x6mm THK GMS
Anchor (L=100)

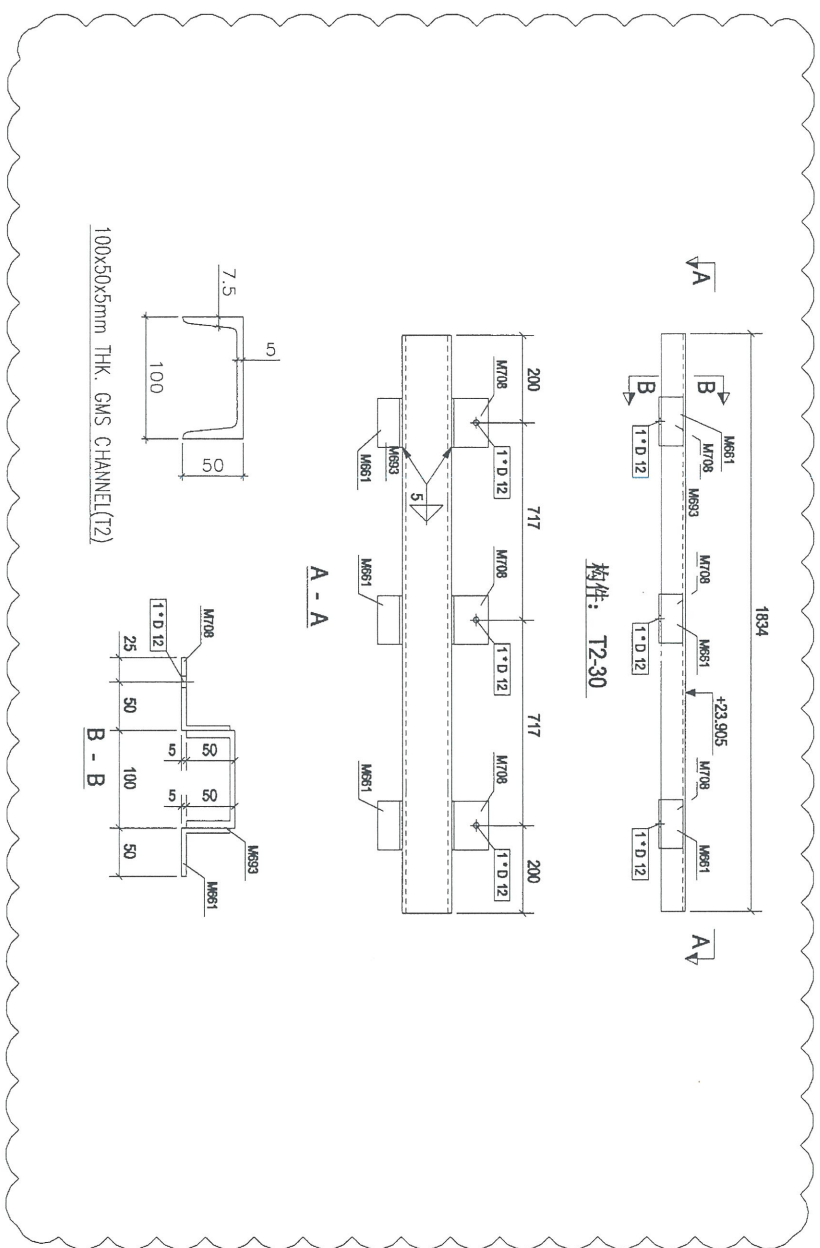

Rev.	A	第2次修版	2018-08-10
PROJECT:	PROPOSED SITE C1 DEED MOUNTAIN GARDEN, TKOIL TO RE-DEVELOPMENT, NEW TERRACES		
CLIENT:	美特铝业有限公司 MIDT ALUMINIUM FABRICATOR Sdn. Bhd. Units 6-8, Sunny Industrial Centre, 1/F 610 Shek Kwo Lung Road, Kowloon Tel: 23495211-4 Fax: (852) 27270868		
DRAWING TITLE:	银同有限公司 Silver Town Limited Tel: 0769-4335988 Fax: 0769-4335954 E-mail: address@silvertown.com.hk		
CAD File Name:	T2-301		
Designed by			
Drawn by			
Reviewed by			
Approved by			
Scale			
DWG NO.:	FL-C-T	-	T2-301
REV.			A

15

零件编号	规格	数量	重量	体积	长度	直径	厚度
M894	PFC-100*50*5	1	28.87	28.87	1.22		
M278	R3450750*5	8	0.38	3.04	0.02		
合计:			31.91				

50x50x5mm THK GMS CHANNEL (12)
 共 6 根

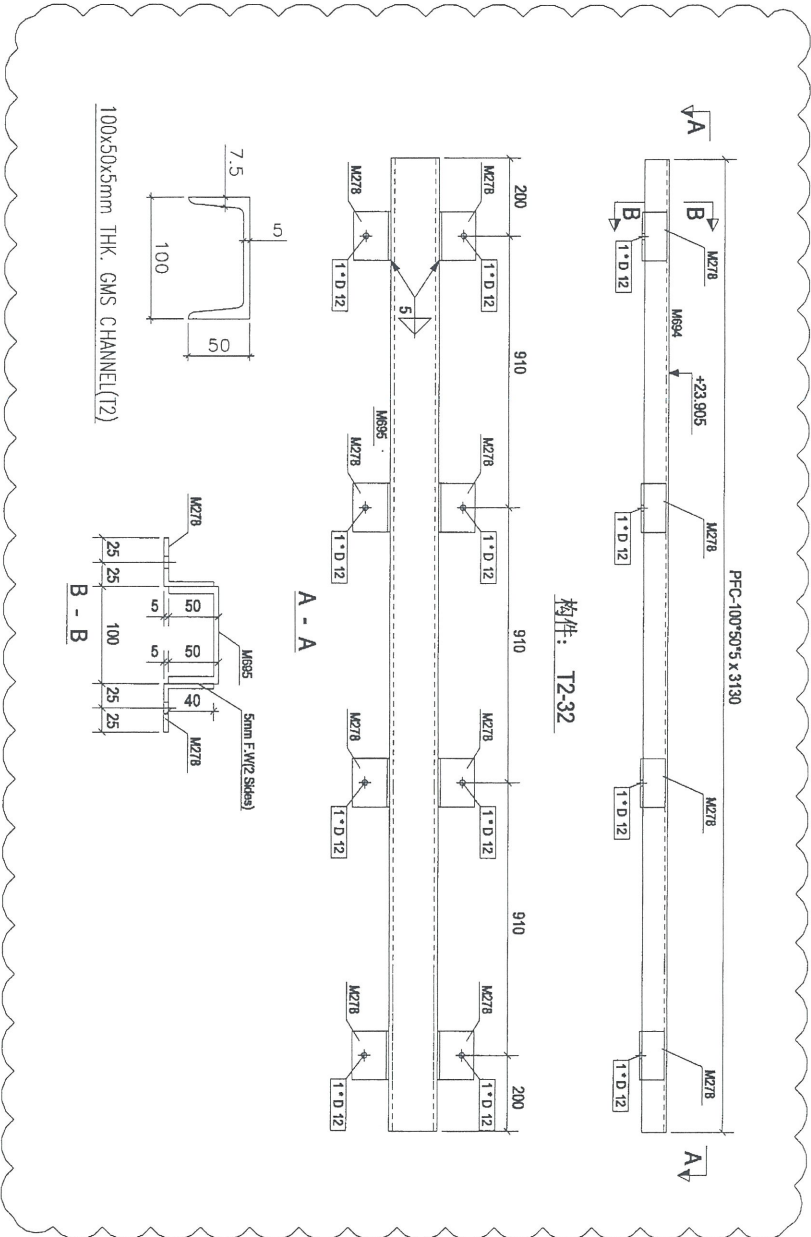

113

Rev.	A	第2次修版	2018-08-10
PROJECT:	PROPOSED SITE C1 DEVELOPMENT AT AREA 88, KOTILONG, TAIPEING KAWAO, NEW TERRORIES		
CLIENT:	美特銀寶有限公司 MID I AMERICA FINANCIAL LTD. Units 6-8, Sunny Industrial Centre, 1/F 510 Chee Kwoong Road, Kowloon Tel: (852) 489211-4 Fax: (852) 7727858		
DRAWING TITLE:	銀同有限公司 Silver Town Limited Tel: (852) 4333486 Fax: (852) 4333894 E-MAIL: ADDRESS: info@silvertown.com.hk		
CAD File Name:	[T2-32]		
Designed by:			
Drawn by:			
Reviewed by:			
Approved by:			
Scale:			
DWG NO.:	FL-C1	-	[T2-32]
REV.	A		

16

零件编号	数量	长度(m)	重量(kg)	体积(m ³)	重量(kg)	体积(m ³)
M278	8	100	0.38	3.08	0.02	
M895	1	2990	27.58	27.58	1.17	
合计:						30.61

150x50x6mm THK
GWS APPS (L=2990)

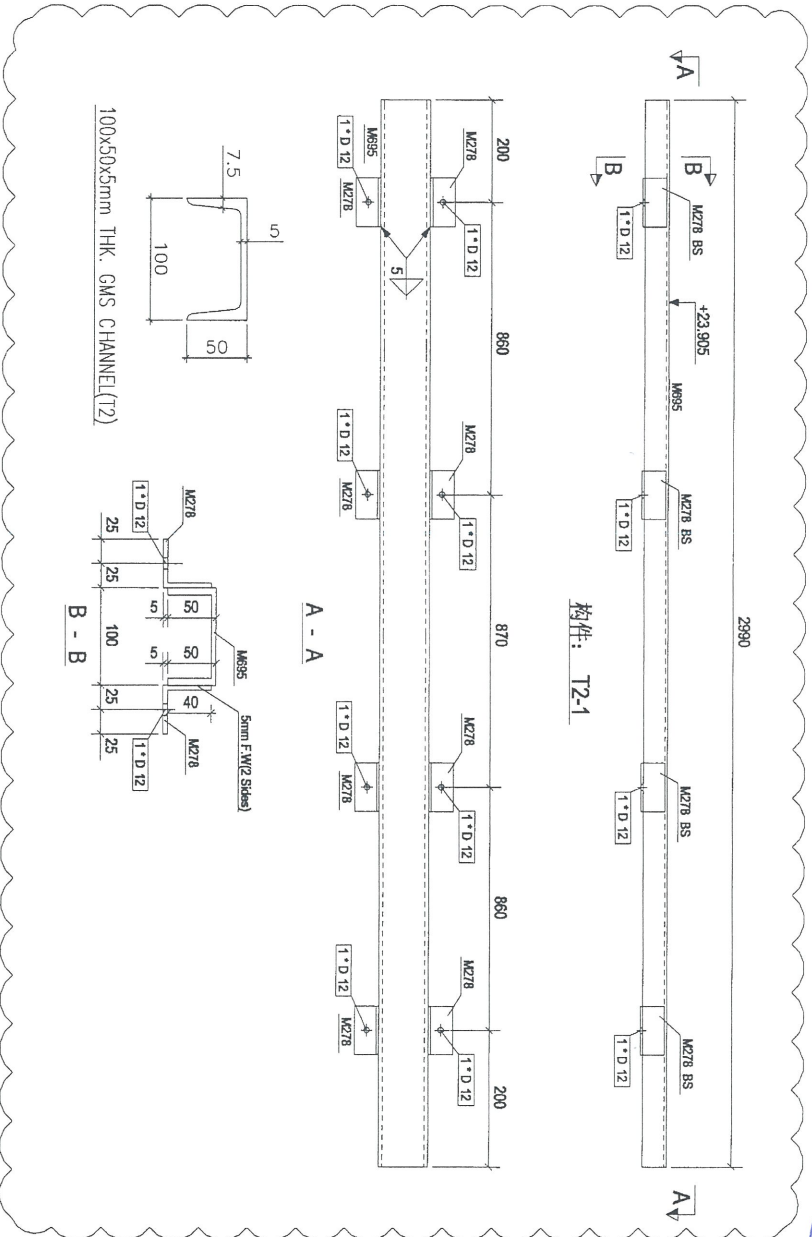

100x50x5mm THK. GWS CHANNEL(T2)

24.

82

Rev	A	第2次修版	2018-08-10
PROJECT:	PROPOSED SITE C1 DEVELOPMENT AT AGEN 08, TKO LIDING, TSEUNGKUN M.O., NEW TERRITORIES		
CLIENT:	美特铝业有限公司 MIDI Aluminium Fabricator Ltd. Units 6-8, Sunny Industrial Centre, 1/F 610 Chee Kwo Ling Road, Kowloon Tel: (852) 27272655		
	银同有限公司 Silver Town Limited Tel: (876) 4333498 Fax: (876) 4333854 E-mail: ADDRESS@silvertown.com.hk		
DRAWING TITLE:	T2-11		
CAD File Name:			
Designed by			
Drawn by			
Reviewed by			
Approved by			
Scale			
DWG NO.:	FL-C.T	-	[T2-11]
REV	A		

17

零件编号	数量	单位	重量(kg)	共重量(kg)	表面积(m ²)
M278	100	个	0.38	3.94	0.02
M895	1	个	27.59	27.59	1.17
合计:				30.73	

50x50x6 mm in the ends
 50x50x6 mm in the ends

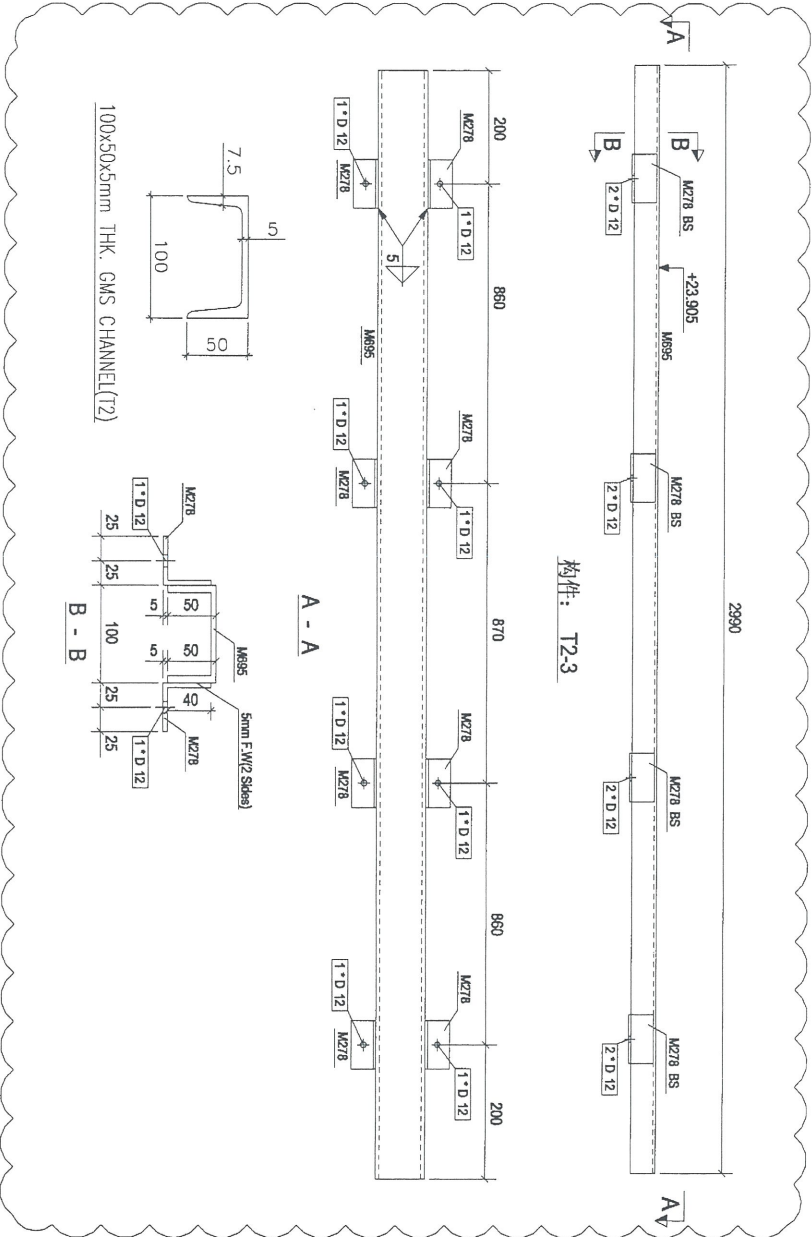

100x50x5mm THK. GMS CHANNEL(T2)

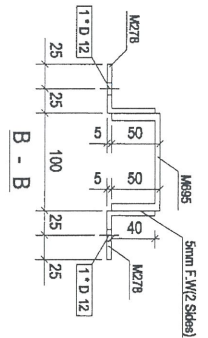

Rev.	Description	Date
A	第2次排批	2018-08-10

PROJECT: PROPOSED SITE C1
 DEVELOPMENT AT PAFB108,
 TROTTON RD, TSEUNG WAN N.O.,
 NEW TERRITORIES

CLIENT: 美特鋁質有限公司
 MID1 Aluminium Fabrication Ltd.
 Unit 5-B, Sunny Industrial Centre, 1/F
 510 Ono Kuo Ling Road, Kowloon
 Tel: 23892111-4 Fax: (852) 27275685

銀同有限公司
 Silver Town Limited
 Tel: 076-83391861 Fax: 076-8339854
 E-MAIL: ADDRESS@silvertown.hk

DRAWING TITLE: [T2-3]

CAD File Name: [T2-3]

Designed by: [Signature]

Drawn by: [Signature]

Reviewed by: [Signature]

Approved by: [Signature]

Scale: [Signature]

DWG NO.: FL-C.T - [T2-3]

REV: A

18

物料编号	规格	数量	单位	重量	备注
M278	SSAS075075	100	个	0.38	
M895	PC-10075075	2990	1	27.58	
合计:				30.73	

50x50x6mm 3根 4mm
 4x4x4 (L=100)

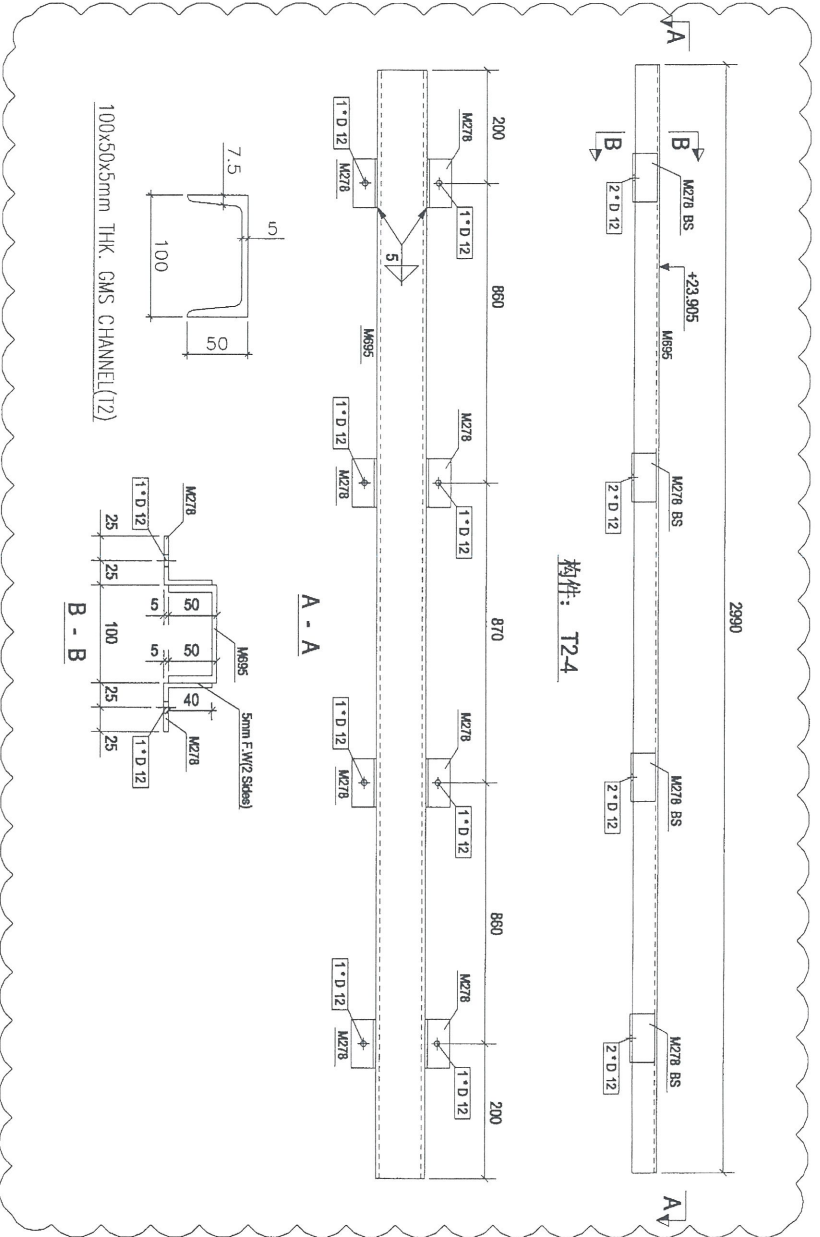

100x50x5mm THK GMS CHANNEL(T2)

构件: T2-4

85

Rev	Description	Date
A	第2次排板	2018-08-10

PROJECT: PROPOSED SITE C1
 DEVELOPMENT AT KACHAK,
 TROTILOV, BEOGRADSKO
 NEW TERRITORIES

CLIENT: 美特铝业有限公司
 MIDJ ALUMINUM MANUFACTURE LTD.
 Unit 5-B, Sunny Industrial Centre, 1/F
 510 Chee Koo Ling Road, Kowloon
 Tel: 23489211-4 Fax: (852) 27272685

银同有限公司
 Silver Town Limited
 Tel: 0789-8335898 Fax: 0789-8335954
 E-MAIL: ADMIN@SILVERTOWN.COM.HK

DRAWING TITLE: [T2-4]

CAD File Name:	
Designed by:	
Drawn by:	
Reviewed by:	
Approved by:	
Scale:	
DWG NO.:	FLCT - [T2-4]
REV.	A

20

零件编号	数量	重量	共重
M861	100	0.38	1.52
M895	1	21.59	1.17
M708	100	0.47	1.88
合计			30.99

50x50x6mm THK GMS
 零件: T2-26

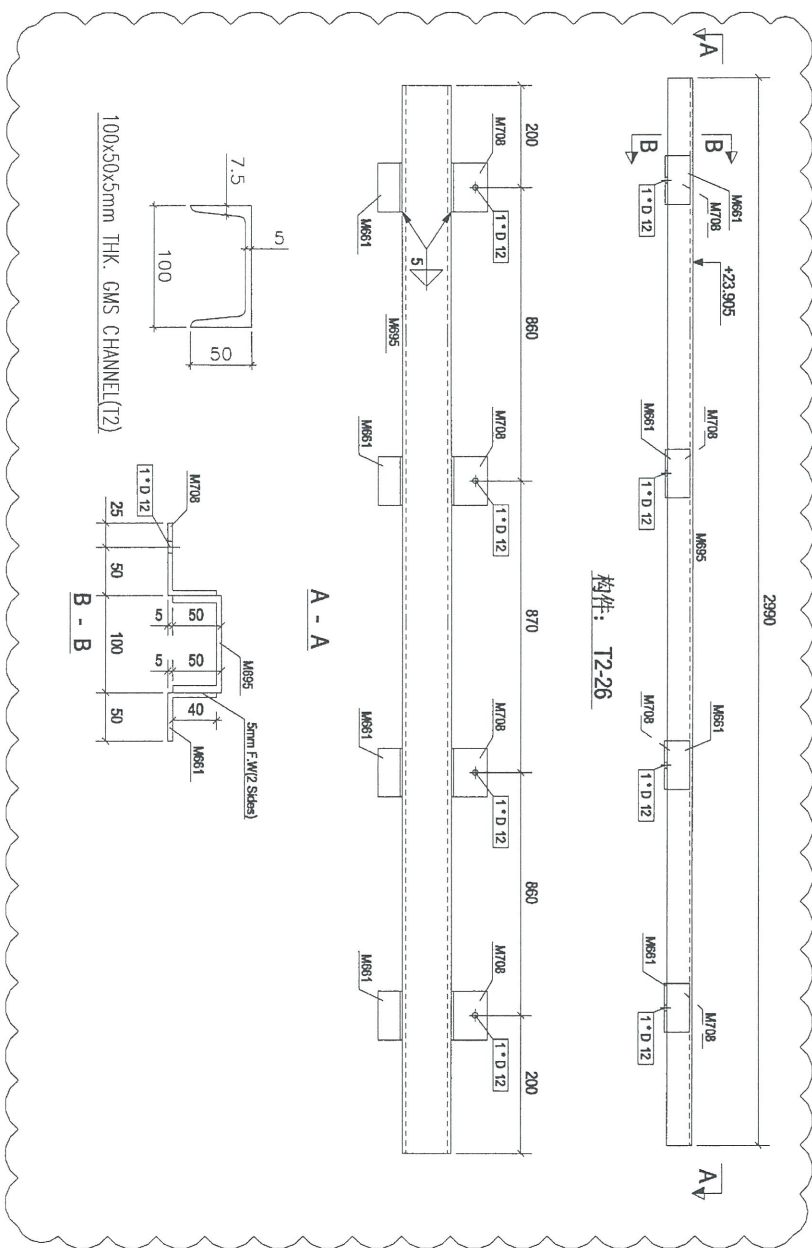

107

Rev.	Description	Date
A	第2次改修	2018-08-10

PROJECT: PROPOSED SITE C1
 DEVELOPMENT AT RACHG8,
 THO/CL/09/1/SEDOENRANNO,
 NEN TERNBORSES

CLIENT: 美特铝业有限公司
 MID1 AUTOMOTIVE MANUFACTURE CO., LTD.
 1/5 5th Floor, Koonin
 610 Chin Koo Lang Road, Koonin
 Tel: 23893211-4 Fax: 232727065

銀同有限公司
 Silver Town Limited
 Tel: 0769-8339666 Fax: 0769-8339354
 E-mail: address@silvertown.com.hk

DRAWING TITLE: T2-261

Design	Drawn	Reviewed	Approved

CAD File Name: T2-261
 Scale: 1:1
 DWG NO.: FL-CT - [T2-261]

21

零件编号	12-27	零件数量	1	零件重量	30.89
零件编号	规格(mm)	长度(mm)	数量	重量(kg)	表面积(m ²)
M851	RS450*50*5	100	4	0.38	1.52
M895	PEC-100*50*5	2980	1	27.59	27.59
M708	RS475*50*5	100	4	0.47	1.88
合计:				30.99	0.03

50x50x6mm THK GMS
 1/4 SIZE CL=100

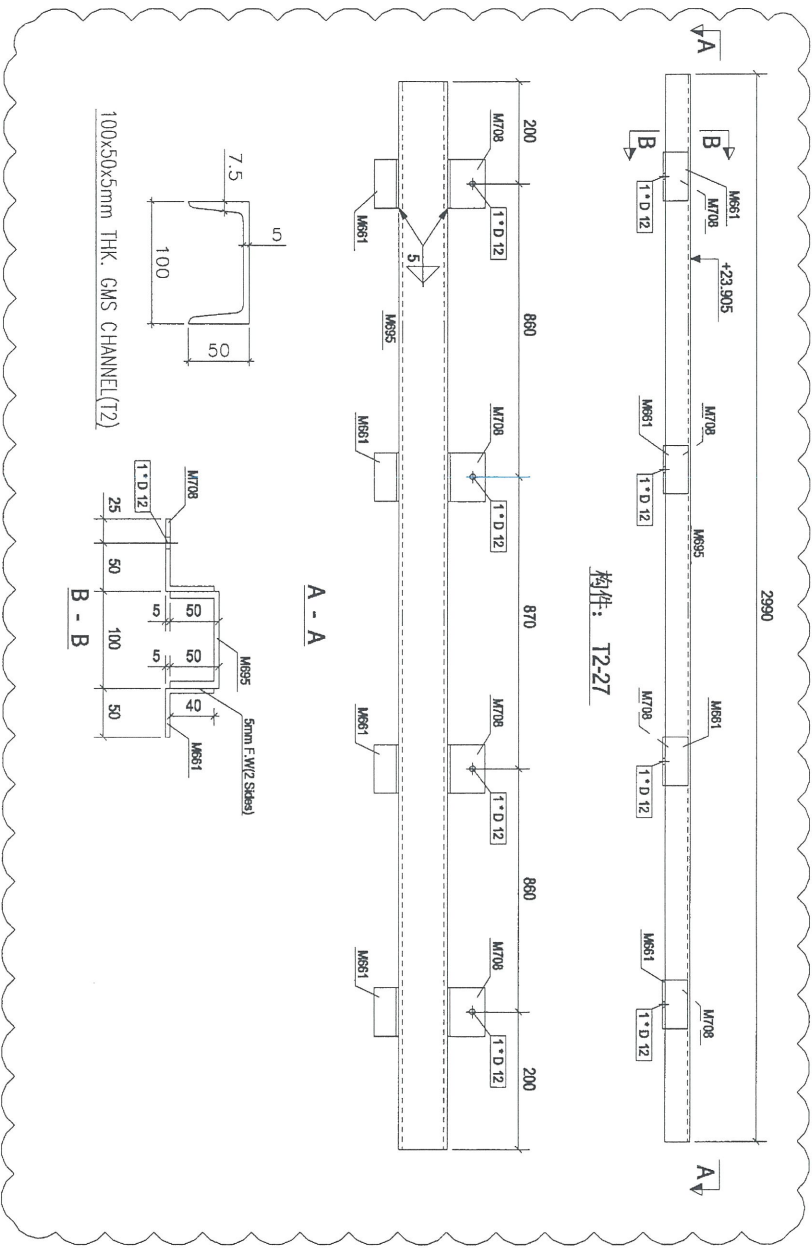

构件: T2-27

108

Rev.	A	第一次批准	2018-08-10
PROJECT:	PROPOSED SITE C1 DEVELOPMENT AT AREA B8, TKOTI TO PP TSEUNG KWAN O, NEW TERRITORIES		
CLIENT:	美特经贸有限公司 MIDE KAO LTD. (INCORPORATED IN HONG KONG) 1570 Cheong Cheong Street, 1/F Tel: 23499211-4 Fax: (852) 27272665		
DRAWING TITLE:	T2-271		
CAD File Name:			
Designed by:			
Drawn by:			
Reviewed by:			
Approved by:			
Scale:			
DMG NO.:	F.L.C.T - T2-271		REV. A

22

零件编号	规格	数量	单位	重量	共重
M851	RSAS5075075	4	0.39	1.52	0.02
M855	FGC-10075075	2890	27.99	27.99	1.17
M708	RSAS752075	100	0.47	1.88	0.03
合计:				30.98	

50X50X5mm THK GMS
 零件: T2-28

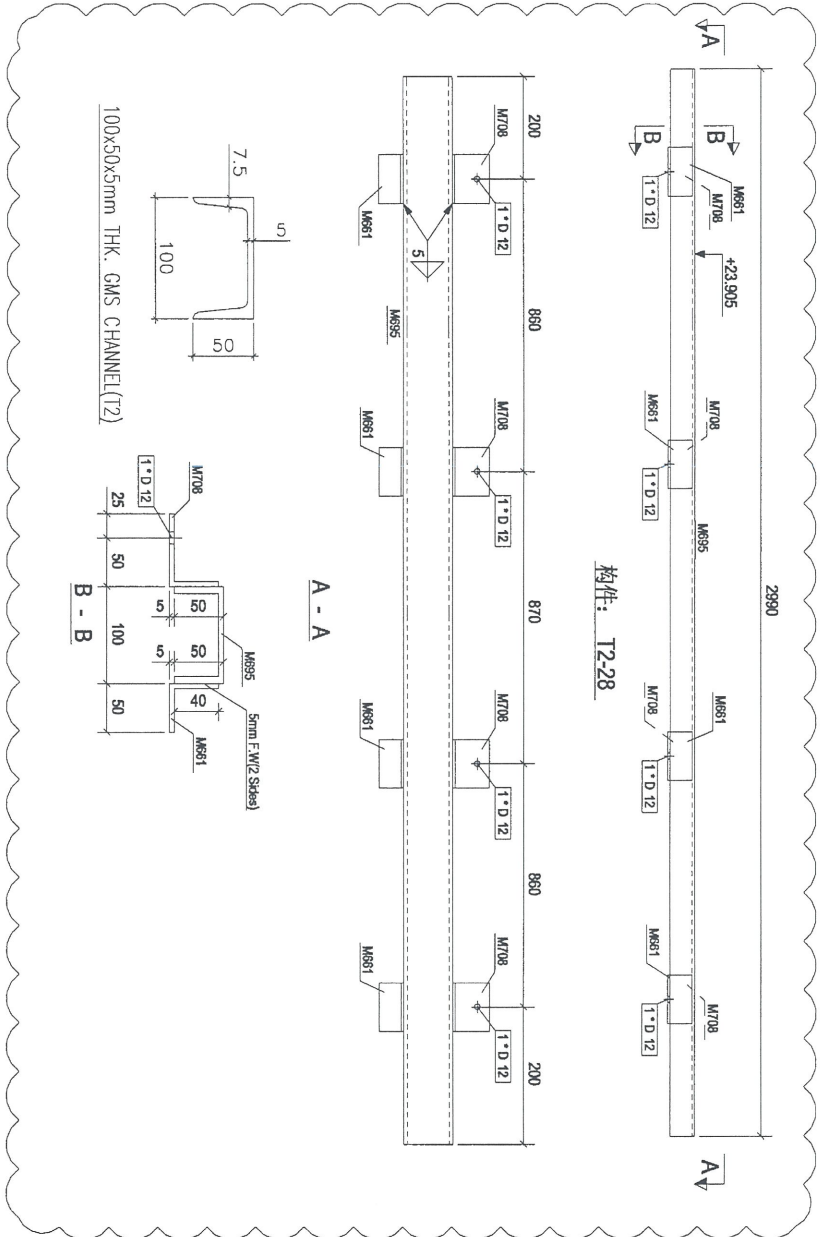

159

Rev.	A	第2次修版	2018-08-10
PROJECT:	PROPOSED SITE C1 DEVELOPMENT AT AREA 98 TKO1 TO RP TSEUNG KWAN O, NEW TERRITORIES		
CLIENT:	美特铝业有限公司 MIDY ALUMINIUM FABRICATOR LTD. Units 6-8, Sunny Industrial Centre, 1/F 510 Chee Koo Ling Road, Kowloon Tel: 2438211-4 Fax: (852) 2727886		
	银同有限公司 Silver Town Limited Tel: 078-4334888 Fax: 078-4335854 E-Mail: Address@silvertown.hk, ts2008		
DRAWING TITLE:	[T2-28]		
CAD File Name:			
Designed by:			
Drawn by:			
Reviewed by:			
Approved by:			
Scale:			
DWG NO.:	FL-C-1 - [T2-28]		
REV	A		

23

零件编号	规格(单位)	长度(mm)	数量	重量	共重(吨)	共重(吨)	重量(m³)
M861	RS457*50*5	100	4	0.38	1.52		0.02
M865	PFC-100*50*5	2990	1	27.59	27.59		1.17
M708	RS457*50*5	100	4	0.47	1.88		0.03
合计:						30.99	

50x50x5mm THK GWS CHANNEL (12)
 共重 30.99

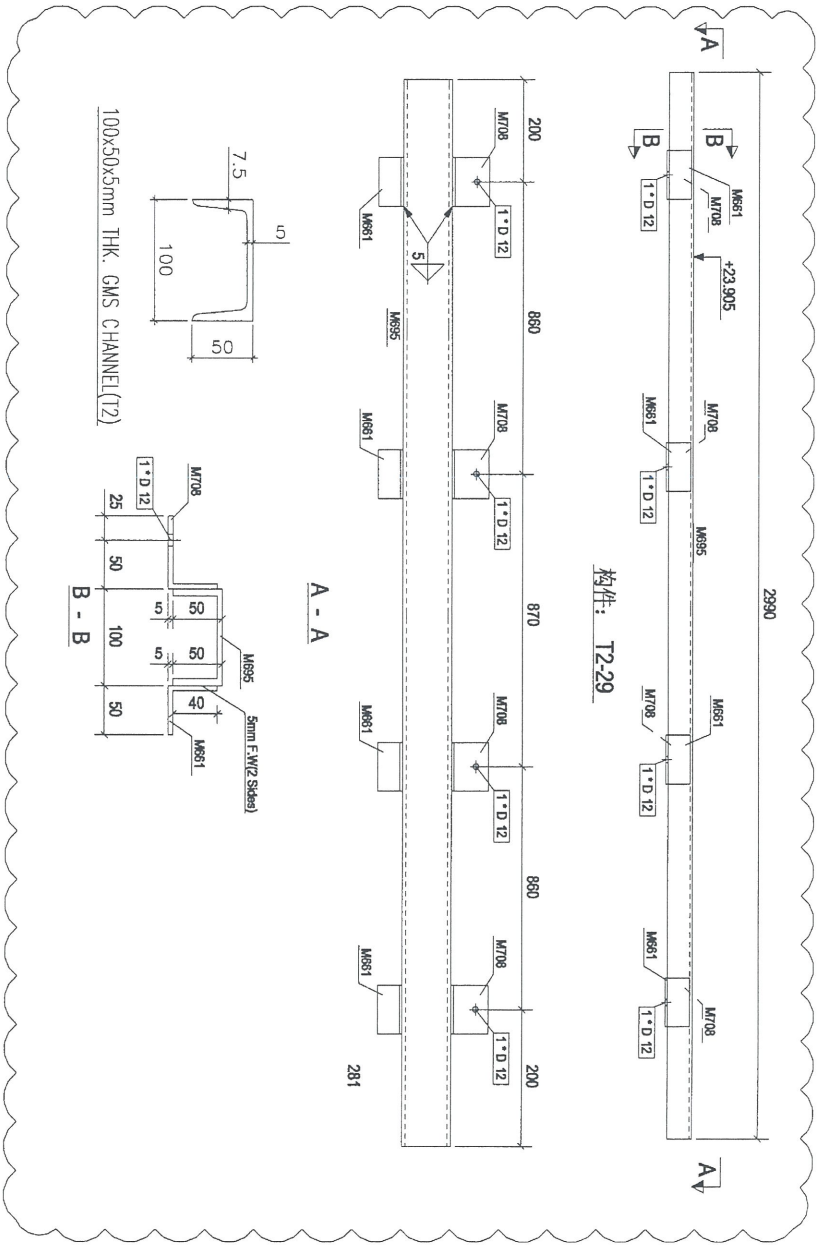

100x50x5mm THK. GWS CHANNEL (12)

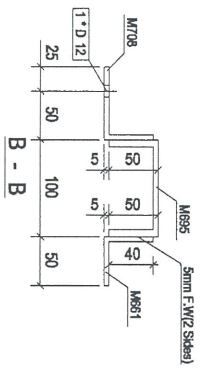
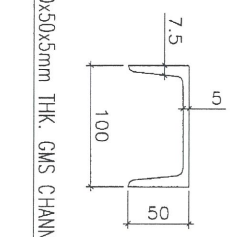

119

Rev.	A	第2次修改	2018-08-10
PROJECT:	PROPOSED SITE C1 DEVELOPMENT AT AREA 08, TJOTL TOWN, TSEUNG KWAN O, NEW TERRITORIES		
CLIENT:	美特鋁質有限公司 MIDI ALUMINIUM INDUSTRIES LTD. Units 6-8, Sunny Industrial Centre, 1/F 510 Chee Kwo Lang Road, Kwai Tsing Tsd: 23489211-4 Fax: (852) 27272558		
	銀同有限公司 Silver Town Limited Tsd: 078-8334688 Fax: 078-833864 E-MAIL: 00883529@silvertown.com.hk		
DRAWING TITLE:	[T2-29]		
CAD File Name:			
Designed by:			
Drawn by:			
Reviewed by:			
Approved by:			
Scale:			
DMG NO.:	FL-C.T	- [T2-29]	
	REV		A

24

零件號	圖號	長度(mm)	數量	重量(kg)	長度(mm)	重量(kg)
M278	SS450/S75	100	8	0.38	3.04	0.32
M896	PC-100/S75	3012	1	27.91	27.91	1.18
合計:				30.95		

50x75x6mm THK GMS
ANKLE-CLIP

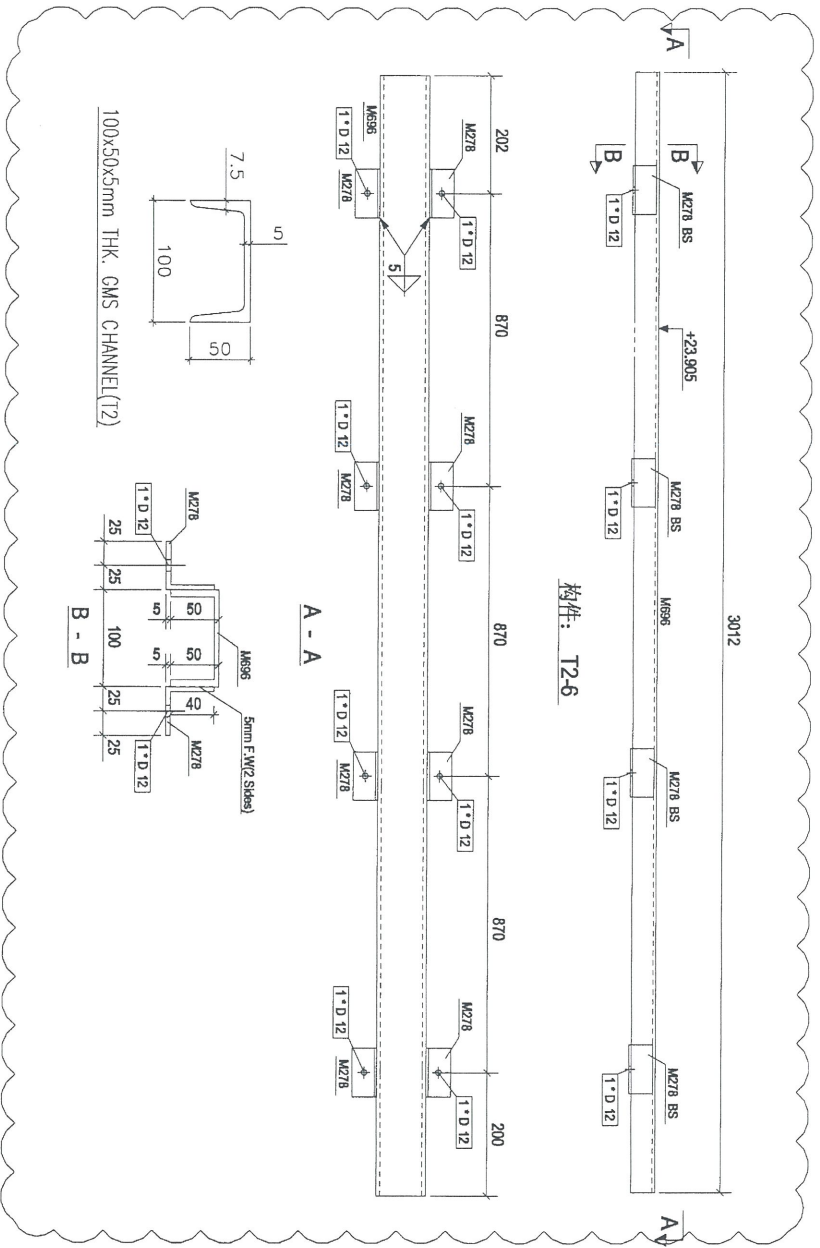

87

Rev.	A	第2次修版	2018-08-10
PROJECT:	PROPOSED SITE DEVELOPMENT AT AGENT 08, TKOIL TOWN, TSEUNG KUAN MO, NEW TERRITORIES		
CLIENT:	美特鋁質有限公司 MIDI Aluminium Fabrication Ltd. Units 6-8, Sunny Industrial Centre, 1/F 610 Chee Koo Ling Road, Kowloon Tel: 23989211-4 Fax: (852) 27272655		
	銀同有限公司 Silver Town Limited Tel: 2789-4333/4988 Fax: 2789-4333/5854 E-mail: address@silvertown.com.hk		
DRAWING TITLE:	[T2-6]		
CAD File Name:			
Designed by			
Drawn by			
Reviewed by			
Approved by			
Scale			
DWG NO.:	FL-C.T	- [T2-6]	
REV.	A		

25

零件编号	数量	重量	长度(m)	重量	重量	重量	重量
M278	100	0.38	2.27	0.22			
M897	1	25.09	25.09	1.08			
合计:				27.36			

50x50x6mm 746 Gms
AK602- (L2100)

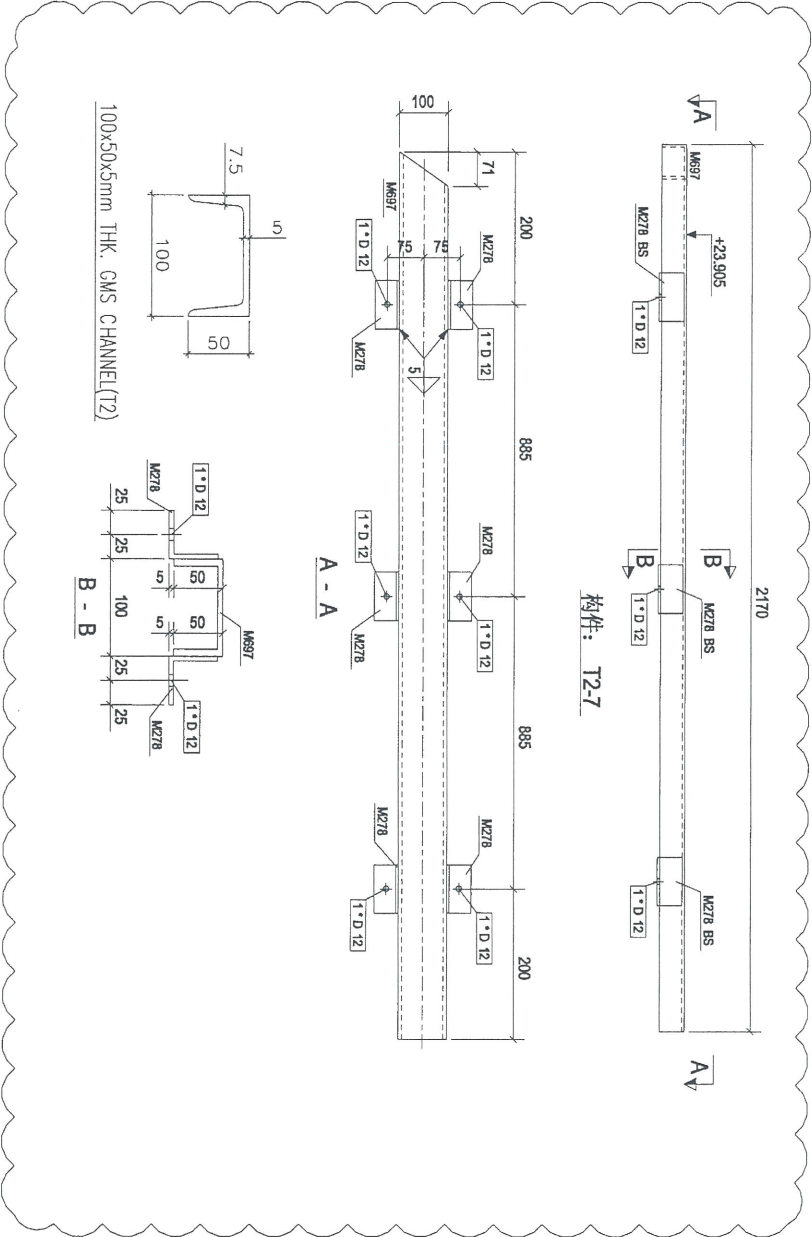

Rev.	A	第2次批准	2018-08-10
PROJECT:	PROPOSED SITE C1 DEVELOPMENT IN AREA 08, TROTTON, HONG KONG, NEW TERRITORIES		
CLIENT:	美特铝业有限公司 MID Aluminium Manufacturing Ltd. Units 5-8, Sunny Industrial Centre, 1/F 610 Chee Koo Ling Road, Kwai Tsing Tel: 23498211-4 Fax: (852) 27276885		
	银同有限公司 Silver Town Limited Tel: 0756-8355386 Fax: 0756-8359594 E-MAIL: ADMIN@SILVERTOWN.HK.COM		
DRAWING TITLE:	T2-71		
CAD File Name:			
Designed by:			
Drawn by:			
Reviewed by:			
Approved by:			
Scale:			
IMG NO.:	FLC.T	- T2-71	

PR

27

零件编号	数量	重量	长度	重量	重量	重量
M278	100	0.39	227	0.02		
M699	1289	11.39	11.39	0.48		
合计:		13.86				

50x50x5mm T AK Gms
ANGLE (L=100)

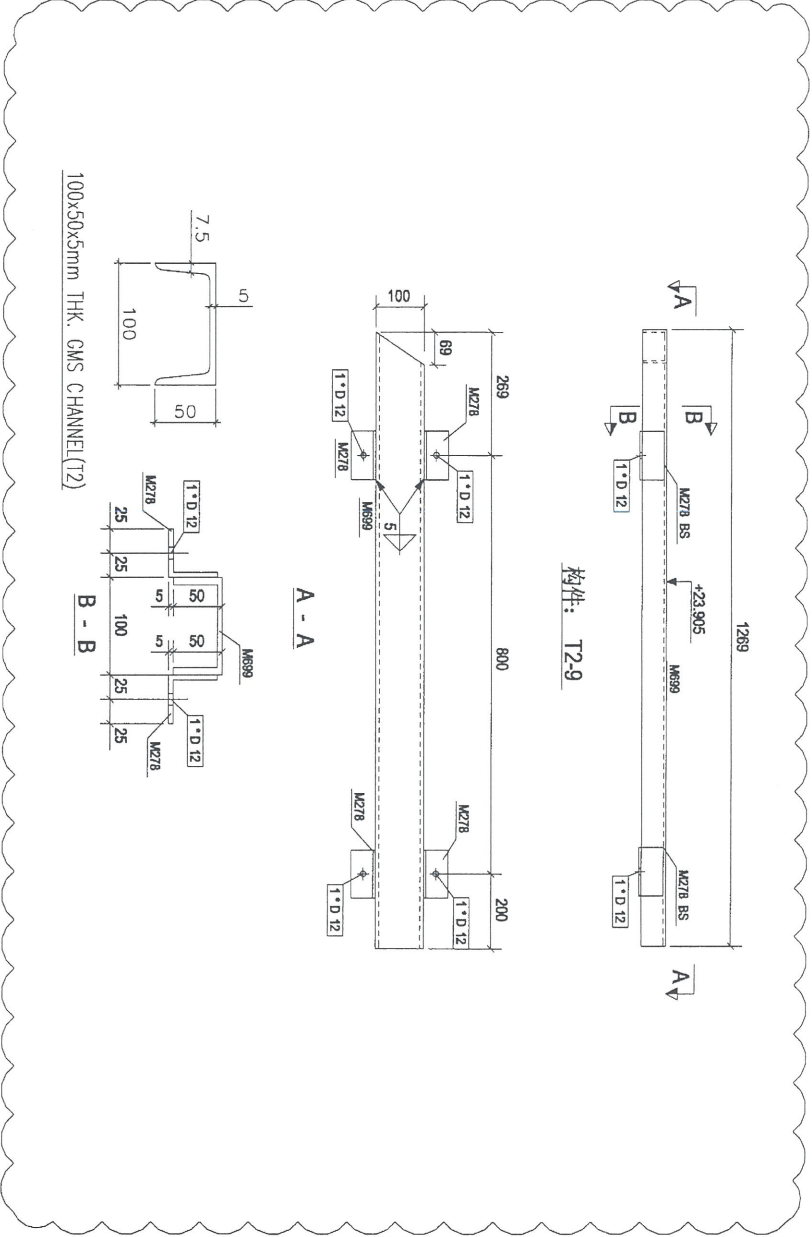

93

Rev	A	第2次批准	2018-08-10
PROJECT:	PROPOSED SITE C1 DEVELOPMENT IN NGAHOK, TROTILORUP, BESOING RUMAH, NEW TERNUTONGS		
CLIENT:	美特铝质有限公司 MID I ALUMINIUM MANUFACTURE LTD. Unit 5-B, Sany Industrial Centre, 1/F 510 Chu Kuo Ling Road, Kowloon Tel: 23489211-4 Fax: (852) 27270588 E-MAIL: 0085233@midm.com.hk, 183.CDN		
DRAWING TITLE:	银同有限公司 Silver Town Limited Tel: 0709-8334988 Fax: 0709-8335954 E-MAIL: 0085233@silvertown.com.hk, 183.CDN		
CAD File Name:	T2-91		
Designed by			
Drawn by			
Reviewed by			
Approved by			
Scale			
DWG NO.:	F.L.C.T - [T2-91]		
REV.	A		

29

零件编号	12-11	零件数量	1	零件重量	14.28
零件编号	规格(mm)	长度(mm)	数量	重量(kg)	重量(kg)
M278	RSAS50*50*5	100	4	0.38	0.02
M701	PC-C100*50*5	1335	1	12.01	0.51
合计:				14.28	

50x50x5mm THK CMS
 50x50x5mm THK CMS
 50x50x5mm THK CMS
 50x50x5mm THK CMS

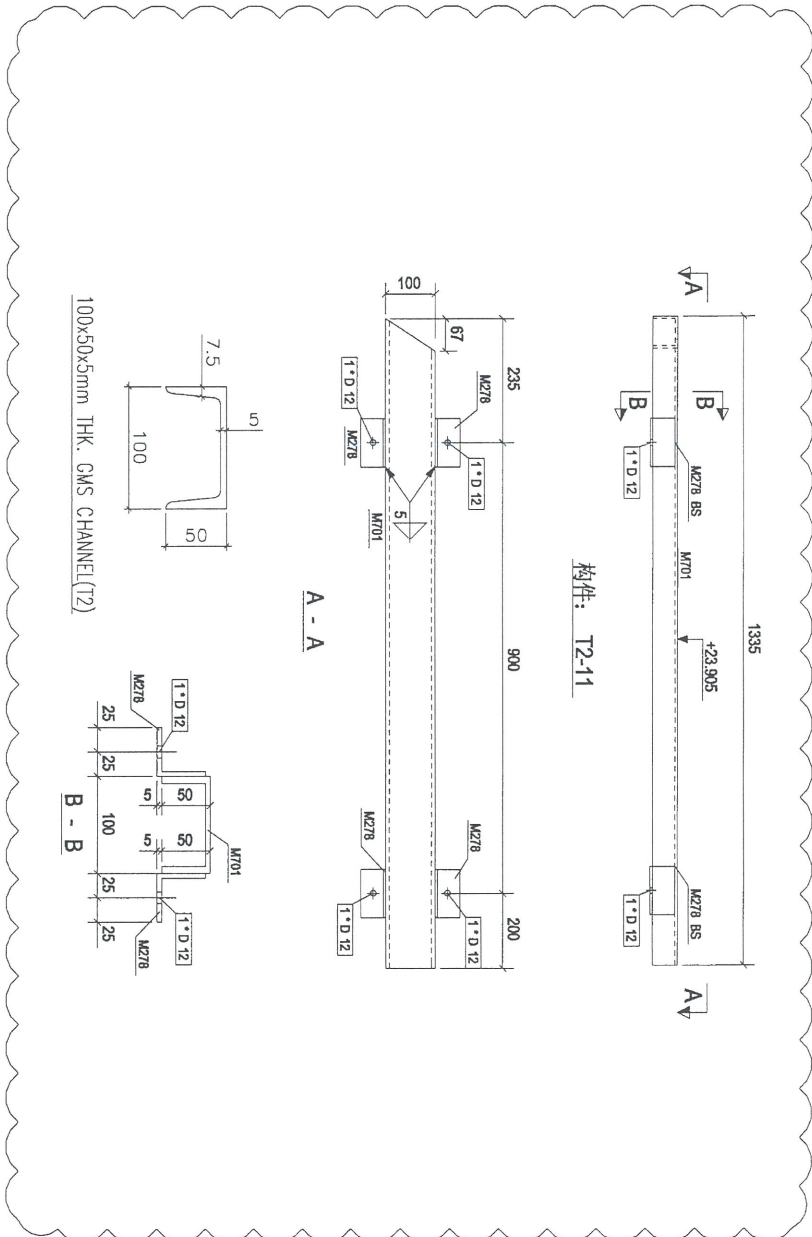

100x50x5mm THK. CMS CHANNEL(T2)

构件: T2-11

A - A

B - B

92

Rev	Description	Date
A	第2次改型	2018-08-10

PROJECT: 第2次改型
 PROPOSED SITE C1
 DEVELOPMENT AT AREA 98,
 TKO1L TO RP, TSEING KWAN O,
 NEW TERRITORIES

CLIENT: 美特铝业有限公司
 MTDI ALUMINIUM FABRICATOR LTD.
 Unit 5-8, Sunny Industrial Centre, 1/F,
 Ping Shee Yee Road, Kowloon
 Tel: 23492211-4 Fax: (852) 27272856

Silver Town Limited
 Tel: 23492211-4 Fax: 23492211-4
 E-mail: address@silvertown.com.hk

DRAWING TITLE: [T2-11]

CAD File Name:	
Designed by	
Drawn by	
Reviewed by	
Approved by	
Scale	
DWG NO.:	FL-C-1 - [T2-11]
REV	A

20

零件號	數量	單位	重量	長度	厚度
M278	4	0.38	2.27	100	0.02
M702	1	12.19	12.19	1354	0.52
合計:			14.46		

50x50x5mm

THE LONGS ABLE
CL=100

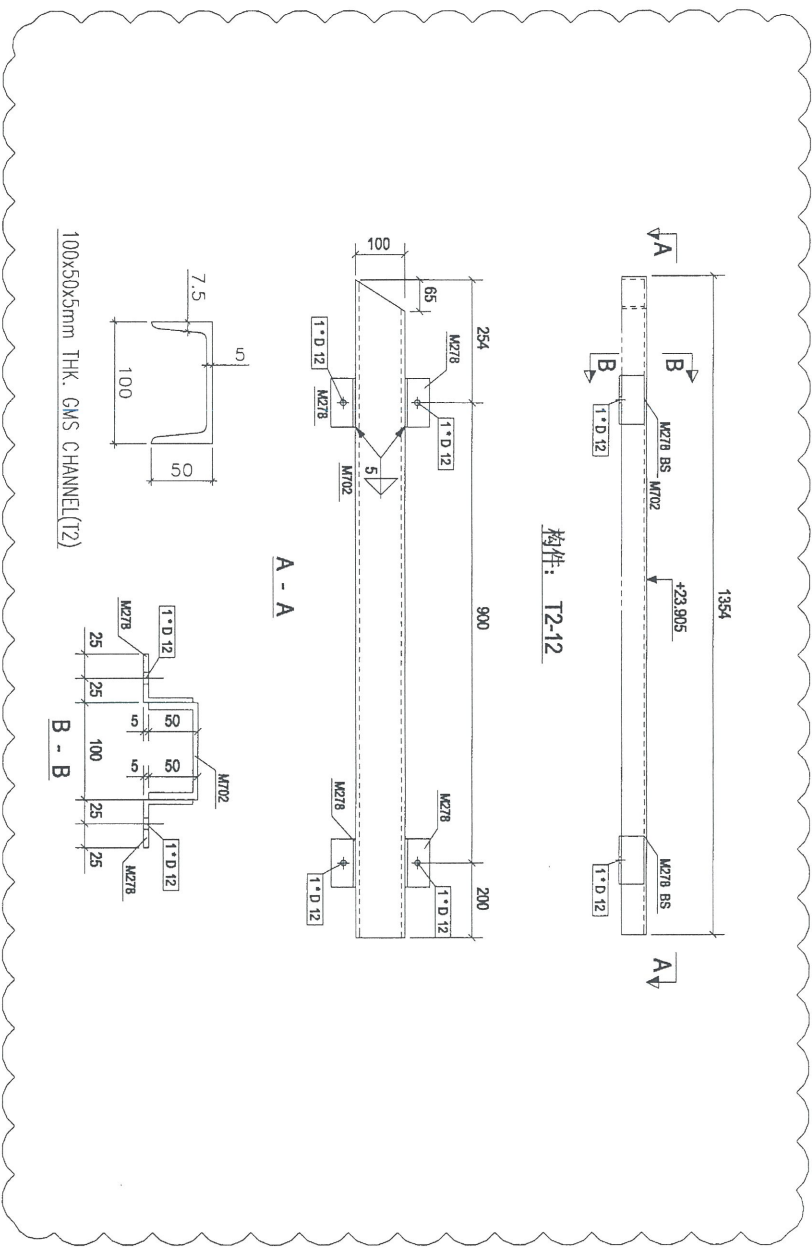

100x50x5mm THK. GWS CHANNEL (T2)

Rev	Description	Date
A	第2次改裝	2018-08-10

PROJECT: PROPOSED SITE C1
DEVELOPMENT AT AREA 88,
TKO11, TO RP, TSEUNG KWAN O,
NEW TERRORIES

CLIENT: 美特鋁質有限公司
MADI ALUMINUM FABRICATOR LTD.
Units 6-8, Sunny Industrial Centre, 1/F
Cao Tin Road, Tsing Kong
P.O. Box 100, Tsing Kong
Tel: 23692111-4 Fax: (852) 2727856

S 銀同有限公司
Silver Town Limited
Tel: 00853-3533868 Fax: 00853-3533854
E-mail: info@silvertown.com.hk

DRAWING TITLE: [T2-12]

CAD File Name: [T2-12]

Designed by	
Drawn by	
Reviewed by	
Approved by	
Scale	

DWG NO.: FL-CT - [T2-12]

REV	
A	

31

零件编号	72-13	零件数量	1	零件重量	14.58
零件编号	规格(mm)	长度(mm)	重量	单重(mm)	重量(kg)
M278	RS450*9*5	100	0.38	2.27	0.02
M703	PC-100*50*5	1384	1	12.29	0.52
合计:					14.58

50x50x5mm THK GWS
KALITE (L=100)

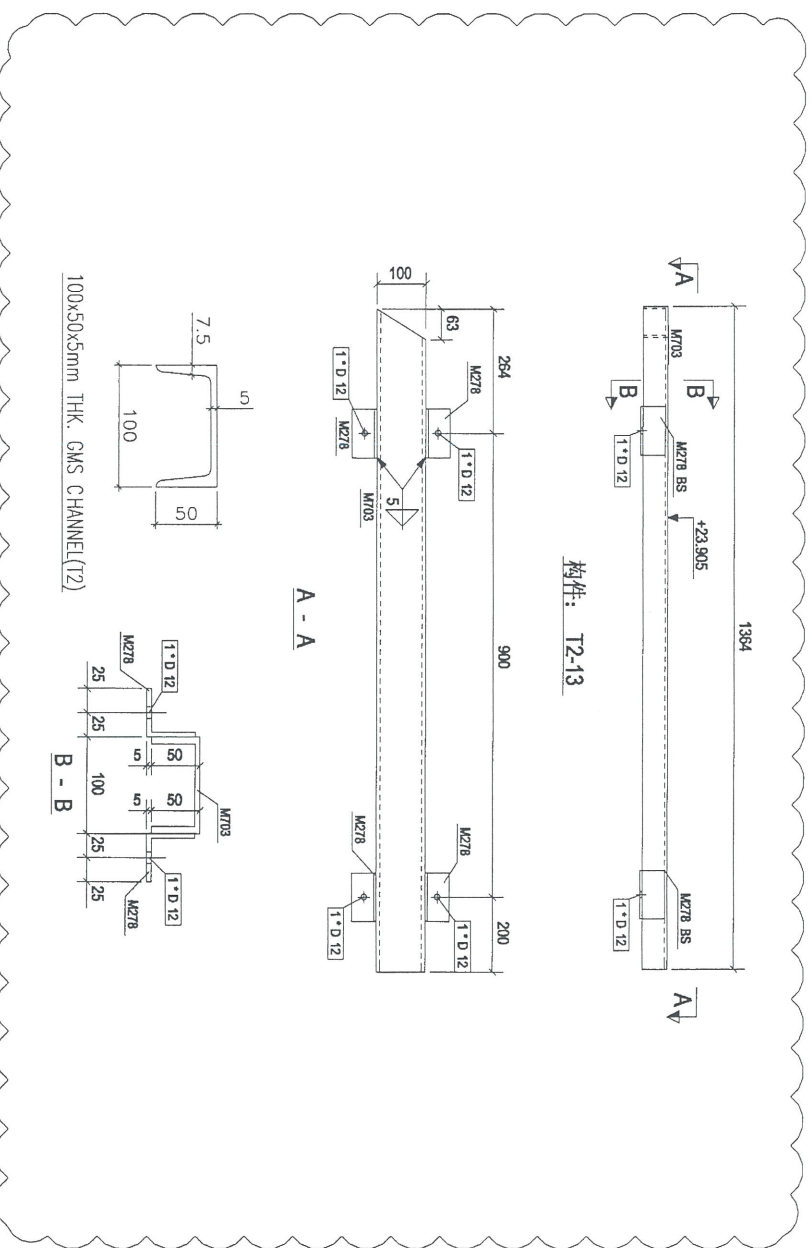

100x50x5mm THK. GWS CHANNEL(12)

Rev.	A	第2次修改	2018-08-10
PROJECT:	PROPOSED SITE C1 DEVELOPMENT AT NEA RS TOLL TOWER (SEKONG KANAO, NEW TERAPODIKES)		
CLIENT:	美特 鋁 質 有 限 公 司 MIDI Aluminium Industries Inc. Unit 5-9, Sunay Industrial Centre, 1/F 610 Chio Kwo Ling Road, Kowloon Tel: (852) 27217585		
	銀 同 有 限 公 司 Silver Town Limited Tel: 0753-4335486 Fax: 0753-4335954 E-MAIL: ADDRESS@silvertown.com.hk		
DRAWING TITLE:	[T2-.13]		
CAD File Name:			
Designed by			
Drawn by			
Reviewed by			
Approved by			
Scale			
DWG NO.:	FL-C-T	-	[T2-13]
			REV
			A

32

零件编号	规格(mm)	数量	重量(kg)	长度(m)	体积(m ³)	重量(kg)
M278	RS407505	4	0.38	2.27		0.82
M703	PC100505	1	12.28	12.28		0.52
合计:		5	14.58			

50x78x6mm THK GMS
 50x78x6mm THK GMS (L=600)

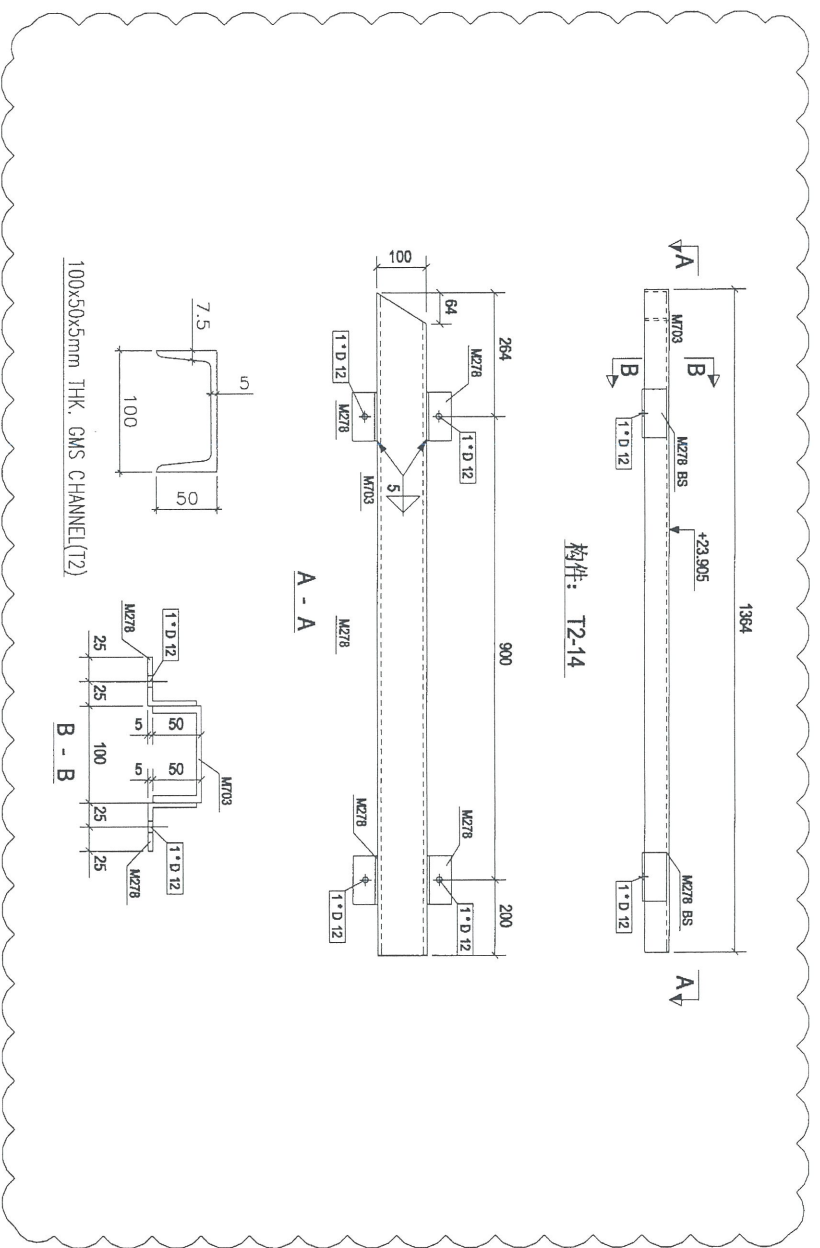

95

Rev	Description	Date
A	初次设计	2018-08-10

PROJECT: PROPOSED SITE C1 DEVELOPMENT AT AREA B8, TROU TOU REU TSEUNG KWAN O, NEW TERRITORIES

CLIENT: 美特铝业有限公司
 MTDI Aluminium Manufacture Ltd.
 Unit 8, 8, Suiyee Industrial Centre, 1/F
 610 Cheong Cheong Street
 Tel: 23489211-4 Fax: (852) 27272566

银同有限公司
 Silver Town Limited
 Tel: 23489211-4 Fax: (852) 27272566
 E-MAIL: ADDRESS@SILVERTOWN.COM

DRAWING TITLE: [T2-14]

CAD File Name: 1

Designed by: [Signature]

Drawn by: [Signature]

Reviewed by: [Signature]

Approved by: [Signature]

Scale: [Blank]

DMG NO.: F.L.C.T - [T2-14]

33

零件编号	T2-15	零件数量	1	零件重量	30.80
零件编号	规格(mm)	长度(mm)	数量	重量(kg)	体积(m ³)
M27B	R83.60*20*5	100	8	0.29	3.04
M704	PHC-100*50*5	3019	1	27.56	27.56
合计:				30.80	1.17

30x50x5mm THK CMS CHANNEL (T2)
 30x50x5mm THK CMS
 30x50x5mm THK CMS

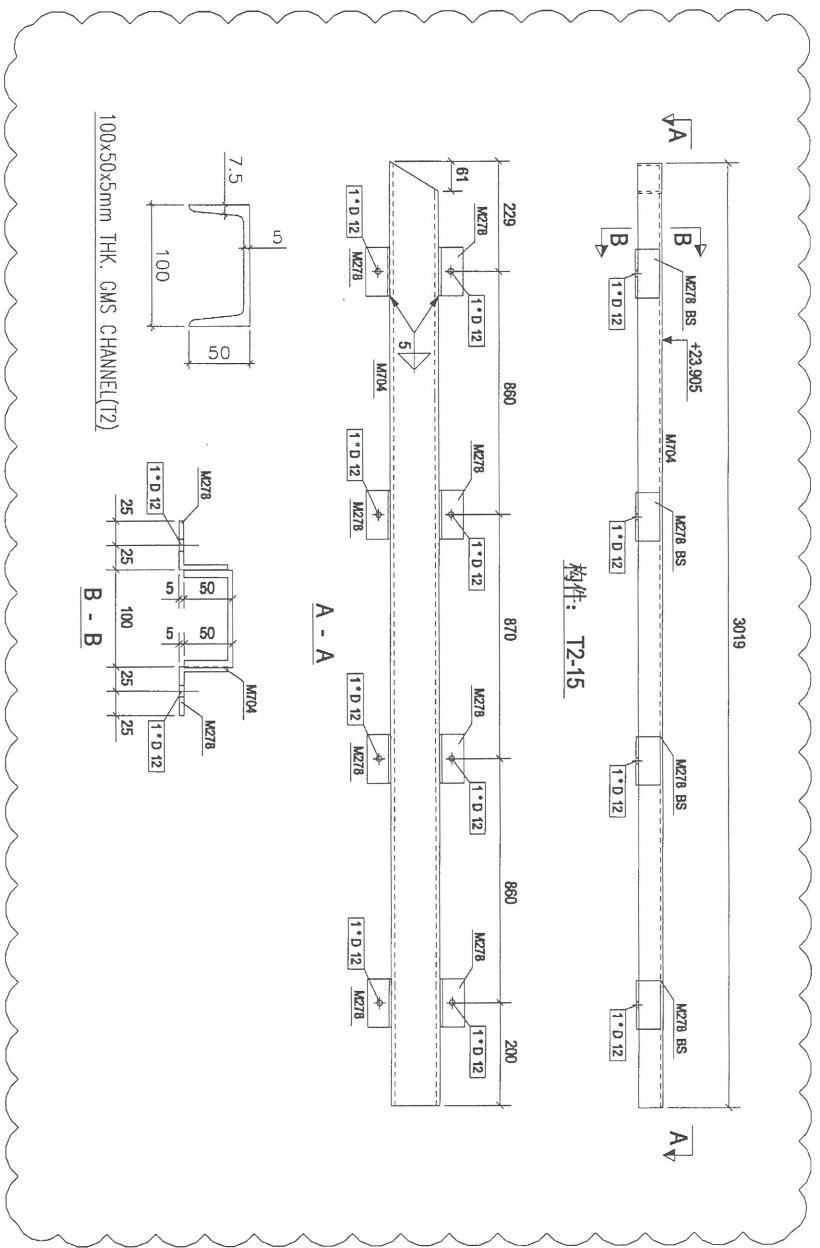

96

Rev	更改/批准	Date
A		2018-08-10

PROJECT:
 PROPOSED SITE C1
 DEVELOPMENT AT AREA B8,
 TKOIL 70 RP TSEUNG KWAN O,
 NEW TERRITORIES

CLIENT:
美特 經 實 有 限 公 司
 MTD CUSTOMER PROTECTIVE LTD.
 Suite 518, Seung Yee Industrial Centre, 1/F
 610 Chee Koon Street, Kwai Tsing, N.T.
 Tel: 3489211-4 Fax: (852) 27272856

銀 同 有 限 公 司
 Silver Town Limited
 Tungpin Industrial Estate, A153529
 610 Chee Koon Street, Kwai Tsing, N.T.
 E-MAIL: ADDRESS@silvertown.com

DRAWING TITLE:
[T2-15]

CAD File Name :	
Designed by	
Drawn by	
Reviewed by	
Approved by	
Scale	
DWG NO. FL-C1 - [T2-15]	REV
	A

54

料件號	料件名稱	料件數量	料件重量
M278	83A50*50*5	4	0.38
M705	PC-100*50*5	1	12.22
合計:			14.50

50x50x5mm THK GWS
 50x50x5mm THK GWS
 50x50x5mm THK GWS

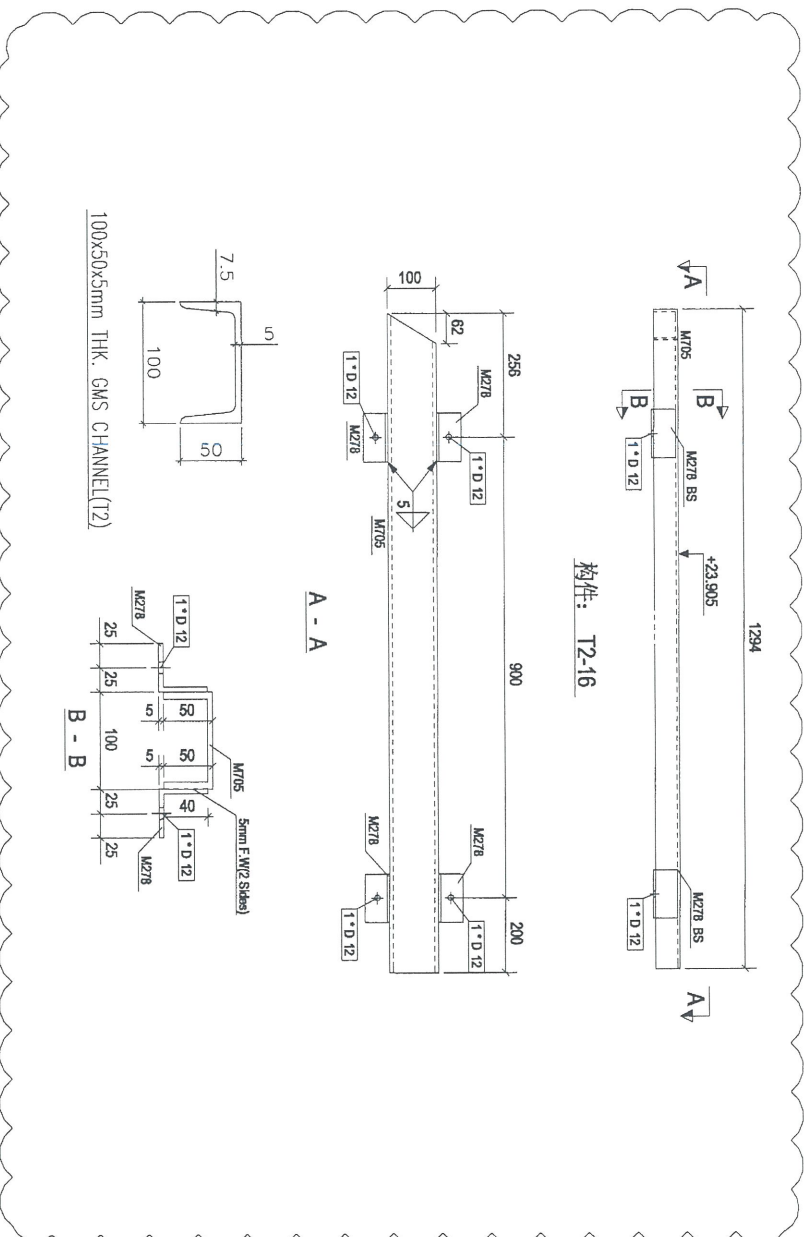

100x50x5mm THK. GWS CHANNEL(T2)

構件: T2-16

97

Rev.	Description	Date
A	第2次規格	2018-08-10

PROJECT:
 PROPOSED SITE C1
 DEVELOPMENT AT AREA 88,
 TKOIL TO RP TSEUNG KWAN O,
 NEW TERRITORIES

CLIENT:
美特銀寶有限公司
 MIDU JARDINER ASSOCIATE LTD
 Units 5-8, Sunco Industrial Centre, Y/F
 510 Che Kwo Ling Road, Kowloon
 Tel: 23489211-4 Fax: (852) 2777555

銀同有限公司
 Silver Town Limited
 Tel: 6778-8334/861 Fax: 6778-8333/84
 E-MAIL: ADDRESS@silvertown.hk, 183.COM

DRAWING TITLE:
[T2-16]

Rev.	Appr.	Scale	CHK NO.	REV.
A			F.L.C.T - [T2-16]	

CAD File Name:
 Designed by:
 Drawn by:
 Reviewed by:
 Approved by:
 Scale

55

物料编号	规格	长度(m)	数量	重量(kg)	共重(kg)	采和(m)
M278	RS450*50*5	100	6	0.38	2.27	0.02
M706	PEC-100*50*5	1706	1	15.74	15.74	0.86
合计:				16.12	18.01	

50x50x6mm The Gms
 100x50x5mm (L=100)

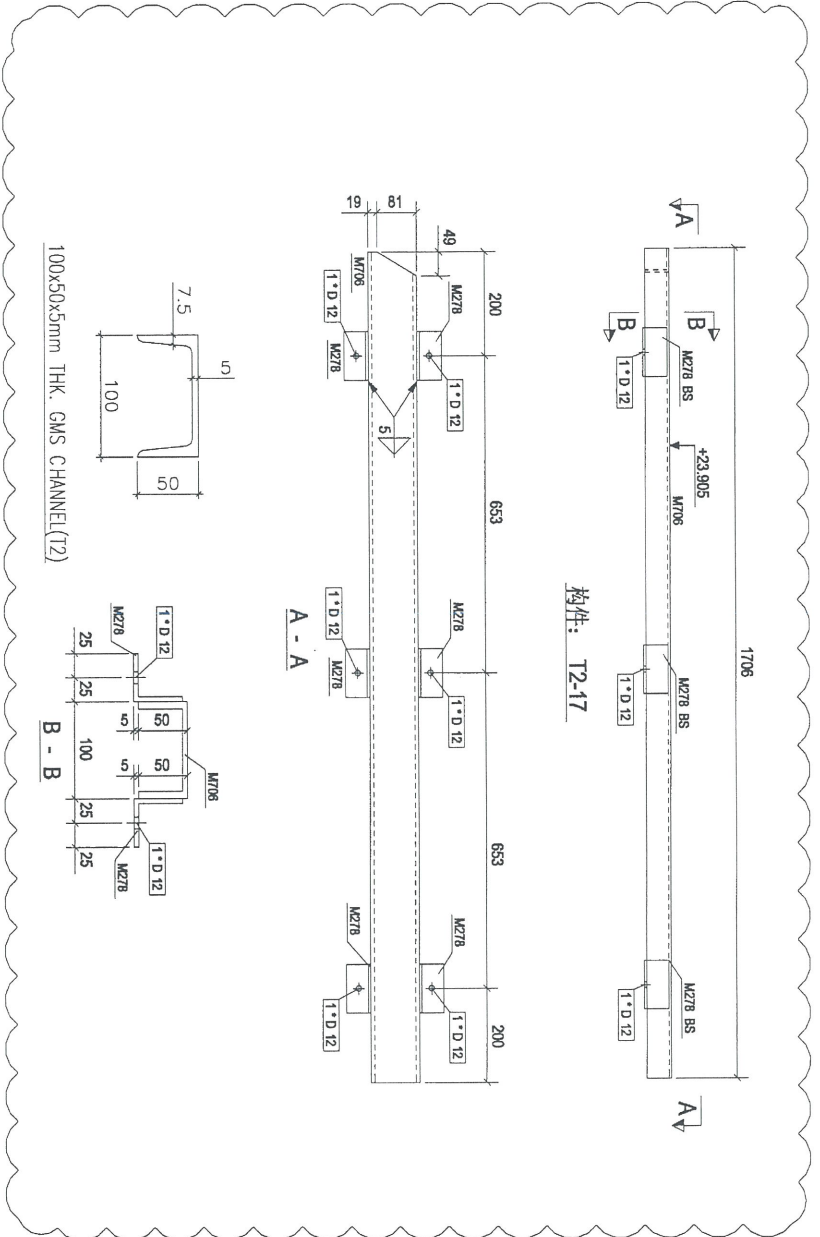

100x50x5mm THK. GMS CHANNEL (T2)

Rev	Description	Date
A	第一次校核	2018-08-08

PROJECT: PROPOSED SITE C1 DEVELOPMENT AT AREA 85, TKOIL TO RP, TSEUNG KWAN O, NEW TERRITORIES

CLIENT: 美特堅有限公司
 MIDT Architecture
 Units 6-8, Sunny Industrial Centre, 1/F, 610 Chee Kwo Ling Road, Kowloon
 Tel: 23489211-4 Fax: (852) 27277656

银同有限公司
 Silver Town Limited
 Tel: 0759-4335485 Fax: 0759-4335954
 E-mail: address@silvertown.com

DRAWING TITLE: [T2-17]

CAD File Name:

Designed by:

Drawn by:

Reviewed by:

Approved by:

Scale:

DWG NO.: FL-CT - [T2-17]

REV: A

0.185

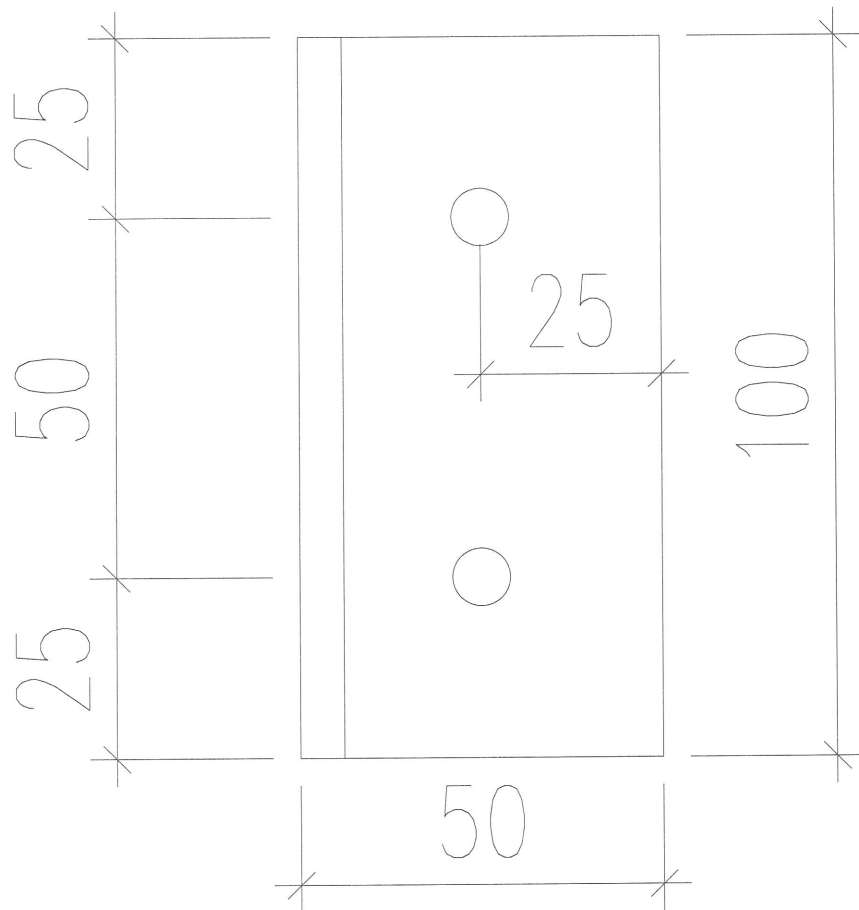
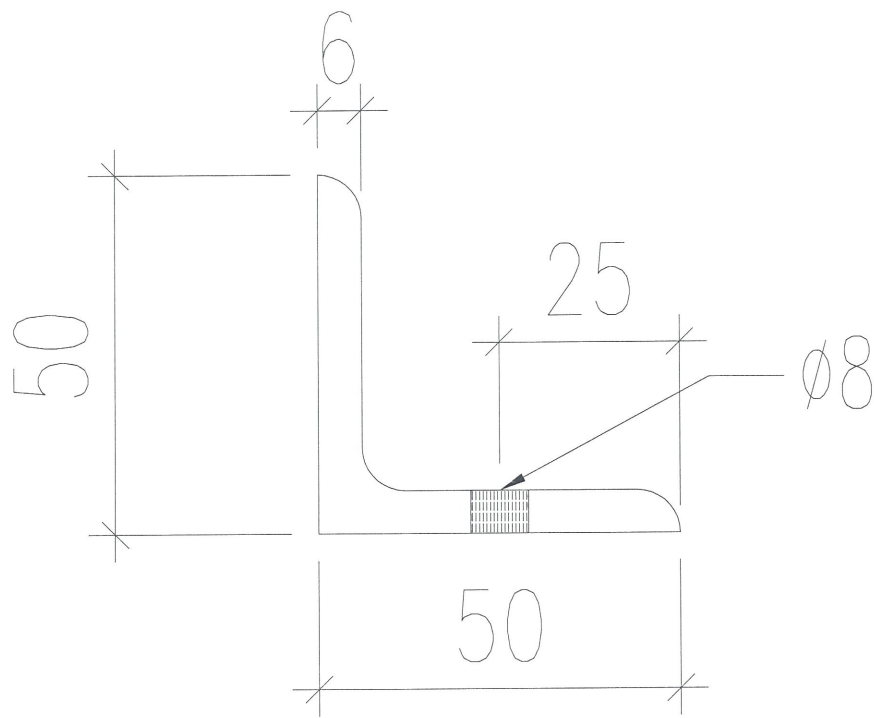

36
92

50x50X6mm THK. GMS ANGLE (L=100)
(~~M278~~) CM661 20件.

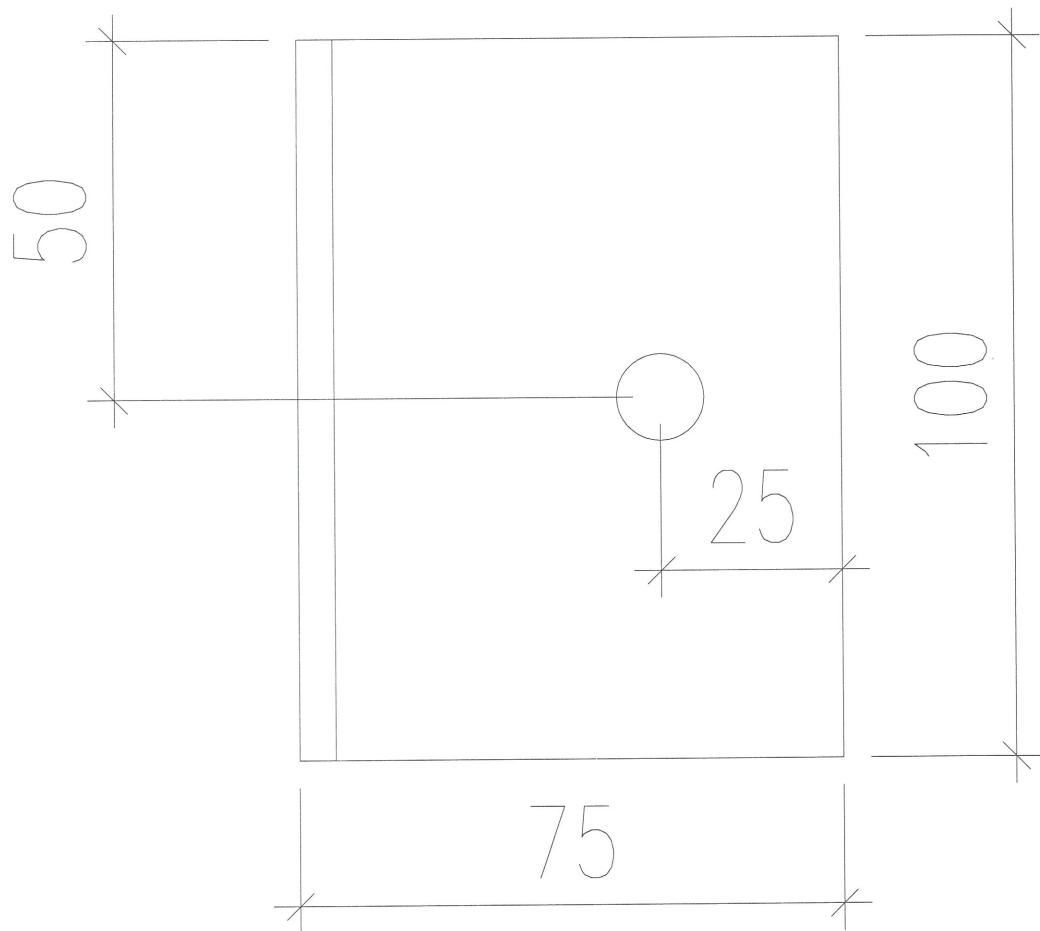
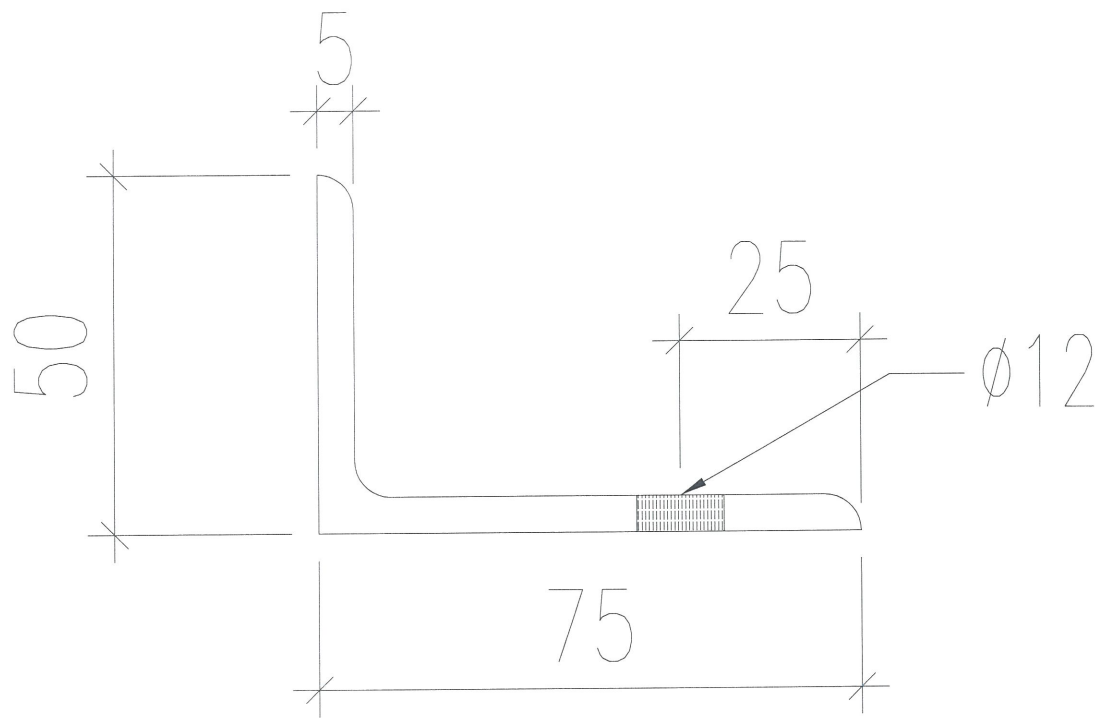

37

75x50X5mm THK. GMS ANGLE (L=100)
(M708) 20 14

Handwritten mark

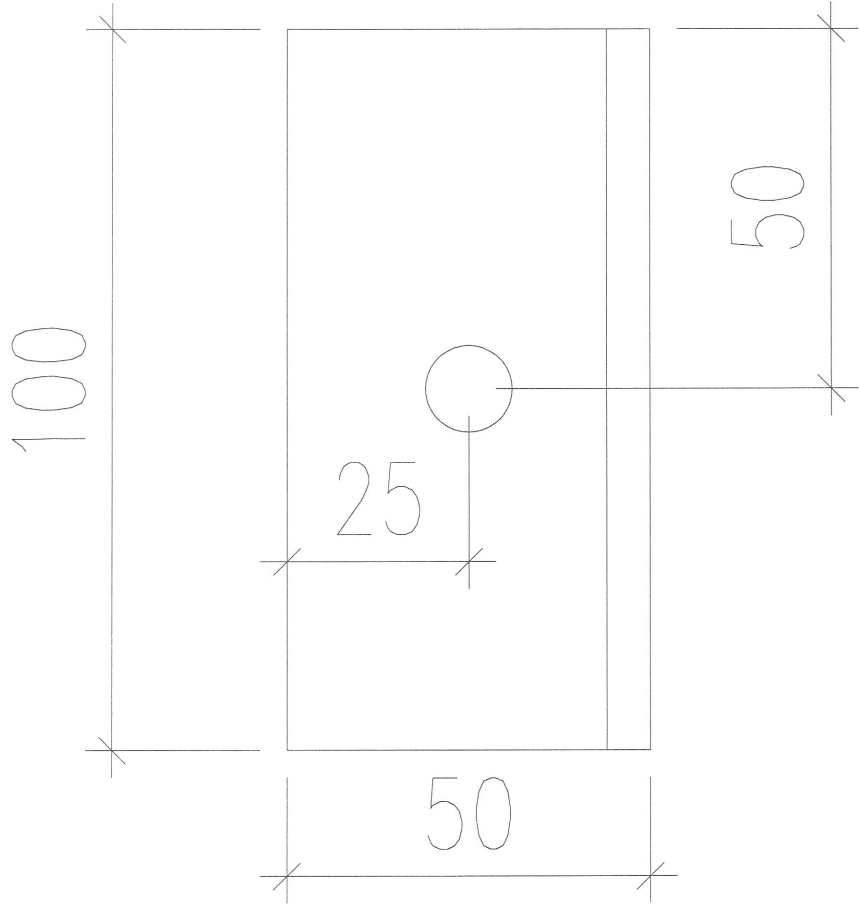
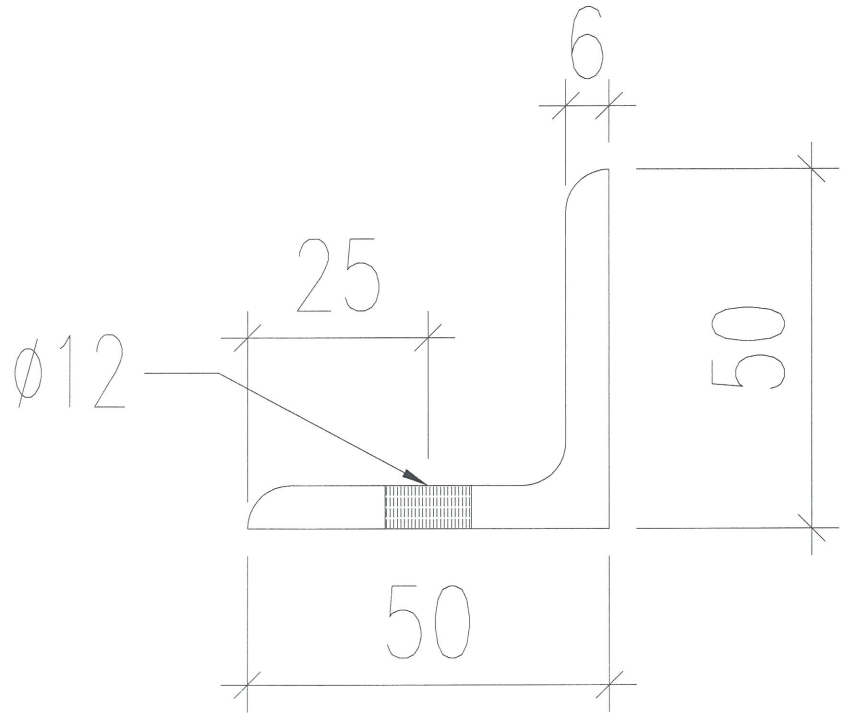

28

50x50X6mm THK. GMS ANGLE (L=100)
(M278) 289 件