

工程指示 / 要求簡箋(E.I.)

工程指示編號：EI/ 9411 /18

修改版次： A

工程編號： J836

工程名稱： 日出康城 7 期平台

工程項目： WW4 (N~RH) 地盤用鐵件修改

收件人： Maggie Lor

發件人： Joe Chan

日期： 17/9/2018

□要求提供 / □確認 事項：

- () 初步鋁料 B.M. () 加工拆圖，然後生產 () 尺寸表
- () 正式鋁料 B.M. () 技術上資料 / 指示 () 報價
- () 配件 B.M. () 樣辦或貨品說明書 () 分判合約
- () 其他： _____

內容：

因鐵器廠拆圖出錯，導致部分鐵件開少了孔。現要求鐵器廠補回開少的孔。

受影响鐵件包括：3C-1, 3C-2, 3C-3, 3C-4, 3C-5, 4C-1 和 4C-3。請按附件資料補回開孔。

請在 22-9-2018 前完成上列要求。

附有關圖紙 / 文件：

4頁

以上項目為：

- 原合約工程包 原合約工程加 / 減賬 新工程報價

原因：-

分發東莞各部門：

- () 生產技術總監 連附件 () 技術部 連附件 () 生產部 連附件 () 機械設計部 連附件
- () 採購部 連附件 () 生產統籌部 連附件
- () 質檢部 連附件 () 會計部 連附件 () 報關組 連附件 () 其他 _____ 連附件

分發香港各部門：

- () 行政部 連附件 () 會計部 連附件 () 統籌部 連附件 () 工程地盤科文 連附件 積哥、豪哥
- () 採購部 連附件 () QS 部 連附件 () 維修部 連附件 () 其他 _____ 連附件

傳遞編號：

發件人簽署：

項目經理簽署：

零件编号	3C-2	数量	1	零件重量	154.6
规格	铝器(mm)	长度(mm)	3607	重量(kg)	1.69
M60	RHS150*100*12.5	数量	1	重量(kg)	1.69
合计:				154.6	1.69

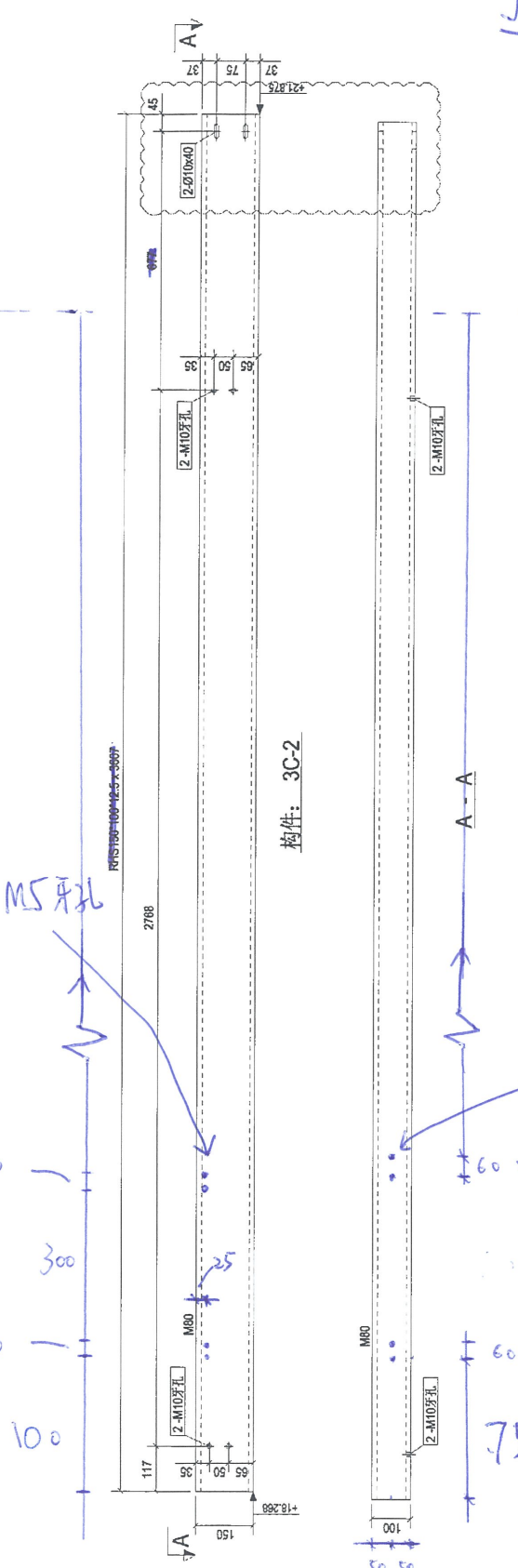

頂

如此类推开孔
至 3075

3075

底

Rev.	第2次修改	Date	2018-06-06
PROJECT: PROPOSED SITE C1 DEVELOPMENT AT AREA 06, TROTTOIR, TSEUNG KWAN O, NEW TERRITORIES			
CLIENT: 美特铝质有限公司 MIDI ALUMINIUM FABRICATOR LTD. Units 6-8, Sunny Industrial Centre, 1/F 610 Che Kwo Ling Road, Kwailoon Tel: (852) 99211-4 Fax: (852) 2727566			
S 银同有限公司 Silver Town Limited Tel: (852) 4333468 Fax: (852) 4335554 E-MAIL: ADDRESS@silvertown.com.hk			
DRAWING TITLE: WINDOW WALL (WMA) [3C-2]			
CAD File Name:			
Designed by:			
Drawn by:			
Reviewed by:			
Approved by:			
Scale:			
DWG NO:	J-836-WMA- [3C-2]	REV:	A

56

原圖

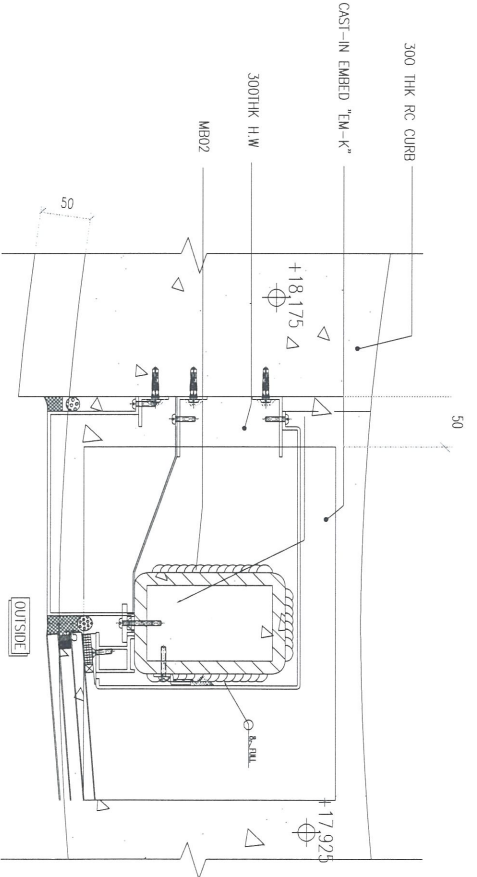
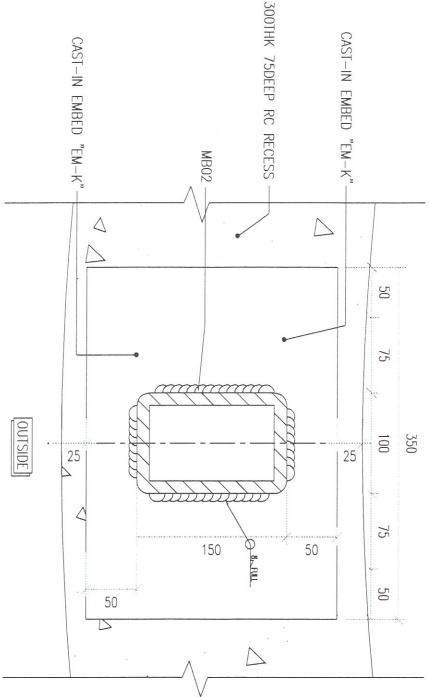
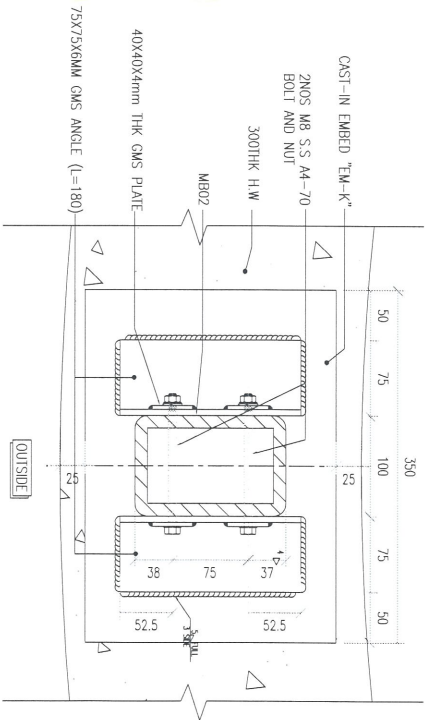
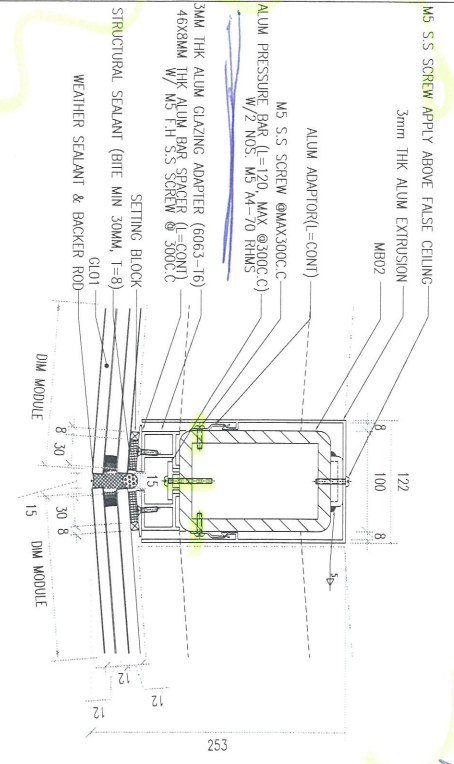

REV. REF : 3/19/99/(c)

LEGEND :

GL01	--12mm THK CLEAR TEMPERED GLASS
GL02	--12mm THK CLEAR TEMPERED GLASS
GL03	--12mm THK CLEAR TEMPERED GLASS
GL04	--12mm THK CLEAR TEMPERED GLASS
GL05	--12mm THK CLEAR TEMPERED GLASS
GL06	--12mm THK CLEAR TEMPERED GLASS
GL07	--12mm THK CLEAR TEMPERED GLASS
GL08	--12mm THK CLEAR TEMPERED GLASS
GL09	--12mm THK CLEAR TEMPERED GLASS
GL10	--12mm THK CLEAR TEMPERED GLASS
GL11	--12mm THK CLEAR TEMPERED GLASS
GL12	--12mm THK CLEAR TEMPERED GLASS
GL13	--12mm THK CLEAR TEMPERED GLASS
GL14	--12mm THK CLEAR TEMPERED GLASS
GL15	--12mm THK CLEAR TEMPERED GLASS
GL16	--12mm THK CLEAR TEMPERED GLASS
GL17	--12mm THK CLEAR TEMPERED GLASS
GL18	--12mm THK CLEAR TEMPERED GLASS
GL19	--12mm THK CLEAR TEMPERED GLASS
GL20	--12mm THK CLEAR TEMPERED GLASS
GL21	--12mm THK CLEAR TEMPERED GLASS
GL22	--12mm THK CLEAR TEMPERED GLASS
GL23	--12mm THK CLEAR TEMPERED GLASS
GL24	--12mm THK CLEAR TEMPERED GLASS
GL25	--12mm THK CLEAR TEMPERED GLASS
GL26	--12mm THK CLEAR TEMPERED GLASS
GL27	--12mm THK CLEAR TEMPERED GLASS
GL28	--12mm THK CLEAR TEMPERED GLASS
GL29	--12mm THK CLEAR TEMPERED GLASS
GL30	--12mm THK CLEAR TEMPERED GLASS
GL31	--12mm THK CLEAR TEMPERED GLASS
GL32	--12mm THK CLEAR TEMPERED GLASS
GL33	--12mm THK CLEAR TEMPERED GLASS
GL34	--12mm THK CLEAR TEMPERED GLASS
GL35	--12mm THK CLEAR TEMPERED GLASS
GL36	--12mm THK CLEAR TEMPERED GLASS
GL37	--12mm THK CLEAR TEMPERED GLASS
GL38	--12mm THK CLEAR TEMPERED GLASS
GL39	--12mm THK CLEAR TEMPERED GLASS
GL40	--12mm THK CLEAR TEMPERED GLASS
GL41	--12mm THK CLEAR TEMPERED GLASS
GL42	--12mm THK CLEAR TEMPERED GLASS
GL43	--12mm THK CLEAR TEMPERED GLASS
GL44	--12mm THK CLEAR TEMPERED GLASS
GL45	--12mm THK CLEAR TEMPERED GLASS
GL46	--12mm THK CLEAR TEMPERED GLASS
GL47	--12mm THK CLEAR TEMPERED GLASS
GL48	--12mm THK CLEAR TEMPERED GLASS
GL49	--12mm THK CLEAR TEMPERED GLASS
GL50	--12mm THK CLEAR TEMPERED GLASS
GL51	--12mm THK CLEAR TEMPERED GLASS
GL52	--12mm THK CLEAR TEMPERED GLASS
GL53	--12mm THK CLEAR TEMPERED GLASS
GL54	--12mm THK CLEAR TEMPERED GLASS
GL55	--12mm THK CLEAR TEMPERED GLASS
GL56	--12mm THK CLEAR TEMPERED GLASS
GL57	--12mm THK CLEAR TEMPERED GLASS
GL58	--12mm THK CLEAR TEMPERED GLASS
GL59	--12mm THK CLEAR TEMPERED GLASS
GL60	--12mm THK CLEAR TEMPERED GLASS
GL61	--12mm THK CLEAR TEMPERED GLASS
GL62	--12mm THK CLEAR TEMPERED GLASS
GL63	--12mm THK CLEAR TEMPERED GLASS
GL64	--12mm THK CLEAR TEMPERED GLASS
GL65	--12mm THK CLEAR TEMPERED GLASS
GL66	--12mm THK CLEAR TEMPERED GLASS
GL67	--12mm THK CLEAR TEMPERED GLASS
GL68	--12mm THK CLEAR TEMPERED GLASS
GL69	--12mm THK CLEAR TEMPERED GLASS
GL70	--12mm THK CLEAR TEMPERED GLASS
GL71	--12mm THK CLEAR TEMPERED GLASS
GL72	--12mm THK CLEAR TEMPERED GLASS
GL73	--12mm THK CLEAR TEMPERED GLASS
GL74	--12mm THK CLEAR TEMPERED GLASS
GL75	--12mm THK CLEAR TEMPERED GLASS
GL76	--12mm THK CLEAR TEMPERED GLASS
GL77	--12mm THK CLEAR TEMPERED GLASS
GL78	--12mm THK CLEAR TEMPERED GLASS
GL79	--12mm THK CLEAR TEMPERED GLASS
GL80	--12mm THK CLEAR TEMPERED GLASS
GL81	--12mm THK CLEAR TEMPERED GLASS
GL82	--12mm THK CLEAR TEMPERED GLASS
GL83	--12mm THK CLEAR TEMPERED GLASS
GL84	--12mm THK CLEAR TEMPERED GLASS
GL85	--12mm THK CLEAR TEMPERED GLASS
GL86	--12mm THK CLEAR TEMPERED GLASS
GL87	--12mm THK CLEAR TEMPERED GLASS
GL88	--12mm THK CLEAR TEMPERED GLASS
GL89	--12mm THK CLEAR TEMPERED GLASS
GL90	--12mm THK CLEAR TEMPERED GLASS
GL91	--12mm THK CLEAR TEMPERED GLASS
GL92	--12mm THK CLEAR TEMPERED GLASS
GL93	--12mm THK CLEAR TEMPERED GLASS
GL94	--12mm THK CLEAR TEMPERED GLASS
GL95	--12mm THK CLEAR TEMPERED GLASS
GL96	--12mm THK CLEAR TEMPERED GLASS
GL97	--12mm THK CLEAR TEMPERED GLASS
GL98	--12mm THK CLEAR TEMPERED GLASS
GL99	--12mm THK CLEAR TEMPERED GLASS
GL100	--12mm THK CLEAR TEMPERED GLASS



ARCHITECT :
MTR
MTR Architects and Engineers Ltd
MTR Architects and Engineers Ltd
MTR Architects and Engineers Ltd

MAIN CONTRACTOR :
CHINA OVERSEAS BUILDING CONSTRUCTION LTD.

STRUCTURAL ENGINEER :
ARUP

FRAME CONSULTANT :
MENHARDT

NOTE :
1. ALL DIMENSIONS ARE IN mm.
2. ALL ELEVATIONS ARE VIEWED FROM OUTSIDE.
3. ALL DIMENSIONS TO BE VERIFIED ON SITE BEFORE FABRICATION.

LEGEND :
① - DETAIL MARK NO.
② - REFER SHEET NO.
③ - REFER TO DRAWING TITLE
④ - REFER TO DRAWING TITLE
⑤ - REFER TO DRAWING TITLE
⑥ - REFER TO DRAWING TITLE
⑦ - REFER TO DRAWING TITLE
⑧ - REFER TO DRAWING TITLE
⑨ - REFER TO DRAWING TITLE
⑩ - REFER TO DRAWING TITLE
⑪ - REFER TO DRAWING TITLE
⑫ - REFER TO DRAWING TITLE
⑬ - REFER TO DRAWING TITLE
⑭ - REFER TO DRAWING TITLE
⑮ - REFER TO DRAWING TITLE
⑯ - REFER TO DRAWING TITLE
⑰ - REFER TO DRAWING TITLE
⑱ - REFER TO DRAWING TITLE
⑲ - REFER TO DRAWING TITLE
⑳ - REFER TO DRAWING TITLE
㉑ - REFER TO DRAWING TITLE
㉒ - REFER TO DRAWING TITLE
㉓ - REFER TO DRAWING TITLE
㉔ - REFER TO DRAWING TITLE
㉕ - REFER TO DRAWING TITLE
㉖ - REFER TO DRAWING TITLE
㉗ - REFER TO DRAWING TITLE
㉘ - REFER TO DRAWING TITLE
㉙ - REFER TO DRAWING TITLE
㉚ - REFER TO DRAWING TITLE
㉛ - REFER TO DRAWING TITLE
㉜ - REFER TO DRAWING TITLE
㉝ - REFER TO DRAWING TITLE
㉞ - REFER TO DRAWING TITLE
㉟ - REFER TO DRAWING TITLE
㊱ - REFER TO DRAWING TITLE
㊲ - REFER TO DRAWING TITLE
㊳ - REFER TO DRAWING TITLE
㊴ - REFER TO DRAWING TITLE
㊵ - REFER TO DRAWING TITLE
㊶ - REFER TO DRAWING TITLE
㊷ - REFER TO DRAWING TITLE
㊸ - REFER TO DRAWING TITLE
㊹ - REFER TO DRAWING TITLE
㊺ - REFER TO DRAWING TITLE
㊻ - REFER TO DRAWING TITLE
㊼ - REFER TO DRAWING TITLE
㊽ - REFER TO DRAWING TITLE
㊾ - REFER TO DRAWING TITLE
㊿ - REFER TO DRAWING TITLE

PROJECT :
PROPOSED SITE C1
DEVELOPMENT AT AREA 86,
TKOIL 70 RP, TSIUNG KWAN O,
NEW TERRITORIES

TITLE :
TYPICAL DETAILS
FOR WINDOW-WALL (W4)

DATE : 07-DEC-2017 **SCALE :** 1:5

DRAWN BY : C.F. **CHECKED BY :** J.M.K.

JOB NO. : J-836

REV. NO. : 1

DATE : 07-DEC-2017 **SCALE :** 1:5

CLIENT : MTR

PROJECT : PROPOSED SITE C1
DEVELOPMENT AT AREA 86,
TKOIL 70 RP, TSIUNG KWAN O,
NEW TERRITORIES

TITLE : TYPICAL DETAILS
FOR WINDOW-WALL (W4)

DATE : 07-DEC-2017 **SCALE :** 1:5

DRAWN BY : C.F. **CHECKED BY :** J.M.K.

JOB NO. : J-836

REV. NO. : 1

CLIENT : MTR

PROJECT : PROPOSED SITE C1
DEVELOPMENT AT AREA 86,
TKOIL 70 RP, TSIUNG KWAN O,
NEW TERRITORIES

TITLE : TYPICAL DETAILS
FOR WINDOW-WALL (W4)

DATE : 07-DEC-2017 **SCALE :** 1:5

DRAWN BY : C.F. **CHECKED BY :** J.M.K.

JOB NO. : J-836

REV. NO. : 1

CLIENT : MTR

PROJECT : PROPOSED SITE C1
DEVELOPMENT AT AREA 86,
TKOIL 70 RP, TSIUNG KWAN O,
NEW TERRITORIES

TITLE : TYPICAL DETAILS
FOR WINDOW-WALL (W4)

DATE : 07-DEC-2017 **SCALE :** 1:5

DRAWN BY : C.F. **CHECKED BY :** J.M.K.

JOB NO. : J-836

REV. NO. : 1

CLIENT : MTR

PROJECT : PROPOSED SITE C1
DEVELOPMENT AT AREA 86,
TKOIL 70 RP, TSIUNG KWAN O,
NEW TERRITORIES

TITLE : TYPICAL DETAILS
FOR WINDOW-WALL (W4)

DATE : 07-DEC-2017 **SCALE :** 1:5

DRAWN BY : C.F. **CHECKED BY :** J.M.K.

JOB NO. : J-836

REV. NO. : 1

CLIENT : MTR

PROJECT : PROPOSED SITE C1
DEVELOPMENT AT AREA 86,
TKOIL 70 RP, TSIUNG KWAN O,
NEW TERRITORIES

TITLE : TYPICAL DETAILS
FOR WINDOW-WALL (W4)

DATE : 07-DEC-2017 **SCALE :** 1:5

DRAWN BY : C.F. **CHECKED BY :** J.M.K.

JOB NO. : J-836

REV. NO. : 1

CLIENT : MTR

PROJECT : PROPOSED SITE C1
DEVELOPMENT AT AREA 86,
TKOIL 70 RP, TSIUNG KWAN O,
NEW TERRITORIES

TITLE : TYPICAL DETAILS
FOR WINDOW-WALL (W4)

DATE : 07-DEC-2017 **SCALE :** 1:5

DRAWN BY : C.F. **CHECKED BY :** J.M.K.

JOB NO. : J-836

REV. NO. : 1

CLIENT : MTR

PROJECT : PROPOSED SITE C1
DEVELOPMENT AT AREA 86,
TKOIL 70 RP, TSIUNG KWAN O,
NEW TERRITORIES

TITLE : TYPICAL DETAILS
FOR WINDOW-WALL (W4)

DATE : 07-DEC-2017 **SCALE :** 1:5

DRAWN BY : C.F. **CHECKED BY :** J.M.K.

JOB NO. : J-836

REV. NO. : 1

CLIENT : MTR

PROJECT : PROPOSED SITE C1
DEVELOPMENT AT AREA 86,
TKOIL 70 RP, TSIUNG KWAN O,
NEW TERRITORIES

TITLE : TYPICAL DETAILS
FOR WINDOW-WALL (W4)

DATE : 07-DEC-2017 **SCALE :** 1:5

DRAWN BY : C.F. **CHECKED BY :** J.M.K.

JOB NO. : J-836

REV. NO. : 1

CLIENT : MTR

PROJECT : PROPOSED SITE C1
DEVELOPMENT AT AREA 86,
TKOIL 70 RP, TSIUNG KWAN O,
NEW TERRITORIES

TITLE : TYPICAL DETAILS
FOR WINDOW-WALL (W4)

DATE : 07-DEC-2017 **SCALE :** 1:5

DRAWN BY : C.F. **CHECKED BY :** J.M.K.

JOB NO. : J-836

REV. NO. : 1

CLIENT : MTR

PROJECT : PROPOSED SITE C1
DEVELOPMENT AT AREA 86,
TKOIL 70 RP, TSIUNG KWAN O,
NEW TERRITORIES

TITLE : TYPICAL DETAILS
FOR WINDOW-WALL (W4)

DATE : 07-DEC-2017 **SCALE :** 1:5

DRAWN BY : C.F. **CHECKED BY :** J.M.K.

JOB NO. : J-836

REV. NO. : 1

CLIENT : MTR

PROJECT : PROPOSED SITE C1
DEVELOPMENT AT AREA 86,
TKOIL 70 RP, TSIUNG KWAN O,
NEW TERRITORIES

TITLE : TYPICAL DETAILS
FOR WINDOW-WALL (W4)

DATE : 07-DEC-2017 **SCALE :** 1:5

DRAWN BY : C.F. **CHECKED BY :** J.M.K.

JOB NO. : J-836

REV. NO. : 1

CLIENT : MTR

PROJECT : PROPOSED SITE C1
DEVELOPMENT AT AREA 86,
TKOIL 70 RP, TSIUNG KWAN O,
NEW TERRITORIES

TITLE : TYPICAL DETAILS
FOR WINDOW-WALL (W4)

DATE : 07-DEC-2017 **SCALE :** 1:5

DRAWN BY : C.F. **CHECKED BY :** J.M.K.

JOB NO. : J-836

REV. NO. : 1

CLIENT : MTR

PROJECT : PROPOSED SITE C1
DEVELOPMENT AT AREA 86,
TKOIL 70 RP, TSIUNG KWAN O,
NEW TERRITORIES

TITLE : TYPICAL DETAILS
FOR WINDOW-WALL (W4)

DATE : 07-DEC-2017 **SCALE :** 1:5

DRAWN BY : C.F. **CHECKED BY :** J.M.K.

JOB NO. : J-836

REV. NO. : 1

CLIENT : MTR

PROJECT : PROPOSED SITE C1
DEVELOPMENT AT AREA 86,
TKOIL 70 RP, TSIUNG KWAN O,
NEW TERRITORIES

TITLE : TYPICAL DETAILS
FOR WINDOW-WALL (W4)

DATE : 07-DEC-2017 **SCALE :** 1:5

DRAWN BY : C.F. **CHECKED BY :** J.M.K.

JOB NO. : J-836

REV. NO. : 1

CLIENT : MTR

PROJECT : PROPOSED SITE C1
DEVELOPMENT AT AREA 86,
TKOIL 70 RP, TSIUNG KWAN O,
NEW TERRITORIES

TITLE : TYPICAL DETAILS
FOR WINDOW-WALL (W4)

DATE : 07-DEC-2017 **SCALE :** 1:5

DRAWN BY : C.F. **CHECKED BY :** J.M.K.

JOB NO. : J-836

REV. NO. : 1

CLIENT : MTR

PROJECT : PROPOSED SITE C1
DEVELOPMENT AT AREA 86,
TKOIL 70 RP, TSIUNG KWAN O,
NEW TERRITORIES

TITLE : TYPICAL DETAILS
FOR WINDOW-WALL (W4)

DATE : 07-DEC-2017 **SCALE :** 1:5

DRAWN BY : C.F. **CHECKED BY :** J.M.K.

JOB NO. : J-836

REV. NO. : 1

CLIENT : MTR

PROJECT : PROPOSED SITE C1
DEVELOPMENT AT AREA 86,
TKOIL 70 RP, TSIUNG KWAN O,
NEW TERRITORIES

TITLE : TYPICAL DETAILS
FOR WINDOW-WALL (W4)

DATE : 07-DEC-2017 **SCALE :** 1:5

DRAWN BY : C.F. **CHECKED BY :** J.M.K.

JOB NO. : J-836

S275 JO

熱浸鍍

BM表

WW4-构件清单

Assy Mk	Qty	Name	Profile	Area (m ²)	Weight (kg)
2B-1	2	BEAM	RHS120*80*6.3	0.65	30.55
2B-2	2	BEAM	RHS120*80*6.3	0.22	9.73
2B-3	2	BEAM	RHS120*80*6.3	0.65	30.51
2B-4	4	BEAM	RHS120*80*6.3	0.65	30.48
2B-5	2	BEAM	RHS120*80*6.3	0.65	30.50
2B-6	2	BEAM	RHS120*80*6.3	0.65	30.60
2B-7	1	BEAM	RHS120*80*6.3	0.66	30.98
2B-8	2	BEAM	RHS120*80*6.3	0.66	30.96
2B-9	13	BEAM	RHS120*80*6.3	0.65	30.67
2B-10	4	BEAM	RHS120*80*6.3	0.65	30.78
2B-11	2	BEAM	RHS120*80*6.3	0.65	30.71
2B-12	4	BEAM	RHS120*80*6.3	0.65	30.61
2B-13	2	BEAM	RHS120*80*6.3	0.64	30.26
2B-14	18	BEAM	RHS120*80*6.3	0.66	30.98
2B-15	7	BEAM	RHS120*80*6.3	0.65	30.94
2B-16	4	BEAM	RHS120*80*6.3	0.66	31.00
2B-17	7	BEAM	RHS120*80*6.3	0.66	31.01
2B-18	2	BEAM	RHS120*80*6.3	0.68	31.91
2B-19	2	BEAM	RHS120*80*6.3	0.65	30.43
2B-20	2	BEAM	RHS120*80*6.3	0.65	30.29
2B-21	2	BEAM	RHS120*80*6.3	0.65	30.30
2B-22	2	BEAM	RHS120*80*6.3	0.65	30.49
2B-23	13	BEAM	RHS120*80*6.3	0.65	30.73
2B-24	2	BEAM	RHS120*80*6.3	0.65	30.70
2B-25	1	BEAM	RHS120*80*6.3	0.13	5.52
2B-26	2	BEAM	RHS120*80*6.3	0.65	30.57
2C-1	4	COLUMN	RHS150*100*12.5	1.85	174.42
2C-2	5	COLUMN	RHS150*100*12.5	1.85	174.42
2C-3	1	COLUMN	RHS150*100*12.5	1.85	174.42
2C-4	3	COLUMN	RHS150*100*12.5	1.85	174.42
2C-5	3	COLUMN	RHS150*100*12.5	1.85	174.42
2C-6	37	COLUMN	RHS150*100*12.5	1.85	174.42
2C-7	1	COLUMN	RHS150*100*12.5	1.85	174.42
2C-8	1	COLUMN	RHS150*100*12.5	1.85	92.36
2C-10	1	BEAM	PL5*220.1	1.78	34.12
2JM-1	108	BEAM	RSA100*75*6	0.07	1.53
2SM-1	196	BEAM	RSA50*50*5	0.02	0.37
2SM-2	16	BEAM	RSA50*50*5	0.02	0.34
2U-1	43	BEAM	RSC75x75x6	1.02	25.14
2U-2	1	BEAM	RSC75x75x6	1.04	25.65
2U-3	1	BEAM	RSA100*75*8	0.08	2.41
3B-1	12	BEAM	RHS120*80*6.3	0.65	30.75
3B-2	2	BEAM	RHS120*80*6.3	0.65	30.80
3B-3	2	BEAM	RHS120*80*6.3	0.66	30.97
3B-4	2	BEAM	RHS120*80*6.3	0.65	30.84
3B-5	2	BEAM	RHS120*80*6.3	0.65	30.53
3B-6	20	BEAM	RHS120*80*6.3	0.65	30.66
3B-7	4	BEAM	RHS120*80*6.3	0.65	30.71
3B-8	4	BEAM	RHS120*80*6.3	0.65	30.78
3B-9	2	BEAM	RHS120*80*6.3	0.65	30.72
3B-10	10	BEAM	RHS120*80*6.3	0.65	30.61
3B-11	2	BEAM	RHS120*80*6.3	0.65	30.46
3B-12	6	BEAM	RHS120*80*6.3	0.64	30.26
3B-13	2	BEAM	RHS120*80*6.3	0.66	31.00

2/2 先送 10/07/2018

2B材料

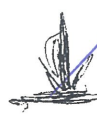

WW4-构件清单

3C-1	1	COLUMN	RHS150*100*12.5	1.85	174.42
3C-2	1	COLUMN	RHS150*100*12.5	1.69	159.27
3C-3	4	COLUMN	RHS150*100*12.5	1.85	174.42
3C-4	1	COLUMN	RHS150*100*12.5	1.85	174.42
3C-5	29	COLUMN	RHS150*100*12.5	1.69	159.27
3JM-1	72	BEAM	RSA100*75*6	0.07	1.53
3SM-1	124	BEAM	RSA50*50*5	0.02	0.37
3SM-2	16	BEAM	RSA50*50*5	0.02	0.34
3U-1	5	BEAM	RSC75x75x6	1.02	25.14
3U-2	30	BEAM	RSC75x75x6	1.11	27.31
4B-1	2	BEAM	RHS120*80*6.3	0.66	31.38
4B-2	4	BEAM	RHS120*80*6.3	0.65	30.75
4B-3	12	BEAM	RHS120*80*6.3	0.65	30.77
4B-4	22	BEAM	RHS120*80*6.3	0.65	30.70
4B-5	10	BEAM	RHS120*80*6.3	0.65	30.65
4B-6	2	BEAM	RHS120*80*6.3	0.65	30.39
4B-7	4	BEAM	RHS120*80*6.3	0.65	30.35
4B-8	2	BEAM	RHS120*80*6.3	0.64	30.11
4B-9	6	BEAM	RHS120*80*6.3	0.65	30.45
4B-10	2	BEAM	RHS120*80*6.3	0.65	30.59
4B-11	2	BEAM	RHS120*80*6.3	0.65	30.72
4B-12	4	BEAM	RHS120*80*6.3	0.65	30.76
4B-13	4	BEAM	RHS120*80*6.3	0.65	30.74
4B-14	8	BEAM	RHS120*80*6.3	0.66	31.01
4B-15	2	BEAM	RHS120*80*6.3	0.65	30.71
4B-16	2	BEAM	RHS120*80*6.3	0.65	30.84
4C-1	43	COLUMN	RHS150*100*12.5	1.85	174.42
4C-2	1	BEAM	PFC-100*50*10	1.67	37.31
4C-3	1	COLUMN	RHS150*100*12.5	1.85	174.42
4JM-1	88	BEAM	RSA100*75*6	0.07	1.53
4SM-1	28	BEAM	RSA50*50*5	0.02	0.34
4SM-2	146	BEAM	RSA50*50*5	0.02	0.37
4U-1	44	BEAM	RSC75x75x6	1.02	25.14
Total for 1319 assemblies:				576.01	34889.6