



工程指示 / 要求簡箋(E.I.)

工程指示編號：EI/ 6032 /16

修改版次：-

工程編號：J835

工程名稱：TKO66D2 TL118

工程項目：Sample - 鋁啣料樣板

收件人：生統、倉庫

發件人：Stanley

日期：12-10-2016

要求提供 /  確認 事項：

- |                                    |  |                               |
|------------------------------------|--|-------------------------------|
| <input type="checkbox"/> 初步鋁料 B.M. | <input type="checkbox"/> 加工拆圖，然後生產           | <input type="checkbox"/> 尺寸表  |
| <input type="checkbox"/> 正式鋁料 B.M. | <input type="checkbox"/> 技術上資料 / 指示          | <input type="checkbox"/> 報價   |
| <input type="checkbox"/> 配件 B.M.   | <input checked="" type="checkbox"/> 樣辦或貨品說明書 | <input type="checkbox"/> 分判合約 |
| <input type="checkbox"/> 其他：_____  |  |                               |

內容：

請提供圖則要求啣料樣板，一式一份，並需釘裝於樣板箱上：

(註:不需要製作圖中的鐵料樣板)

請在 26-10-2016 前完成上列要求。

附有關圖紙 / 文件：

圖紙六張

以上項目為：

- 原合約工程包       原合約工程加 / 減賬       新工程報價

原因：-

分發東莞各部門：

- ( ) 生產技術總監  連附件    ( ) 技術部  連附件    ( ) 生產部  連附件    ( ) 機械設計部  連附件  
 ( ) 採購部  連附件    ( ) 生產統籌部  連附件  
 ( ) 質檢部  連附件    ( ) 會計部  連附件    ( ) 報關組  連附件    ( ) 其他 \_\_\_\_\_  連附件

分發香港各部門：

- ( ) 行政部  連附件    ( ) 會計部  連附件    ( ) 統籌部  連附件    ( ) 工程部地盤科文  連附件  
 ( ) 採購部  連附件    ( ) QS 部  連附件    ( ) 維修部  連附件    (  ) 其他 林哥、師傅強  連附件

傳遞編號：HK2173 /16

發件人簽署：Hang  
項目經理簽署：

A1H

ALUMINIUM EXTRUSION\_  
MARK: A1

GRADE: 6063-T5

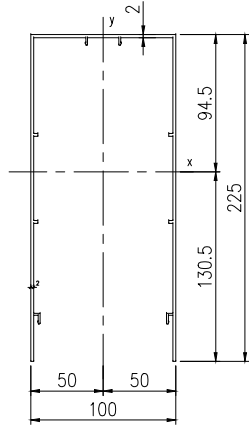

MASS PROPERTIES (UNIT)	VALUES
Area (mm <sup>2</sup> ):	1157.74
Perimeter (mm):	1183.79
Bounding Box - X (mm):	-50.00 to 50.00
Bounding Box - Y (mm):	-130.52 to 94.48
Centroid - X (mm):	0.00
Centroid - Y (mm):	0.00
Moments of inertia - X (mm <sup>4</sup> ):	6181205.73
Moments of inertia - Y (mm <sup>4</sup> ):	2419553.24
Product of inertia - XY (mm <sup>4</sup> ):	0.00
Radii of gyration - X (mm):	73.07
Radii of gyration - Y (mm):	45.72
Principal moments along X-Y (mm <sup>4</sup> ):	2419553.24 along [0.00 -1.00]
Principal moments along Y-X (mm <sup>4</sup> ):	6181205.73 along [1.00 0.00]
Elastic Modulus - Zx (mm <sup>3</sup> ):	I / y-max= 47359.79
Elastic Modulus - Zy (mm <sup>3</sup> ):	J / x-max= 48391.06

ALUMINIUM EXTRUSION\_  
MARK: A2

GRADE: 6063-T5

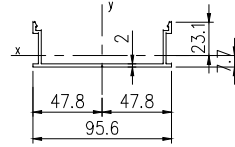

MASS PROPERTIES (UNIT)	VALUES
Area (mm <sup>2</sup> ):	323.45
Perimeter (mm):	326.70
Bounding Box - X (mm):	-47.80 to 47.80
Bounding Box - Y (mm):	-7.73 to 23.07
Centroid - X (mm):	0.00
Centroid - Y (mm):	0.00
Moments of inertia - X (mm <sup>4</sup> ):	30148.89
Moments of inertia - Y (mm <sup>4</sup> ):	402606.93
Product of inertia - XY (mm <sup>4</sup> ):	0.00
Radii of gyration - X (mm):	9.65
Radii of gyration - Y (mm):	35.28
Principal moments along X-Y (mm <sup>4</sup> ):	30148.89 along [1.00 0.00]
Principal moments along Y-X (mm <sup>4</sup> ):	402606.93 along [0.00 1.00]
Elastic Modulus - Zx (mm <sup>3</sup> ):	I / y-max= 1306.65
Elastic Modulus - Zy (mm <sup>3</sup> ):	J / x-max= 8422.74

ALUMINIUM EXTRUSION\_  
MARK: A3

GRADE: 6063-T6

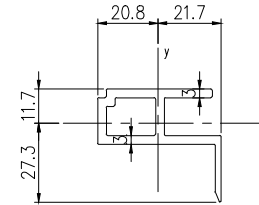

MASS PROPERTIES (UNIT)	VALUES
Area (mm <sup>2</sup> ):	361.39
Perimeter (mm):	251.52
Bounding Box - X (mm):	-20.80 to 21.70
Bounding Box - Y (mm):	-27.30 to 11.70
Centroid - X (mm):	0.00
Centroid - Y (mm):	0.00
Moments of inertia - X (mm <sup>4</sup> ):	23484.59
Moments of inertia - Y (mm <sup>4</sup> ):	70224.92
Product of inertia - XY (mm <sup>4</sup> ):	0.00
Radii of gyration - X (mm):	9.00
Radii of gyration - Y (mm):	13.35
Principal moments along X-Y (mm <sup>4</sup> ):	23484.59 along [0.9358 -0.3525]
Principal moments along Y-X (mm <sup>4</sup> ):	70224.92 along [0.3525 0.9358]
Elastic Modulus - Zx (mm <sup>3</sup> ):	I / y-max= 1074.38
Elastic Modulus - Zy (mm <sup>3</sup> ):	J / x-max= 2970.75

ALUMINIUM EXTRUSION\_  
MARK: A4

GRADE: 6063-T6

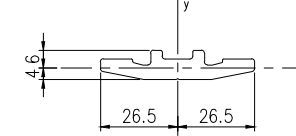

MASS PROPERTIES (UNIT)	VALUES
Area (mm <sup>2</sup> ):	328.93
Perimeter (mm):	128.49
Bounding Box - X (mm):	-26.5 to 26.5
Bounding Box - Y (mm):	-4.00 to 6.00
Centroid - X (mm):	0.00
Centroid - Y (mm):	0.00
Moments of inertia - X (mm <sup>4</sup> ):	1569.72
Moments of inertia - Y (mm <sup>4</sup> ):	63609.75
Product of inertia - XY (mm <sup>4</sup> ):	0.00
Radii of gyration - X (mm):	2.19
Radii of gyration - Y (mm):	13.91
Principal moments along X-Y (mm <sup>4</sup> ):	1569.72 along [0.9358 -0.3525]
Principal moments along Y-X (mm <sup>4</sup> ):	63609.75 along [0.3525 0.9358]
Elastic Modulus - Zx (mm <sup>3</sup> ):	I / y-max= 262.55
Elastic Modulus - Zy (mm <sup>3</sup> ):	J / x-max= 2400.37

B.D. Ref.  
F.P.B. Ref.

DATE/REVISION/AMENDMENTS

**SUN HUNG KAI**  
ARCHITECTS AND ENGINEERS LTD.

SUN HUNG KAI CENTRE, WANCHAI, HONGKONG  
TEL: 28278111 FAX: 28272884

YEE FAI CONTRACTORS CO. LTD.

44/F SUN HUNG KAI CENTRE, WANCHAI, HONGKONG  
TEL: 23489211-4 Fax: (852)2727666

**美特鋁質有限公司**  
MIDI ALUMINIUM FABRICATOR LTD.

Units 6-8, Sunray Industrial Centre, 1/F  
610 Cha Kwo Ling Road, Kowloon  
Tel: 23489211-4 Fax: (852)2727666

This drawing and design are copyright of the authorized person. No portion may be reproduced without his written permission. Use written dimensions. Measurements to existing works to be verified on site. This drawing shall be read in conjunction with specification and condition of contract.

ALUMINIUM EXTRUSION\_  
MARK: A5

GRADE: 6063-T6

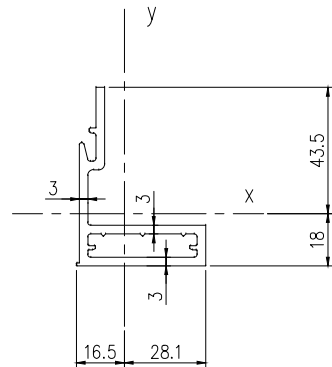

MASS PROPERTIES (UNIT)	VALUES
Area (mm <sup>2</sup> ):	498.98
Perimeter (mm):	334.99
Bounding Box - X (mm):	-16.50 to 28.10
Bounding Box - Y (mm):	-18.00 to 43.50
Centroid - X (mm):	0.00
Centroid - Y (mm):	0.00
Moments of inertia - X (mm <sup>4</sup> ):	61980.9853
Moments of inertia - Y (mm <sup>4</sup> ):	182517.3593
Product of inertia - XY (mm <sup>4</sup> ):	0.00
Radii of gyration - X (mm):	16.99
Radii of gyration - Y (mm):	14.19
Principal moments along X-Y (mm <sup>4</sup> ):	61980.9853 along [0.5648 -0.8253]
Principal moments along Y-X (mm <sup>4</sup> ):	182517.3593 along [0.8253 0.5648]
Elastic Modulus - Zx (mm <sup>3</sup> ):	I / y-max= 3310.38
Elastic Modulus - Zy (mm <sup>3</sup> ):	J / x-max= 3577.69

ALUMINIUM EXTRUSION\_  
MARK: A6

GRADE: 6063-T5

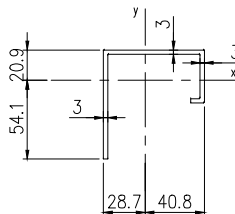

MASS PROPERTIES (UNIT)	VALUES
Area (mm <sup>2</sup> ):	544.50
Perimeter (mm):	367.71
Bounding Box - X (mm):	-28.70 to 40.80
Bounding Box - Y (mm):	-54.10 to 20.90
Centroid - X (mm):	0.00
Centroid - Y (mm):	0.00
Moments of inertia - X (mm <sup>4</sup> ):	190109.32
Moments of inertia - Y (mm <sup>4</sup> ):	496132.06
Product of inertia - XY (mm <sup>4</sup> ):	0.00
Radii of gyration - X (mm):	21.69
Radii of gyration - Y (mm):	28.11
Principal moments along X-Y (mm <sup>4</sup> ):	190109.32 along [0.886 0.464]
Principal moments along Y-X (mm <sup>4</sup> ):	496132.06 along [-0.464 0.886]
Elastic Modulus - Zx (mm <sup>3</sup> ):	I / y-max= 4737.88
Elastic Modulus - Zy (mm <sup>3</sup> ):	J / x-max= 10546.96

ALUMINIUM EXTRUSION\_  
MARK: A7

GRADE: 6063-T5

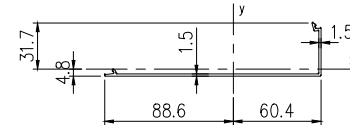

MASS PROPERTIES (UNIT)	VALUES
Area (mm <sup>2</sup> ):	285.87
Perimeter (mm):	384.07
Bounding Box - X (mm):	-88.60 to 60.40
Bounding Box - Y (mm):	-4.80 to 31.70
Centroid - X (mm):	0.00
Centroid - Y (mm):	0.00
Moments of inertia - X (mm <sup>4</sup> ):	17694.66
Moments of inertia - Y (mm <sup>4</sup> ):	692885.27
Product of inertia - XY (mm <sup>4</sup> ):	0.00
Radii of gyration - X (mm):	9.23
Radii of gyration - Y (mm):	48.99
Principal moments along X-Y (mm <sup>4</sup> ):	17694.66 along [0.995 0.099]
Principal moments along Y-X (mm <sup>4</sup> ):	692885.27 along [-0.099 0.995]
Elastic Modulus - Zx (mm <sup>3</sup> ):	I / y-max= 767.88
Elastic Modulus - Zy (mm <sup>3</sup> ):	J / x-max= 7743.43

ALUMINIUM EXTRUSION\_  
MARK: A8

GRADE: 6063-T6

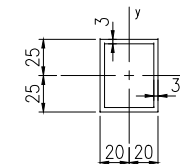

MASS PROPERTIES (UNIT)	VALUES
Area (mm <sup>2</sup> ):	504.00
Perimeter (mm):	336.00
Bounding Box - X (mm):	-20.00 to 20.00
Bounding Box - Y (mm):	-25.00 to 25.00
Centroid - X (mm):	0.00
Centroid - Y (mm):	0.00
Moments of inertia - X (mm <sup>4</sup> ):	175312.00
Moments of inertia - Y (mm <sup>4</sup> ):	122552.00
Product of inertia - XY (mm <sup>4</sup> ):	0.00
Radii of gyration - X (mm):	18.65
Radii of gyration - Y (mm):	15.59
Principal moments along X-Y (mm <sup>4</sup> ):	175312.00 along [1.000 0.000]
Principal moments along Y-X (mm <sup>4</sup> ):	122552.00 along [0.000 1.000]
Elastic Modulus - Zx (mm <sup>3</sup> ):	I / y-max= 7012.48
Elastic Modulus - Zy (mm <sup>3</sup> ):	J / x-max= 6127.60

PROJECT  
PROPOSED RESIDENTIAL  
DEVELOPMENT AT  
TSEUNG KWAN O  
AREA 66D2, T.K.O.T.L. 118

TITLE  
SECTION PROPERTIES OF CURTAIN WALL  
( 1 OF 4 )

FILE NAME

DRAWN BY

CHECKED BY

PRINTED DATE

SCALE 1:5

JOB No.	DRAWING No.	REV.
J-835	J835-CW-GN02	-

R.S.E.

FOR B.D. APPROVAL

A1H  
STEEL MARK: MARK: A9  
30x30x5mm THK. G.M.S ANGLE  
GRADE: S275

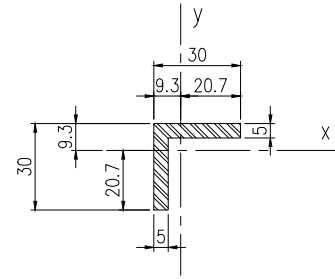

MASS PROPERTIES (UNIT)	VALUES
Area (mm <sup>2</sup> ):	275.00
Perimeter (mm):	120.00
Bounding Box - X (mm):	-9.30 to 20.70
Bounding Box - Y (mm):	-9.30 to 20.70
Centroid - X (mm):	0.00
Centroid - Y (mm):	0.00
Moments of inertia - X (mm <sup>4</sup> ):	9379.76
Moments of inertia - Y (mm <sup>4</sup> ):	34947.94
Product of inertia - XY (mm <sup>4</sup> ):	0.00
Radii of gyration - X (mm):	8.98
Radii of gyration - Y (mm):	8.98
Principal moments along X-Y (mm <sup>4</sup> ):	9379.76 along [1.000 0.000]
Principal moments along Y-X (mm <sup>4</sup> ):	34947.94 along [0.000 1.000]
Elastic Modulus - Zx (mm <sup>3</sup> ):	I / y-max= 1071.66
Elastic Modulus - Zy (mm <sup>3</sup> ):	J / x-max= 1071.66

ALUMINIUM EXTRUSION\_  
MARK: A10  
GRADE: 6063-T6

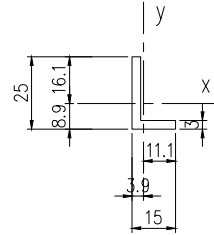

MASS PROPERTIES (UNIT)	VALUES
Area (mm <sup>2</sup> ):	111.00
Perimeter (mm):	80.00
Bounding Box - X (mm):	-3.90 to 11.10
Bounding Box - Y (mm):	-8.90 to 16.10
Centroid - X (mm):	0.00
Centroid - Y (mm):	0.00
Moments of inertia - X (mm <sup>4</sup> ):	1152.91
Moments of inertia - Y (mm <sup>4</sup> ):	7580.08
Product of inertia - XY (mm <sup>4</sup> ):	0.00
Radii of gyration - X (mm):	7.87
Radii of gyration - Y (mm):	4.09
Principal moments along X-Y (mm <sup>4</sup> ):	1152.91 along [1.000 0.000]
Principal moments along Y-X (mm <sup>4</sup> ):	7580.08 along [0.000 1.000]
Elastic Modulus - Zx (mm <sup>3</sup> ):	I / y-max= 427.97
Elastic Modulus - Zy (mm <sup>3</sup> ):	J / x-max= 167.74

ALUMINIUM EXTRUSION\_  
MARK: A11  
GRADE: 6063-T6

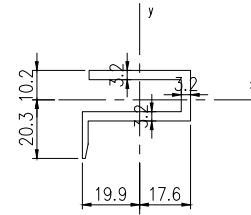

MASS PROPERTIES (UNIT)	VALUES
Area (mm <sup>2</sup> ):	289.63
Perimeter (mm):	198.83
Bounding Box - X (mm):	-19.90 to 17.60
Bounding Box - Y (mm):	-10.20 to 20.30
Centroid - X (mm):	0.00
Centroid - Y (mm):	0.00
Moments of inertia - X (mm <sup>4</sup> ):	15096.71
Moments of inertia - Y (mm <sup>4</sup> ):	45168.79
Product of inertia - XY (mm <sup>4</sup> ):	0.00
Radii of gyration - X (mm):	7.69
Radii of gyration - Y (mm):	12.20
Principal moments along X-Y (mm <sup>4</sup> ):	15096.71 along [1.000 0.000]
Principal moments along Y-X (mm <sup>4</sup> ):	45168.79 along [0.000 1.000]
Elastic Modulus - Zx (mm <sup>3</sup> ):	I / y-max= 842.53
Elastic Modulus - Zy (mm <sup>3</sup> ):	J / x-max= 2171.93

ALUMINIUM EXTRUSION\_  
MARK: A12  
GRADE: 6063-T6

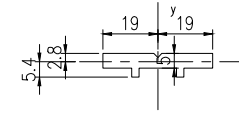

MASS PROPERTIES (UNIT)	VALUES
Area (mm <sup>2</sup> ):	203.90
Perimeter (mm):	99.89
Bounding Box - X (mm):	-19.00 to 19.00
Bounding Box - Y (mm):	-2.80 to 5.40
Centroid - X (mm):	0.00
Centroid - Y (mm):	0.00
Moments of inertia - X (mm <sup>4</sup> ):	643.35
Moments of inertia - Y (mm <sup>4</sup> ):	23826.00
Product of inertia - XY (mm <sup>4</sup> ):	0.00
Radii of gyration - X (mm):	1.78
Radii of gyration - Y (mm):	10.81
Principal moments along X-Y (mm <sup>4</sup> ):	643.35 along [1.000 0.000]
Principal moments along Y-X (mm <sup>4</sup> ):	23826.00 along [0.000 1.000]
Elastic Modulus - Zx (mm <sup>3</sup> ):	I / y-max= 120.45
Elastic Modulus - Zy (mm <sup>3</sup> ):	J / x-max= 1254.00

B.D. Ref.

F.P.B. Ref.

DATE/REVISION/AMENDMENTS

**SUN HUNG KAI**  
ARCHITECTS AND ENGINEERS LTD.

SUN HUNG KAI CENTRE, WANCHAI, HONGKONG  
TEL: 28278111 FAX: 28272884

YEE FAI CONTRACTORS CO. LTD.

44/F SUN HUNG KAI CENTRE, WANCHAI, HONGKONG  
TEL: 28278111 FAX: 28270717

**英特鋁質有限公司**  
MIDI ALUMINIUM FABRICATOR LTD.

Units 6-8, Sunray Industrial Centre, 1/F  
610 Cho Kwo Ling Road, Kowloon  
Tel: 23489211-4 Fax: (852)2727666

This drawing and design are copyright of the authorized person. No portion may be reproduced without his written permission. Use written dimensions. Measurements to existing works to be verified on site. This drawing shall be read in conjunction with specification and condition of contract.

ALUMINIUM EXTRUSION\_  
MARK: M1  
GRADE: 6063-T6

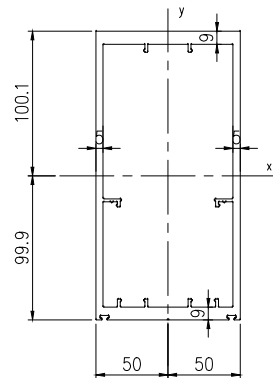

MASS PROPERTIES (UNIT)	VALUES
Area (mm <sup>2</sup> ):	3730.37
Perimeter (mm):	1299.38
Bounding Box - X (mm):	-50.00 to 50.00
Bounding Box - Y (mm):	-99.99 to 100.10
Centroid - X (mm):	0.00
Centroid - Y (mm):	0.00
Moments of inertia - X (mm <sup>4</sup> ):	21737231.53
Moments of inertia - Y (mm <sup>4</sup> ):	5688542.00
Product of inertia - XY (mm <sup>4</sup> ):	0.00
Radii of gyration - X (mm):	76.34
Radii of gyration - Y (mm):	39.05
Principal moments along X-Y (mm <sup>4</sup> ):	5688542.00 along [1.000 0.000]
Principal moments along Y-X (mm <sup>4</sup> ):	21737231.53 along [0.000 1.000]
Elastic Modulus - Zx (mm <sup>3</sup> ):	I / y-max= 217194.34
Elastic Modulus - Zy (mm <sup>3</sup> ):	J / x-max= 113770.84

ALUMINIUM EXTRUSION\_  
MARK: T1  
GRADE: 6063-T6

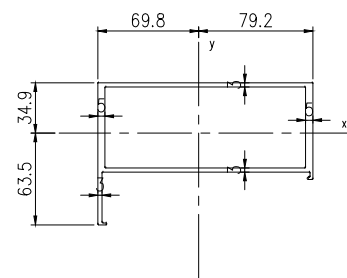

MASS PROPERTIES (UNIT)	VALUES
Area (mm <sup>2</sup> ):	1580.09
Perimeter (mm):	901.42
Bounding Box - X (mm):	-69.80 to 79.20
Bounding Box - Y (mm):	-63.50 to 34.90
Centroid - X (mm):	0.00
Centroid - Y (mm):	0.00
Moments of inertia - X (mm <sup>4</sup> ):	1180524.79
Moments of inertia - Y (mm <sup>4</sup> ):	5225082.07
Product of inertia - XY (mm <sup>4</sup> ):	0.00
Radii of gyration - X (mm):	27.69
Radii of gyration - Y (mm):	57.33
Principal moments along X-Y (mm <sup>4</sup> ):	1180524.79 along [0.996 0.088]
Principal moments along Y-X (mm <sup>4</sup> ):	5225082.07 along [-0.088 0.996]
Elastic Modulus - Zx (mm <sup>3</sup> ):	I / y-max= 19067.48
Elastic Modulus - Zy (mm <sup>3</sup> ):	J / x-max= 65606.20

STEEL MARK: S1  
210x80x30x25mm THK. G.M.S.  
BUILD-UP RHS  
GRADE: S275

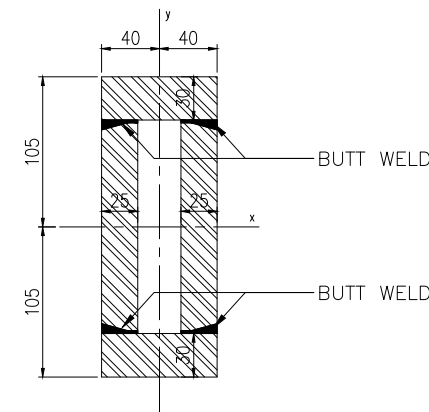

MASS PROPERTIES (UNIT)	VALUES
Area (mm <sup>2</sup> ):	12200.00
Perimeter (mm):	932.00
Bounding Box - X (mm):	-40.00 to 40.00
Bounding Box - Y (mm):	-104.00 to 104.00
Centroid - X (mm):	0.00
Centroid - Y (mm):	0.00
Moments of inertia - X (mm <sup>4</sup> ):	51888266.67
Moments of inertia - Y (mm <sup>4</sup> ):	8541664.00
Product of inertia - XY (mm <sup>4</sup> ):	0.00
Radii of gyration - X (mm):	65.22
Radii of gyration - Y (mm):	26.46
Principal moments along X-Y (mm <sup>4</sup> ):	51888266.67 along [1.000 0.000]
Principal moments along Y-X (mm <sup>4</sup> ):	8541664.00 along [0.000 1.000]
Elastic Modulus - Zx (mm <sup>3</sup> ):	I / y-max= 498925.64
Elastic Modulus - Zy (mm <sup>3</sup> ):	J / x-max= 213541.60

STEEL MARK: S2  
50x32x6mm THK. G.M.S CHANNEL  
(CUT FROM 50x50x6mm THK. G.M.S SHS)  
GRADE: S275

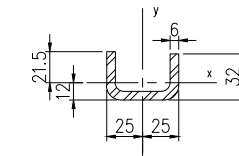

MASS PROPERTIES (UNIT)	VALUES
Area (mm <sup>2</sup> ):	593.53
Perimeter (mm):	205.27
Bounding Box - X (mm):	-24.70 to 25.30
Bounding Box - Y (mm):	-12.00 to 21.50
Centroid - X (mm):	0.00
Centroid - Y (mm):	0.00
Moments of inertia - X (mm <sup>4</sup> ):	57933.10
Moments of inertia - Y (mm <sup>4</sup> ):	201319.98
Product of inertia - XY (mm <sup>4</sup> ):	0.00
Radii of gyration - X (mm):	9.89
Radii of gyration - Y (mm):	18.41
Principal moments along X-Y (mm <sup>4</sup> ):	57933.10 along [1.000 -0.029]
Principal moments along Y-X (mm <sup>4</sup> ):	201319.98 along [0.029 1.000]
Elastic Modulus - Zx (mm <sup>3</sup> ):	I / y-max= 2703.82
Elastic Modulus - Zy (mm <sup>3</sup> ):	J / x-max= 7942.12

PROJECT  
PROPOSED RESIDENTIAL  
DEVELOPMENT AT  
TSEUNG KWAN O  
AREA 66D2, T.K.O.T.L. 118

TITLE  
SECTION PROPERTIES OF CURTAIN WALL  
( 2 OF 4)

FILE NAME

DRAWN BY

CHECKED BY

PRINTED DATE

SCALE 1:5

JOB No. DRAWING No. REV.

J-835 J835-CW-GN03 -

R.S.E.

FOR B.D. APPROVAL

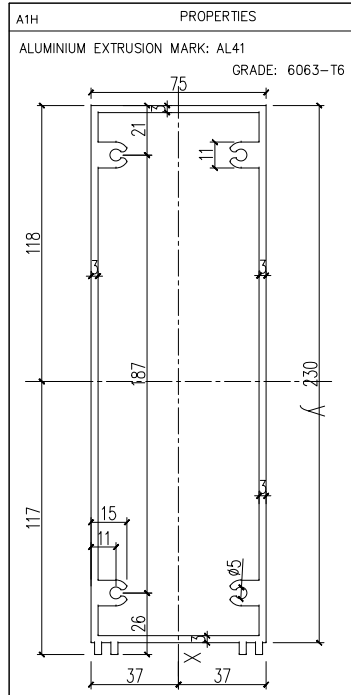

MASS PROPERTIES (UNIT)	VALUES
Area (mm <sup>2</sup> )	2282
Perimeter (mm)	1376
Bounding Box - X (mm)	-118 to 117
Bounding Box - Y (mm)	-37 to 37
Centroid - X (mm)	0
Centroid - Y (mm)	0
Moments of inertia - X (mm <sup>4</sup> )	2367575
Moments of inertia - Y (mm <sup>4</sup> )	15804207
Product of inertia - XY (mm <sup>4</sup> )	0
Radii of gyration - X (mm)	32
Radii of gyration - Y (mm)	84
Principal moments along X-Y (mm <sup>4</sup> )	2367575 along [1 0]
Principal moments along Y-X (mm <sup>4</sup> )	15804207 along [0 1]
Elastic Modulus - Zx (mm <sup>2</sup> )	1 / y-max= 63136
Elastic Modulus - Zy (mm <sup>2</sup> )	1 / x-max= 133860

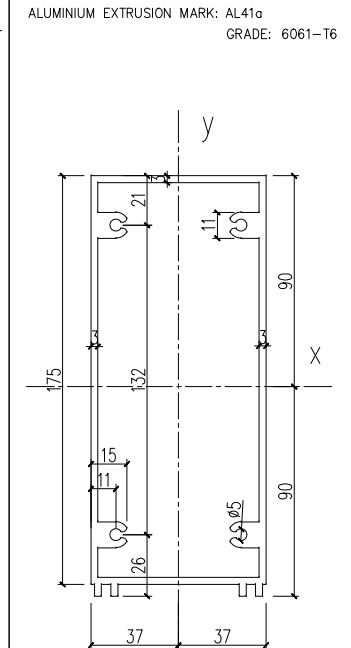

MASS PROPERTIES (UNIT)	VALUES
Area (mm <sup>2</sup> )	1932
Perimeter (mm)	1156
Bounding Box - X (mm)	-37 to 37
Bounding Box - Y (mm)	-90 to 90
Centroid - X (mm)	0
Centroid - Y (mm)	0
Moments of inertia - X (mm <sup>4</sup> )	8001110
Moments of inertia - Y (mm <sup>4</sup> )	1939655
Product of inertia - XY (mm <sup>4</sup> )	0
Radii of gyration - X (mm)	64
Radii of gyration - Y (mm)	32
Principal moments along X-Y (mm <sup>4</sup> )	1939655 along [0 -1]
Principal moments along Y-X (mm <sup>4</sup> )	8001110 along [1 0]
Elastic Modulus - Zx (mm <sup>2</sup> )	1 / y-max= 88661
Elastic Modulus - Zy (mm <sup>2</sup> )	1 / x-max= 51725

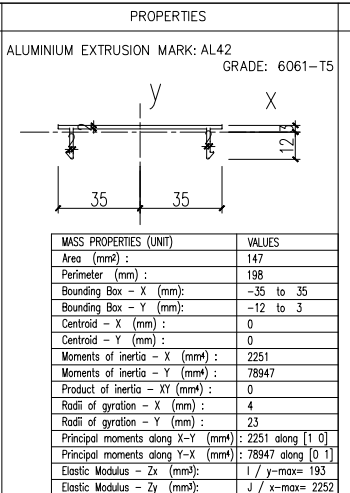

MASS PROPERTIES (UNIT)	VALUES
Area (mm <sup>2</sup> )	147
Perimeter (mm)	198
Bounding Box - X (mm)	-35 to 35
Bounding Box - Y (mm)	-12 to 3
Centroid - X (mm)	0
Centroid - Y (mm)	0
Moments of inertia - X (mm <sup>4</sup> )	2251
Moments of inertia - Y (mm <sup>4</sup> )	78947
Product of inertia - XY (mm <sup>4</sup> )	0
Radii of gyration - X (mm)	4
Radii of gyration - Y (mm)	23
Principal moments along X-Y (mm <sup>4</sup> )	2251 along [1 0]
Principal moments along Y-X (mm <sup>4</sup> )	78947 along [0 1]
Elastic Modulus - Zx (mm <sup>2</sup> )	1 / y-max= 193
Elastic Modulus - Zy (mm <sup>2</sup> )	1 / x-max= 2252

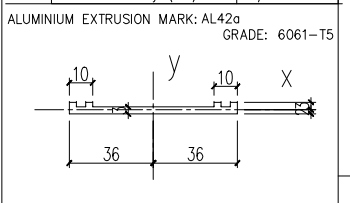

MASS PROPERTIES (UNIT)	VALUES
Area (mm <sup>2</sup> )	240
Perimeter (mm)	186
Bounding Box - X (mm)	-36 to 36
Bounding Box - Y (mm)	-2 to 3
Centroid - X (mm)	0
Centroid - Y (mm)	0
Moments of inertia - X (mm <sup>4</sup> )	305
Moments of inertia - Y (mm <sup>4</sup> )	116685
Product of inertia - XY (mm <sup>4</sup> )	0
Radii of gyration - X (mm)	1
Radii of gyration - Y (mm)	22
Principal moments along X-Y (mm <sup>4</sup> )	305 along [1 0]
Principal moments along Y-X (mm <sup>4</sup> )	116685 along [0 1]
Elastic Modulus - Zx (mm <sup>2</sup> )	1 / y-max= 94
Elastic Modulus - Zy (mm <sup>2</sup> )	1 / x-max= 3241

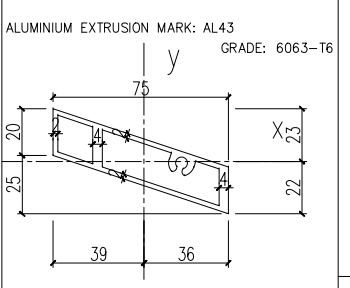

MASS PROPERTIES (UNIT)	VALUES
Area (mm <sup>2</sup> )	521
Perimeter (mm)	423
Bounding Box - X (mm)	-39 to 36
Bounding Box - Y (mm)	-22 to 23
Centroid - X (mm)	0
Centroid - Y (mm)	0
Moments of inertia - X (mm <sup>4</sup> )	61432
Moments of inertia - Y (mm <sup>4</sup> )	305329
Product of inertia - XY (mm <sup>4</sup> )	-98380
Radii of gyration - X (mm)	11
Radii of gyration - Y (mm)	24
Principal moments along X-Y (mm <sup>4</sup> )	26696 along [1 0]
Principal moments along Y-X (mm <sup>4</sup> )	340065 along [0 1]
Elastic Modulus - Zx (mm <sup>2</sup> )	1 / y-max= 2722
Elastic Modulus - Zy (mm <sup>2</sup> )	1 / x-max= 7846

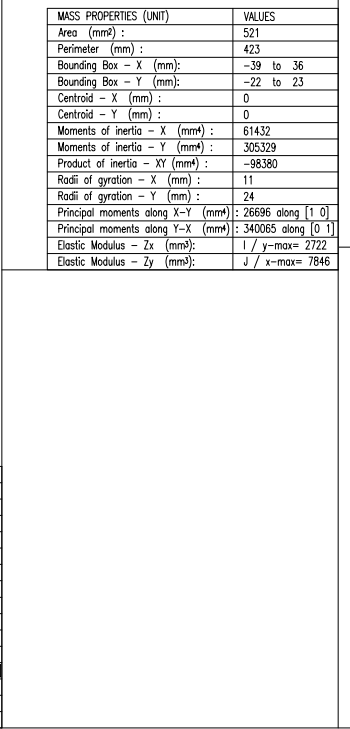

MASS PROPERTIES (UNIT)	VALUES
Area (mm <sup>2</sup> )	1700
Perimeter (mm)	680
Bounding Box - X (mm)	-45 to 45
Bounding Box - Y (mm)	-45 to 45
Centroid - X (mm)	0
Centroid - Y (mm)	0
Moments of inertia - X (mm <sup>4</sup> )	2054167
Moments of inertia - Y (mm <sup>4</sup> )	2054167
Product of inertia - XY (mm <sup>4</sup> )	0
Radii of gyration - X (mm)	35
Radii of gyration - Y (mm)	35
Principal moments along X-Y (mm <sup>4</sup> )	2054167 along [1 0]
Principal moments along Y-X (mm <sup>4</sup> )	2054167 along [0 1]
Elastic Modulus - Zx (mm <sup>2</sup> )	1 / y-max= 45648
Elastic Modulus - Zy (mm <sup>2</sup> )	1 / x-max= 45648

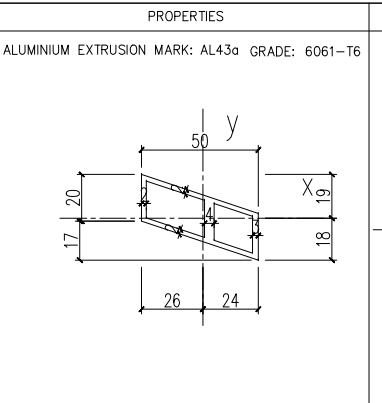

MASS PROPERTIES (UNIT)	VALUES
Area (mm <sup>2</sup> )	345
Perimeter (mm)	296
Bounding Box - X (mm)	-26 to 24
Bounding Box - Y (mm)	-18 to 19
Centroid - X (mm)	0
Centroid - Y (mm)	0
Moments of inertia - X (mm <sup>4</sup> )	29173
Moments of inertia - Y (mm <sup>4</sup> )	84945
Product of inertia - XY (mm <sup>4</sup> )	-28315
Radii of gyration - X (mm)	9
Radii of gyration - Y (mm)	16
Principal moments along X-Y (mm <sup>4</sup> )	17318 along [1 0]
Principal moments along Y-X (mm <sup>4</sup> )	96800 along [0 1]
Elastic Modulus - Zx (mm <sup>2</sup> )	1 / y-max= 1556
Elastic Modulus - Zy (mm <sup>2</sup> )	1 / x-max= 3236

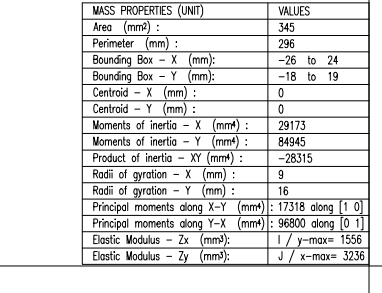

MASS PROPERTIES (UNIT)	VALUES
Area (mm <sup>2</sup> )	716
Perimeter (mm)	327
Bounding Box - X (mm)	-50 to 50
Bounding Box - Y (mm)	-9 to 25
Centroid - X (mm)	0
Centroid - Y (mm)	0
Moments of inertia - X (mm <sup>4</sup> )	68271
Moments of inertia - Y (mm <sup>4</sup> )	980805
Product of inertia - XY (mm <sup>4</sup> )	0
Radii of gyration - X (mm)	10
Radii of gyration - Y (mm)	37
Principal moments along X-Y (mm <sup>4</sup> )	68271 along [1 0]
Principal moments along Y-X (mm <sup>4</sup> )	980805 along [0 1]
Elastic Modulus - Zx (mm <sup>2</sup> )	1 / y-max= 2683
Elastic Modulus - Zy (mm <sup>2</sup> )	1 / x-max= 19616

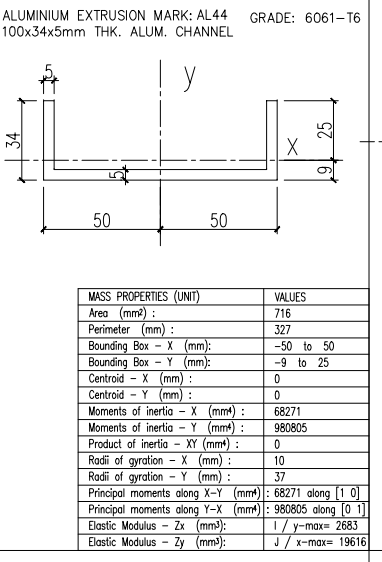

MASS PROPERTIES (UNIT)	VALUES
Area (mm <sup>2</sup> )	705
Perimeter (mm)	372
Bounding Box - X (mm)	-45 to 45
Bounding Box - Y (mm)	-31 to 11
Centroid - X (mm)	0
Centroid - Y (mm)	0
Moments of inertia - X (mm <sup>4</sup> )	111796
Moments of inertia - Y (mm <sup>4</sup> )	828482
Product of inertia - XY (mm <sup>4</sup> )	0
Radii of gyration - X (mm)	13
Radii of gyration - Y (mm)	34
Principal moments along X-Y (mm <sup>4</sup> )	111796 along [1 0]
Principal moments along Y-X (mm <sup>4</sup> )	828482 along [0 1]
Elastic Modulus - Zx (mm <sup>2</sup> )	1 / y-max= 3629
Elastic Modulus - Zy (mm <sup>2</sup> )	1 / x-max= 18411

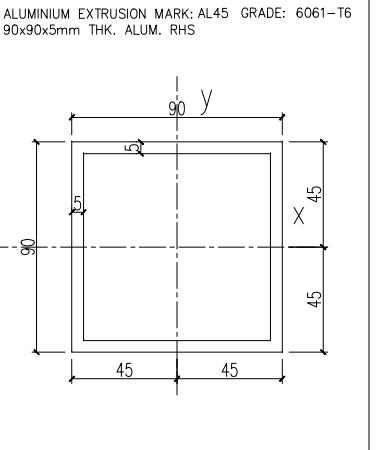

MASS PROPERTIES (UNIT)	VALUES
Area (mm <sup>2</sup> )	629
Perimeter (mm)	262
Bounding Box - X (mm)	-33 to 33
Bounding Box - Y (mm)	-47 to 18
Centroid - X (mm)	0
Centroid - Y (mm)	0
Moments of inertia - X (mm <sup>4</sup> )	255346
Moments of inertia - Y (mm <sup>4</sup> )	120414
Product of inertia - XY (mm <sup>4</sup> )	0
Radii of gyration - X (mm)	20
Radii of gyration - Y (mm)	14
Principal moments along X-Y (mm <sup>4</sup> )	120414 along [1 0]
Principal moments along Y-X (mm <sup>4</sup> )	255346 along [0 -1]
Elastic Modulus - Zx (mm <sup>2</sup> )	1 / y-max= 5439
Elastic Modulus - Zy (mm <sup>2</sup> )	1 / x-max= 3649

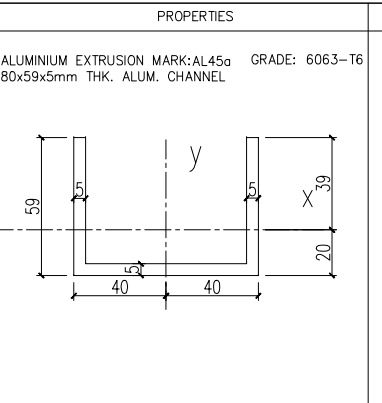

MASS PROPERTIES (UNIT)	VALUES
Area (mm <sup>2</sup> )	935
Perimeter (mm)	384
Bounding Box - X (mm)	-40 to 40
Bounding Box - Y (mm)	-20 to 39
Centroid - X (mm)	0
Centroid - Y (mm)	0
Moments of inertia - X (mm <sup>4</sup> )	330572
Moments of inertia - Y (mm <sup>4</sup> )	945818
Product of inertia - XY (mm <sup>4</sup> )	0
Radii of gyration - X (mm)	19
Radii of gyration - Y (mm)	32
Principal moments along X-Y (mm <sup>4</sup> )	330572 along [1 0]
Principal moments along Y-X (mm <sup>4</sup> )	945818 along [0 1]
Elastic Modulus - Zx (mm <sup>2</sup> )	1 / y-max= 8377
Elastic Modulus - Zy (mm <sup>2</sup> )	1 / x-max= 23945

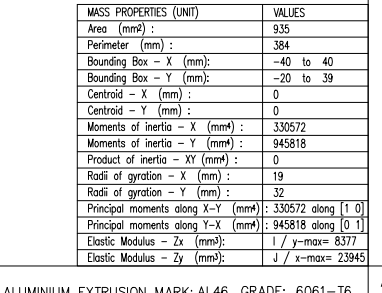

MASS PROPERTIES (UNIT)	VALUES
Area (mm <sup>2</sup> )	705
Perimeter (mm)	372
Bounding Box - X (mm)	-45 to 45
Bounding Box - Y (mm)	-31 to 11
Centroid - X (mm)	0
Centroid - Y (mm)	0
Moments of inertia - X (mm <sup>4</sup> )	111796
Moments of inertia - Y (mm <sup>4</sup> )	828482
Product of inertia - XY (mm <sup>4</sup> )	0
Radii of gyration - X (mm)	13
Radii of gyration - Y (mm)	34
Principal moments along X-Y (mm <sup>4</sup> )	111796 along [1 0]
Principal moments along Y-X (mm <sup>4</sup> )	828482 along [0 1]
Elastic Modulus - Zx (mm <sup>2</sup> )	1 / y-max= 3629
Elastic Modulus - Zy (mm <sup>2</sup> )	1 / x-max= 18411

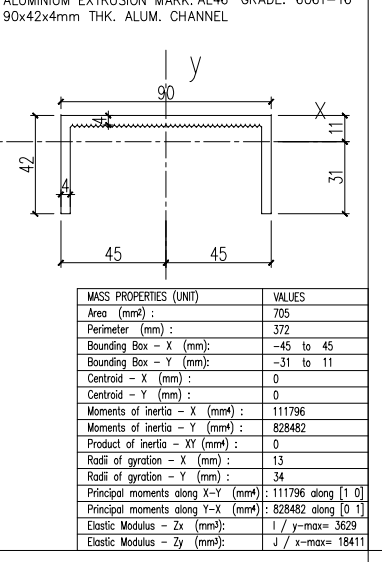

MASS PROPERTIES (UNIT)	VALUES
Area (mm <sup>2</sup> )	681
Perimeter (mm)	282
Bounding Box - X (mm)	-48 to 20
Bounding Box - Y (mm)	-15 to 38
Centroid - X (mm)	0
Centroid - Y (mm)	0
Moments of inertia - X (mm <sup>4</sup> )	177329
Moments of inertia - Y (mm <sup>4</sup> )	304897
Product of inertia - XY (mm <sup>4</sup> )	137711
Radii of gyration - X (mm)	16
Radii of gyration - Y (mm)	21
Principal moments along X-Y (mm <sup>4</sup> )	89348 along [1 1]
Principal moments along Y-X (mm <sup>4</sup> )	392878 along [-1 1]
Elastic Modulus - Zx (mm <sup>2</sup> )	1 / y-max= 4639
Elastic Modulus - Zy (mm <sup>2</sup> )	1 / x-max= 6368

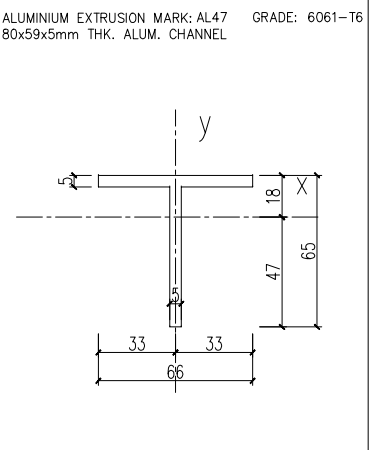

MASS PROPERTIES (UNIT)	VALUES
Area (mm <sup>2</sup> )	768
Perimeter (mm)	430
Bounding Box - X (mm)	-20 to 20
Bounding Box - Y (mm)	-29 to 31
Centroid - X (mm)	0
Centroid - Y (mm)	0
Moments of inertia - X (mm <sup>4</sup> )	303717
Moments of inertia - Y (mm <sup>4</sup> )	180736
Product of inertia - XY (mm <sup>4</sup> )	0
Radii of gyration - X (mm)	20
Radii of gyration - Y (mm)	15
Principal moments along X-Y (mm <sup>4</sup> )	180736 along [0 -1]
Principal moments along Y-X (mm <sup>4</sup> )	303717 along [1 0]
Elastic Modulus - Zx (mm <sup>2</sup> )	1 / y-max= 9857
Elastic Modulus - Zy (mm <sup>2</sup> )	1 / x-max= 9037

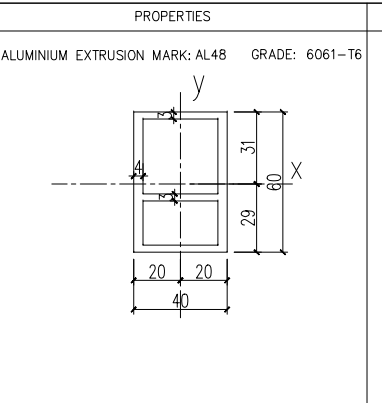

MASS PROPERTIES (UNIT)	VALUES
Area (mm <sup>2</sup> )	648
Perimeter (mm)	559
Bounding Box - X (mm)	-39 to 36
Bounding Box - Y (mm)	-25 to 25
Centroid - X (mm)	0
Centroid - Y (mm)	0
Moments of inertia - X (mm <sup>4</sup> )	316195
Moments of inertia - Y (mm <sup>4</sup> )	562338
Product of inertia - XY (mm <sup>4</sup> )	0
Radii of gyration - X (mm)	26
Radii of gyration - Y (mm)	28
Principal moments along X-Y (mm <sup>4</sup> )	316195 along [1 0]
Principal moments along Y-X (mm <sup>4</sup> )	562338 along [0 1]
Elastic Modulus - Zx (mm <sup>2</sup> )	1 / y-max= 12590
Elastic Modulus - Zy (mm <sup>2</sup> )	1 / x-max= 14511

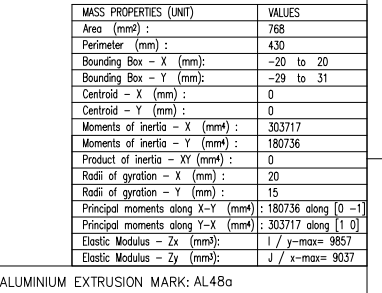

MASS PROPERTIES (UNIT)	VALUES
Area (mm <sup>2</sup> )	568
Perimeter (mm)	292
Bounding Box - X (mm)	-40 to 40
Bounding Box - Y (mm)	-10 to 25
Centroid - X (mm)	0
Centroid - Y (mm)	0
Moments of inertia - X (mm <sup>4</sup> )	63240
Moments of inertia - Y (mm <sup>4</sup> )	529477
Product of inertia - XY (mm <sup>4</sup> )	0
Radii of gyration - X (mm)	11
Radii of gyration - Y (mm)	31
Principal moments along X-Y (mm <sup>4</sup> )	63240 along [1 0]
Principal moments along Y-X (mm <sup>4</sup> )	529477 along [0 1]
Elastic Modulus - Zx (mm <sup>2</sup> )	1 / y-max= 2492
Elastic Modulus - Zy (mm <sup>2</sup> )	1 / x-max= 13237

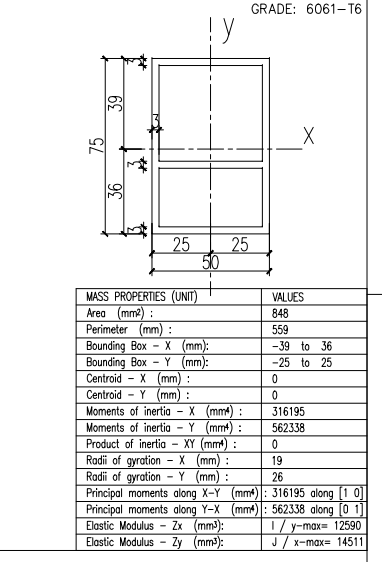

MASS PROPERTIES (UNIT)	VALUES
Area (mm <sup>2</sup> )	382
Perimeter (mm)	204
Bounding Box - X (mm)	-13 to 32
Bounding Box - Y (mm)	-34 to 15
Centroid - X (mm)	0
Centroid - Y (mm)	0
Moments of inertia - X (mm <sup>4</sup> )	90296
Moments of inertia - Y (mm <sup>4</sup> )	73216
Product of inertia - XY (mm <sup>4</sup> )	48475
Radii of gyration - X (mm)	15
Radii of gyration - Y (mm)	14
Principal moments along X-Y (mm <sup>4</sup> )	32534 along [1 1]
Principal moments along Y-X (mm <sup>4</sup> )	130978 along [-1 1]
Elastic Modulus - Zx (mm <sup>2</sup> )	1 / y-max= 2634
Elastic Modulus - Zy (mm <sup>2</sup> )	1 / x-max= 2274

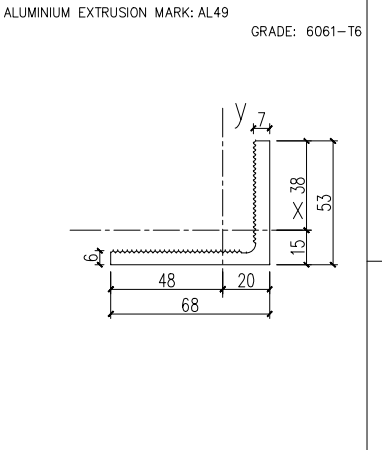

MASS PROPERTIES (UNIT)	VALUES
Area (mm <sup>2</sup> )	141
Perimeter (mm)	100
Bounding Box - X (mm)	-18 to 7
Bounding Box - Y (mm)	-7 to 18
Centroid - X (mm)	0
Centroid - Y (mm)	0
Moments of inertia - X (mm <sup>4</sup> )	8204
Moments of inertia - Y (mm <sup>4</sup> )	8204
Product of inertia - XY (mm <sup>4</sup> )	4827
Radii of gyration - X (mm)	8
Radii of gyration - Y (mm)	8
Principal moments along X-Y (mm <sup>4</sup> )	3376 along [1 1]
Principal moments along Y-X (mm <sup>4</sup> )	13031 along [-1 1]
Elastic Modulus - Zx (mm <sup>2</sup> )	1 / y-max= 465
Elastic Modulus - Zy (mm <sup>2</sup> )	1 / x-max= 465

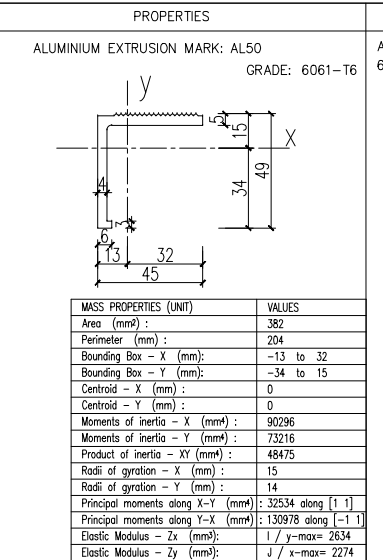

MASS PROPERTIES (UNIT)	VALUES
Area (mm <sup>2</sup> )	135
Perimeter (mm)	80
Bounding	

A1H PROPERTIES

ALUMINIUM EXTRUSION MARK: AL58  
110x30x3mm THK. ALUM ANGLE  
GRADE:

MASS PROPERTIES (UNIT)	VALUES
Area (mm <sup>2</sup> ):	411
Perimeter (mm):	280
Bounding Box - X (mm):	-66 to 44
Bounding Box - Y (mm):	-4 to 26
Centroid - X (mm):	0
Centroid - Y (mm):	0
Moments of inertia - X (mm <sup>4</sup> ):	19801
Moments of inertia - Y (mm <sup>4</sup> ):	518661
Product of inertia - XY (mm <sup>4</sup> ):	52192
Radii of gyration - X (mm):	7
Radii of gyration - Y (mm):	36
Principal moments along X-Y (mm <sup>4</sup> ):	14403 along [1 0]
Principal moments along Y-X (mm <sup>4</sup> ):	524360 along [0 1]
Elastic Modulus - Zx (mm <sup>2</sup> ):	1 / y-max= 775
Elastic Modulus - Zy (mm <sup>2</sup> ):	J / x-max= 7918

PROPERTIES

ALUMINIUM EXTRUSION MARK: AL59  
65x45x3mm THK. ALUM ANGLE  
GRADE:

MASS PROPERTIES (UNIT)	VALUES
Area (mm <sup>2</sup> ):	321
Perimeter (mm):	220
Bounding Box - X (mm):	-45 to 20
Bounding Box - Y (mm):	-10 to 35
Centroid - X (mm):	0
Centroid - Y (mm):	0
Moments of inertia - X (mm <sup>4</sup> ):	57418
Moments of inertia - Y (mm <sup>4</sup> ):	142308
Product of inertia - XY (mm <sup>4</sup> ):	53388
Radii of gyration - X (mm):	13
Radii of gyration - Y (mm):	21
Principal moments along X-Y (mm <sup>4</sup> ):	31658 along [1 0]
Principal moments along Y-X (mm <sup>4</sup> ):	168067 along [0 1]
Elastic Modulus - Zx (mm <sup>2</sup> ):	1 / y-max= 1656
Elastic Modulus - Zy (mm <sup>2</sup> ):	J / x-max= 3186

PROPERTIES

ALUMINIUM EXTRUSION MARK: AL54a  
GRADE: 6061-T6

MASS PROPERTIES (UNIT)	VALUES
Area (mm <sup>2</sup> ):	299
Perimeter (mm):	205
Bounding Box - X (mm):	-32 to 10
Bounding Box - Y (mm):	-22 to 42
Centroid - X (mm):	0
Centroid - Y (mm):	0
Moments of inertia - X (mm <sup>4</sup> ):	123167
Moments of inertia - Y (mm <sup>4</sup> ):	45074
Product of inertia - XY (mm <sup>4</sup> ):	46338
Radii of gyration - X (mm):	20
Radii of gyration - Y (mm):	12
Principal moments along X-Y (mm <sup>4</sup> ):	23525 along [0 1]
Principal moments along Y-X (mm <sup>4</sup> ):	144716 along [-1 0]
Elastic Modulus - Zx (mm <sup>2</sup> ):	1 / y-max= 2909
Elastic Modulus - Zy (mm <sup>2</sup> ):	J / x-max= 1410

PROPERTIES

ALUMINIUM EXTRUSION MARK: AL44a  
GRADE: 6061-T6

MASS PROPERTIES (UNIT)	VALUES
Area (mm <sup>2</sup> ):	767
Perimeter (mm):	328
Bounding Box - X (mm):	-50 to 50
Bounding Box - Y (mm):	-12 to 28
Centroid - X (mm):	0
Centroid - Y (mm):	0
Moments of inertia - X (mm <sup>4</sup> ):	89033
Moments of inertia - Y (mm <sup>4</sup> ):	1019629
Product of inertia - XY (mm <sup>4</sup> ):	0
Radii of gyration - X (mm):	11
Radii of gyration - Y (mm):	36
Principal moments along X-Y (mm <sup>4</sup> ):	89033 along [1 0]
Principal moments along Y-X (mm <sup>4</sup> ):	1019629 along [0 1]
Elastic Modulus - Zx (mm <sup>2</sup> ):	1 / y-max= 3223
Elastic Modulus - Zy (mm <sup>2</sup> ):	J / x-max= 20383

PROPERTIES

ALUMINIUM EXTRUSION MARK: AL44b  
GRADE: 6061-T6

MASS PROPERTIES (UNIT)	VALUES
Area (mm <sup>2</sup> ):	795
Perimeter (mm):	341
Bounding Box - X (mm):	-50 to 50
Bounding Box - Y (mm):	-11 to 27
Centroid - X (mm):	0
Centroid - Y (mm):	0
Moments of inertia - X (mm <sup>4</sup> ):	80715
Moments of inertia - Y (mm <sup>4</sup> ):	1082939
Product of inertia - XY (mm <sup>4</sup> ):	0
Radii of gyration - X (mm):	10
Radii of gyration - Y (mm):	37
Principal moments along X-Y (mm <sup>4</sup> ):	80715 along [1 0]
Principal moments along Y-X (mm <sup>4</sup> ):	1082939 along [0 1]
Elastic Modulus - Zx (mm <sup>2</sup> ):	1 / y-max= 2993
Elastic Modulus - Zy (mm <sup>2</sup> ):	J / x-max= 21704

PROPERTIES

100x100x5mm THK. G.M.S. SHS  
STEEL MARK: S1 GRADE: S275

MASS PROPERTIES (UNIT)	VALUES
Area (mm <sup>2</sup> ):	1892
Perimeter (mm):	755
Bounding Box - X (mm):	-50 to 50
Bounding Box - Y (mm):	-50 to 50
Centroid - X (mm):	0
Centroid - Y (mm):	0
Moments of inertia - X (mm <sup>4</sup> ):	2847031
Moments of inertia - Y (mm <sup>4</sup> ):	2847031
Product of inertia - XY (mm <sup>4</sup> ):	0
Radii of gyration - X (mm):	39
Radii of gyration - Y (mm):	39
Principal moments along X-Y (mm <sup>4</sup> ):	2847031 along [0 -1]
Principal moments along Y-X (mm <sup>4</sup> ):	2847031 along [1 0]
Elastic Modulus - Zx (mm <sup>2</sup> ):	1 / y-max= 56941
Elastic Modulus - Zy (mm <sup>2</sup> ):	J / x-max= 56941

PROPERTIES

120x60x4mm THK. G.M.S. RHS  
STEEL MARK: S2 GRADE: S275

MASS PROPERTIES (UNIT)	VALUES
Area (mm <sup>2</sup> ):	1376
Perimeter (mm):	688
Bounding Box - X (mm):	-60 to 60
Bounding Box - Y (mm):	-30 to 30
Centroid - X (mm):	0
Centroid - Y (mm):	0
Moments of inertia - X (mm <sup>4</sup> ):	847659
Moments of inertia - Y (mm <sup>4</sup> ):	2551979
Product of inertia - XY (mm <sup>4</sup> ):	0
Radii of gyration - X (mm):	25
Radii of gyration - Y (mm):	43
Principal moments along X-Y (mm <sup>4</sup> ):	847659 along [1 0]
Principal moments along Y-X (mm <sup>4</sup> ):	2551979 along [0 1]
Elastic Modulus - Zx (mm <sup>2</sup> ):	1 / y-max= 28255
Elastic Modulus - Zy (mm <sup>2</sup> ):	J / x-max= 42533

PROPERTIES

175x35x6mm THK. G.M.S. ANGLE  
STEEL MARK: S3 GRADE: S275

MASS PROPERTIES (UNIT)	VALUES
Area (mm <sup>2</sup> ):	1224
Perimeter (mm):	420
Bounding Box - X (mm):	-5 to 30
Bounding Box - Y (mm):	-75 to 100
Centroid - X (mm):	0
Centroid - Y (mm):	0
Moments of inertia - X (mm <sup>4</sup> ):	3745997
Moments of inertia - Y (mm <sup>4</sup> ):	61057
Product of inertia - XY (mm <sup>4</sup> ):	-220725
Radii of gyration - X (mm):	55
Radii of gyration - Y (mm):	7
Principal moments along X-Y (mm <sup>4</sup> ):	47883 along [0 -1]
Principal moments along Y-X (mm <sup>4</sup> ):	3759171 along [1 0]
Elastic Modulus - Zx (mm <sup>2</sup> ):	1 / y-max= 37644
Elastic Modulus - Zy (mm <sup>2</sup> ):	J / x-max= 2069

PROPERTIES

100x50x5mm THK. G.M.S. RHS  
STEEL MARK: S4 GRADE: S275

MASS PROPERTIES (UNIT)	VALUES
Area (mm <sup>2</sup> ):	1400
Perimeter (mm):	560
Bounding Box - X (mm):	-50 to 50
Bounding Box - Y (mm):	-25 to 25
Centroid - X (mm):	0
Centroid - Y (mm):	0
Moments of inertia - X (mm <sup>4</sup> ):	561667
Moments of inertia - Y (mm <sup>4</sup> ):	1736667
Product of inertia - XY (mm <sup>4</sup> ):	0
Radii of gyration - X (mm):	20
Radii of gyration - Y (mm):	35
Principal moments along X-Y (mm <sup>4</sup> ):	561667 along [1 0]
Principal moments along Y-X (mm <sup>4</sup> ):	1736667 along [0 1]
Elastic Modulus - Zx (mm <sup>2</sup> ):	1 / y-max= 22467
Elastic Modulus - Zy (mm <sup>2</sup> ):	J / x-max= 34733

PROPERTIES

80x80x8mm THK. G.M.S. ANGLE  
STEEL MARK: S5 GRADE: S275

MASS PROPERTIES (UNIT)	VALUES
Area (mm <sup>2</sup> ):	1216
Perimeter (mm):	320
Bounding Box - X (mm):	-23 to 57
Bounding Box - Y (mm):	-23 to 57
Centroid - X (mm):	0
Centroid - Y (mm):	0
Moments of inertia - X (mm <sup>4</sup> ):	737298
Moments of inertia - Y (mm <sup>4</sup> ):	737298
Product of inertia - XY (mm <sup>4</sup> ):	-436547
Radii of gyration - X (mm):	25
Radii of gyration - Y (mm):	25
Principal moments along X-Y (mm <sup>4</sup> ):	300751 along [1 -1]
Principal moments along Y-X (mm <sup>4</sup> ):	1173845 along [1 1]
Elastic Modulus - Zx (mm <sup>2</sup> ):	1 / y-max= 12923
Elastic Modulus - Zy (mm <sup>2</sup> ):	J / x-max= 12923

PROPERTIES

80x80x5mm THK. G.M.S. SHS  
STEEL MARK: S6 GRADE: S275

MASS PROPERTIES (UNIT)	VALUES
Area (mm <sup>2</sup> ):	1486
Perimeter (mm):	593
Bounding Box - X (mm):	-40 to 40
Bounding Box - Y (mm):	-40 to 40
Centroid - X (mm):	0
Centroid - Y (mm):	0
Moments of inertia - X (mm <sup>4</sup> ):	1391488
Moments of inertia - Y (mm <sup>4</sup> ):	1391488
Product of inertia - XY (mm <sup>4</sup> ):	0
Radii of gyration - X (mm):	31
Radii of gyration - Y (mm):	31
Principal moments along X-Y (mm <sup>4</sup> ):	1391488 along [1 0]
Principal moments along Y-X (mm <sup>4</sup> ):	1391488 along [0 1]
Elastic Modulus - Zx (mm <sup>2</sup> ):	1 / y-max= 34787
Elastic Modulus - Zy (mm <sup>2</sup> ):	J / x-max= 34787

B.D. Ref.  
F.P.B. Ref.

DATE/REVISION/AMENDMENTS

**SUN HUNG KAI**  
ARCHITECTS AND ENGINEERS LTD.

SUN HUNG KAI CENTRE, WANCHAI, HONGKONG  
TEL. 28278111 FAX. 28272884

YEE FAI CONTRACTORS CO. LTD.  
44/F SUN HUNG KAI CENTRE, WANCHAI, HONGKONG  
TEL. 28278111 FAX. 28270717

**美特鋁質有限公司**  
MIDI ALUMINIUM FABRICATOR LTD.

Units 6-8, Sunray Industrial Centre, 1/F  
610 Cha Kwo Ling Road, Kowloon  
Tel: 23489211-4 Fax: (852)2727666

This drawing and design are copyright of the authorized person. No portion may be reproduced without his written permission. Use written dimensions. Measurements to existing works to be verified on site. This drawing shall be read in conjunction with specification and condition of contract.

PROJECT

PROPOSED RESIDENTIAL  
DEVELOPMENT AT  
TSEUNG KWAN O  
AREA 66D2, T.K.O.T.L. 118

TITLE

SECTION PROPERTIES

FILE NAME

DRAWN BY

CHECKED BY

PRINTED DATE

SCALE 1:25

JOB No. J-835 DRAWING No. J835-GR-0004 REV. -

R.S.E.

Lam Kwok Leung  
BS(Eng) CEng MInstREE  
MIRIE, RSE, RPE

FOR B.D. APPROVAL

# GENERAL NOTES

I. SCOPE OF DESIGN:

ALL DIMENSIONS TO BE CHECKED AND VERIFIED ON SITE

II. MAIN MATERIALS AND MECHANICAL PROPERTIES:

1. ALUMINIUM EXTRUSION TO BE ALLOY 6063-T5 TO BS EN755-2:1997 AND DESIGN TO BS 8118	
0.2% PROOF STRESS	Rp0.2= 110 MPa
MINIMUM TENSILE STRENGTH	Rm= 150 MPa
BENDING STRENGTH	po= 110 MPa
SHEAR STRENGTH	pV= 65 MPa
MODULUS OF ELASTICITY	Ea= 70000 MPa
MIN. ELONGATION	A=8%

2. STRUCTURAL STEEL TO BE GRADE S275 TO BS EN 10025: 2004 FOR STEEL PLATE A SECTIONS	
YIELD STRENGTH	Ys= 275 MPa
TENSILE STRENGTH	Us= 430 MPa
DESIGN STRENGTH	pY= 275 MPa
MODULUS OF ELASTICITY	Es= 205000 MPa

3. STAINLESS STEEL BOLT, THROUGH BOLT, SCREW AND NUT TO BS EN ISO 3506:1998 AND DESIGN TO SCI PUBLICATION P291

GRADE	A2-50	A2-70
YIELD STRENGTH (0.2% PROOF STRENGTH)	Yb= 210 MPa	Yb= 450 MPa
MINIMUM TENSILE STRENGTH	Ub= 500 MPa	Ub= 700 MPa
DESIGN TENSILE STRENGTH	pt= 210 MPa	pt= 450 MPa
DESIGN SHEAR STRENGTH	ps= 145 MPa	ps= 311 MPa

4. ALUMINIUM NON-HEAT TREATABLE ALLOYS TO BS EN485-2 : 2004

GRADE	3003-H14
MIN. TENSILE STRENGTH	Rm = 145MPa
0.2% PROOF STRENGTH	RO.2 = 125MPa

SPACING OF STIFFENER (S) = 350mm (MAX.)

5. STAINLESS STEEL LIGHTING FEATURE

- 100MM THK OVERALL LED VINYL SIGNAGE BANNER BOX COMPLETED WITH 3mm THK STAINLESS STEEL CLADDING
- STAINLESS STEEL GENERALLY GRADE 316

III. DESIGN CODES AND STANDARDS

- BS 8118 : 1991 "THE STRUCTURAL USE OF ALUMINIUM"
- HONG KONG "CODE OF PRACTICE FOR THE STRUCTURAL USE OF STEEL" - 2011
- CODE OF PRACTICE ON WIND EFFECTS IN HONG KONG - 2004
- BUILDING (CONSTRUCTION) REGULATIONS 1990
- HONG KONG "CODE OF PRACTICE FOR THE STRUCTURAL USE OF CONCRETE" - 2004

IV. DESIGN CRITERIA:

DESIGN WIND LOAD (AS PER CODE OF PRACTICE ON WIND EFFECTS IN HK-2004)  
 BASIC WIND LOAD : qb = 2.57kPa (Building height above ground level < 50 m)  
 WIND PRESSURE COEFFICIENT : Cp = 1.4  
 DESIGN WIND PRESSURE : qd = qb X Cp = 3.598kPa

V. FABRICATION & INSTALLATION

- ALL DIMENSIONS SHOWN ON SHOP DRAWING TO BE READ IN MILLIMETER (mm), EXCEPT THE FLOOR LEVEL MARK TO BE READ IN METER (m)
- CORROSION PROTECTION / PREVENTION FOR BIMETALLIC EFFECTS BITUMINOUS PAINT FOR CONTACTED SURFACES BETWEEN ALUMINIUM & R.C. STRUCTURE OR GALVANIZED STEEL
- WELDING FOR STRUCTURAL STEEL:
  - ALL WELDING SHALL COMPLY WITH BS EN 1011
  - SITE WELD SURFACES TO BE PROTECTED BY ZINC CHROMATE
  - DESIGN WELD STRENGTH: pw=220 MPa
  - ALL WELDING SHOULD BE 4mm FILLET WELD UNLESS OTHERWISE NOTED

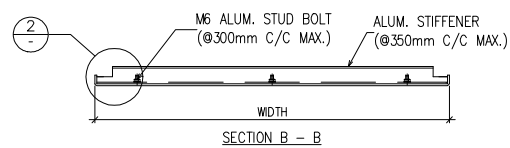
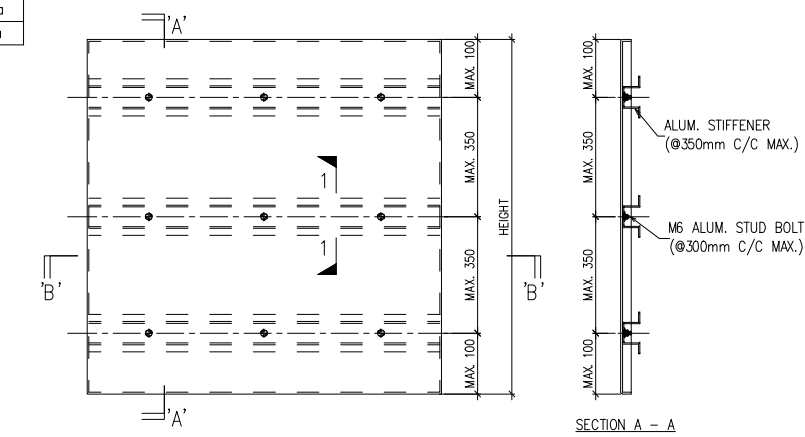
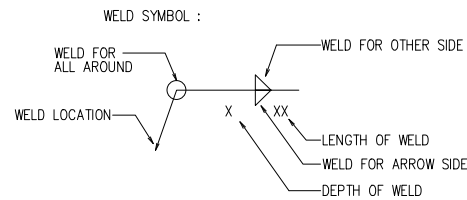

TYPICAL ALUM. CLADDING UNIT DETAIL

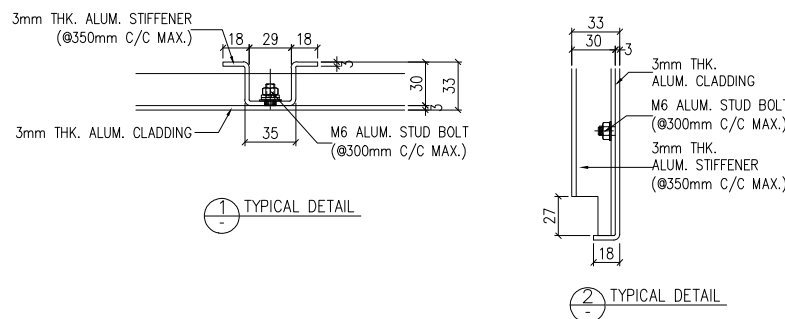

4. PROTECTIVE TREATMENT:

ALL STRUCTURAL MILD STEEL WORKS TO BE HOT DIP GALVANIZED OF ZINC TO BS EN ISO 1461:1999 WITH MIN. THK. OF 85mm

5. HILTI ANCHOR BOLT:

INSTALLATION SHALL BE IN STRICT ACCORDANCE WITH THE MANUFACTURER'S PRINTED INSTRUCTIONS

ANCHOR BOLT	M8x75 HILTI HST3-R	M10x90 HILTI HST3-R
EFFECTIVE EMBEDMENT DEPTH (mm)	47	60
MAX. WORKING TENSILE LOAD (kN)	1.7	3
MAX. WORKING SHEAR LOAD (kN)	4.3	6.7
TENSILE TEST LOAD (kN)	2.55	4.5
MIN. EDGE DISTANCE (mm)	45	50
MIN. BOLT SPACING	40	55

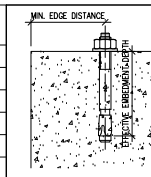

MEMBER LIST		MEMBER LIST	
MEMBER MARK : M1	ALUM. TRANSOM	MEMBER MARK : M3	ALUM. TRANSOM
AREA (mm <sup>2</sup> )	3145.8	AREA (mm <sup>2</sup> )	2637.0
Ixx (mm <sup>4</sup> )	5,685,847.9	Ixx (mm <sup>4</sup> )	5262146.1
Iyy (mm <sup>4</sup> )	4,163,358.9	Iyy (mm <sup>4</sup> )	8897618.8
Zxx (mm <sup>3</sup> )	65,036	Zxx (mm <sup>3</sup> )	54746.7
Zyy (mm <sup>3</sup> )	148,744	Zyy (mm <sup>3</sup> )	69516.9
REMARK	GR.: 6063-T6	REMARK	GR.: 6063-T6
MEMBER MARK : M2	ALUM. ADAPTER	MEMBER MARK : M4	ALUM. COVER
AREA (mm <sup>2</sup> )	601.8	AREA (mm <sup>2</sup> )	66.6
Ixx (mm <sup>4</sup> )	109,044.8	Ixx (mm <sup>4</sup> )	1326.5
Iyy (mm <sup>4</sup> )	515,499	Iyy (mm <sup>4</sup> )	4870.3
Zxx (mm <sup>3</sup> )	6265	Zxx (mm <sup>3</sup> )	105.7
Zyy (mm <sup>3</sup> )	12,035	Zyy (mm <sup>3</sup> )	315.9
REMARK	GR.: 6063-T6	REMARK	GR.: 6063-T6
MEMBER MARK : M5	ALUM. EXTRUSION		
AREA (mm <sup>2</sup> )	473.4		
Ixx (mm <sup>4</sup> )	53980.8		
Iyy (mm <sup>4</sup> )	100637.3		
Zxx (mm <sup>3</sup> )	3837		
Zyy (mm <sup>3</sup> )	3679		
REMARK	GR.: 6063-T5		

DATE/REVISION/AMENDMENTS



SUN HUNG KAI CENTRE, WANCHAI, HONGKONG  
 TEL. 28278111 FAX. 28272884

YEE FAI CONTRACTORS CO. LTD.

44/F SUN HUNG KAI CENTRE, WANCHAI, HONGKONG  
 TEL. 28278111 FAX. 28270717

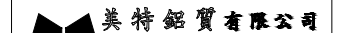

Units 6-8, Sunray Industrial Centre, 1/F  
 610 Cha Kwo Ling Road, Kowloon  
 Tel: 23489211-4 Fax: (852)27727666

This drawing and design are copyright of the authorized person. No portion may be reproduced without his written permission. Use written dimensions. Measurements to existing works to be verified on site. This drawing shall be read in conjunction with specification and condition of contract.

PROJECT  
 PROPOSED RESIDENTIAL  
 DEVELOPMENT AT  
 TSEUNG KWAN O  
 AREA 66D2, T.K.O.T.L. 118

TITLE  
 GENERAL NOTES FOR PODIUM  
 ALUM. CLADDING,  
 ALUM. FEATURE &  
 LIGHTING FEATURE

FILE NAME

DRAWN BY

CHECKED BY

PRINTED DATE

SCALE

JOB No. DRAWING No. REV.

J835-GN01 -

R.S.E.

Lam Kwok Leung  
 BSc(Eng) CEng MStruct  
 MBRIE RSE RPE

FOR B.D. APPROVAL

